



RING RJS010 Lithium Jump Starter Instruction Manual

[Home](#) » [Ring](#) » RING RJS010 Lithium Jump Starter Instruction Manual 



RJS010 / RJS020
LITHIUM JUMP STARTER
500A / 1000A ULTRA BOOST
For workshop and professional use

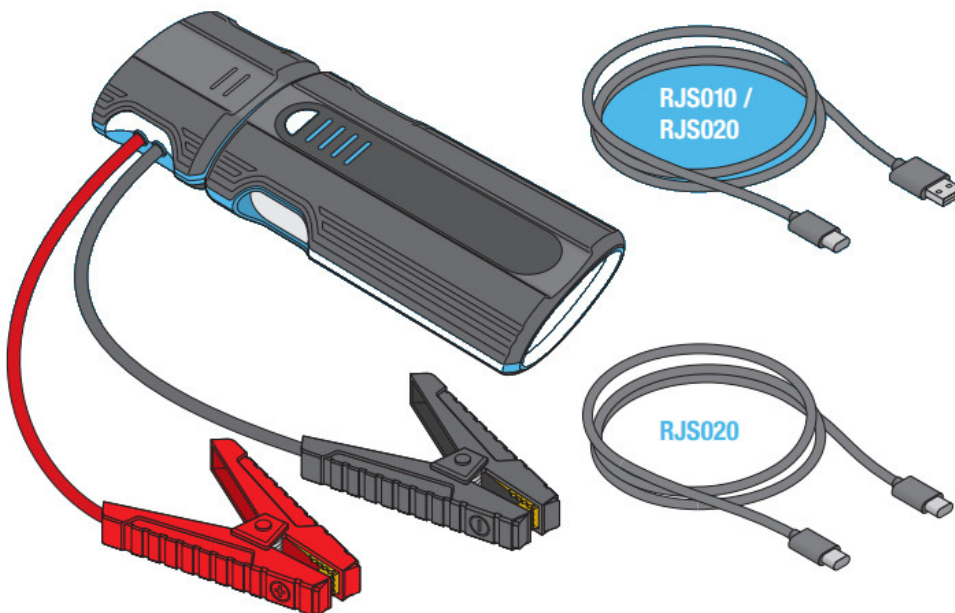

Contents

- [1 RJS010 Lithium Jump Starter](#)
- [2 Documents / Resources](#)
 - [2.1 References](#)



<https://www.ringautomotive.com/en/battery-care>



12V



Car



Motorcycle



4x4



Van

INNOVATION ON THE MOVE

OSRAM

NOT FOR PRINT PRODUCTION

WARNING:

This POF file is for reference only and not to be used for the creation of production art. Colour printouts and screen displays should not be used for colour approval as colours may vary from device to device, The colour values for this file are defined in either Pantone (PMS), HKS, or in process colours (CMYK), For obtaining hard-copies in actual size (1:1) you need to enter the proper settings in your printer options.

RJS010 / RJS020

LITHIUM JUMP STARTER 500A / 1000A ULTRA BOOST

For workshop and professional use

Warnings*

DANGER! BE AWARE, LEAD-ACID BATTERIES GENERATE EXPLOSIVE GASES DURING NORMAL BATTERY OPERATION. FOR THIS REASON, IT IS VERY IMPORTANT TO READ AND FOLLOW THESE INSTRUCTIONS CAREFULLY, EACH TIME YOU USE THE CHARGING EQUIPMENT.

WARNING! Modern vehicles contain extensive electronic systems. You are required to check with the vehicle manufacturer, for any specific instructions regarding the use of this type of equipment on each vehicle.

Charge in a well-ventilated area.

DO NOT operate near flammable liquids or gases.

DO NOT touch the clamps together or allow to touch the chassis.

DO NOT connect the clamps via another metallic object.

DO NOT cross connect power leads from charger to battery. Ensure positive (+/RED) is connected to positive and negative (-/BLACK) is connected to negative.

DO NOT pull the cables or clamps from the battery terminals.

DO NOT pull or carry the charger by the power cable.

DO NOT pull the plug from the socket by the cable.

DO NOT use worn or damaged cables, plugs or clamps. Any faulty item should be immediately repaired or replaced by a qualified technician.

DO NOT use the charger for a task for which it is not designed.

DO NOT cover or obstruct the charger ventilation louvres or fan.

DO NOT at the same time charge batteries of different capacities or discharge levels.







For list of General Power Tool Safety Warnings please scan the QR code or visit:

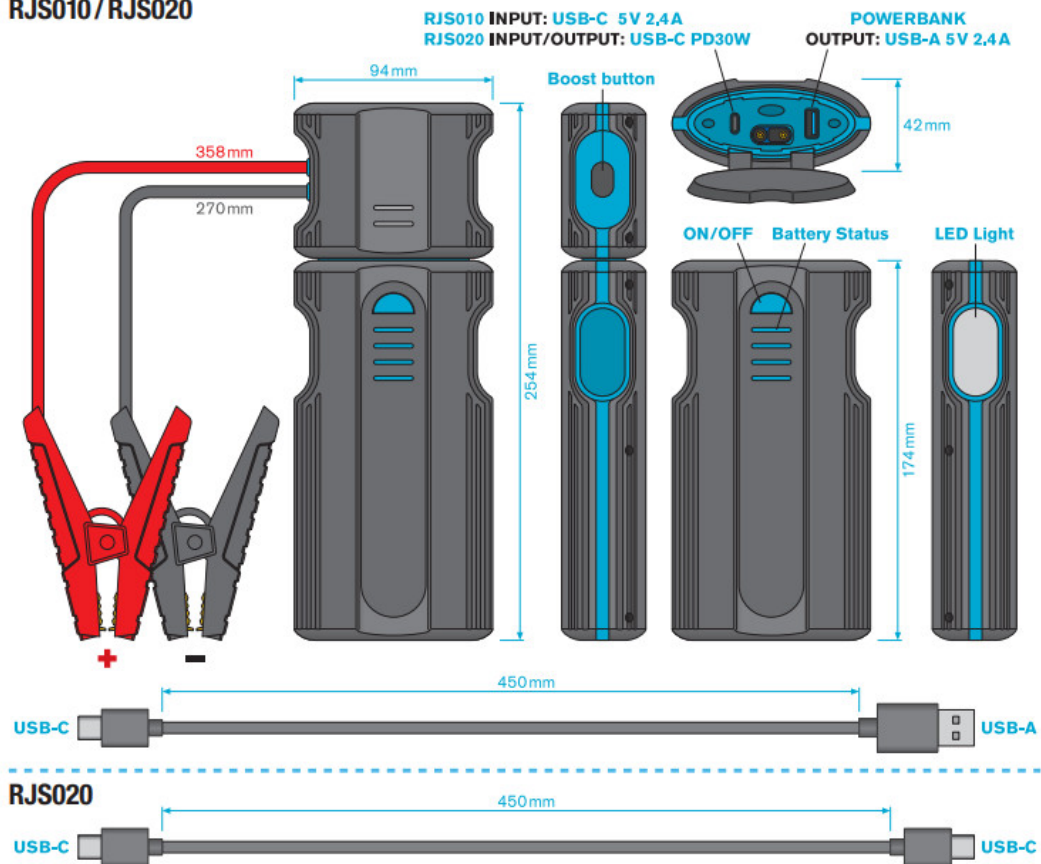

www.ringautomotive.com/en/product-safety-documents

RJS010 / RJS020



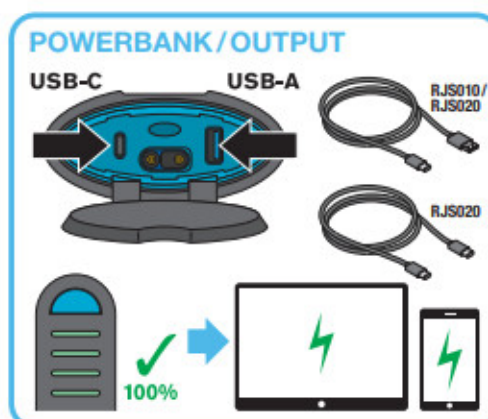
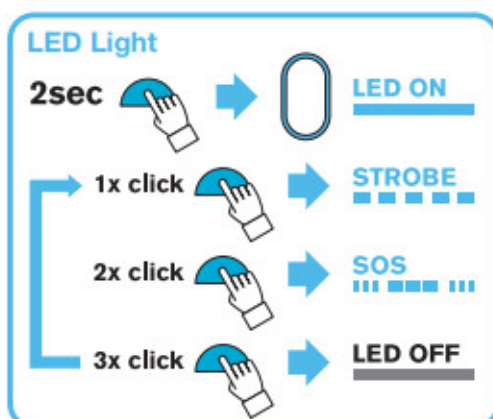
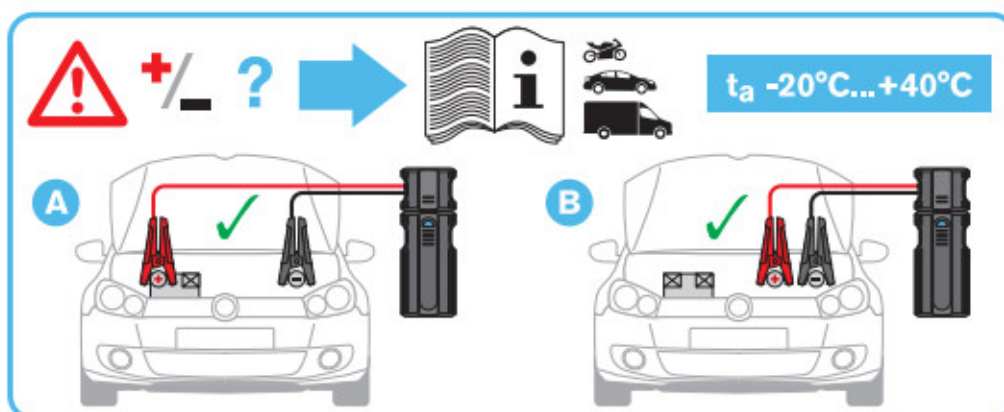
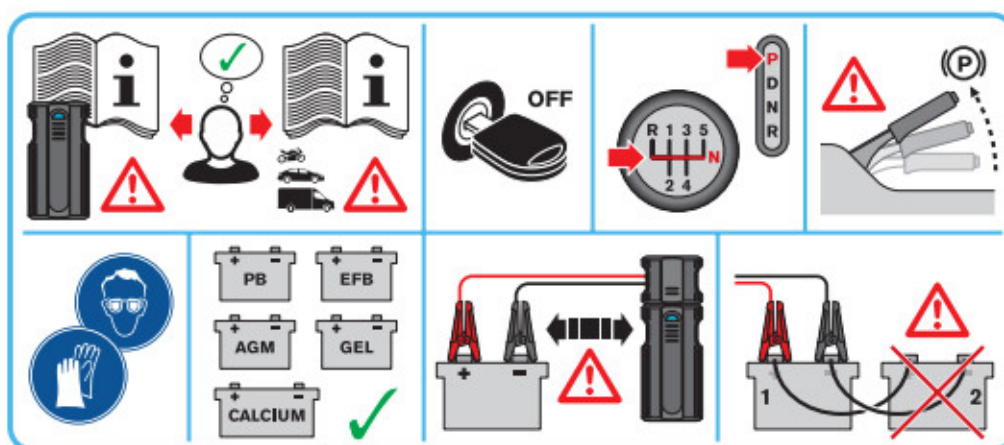

	RJS010	RJS020
	s 3.0 L Petrol, s 1.5 L Diesel	s 5.0 L Petrol, s 2.0 L Diesel
	Rechargeable Li-ion Battery 6000 mAh	Rechargeable Li-ion Battery 8000 mAh
	a: 200A (3 s) / b: 500 A (0.1s)	a: 250A (3s) / b: 1000A (0.1 s)
	USB-C (input): 5V 2A USB (output): Quick Charge (5V 3A; 9V 2 A; 12V 1.5A)	USB (output): Quick Charge 5V 3A; 9V 2 A ; 12V 1.5A)
	Normal temperature range for use: -20°C...55°C	
	Temperature Range for charging: 0°C...20°C	

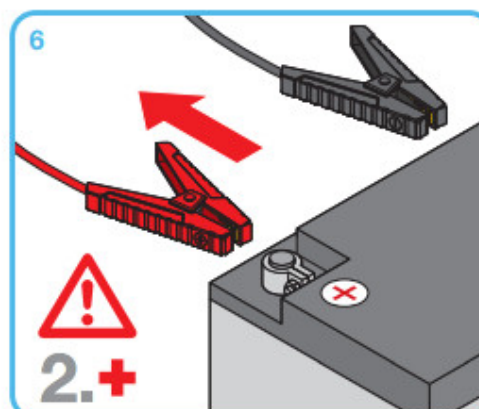
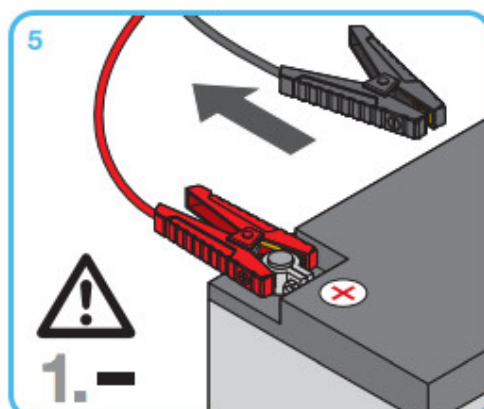
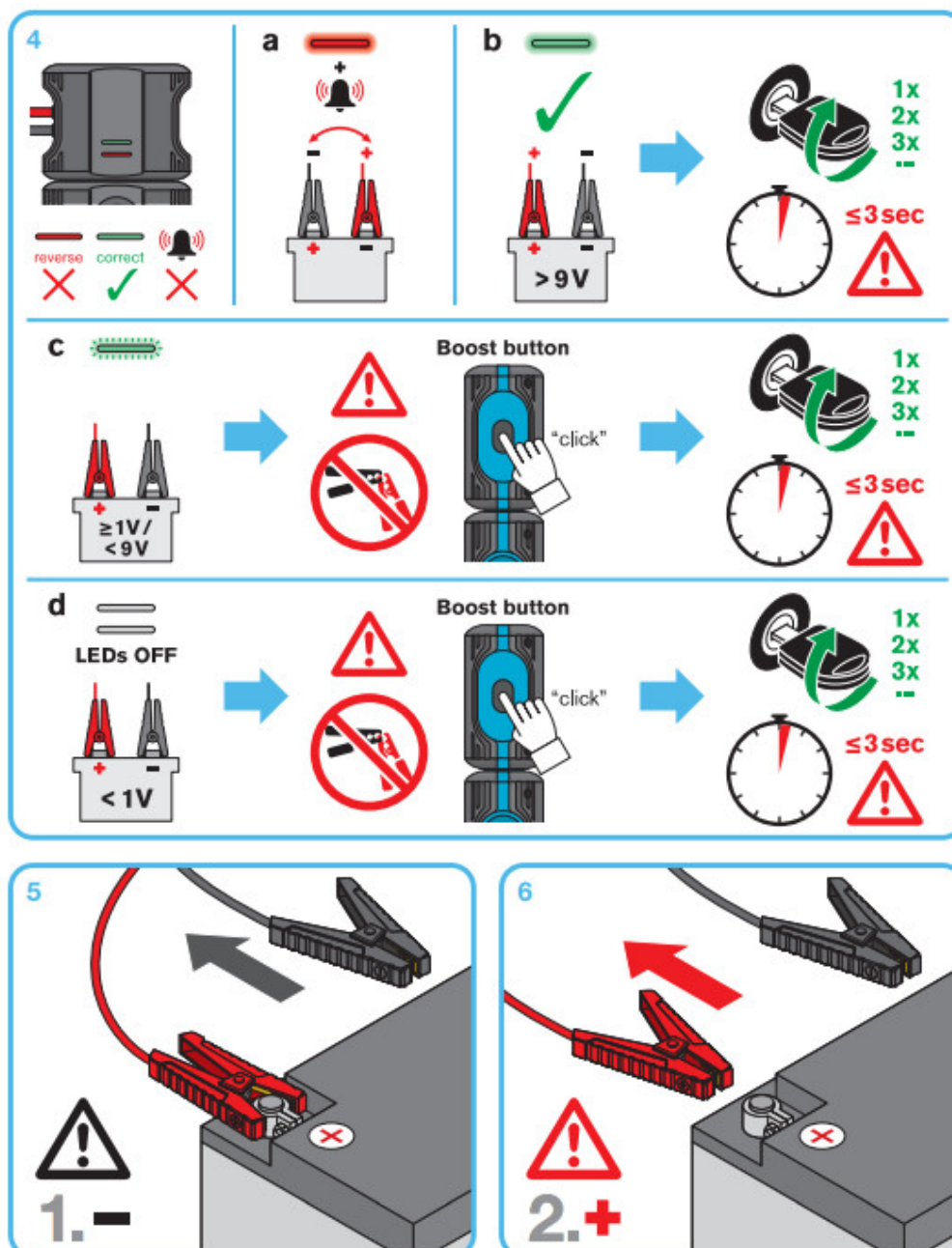



This appliance is not intended for use by persons (including children) with reduced physical, sensory or mental capabilities, or lack of experience and knowledge, unless they have been given supervision or instruction concerning use of the appliance by a person responsible for their safety. Children should be supervised to ensure that they do not play with the appliance. For indoor use only. Charging only rechargeable Batteries. Disconnect the supply before making or breaking the connections to the battery. **WARNING:** Explosive gases. Prevent flames and sparks.

WARNING: Use of unauthorized parts or failure to follow maintenance Instructions may create a risk of electric shock or injury. Store the manual in a safe place. ** Always charge before use!

	Do not use in extreme heat.
	Do not use in extreme cold.
	No drinks/liquids.

	No smoking/vaping
	Keep away from children.
	Do not drop.
	Do not expose to moisture.
	Do not charge a frozen battery.
	Do not damage cables.
	Do not use with damaged cable.
	Keep cables away from moving parts
	Do not carry by cables.
	Do not touch clamps together
	Risk of fire
	Risk of electric shock
	Risk of hazardous materials
	Use in a well ventilated area
	Battery may emit fumes
	Surrounding items may emit fumes



The UK Conformity Assessed mark identifies products conforming with the statutory requirements (refer to "Declaration of Conformity").



The EU Conformity Assessed mark identifies products conforming with the statutory requirements (refer to "Declaration of Conformity").

The UKCA / CE declaration of conformity is available on request from technical support@ringautomotive.com

Not for use by children. ATTENTION: The batteries in your product are the Lithium-Ion type. Do not dispose of battery packs/batteries into household waste, fire or water.

Battery packs/batteries should be collected, recycled or disposed of in an environmental-friendly manner



File instructions for future reference.



Imported by
OSRAM GmbH
Nonnendammallee 44
13629 Berlin Germany

www.osram.com



Manufactured by
Ring Automotive Limited
Volvox House, Gelderd Road,
LEEDS, LS12 6NA,
UNITED KINGDOM

Telephone +44 (0)113 213 2000

Fax +44 (0)113 231 0266

Email autosales@ringautomotive.com

www.ringautomotive.com



C10449059
G15127558
16.11.23

Documents / Resources



[RING RJS010 Lithium Jump Starter](#) [pdf] Instruction Manual

RJS010, RJS010 Lithium Jump Starter, Lithium Jump Starter, Jump Starter, Starter

References

- [OSRAM](#) [OSRAM Americas](#) | [OSRAM SYLVANIA Homepage](#)
- [User Manual](#)

[Manuals+](#), [Privacy Policy](#)

This website is an independent publication and is neither affiliated with nor endorsed by any of the trademark owners. The "Bluetooth®" word mark and logos are registered trademarks owned by Bluetooth SIG, Inc. The "Wi-Fi®" word mark and logos are registered trademarks owned by the Wi-Fi Alliance. Any use of these marks on this website does not imply any affiliation with or endorsement.