



## Contents [ [hide](#) ]

- [1 ring Mailbox Sensor](#)
- [2 Non-metal mailbox installation](#)
- [3 Metal mailbox installation](#)
- [4 Replacing the batteries.](#)
- [5 Frequently Asked Questions](#)
- [6 Documents / Resources](#)
  - [6.1 References](#)

# ring

## ring Mailbox Sensor



## Product Specifications:

- Model: Mailbox Sensor
- Power Source: 3 AAA batteries (included)
- Compatibility: Works with the Ring app
- Installation Type: Non-metal or Metal mailbox
- Antenna: Included for signal transmission

## Tools needed

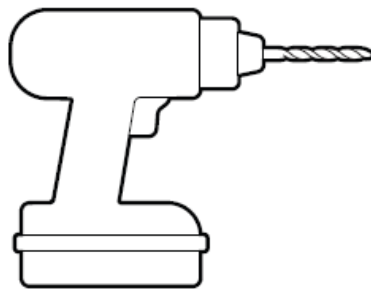

Drill

5/16 in (8 mm) drill bit

1. Download the Ring app.
2. Slide to remove the mounting plate.
- 3.

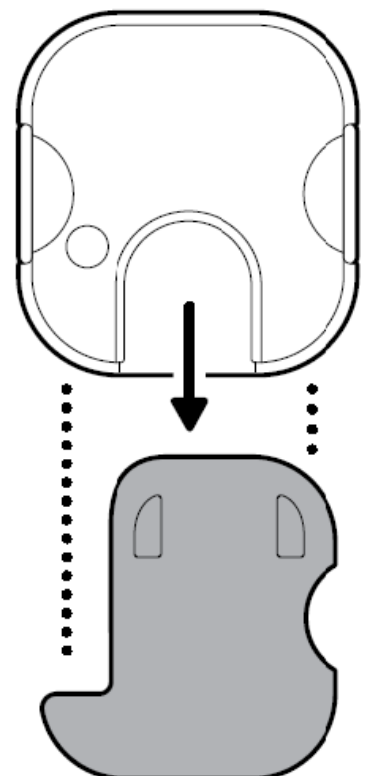
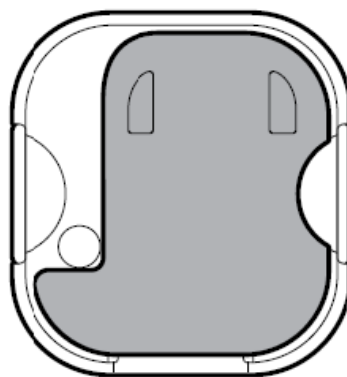

Scan the QR code on your device.

4. Reattach the mounting plate.
5. Follow in-app instructions.

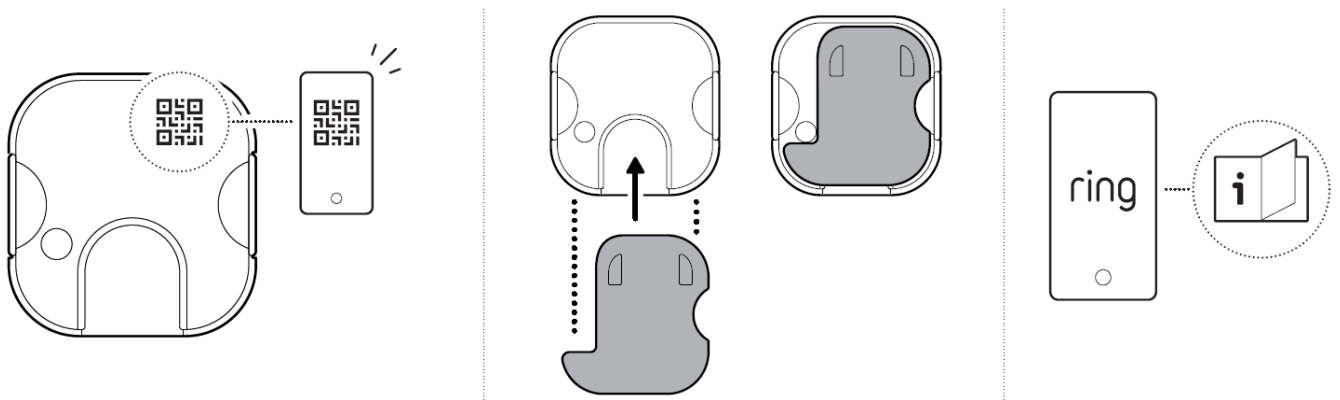

## Non-metal mailbox installation

1. Pull the tabs on the side of your sensor to remove the back cover.
- 2.

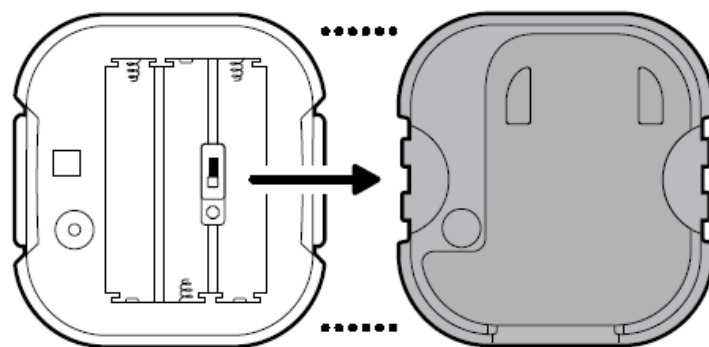
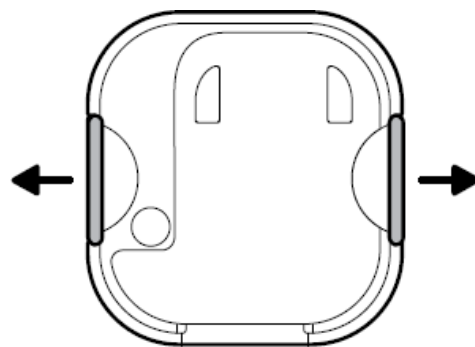

Flip the switch in the battery compartment away from the octagon marking.

3. Insert the three included AAA batteries.

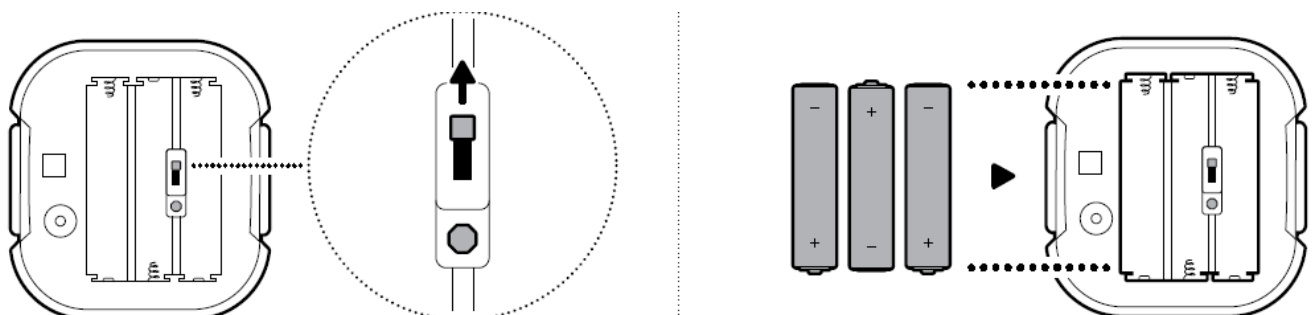

4. Reattach the back cover.
5. Mount your sensor on the inside of the mailbox lid with an included adhesive.

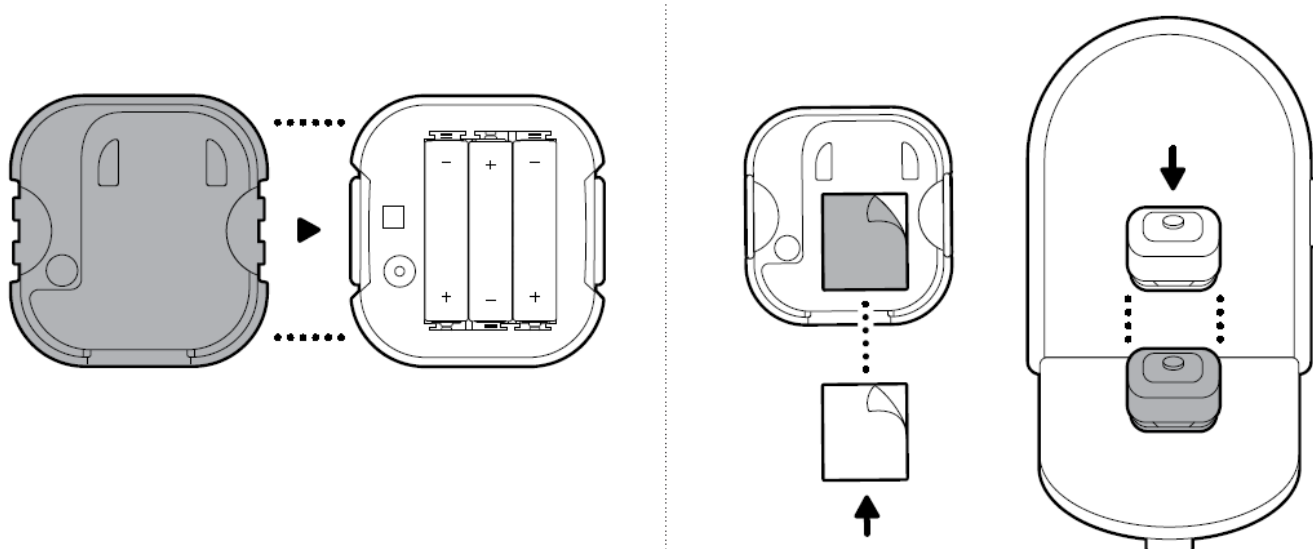

## Metal mailbox installation

1. Pull the tabs on the side of your sensor to remove the back cover.
- 2.

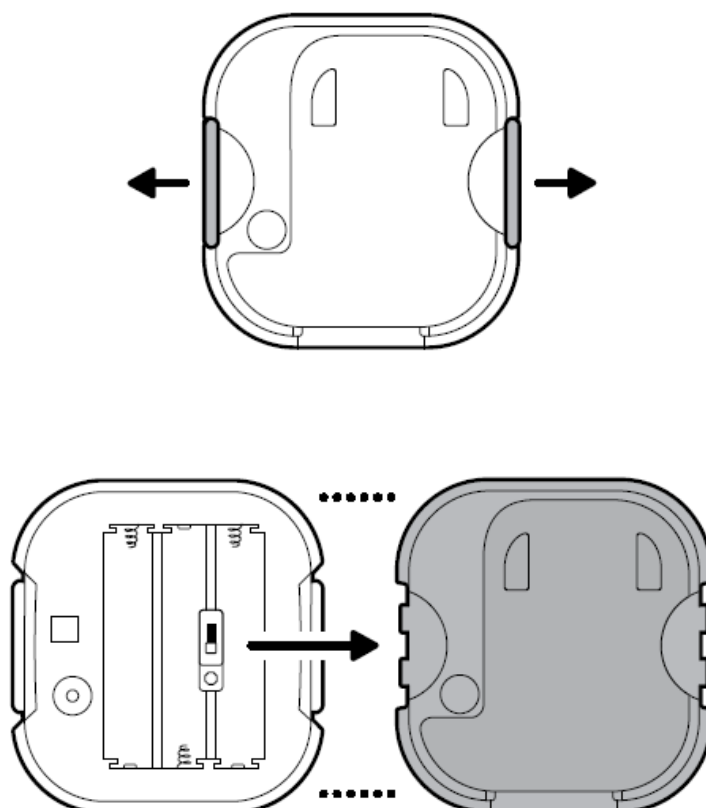

Keep the switch in the battery compartment flipped toward the octagon marking.

3. Insert the three included AAA batteries.

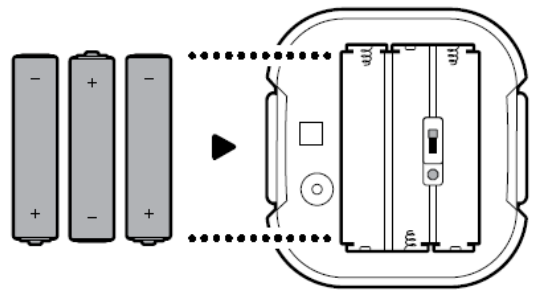
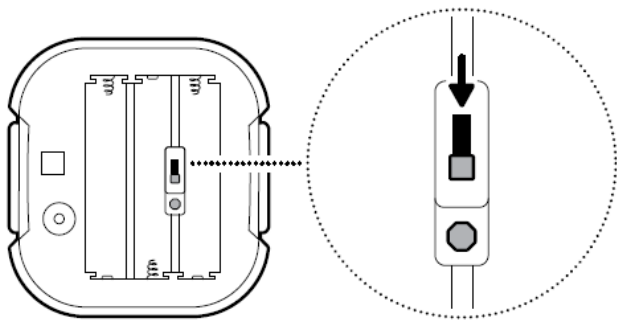

4. Reattach the back cover.

5. Drill a hole through your mailbox with a 5/16 in (8 mm) drill bit.

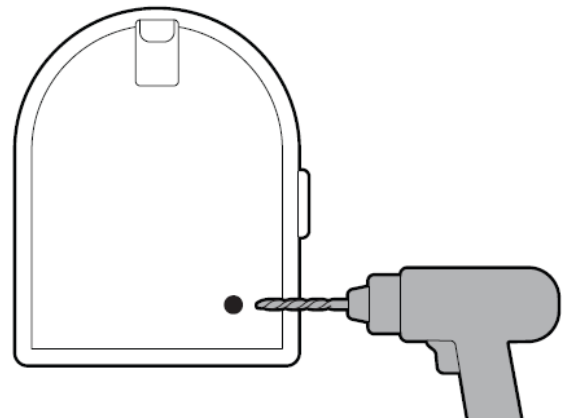
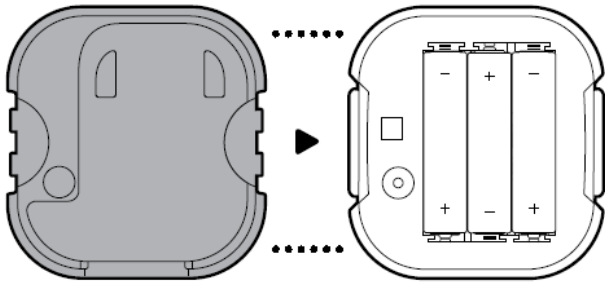

NOTE: The antenna requires a gap or hole in your mailbox to connect to your sensor once it is installed.

6. Insert the antenna cable through the gap or hole in your mailbox.

7. Plug the antenna into your sensor.

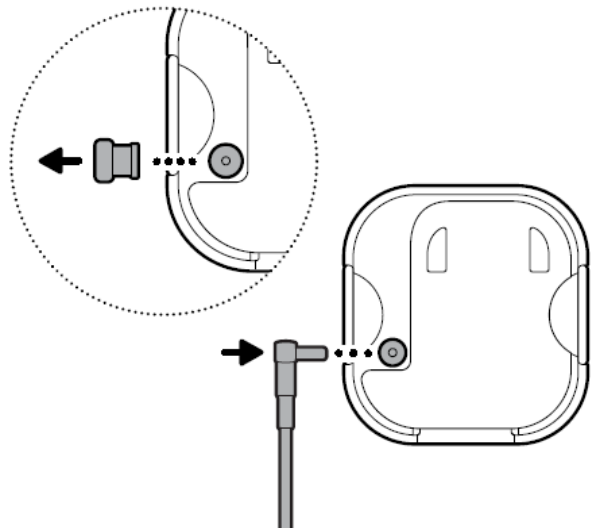
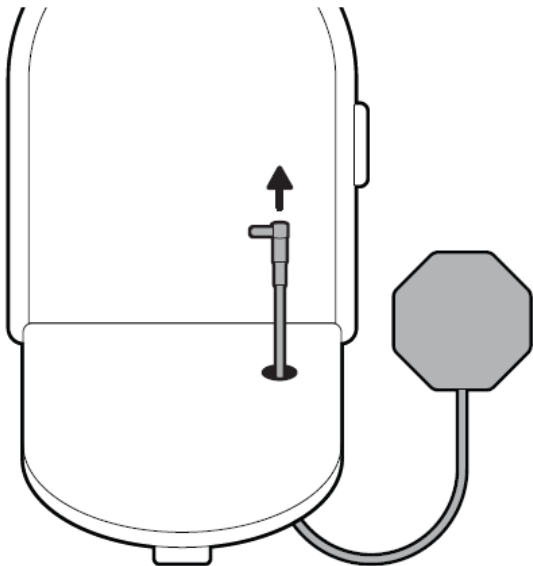

8. Mount your sensor on the inside of the mailbox lid with an included adhesive.

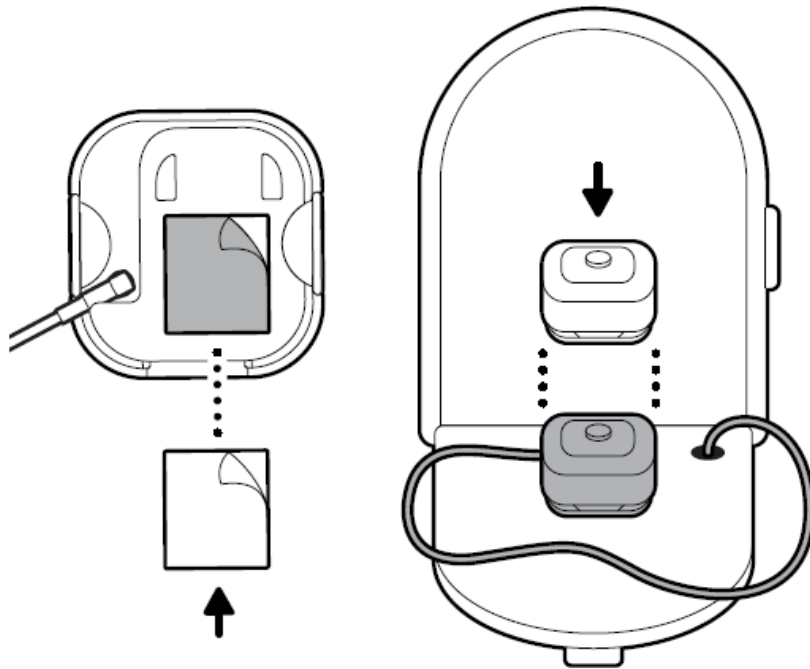

9. Mount the hexagonal end of the antenna to the outside of your mailbox with an included adhesive.
10. If you drilled a hole, wrap the included grommet around the cable and plug the hole.

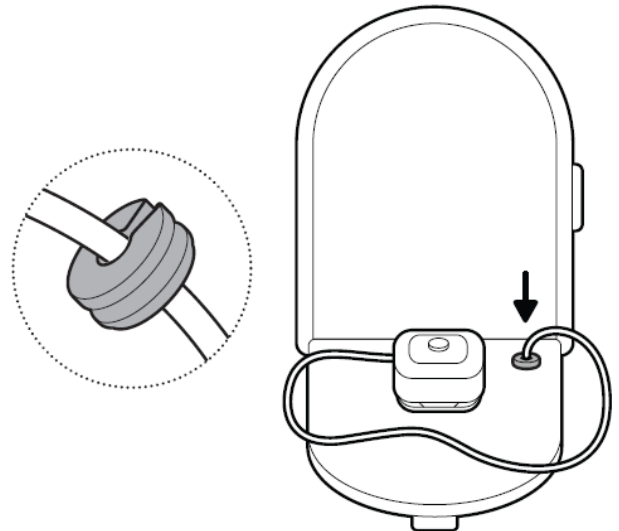
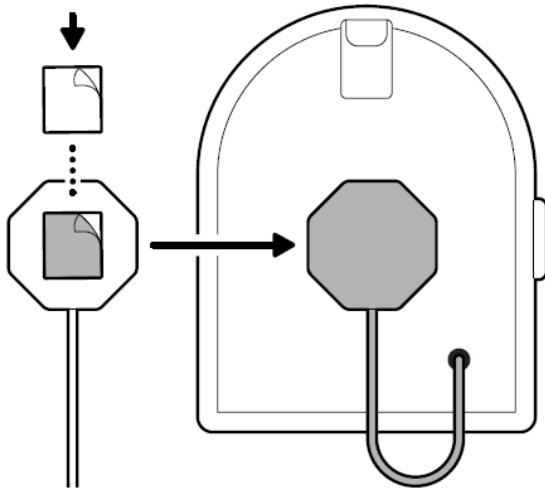

11. Manage the cable with the included cable management system.

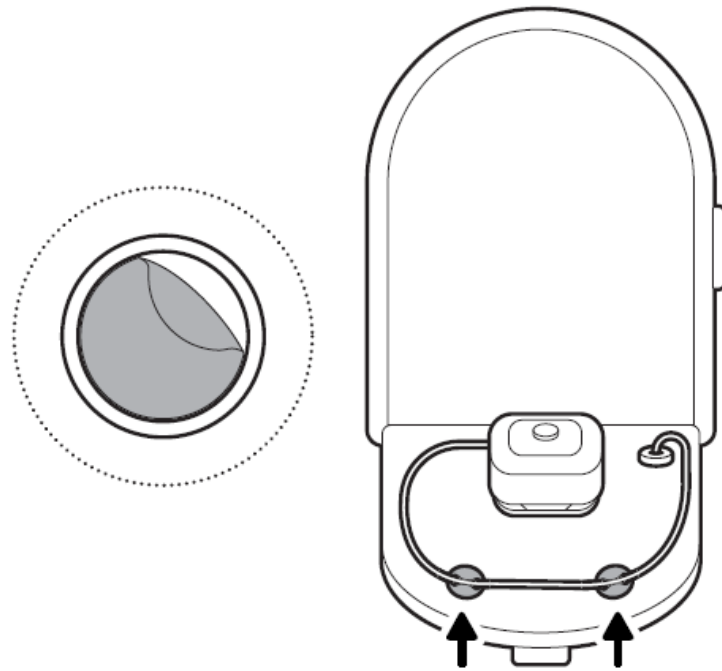

## Replacing the batteries.

1. Slide your sensor off the mount to remove.
2. Unplug the antenna, if attached.
- 3.

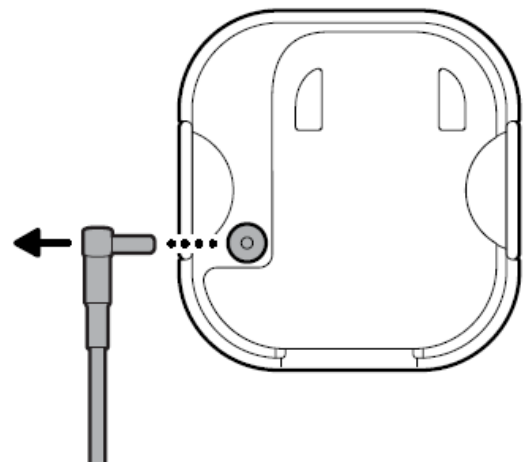
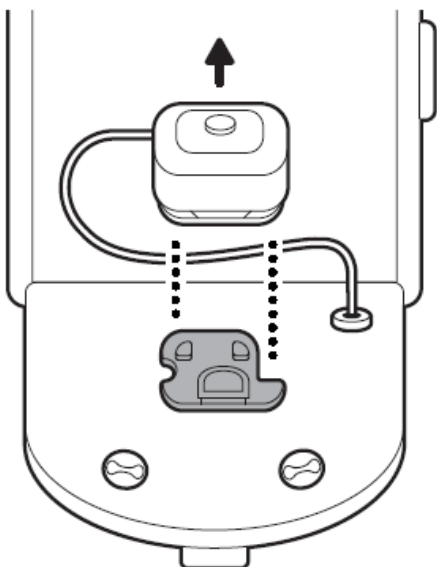

Pull the tabs on the side of your sensor to remove the back cover.

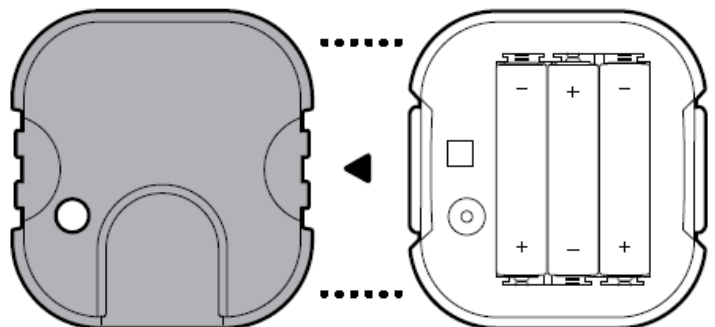
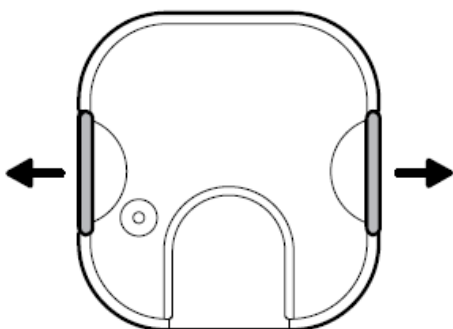

## Frequently Asked Questions

- Q: How do I connect my Mailbox Sensor to the Ring app?**  
A: Scan the QR code on your device and follow the in-app instructions after downloading the Ring app.
- Q: What should I do if my Mailbox Sensor batteries run out?**  
A: Follow the steps provided in the manual to replace the AAA batteries. Remember to unplug the antenna before removing the back cover.

## Documents / Resources

	<a href="#">ring Mailbox Sensor [pdf]</a> Installation Guide RBMB004, 2AEUPRBMB004, bmb004, Mailbox Sensor, Mailbox, Sensor
---	--

## References

- [Contact Us](#)
- [Welcome to Ring Help!](#)
- [User Manual](#)

2AEUPRBMB004, bmb004, Mailbox, Mailbox Sensor, RBMB004, Ring,

Ring Sensor

—Previous Post

[ring RBMB004 Mailbox Sensor Instruction Manual](#)

## Leave a comment

Your email address will not be published. Required fields are marked \*

Comment \*



Name

Email

Website

☐ Save my name, email, and website in this browser for the next time I comment.

Post Comment

Search:

e.g. whirlpool wrf535swhz

Search

[Manuals+](#) | [Upload](#) | [Deep Search](#) | [Privacy Policy](#) | [@manuals.plus](#) | [YouTube](#)

This website is an independent publication and is neither affiliated with nor endorsed by any of the trademark owners. The "Bluetooth®" word mark and logos are registered trademarks owned by Bluetooth SIG, Inc. The "Wi-Fi®" word mark and logos are registered trademarks owned by the Wi-Fi Alliance. Any use of these marks on this website does not imply any affiliation with or endorsement.