

CARE Rightest Wiz Plus



CARE Rightest Wiz Plus User Guide

[Home](#) » [RIGHTEST](#) » CARE Rightest Wiz Plus User Guide 

Contents

- 1 CARE Rightest Wiz Plus
- 2 Product Information
- 3 Meter Pairing
- 4 Download and Install App
- 5 Use phone number to create an account
- 6 Pair Glucometer
- 7 Setting up lifestyle
- 8 Register Product Serial Number And Scan Store QR Code
- 9 BG Target Range
- 10 How to find more information
- 11 Contact
- 12 Documents / Resources
 - 12.1 References

RIGHTEST

CARE Rightest Wiz Plus



Product Information

Specifications

- **Product Name:** RIGHTEST CARE Glucometer
- **Compatibility:** iOS and Android devices with Bluetooth capability
- **Features:** Blood glucose monitoring, data syncing, lifestyle scheduling
- **Availability:** Available in specific regions

FAQ

- **Q:** What should I do if I encounter issues with Bluetooth pairing?
 - **A:** Make sure the Bluetooth on both your mobile device and glucometer is turned on. Follow the on-screen instructions carefully during the pairing process.
- **Q:** Can I use the app in any country?
 - **A:** The app's availability may vary by region. Check the app store for compatibility in your area.

Meter Pairing

- **Step 1.** Download and Install RIGHTEST CARE
- **Step 2.** Use phone number to create an account
- **Step 3.** Pair glucometer
- **Step 4.** Setting up lifestyle
- **Step 5.** Register product serial number and scan store QR code
- **Step 6.** We provide BG target range for your BG management as reference.

Download and Install App

Step 1. Download and Install RIGHTEST CARE

Method 1) Scan QR code to download

- Open QR code scanner on your mobile device.



Method 2) Search “RIGHTEST CARE” on App Store or Google Play, download and install.



- Available in particular regions only.

Download



• RIGHTEST CARE Meter Pairing

ALL PICTURES SHOWN ARE FOR ILLUSTRATION PURPOSE ONLY.
ACTUAL PRODUCT MAY VARY DUE TO PRODUCT ENHANCEMENT.

Use phone number to create an account

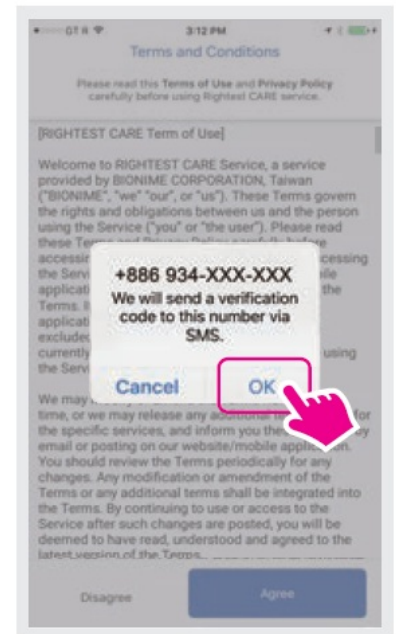
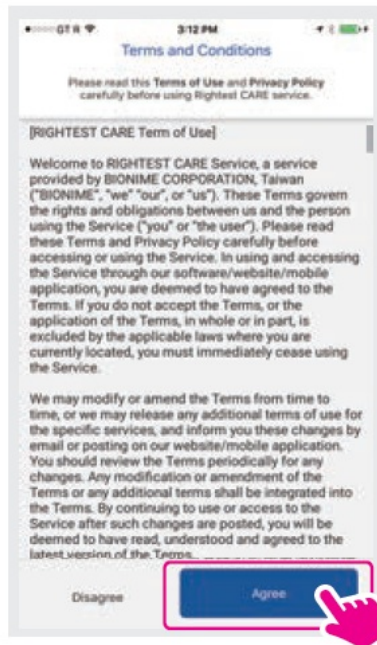
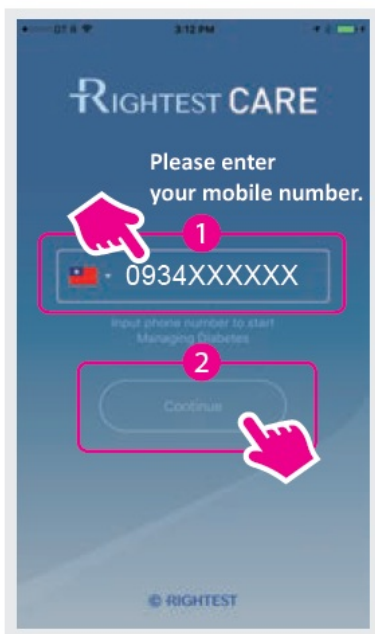

1. Select your country and Enter your mobile phone number.
2. Accept terms of use and privacy policy to use the App.
3. System sends out verification code to your phone via SMS.

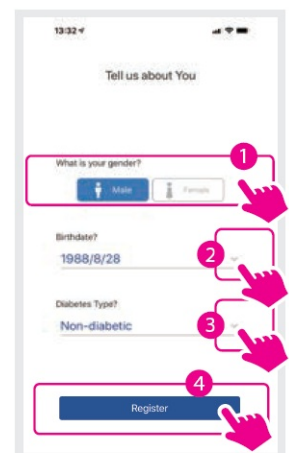
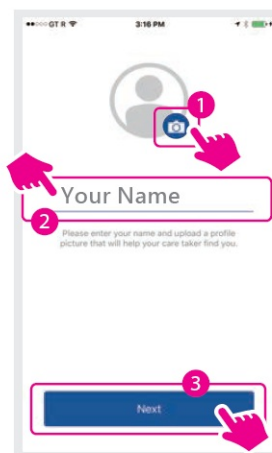
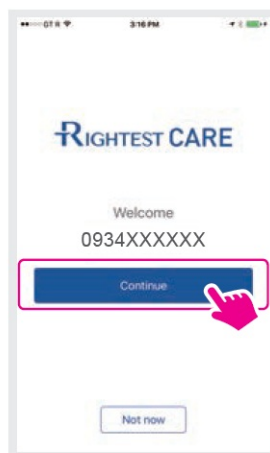

4. Enter SMS verification code.

5. Continue to set the user account. Press Continue to set up the account.
6. Please select your profile photo and enter your name.
7. Please select your basic information, click “register” when it's done.

Pair Glucometer

Pairing mode shows on screen after completion of registration. Follow the instructions to pair glucometer.

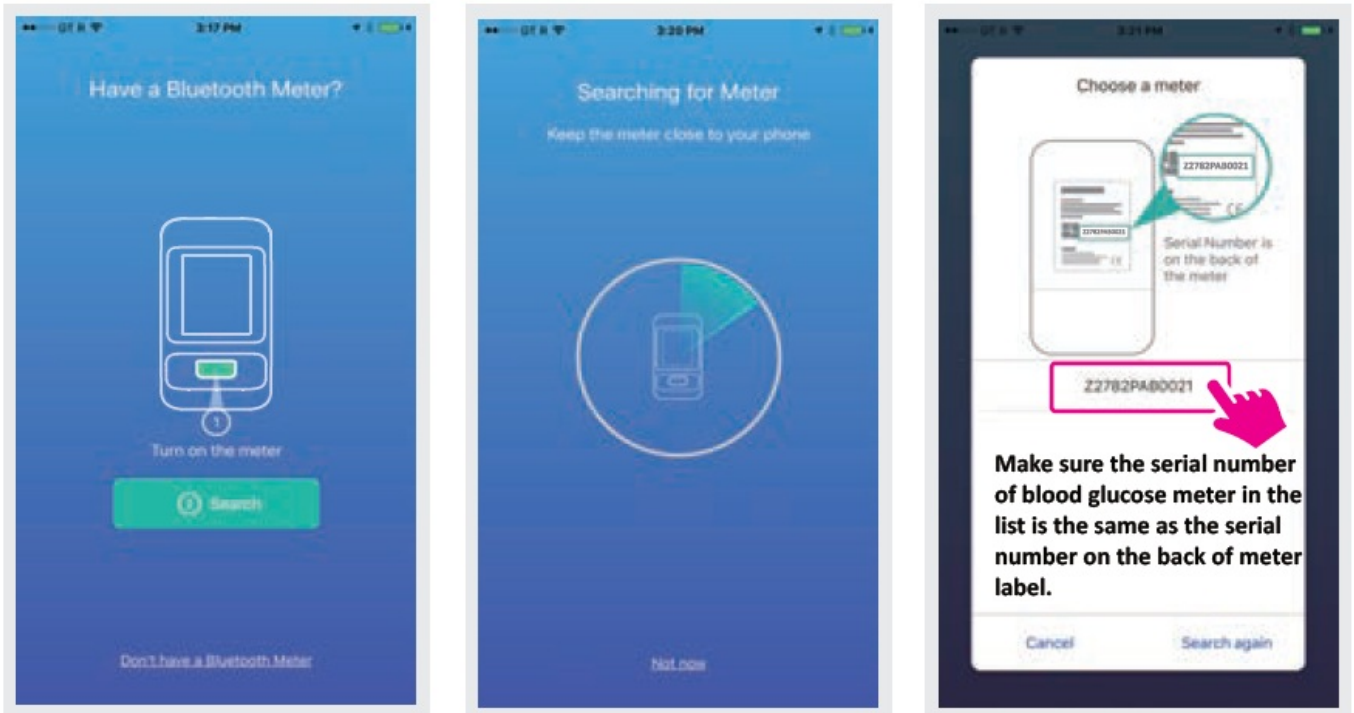

1. Activate Bluetooth of glucometer before clicking “search” on your mobile device.
2. Search for nearby meters.
3. Pairing your meter by selecting its serial number.

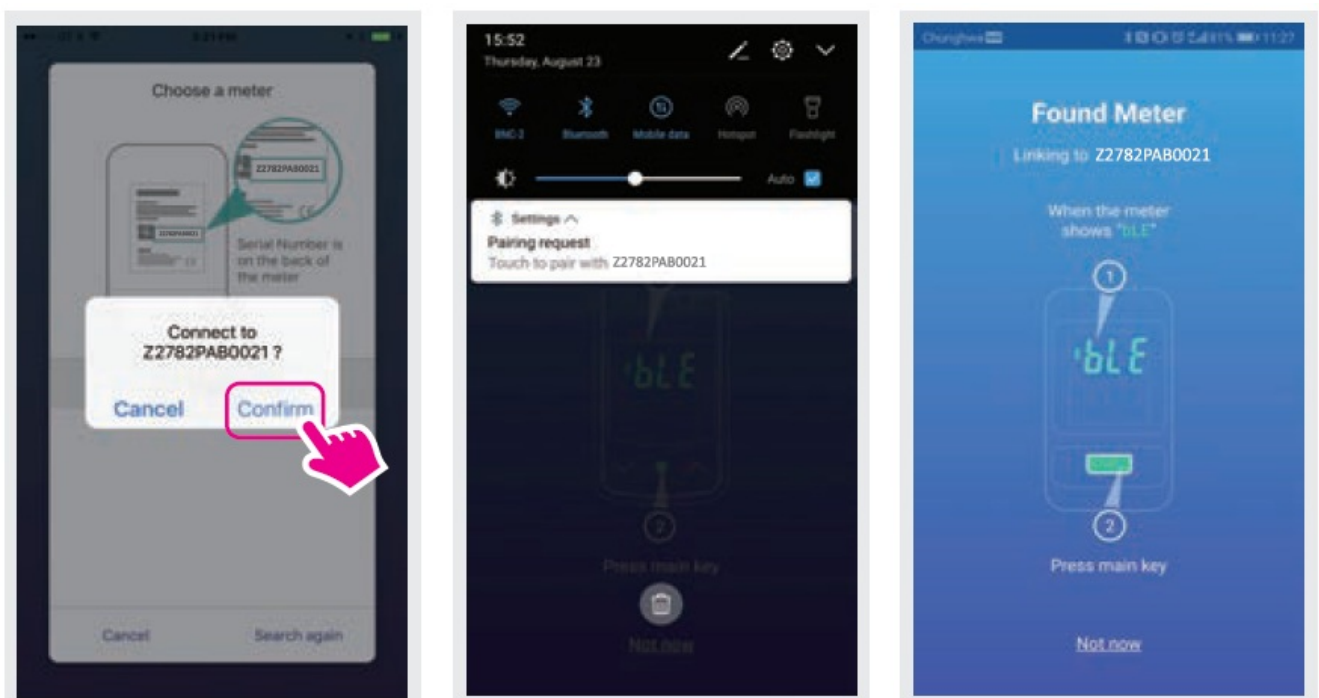

4. Confirm meter serial number.

5. **Android:** Pulldown Status bar of mobile, accept Bluetooth pairing request.

- **iOS:** Accept a Bluetooth pairing request.

6. Confirm Bluetooth pairing requirements.

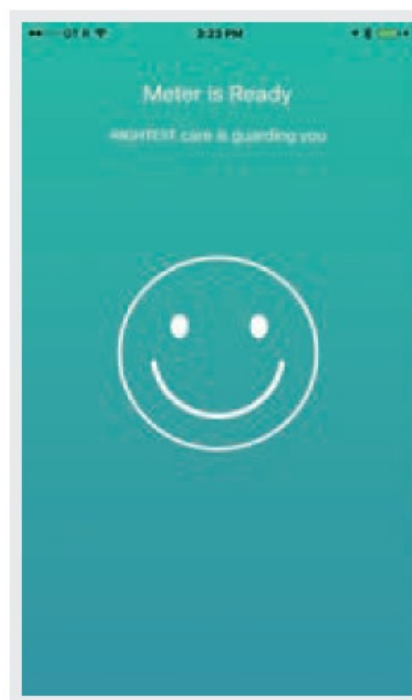
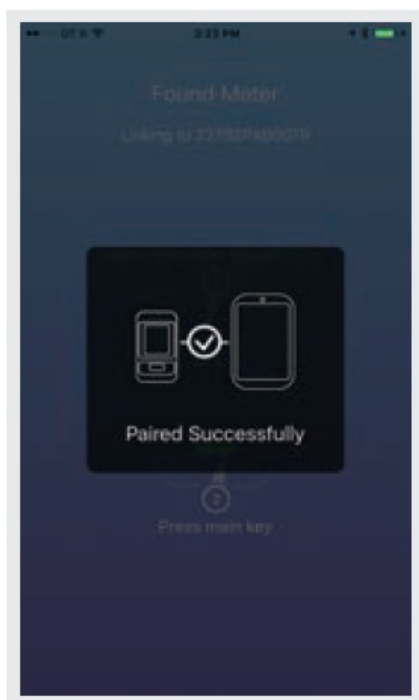

7. Paired successfully.

8. Data sync.

9. The process is now completed.

Setting up lifestyle

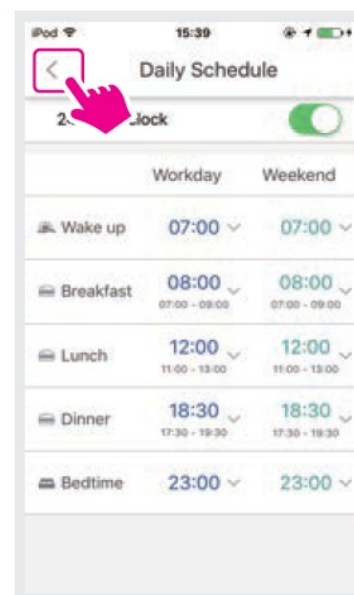
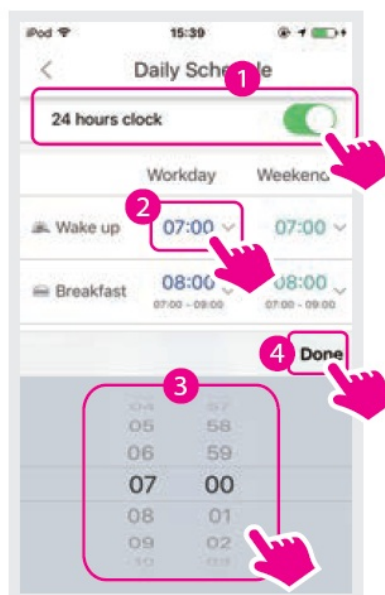
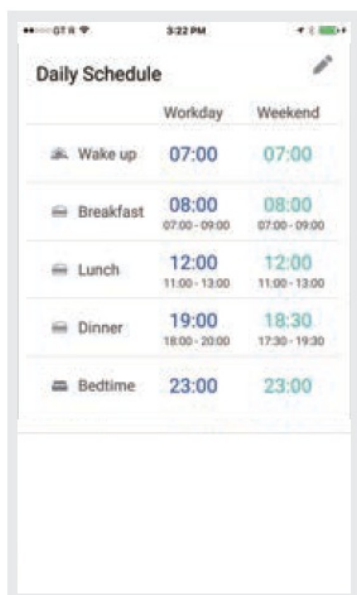

1. Set up "life schedule".

2. Set Daily lifestyle periods.

3. App will categorize before/after meal blood glucose data upon your setting. After setting, return to my profile.

Measurement schedule

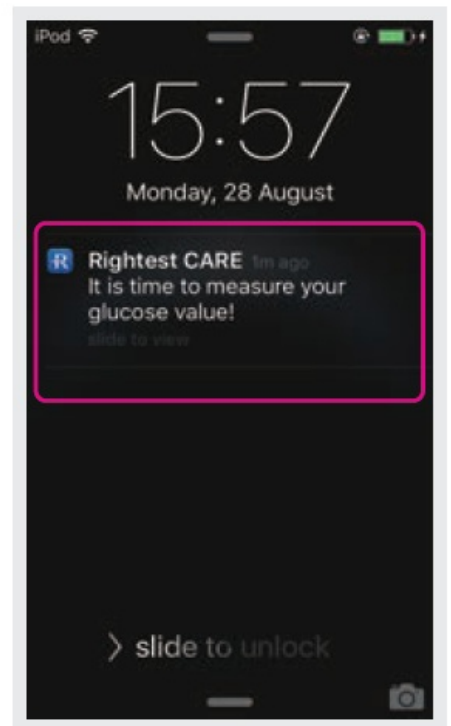
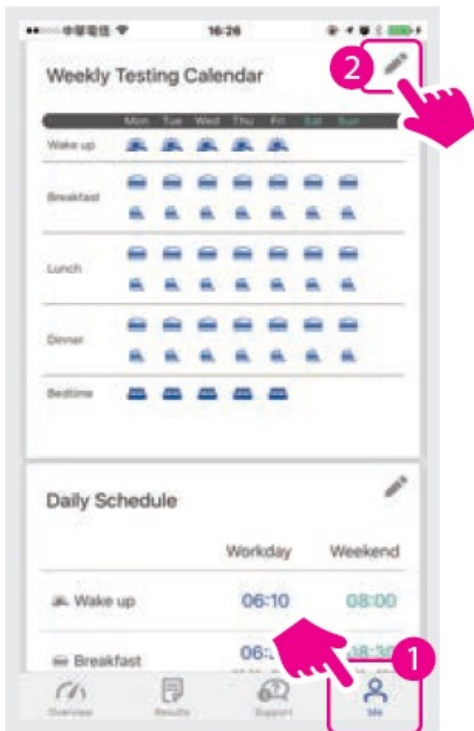

1. Select "Me", select "Testing Calendar", Confirm Testing Calendar.
2. Once finished setting, user will receive notifications when time to perform blood glucose test.

Note

- The picture will be slightly different according to the mobile phone brand.

Register Product Serial Number And Scan Store QR Code

Register product serial number and scan store QR code (To be decided by local market)

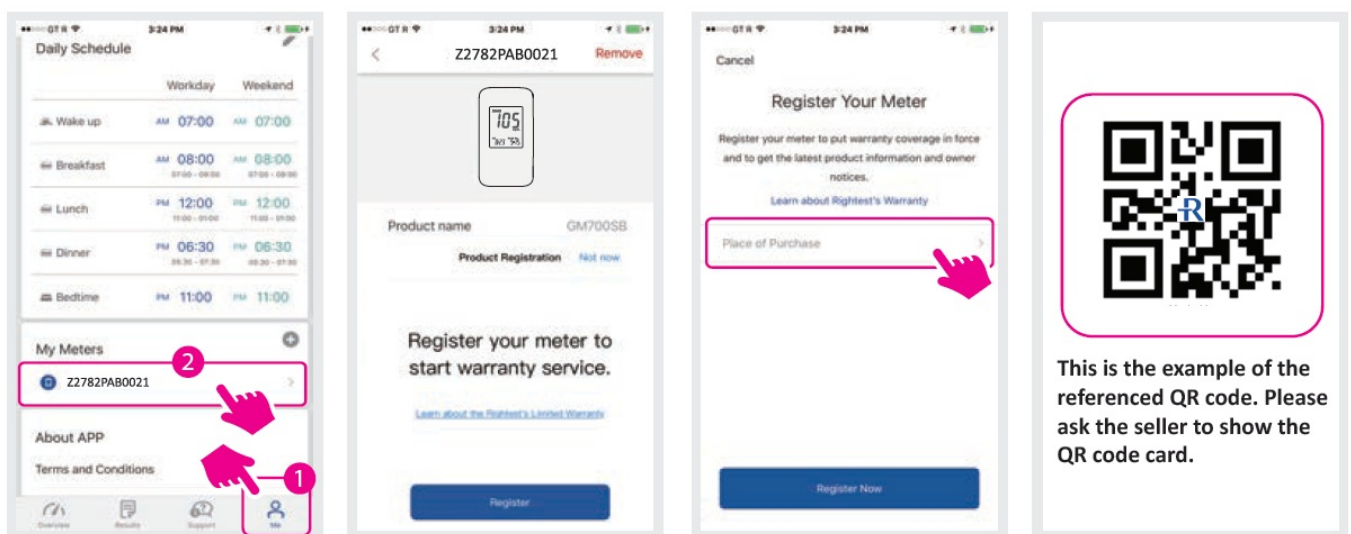

1. Click "My Meters" in Me.
2. Register the product warranty
3. Select "Place of Purchase" for warranty registration.
4. Scan store QR code.

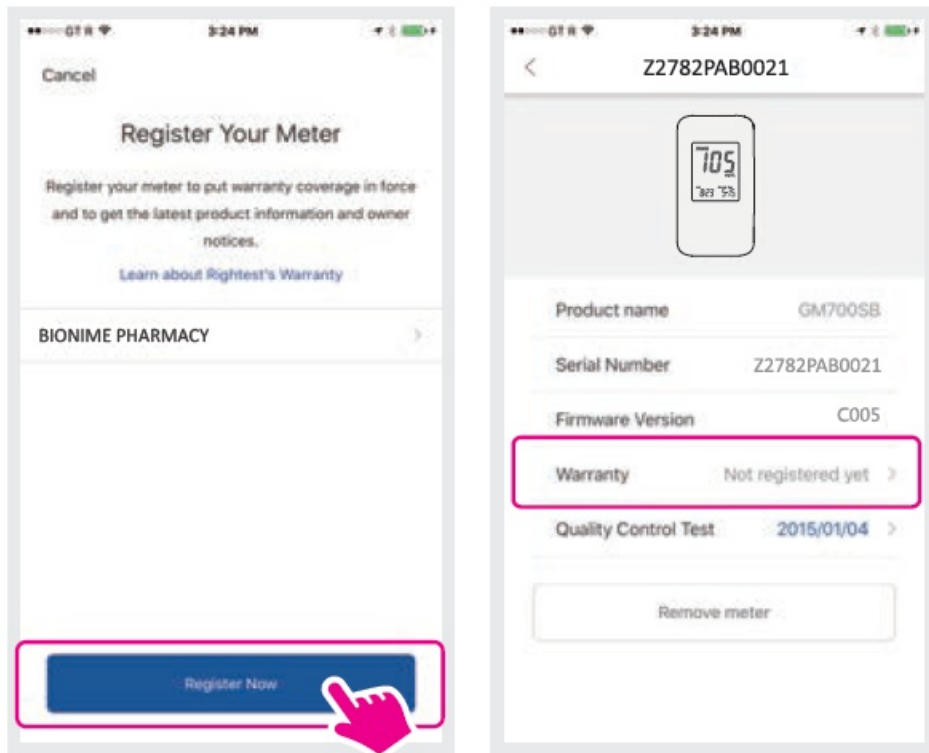

5. Confirm store of purchase and select “Register Now”.
6. Date of product warranty appears after register completion.

Note:

- You can also register warranty with warranty card.

BG Target Range

We provide BG target range for your BG management as reference

Select  “ME” to set up your BG target range and measurement schedule. We provide by default, the BG target range suggested by the American Diabetes Association to assist with your BG management. You may adjust other BG goal range, please discuss with your physician for the suitable BG goal range.

BG goal range

BG represents “Blood Glucose”.



1. Select "Me", select "blood glucose goal range".
2. Please select your diabetes type, blood glucose ranges will be suggested.
3. After setting BG target, return to my profile page.

An intuitive comprehensive visualized dashboard

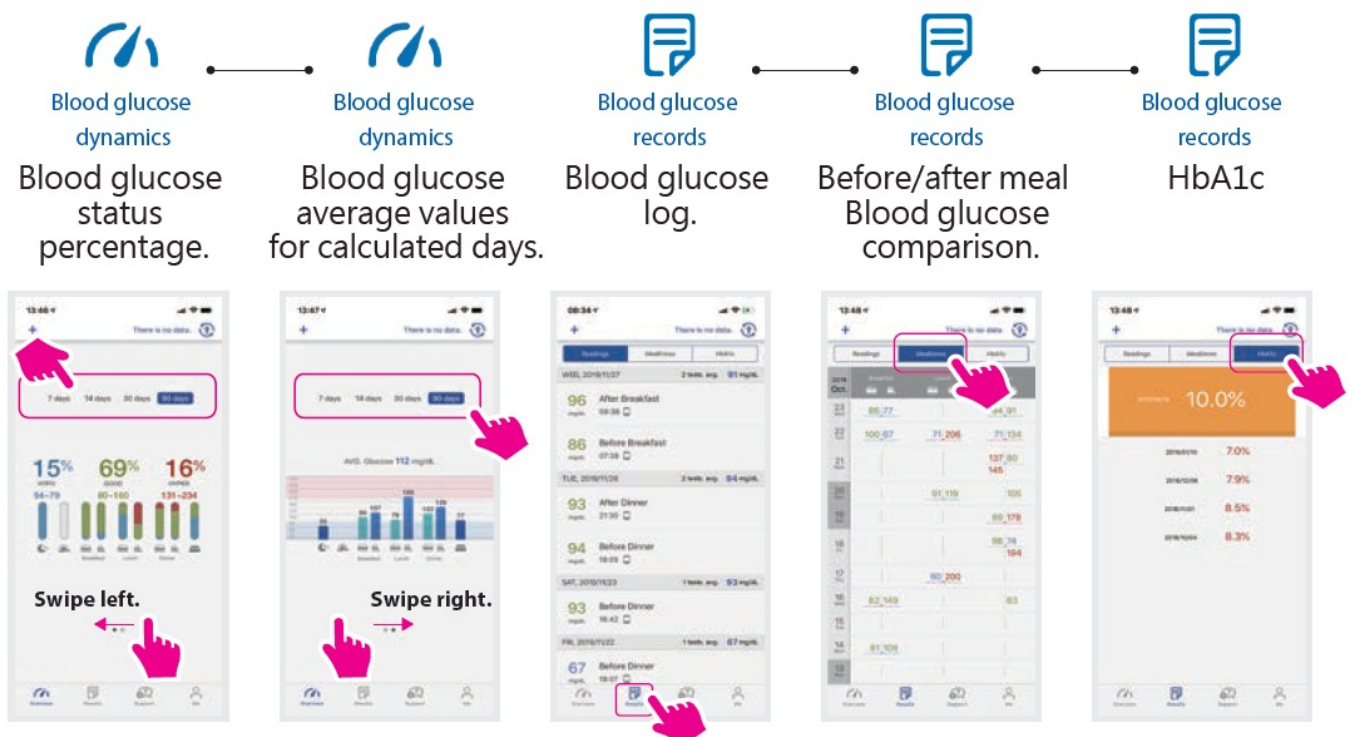

HbA1c (measurement) result could ONLY be retrieved from your health care provider. More info →
please contact your local distributor.

How to find more information

Step 1)

- Open RIGHTEST CARE App in mobile device.

Step 2)

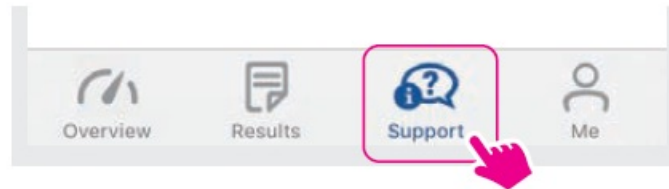

- Select “Support”

Step 3)

- Select topic of interest to receive more information.

For more information on how to use your Rightest CARE App and understanding your test results, please see your Rightest CARE App User Guide.

Contact

- No. 100, Sec. 2, Daqing St., South Dist., Taichung City 40242, Taiwan
- **Tel:** +886 4 2369 2388
- **Fax:** +886 4 2261 7586
- **Email:** info@bionime.com
- <http://www.bionime.com>

Documents / Resources

	<p>RIGHTEST CARE Rightest Wiz Plus [pdf] User Guide CARE Rightest Wiz Plus, CARE, Rightest Wiz Plus, Wiz Plus, Plus</p>
---	---

References

-  [Rightest Blood Glucose Monitoring - Bionime Global](#)
- [User Manual](#)

[Manuals+](#), [Privacy Policy](#)

This website is an independent publication and is neither affiliated with nor endorsed by any of the trademark owners. The "Bluetooth®" word mark and logos are registered trademarks owned by Bluetooth SIG, Inc. The "Wi-Fi®" word mark and logos are registered trademarks owned by the Wi-Fi Alliance. Any use of these marks on this website does not imply any affiliation with or endorsement.