



Riddost B0C4FLVX8X Digital Keypad Fireproof Safe Box User Manual

[Home](#) » [Riddost](#) » Riddost B0C4FLVX8X Digital Keypad Fireproof Safe Box User Manual 

Riddost B0C4FLVX8X Digital Keypad Fireproof Safe Box



Contents

- [1 Electrical Specifications](#)
- [2 Warm Reminder](#)
- [3 Basic Series](#)
- [4 Safe Box Accessories](#)
- [5 Operating Instructions](#)
- [6 Please Note](#)
- [7 FAQ](#)
- [8 Documents / Resources](#)
 - [8.1 References](#)

Electrical Specifications

Working Power: Four AAA Alkaline Batteries

Operating Voltage Range: 4.0V~6.8V

Under Voltage Point: 4.5V+0.20V

Working Current: $\leq 350\text{mA}$

Standby Current: $< 35\mu\text{A}$ (at 6.0V)

Working Environment: -10°C to 60°C

Thank you once again for choosing our products. We are dedicated to the development and production of security products, aiming to offer our customers high-quality products that enhance their quality of life. If you have any suggestions for improving our products, we would be delighted to hear from you. Your feedback is valuable to us in our continuous efforts to provide the best products and services.

E-mail: grwlrss@126.com

Store: Riddost

Warm Reminder

Thank you for choosing our product.

Before use, please read the instructions carefully. A link to the operation video is provided for your convenience.

If you have any questions during reading or operation, feel free to contact us. We will promptly assist and resolve any concerns you may have.



Basic Series



0.8 Cubic

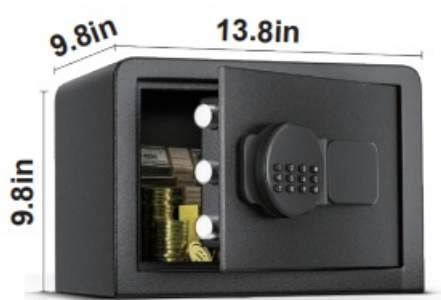

1.0 Cubic

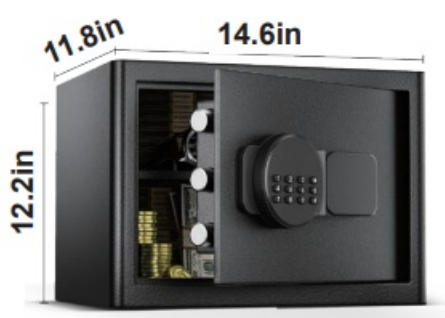

1.2 Cubic



2.0 Cubic



2.2 Cubic

Safe Box Accessories

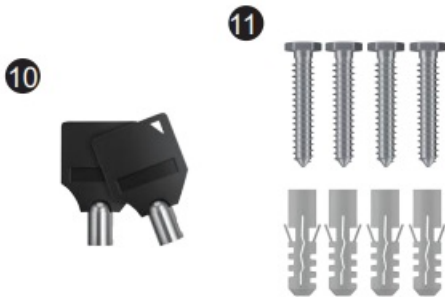
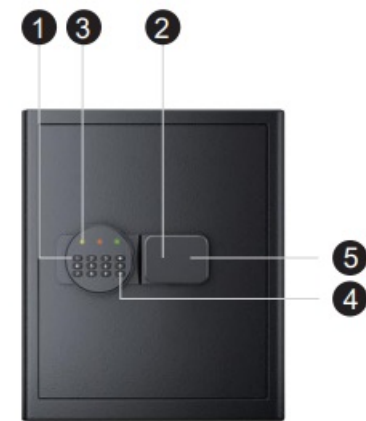

1. Knob
2. Hidden Key Cover
3. Hidden Indicator Light
4. Confirmation Button
5. Battery Compartment
6. Bolts
7. Reset Button
8. Interior Light
9. Removable Shelf (0.8 cubic feet not included)
10. Backup Keys (2)

- 11. Expansion Screws
- 12. Owner's Manual
- 13. Fireproof Bag
- 14. Flannelette Pad
- 15. Screw Gasket

Operating Instructions

Use Only the Key to Open the Lock

1. Slide to the right to open the battery case cover.



2. Insert the key into the lock hole and turn it to the left.



3. Turn the handle to the right to open the door.



Use Only the Password to Unlock

1. Slide to the right to open the battery case cover.



2. Install four 3A batteries.



3. Press the # key, and the hidden light will show yellow on the far left, accompanied by a “drip” sound, indicating that the password lock begins to work normally.



4. Enter the original code, 1-5-9, and press “#” to confirm.
The hidden light will show red and green indicating that the safe door is open.



Set A New Password

1. Click the reset button, and the hidden light will show yellow.



2. Enter a 3-digit code from 1 to 8 you want.



3. Press “#” to confirm, and there will be two “drip” sounds, indicating that it has been successfully set and saved. The hidden light will show yellow.



4. Check your new password, enter it, and press the # key to confirm. The hidden indicator will show red and green, indicating a successful setting.



Please Note

1. When the password is entered incorrectly
 - If you enter an incorrect password once, the indicator will blink yellow several times and then turn off.



You can enter the * key, clear the number, and then re-enter the password.



- If the password is incorrectly entered 3 consecutive times, the yellow indicator will blink continuously with an alarm sound.



You can click the reset button, and the hidden light will show yellow.



2. When the lock is opened by external force

The yellow indicator blinks continuously with an alarm sound.

- Forced blunt object attack.



- Electric drill breach attempt.



- Crowbar prying



3. When the battery is low

The hidden light will blink red and green.



4. When the key is not operated for more than 20 seconds

The lock system will go to sleep mode, and the input will be cleared.

Extinguish



5. When you lose your keys

Please find the serial number above the lock hole and provide it to us, and we will deliver one to you for free.

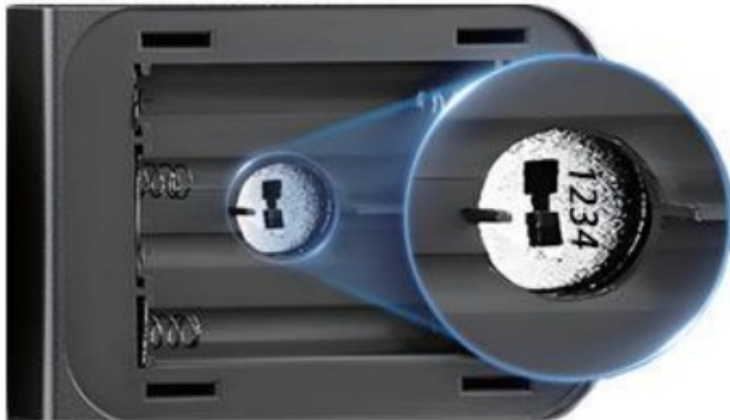

FAQ

What should I do if I forget the code or the battery is depleted?

A: You can use the emergency key to open the door, or either change the battery or reset the code.

Can I get a replacement if I lose the emergency key?

A: Yes, you can get a replacement by verifying your identity and providing the serial number on the safe's lock hole.

How to stop the alarm beep after entering the wrong password three times in a row?

A: To stop the beeping, either enter the correct password or remove the battery

Under what circumstances is the safe system prone to failure?

After using the safe for some time, I enter the correct password, the green light is on, but I can't open the safe. What could be the issue?

A: The battery might be low and needs replacement.

Can the safe be mounted on the wall?

A: Yes, our safes come with pre-drilled holes on the back and include appropriate accessories for wall mounting

—

Documents / Resources

	Riddost B0C4FLVX8X Digital Keypad Fireproof Safe Box [pdf] User Manual B0C4FLVX8X Digital Keypad Fireproof Safe Box, B0C4FLVX8X, Digital Keypad Fireproof Safe Box, Keypad Fireproof Safe Box, Fireproof Safe Box, Safe Box, Box
--	---

References

- [User Manual](#)