



ricoo F0211 Thin Client Bracket Instruction Manual

[Home](#) » [ricoo](#) » ricoo F0211 Thin Client Bracket Instruction Manual 



Assembly Instructions



MAX
3kg
6.6lbs



! **Warning:** Do not exceed listed load weight. Property damage oder serious injury may occur!

Contents

1 Scope of delivery

2 Documents / Resources

2.1 References



Scope of delivery

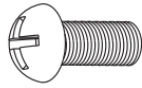

M-A x4
M4x12

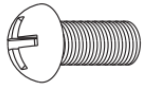

M-B x4
M5x12

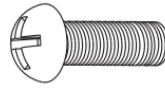

M-C x4
M4x20

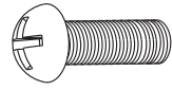

M-D x4
M5x20



M-E x4
D5



M-F x8

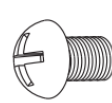

M-G x4
M4x5



• The numbering on the plastic bag may differ / missing completely!

Dear customer,

we are pleased that you have decided for a product of the brand “RICOO”.

Sometimes, despite our efforts to provide you with a high-quality product, it may happen that an accessory is missing or a part is damaged during transport. Please do not return the item in such a case, simply request replacement for the missing or damaged part at our customer hotline. Contact details from our customer hotline are listed below.

When contacting us, please mention the article data (listed on top), article color as well as the required spare part numbers (including the required quantity of items), as indicated in the “Scope of delivery” section of this manual. Please keep ready your order number / order ID for our customer hotline. We will process your request immediately!

NOTE: Read the entire instruction manual before you start installation and assembly

- Please note: Images in these assembly instructions are only technical presentation of the product. Actual product design may vary minimally.
- Do not begin the installation until you have read and understood all the instructions and warnings contained in this installation sheet. If you have any questions regarding any of the instructions or warnings, please contact your local distributor.
- This product was designed to be installed and used **ONLY** as specified in this manual. Improper installation of this product may cause damage or serious injury.
- This product may only be assembled / installed by the technical staff.
- Make sure that the supporting surface will safely support the combined weight of the equipment and all attached hardware and components.

- When mounting on the wooden beams wall, make sure that the fastening screws are anchored in the center of the beams. It is highly recommended to use a beamfinder.
- Always use an assistant or mechanical lifting equipment to safely lift and position the equipment.
- Tighten screws firmly, but do not over tighten. Over tightening can cause damage the items, this greatly reduces their holding power.
- This product is intended for indoor use only. Using this product outdoors could lead to product failure and personal injury.



By reason of large television construction types on the market, we can't adjust our screen installation materials for each screen type. Therefore it is possible that the screws which are numerously delivered don't fit with your TV/Monitor. We ask for your understanding that we can't cover up all possibilities of many screen types.



Each wall is built up of different materials which can result a special requirement. Therefore we are concentrated on the delivery of installation materials only for mass concrete walls. Use our included installation accessories only for mass concrete walls.

- If your walls have a special demand of materials, we advise you to ask in an expert shop for a suitable acquirement of the installation materials.
- Make sure that before and after the installation of the product neither you nor somebody else can be injured and other objects can be damaged. In case of doubt request for help from an expert.
- Make also sure that you and optionally the co-helper or representatives have registered the mounting instructions before the installation and also the warning notice.

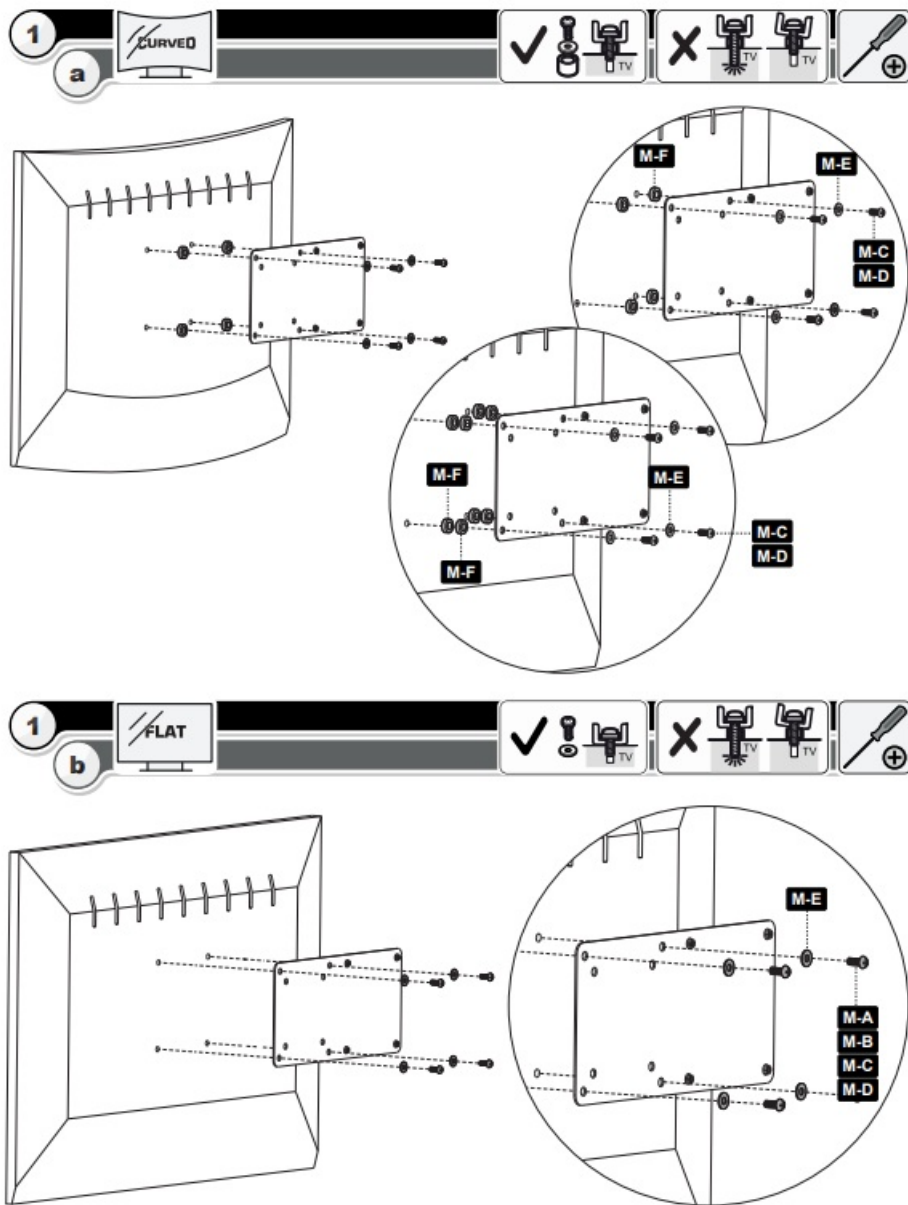

If the screws "M-C, M-D" are too long, use the plastic spacers "M-F". (like in Step 1 A)

2

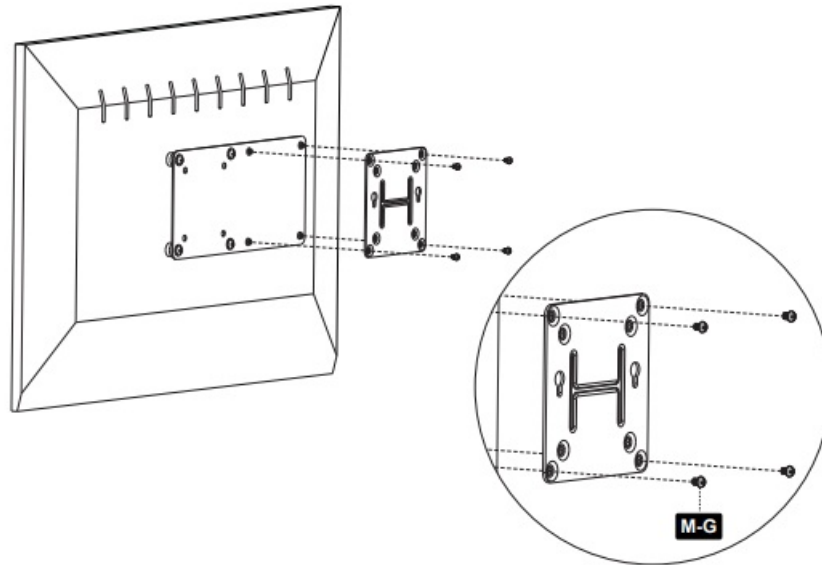

3

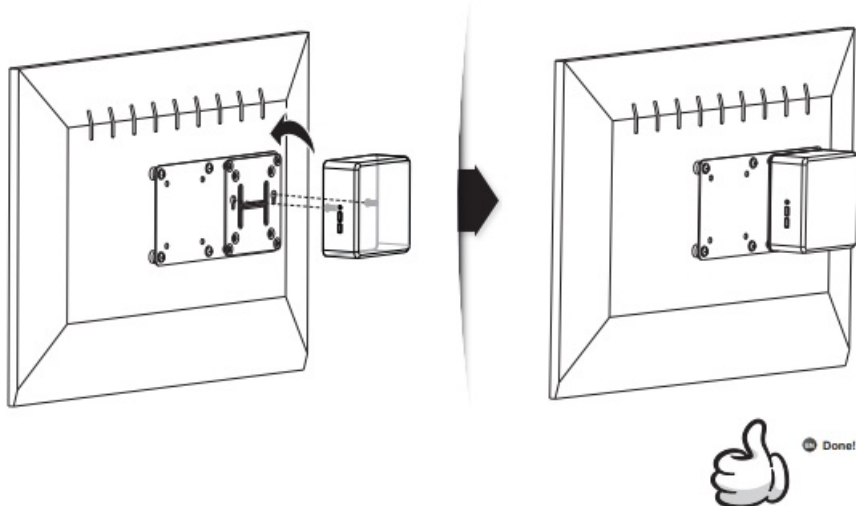

F0211

ENZ
ENGINEERING GMBH

E-Mail: support@ricoo.de
www.ricoo.eu

E.N.Z. Engineering GmbH
Salzmatten 6
79341 Kenzingen
(Germany)

Documents / Resources

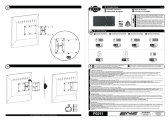

[ricoo F0211 Thin Client Bracket](#) [pdf] Instruction Manual

F0211 Thin Client Bracket, F0211, Thin Client Bracket, Client Bracket, Bracket

References

- [🌐 RICOO-Shop](#)
- [📺 Multimediaprodukte und Werbetechnik günstig kaufen! | RICOO](#)

Manuals+,