



RGBlink TAO 1mini-HN USB HDMI Streaming Node User Guide

[Home](#) » [RGBlink](#) » RGBlink TAO 1mini-HN USB HDMI Streaming Node User Guide 

Contents

- [1 RGBlink TAO 1mini-HN USB HDMI Streaming Node](#)
- [2 Product Information](#)
- [3 About Your Product](#)
- [4 Product Usage Instructions](#)
- [5 Features](#)
- [6 Overview](#)
- [7 About Your Product](#)
- [8 Use Your Product](#)
- [9 Contact Information](#)
- [10 ABOUT COMPANY](#)
- [11 Documents / Resources](#)
 - [11.1 References](#)
- [12 Related Posts](#)



RGBlink TAO 1mini-HN USB HDMI Streaming Node



Product Information

Overview

The TAO 1mini-HN is a lightweight and compact device designed for easy portability. It serves as an NDI node for both encoding and decoding, supporting multiple formats including RTMP, RTMPS, RTSP, SRT, FULL NDI, and NDI.

About Your Product

Appearance

The TAO 1mini-HN has a small and sleek appearance, making it convenient to carry around.

Connectors

The device is equipped with various connectors for different purposes.

- **Input Area:** Used for input signals
- **Output Area:** Used for output signals

Dimension

The exact dimensions of the TAO 1mini-HN are specified in the user manual. Please refer to page 5 for detailed dimension information.

Product Usage Instructions

• Turn on Your TAO 1mini-HN

To turn on the device, locate the power button and press it. Wait for the device to power up completely before proceeding.

• Input Area

The input area is where you can connect your input signals to the TAO 1mini-HN. Refer to page 7 in the user manual for detailed instructions on how to connect your desired input signal.

• Input Signal Selection

After connecting your input signals, you can use the TAO 1mini-HN to select the desired input signal. Please refer to page 7 of the user manual for instructions on how to select your input signal.

- **NDI Decoding**

The TAO 1mini-HN supports NDI decoding. You can decode NDI streams using this device. For detailed instructions, please see page 8 of the user manual.

- **RTMP Pull**

The TAO 1mini-HN allows you to pull RTMP streams. Refer to page 8 in the user manual for instructions on how to use this feature.

- **Play Video in U Disk**

If you have videos stored on a USB flash drive, you can play them using the TAO 1mini-HN. Please refer to page 9 of the user manual for instructions on how to play videos from a USB flash drive.

- **Output Area**

The output area of the TAO 1mini-HN is where you can connect devices to receive the output signals. For more information, please see page 10 of the user manual.

- **RTMP Push**

You can push RTMP streams using the TAO 1mini-HN. Instructions on how to utilize this feature can be found on page 10 of the user manual.

- **NDI Encoding**

The TAO 1mini-HN supports NDI encoding. You can encode your own video streams using this device. For detailed instructions, please see page 11 of the user manual.

- **Settings**

The TAO 1mini-HN has various settings that can be adjusted to suit your needs. Refer to page 12 of the user manual for instructions on how to access and modify these settings.

- **Go to Homepage**

If you wish to return to the homepage of the TAO 1mini-HN, please follow the instructions provided on page 12 of the user manual.

- **Input Settings**

The TAO 1mini-HN allows you to customize input settings according to your preferences. Please refer to page 12 of the user manual for instructions on how to adjust these settings.

Features

- Light in weight and small in appearance, easy to carry
- NDI node for encode and decode
- Support multiple formats,including RTMP/RTMPS/RTSP/SRT/FULL NDI/NDI | HX3/NDI | HX2/ NDI | HX
- Stream to at least 4 platforms at the same time
- Resolution up to 2K@60
- Low latency
- Intuitive touch control and dynamic display
- Power from USB-C or PoE network
- Dual 1/4in mounts

Overview

- TAO 1mini-HN supports HDMI &UVC and FULL NDI® gigabit Ethernet video stream codecs for encoding and decoding.

- TAO 1mini-HN features light in weight and small in appearance, which makes it easy to carry. Standard camera screw holes can be easily installed to the camera bracket. The device has a 2.1-inch TFT touch screen for real-time monitoring of signals and menu operations. Support U disk recording, support PoE and other functions.

System Connection

RGBlink offers solutions to demanding technical problem. Any application questions, or required further information, please contact with our customer Support Engineers.



TAO 1mini-HN SYSTEM CONNECTION DIAGRAM

About Your Product

Appearance



No.	Item	Description
1	Touch Screen	2.1-inch TFT touch screen for real-time monitoring of signals and menu operations.
2	1/4in mounts	For installation.

Connectors



No.	Connectors	Description
1	USB-C	Connect to the power supply, support PD protocol.
2	HDMI-OUT	Connect to external monitor for real-time monitoring of inputs and outputs.
3	USB-C	For receiving video signal from your phone or others. Connect to USB camera for UVC capture. Support 5V/1A reverse power supply.
4	HDMI-IN	For receiving video signal.
5	3.5mm Audio Socket	For analog audio input and audio output monitoring.
6	USB 3.0	Connect to harddisk for recording, and storage up to 2T.
7	LAN	Gigabit network port, support PoE.

Dimension

Following the dimension of TAO 1mini-HN for your reference: 91mm(diameter)×40.8mm(height)

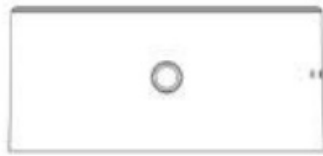

Bottom View



Right View



Front View



Rear View

Use Your Product

Turn on Your TAO 1mini-HN

- Connect your TAO 1mini-HN with the packaged USB-C power link cable and standard power adapter. Besides, TAO 1mini-HN also support power over Ethernet.



- After TAO 1mini-HN is powered on, 2.1 inch screen will show TAO 1mini logo and then come into the main menu.



Notice:

1. Users can choose functions through slight touch and set parameters through long-pressing.
2. In Settings, users can choose different functions through clicking Arrow Icon.

Input Area



Users can operate five functions in Input Area, including HDMI Input Signal Selection, UVC Input Signal Selection, USB Player, RTMP Pull and NDI Decoding.

Input Signal Selection

- Click yellow arrows to choose HDMI or UVC as input signal.



- Long press the UVC icon to adjust Brightness and Mirror.



- **Brightness:** 0-14
- **Mirror:** ON/OFF

Notice: The above settings are designed for UVC input signal ONLY.

NDI Decoding

- Click yellow arrows to select NDI Decoding icon. Long press the icon to enter the following interface.



- Select NDI source by swiping the screen. Users can see NDI channel name, NDI source you selected, IP address, bitrate and more.

RTMP Pull

- Click yellow arrows to select RTMP Pull icon. Long press the icon to enter the following interface.

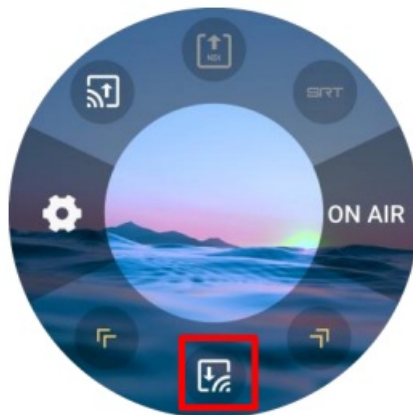

- Click the icon for installation. Turn on Bluetooth to pair TAO 1mini-HN with your mobile phone, (For more details, please refer to Bluetooth), so that you can import RTMP stream-address via TAO APP.

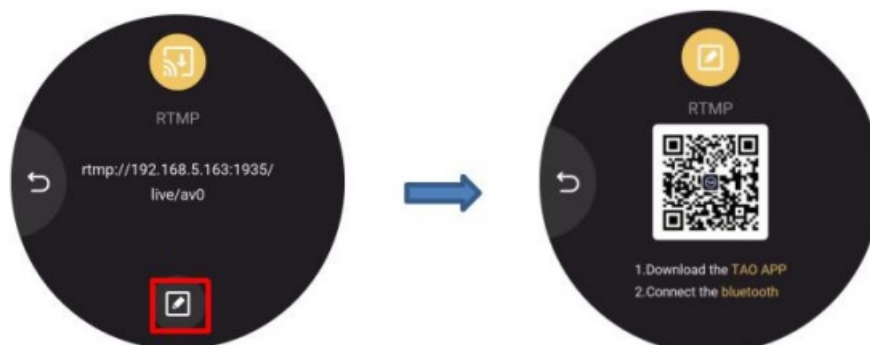

Play Video in U Disk

- Insert U disk to USB 3.0 port of TAO 1mini-HN to play the video stored.



- Users can choose different videos by wiping the screen and click  icon on the left to switch video-playing mode.

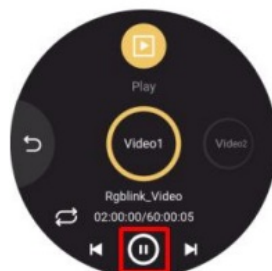

Click to pause.

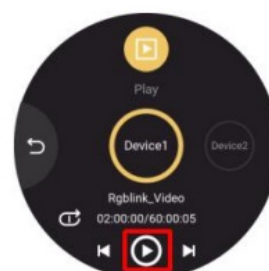

Click to play.

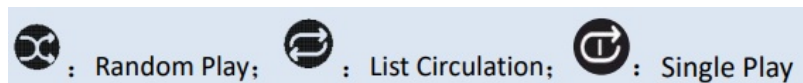

Output Area

Users can operate two functions in Output Area, including RTMP Push and NDI Encoding.



RTMP Push

- Long press the RTMP Push icon in output area to check the RTMP stream address of TAO 1mini-HN.



- TAO 1mini-HN supports RTMP stream address modification. Users can download TAO APP to import new stream address.



- Users can operate RTMP Push via USB disk or TAO APP. For more specific steps, please refer to 3.2.1 RTMP Push in User Manual.
- After importing stream address, users can choose the streaming platform, check RTMP stream address by long-pressing and click cross icon for address deletion. The green circle outside indicates the platform you chose.



- Users can also set resolution, bitrate and display mode by clicking .
- After all parameters are set, click [ON AIR] in the main interface to turn on RTMP Push function.

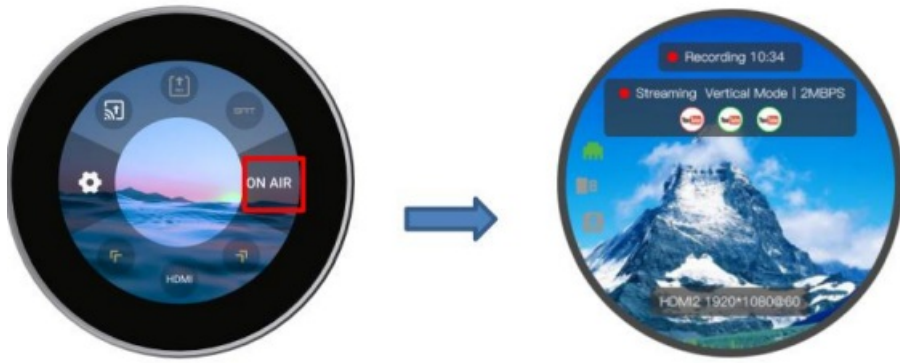

NDI Encoding

Click NDI Encoding icon in output area to turn on NDI Encoding function and long press the icon to choose encoding format (NDI | HX by default), set resolution, bitrate and check channel name.

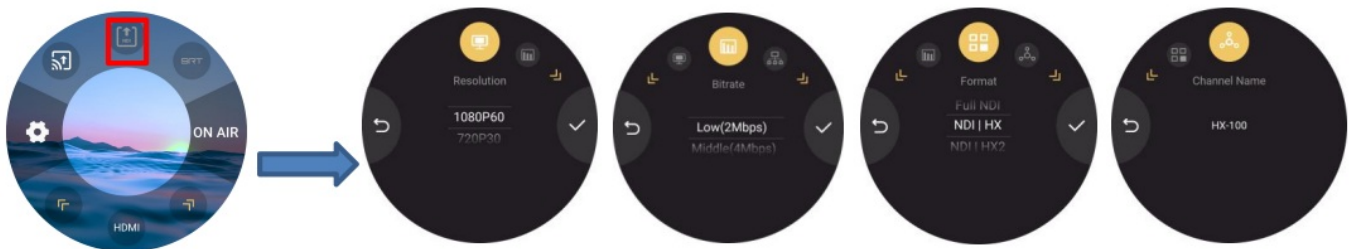

Settings

Click Settings on the left to operate more functions, including Go to Homepage, Input Settings, Output Settings, Network, Bluetooth, Fan Speed, Display and Device Info.



Go to Homepage

Click  to return to the main interface of TAO 1mini-HN.



Input Settings

- Click  to enter to operate five functions, including RTMP Pull, NDI Decoding, UVC Input Settings, Video Playing and Audio Settings.

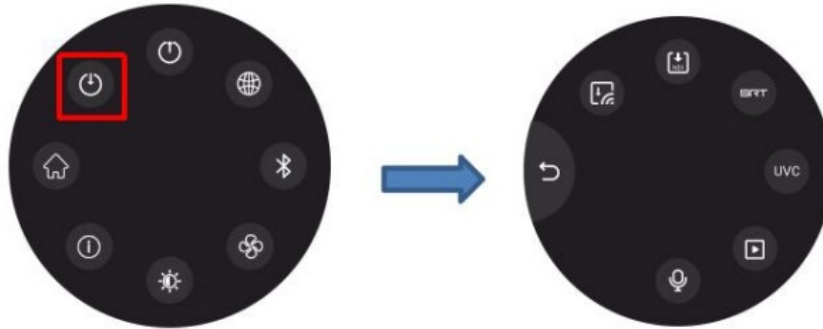

- In Input Settings part, users can turn on/off audio by swiping the screen, shown as below.



Output Settings

- Click  to enter to operate six functions, including RTMP Push, NDI Encoding, USB Recording, HDMI Output Settings, UVC Output Settings and Audio Settings.
- RTMP Push and NDI Encoding have been introduced in Output Area already. Therefore, please refer to the previous chapter.
- For USB Recording, TAO 1mini-HN can be used as a recorder. Users can set resolution, bitrate and check disk info.

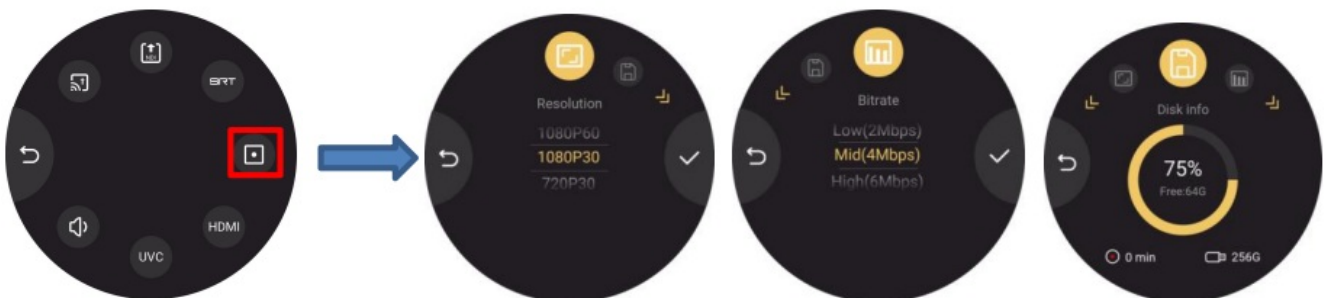

- For HDMI Output Settings, users can set HDMI output resolution by swiping the screen.



- For UVC Output Settings, users can set UVC output resolution, turn on/off mirror mode and adjust display mode.



- For Audio Setting, users can set output volume at free or choose 0 to turn on mute mode.



Network

Click network icon to turn on DHCP for automatic capture of IP address, netmask and gateway set or set IP address, netmask and gateway manually.

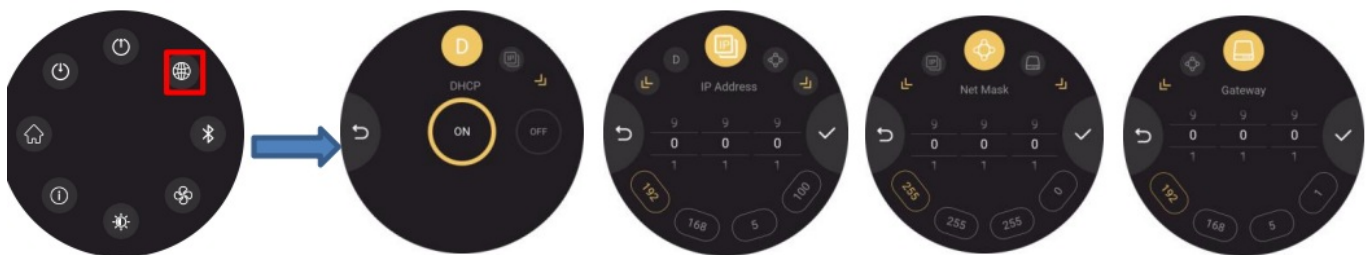

Bluetooth

Click Bluetooth icon to turn on Bluetooth for pairing TAO 1mini-HN with TAO APP installed in your mobile phone, so that users can import new stream address.

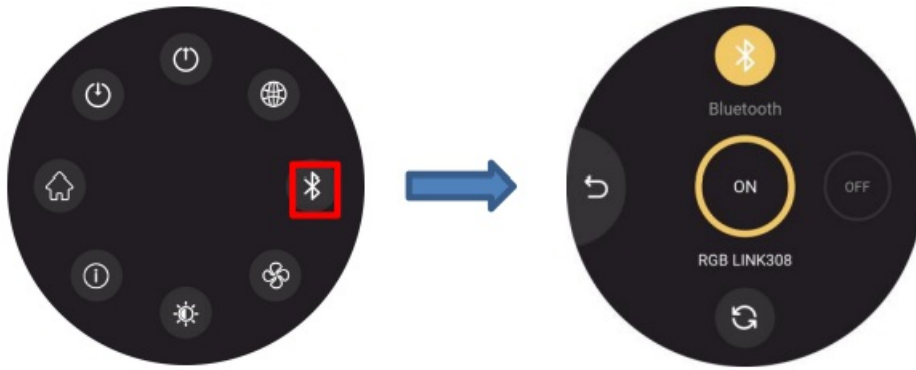

Notice:

1. Make sure the distance between TAO 1mini-HN and mobile phone is within 2m.
2. Pair TAO 1mini-HN with TAO APP within 300s.

Fan Control

Click Fan icon to adjust fan speed for heat dissipation.



Display

Click Display icon to adjust brightness and display mode.



About TAO 1mini-HN

Click Information icon to check device information, set language, upgrade TAO 1mini-HN and choose factory reset.

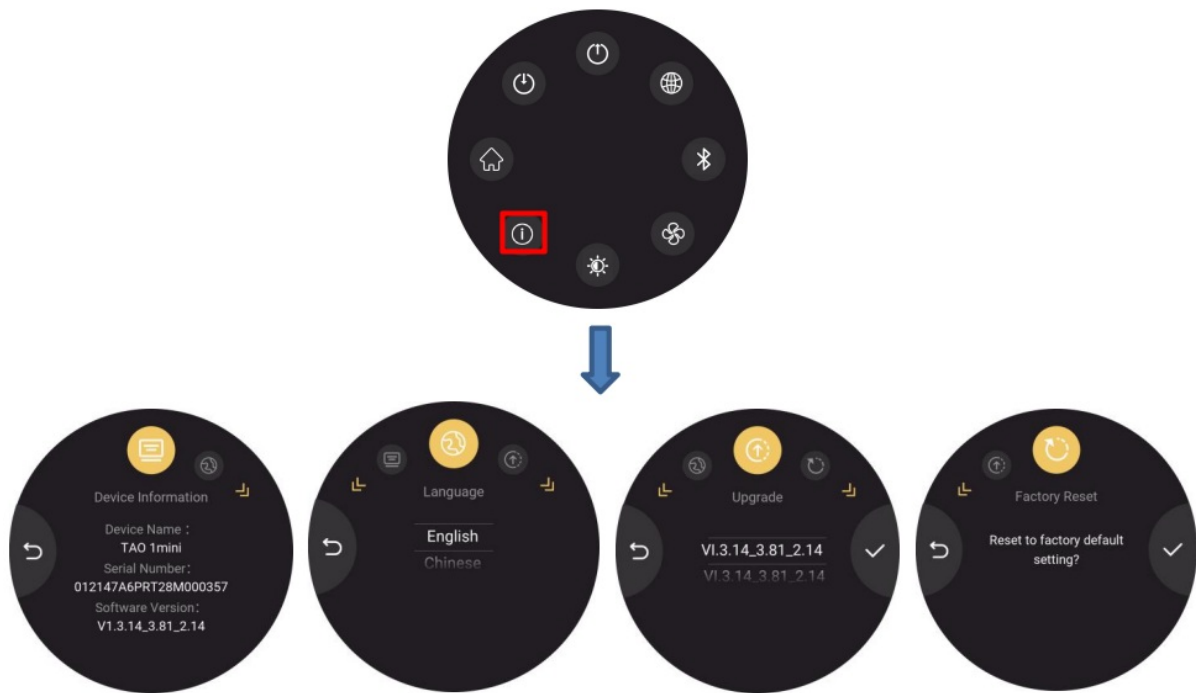

Notice:

1. Keep TAO 1mini-HN plugged in during upgrading.
2. Make sure file for upgrade is valid on the USB disk.

ON AIR

If operations for RTMP Push are successful, then click ON AIR in the main interface and TAO 1mini-HN will start streaming. When TAO 1mini-HN recognizes the USB flash drive, it will start recording.

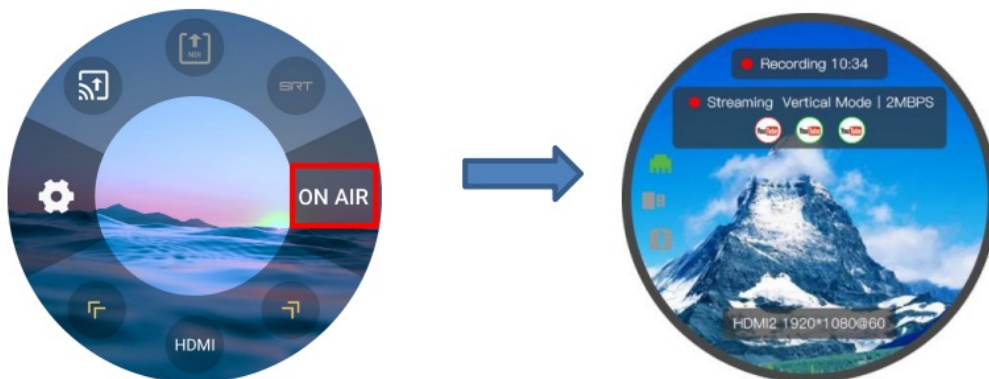

User can do the following operations:

1. Hide the setting options by clicking the blank screen. And the interface will display information about streaming.
2. On the basis of operation 1, click the screen again to hide all the information but to display the streaming image only.
3. On the basis of operation 2, click the screen again to restore the setting interface.

Status Display Area

The left area of interface displays the status of the TAO 1mini-HN.



	no network input		no USB		Bluetooth not connected
	with network input		USB inserted		Bluetooth connected

Contact Information

Warranty:

- All products are designed and tested to the highest quality standard and backed by 1 year parts and labor warranty. Warranties are effective upon delivery date to customer and are non-transferable. RGBlink warranties are only valid to the original purchase/owner. Warranty related repairs include parts and labor, but do not include faults resulting from user negligence, special modification, lighting strikes, abuse(drop/crush), and/or other unusual damages.
- The customer shall pay shipping charges when unit is returned for repair.
- **Headquarter:** Room 601A, No. 37-3 Banshang community, Building 3, Xinke Plaza, Torch Hi-Tech Industrial Development Zone, Xiamen, China
- **Tel:** +86-592-5771197
- **Fax:** +86-592-5788216
- **Customer Hotline:** 4008-592-315
- **Web:**
 - <http://www.rgblink.com>
 - <http://www.rgblink.cn>
- **E-mail:** support@rgblink.com

ABOUT COMPANY

- © Xiamen RGBlink Science & Technology Co., Ltd.
- Ph: +86 592 5771197
- support@rgblink.com
- www.rgblink.com

	<p>RGBlink TAO 1mini-HN USB HDMI Streaming Node [pdf] User Guide</p> <p>TAO 1mini-HN USB HDMI Streaming Node, TAO 1mini-HN, USB HDMI Streaming Node, Streaming Node, Node</p>
---	---

References

- [RGBlink](#)
- [RGBlink](#)
- [RGBlink](#)