



REXING V3 Dual Camera Front and Inside Cabin User Guide

[Home](#) » [Rexing](#) » REXING V3 Dual Camera Front and Inside Cabin User Guide 

REXING V3 Dual Camera Front and Inside Cabin User Guide

Contents

- [1 Overview](#)
- [2 What's in the Box](#)
- [3 Camera Overview](#)
- [4 Installation](#)
- [5 Basic Operation](#)
- [6 Documents / Resources](#)
 - [6.1 References](#)
- [7 Related Posts](#)

Overview

Thank you for choosing REXING! We hope you love your new product as much as we do. If you need assistance or have any suggestions to improve it, please contact us. You can reach us via care@rexingusa.com or call us at (203) 800-4466. Our support team will respond to you as soon as possible.

Always a surprise in Rexing. Check us out here.

<https://www.facebook.com/rexingusa/>

<https://www.instagram.com/rexingdashcam/>

<https://www.rexingusa.com/support/registration/>

Facebook



Instagram



Site



<https://www.facebook.com/rexingusa/>

<https://www.instagram.com/rexingdashcam/>

<https://www.rexingusa.com/support/registration/>

What's in the Box

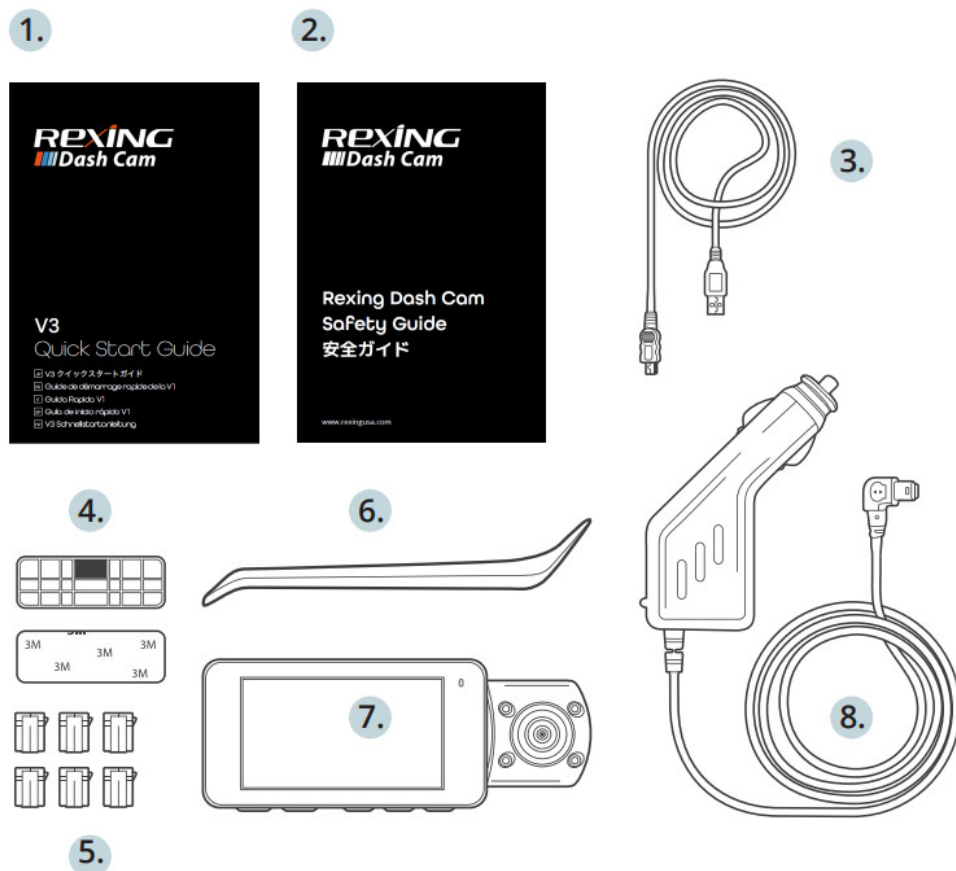

1. V3 Quick Start Guide
2. Safety Guide
3. USB Cable
4. 3M Adhesive Mount
5. Cable Adhesive Spacer
6. Cable Management Tool
7. Rexing V3 Dashboard Camera
8. Car Power Connector (12ft)

Camera Overview

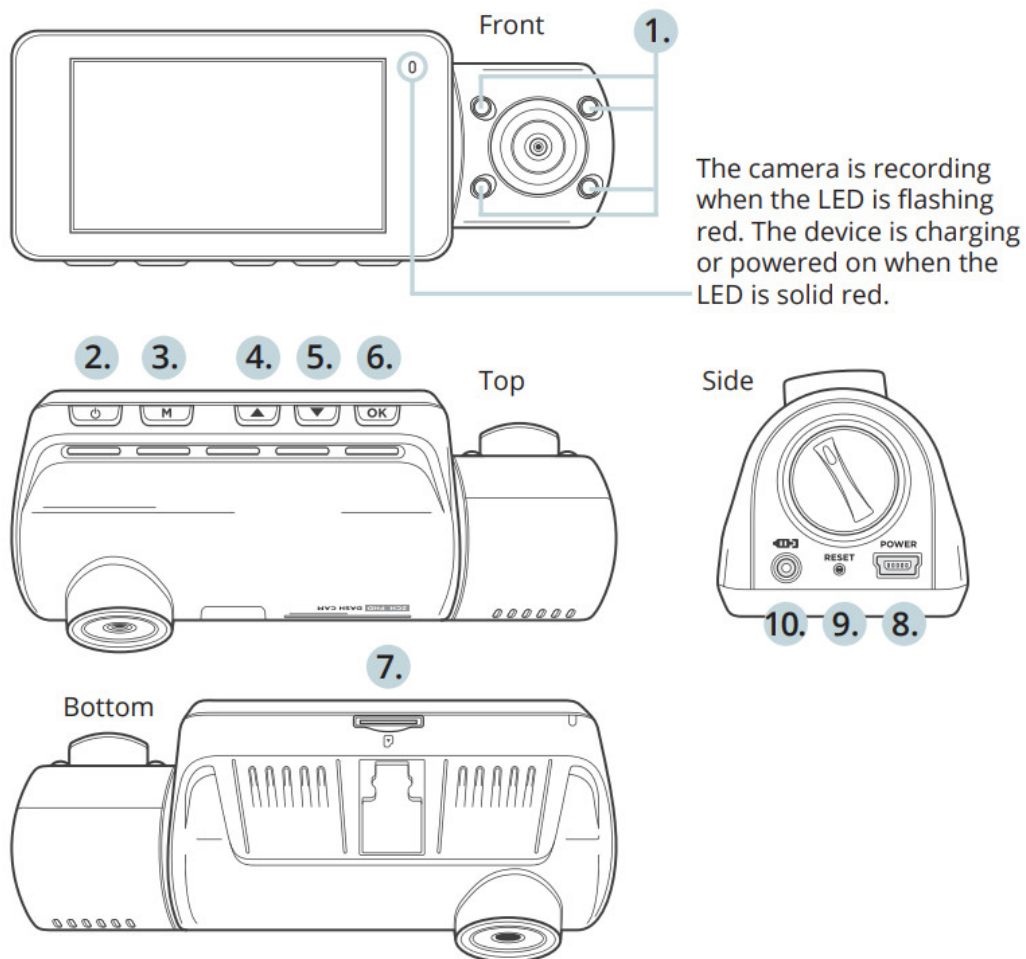

1. 4 IR Lights
2. Power Button / Screen Toggle Button
3. Menu Button / Mode Button
4. Up Navigation Button / Front and Rear Switch Button
5. Down Navigation Button / Mic Button
6. OK (Confirm) Button / Emergency Lock Button / Record Button
7. Micro SD Card Slot
8. Power / USB Charging Port
9. Reset Button
10. Rear Camera Port (currently not supported)

Screen Icons

Exposure Value

WDR Mode (on)

Recording
Standby Status

Wi-Fi
(Not Connected)

Recording Time
(current clip)

G Sensor Level

Recording (on)

Loop Recording
Time

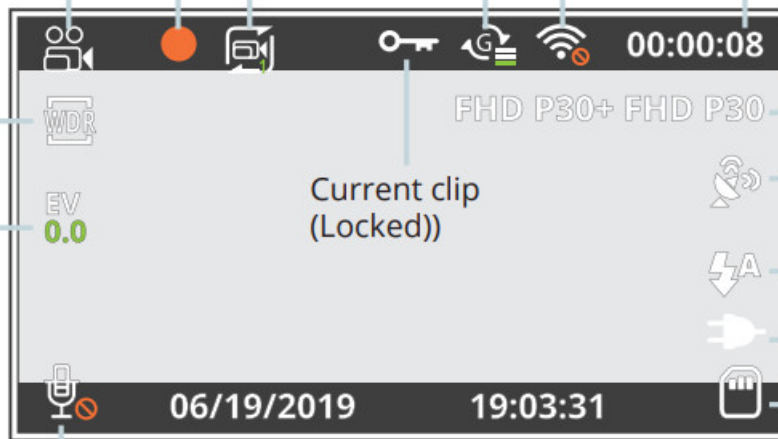

Video Resolution

GPS Signal
(Searching)

IR Lights

Battery Charging

Memory Card
(Inserted)

MIC (off)

Wi-Fi (Connected)

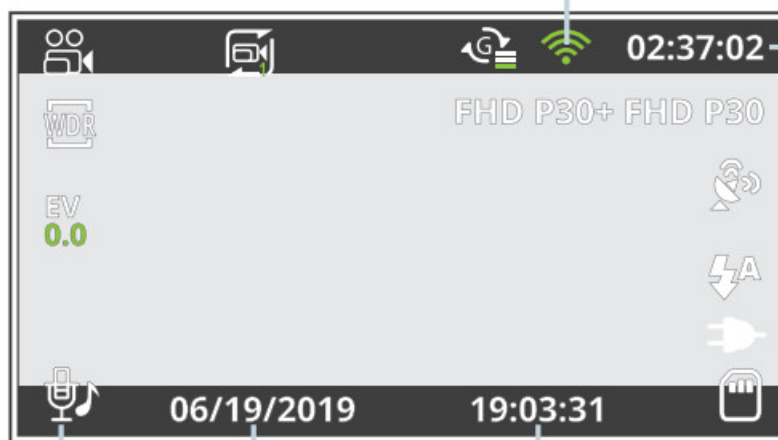

Memory Card
Remaining Time

MIC (on)

Current Date
(DD/MM/YYYY)

Time (24h)

Installation

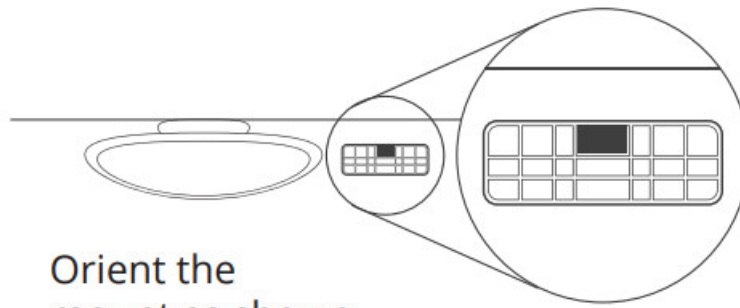

Orient the
mount as shown

Step 1:

Install the Dash Cam

Place the 3M tape on the mount and properly orient the mount straight to the roof and hood line of the vehicle. Firmly press the mount onto the windshield. Wait at least 20 minutes before mounting the camera. Orient the mount as shown in the illustration above.

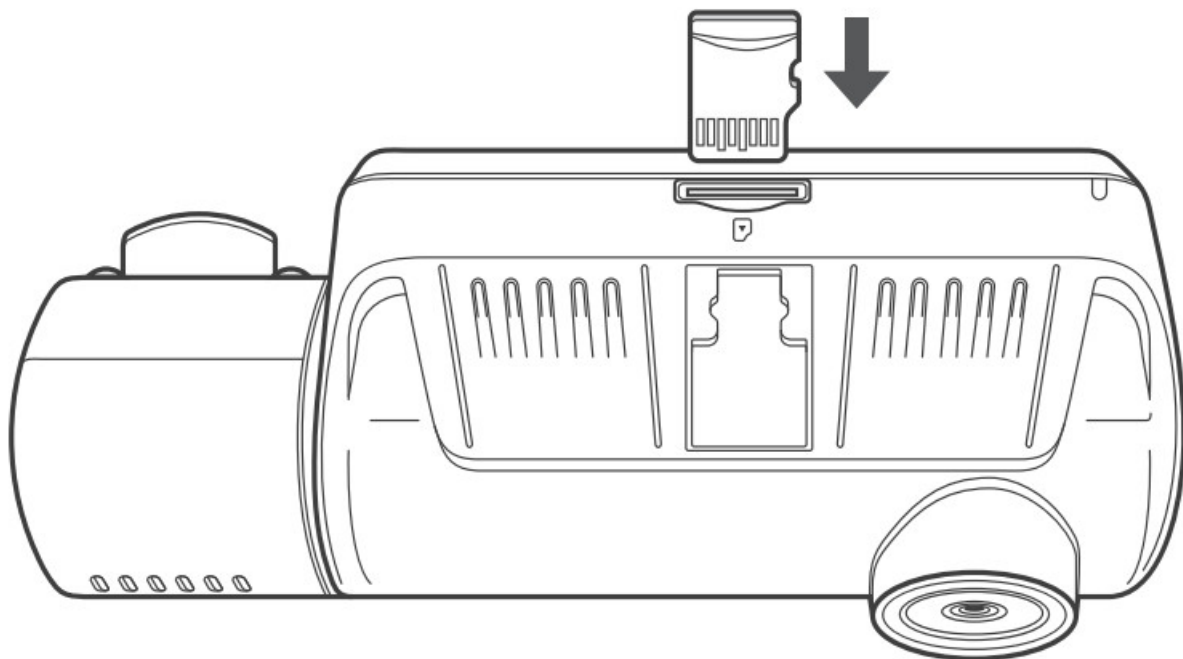

Step 2:

Insert the Memory Card

The Rexing V3 accepts [Class 10/UHS-1 or higher] Micro SD memory cards up to 256GB. You will need to insert a memory card before you can begin recording. Before inserting or removing a memory card, first ensure you've powered down the device. Gently push the memory card in until you hear a click, and allow the spring release to push the card out.

Step 3: Power the Camera and Format the Memory Card Power the camera by connecting the charger to the car cigarette lighter and camera. To ensure the V3 records to your memory card properly and without error. Before you start using a new memory card, you must format the card within the camera using the format function. Always backup important data stored on the memory card before formatting.

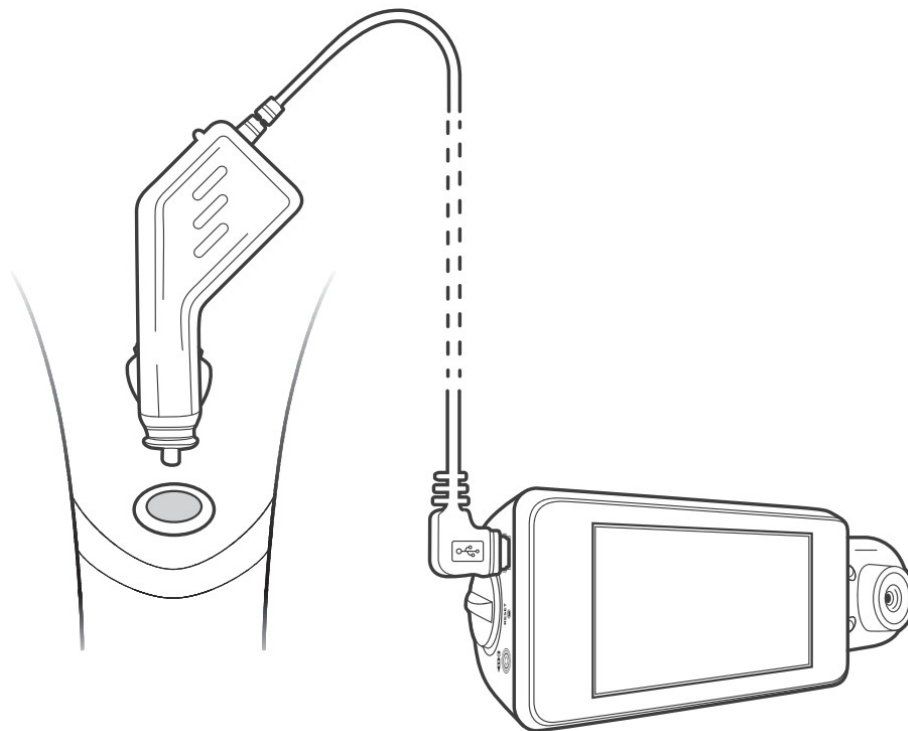

To format the memory card, make sure you have inserted your memory card, then turn on the device by connecting to a power source. Press OK to stop recording. Then press the MENU button twice to enter the System Setup Menu.

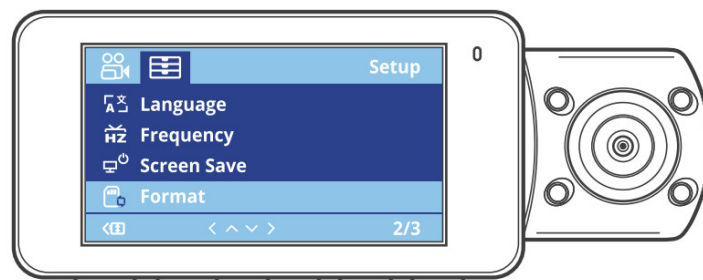

Press the Menu button twice

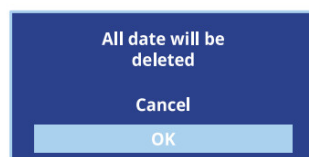

Press the OK button to confirm formatting the card

Use the UP and DOWN navigation buttons and go to the Format setting. Press the OK button to confirm the selection.

You may now disconnect from power. The camera will shut down after 3 seconds. The camera should begin recording automatically the next time it is powered on.

Step 4: Installing the Camera onto the Windshield

Place the camera on the mount and carefully route the power cable around the windshield and tuck it under the trim.

Plug the car charger cable to a 12V DC power outlet or the car cigarette lighter.

Connect the car charger to the camera. The camera will auto-start the recording once it's powered on.

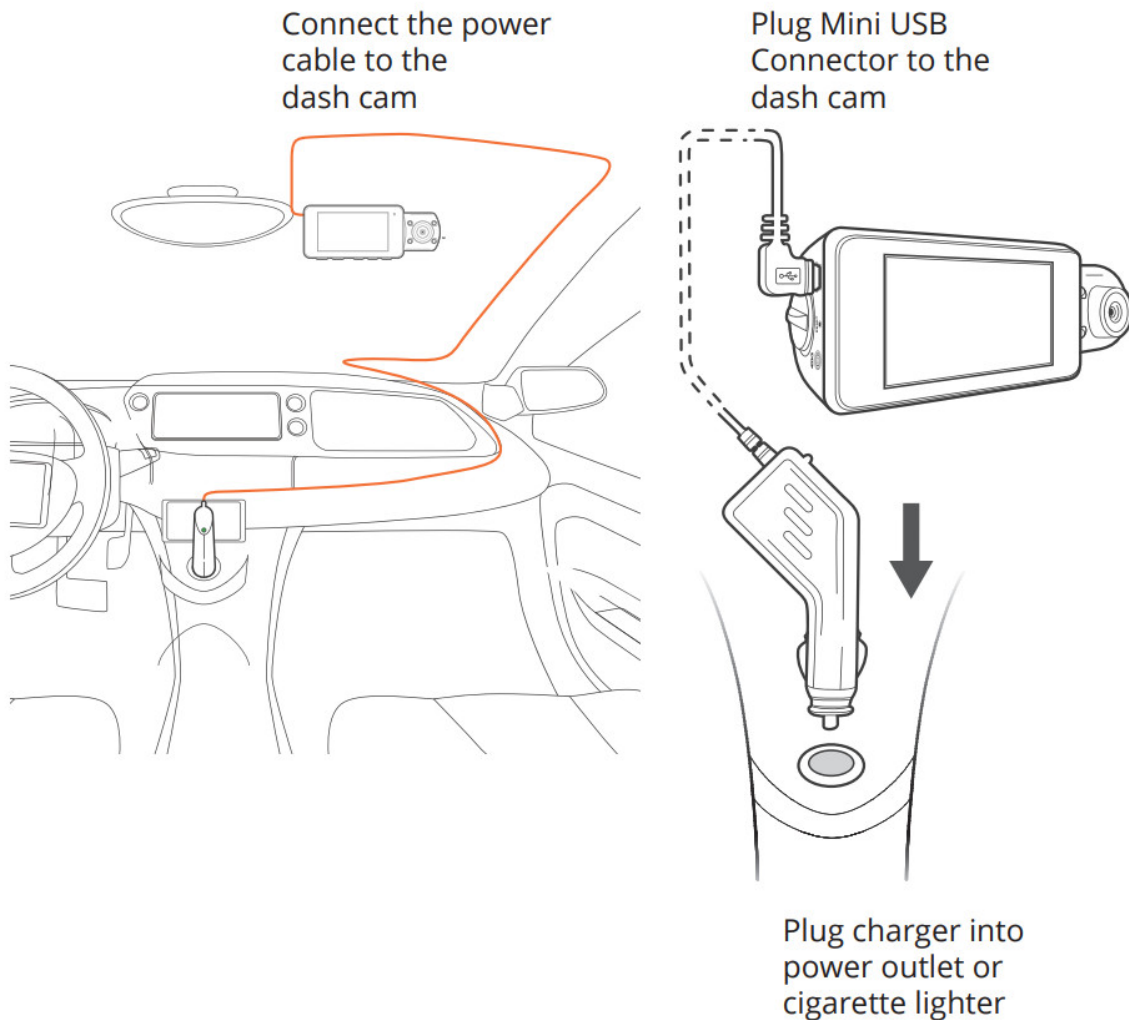

Basic Operation

Device Power

The device will be automatically powered on when plugged into a 12V accessory socket or cigarette lighter when receives a charge (i.e.: the vehicle is started).

To turn the device on manually, press and hold the Power button until the welcome screen appears.

The camera will automatically start recording when it's powered on.



Press and hold the Power button to turn the device on manually

Menu Settings

Power the camera On. If the camera is recording, press the OK button to stop recording.

Hold the MENU button and toggle to the desired mode.

Press the MENU button once to enter the settings menu for a Mode. Press the MENU button twice to enter the System Settings (Set up).



Video Playback

Playback of videos can be done on the device or a computer.

To playback, a video on the device, toggle to the Playback mode.

Use the UP and DOWN navigation buttons to toggle to the desired video. Press the OK button to play.

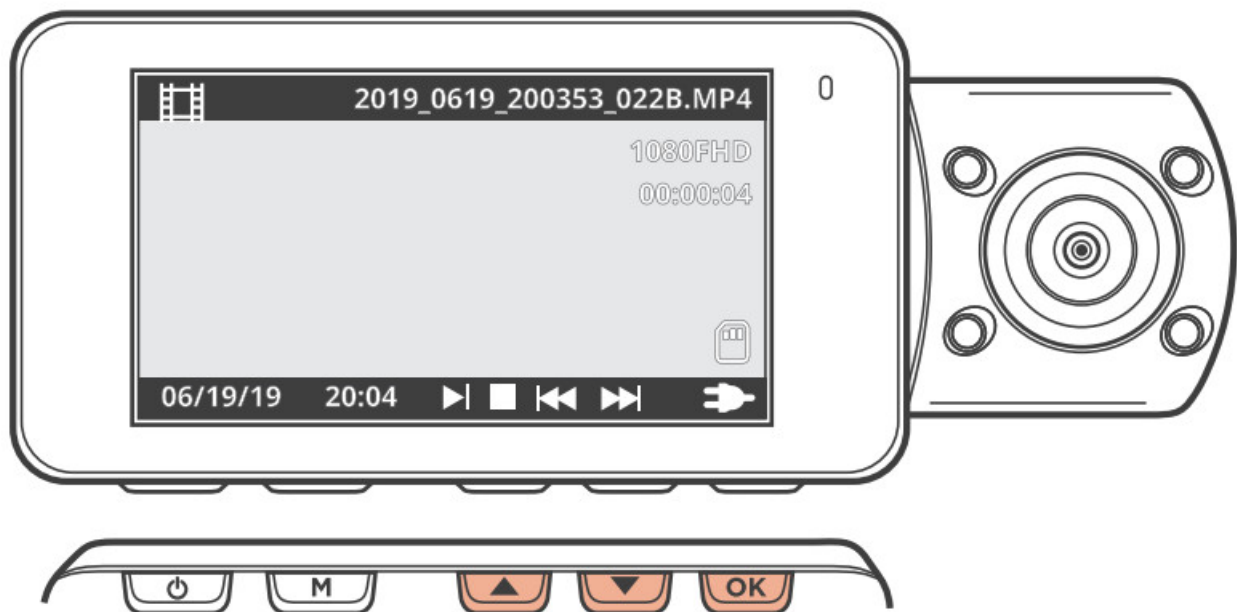

During playback, use the OK (pause), UP navigation (rewind), and DOWN navigation (fast forward) buttons to control the video playback.

To playback, a video on the computer, either use an SD card or an adapter or connect the device to the computer directly using the USB cable.

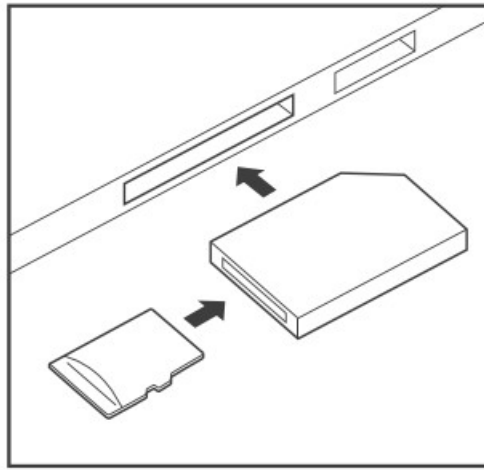

To playback, a video using an SD card adapter, remove the memory card and insert it into an SD card adapter. Place the adapter in the computer. Then place the adapter into the computer.

To playback, a video using a USB cable, connect the USB cable to the device and the computer. After the device is powered on, press the OK button to select Mass Storage.

On the computer, navigate to the device drivers. The videos are stored at \CARDV\MOVIE. The locked videos are stored at:\CARDV\MOVIE\RO.

Select the video to playback.

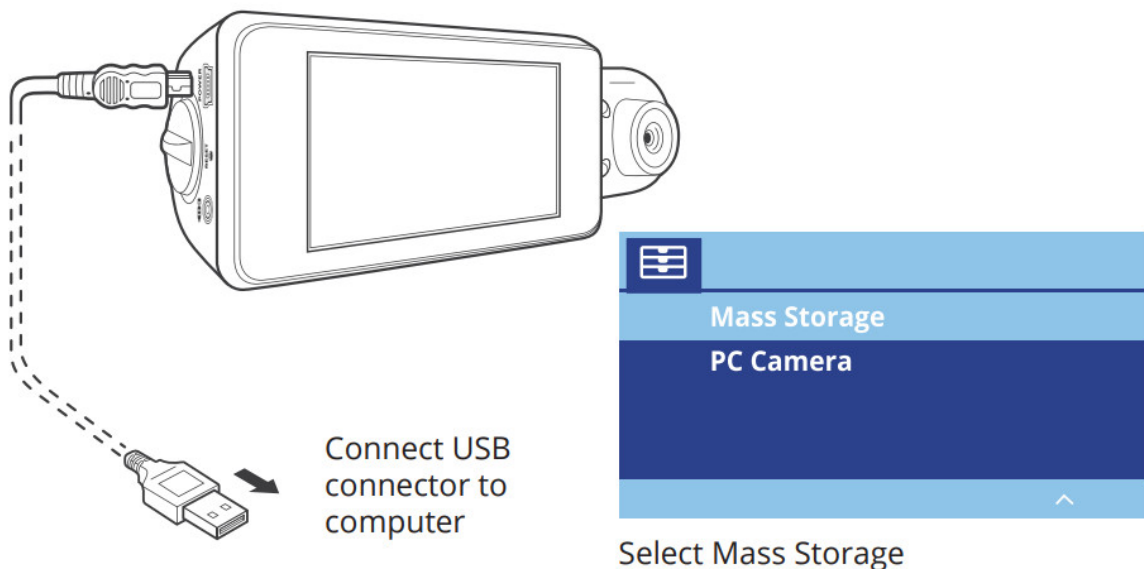

Wi-Fi Connect

Download the "Rexing Connect" app from the App Store/Google Play Store.

1. To access or exit the WiFi feature, hold down the UP navigation button.
2. Open Wi-Fi settings on your phone, find "SSID" from the list, and tap to connect. (Default password: 12345678)
3. Open the Rexing Connect app, and tap "Connect" to enter the real-time video streaming page.

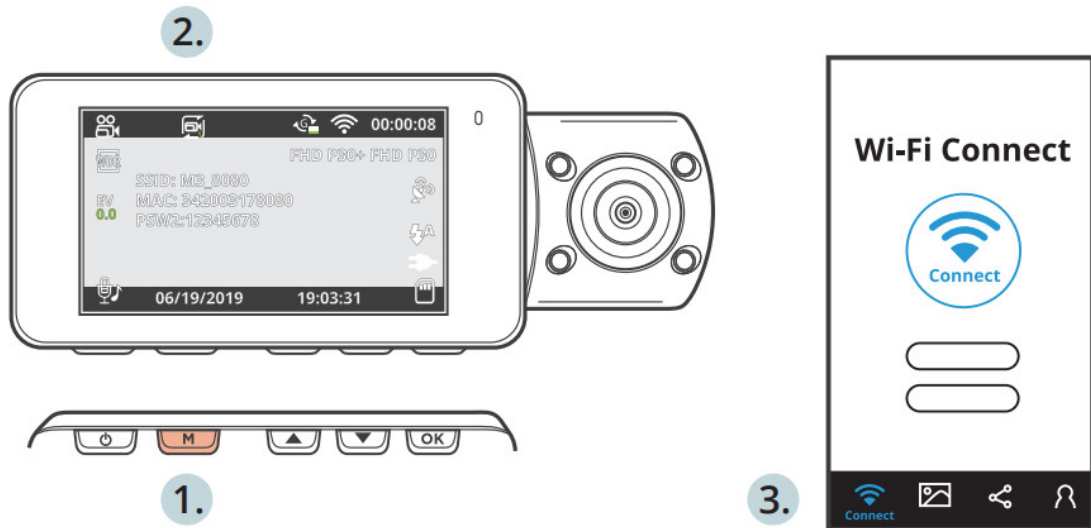

4. Once connected, the dash cam screen will switch to the camera view and will display a “WiFi Connected” message. Using the Rexing Connect app, you can view a live preview of the dash cam screen, start/stop recording, as well as view and save your captures with your mobile device.

For further instruction regarding the Wi-Fi Connect feature, please visit www.rexingusa.com/wifi-connect/.

GPS Logger

When connected to the camera, it will record the speed and location of your vehicle as you drive.

You can then access this information while playing back your recordings using the GPS Video player (For Windows and Mac, available at rexingusa.com).

The dash cam will automatically search for the GPS signal once it's connected to the power source. Press the MENU button once and go to System Settings. Toggle the GPS setting, and select your favorite speed unit. After a GPS signal is found, the screen icon will turn from not connected to active – as per the below icons.



GPS Signal - Searching



GPS Signal - Active



GPS Signal - Not Connected

Taking Photos

To take a photo, stop video recording and toggle to the Photo Mode.

Press the OK button to take a photo.

To view a photo, stop video recording and toggle to the Playback Mode.

Press the UP and DOWN navigation buttons to toggle through your photos.



To delete a photo, stop video recording and toggle to the Playback Mode and toggle through the videos and photos to the one you want to delete.

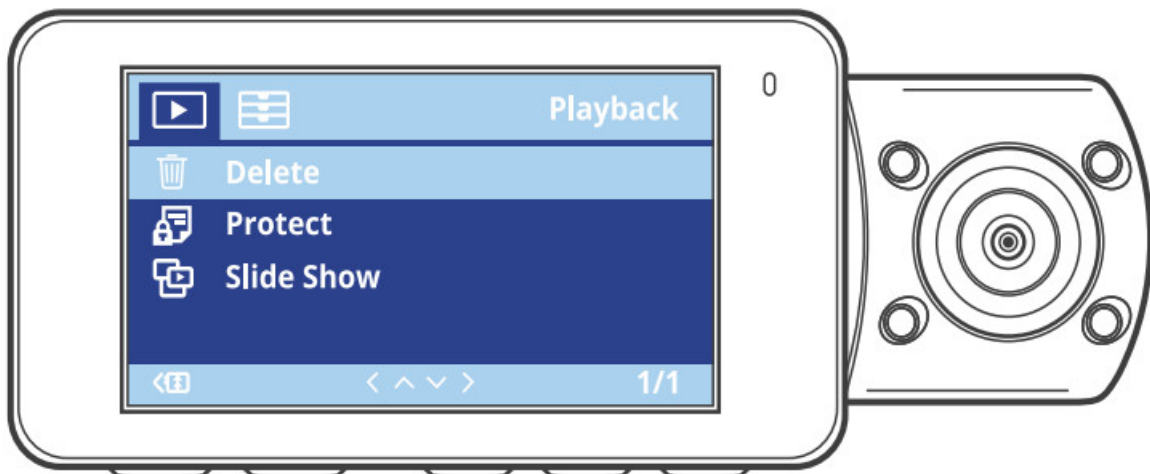

Warning

This device complies with Part 15 of the FCC Rules. Operation is subject to the following two conditions: (1) this device may not cause harmful interference, and (2) this device must accept any interference received, including interference that may cause undesired operation.

Changes or modifications not expressly approved by the party responsible for compliance could void the user's authority to operate the equipment.

NOTE:

This equipment has been tested and found to comply with the limits for a Class B digital device, pursuant to Part 15 of the FCC Rules. These limits are designed to provide reasonable protection against harmful interference in a residential installation. This equipment generates uses and can radiate radio frequency energy and, if not installed and used in accordance with the instructions, may cause harmful interference to radio communications. However, there is no guarantee that interference will not occur in a particular installation. If this equipment does cause harmful interference to radio or television reception, which can be determined by turning the equipment off and on, the user is encouraged to try to correct the interference by one or more of the following measures:

- Reorient or relocate the receiving antenna.

- Increase the separation between the equipment and receiver.
- Connect the equipment into an outlet on a circuit different from that to which the receiver is connected.
- Consult the dealer or an experienced radio/TV technician for help.

NOTE:

This device and its antenna(s) must not be co-located or operated in conjunction with any other antenna or transmitter.

RF Exposure Statement

To maintain compliance with FCC's RF exposure guidelines, This equipment should be installed and operated with a minimum distance of 20cm from the radiator of your body. This device and its antenna(s) must not be co-located or operated in conjunction with any other antenna or transmitter.

Safety Information

To prevent injury to yourself or others and damage to your device, read all safety information before using.



Warning

Failure to comply with safety warnings and regulations can result in serious injury or death.

or calibrated while operating a vehicle. Rexing is not responsible for any damages resulting from the user's misuse of the camera.

Do not use damaged power cords or plugs or loose electrical sockets.

Do not touch the car charger with wet hands or disconnect the charger by pulling the cord. Doing so may result in electrocution.

Do not use a bent or damaged car charger. Doing so may

Do not use your device while it is charging or touch your device with wet hands. Doing so may cause electric shock.

Do not short-circuit the charger or the device. Doing so may

Do not drop the charger or device or subject them to impact.

Handle and dispose of the charger and device with care.

- Never crush or puncture the device.
- Never place the device in or on heating devices, such as microwave ovens, stoves, or radiators. The device may explode if overheated. Follow all local regulations when disposing of a used device.
- Avoid exposing the device to high external pressure which can lead to an internal short circuit and overheating.

Protect the device and charger from damage.

- Avoid exposing your device to excessive cold or heat.

Extreme temperatures can damage the device and reduce the charging capacity and life of your device.

- Do not allow children or animals to bite or chew the device.

be a choking hazard. If children use the device, make sure they use the device properly.

- Never use a damaged charger.



Caution

Failure to comply with safety precautions and regulations can result in property damage, serious injury, or death.

Do not use your device near other electronic devices. Most electronic devices use radio frequency signals. Your device may interfere with other nearby electronic devices.

Do not use your device near other devices that emit radio signals, such as sound systems or radio towers. Radio signals from these may cause your device to malfunction.

Do not expose the device to heavy smoke or fumes. Doing so may damage the outside of the device or cause it to malfunction.

If you notice strange smells or sounds coming from your device, or if you see smoke or liquid leaking from the device, stop using the device immediately and take it to a Rexing

Service Center.

For your own safety, do not operate the controls of this product while driving. The window mount is needed when using the recorder in a car. Make sure you place the device in a location where it won't obstruct the driver's view. Always keep the camera lens clean, and ensure that the lens material. If the car's windshield is tinted with a dark coating,

Do not store your device in excessively hot, cold, damp, or dry locations. Doing so may cause the screen to malfunction or result in damage to the device.

If your device becomes overheated, allow it to cool down before use. Prolonged exposure of skin to an overheated device may cause low-temperature burn symptoms, such as red spots or areas of darker pigmentation.

Install mobile devices and equipment with caution.

- Ensure that any mobile devices or related equipment installed in your vehicle are securely mounted.
- Avoid placing your device and accessories in or near an airbag deployment area. Improperly installed wired equipment can cause serious injury in a situation where

Do not drop your device or subject your device to impact.

If the device is bent, deformed, or damaged, a malfunction may occur.

Your device may wear out over time. Some parts and repairs are covered by the warranty within the validity period, but damage or deterioration related to the use of unapproved accessories is not.

- Do not attempt to disassemble, repair, or modify your device.

Clean your device and charger by wiping with a towel or eraser. Do not use chemicals or detergents. Doing so can discolor or corrode the outside of the device and may result in the manufacturer's warranty.

Do not distribute copyright-protected material. Doing so without the permission of the content owners may violate copyright laws. The manufacturer is not responsible or liable for any legal issues that result from the user's illegal use of copyrighted material.

Correct Disposal of This Product

(Applicable in countries with separate waste collection systems)

Waste Electrical & Electronic Equipment

This symbol, found on the device, accessories, or accompanying literature, indicates that the product and its electronic accessories (e.g. charger, headset, USB cable) should not be disposed of with other household waste. To prevent possible harm to the environment or human health from uncontrolled waste disposal, please separate these items from other types of waste and recycle them responsibly to promote the sustainable reuse of material resources.

Household users should contact either the retailer where they information on where and how they can take these items for environmentally safe recycling.

Business users should contact their suppliers and check the terms and conditions of the purchase contract. This product and its electronic accessories should not be mixed with other commercial wastes for disposal.

Disclaimer

Some content and services accessible through this device belong to third parties and are protected by copyright, patent, trademark, and/or other intellectual property laws. Such content and services are provided solely for your personal noncommercial use.

You may not use any content or services in a manner that has not been authorized by the content owner or service provider.

Without limiting the foregoing, unless expressly authorized by the applicable content owner or service provider, you may not modify, copy, republish, upload, post, transmit, translate, sell, create derivative works, exploit, or distribute in any manner or medium any content or services displayed through this device.

“THIRD-PARTY CONTENT AND SERVICES ARE PROVIDED “AS IS.” REXING DOES NOT WARRANT CONTENT OR SERVICES SO PROVIDED, EITHER EXPRESSLY OR IMPLIED, FOR ANY PURPOSE.

REXING EXPRESSLY DISCLAIMS ANY IMPLIED WARRANTIES, INCLUDING BUT NOT LIMITED TO, WARRANTIES OF MERCHANTABILITY OR FITNESS FOR A PARTICULAR PURPOSE.

REXING DOES NOT GUARANTEE THE ACCURACY, VALIDITY, TIMELINESS, LEGALITY, OR COMPLETENESS OF ANY CONTENT OR SERVICE MADE AVAILABLE THROUGH THIS DEVICE, AND UNDER NO CIRCUMSTANCES, INCLUDING NEGLIGENCE, SHALL REXING BE LIABLE, WHETHER IN CONTRACT OR TORT, FOR ANY DIRECT, INDIRECT, INCIDENTAL, SPECIAL OR CONSEQUENTIAL DAMAGES, ATTORNEY FEES, EXPENSES, OR ANY OTHER DAMAGES ARISING OUT OF, OR IN CONNECTION WITH, ANY INFORMATION CONTAINED IN OR AS A RESULT OF THE USE OF ANY CONTENT OR SERVICE BY YOU OR ANY THIRD PARTY, EVEN IF ADVISED OF THE POSSIBILITY OF SUCH DAMAGES.”



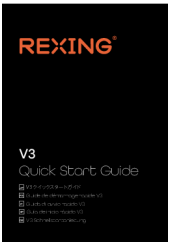

Third-party services may be terminated or interrupted at any time, and Rexing makes no representation or warranty that any content or service will remain available for any period of time. Content and services are transmitted by third parties by means of networks and transmission facilities over which Rexing has no control. Without limiting the generality of this disclaimer, Rexing expressly disclaims any responsibility or liability for any interruption or suspension of any content or service made available through this device.

Rexing is neither responsible nor liable for customer service related to the content and services. Any question or request for service relating to the content or services should be made directly to the respective content and service providers.

Documents / Resources

	<p>REXING V3 Dual Camera Front and Inside Cabin [pdf] User Guide</p> <p>V3, Dual Camera, Front and Inside Cabin, Camera</p>
---	---

References

-  [Rexing USA | Your Roadside Eyewitness](#)
-  [Rexing USA | Your Roadside Eyewitness](#)
-  [Wi-Fi Connect](#)
-  [Yuhe Sun \(@rexingdashcam\) • Instagram photos and videos](#)
-  [Rexing USA](#)