

REXING V1P Plus 4K UHD Front and Rear Dash Cam with Wi-Fi



REXING V1P Plus 4K UHD Front and Rear Dash Cam with Wi-Fi User Guide

[Home](#) » [Rexing](#) » REXING V1P Plus 4K UHD Front and Rear Dash Cam with Wi-Fi User Guide 

Contents

- [1 REXING V1P Plus 4K UHD Front and Rear Dash Cam with Wi-Fi](#)
- [2 Overview](#)
- [3 What's in the Box](#)
- [4 Camera Overview](#)
- [5 Installation](#)
- [6 Basic Operation](#)
- [7 Warranty & Support](#)
- [8 FCC STATEMENT](#)
- [9 Documents / Resources](#)
 - [9.1 References](#)

REXING®

REXING V1P Plus 4K UHD Front and Rear Dash Cam with Wi-Fi



The information in this manual is subject to change without notice. www.rexingusa.com.

Activate Your 18-Month Warranty & Choose Your

FREE Gift!

Activate within 30 days of purchase to claim your free gift and extend your limited 12-month warranty to 18 months.

Scan The QR To Activate & Select Your Free Gift

SCAN ME!



<https://www.rexingusa.com/productreg/>

Overview

Thank you for choosing Rexing!

We hope you love your new products as much as we do. If you need any assistance or have any suggestions to help us improve, please contact us.

- care@rexingusa.com
- [877-740-8004](tel:877-740-8004)

Our support team will respond to you as soon as possible. Always a surprise in Rexing.

Check us out here

- <https://www.facebook.com/rexingusa/>
- <https://www.instagram.com/rexingdashcam/>
- <https://www.rexingusa.com/support/registration/>
- <https://www.rexingusa.com/support/product-support/>



Facebook



Instagram



Site



Product Support



What's in the Box



1. Rexing VI P-4K Dashcam
2. Car Charger
3. Mount Plate & 3M Adhesive
4. Warning Sticker
5. Rear Camera
6. Cable Management Tool
7. Cable Clips
8. Quick Start Guide
9. Safety Guide
10. 32GBSD Card
11. Electrostatic Sticker
12. Smart Hardwire Kit

Camera Overview

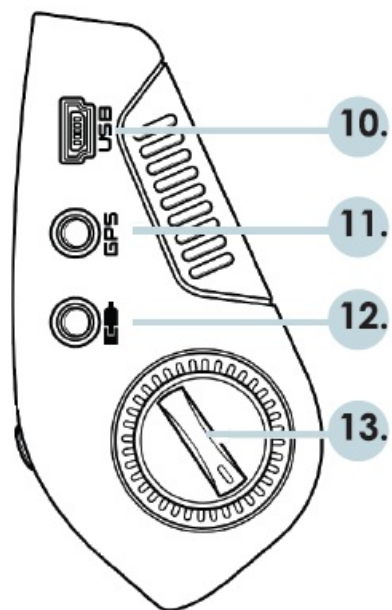
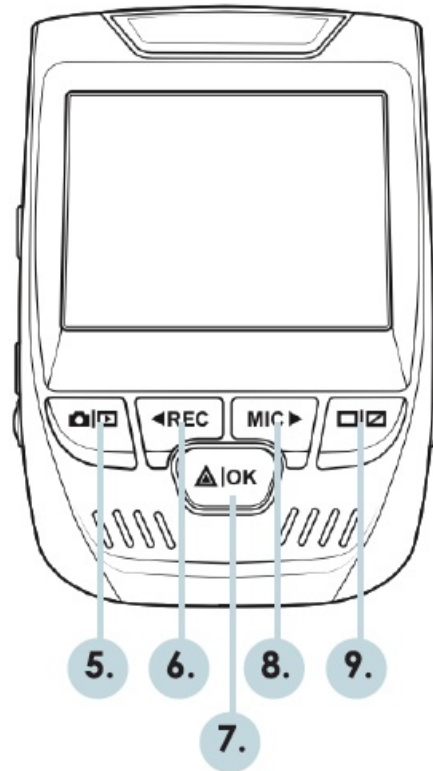
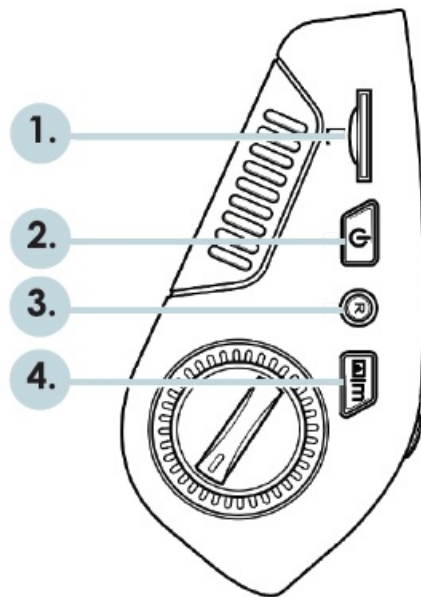

1. Micro SD Card Slot
2. Power Button
3. Reset Button
4. Menu Button
5. Mode Button
6. REC (Record) Button
7. OK (Confirm) Button
8. MIC Button
9. Screen Button
10. Mini-USS Port
11. GPS Logger Port
12. Rear Camera Port
13. Lens Angle Adjustment

The camera is recording when the LED is flashing red. The device is charging or powered on when the LED is solid blue.

Screen Icons

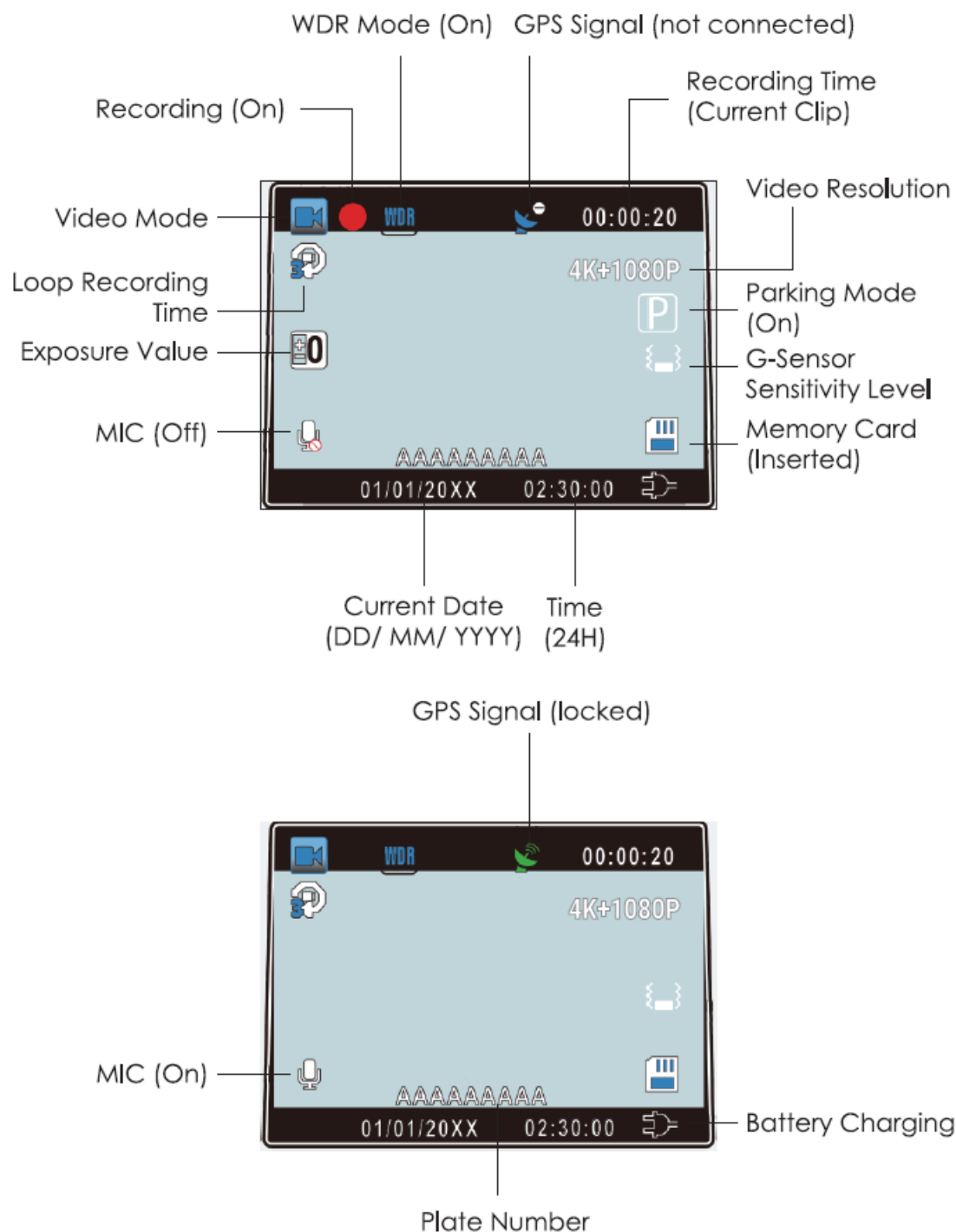

Installation

Step 1: Installing the Electrostatic Stickers

Prepare Your Windshield

Thoroughly cleanse your windshield with either water or alcohol. Follow this by wiping it dry using a clean, dry cloth to ensure a spotless surface.

Position the Sticker

Next, carefully peel off the protective film from the electrostatic sticker. Attach the sticker to the windshield, ideally behind the rear-view mirror. This position is recommended to avoid obstructing your view while you're on the road.

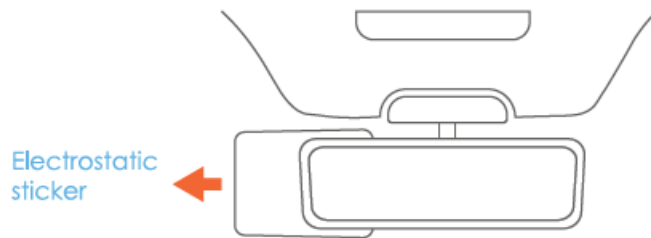

Step 2: Install the Dash Cam

Place the 3M adhesive on the mounting plate and properly orient the mounting piece to the roof and hood line of the vehicle.

Important!

Ensure the T-interlock on the mount is oriented in the correct direction. Firmly press the mount onto the windshield.

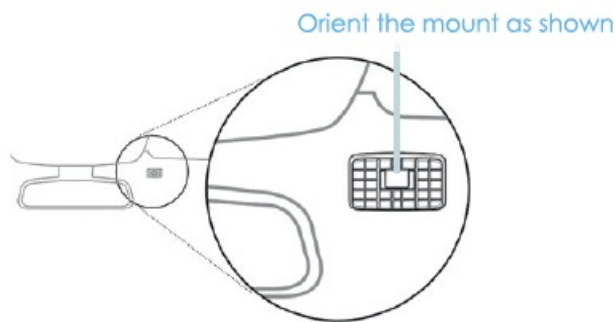

Step 3: Insert the Memory Card

The Rexing VI P-4K accepts [Class 10/ UHS-1 or higher] Micro SD memory cards up to 512GB. You will need to insert a memory card before you can begin recording. Before inserting or removing a memory card, first ensure you've powered down the device.

Gently push the memory card in until you hear a click, and allow the spring release to push the card out.

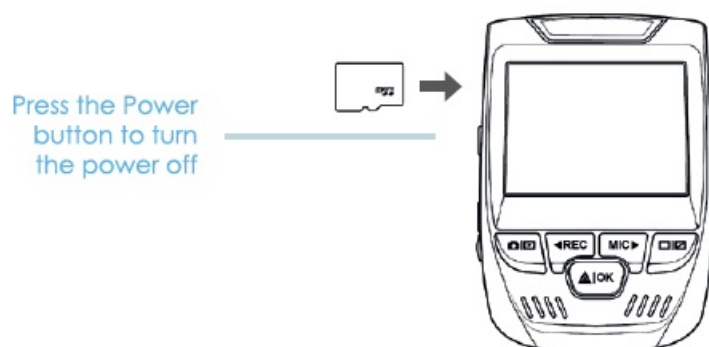

Step 4: Power the Camera and Format the Memory Card

- Power the camera by connecting the charger to the car cigarette lighter and the camera
- Ensure the VI P-4K records to your memory card properly and without error. Before you start using a new memory card, you must format the card within the camera using the format function. Always back up important data stored on the memory card before formatting.
- To format the memory card, make sure you have inserted your memory card, then turn on the device by

connecting to a power source. Press REC to stop recording. Then press the MENU button twice to enter the system Setup Menu. Use the REC and MIC buttons and go to the Format settings. Press the OK Button to confirm the selection.

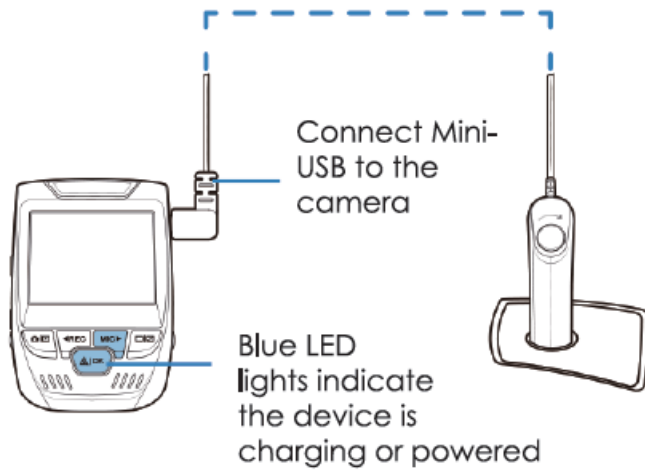

- You may now disconnect from power. The camera will shut down after 3 seconds. The camera should begin recording automatically the next time it is powered on.

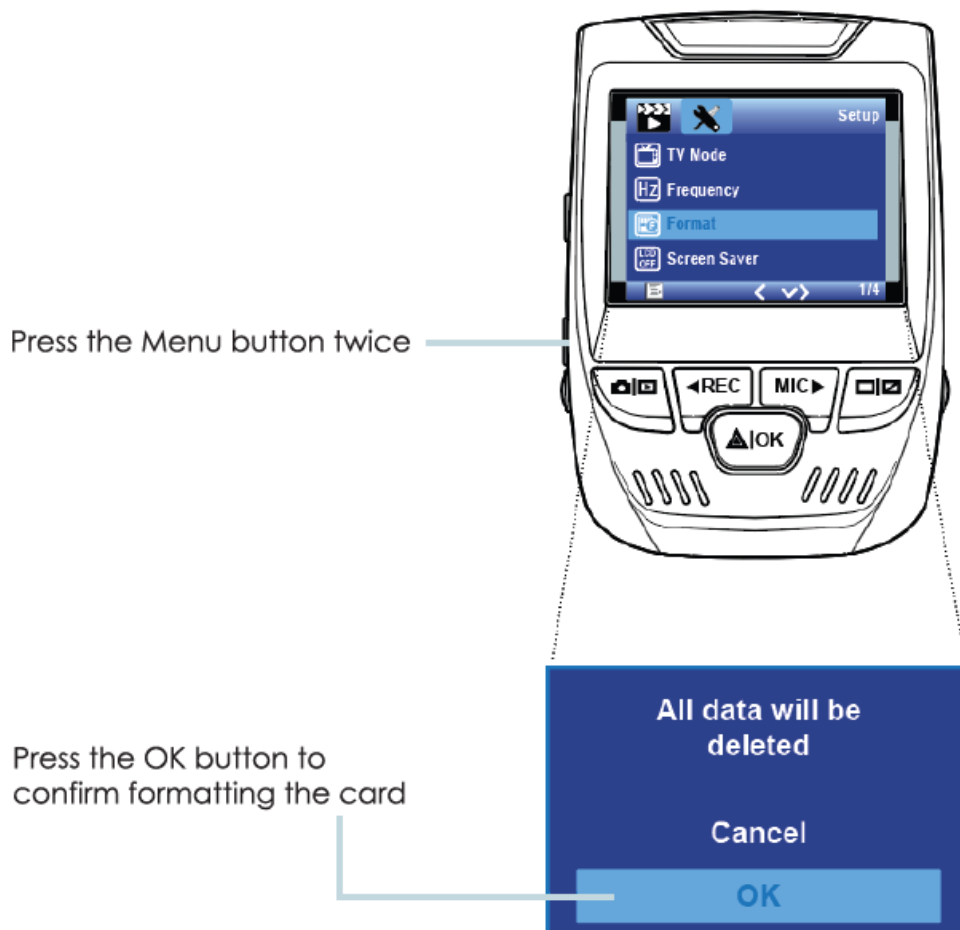

Step 5: Mount the Rear Camera

Mount the rear camera as shown below. Use the provided rear camera cable to connect the rear camera to the front camera.

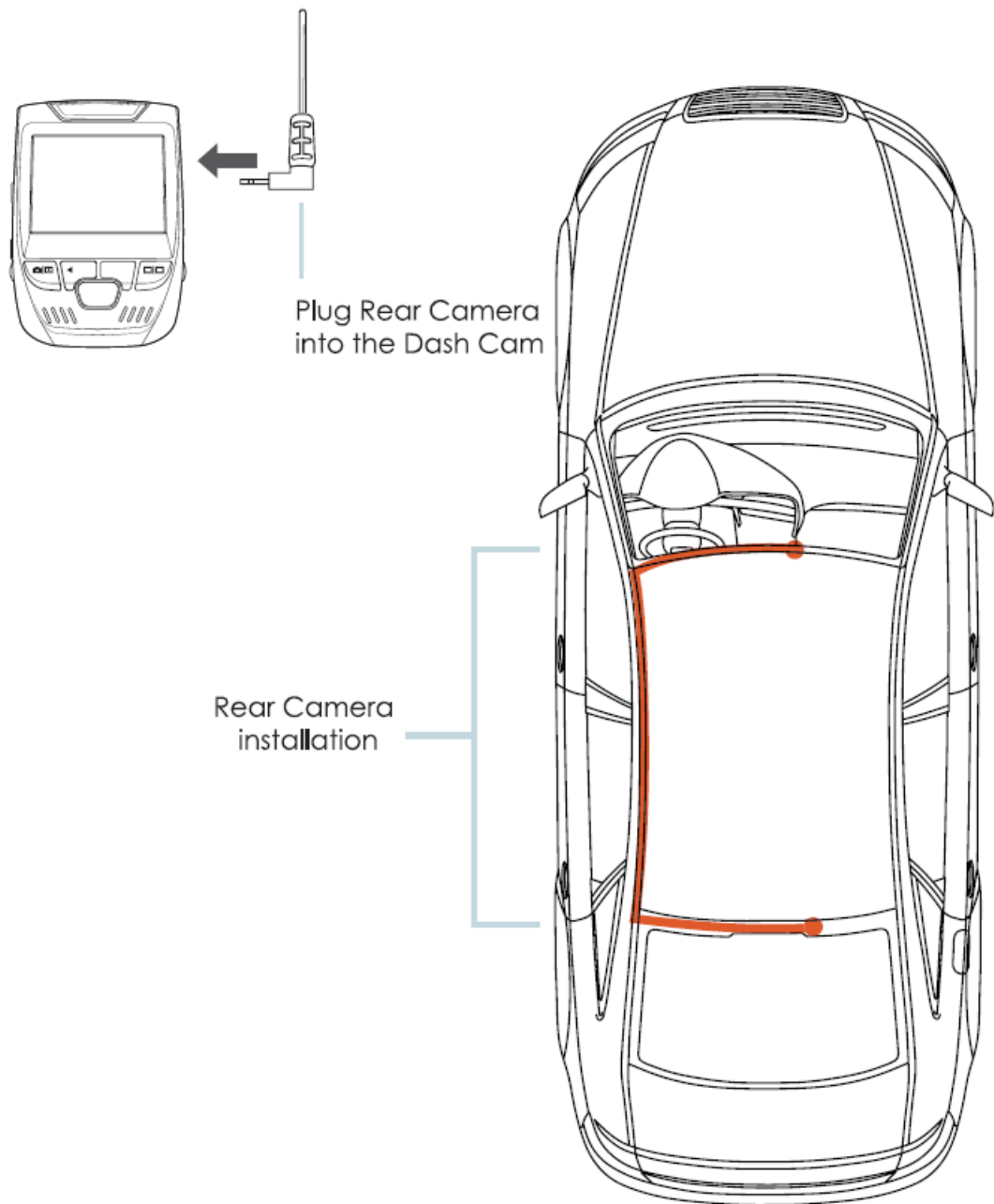

Step 6: Installing the Camera onto the Windshield

- Place the camera on the mount carefully route the power cable around the windscreen and tuck it in under the trim.
- Plug the Car Charger Cable into a 12V DC power outlet or the car cigarette lighter.
- Connect the car charger to the camera. The camera will auto-start recording once powered on.

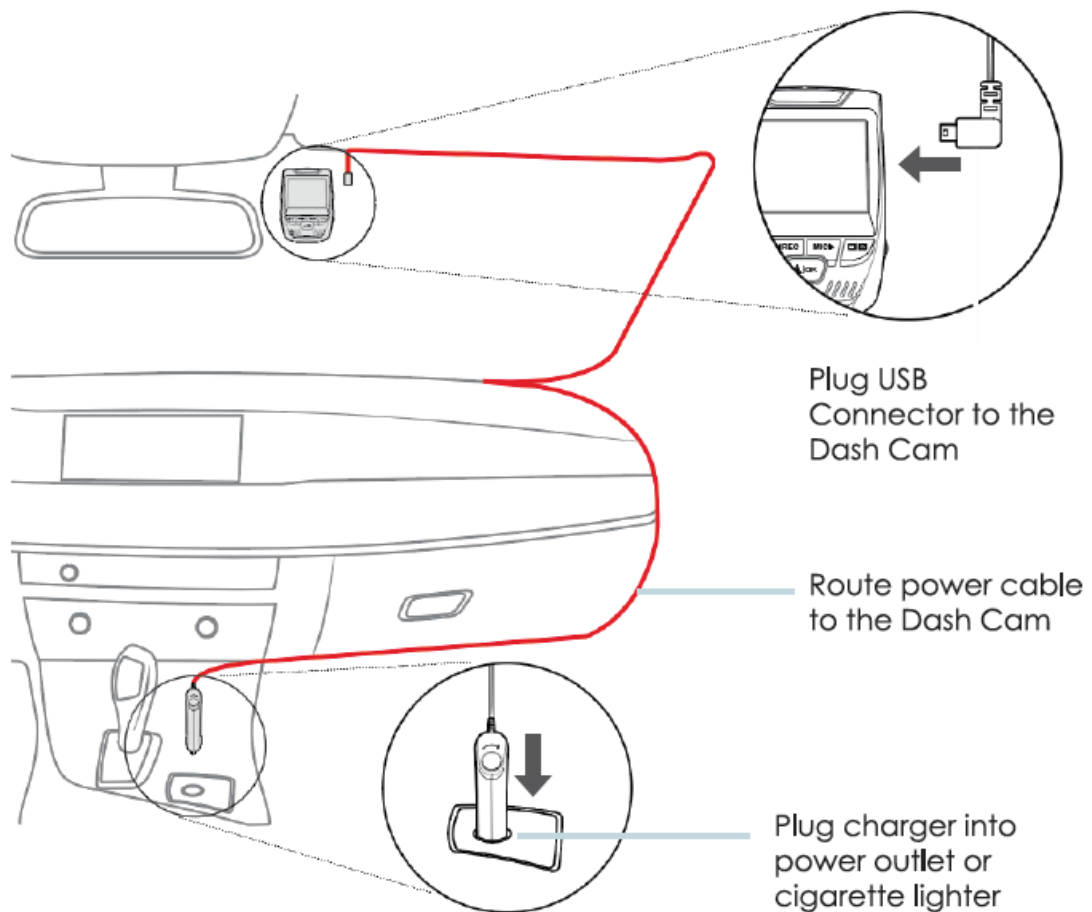

Basic Operation

Device Power

- The device is automatically powered on when plugged into a 12V accessory socket or cigarette lighter and receives a charge (i.e.: the vehicle is started.)
- To turn the device on manually, press and hold the POWER button until the welcome screen appears.
- The camera will automatically start recording when powered on.

Press and hold the POWER button to turn the device on manually

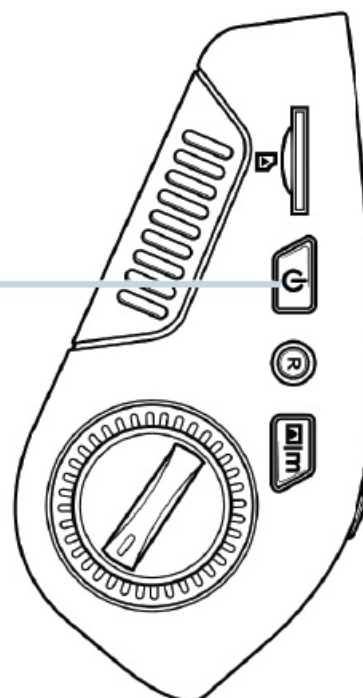

Menu Settings

- Power the camera on. If the camera is recording, press the REC button to stop recording. Press the MODE button to toggle to the desired mode.
- Press the MENU button once to enter the settings menu for a Mode. Press the MENU button twice to enter the System Settings.



Video Recording

The camera will automatically start recording when the device receives a charge. The LED lights and the red dot will blink when the device is recording. Press the REC button to stop recording.



The camera automatically start recording when powered on

Video Playback

- Playback of videos can be done on the device or a computer. Also, if you have purchased a Rexng GPS Logger you may play back the recordings in a specialized application.
- To playback a video on the device, toggle to the Playback mode. Use the REC and MIC buttons to toggle to the desired video. Press the OK button to play.

Playback mode



Control playback with these buttons

- During playback use the OK (pause), MIC (fast forward), and REC (rewind) buttons to control the video playback.
- To playback a video on the computer, either use an SD card adapter or connect the device to the computer

directly using the USB to Mini USB cable.

- To playback a video using an SD card adapter, remove the memory card and insert it into an SD card adapter. Place the adapter in the computer.

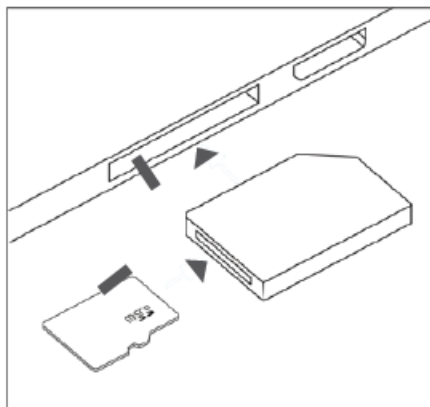

- To playback a video using a USB cable, connect the USB Cable to the device and the computer. After the device powers up, press the OK Button to select Mass Storage.
- On the computer, navigate to the device drive. The videos are stored at: \CARDV\MOVIE. Select the video to playback.

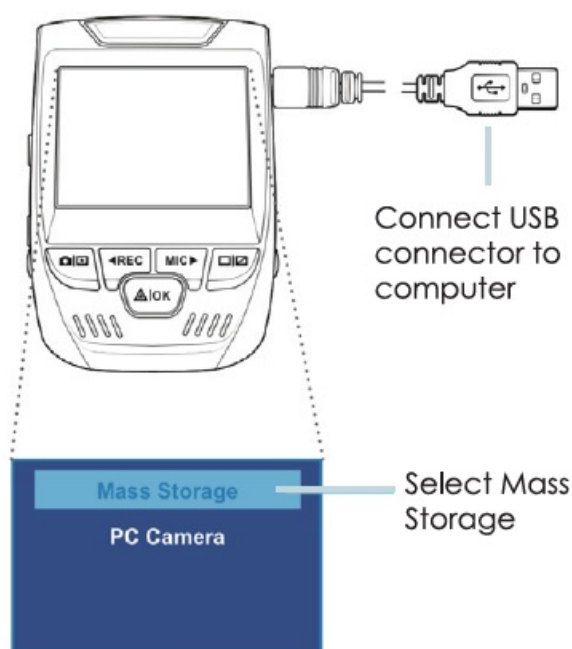

Parking Monitor (Parking Surveillance Mode)

A parking monitor provides surveillance on your parked vehicle. When the engine is off, the hardwire kit is used to provide continuous power and protect your car battery from being discharged.

- We kindly suggest taking a moment to watch our tutorial video. It's designed to help you have a smooth and successful installation experience. We believe you'll find it very helpful!
- Please go to <https://www.rexingusa.com/ihwkinstall> or scan QR code



Option 1: Vibration Detection

To enable the Parking Monitor, you'll need to connect it with a Smart Hardwire Kit (Included).

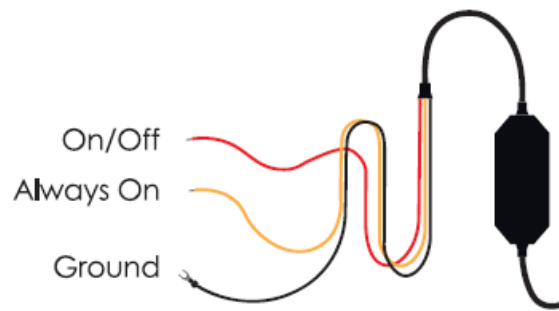

This feature will allow the dash cam to switch to parking mode automatically if the vehicle's engine turns off and switch back to the normal recording after the vehicle's engine turns on.

Gravity Sensing Record:

The Gravity Sensing detects significant or sudden movement (such as an impact or collision), it will trigger an event recording. We suggest setting the "Gravity Sensing" to High sensitivity for Parking Mode Recording.

Note:

If you do not use the parking mode function, please change the Gravity Sensing sensitivity to low. Otherwise, the video will easily be locked and the video cannot be deleted by the loop recording function. This will cause the memory card to be full of locked videos and cause the recorder to fail to work normally.

Please DO NOT ENABLE the Parking Monitor function in the settings of the dash cam WITHOUT connecting a smart hardwire kit. Otherwise, it may cause a malfunction.

Option 2: Motion Detection

To use this feature, you need to connect it with a Rexing Intelligent Hardwire Kit (sold separately).

- Make sure that the Parking Mode Is turned off on your dash cam, otherwise it may cause a malfunction.

Once the sensor has detected MOTIONS. The intelligent hardwire kit will power up the dash cam automatically and start recording until the MOTION is cleared.

Wi-Fi Connect

Step 1

With your dash cam powered on, hold the REC navigation button to enable the Wi-Fi function. The Wi-Fi name (aka the SSID) and password for the dash cam should be displayed on-screen.

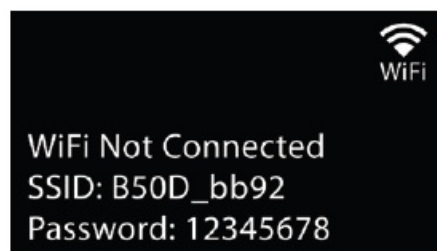

Step 2

- On your mobile device, navigate to your Wi-Fi settings. Connect to your dash cam's Wi-Fi by tapping its name

when it appears. Enter your dash cam's Wi-Fi password if you are prompted to do so.

- **Note:** On some mobile devices, you may have to try to connect more than once. To ensure you've successfully connected, your mobile device's screen should resemble the examples shown.



Step 3

- Once you're connected to the dash cam, open the Rexing Connect app on your mobile device.
- Please select "Keep Trying Wi-Fi" if you see the notification on the right.



Step 4

- In the app, hit the "Connect" button to connect to your dash cam, allowing you to access live view and view/download your recordings.
- **Note:** Hold to the REC button for 2 seconds to disconnect the Wi-Fi.

Rexing Connect App

Easily download the app by scanning the QR code below or search via the App Store or Google Play



Wi-Fi Connect Troubleshooting

If you bring up the Rexing Connect app and cannot connect your phone to the dash cam please go to <https://www.rexingusa.com/wifi-connect/> OR scan the QR code below.



GPS Logger

(Need to purchase separately)

- When connected to the camera, it will record the speed and location of your vehicle as you drive.
- The dash cam will automatically search for the GPS signal once it's connected to the power source.
- You can then access this information while playing back your recordings using the GPS Video player. For Windows and Mac, available at <http://www.rexingusa.com/support/rexing-apps/>.



- Press the MENU button twice and enter the System Settings.
- Toggle to the GPS Speed Unit setting and select your preferred speed unit.
- After a GPS signal is found, the screen icon will turn from blue to green.
- Please visit gpsa.rexingusa.com to watch a video tutorial.



GPS Date-Time Troubleshooting

- If your dash cam GPS date and time are incorrect please go to <https://www.rexingusa.com/gps-date-time/>
OR scan the QR code below.



Taking Photo

- To take a photo, stop video recording and toggle to the Photo Mode. Press the OK Button to take a photo.
- To view a photo, stop video recording and toggle to the Playback Mode. Press the REC and MIC Buttons to toggle through your photos.

Toggle to the Playback mode and select a photo to view



- To delete a photo, stop video recording toggle to the Playback Mode and toggle through the videos and photos to the one you want to delete. Press the MENU button once and toggle to the Delete option. Press the OK Button and select Delete Current or Delete All.

Toggle to the Delete option



Choose the desired option

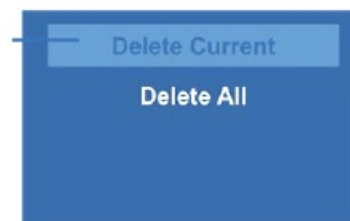

Warranty & Support

Warranty

The Rexing VI P Plus Dash Cam comes with a full 12-month warranty. If you register your product on our official site (<https://www.rexingusa.com/support/registration>), you can extend the warranty to 18 months.

Support

If you have any questions regarding your product, please do not hesitate to contact us at care@rexingusa.com, or call us at (877) 7 40-8004. Queries are typically answered within 12-24 hours.

Your opinion matters

- Rexing is firmly committed to always improving our products, services, and user experience. If you have any thoughts on how we can do even better, we welcome your constructive feedback and suggestions.
- Connect with us today at care@rexingusa.com.

Thank you for choosing Rexing!

FCC STATEMENT

FCCID: 2AW5W-V1P-4K

This device complies with part 15 of the FCC Rules. Operation is subject to the following two conditions:

1. This device may not cause harmful interference, and
2. This device must accept any interference received, including interference that may cause undesired operation.

Changes or modifications not expressly approved by the party responsible for compliance could void the user's authority to operate this equipment.

MADE IN CHINA.

Documents / Resources

	<p>REXING V1P Plus 4K UHD Front and Rear Dash Cam with Wi-Fi [pdf] User Guide V1P Plus 4K UHD Front and Rear Dash Cam with Wi-Fi, V1P Plus, 4K UHD Front and Rear Dash Cam with Wi-Fi, Front and Rear Dash Cam with Wi-Fi, Rear Dash Cam with Wi-Fi, Dash Cam with Wi-Fi, Cam with Wi-Fi, Wi-Fi</p>
---	---

References

- [User Manual](#)

[Manuals+](#), [Privacy Policy](#)

This website is an independent publication and is neither affiliated with nor endorsed by any of the trademark owners. The "Bluetooth®" word mark and logos are registered trademarks owned by Bluetooth SIG, Inc. The "Wi-Fi®" word mark and logos are registered trademarks owned by the Wi-Fi Alliance. Any use of these marks on this website does not imply any affiliation with or endorsement.