



# REXING V1P-4K Front and Rear dash Cam with Wi-Fi User Guide

[Home](#) » [Rexing](#) » REXING V1P-4K Front and Rear dash Cam with Wi-Fi User Guide 

## Contents

- 1 REXING V1P-4K Front and Rear dash Cam with Wi-Fi
- 2 Overview
- 3 What's in the box
- 4 Camera Overview
- 5 Screen Icons
- 6 installation
- 7 Basic Operation
  - 7.1 Device Power
  - 7.2 Menu Settings
  - 7.3 Parking Monitor
- 8 Wi-Fi Connect
- 9 GPS Logger
- 10 Taking Photos
- 11 Documents / Resources
  - 11.1 References
- 12 Related Posts



**REXING V1P-4K Front and Rear dash Cam with Wi-Fi**



## Overview

### Thank you for choosing REXING!

We hope you love your new products as much as we do. If you need assistance, or have any suggestions to improve it, please contact us.

[care@rexingusa.com](mailto:care@rexingusa.com)

DI (877) 740-8004

Our support team will respond you as soon as possible.

Always a surprise in Rexing.

**Check us out here**

- <https://www.facebook.com/rexingusa/>
- <https://www.instagram.com/rexingdashcam/>
- <https://www.rexingusa.com/support/registration/>
- <https://www.rexingusa.com/support/product-support/>



Facebook



Instagram



Site



Product Support



## What's in the box

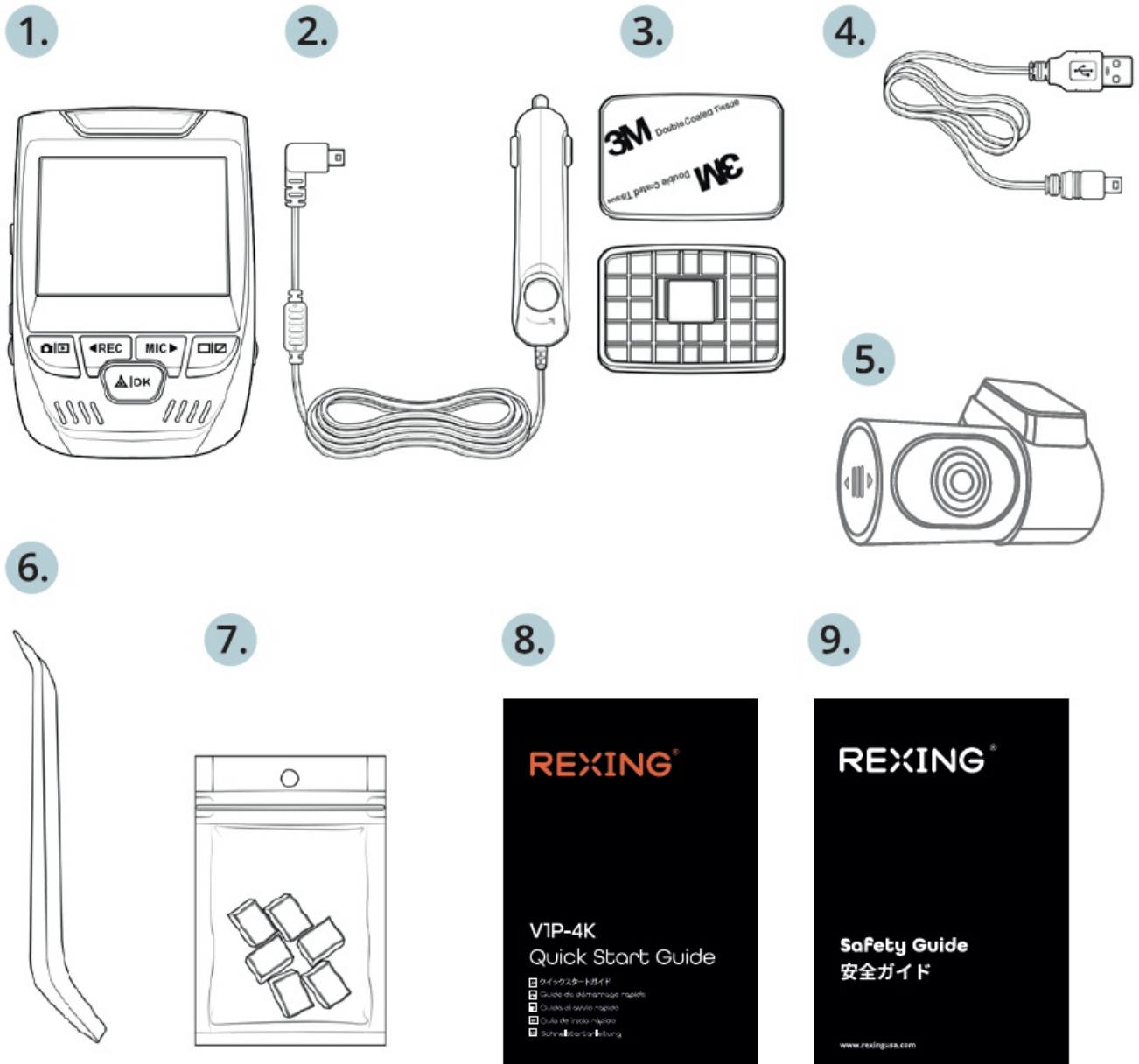

1. Rexing V1 P-4K Dash Cam
2. car Charger
3. Mount Plate & 3M Adhesive
4. Mini-USB (able
5. Rear Camera
6. Cable management tool
7. Cable Clips©
8. Quick Start Guide
9. Safety Guide

## Camera Overview

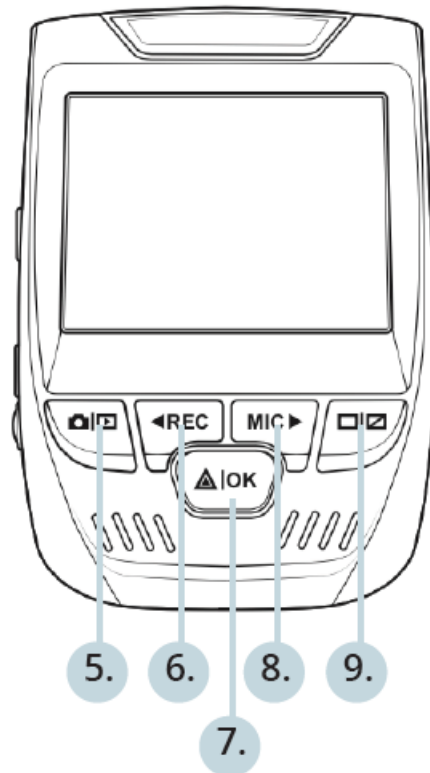
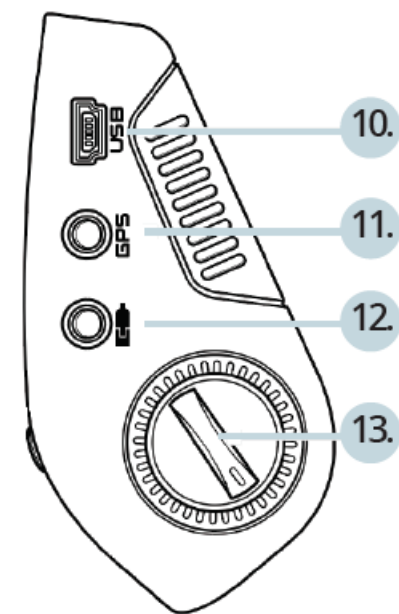
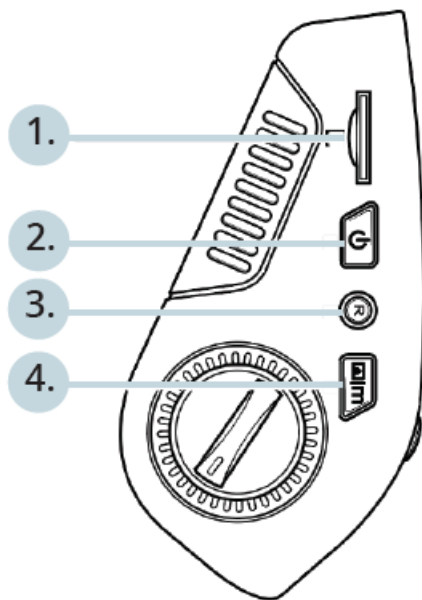

1. Micro SD Card Slot
2. Power Button
3. Reset Button
4. Menu Button
5. Mode Button
6. REC (Record) Button \*
7. OK (Confirm) Button \*\*
8. MIC (Microphone) Button \*\*\*
9. Screen Button
10. Mini-USB Port
11. GPS Logger Port
12. Rear Camera Port
13. Lens Angle Adjustment

1. Micro SD Card Slot
2. Power Button
3. Reset Button
4. Menu Button
5. Mode Button
6. REC (Record) Button \*
7. Ok (Confirm)
8. MIC (Microphone) Button
9. Screen Button
10. Mini-USB Port
11. GPS Logger Port
12. Rear Camera Port
13. Lens Angle Adjustment

## Screen Icons

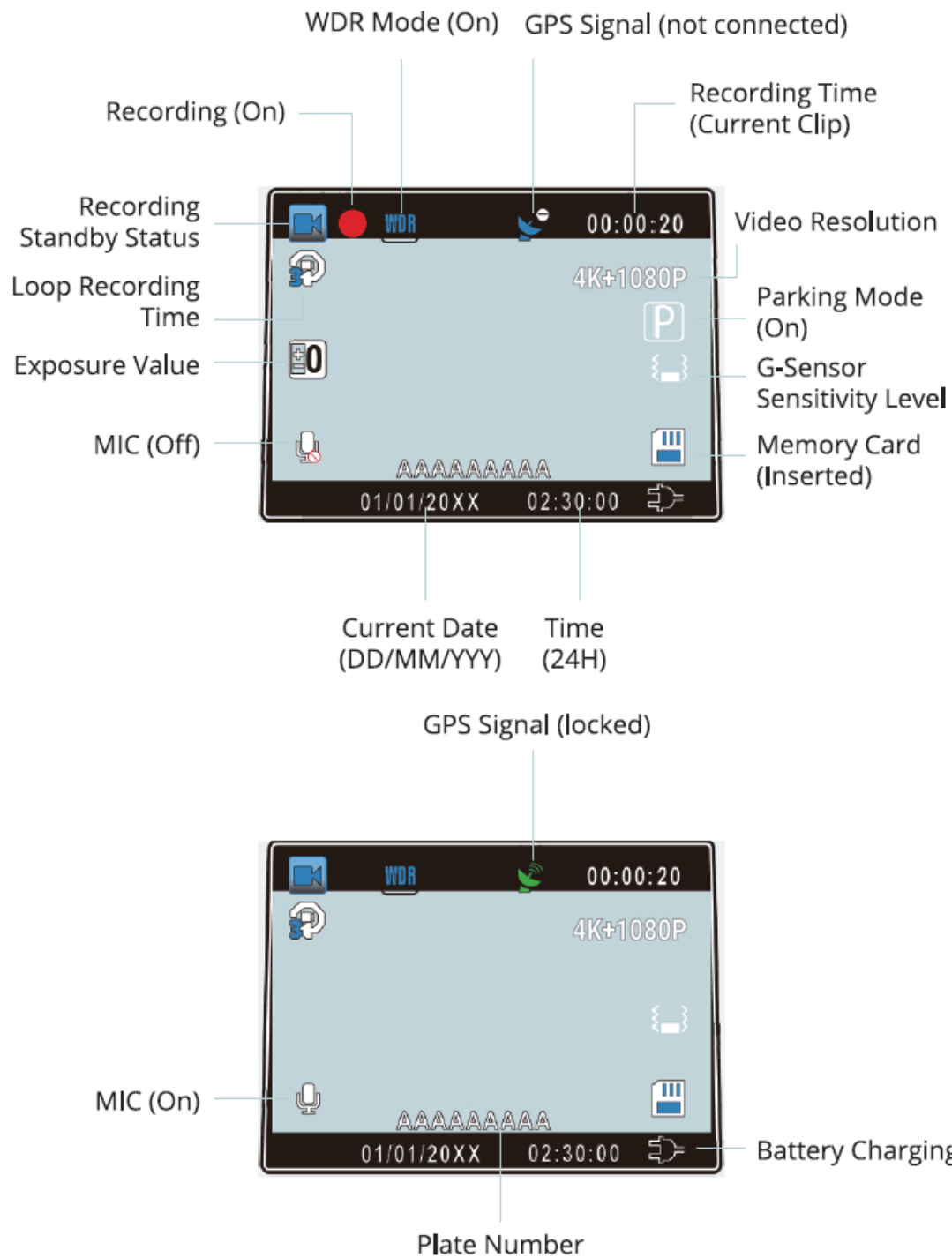

## installation

### Step 1: Install the Dash Cam

Place the 3M tape on the Mount and properly orient the Mount square to the roof and hood line of the vehicle. Important! Ensure the T-interlock on the Mount is oriented in the correct direction. Firmly press the Mount onto the windshield. Wait at least 20 minutes before mounting the camera.

Orientation mount as shown

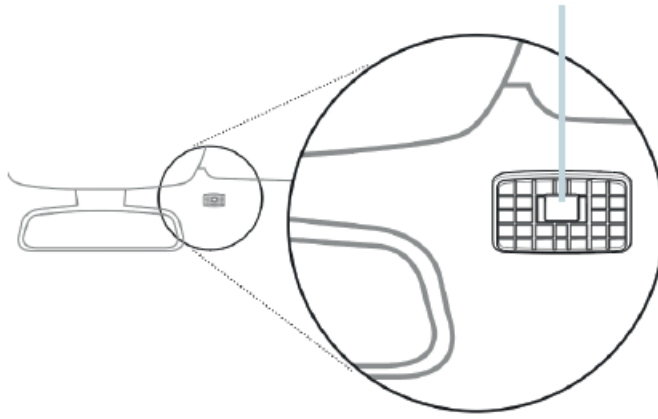

### Step 2: Insert the memory Card

The Rexing V1 P-4K accepts [Class 10/ UHS-1 or higher] Micro SD memory cards up to 256GB. You will need to insert a memory card before you can begin recording. Before inserting or removing a memory card, first ensure you've powered down the device.

Gently push the memory card in until you hear a click, and allow the spring release to push the card out.

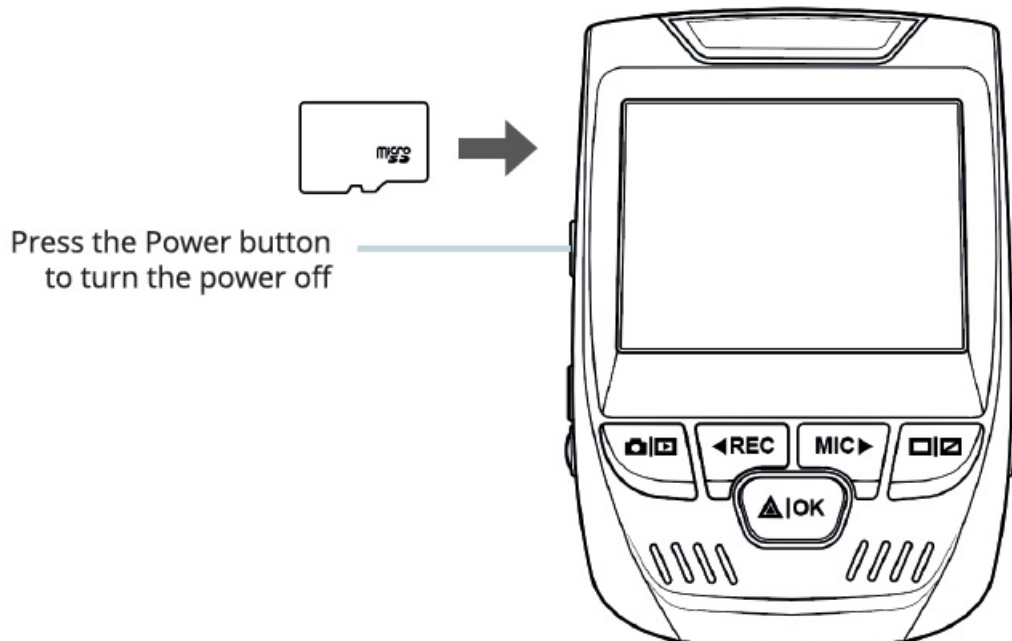

### Step 3: Power the Camera and Format the memory Card

Power the camera by connecting the charger to the car cigarette lighter and camera.

To ensure the V1 P-4K records to your memory card properly and without error. Before you start using a new memory card, you must format the card within the camera using the format function. Always backup important data stored on the memory card before formatting.

To format the memory card, make sure you have inserted your memory card, then turn on the device by connecting to a power source. Press REC to stop recording. Then press the MENU button twice to enter the System Setup Menu. Use the REC and MIC buttons and go to the Format setting. Press the OK Button to confirm the selection.

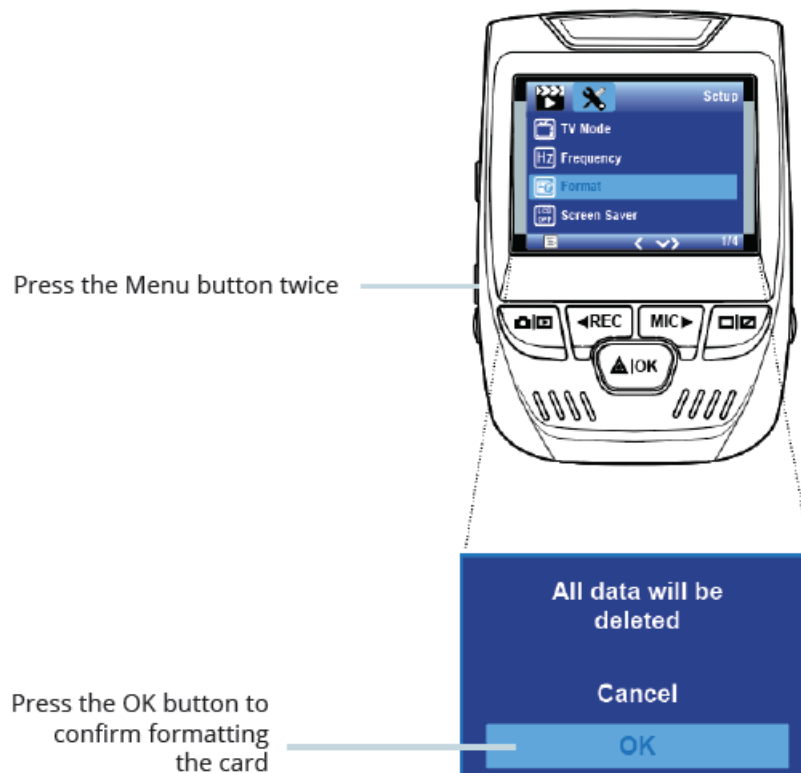
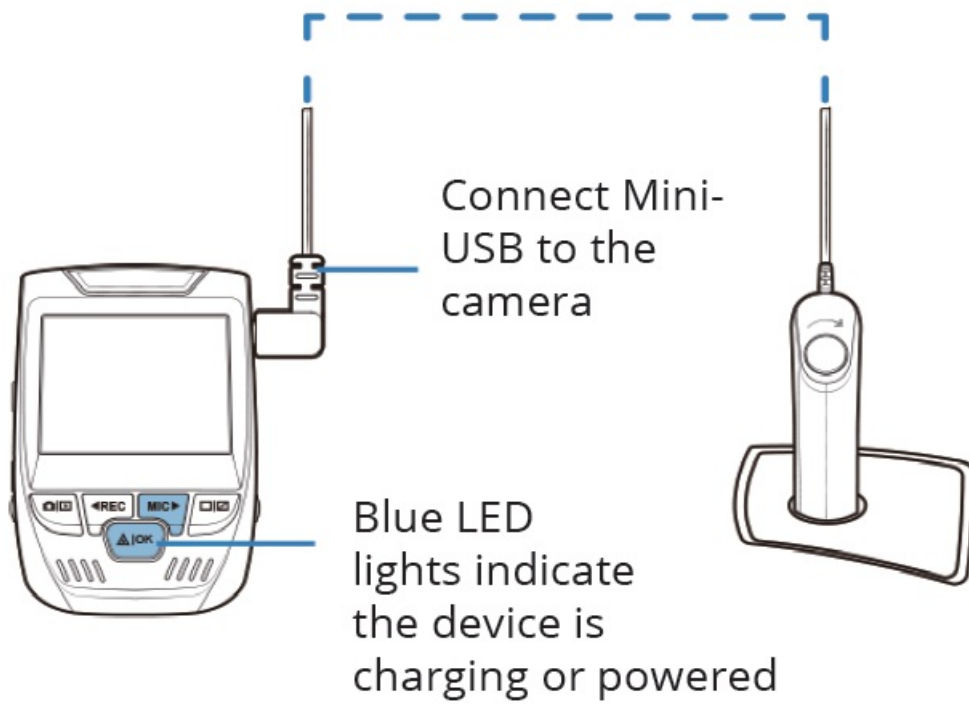

#### Step 4: Mount the Rear Camera

Mount the rear camera as shown below. Use the provided rear camera cable to connect the rear camera to the front camera.

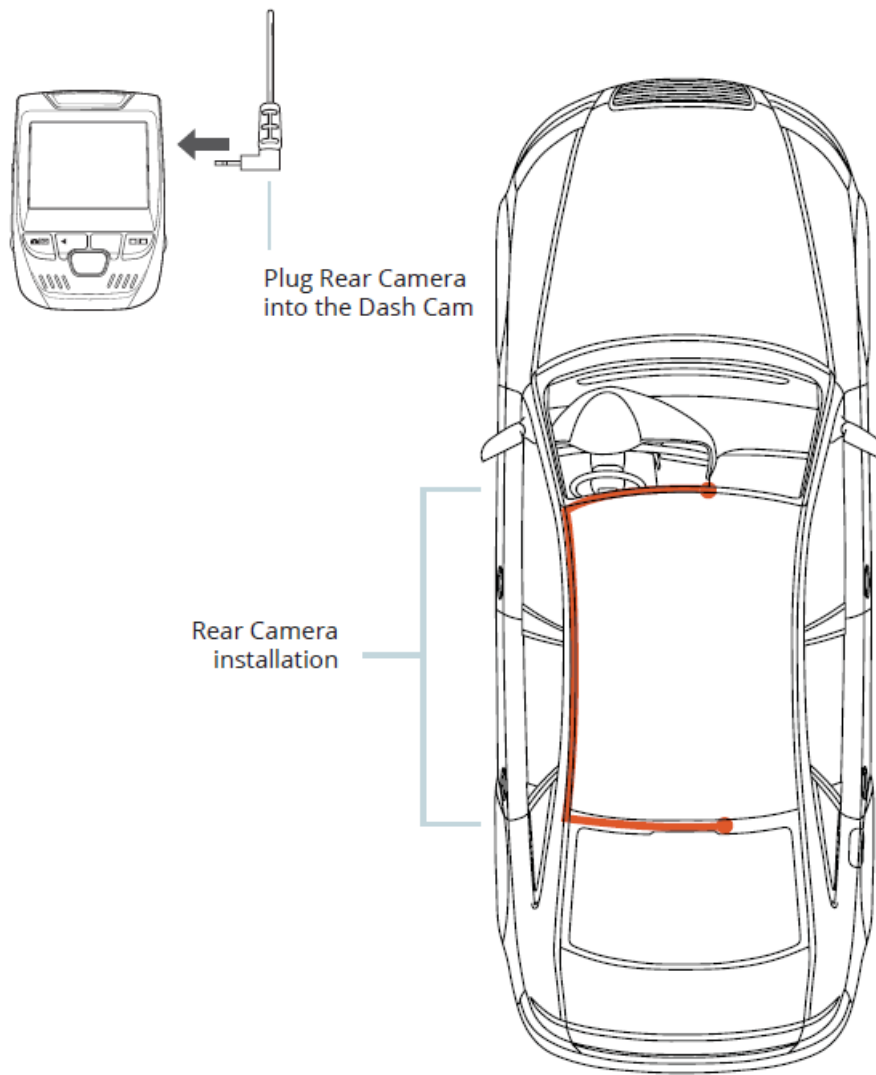

#### **Step 5: Installing the Camera onto the Windshield**

Place the camera on the mount and carefully route the power cable around the windscreen and tuck in under the trim.

Plug the Car Charger Cable into a 12V DC power outlet or the car cigarette lighter.

Connect car charger to the camera. The camera will auto-start recording once powered on.



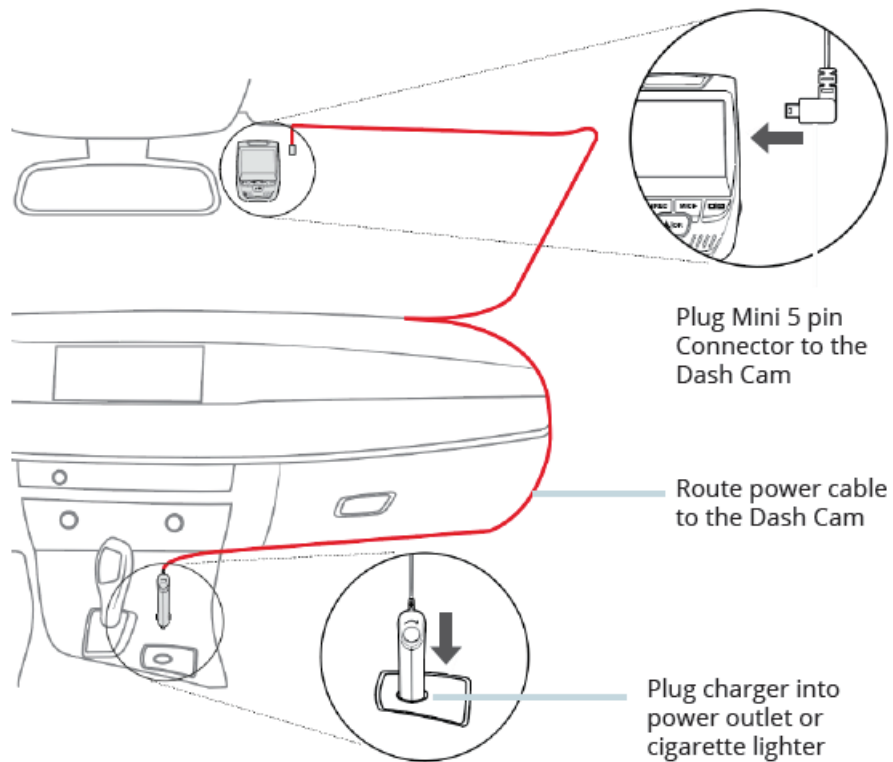

## Basic Operation

### Device Power

The device is automatically powered on when plugged into a 12V accessory socket or cigarette lighter and receives a charge (i.e.: the vehicle is started.)

To turn the device on manually, press and hold the button until the welcome screen appears. The camera will automatically start recording when powered on.

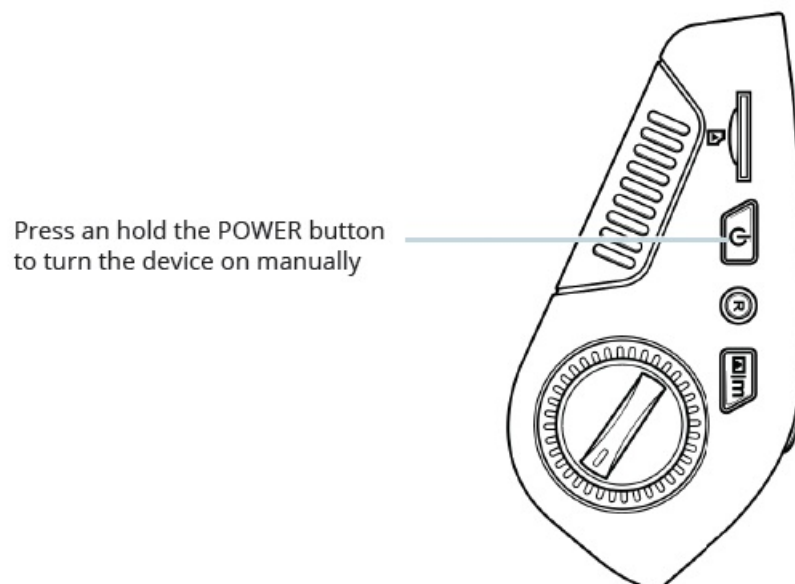

### Menu Settings

Power the camera on. If the camera is recording, press the REC button to stop recording. Press the button and toggle to the desired mode.

Press the button once to enter the settings menu for a Mode. Press the MENU button twice to enter the System Settings.

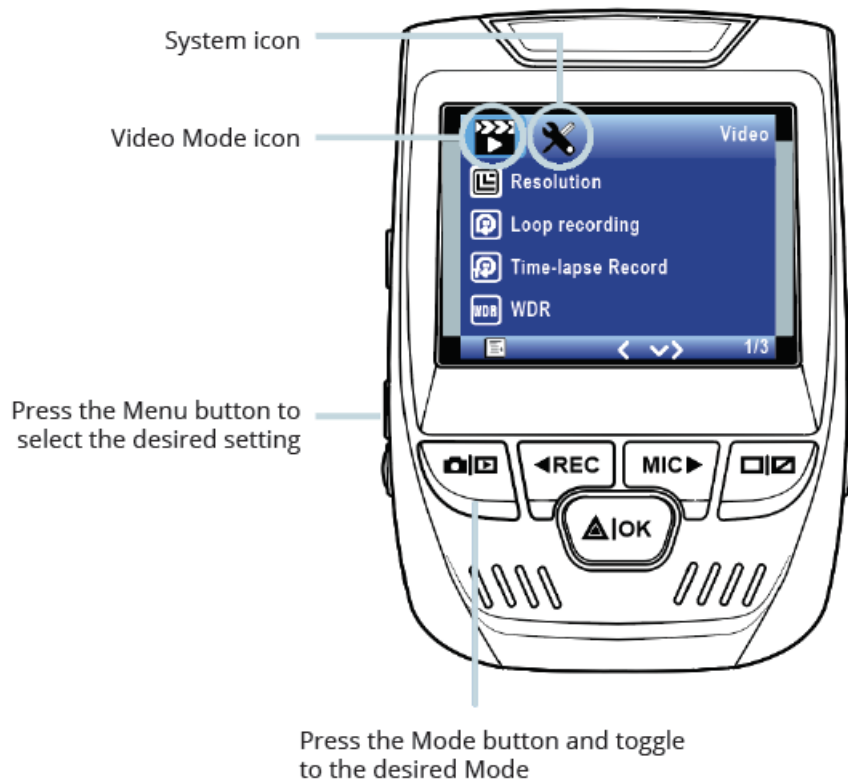

### Video Recording

The camera will automatically start recording when the device receives a charge. The LED lights and the red dot will blink when the device is recording. Press the button to stop recording.



### Video Playback

Playback of videos can be done on the device or a computer. Also, if you have purchased a Rexing GPS Logger you may play back the recordings in a specialized application.



Control playback with these buttons

During playback use the (pause), (fast forward) and (rewind) buttons to control the video playback.

To playback a video on the computer either use an SD card adapter or connect the device to the computer directly using the USB to Mini B 5pin male cable.

#### To playback a video using

an SD card adapter, remove the memory card and insert it into an SD card adapter. Place the adapter in the computer.

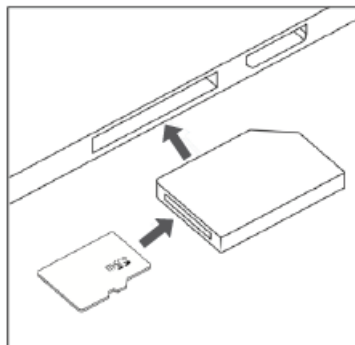

**To playback a video using USB cable,** connect the USB Cable to the device and the computer. After the device powers up, press the Button to select Mass Storage.

On the computer, navigate to device drive. The videos are stored at: \CARDV\ MOVIE. Select the video to playback.

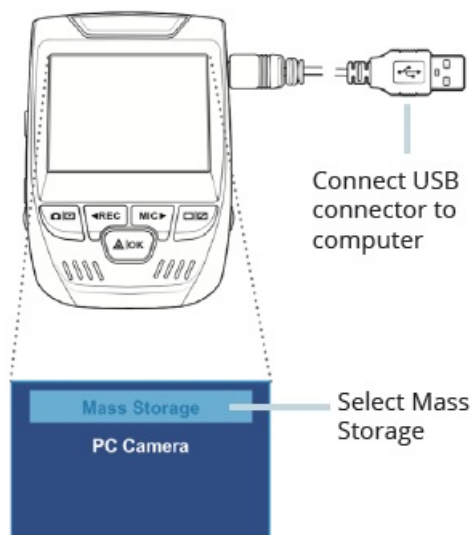

## Parking Monitor

Connect the dash cam to the smart hardware kit to activate the parking monitor function (Need to purchase the smart hardware kit separately).

Please visit [support.rexingusa.com](http://support.rexingusa.com) to watch a video tutorial.

## Wi-Fi Connect

Download “Rexing Connect” app from the App Store/Google Play Store.

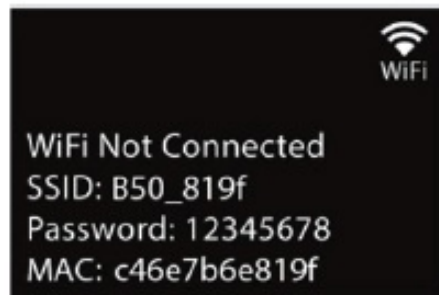
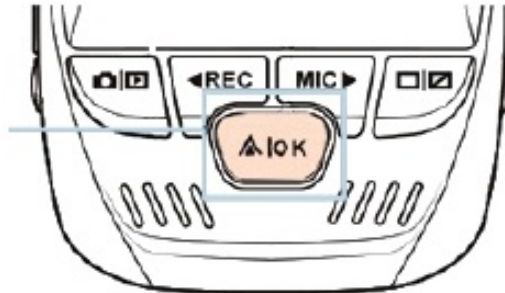

1. To access or exit the Wi-Fi feature, hold down OK .
2. Open Wi-Fi settings on from the list, tap to connect.(Default password: 12345678)
3. Open the Rexing Connect App, tap “Connect to enter realtime video streaming page.
4. Once connected, the dash cam screen will switch to the camera view and will display “Wi-Fi Connect” message.

Using the Rexing Connect app, you can view a live preview of the dash cam screen, start/stop recording, as well as view and save your captures with your mobile device.

For further instruction regarding the Wi-Fi Connect feature,

## GPS Logger

GPS Signal  
(not connected)



(Need to purchase separately)

When connected to the camera, it will record the speed and location of your vehicle as you drive.

You can then access this information while playing back your recordings using the GPS Video player (For Windows and Mac, available at [rexingusa.com](http://rexingusa.com)).

Press the button twice and enter the System Settings.

GPS Signal  
(active)



Toggle to the GPS Speed Unit setting and select your preferred speed unit.

After a GPS signal is found, the screen icon will turn from blue to green.

Please visit [gpsa.rexingusa.com](http://gpsa.rexingusa.com) to watch a video tutorial.

## Taking Photos

Toggle to the Playback mode and select a photo to view



Toggle to the Delete option



Choose the desired option

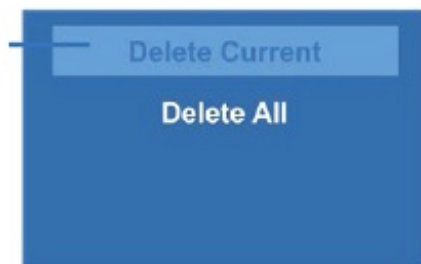

**To take a photo**, stop video recording and toggle to the Photo Mode. Press the OK Button to take a photo.



**To view a photo**, stop video recording and toggle to the Playback Mode. Press the REC and MIC Buttons to toggle through your photos.

**To delete a photo**, stop video recording and toggle to the Playback Mode and toggle through the videos and photos to the one you want to delete. Press the MENU button once and toggle to the Delete option. Press the OK Button and select Delete Current or Delete All.

## Documents / Resources

	<p><a href="#">REXING V1P-4K Front and Rear dash Cam with Wi-Fi</a> [pdf] User Guide</p> <p>V1P-4K, Front and Rear dash Cam with Wi-Fi</p>
--	--

References

-  [GPS Player Type A](#)
-  [Rexing USA | Your Roadside Eyewitness](#)
-  [Product Support | Rexing USA](#)