



REXING S3 Dash Camera User Manual

[Home](#) » [Rexing](#) » REXING S3 Dash Camera User Manual 

REXING S3 Dash Camera User Manual



Contents

- [1 About Us](#)
- [2 What's in the box](#)
- [3 Camera Overview](#)
- [4 Installation](#)
- [5 Basic Operation](#)
- [6 Warranty & Support](#)
- [7 FCCID:](#)
- [8 Documents / Resources](#)
 - [8.1 References](#)
- [9 Related Posts](#)

About Us

Thank you for choosing REXING!

We hope you love your new products as much as we do. If you need any assistance, or have any suggestions to help us improve, please contact us.



care@rexingusa.com



(877) 740-8004

Our support team will respond to you as soon as possible.
Always a surprise in Rexing.

- <https://www.facebook.com/rexingusa/>
- <https://www.instagram.com/rexingdashcam/>
- <https://www.rexingusa.com/support/registration/>
- <https://www.rexingusa.com/support/product-support/>



Facebook



Instagram



Site





Product Support



What's in the box

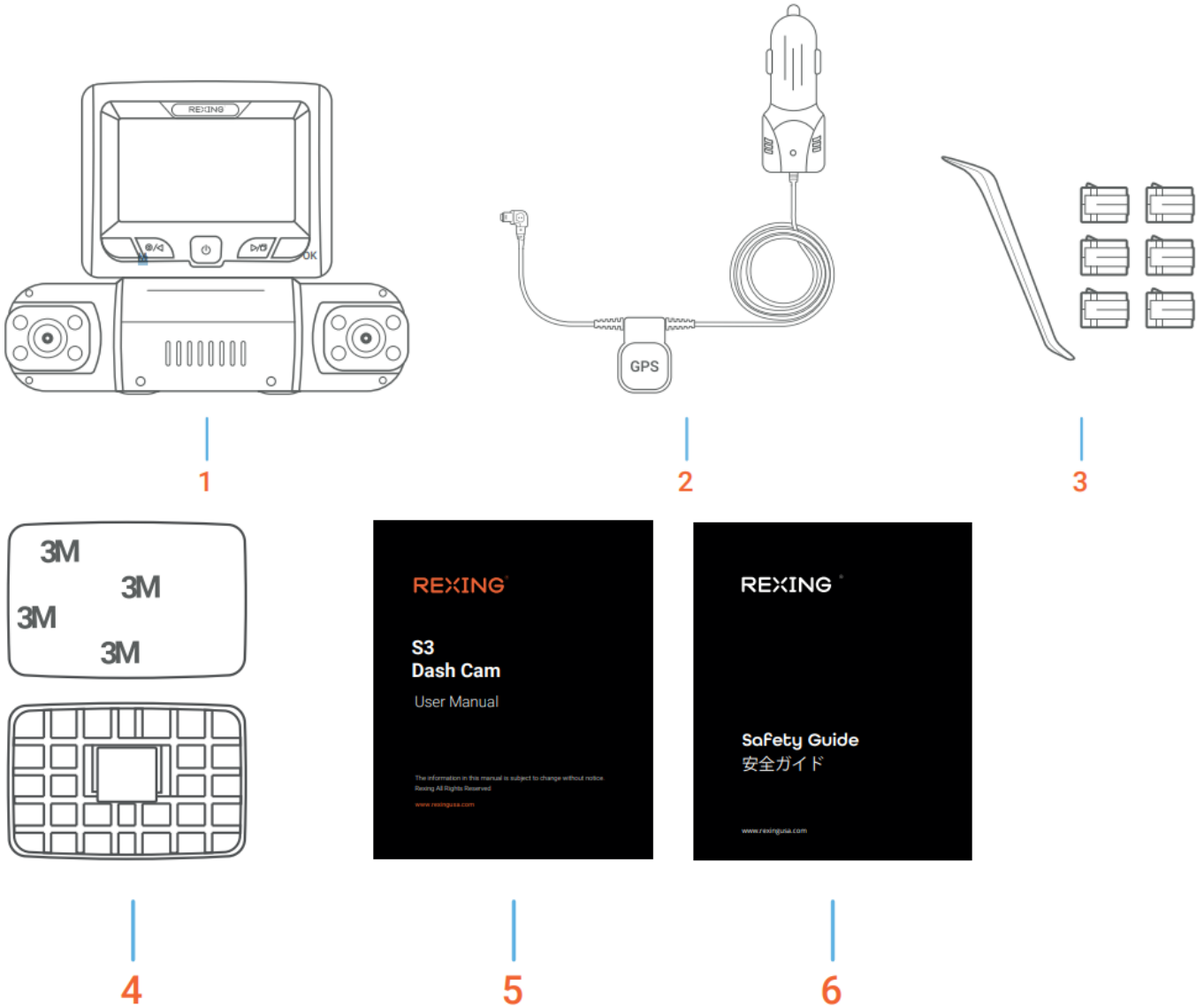

1. Rexing S3 3-Channel Dash Cam
2. Power Cable with GPS Logger (12ft)
3. Cable Management Kit
4. Adhesive Mount
5. User Manual
6. Safety Guide

Camera Overview

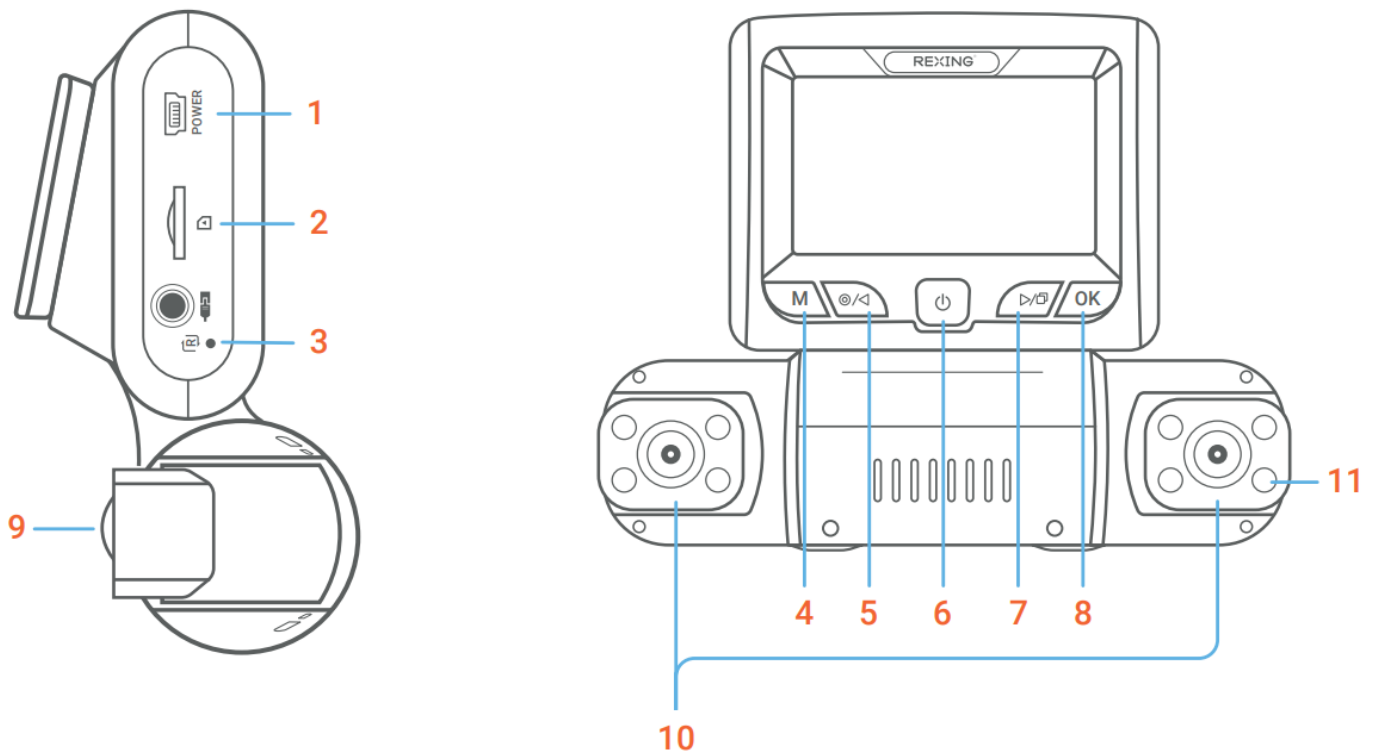

1. Power Port
2. Micro SD Card Slot
3. Reset Pin Hole
4. Menu Button, Mode Switch Button
5. Record Button, Photo Button, Up Button
6. Power Button, Screen Button
7. Screen-view Switching, Audio Button, Down Button
8. Confirm Button, Video Lock Button, Wi-Fi Button
9. Rotating Front Camera (90°)
10. Rotating Rear/Cabin Cameras (180° horizontal and 270° vertical)
11. Infrared Lights

Button	Function
	<ul style="list-style-type: none"> • Press to turn on or turn off the screen • Press and hold for 3 seconds to turn the device on or off



- Press to confirm a selection in settings
- Lock a Video: Press to manually lock / unlock a video file while recording
- Press and hold for about 3 seconds to turn on/off the Wi-Fi



- Please press the Record Button to stop recording first.
- Press once/twice to switch between Video Settings and General Settings; press and hold for 3 seconds to exit settings
- Press and hold for 3 seconds to switch between video recording and playback modes
- In the playback mode, press to switch among the three cameras' footages



- Press to navigate UP through the options in settings
- Press to start / stop video recording
- Press and hold for about 3 seconds to take a photo



- Press to navigate DOWN through the options in settings
- Press this button to switch among three camera's views
- Press and hold for 3 seconds to turn on/off the audio



Use a pin and press it **for 5 seconds to reset the device** back to the manufactures' default settings

Screen Icons

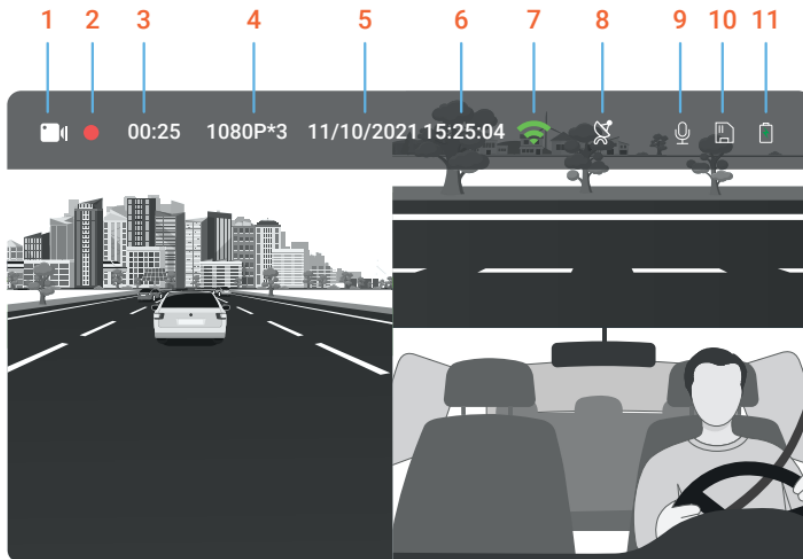

1. Recording Mode
2. Recording Indicator
3. Recording Time
4. Resolution
5. Date
6. Time
7. Wi-Fi Signal
8. GPS Signal
9. Microphone
10. SD Card
11. Power Indicator

Installation

Step 1

Installing Adhesive Mount

Place the 3M adhesive on the mount plate and properly orient the mount piece to the roof and hood line of the vehicle.

Important! Ensure the T-interlock on the mount is oriented in the correct direction.

Firmly press the mount onto the windshield. **Wait at least 20 minutes before mounting the camera.**

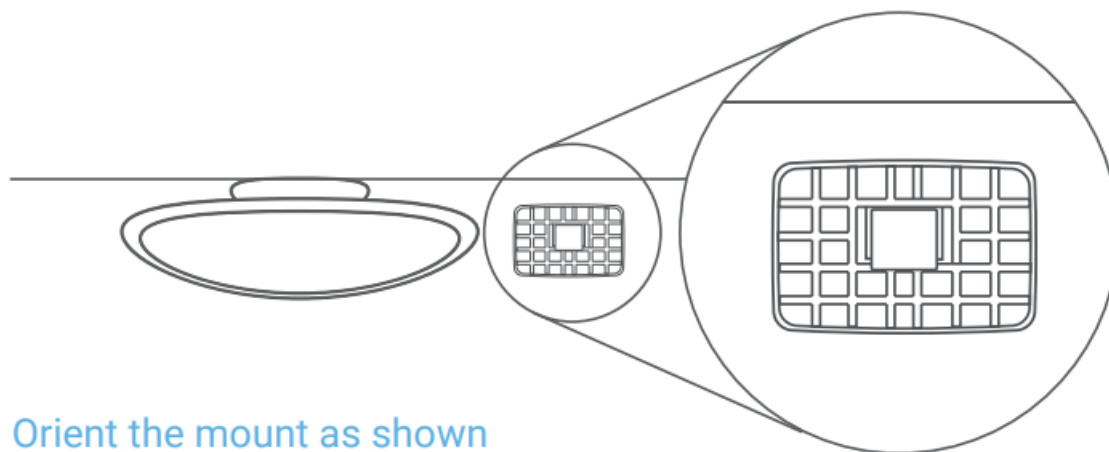

Orient the mount as shown

Step 2

Mount the Rear Camera

Mount the rear camera as shown below. Use the included rear camera cable to connect the rear camera to the front camera.

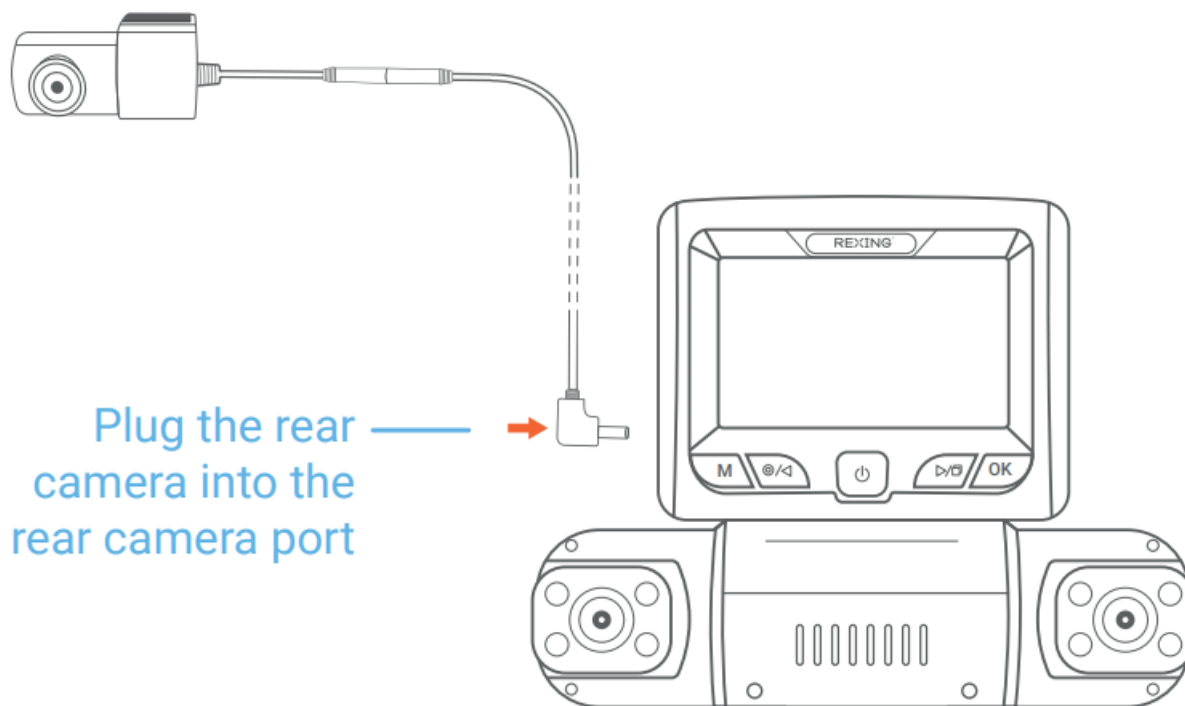

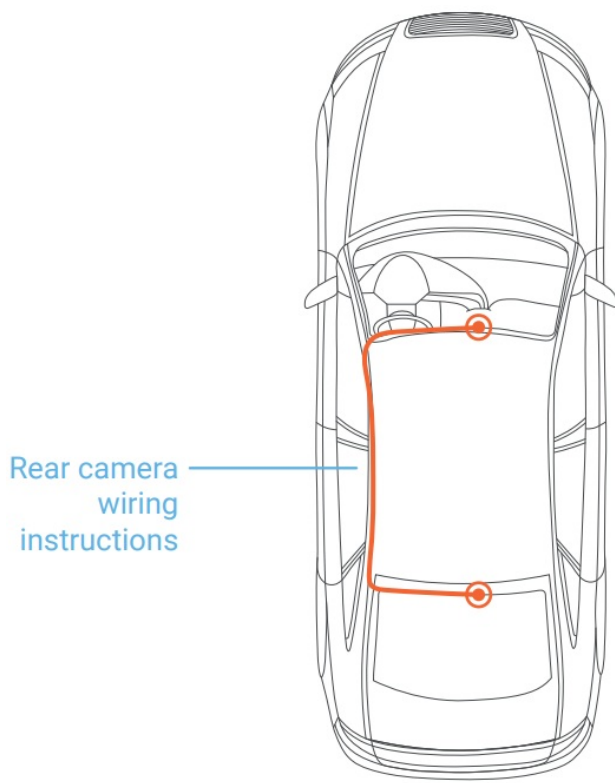

Step 3

Insert the Memory Card

The Rexing S3 accepts Class 10/ UHS-1 or higher Micro SD memory cards up to 256GB. You will need to insert a memory card before recording. **Before inserting or removing a memory card, ensure you've powered down the device.**

Gently push the memory card in until you hear a click, and allow the spring release to push the card out.

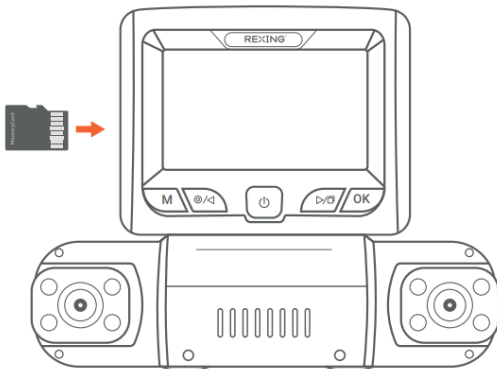

Step 4

Power on the Camera and Format the Memory Card

Place the camera on the mount and carefully route the power cable around the windshield and tuck it in under the trim.

Power the camera by connecting the charger to the car cigarette lighter and the camera.

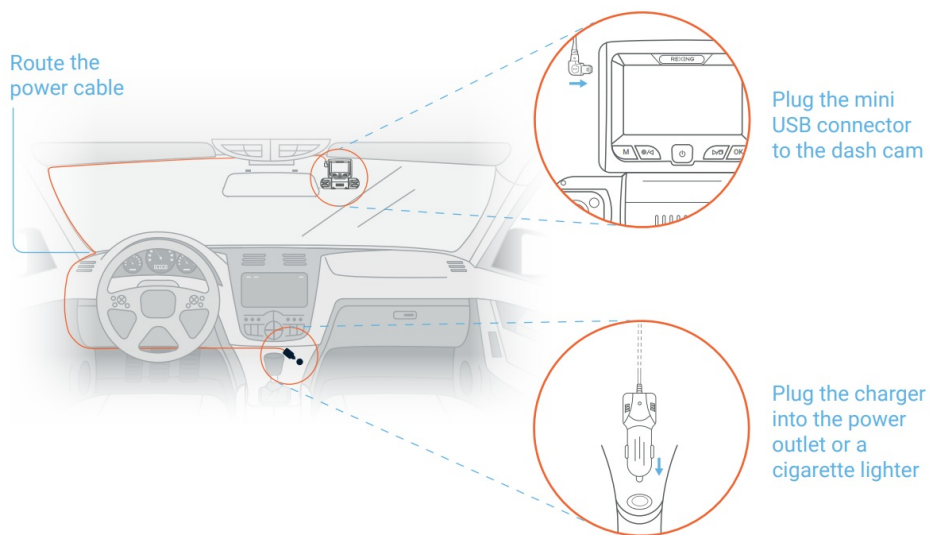

The camera will shut down after 3 seconds when it's disconnect from the power source and it should begin recording automatically the next time it is powered on.

To ensure the S3 records to your memory card properly and without error, we strongly recommend you **to format the card within the camera when you're using the dash cam for the first time.**

Note:

Always remember backup important data stored on the memory card before formatting.

To format the memory card, first press the **REC** button to stop recording. Then press the **MENU** button twice to enter the Setup Settings. Use the **REC** and MIC buttons and toggle to the Format. Press the **OK** button to confirm the format.

Press the **MENU** button twice

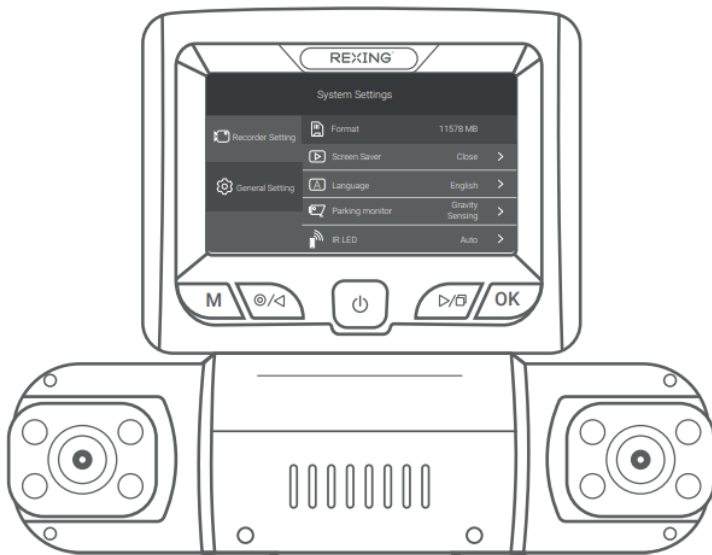

Press the **OK** button to confirm formatting the memory card

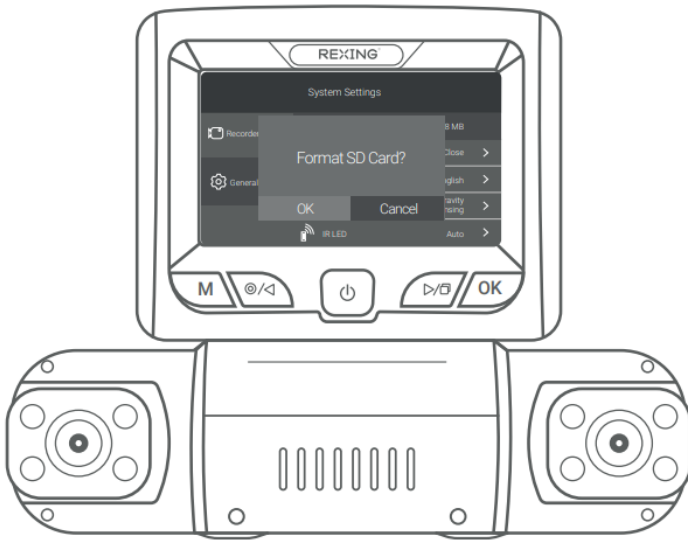

Basic Operation

Video Playback

To playback a video on the device, press the **Record** button to stop recording. Press and hold the Mode button to enter the playback mode. Use the the **Up** and **Down** buttons to toggle to the desired video. Press the **OK** button to play. During playback, use the **OK** (pause), **Up** (rewind) and **Down** (fast forward) buttons to control the video playback.

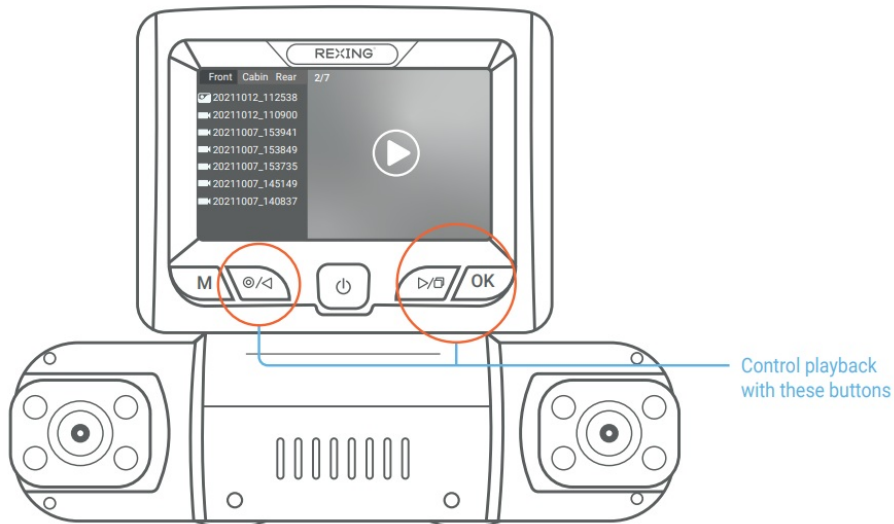

To playback a video by using an SD card adapter, remove the memory card and insert it into an SD card adapter. Place the adapter in the computer.

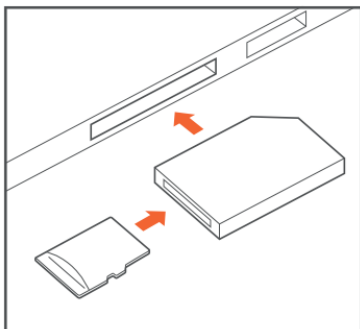

Menu Settings

Loop Recording

With loop recording mode enabled, the device will continuously erase the oldest video once the memory card reaches the storage limit. The video will be recorded and kept with the user-selected time range.

Loop Recording
1 Minute
2 Minute
3 Minute
Off

Time Lapse Record

The time lapse record can be selected in 1FPS/2FP

Timelapse record
Off
1FPS
2FPS
4FPS

Gravity Sensing

If a change in gravitational forces is detected, such as in the event of a vehicular accident, the G-Sensor will send a signal to the dash cam and automatically place a file lock on the current video. Which will preserve your most crucial footage.

Note:

Locked video files won't be erased by Loop Recording, they will remain on the memory card until they are manually deleted, or when the card is formatted.

Gravity Sensing
High
Middle
Low
Close

Date Stamp

You have the option to display the date and time in your videos. Note that the date and time stamp cannot be removed from videos if this feature was enabled at the time of recording.

Recording Audio

You may choose to record audio with video, or turn off the microphone so that all recorded videos will be muted.

Alternatively, you can press and hold the **Audio** button for about 3 seconds to mute/unmute the microphone for

video recording.

Exposure

Adjust the camera exposure value for brighter or darker recorded video, according to your preference.

Exposure
-3
-2
-1
0
1

Light Frequency

This option should be set according to the power supply specification used in your country or geographical region (**U.S. users should select the “60Hz” option**).

Screen Saver
10 Seconds
30 Seconds
1 Minute
Close

You may also press the **Power** button to turn the screen on/off.

Language

Use the following procedure to change the device’s language.

Language
English
Français
Español
Português
Deutsch

Parking Monitor (Parking Surveillance Mode)

Parking monitor provides surveillance on your parked vehicle. When the engine is off, the hardwire kit is used to provide continuous power and protect your car battery from being discharged.

Option 1: Vibration Detection

To enable the Parking Monitor, you’ll need to connect it with the Smart Hardwire Kit (ASIN B07RN24B7V, sold

separately).

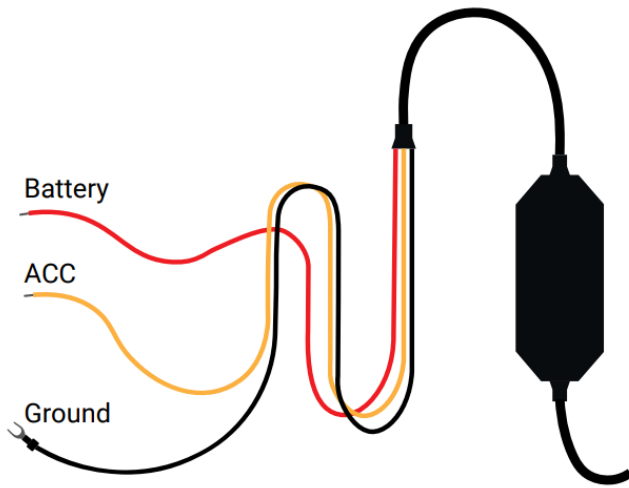

This feature will allow the dash cam to switch to parking mode automatically if the vehicle's engine turns off and switch back to the normal recording after the vehicle's engine turns on.

Please go to <https://www.rexingusa.com/support/videos/> to watch a video tutorial about the installation.

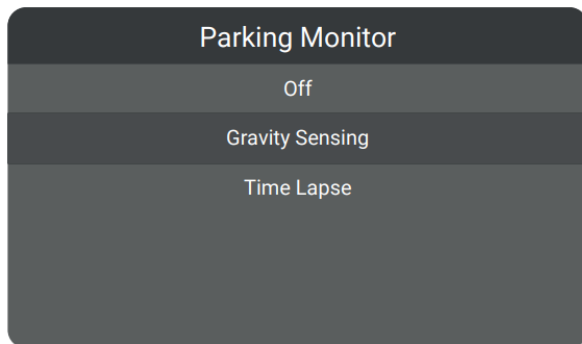

There are 2 options under parking mode:

We recommend using the Time Lapse option.

- **Time Lapse Record:**

Record video in one frame per second to conserve memory and reduce the time it takes to review video.

- **Gravity Sensing Record:**

The Gravity Sensing detects significant or sudden movement (such as an impact or collision), it will trigger an event recording. We suggest setting the "Gravity Sensing" to High sensitivity for Parking Mode Recording.

Note:

If you do not use the parking mode function, please change the Gravity Sensing sensitivity to low. Otherwise, the video will easily be locked and the video cannot be deleted by the loop recording function. This will cause the memory card to be full of locked videos and cause the recorder to fail to work normally.

Option 2: Motion Detection

To use this feature, you need to connect it with an Intelligent Hardwire Kit (ASIN B0973MBCT8, sold separately). Make sure that the Parking Mode is turned off on your dash cam.

Once the sensor has detected MOTIONS. The intelligent hardwire kit will powerup the dash cam automatically

and start recording until the MOTION is cleared.

IR LED

Use the following procedure to turn on or off the infrared lights.

System Volume

Increase or decrease the volume of your dash cam.

Key Sound

Allows you to turn the device's button sound effect on or off.

Date and Time

Use the following procedure to change the device's time and date.

Set Time Zone

Use the following procedure to change the device's time zone

Set Time Zone
GMT-09:00 Alaska
GMT-08:00 LosAngeles
GMT-07:00 Arizona
GMT-06:00 Chicago
GMT-05:00 New York

GPS Speed Unit

Use the following procedure to change the GPS speed unit.

The GPS logger is integrated on the power cable, which allows you to view your speed and location when you playback your recordings using the GPS video player.

After a GPS signal is found, the screen icon will turn from blue to green.

Please visit <https://www.rexingusa.com/support/videos/> to watch a video tutorial.

Download a GPS Video player

Please download GPS logger player through <https://www.rexingusa.com/support/-mobile-downloads/gps-player-type-b/> OR Scan the QR Code below.



Wi-Fi

With the dash cam built-in Wi-Fi, you can use your smart device as a remote camera, viewfinder, and download

files to your phone. Please disconnect the Wi-Fi connection first if you want to operate on the dash cam.

1. Press the Record button to stop recording
2. Press the Menu button twice to enter General Settings
3. Press the Up or Down button to toggle to Wi-Fi
4. Press the OK button to turn it on/off
5. Press and hold the Menu button for 3 seconds to exit.

You can also press and hold the OK button for about 3 seconds to turn on/off the Wi-Fi feature.

Downloading the Wi-Fi App



Download Rexing Connect app from the App Store or Google Play or scan the QR code below.



Pairing the camera to your device

Turn on Wi-Fi on the dash cam and the SSID and password will be shown as below.

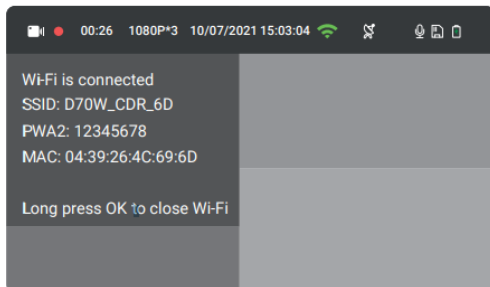

Open Settings on your phone (make sure that the Wi-Fi has turned on) and find the SSID in the network list, then enter the default password 12345678 to connect. Once it's connected, the Wi-Fi icon on the dash cam screen will turn to green.

Open the **Rexing Connect** app and press connect to complete the pairing.



Restore Factory Settings

Performing this operation will reset all of your device's settings to their original values.

Note:

Any user-customized settings will be lost.

Warranty & Support

Warranty

The Rexing S3 Dash Cam comes with a full 12-month warranty. If you register your product on our official site <https://www.rexingusa.com/support/registration>, you can extend the warranty to 18 months.

Support

If you have any questions regarding your product, please do not hesitate to contact us at care@rexingusa.com, or call us at **(877) 740-8004**. Queries are typically answered within 12-24 hours.

Your opinion matters

Rexing is firmly committed to always improving our products, services, and user experience. If you have any thoughts on how we can do even better, we welcome your constructive feedback and suggestions. Your opinion matters

Connect with us today at care@rexingusa.com

Thank you for choosing Rexing!

FCCID:

This device complies with part 15 of the FCC Rules. Operation is subject to the following two conditions:

1. This device may not cause harmful interference, and
2. this device must accept any interference received, including interference that may cause undesired operation.





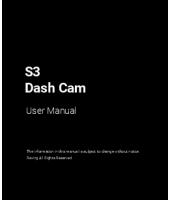

Changes or modifications not expressly approved by the party responsible for compliance could void the user's authority to operate this equipment.



Documents / Resources

	<p>REXING S3 Dash Camera [pdf] User Manual S3, Dash Camera, S3 Dash Camera, Camera</p>
---	--

References

-  [Rexing USA | Your Roadside Eyewitness](#)
-  [Yuhe Sun \(@rexingdashcam\) • Instagram photos and videos](#)
-  [Product Support | Rexing USA](#)
-  [Rexing USA](#)
-  [Rexing USA](#)
-  [Videos | Rexing USA](#)