



RETROFLAG 64Pi Case for Raspberry Pi5 SD Card Storage Instruction Manual

[Home](#) » [RETROFLAG](#) » RETROFLAG 64Pi Case for Raspberry Pi5 SD Card Storage Instruction Manual 

RETROFLAG 64Pi Case for Raspberry Pi5 SD Card Storage



Contents

- [1 Impotent Information](#)
- [2 Install heat sinks](#)
- [3 Parts](#)
- [4 Assemble](#)
- [5 Documents / Resources](#)
- [5.1 References](#)
- [6 Related Posts](#)

Impotent Information

- Please be careful when handling the parts.

It is not our responsibility for any damage caused in use.

Waining: Please make sure there is NO MicroSD inserted before assembling.

- 2.4G WiFi might be affected by the environment and USB 3.0, recommend use 5G WiFi or wired connect to network.

Install heat sinks

Step 1

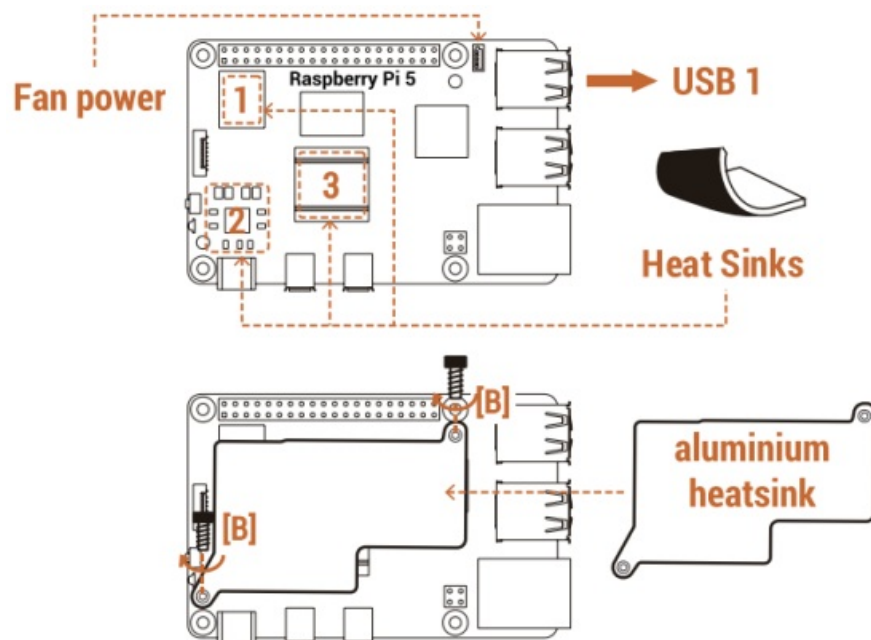

Parts

- (A)
(PB 2.5 X 5) * 4



(B)
(PW1.7x5) *2



(C)
(PB 2 x 7) *2



(D)
(PB 2 x 18) *2



1. (12.5 x 9.9 x 1) * 1



2. (16.5 x 11.7 x 2) * 1



3. [19 x 19 x 1] *1



[Fan] (30 x 30 x 7) *1



(Screwdriver) * 1



(aluminium heatsink) * 1



Assemble

Step 2

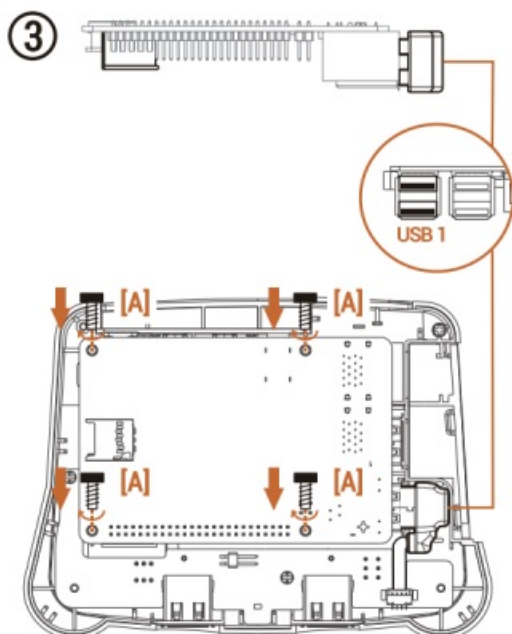
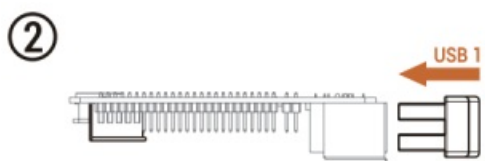
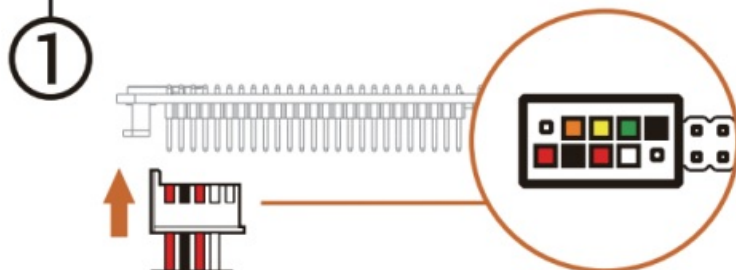
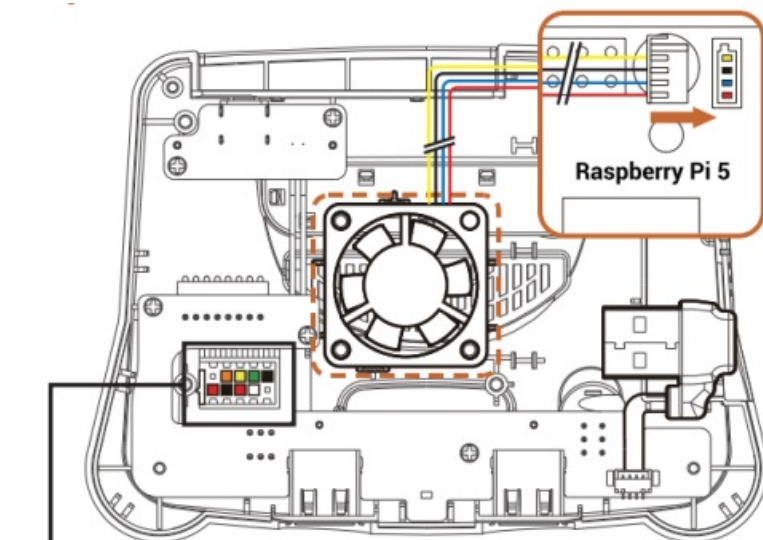

4

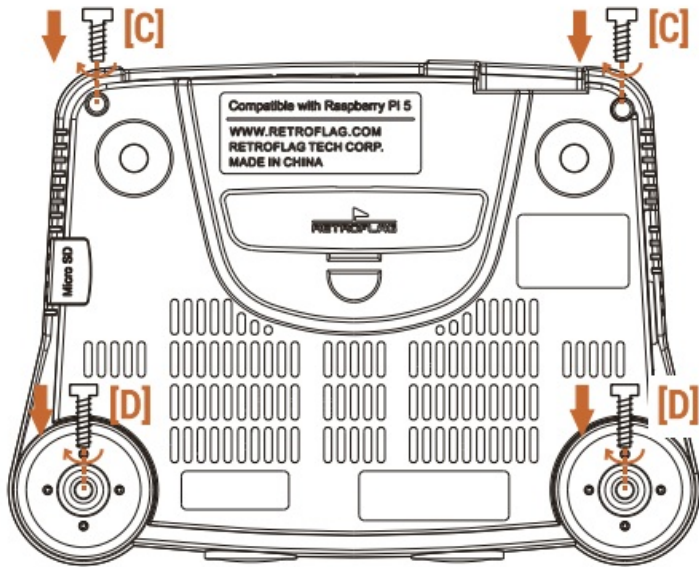

Documents / Resources

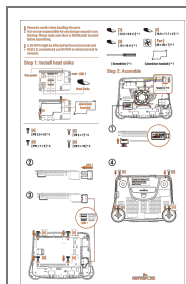

[RETROFLAG 64Pi Case for Raspberry Pi5 SD Card Storage](#) [pdf] Instruction Manual
64Pi, 64Pi Case for Raspberry Pi5 SD Card Storage, Case for Raspberry Pi5 SD Card Storage,
Raspberry Pi5 SD Card Storage, SD Card Storage, Storage

References

- [User Manual](#)

[Manuals+](#), [Privacy Policy](#)

This website is an independent publication and is neither affiliated with nor endorsed by any of the trademark owners. The "Bluetooth®" word mark and logos are registered trademarks owned by Bluetooth SIG, Inc. The "Wi-Fi®" word mark and logos are registered trademarks owned by the Wi-Fi Alliance. Any use of these marks on this website does not imply any affiliation with or endorsement.