



RETEKESS T118 Wireless Calling System User Manual

[Home](#) » [RETEKESS](#) » RETEKESS T118 Wireless Calling System User Manual 

RETEKESS T118 Wireless Calling System Manual

Contents

- [1 Functional Diagram](#)
- [2 Parameter](#)
- [3 Instructions for use](#)
- [4 Avoid Choking Hazard](#)
- [5 Safety Operation](#)
- [6 Documents / Resources](#)
- [7 Related Posts](#)

Functional Diagram

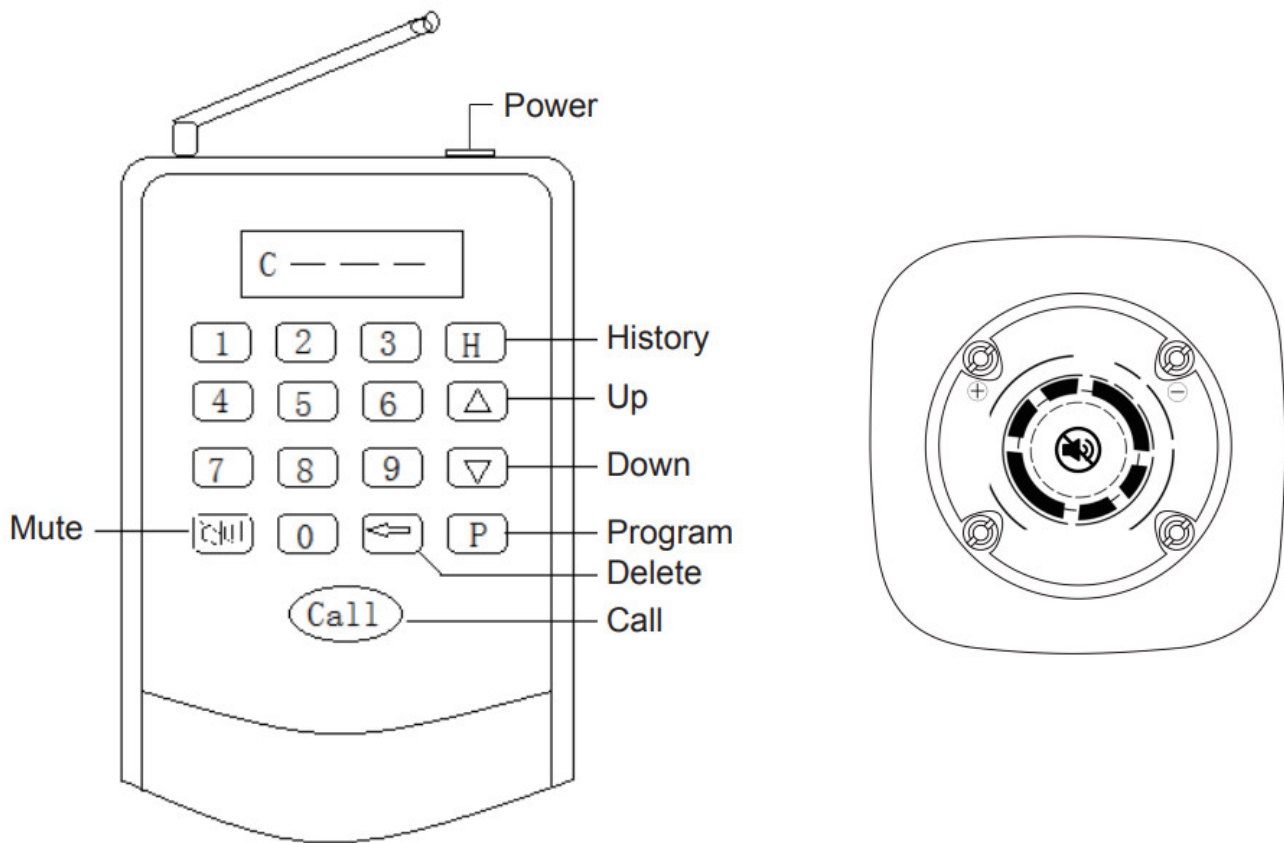

Parameter

Host		Pager	
Power input	DC5V/3A	Operating Voltage	3.7V
Transmitting frequency	433.92MHz	Receiving frequency	433.92MHz
Transmit power	13dBm	Stand-by current	30mA
Standby power	150mW	Standby duration	10h
Button mode	Mechanical button	Receiving sensitivity	-115dBm
Max number of pagers	998	Transmission distance	500m-800m
Shell material	ABS	Prompt mode	Vibration / buzzer / flashing light
Dimensions	110*165*50mm	Reminder time	The 30s
Number of charging pagers	10	Charger Power	DC 5V/3A

Instructions for use

1. Preparation for use

Connect the power supply of the transmitter, put the pagers on the charging base, and connect the power source. After charging for 10 minutes, then start to program.

2. Program

When all the pagers are under power charging, press P, the screen will display "p—" then press "999" and press CALL, all pagers will be flashing to show program state.

Note: we must input P999 within 20 seconds in the charging state.

Input a number, and press CALL. For example in input 98, the host displays P098. Then press CALL, all numbers on charging pagers will change to 98 and flash. Move the top pager away from the base, the pager will long beep, and number 98 stops flashing. The program is done.

Repeat the above operation to program other pagers.

If no operation within 1 minute, the device will quit the program state. 1 pager can program 1 number only, a new number will replace the old one.

3. Use

Input number and press CALL, the corresponding pager will alarm to remind. If input wrong numbers, press to delete.

Pressing the DELETE button several times will return to calling mode.

4. Charging reminder:

The red light flashes in the charging state. When the RED light turns to always-on, it shows the pager is fully charged

Silent mode

Buttons pressed	Display on LCD	Function	Remark
MUTE+999+CALL	S999	All charging pagers change to SILENT Mode	Pagers must in charging state
MUTE+000+CALL	S000	All charging pagers change to NORMAL Mode	Pagers must in charging state

In SILENT mode, pagers vibrate and flash only when receiving a call, no beep. Pagers not in the charging state will not change mode.

Pressing the DELETE button several times will return to calling mode.

Call history

Press H. the LCD displays H and the last call number. Press UP/DOWN to check the last 10 number records. Pressing the DELETE button several times will return to calling mode.

Warnings

	Before using this radio, read the user manual for proper usage and RF emissions regulations.
---	--

Local Government Regulations

When the radios are used as a consequence of employment, the Local Government Regulations requires users to be fully aware of and able to control their exposure to meet occupational requirements. Exposure awareness can be facilitated by the use of a product label directing users to specific user awareness information. Your Reteless radio has an RF Exposure Product Label. Also, your user manual or separate safety booklet includes information

and operating instructions required to control your RF exposure and to satisfy compliance requirements.

Compliance with RF Exposure Standards (If appropriate, reference to the actual product's Safety Marking)

Your Reteless radio is designed and tested to comply with a number of national and international standards and guidelines (listed below) for human exposure to radiofrequency electromagnetic energy.

FCC ID

The FCC ID means: This radio complies with the IEEE (FCC) and ICNIRP exposure limits for occupational/controlled RF exposure environments at operating duty factors of up to 50% talk•50% listen and is approved for occupational use only.

This device complies with Part 15 of the FCC Rules. Operation is subject to the following two conditions:

- This device may not cause harmful interference, and
- This device must accept any interference received, including interference that may cause undesired

Warning: Changes or modifications not expressly approved by the party responsible for compliance could void the user's authority to operate the equipment.

NOTE

This equipment has been tested and found to comply with the limits for a Class B digital device, pursuant to Part 15 of the FCC Rules. These limits are designed to provide reasonable protection against harmful interference in a residential installation. This equipment generates uses and can radiate radio frequency energy and, if not installed and used in accordance with the instructions, may cause harmful interference to radio communications. However, there is no guarantee that interference will not occur in a particular installation. If this equipment does cause harmful interference to radio or television reception, which can be determined by turning the equipment off and on, the user is encouraged to try to correct the interference by one or more of the following measures:

- Reorient or relocate the receiving antenna.
- Increase the separation between the equipment and receiver.
- Connect the equipment into an outlet on a circuit different from that to which the receiver is connected.
- Consult the dealer or an experienced radio/TV technician for help.



The CE marking means: Hereby, Henan Eshow Electronic Commerce Co., Ltd. declares that the radio equipment type is in compliance with the RED Directive 2014/53/EU and the ROHS Directive 2011/65/EU, and the WEEE Directive 2012/19/EU.

The full text of the EU declaration of conformity is available at the following internet address: www.retekess.com

IC ID

This device complies with Industry Canada license-exempt RSS standard(s). Operation is subject to the following two conditions:

- This device may not cause interference. and

- This device must accept any interference, including interference that may cause undesired operation of the device.

In terms of measuring RF energy for compliance with these exposure guidelines, your radio generates measurable RF energy only while it is transmitting (during talking), not when it is receiving (listening) or in standby mode.

Avoid Choking Hazard



Small Parts. Not for children under 3 years.



WARNING Protect your hearing

- Use the lowest volume necessary to do your job.
- Turn up the volume only if you are in noisy surroundings.
- Turn down the volume before adding a headset or earpiece.



WARNING Turn off your radio power in the following conditions

- Turn off your radio before removing (installing) a battery or accessory or when charging the battery.
- Turn off your radio when you are in a potentially hazardous environment: Near electrical blasting caps, in a blasting area, in explosive atmospheres (inflammable gas, dust particles, metallic powders, grain powders, etc.).
- Turn off your radio while taking on fuel or while parked at gasoline service stations.



WARNING To avoid electromagnetic interference and/or compatibility conflicts

- Turn off your radio in any facility where posted notices instruct you to do so, hospitals or health care facilities (Pacemakers, Hearing Aids, and Other Medical Devices) may be using equipment that is sensitive to external RF energy.
- Turn off your radio when onboard an aircraft. Any use of a radio must be in accordance with applicable regulations per airline crew instructions.

Avoid Burns



WARNING Antennas

- Do not use any portable radio that has a damaged antenna. If a damaged antenna comes into contact with the skin when the radio is in use, a minor burn can result.

Batteries (If appropriate)

- When the conductive material such as jewelry, keys, or chains touch exposed terminals of the batteries, may complete an electrical circuit (short circuit the battery) and become hot to cause bodily injury such as burns. Exercise care in handling any battery, particularly when placing it inside a pocket, purse, or another container with metal objects

Long transmission (If appropriate)

- When the transceiver is used for long transmissions, the radiator and chassis will become hot.

Safety Operation



WARNING Forbid

- Do not use charger outdoors or in moist environments, use only in dry locations/conditions.
- Do not disassemble the charger, that may result in a risk of electrical shock or fire.
- Do not operate the charger if it has been broken or damaged in any way.
- Do not place a portable radio in the area over an airbag or in the airbag deployment area. The radio may be propelled with great force and cause serious injury to occupants of the vehicle when the airbag inflates.

To reduce risk

- Pull by the plug rather than the cord when disconnecting the charger.
- Unplug the charger from the AC outlet before attempting any maintenance or cleaning.
- Contact Retekeess for assistance regarding repairs and service.

EU Importer

Name Germany Retevis Technology GmbH

Address Uetzenacker 29,38176 wendeburg

Documents / Resources

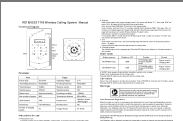
	<p>RETEKESS T118 Wireless Calling System [pdf] User Manual T118, Wireless Calling System, T118 Wireless Calling System</p>
---	--