

[Skip to content](#)

[Manuals+](#)

User Manuals Simplified.

RETEKESS T116A Queue Wireless Calling System User Manual

[Home](#) » [RETEKESS](#) » RETEKESS T116A Queue Wireless Calling System User Manual



RETEKESS

Queue Wireless Calling System

User Manual
T116A

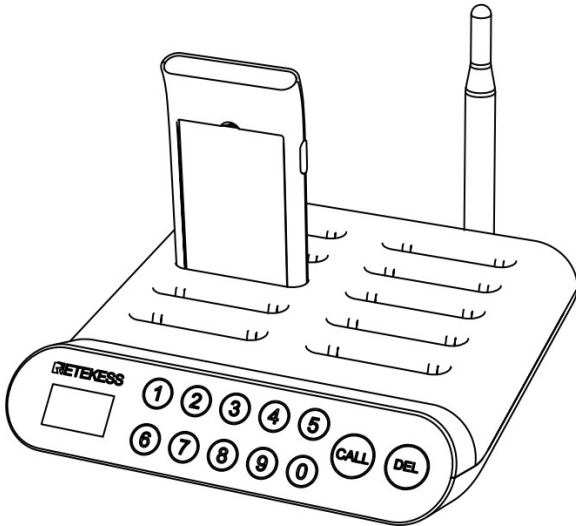

Contents [hide](#)

- [1 Product introduction](#)
- [2 The diagram of transmitting host](#)
- [3 The diagram of the receiver](#)
- [4 Technical data](#)
- [5 Packing List](#)
- [6 Operation instruction](#)
- [7 Function Description](#)
- [8 Pairing method](#)
- [9 Reminder mode switching](#)
- [10 Change Stickers](#)
- [11 Precautions](#)
- [12 FCC Requirements:](#)
- [13 Precautions](#)
- [14 CE Requirements:](#)
- [15 IC Requirements:](#)
- [16 RF Exposure Information](#)
- [17 Guarantee](#)
- [18 Documents / Resources](#)
- [19 Related Posts](#)

Product introduction

Thanks for using our company's wireless calling system, it adopts RF wireless technology. The system consists of 1 transmitting host and 10 portable receivers, the receiver supports 998-channel extensions, the transmitting host has 10 battery charging slots. Each receiver is rechargeable and labeled with a number, in standby status, it is plugged into the charging slots, while the guest places an order, he/she will be dispatched one receiver with a number when the order is ready, the waiter will press the keypad to call the number, the guest will get it through the buzzer/vibration/LED indications.

The queue system greatly improves the work efficiency and avoids the guest waiting in a long queue. It is widely used in fast-food restaurants, churches, dessert shops, auto 4S shops, food trucks,s or other queue occasions.

The diagram of transmitting host

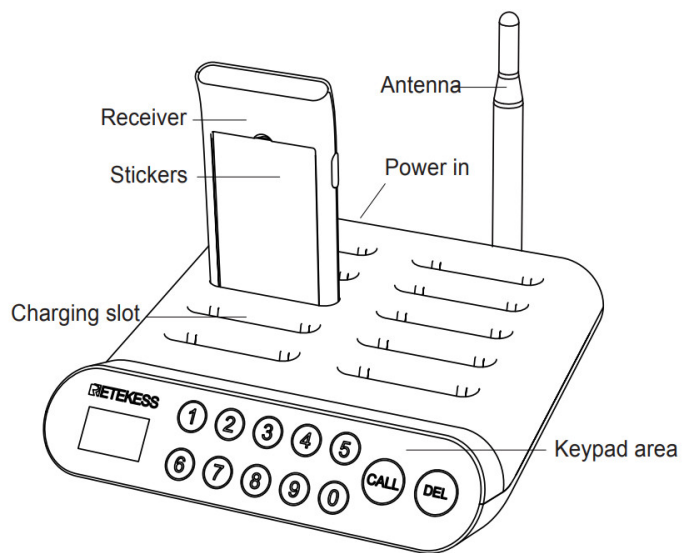

The diagram of the receiver

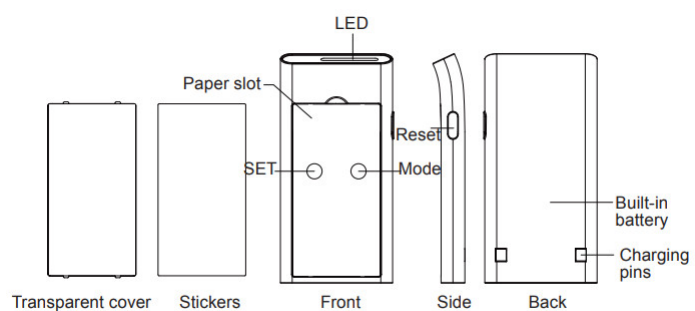

Technical data

Receiver	
Working voltage	DC 3.7V (Rechargeable battery)
Working frequency	433MHz
Standby current	10mA
Standby Time	r.-20 Hour
Receive sensitivity	-110 dBm
Battery capacity	300mAh
Decoder	Learning code (AM)
Dimensions	106*52*11mm

Transmitting host

Power input	DC 12V/1A
working frequency	433MHz
Transmit Power	360mW
Encoder	Learning code (AM)
Dimension	180*160*35mm

Packing List

Name	Quantity
Transmitting host	1 pc
Antenna	1 pc
Receiver	10 pcs
Power adaptor	1 pc
User manual	1 pc
Stickers	10pcs
Transparent cover	1 Optics

Operation instruction

1. Open the package, connect the mainframe power on, and perform the self-test procedure.
2. When the guest placed an order, the service staff give him or her a receiver and write down the
3. While the order is ready, the waiter press keypad to call the guest (number), the corresponding receiver gets the information and prompts vibration/buzzer/light for 30 sec, reminding the guest to get the
4. At last, the guest returns the receiver to the waiter and the service is

Function Description

1. Connected to the power supply through the power adapter, the host digital screen displays “000”, inserts the receiver into the charging slot of the host, the receiver automatically turns on and charges and the red light of the receiver indicator is always on.
2. After the receiver is fully charged, the indicator light will be turned to Green from
3. After the receiver is taken out, the receiver enters the waiting call state, the indicator light shows blue and flashes once every 3s.
4. When the host calls, the receiver receives the call inform Alert by vibrating, buzzing and blue lights flashing every 0.5s.
5. The receiver reminding time is 30 sec. The guest can short press the side button of the receiver to close the reminder or insert the host charging slot to close the

6. The receiver in the charging process, when the host cell, the blue light of the reception indicator flashes every 0.5 sec for a reminder.
7. When the power of the receiver is low, the red light of the indicator is flickers once every 1 sec.
8. When the receiver is inserted into the host charging slot, press 999 on the keypad call button and then press the call key, the receiver in all the charging slots can be turned off at the same time.

Note: the host must be paired with the receiver before it can operate properly.

Pairing method

1. Set the host ID: to press the [CALL] key and the [DEL] key at the same time until [F1] is displayed on the host screen, and then press the [CALL] key to enter the setting mode. After entering the new number "001-999" from the keyboard, press [CALL] to save and press [DEL] to exit.
2. Pairing – The receiver is in the standby state, short press the "Set" button, the blue indicator light of the receiver is law ys on, then press the call number on the keypad, the receiver gets the signal and the blue indicator light turns off and accompanied by buzz and vibration reminding. It means pair success.
3. Deleting – The receiver is in the standby state, press and hold on the "Set" button for 3 sec, the receiving indicator light goes from blue to extinguish, then release the button, Successfully deleted paired call.

Note: after changing the host ID, the receiver must be repaired.

Reminder mode switching

The receiver is in the standby state, short press the mode button on the receiver to change the reminder mode. There are five kinds of modes, the default is vibration, buzzing, and LED lights, the other four are Vibration and buzz; Vibration; Vibration and lamplight; Buzz and lamplight.

Five mode cycle switching, when switching to the corresponding mode, the receiver shall receive a reminder with the corresponding mode for 5s.

Change Stickers

Take out the transparent cover in the front of the receiver, then put a Sticker inside the paper slot, and then put it back on the cover.

Note: when you need to pair or switch reminder mode, take out the cover and paper firstly.

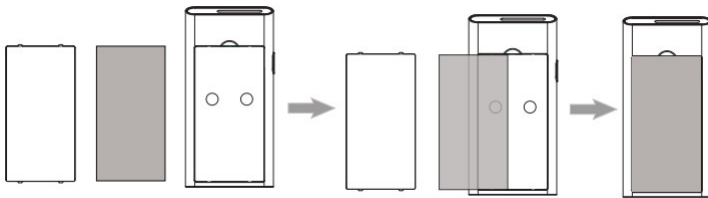

Precautions

RF ENERGY EXPOSURE AND PRODUCT SAFETY GUIDE



ATTENTION!

Before using this radio, read this guide which contains important operating instructions for safe usage and energy awareness and control for compliance with applicable standards and regulations.

This radio uses electromagnetic energy in the radio frequency (RF) spectrum to provide communications between two or more users over a distance. RF energy, which when used improperly, can cause biological damage.

All Reteless radios are designed, manufactured, and tested to ensure they meet government-established RF exposure levels.

In addition, manufacturers also recommend specific operating instructions to users of the radios. These instructions are important because they inform users about RF energy exposure and provide simple procedures on how to control it. Please refer to the following websites for more information on what RF energy exposure is and how to control your exposure to assure compliance with established RF exposure limits: <http://www.who.int/en/>

Local Government Regulations

When radios are used as a consequence of employment, the Local Government Regulations requires users to be fully aware of and able to control their exposure to meet occupational requirements. Exposure awareness can be facilitated by the use of a product label directing users to specific user awareness information. Your Reteless radio has an RF Exposure Product Label. Also, your Reteless user manual or separate safety booklet includes information and operating instructions required to control your exposure and to satisfy compliance requirements.

Radio License (if appropriate)

Governments keep the radios in classification, business radios operate on radio frequencies that are regulated by the local radio management departments (FCC, ISED, OFCOM, ANFR, BFTK, Bundesnetzagentur...). To transmit on these frequencies, you are required to have a license issued by them. For the detailed classification and the use of your radios, please contact the local government radio management departments. Use of this radio outside the country where it was intended to be distributed is subject to regulations and may be prohibited.

Unauthorized modification and adjustment

Changes or modifications not expressly approved by the party responsible for compliance may void the user's authority granted by the local government radio management departments to operate this radio and should not be made.

To comply with the corresponding requirements, transmitter adjustments should be made only by or under the supervision of a person certified as technically qualified to perform transmitter maintenance and repairs in the private land mobile and fixed services as certified by an organization representative of the user of those services.

Replacement of any transmitter component (crystal, semiconductor, etc.) not authorized by the local government radio management departments equipment authorization for this radio could violate the rules.

FCC Requirements:

- This device complies with part 15 of the FCC Rules. Operation is subject to the following two conditions:
 - 1) This device may not cause harmful interference, and
 - 2) this device must accept any interference received, including interference that may cause undesired operation.
- This equipment has been tested and found to comply with the limits for a Class B digital device, pursuant to Part 15 of the FCC Rules. These limits are designed to provide reasonable protection against harmful interference in a residential installation.

This equipment generates uses and can radiate radio frequency energy and, if not installed and used in accordance with the instructions, may cause harmful interference to radio communications. However, there is no guarantee that interference will not occur in a particular installation. If this equipment does cause harmful interference to radio or television reception, which can be determined by turning

Precautions

the equipment off and on, the user is encouraged to try to correct the interference by one or more of the following measures:

- Reorient or relocate the receiving antenna.

- Increase the separation between the equipment and receiver.
- Connect the equipment into an outlet on a circuit different from that to which the receiver is connected.
- Consult the dealer or an experienced radio/TV technician for help.

CE Requirements:

- (Simple EU declaration of conformity) Henan Eshow Electronic Commerce Co., Ltd declares that the radio equipment type is in compliance with the essential requirements and other relevant provisions of RED Directive 2014/53/EU and the ROHS Directive 2011/65/EU and the WEEE Directive 2012/19/EU; the full text of the EU declaration of conformity is available at the following internet address: www.retekess.com.



-  Disposal

The crossed-out wheeled bin symbol on your product, literature, or packaging reminds you that in the European Union, all electrical and electronic products, batteries, and accumulators (rechargeable batteries) must be taken to designated collection locations at the end of their working life. Do not dispose of these products as unsorted municipal waste. Dispose of them according to the laws in your area.

IC Requirements:

License-exempt radio apparatus This device contains license-exempt transmitter(s)/receiver(s) that comply with Innovation, Science, and Economic Development Canada's license-exempt RSS(s).

Operation is subject to the following two conditions:

- 1) This device may not cause interference.
- 2) This device must accept any interference, including interference that may cause undesired operation of the device.

RF Exposure Information

- DO NOT operate the radio without a proper antenna attached, as this may damage the radio and may also cause you to exceed RF exposure limits. A proper antenna is antenna supplied with this radio by the manufacturer or an antenna specifically authorized by the manufacturer for use with this radio, and the antenna gain shall not exceed the specified gain by the manufacturer declared.
- DO NOT transmit for more than 50% of total radio use time, more than 50% of the time can cause RF exposure compliance requirements to be exceeded.
- During transmissions, your radio generates RF energy that can possibly cause interference with other devices or systems. To avoid such interference, turn off the radio in areas where signs are posted to do so.
- The device complies with RF specifications when the device is used at 5mm from your body. Third-party belt clips, holsters, and similar accessories used by this device should not contain any metallic components. Body-worn accessories that do not meet these requirements may not comply with RF exposure requirements and should be avoided.
- DO NOT operate the transmitter in areas that are sensitive to electromagnetic radiation such as hospitals, aircraft, and blasting sites.

Avoid Choking Hazard



Small Parts. Not for children under 3 years.



WARNING Protect your hearing:

- Use the lowest volume necessary to do your job.
- Turn up the volume only if you are in noisy surroundings.
- Turn down the volume before adding a headset or earpiece.
- Limit the amount of time you use headsets or earpieces at high volume.
- When using the radio without a headset or earpiece, do not place the radio's speaker directly against your ear

- Use care with the earphone may be possible excessive sound pressure from earphones and headphones can cause hearing loss .

Note: Exposure to loud noises from any source for extended periods of time may temporarily or permanently affect your hearing. The louder the radio's volume, the less time is required before your hearing could be affected. Hearing damage from loud noise is sometimes undetectable at first and can have a cumulative effect

Avoid Burns



WARNING Antennas

- Do not use any portable radio that has a damaged antenna. If a damaged antenna comes into contact with the skin when the radio is in use, a minor burn can result. Batteries (if appropriate)
- When the conductive material such as jewelry, keys or chains touch exposed terminals of the batteries, may complete an electrical circuit (short circuit the battery) and become hot to cause bodily injury such as burns. Exercise care in handling any battery, particularly when placing it inside a pocket, purse, or another container with metal objects

Long transmission

- When the transceiver is used for long transmissions, the radiator and chassis will become hot.



WARNING Forbid

- Do not use charger outdoors or in moist environments, use only in dry locations/conditions.
- Do not disassemble the charger, which may result in a risk of electrical shock or fire.
- Do not operate the charger if it has been broken or damaged in any way.
- Do not place a portable radio in the area over an airbag or in the airbag deployment area. The radio may be propelled with great force and cause serious injury to occupants of the vehicle when the airbag inflates.

To reduce risk

- Pull by the plug rather than the cord when disconnecting the charger.
- Unplug the charger from the AC outlet before attempting any maintenance or cleaning.
- Contact Reteless for assistance regarding repairs and service.
- The adapter shall be installed near the equipment and shall be easily accessible
- Risk of explosion if the battery is replaced by an incorrect type. Dispose of used batteries according to the instructions.
- The adapter shall be installed near the equipment and shall be easily accessible.
- The plug is considered as a disconnect device of the adapter.
- The operating temperature of the EUT can't exceed the specified range.



WARNING Approved Accessories

- This radio meets the RF exposure guidelines when used with the Reteless accessories supplied or designated for the product. Use of other accessories may not ensure compliance with the RF exposure guidelines and may violate regulations.
- For a list of Reteless-approved accessories for your radio model, visit the following website: <http://www.Reteless.com>.

RETELESS

Guarantee

Model Number: _____
Serial Number: _____
Purchasing Date: _____
Dealer: _____
Telephone: _____
User's Name: _____
Telephone: _____
Country: _____
Address: _____
Post Code: _____
Email: _____

Remarks:

1. This guarantee card should be kept by the user, no replacement if lost.
2. Most new products carry a two-year manufacturer's warranty from the date of purchase.
3. The user can get a warranty and after-sales service as below:
 - Contact the seller where you buy.
 - Products Repaired by Our Local Repair Center
4. For warranty service, you will need to provide a receipt proof of purchase from the actual seller for verification

Exclusions from Warranty Coverage:

1. To any product damaged by accident.
2. In the event of misuse or abuse of the product or as a



Henan Eshow Electronic Commerce Co., Ltd
Add: 7/F, Sanjiang Building, No.170 Nanyang Road, Huiji District,
Zhengzhou, Henan, China
EU Importer: Germany Retevis Technology GmbH
Address: Uetzenacker 29, 38176 Wendeburg
Facebook: facebook.com/Reteless.ru
E-mail: support@reteless.com.ru
Web: reteless.com.ru



MADE IN CHINA

<https://reteless.com.ru/>

CE FCC RoHS



Documents / Resources



RETELESS T116A Queue Wireless Calling System [pdf] User Manual
T116A, Queue Wireless Calling System, T116A Queue Wireless Calling System

Manuals+

- [home](#)
- [privacy](#)