



Reptile Habitats Reptile Enclosure Instruction Manual

[Home](#) » [Reptile Habitats](#) » Reptile Habitats Reptile Enclosure Instruction Manual 



Contents

- [1 IMPORTANT INSTALLATION TIPS:](#)
- [2 STEP 1-Assemble bottom](#)
- [3 STEP 2 – Assemble sides](#)
- [4 STEP 3 – Assemble top](#)
- [5 STEP 4 – Assemble door](#)
- [6 STEP 5 – Assemble Cable pass through port](#)
- [7 Documents / Resources](#)
- [8 Related Posts](#)

IMPORTANT INSTALLATION TIPS:

1. Assemble bottom with long bars first, so panel can slide in from side. Make sure the openings on the corner fittings are face down.
2. On side panels with cable openings, position the opening toward the back top corner.
3. When putting on top with screen, make sure the double track (for doors) is facing forward.

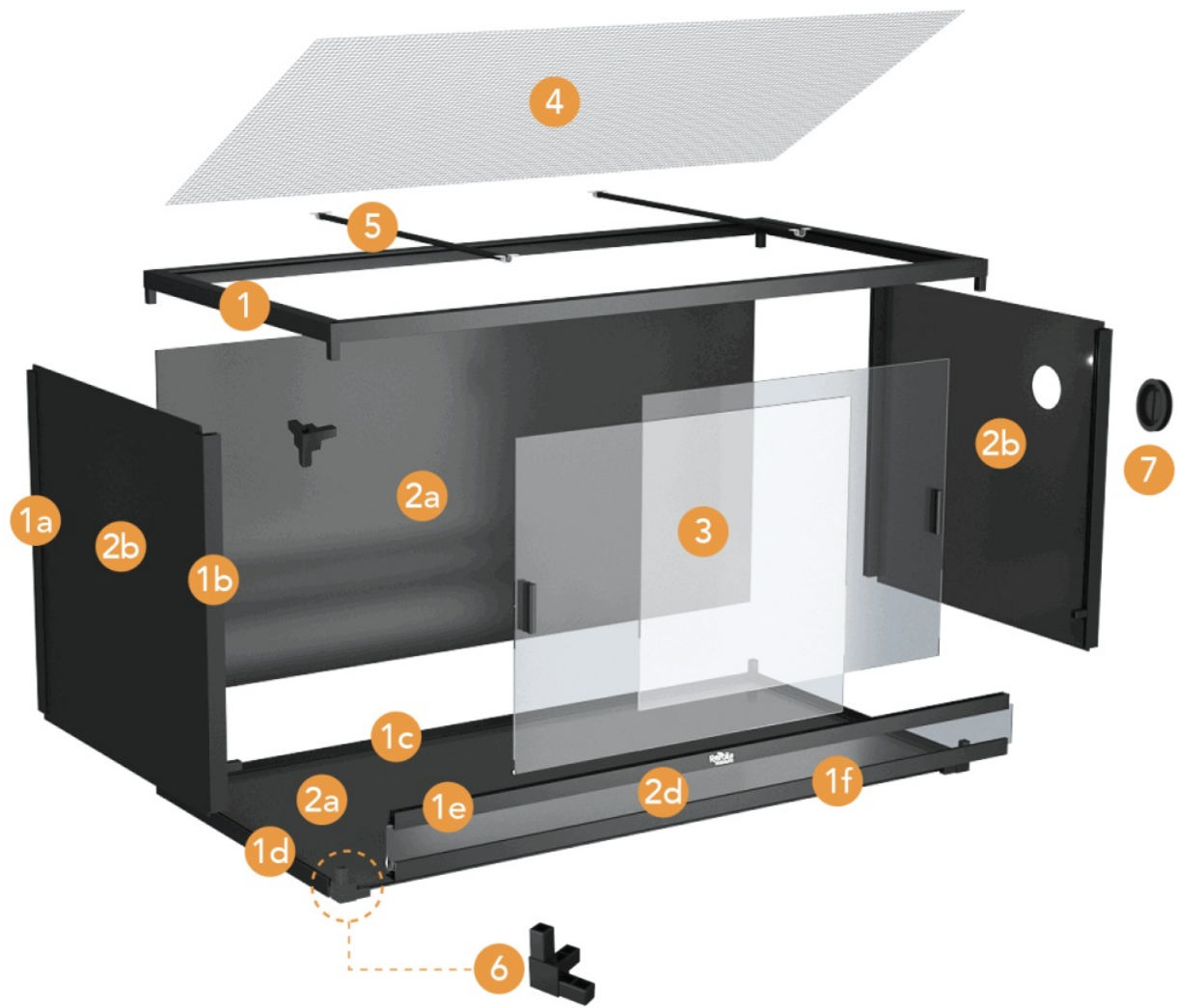

- 1. Frames (aluminum)
- 2. Panels (5)
- 3. Door (2)
- 4. Mesh (screen built-in)
- 5. Support Bars (2)
- 6. Corner Fittings (8)
- 7. Cable Pass Through Port (2)

The 48x24x12 and 36x18x18 enclosures will have a roll of double-sided tape in place of part 1E.

STEP 1-Assemble bottom

- a. Take out 4 corners (#61, 4 frames (1C, 2x1D, 1F), & 1 4x2 panel (2A).



MAKE SURE OPENINGS ARE FACE DOWN.

b. Connect 3 aluminum frames to each end of 2 corner fittings.



c. Slide the bottom panel into the channels of the assembled frame.

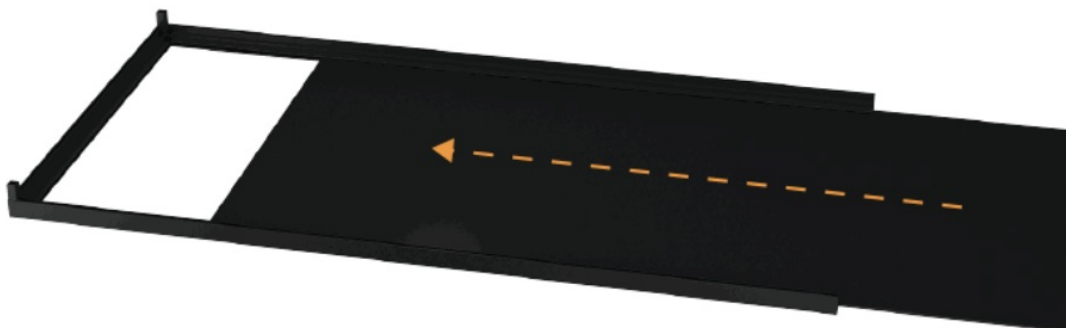

*** Slide into the channels**

d. Attach the other frame and corner fittings to secure the bottom panel.



*** Attach to the main part**

STEP 2 – Assemble sides

a. Attach 2 back frames on the back left & right corner fittings.

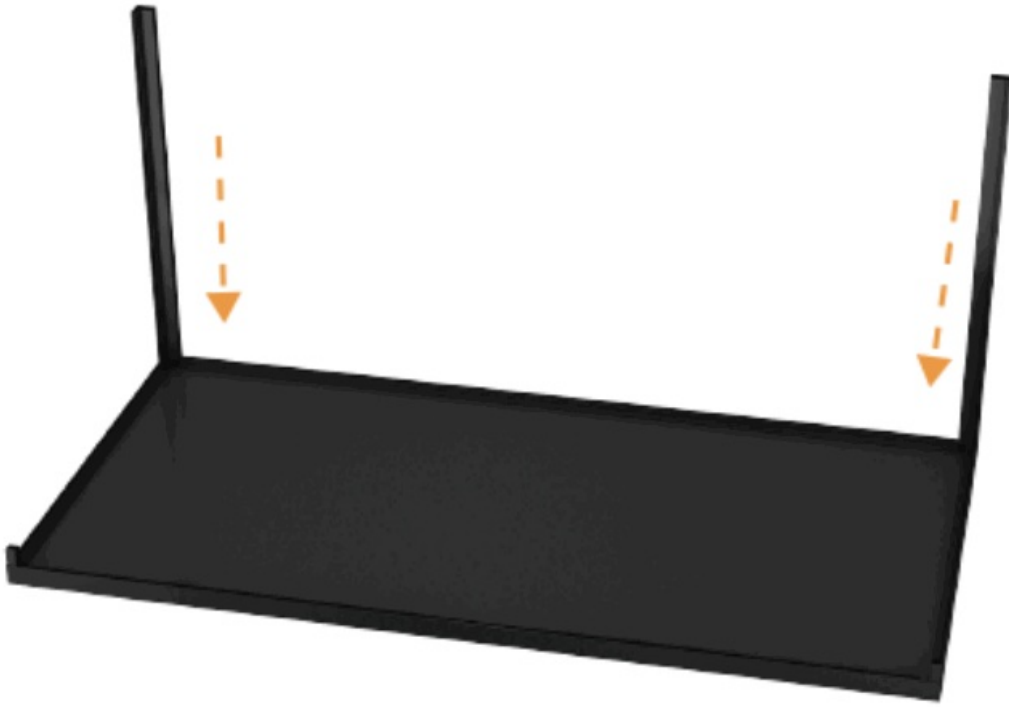

b. Insert the acrylic panel into the bottom channel.

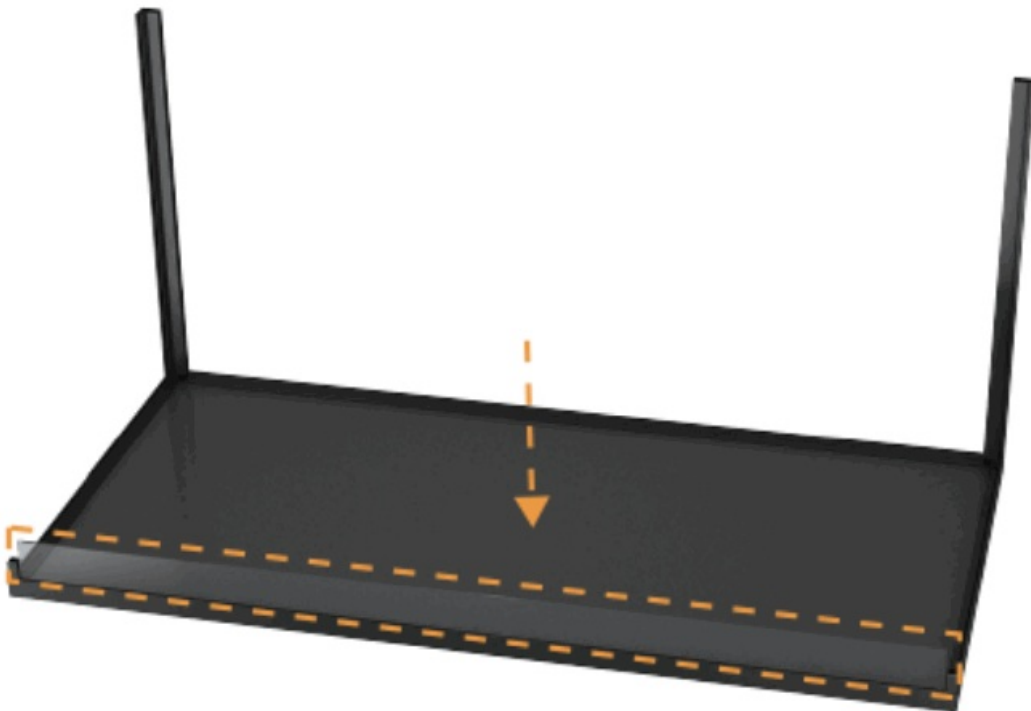

c. Connect the assembled frames to the bottom channels, and then slide the 3 side panels into the bottom channels.

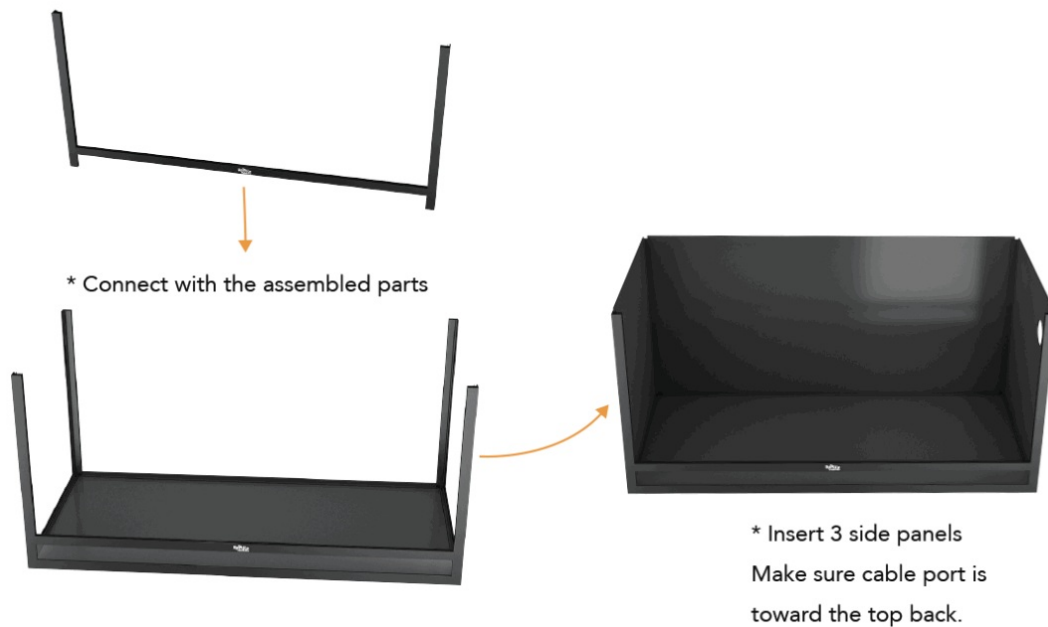

When assembling the 48x24x12 and 36x18x18 enclosures, skip Step 2C. Instead, your last step will be to attach the acrylic panel using double-sided tape.

STEP 3 – Assemble top

- a. The screen is already assembled. Screw in the support bars with U-shape clamp.
*Make sure double channels on pre-assembled screen top face forward.

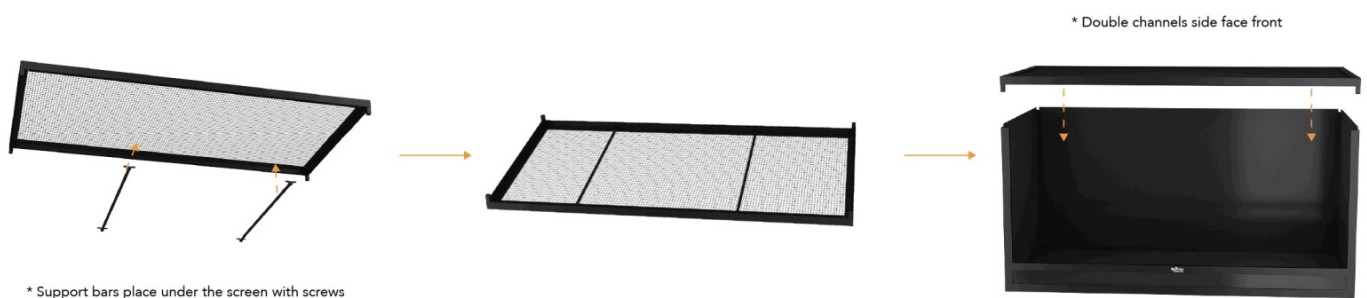

STEP 4 – Assemble door

- a. Peel off the protective film on the acrylic doors, and then attach the door handles using screws M4*6mm.

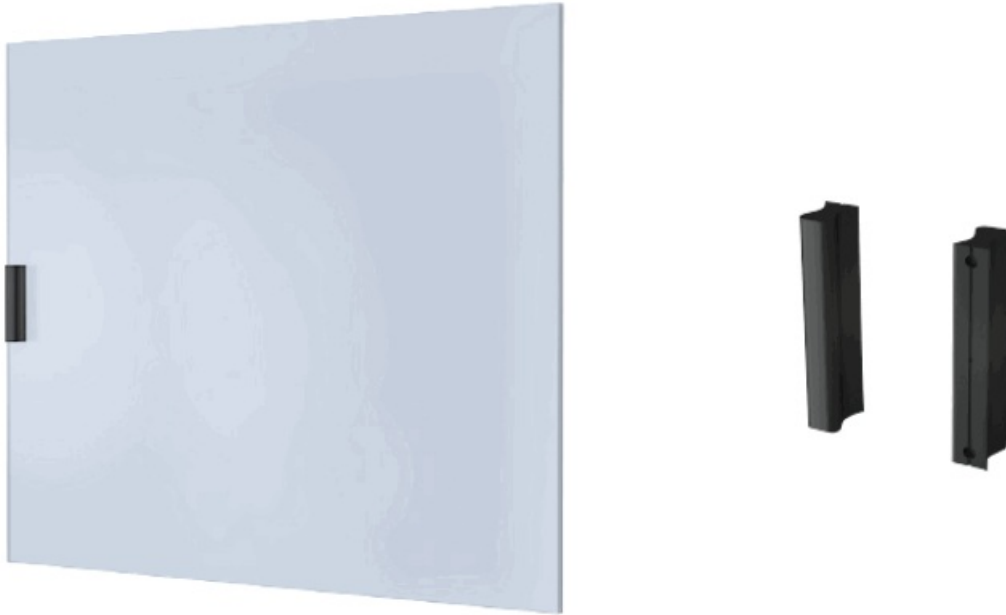

* Peel off the protective film, install the door handles on to the doors

b. Insert top edge of the left door into the back-top door rail, and then align with the back bottom door rail and drop into place and vice versa.



* Insert the door inside the door rail, one

STEP 5 – Assemble Cable pass through port

a. Take apart the cable pass into two pieces, and then open the acrylic door, install it on the side panel of the enclosure.

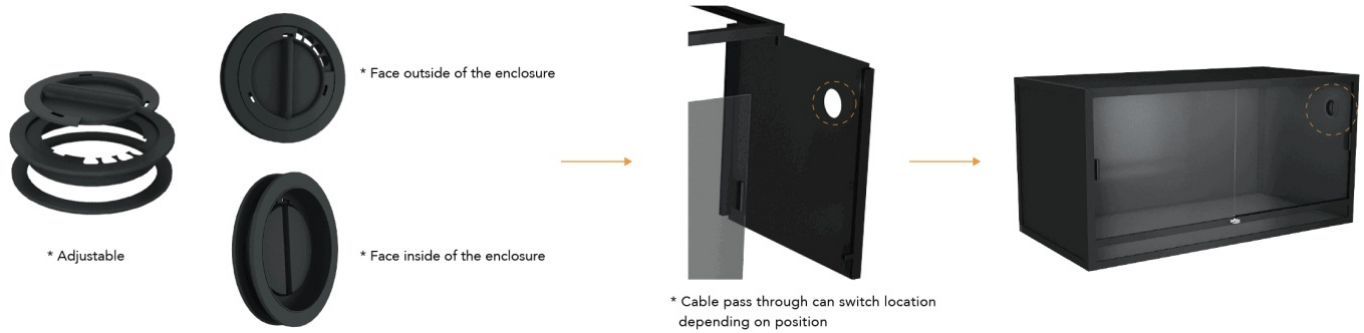

Documents / Resources



Reptile Enclosure
Installation Instructions

Reptile Habitats Reptile Enclosure [pdf] Instruction Manual
Reptile Enclosure, Reptile, Enclosure