

reolink
RLK8-1200B4-A
PoE Surveillance
Security Camera
System



reolink RLK8-1200B4-A PoE Surveillance Security Camera System Instruction Manual

[Home](#) » [reolink](#) » reolink RLK8-1200B4-A PoE Surveillance Security Camera System Instruction Manual 

Contents

- [1 Relink RLK8-1200B4-A PoE Surveillance Security Camera System](#)
- [2 Product Usage Instructions](#)
- [3 What's in the Box](#)
- [4 Introduce the NVR](#)
- [5 Introduce the Cameras](#)
- [6 Connection Diagram](#)
- [7 Set up the NVR System](#)
- [8 Mount Tips for the Cameras](#)
- [9 Troubleshooting](#)
- [10 Specifications](#)
- [11 Notification of Compliance](#)
- [12 Frequently Asked Questions](#)
- [13 Documents / Resources](#)
 - [13.1 References](#)

reolink
Be Prepared, Be Reolink

Relink RLK8-1200B4-A PoE Surveillance Security Camera System



Specifications

- **Brand:** LostManual
- **Model:** XYZ-123
- **Color:** Black
- **Material:** Plastic
- **Power Source:** Battery
- **Dimensions:** 6in x 4in x 2in

Product Usage Instructions

- **Unboxing and Setup:**

Upon receiving the product, carefully unbox it and ensure all components are included. Follow the setup instructions provided in the manual to assemble the product correctly.

- **Powering On the Device:**

Insert the required batteries into the designated compartment. Make sure the batteries are inserted with the correct polarity. Press the power button to turn on the device.

- **Navigating the Menu:**

Use the navigation buttons to move through the menu options. Press the select button to choose an option or confirm a selection.

- **Using the Features:**

Explore the different features of the product such as settings, modes, and functionalities as described in the user manual. Familiarize yourself with how to operate each feature effectively.

- **Maintenance and Care:**

Regularly clean the product with a soft, dry cloth. Avoid using harsh chemicals or abrasive materials that may damage the device. Store the product in a cool, dry place when not in use.

What's in the Box

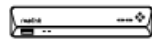

NVR

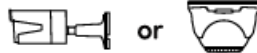

Bullet or Dome Camera



Pack
of Screws



Waterproof
Lid



1m
Network Cable



18m
Network Cable

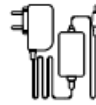

NVR
Power Adapter



USB Mouse



HDMI Cable



Surveillance Card



Quick Start Guide

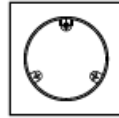

Mounting
Hole Template

NOTE

The quantity of devices and accessories varies by the different models that you purchase.

Introduce the NVR

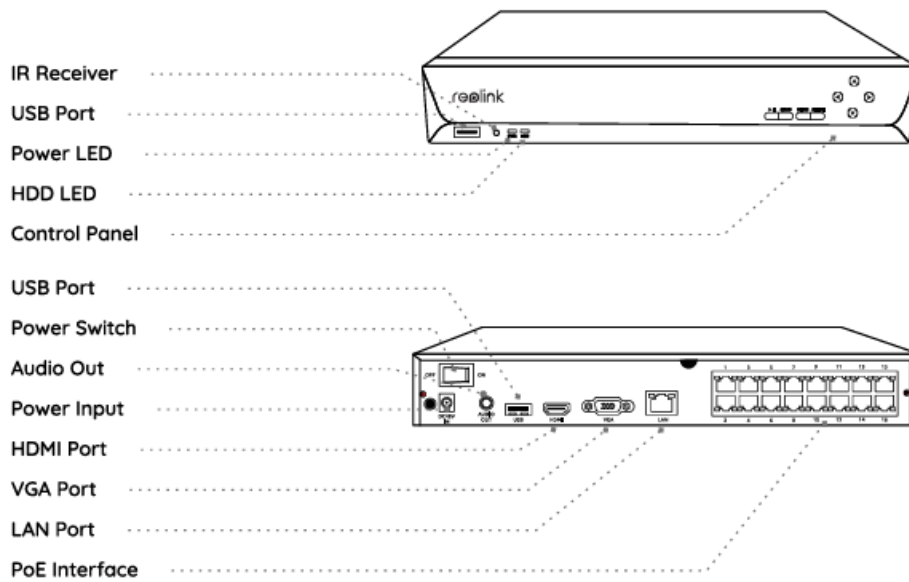

Introduce the Cameras

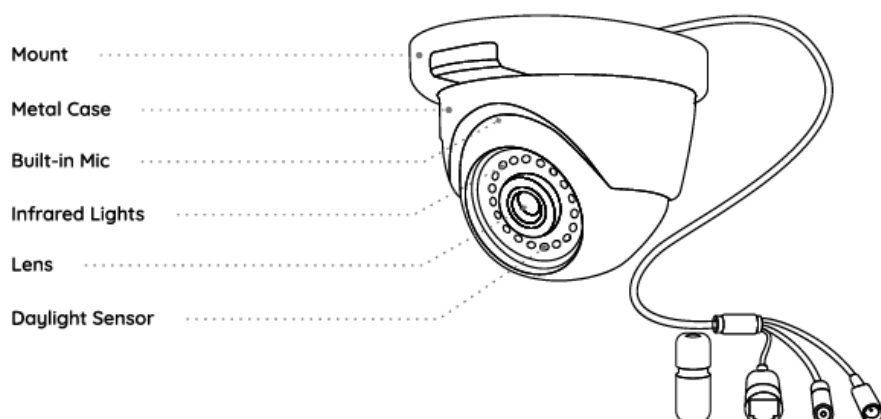
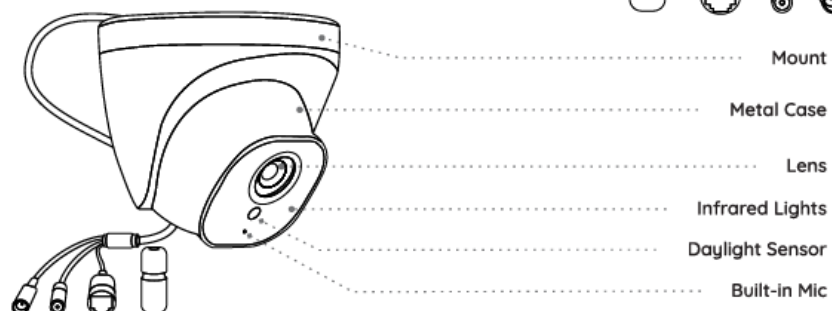
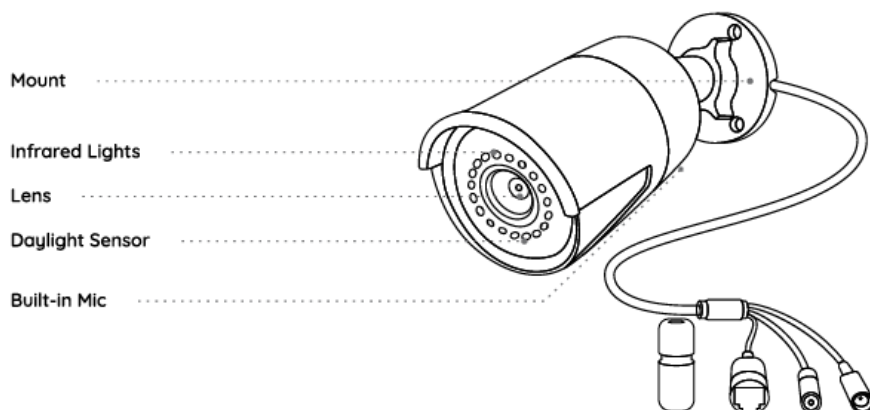
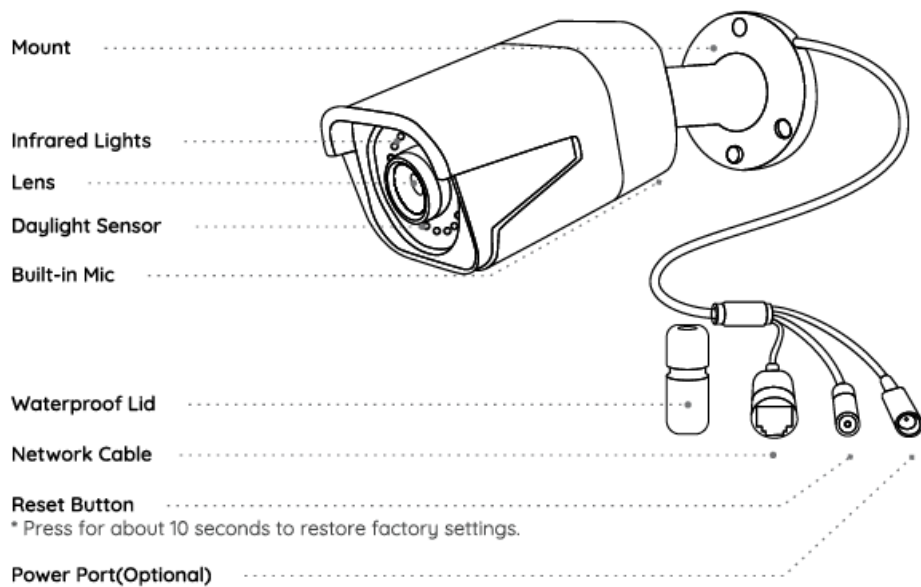

NOTE:

- Different types of cameras are introduced in this section. Please check out the camera included in the package and check out the details from the corresponding introduction above,
- The actual appearance and components may vary with different models of products,

Connection Diagram

To ensure all components work properly, it is recommended that you connect every part and try to run the system before a final installation.

- Connect the NVR (LAN port) to your router with a network cable. Next. Connect the mouse to the USB port of the NVR.
- Connect the NVR to the monitor with a VGA or HDMI cable.

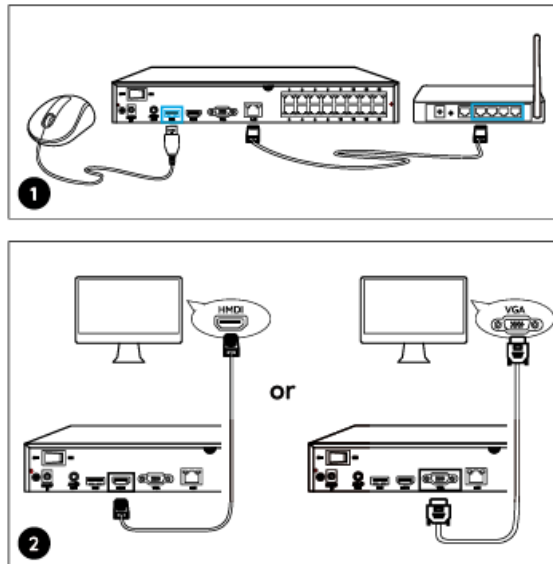

NOTE

There is no VGA cable included in the package.

- Connect cameras to POE ports on the NVR-
- Connect the NVR to a power outlet and turn on the power switch,

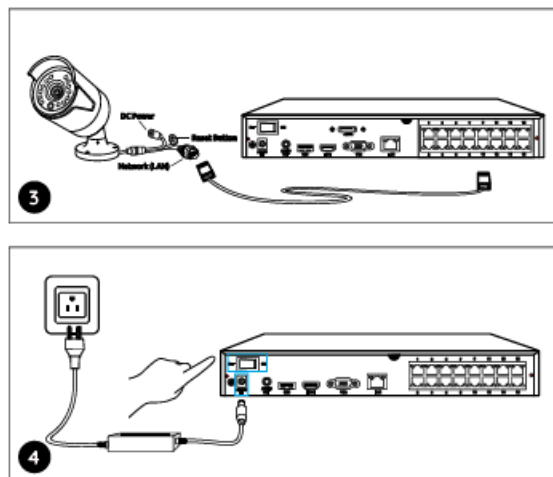

NOTE:

Some Reolink WiFi cameras also work with Reolink POE NVR For more information, visit <https://suppofit.reolink.com> and search Make Reolink WiFi Cameras Work with Reolink PoE-NVRs

Set up the NVR System

A setup wizard will guide you through the NVR system configuration process, Please set a password for your NVR (for the initial access) and follow the wizard to configure the system.

NOTE,

The password should be at least 6 characters, It is recommended that you note down the password and keep It in a secure place.

Access the System via a Smartphone or PC

Download and launch the Reolink App or Client software and follow the instructions to access the NVR-

- **On Smartphone**

Scan to download the Reolink App.

- **On pc**

Download path: Go to <https://reolink.com> > Support > App & Client



Mount Tips for the Cameras

- Do not face the camera towards any light sources.
- Do not point the camera toward a glass window. Or. It may result In poor Image quality because of the window glare by infrared LEDs, ambient lights, or status lights.
- Do not place the camera in a shaded area and point it towards a well-lit area. Or, it may result in poor Image quality, To ensure the best image quality. The lighting conditions for both the camera and the captured object shall be the same.
- To ensure better image quality, it is recommended to clean the lens with a soft cloth from time to time.
- Make sure the power ports are not directly exposed to water or moisture and not blocked by dirt or other elements.
- With IP waterproof ratings, the camera can work properly under conditions like rain and snow. However, it doesn't mean the camera can work underwater.
- Do not install the camera at places where rain and snow can hit the lens directly,
- The camera may work in extreme cold conditions as low as -250C because it will produce heat when powered on. You may power the camera indoors for a few minutes before installing It outdoors.

Troubleshooting

No video output on the monitor/ T

If there's no video output on the monitor from Reolink NVR. Please try the following solutions:

- TV/monitor resolution should be at least 720p or above,
- Make sure your NVR is powered on.
- Double-check the HDMI/VGA connection, or swap another cable or monitor to test.
- If it still doesn't work. please contact Reolink
- Support support@reolink.com

Failed to access the POE NVR locally

If you failed to access the POE NVR locally via mobile phone or PC please try the following solutions:

- Connect the NVR (LAN port) to your router with a network cable.
- Swap another Ethernet cable or plug the NVR to other ports on the router.
- Go to Menu System -> Maintenance and restore all settings-

If it still doesn't work, please contact Reolink Support support@reolink.com

Failed to access the POE NVR remotely

If you failed to access the POE NVR remotely via mobile phone or PC please try the following.

- Make sure you can locally access this NVR system.
- Go to NVR Menu Network -> Network > Advanced and make sure that IJID Enable is selected.
- Please connect your phone or PC under the same network (LAN) of your NVR and see if you can visit any website to verify whether there is Internet access available,
- Please reboot your NVR and router and try again.

If it still doesn't work, please contact Reolink Support support@reolink.com.

Specifications

NVR

- **Decoding Resolution:** 12MP/8MP/5MP/4MP/3MP/1080p/720p
- **Operating Temperature:** -100C to 450C (-100C to 550C for RLN16-41
- **Size:** 260 x 41 x 230mm (330 x 45 x 285mm for RLN16-410)
- **Weight:** 2.0kg (3.0kg for RLN16-410)

Camera

- **Night Vision:** 30 Meters (100ft)
- **Day/Night Mode:** Auto Switchover
- **Operating Temperature:** -10C to 550C (140F to 1310F)
- **Operating Humidity:** 10%-90%
- **Weather Resistance:** IP66

For more Specifications. Visit <https://reolink.com/>,

Notification of Compliance

FCC Compliance Statement

This device complies with Part 15 of FCC Rules. Operation is subject to the following two conditions:

1. This device may not cause harmful interference. and
 2. This device must accept any interference received. Including interference that may cause undesired operation,
- For more information, visit: <https://reolink.com/fcc-compliance-notice/>.

Simplified EU Declaration of Conformity

Reolink declares that this device complies with the essential requirements and other relevant provisions of Directive 2014/53/EU.

Correct Disposal of this product

This marking indicates that this product cannot be disposed of with other household wastes throughout the EU. To prevent possible harm to the environment or human health from uncontrolled waste disposal and promote the sustainable reuse of material resources, please recycle it responsibly. To return your used device, please visit the Return and Collection System or contact the retailer from whom the product was purchased. They can take this product away for environmentally safe recycling. Promote the sustainable reuse of material resources. Please recycle it responsibly. To return your used device, please visit the Return and Collection System or contact the retailer from whom the product was purchased. They can take this product away for environmentally safe recycling.

Limited warranty

This product comes with a 2-year limited warranty that is valid only if purchased from the Reolink Official Store or a Reolink authorized reseller. Learn more: <https://reolink.com/warranty-and-return/>.

NOTE;

" We hope that you enjoy your new purchase. But if you are not satisfied with the product and plan to return it, we strongly suggest that you format the inserted HDD first.

Terms and Privacy

Use of the product is subject to your agreement to the Terms of Service and Privacy Policy at [Keep it out of reolink.com](https://reolink.com). reach of children.

End User License Agreement

By using the Product Software that is embedded in the Reolink product, you agree to the terms of this End User License Agreement ("EULA") between you and Reolink. Learn more: <https://reolink.com/eula/>.

Frequently Asked Questions

• Q: How do I change the settings on the device?

A: To change settings, navigate to the settings menu using the navigation buttons and make adjustments using the select button.

• Q: What type of batteries does the device use?

A: The device uses AA batteries. Ensure you use fresh batteries for optimal performance.

• Q: Can I use the product outdoors?

A: While the product is designed for indoor use, it can be used outdoors in dry conditions. Avoid exposing it to moisture or extreme temperatures.

Documents / Resources

	reolink RLK8-1200B4-A PoE Surveillance Security Camera System [pdf] Instruction Manual RLK8-1200B4-A, RLK8-1200B4-A PoE Surveillance Security Camera System, PoE Surveillance Security Camera System, Surveillance Security Camera System, Security Camera System, Camera System
---	---

References

-  [Your Ultimate Resource for Millions of User Manuals](#)
- [User Manual](#)

[Manuals+](#), [Privacy Policy](#)

This website is an independent publication and is neither affiliated with nor endorsed by any of the trademark owners. The "Bluetooth®" word mark and logos are registered trademarks owned by Bluetooth SIG, Inc. The "Wi-Fi®" word mark and logos are registered trademarks owned by the Wi-Fi Alliance. Any use of these marks on this website does not imply any affiliation with or endorsement.