



# reolink RLK8-1200B4-A 12MP PoE Security Camera System Instruction Manual

[Home](#) » [reolink](#) » reolink RLK8-1200B4-A 12MP PoE Security Camera System Instruction Manual 

## reolink RLK8-1200B4-A 12MP PoE Security Camera System Instruction Manual



### Contents

- [1 What's in the Box](#)
- [2 Introduce The NVR](#)
- [3 Introduce the Cameras](#)
- [4 Connection Diagram](#)
- [5 Set up the NVR System](#)
- [6 Mount Tips for the Cameras](#)
- [7 Troubleshooting](#)
- [8 Specifications](#)
- [9 Notification of Compliance](#)
- [10 Documents / Resources](#)
- [11 Related Posts](#)

### What's in the Box

- NVR

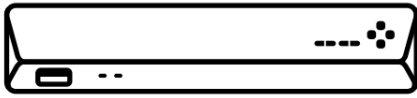

- Bullet or Dome Camera



- Pack of Screws

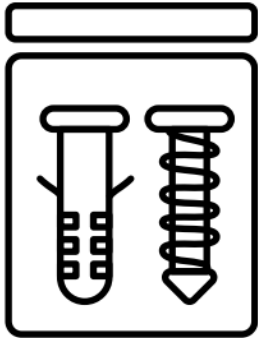

- Waterproof Lid

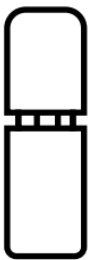

- 1m Network Cable

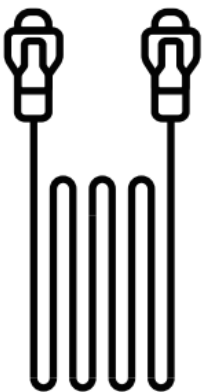

- 18m Network Cable

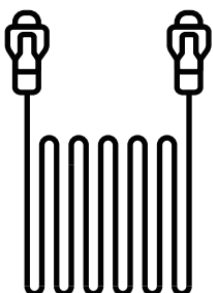

- NVR Power Adapter

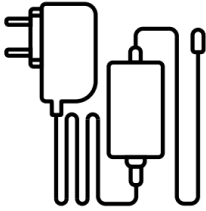

- USB Mouse

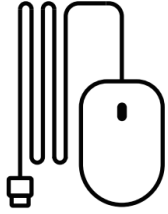

- HDMI Cable

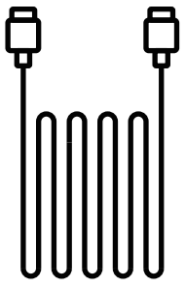

- Surveillance Card



- Quick Start Guide

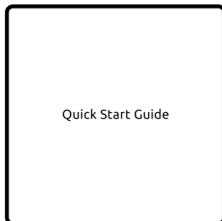

- Mounting Hole Template

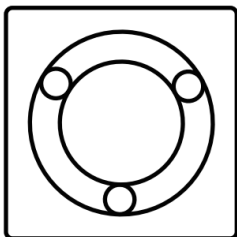

**NOTE:** Quantity of devices and accessories vary by different models that you purchase.

## Introduce The NVR

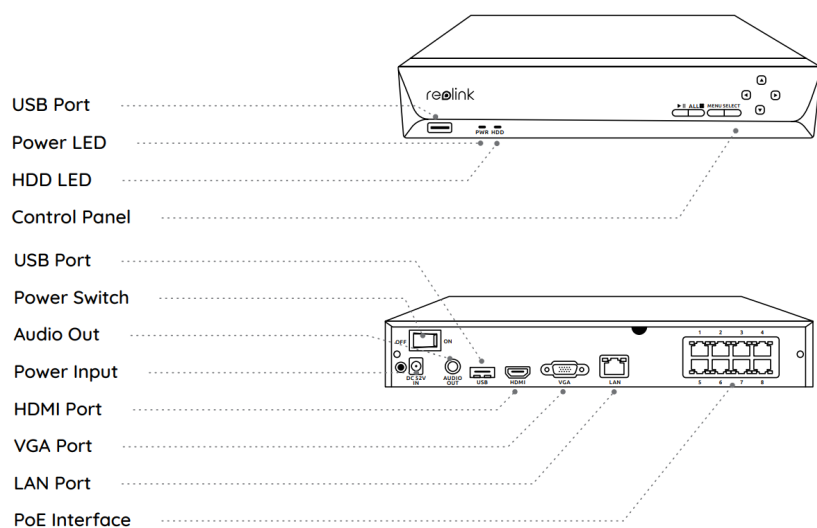

**NOTE:** The actual appearance and components may vary with different products.

## Introduce the Cameras

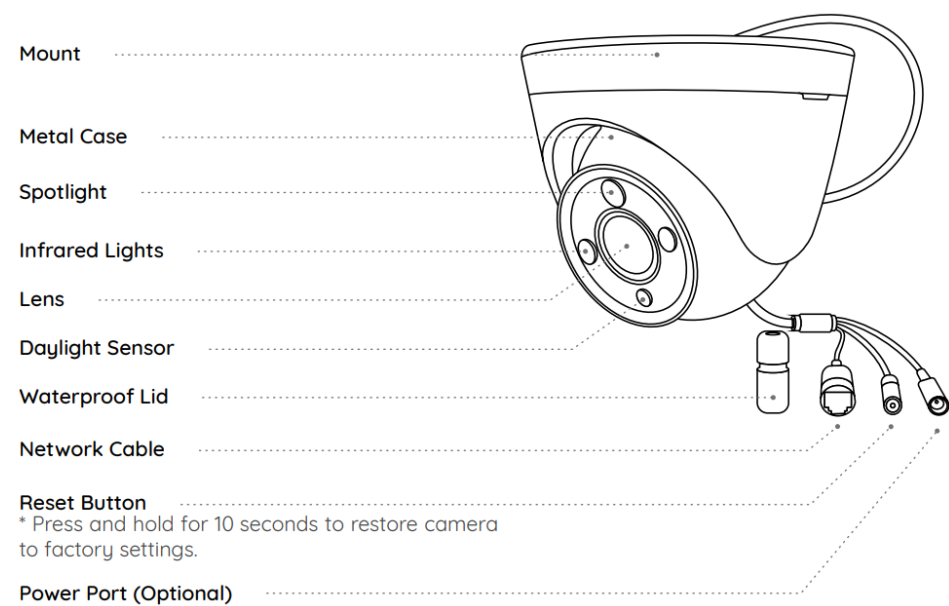
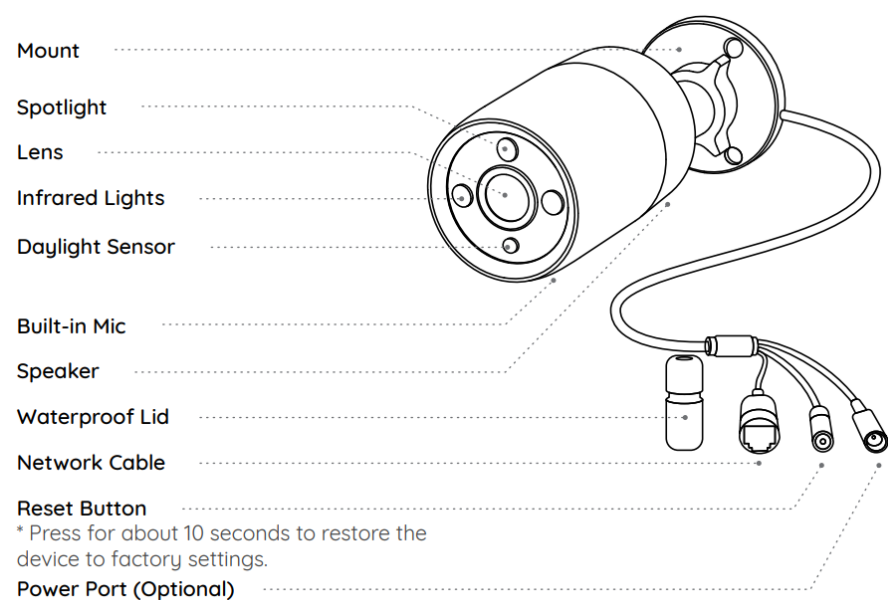

Built-in Mic

Speaker

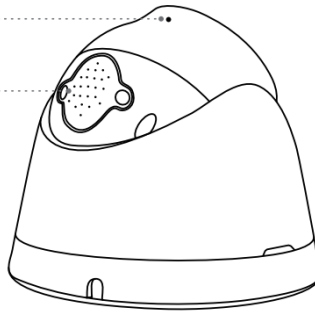

#### NOTE:

- Different types of cameras are introduced in this section. Please check out the camera included in the package and check out the details from the corresponding introduction above.
- The actual appearance and components may vary with different model of product.

### Connection Diagram

To ensure all components work properly, it is recommended that you connect every part and try to run the system before a final installation

1. Connect the NVR (LAN port) to your router with a network cable. Next, connect the mouse to the USB port of the NVR.

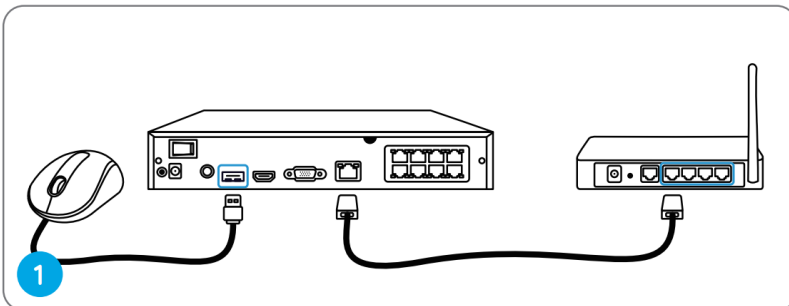

2. Connect the NVR to the monitor with a VGA or HDMI cable. Connect cameras to PoE ports on the NVR. Connect the NVR to a power outlet and turn on power switch.

**NOTE:** There is no VGA cable included in the package.

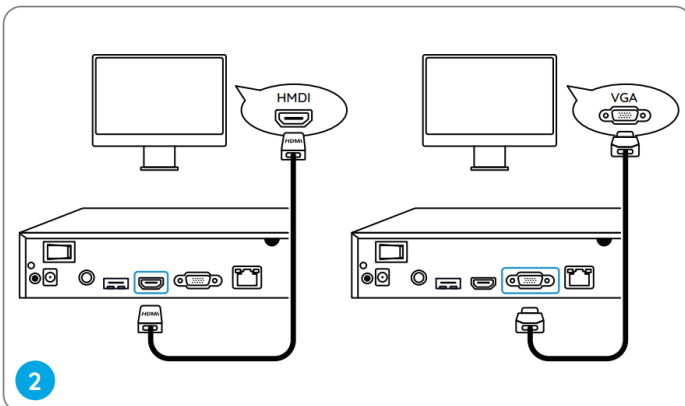

3. Connect cameras to PoE ports on the NVR.

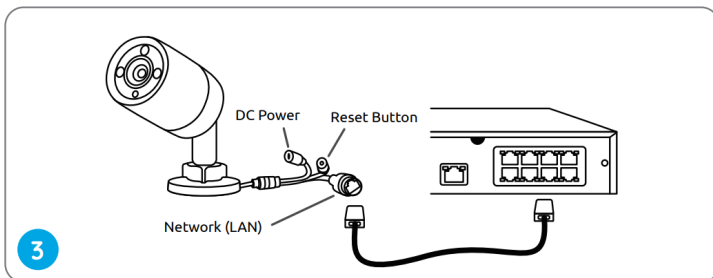

4. Connect the NVR to a power outlet and turn on power switch.

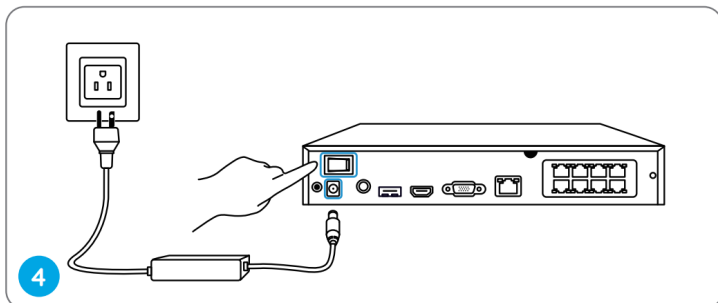

## Set up the NVR System

A setup wizard will guide you through the NVR system configuration process. Please set a password for your NVR (for the initial access) and follow the wizard to configure the system.

**NOTE:** The password should be at least 6 characters. It is recommended that you note down the password and keep it in a secure place.

## Access the System via Smartphone or PC

Download and launch the Reolink App or Client software and follow the instructions to access the NVR.



- **On Smartphone**

Scan to download the Reolink App

- **On PC**

## Mount Tips for the Cameras

- Do not face the camera towards any light sources.
- Do not point the camera towards a glass window. Or, it may result in poor image quality because of the window glare by infrared LEDs, ambient lights or status lights.
- Do not place the camera in a shaded area and point it towards a well-lit area. Or, it may result in poor image quality. To ensure best image quality, the lighting condition for both the camera and the capture object shall be the same.
- To ensure better image quality, it's recommended to clean the lens with a soft cloth from time to time.
- Make sure the power ports are not directly exposed to water or moisture and not blocked by dirt or other elements.
- With IP waterproof ratings, the camera can work properly under conditions like rain and snow. However, it doesn't mean the camera can work underwater.
- Do not install the camera at places where rain and snow can hit the lens directly.
- The camera may work in extreme cold conditions as low as -25°C because it will produce heat when powered on. You may power the camera indoors for a few minutes before installing it outdoors.

## Troubleshooting

### No Video Output on the Monitor/TV

If there's no video output on the monitor from Reolink NVR, please try the following solutions:

- TV/monitor resolution should be at least 720p or above.
- Make sure your NVR is powered on.
- Double check the HDMI/VGA connection, or swap another cable or monitor to test.

If it still doesn't work, please contact Reolink

### Failed to Access the PoE NVR Locally Support

If you failed to access the PoE NVR locally via mobile phone or PC, please try the following solutions:

- Connect the NVR (LAN port) to your router with a network cable.
- Swap another Ethernet cable or plug the NVR to other ports on the router.
- Go to Menu -> System -> Maintenance and restore all settings.

If it still doesn't work, please contact Reolink Support

### Failed to Access the PoE NVR Remotely

If you failed to access the PoE NVR remotely via mobile phone or PC, please try the following resolutions:

- Make sure you can locally access this NVR system.
- Go to NVR Menu -> Network -> Network > Advanced and make sure that UID Enable is selected.

- Please connect your phone or PC under the same network (LAN) of your NVR and see if you can visit any website to verify whether there is Internet access available.
- Please reboot your NVR and router and try again.

If it still doesn't work, please contact Reolink Support

## Specifications

### NVR

- Decoding Resolution:
- 12MP/8MP/5MP/4MP/3MP/1080p/720p
- **Operating Temperature:** -10°C to 45°C
- **Size:** 260 x 41 x 230mm
- **Weight:** 2.0kg

### Camera

- **Night Vision:** 30 Meters (100ft)
- **Day/Night Mode:** Auto Switchover
- **Operating Temperature:** -10°C to 55°C (14°F to 131°F)
- **Operating Humidity:** 10%-90%
- **Weather Resistance:** IP66

## Notification of Compliance

### FCC Compliance Statement

This device complies with Part 15 of FCC Rules. Operation is subject to the following two conditions: (1) this device may not cause harmful interference, and (2) this device must accept any interference received, including interference that may cause undesired operation.



Reolink declares that this device is in compliance with the essential requirements and other relevant provisions of Directive 2014/30/EU.



**Correct Disposal of this product**

This marking indicates that this product cannot be disposed with other household wastes throughout the EU. To prevent possible harm to the environment or human health from uncontrolled waste disposal and promote the sustainable reuse of material resources, please recycle it responsibly. To return your used device, please visit the Return and Collection System or contact the retailer from whom the product was purchased. They can take this product away for environmentally safe recycling. To promote the sustainable reuse of material resources, please



recycle it responsibly. To return your used device, please visit the Return and Collection System or contact the retailer from whom the product was purchased. They can take this product away for environmentally safe recycling.

**Limited warranty**

This product comes with a 2-year limited warranty that is valid only if purchased from Reolink Official Store or a Reolink authorized reseller.

**NOTE:** We hope that you enjoy your new purchase. But if you are not satisfied with the product and plan to return it, we strongly suggest that you format the inserted HDD first.

**Terms and Privacy**

Use of the product is subject to your agreement to the Terms of Service and Privacy Policy . Keep it out of reach of children.

**End User License Agreement**

By using the Product Software that is embedded on the Reolink product, you agree to the terms of this End User License Agreement (“EULA”) between you and Reolink.

**Documents / Resources**

	<a href="#">reolink RLK8-1200B4-A 12MP PoE Security Camera System</a> [pdf] Instruction Manual RLK8-1200B4-A, RLK8-1200B4-A 12MP PoE Security Camera System, 12MP PoE Security C amera System, Security Camera System, Camera System
---	--