

reolink RLC-D4K30 PoE IP Camera



reolink RLC-D4K30 PoE IP Camera User Guide

[Home](#) » [reolink](#) » reolink RLC-D4K30 PoE IP Camera User Guide 

Contents

- [1 reolink RLC-D4K30 PoE IP Camera](#)
- [2 What's in the Box](#)
- [3 Camera Introduction](#)
- [4 Connection Diagram](#)
- [5 Documents / Resources](#)
 - [5.1 References](#)
- [6 Related Posts](#)



reolink RLC-D4K30 PoE IP Camera



Specifications

- **Model:** RLC-D4K30
- **Resolution:** 4K
- **Connectivity:** Ethernet
- **Power:** 12V DC adapter or PoE
- **Features:** Infrared Light, Built-in Mic, Daylight Sensor, Waterproof
- **Storage:** SD Card Slot

Camera Setup

Before using the camera, follow these steps:

1. Connect the camera to a Reolink NVR using an Ethernet cable.
2. Connect the NVR to your router and power it on.
3. Ensure the camera is powered with a 12V DC adapter or a PoE device.

Mounting the Camera

Mounting to Wall:

1. Drill holes according to the mounting hole template.
2. Install the mount base using the screws provided.
3. Adjust camera direction using the Reolink App or Client.

Mounting to Ceiling:

1. Follow the same steps as wall mounting, adjusting for ceiling installation.
2. Use drywall anchors if necessary.

Troubleshooting

If the camera is not powered on or if the picture is unclear, refer to the troubleshooting section in the manual for solutions.

FAQ

- **Q: How can I reset the camera to factory settings?**
 - **A:** Press and hold the reset button for about 10 seconds to restore the device to factory settings.
- **Q: Can the camera be connected to a PoE switch?**
 - **A:** Yes, you can also connect the camera to a PoE switch or PoE injector for power.
- **Q: What is the resolution of the camera?**
 - **A:** The camera has a resolution of 4K for high-quality video recording.

What's in the Box



Camera



Waterproof Lid

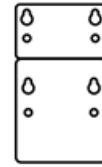

Mounting Hole
Template



1m
Ethernet Cable



Quick Start Guide



Surveillance Sign

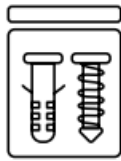

Pack of Screws

Camera Introduction

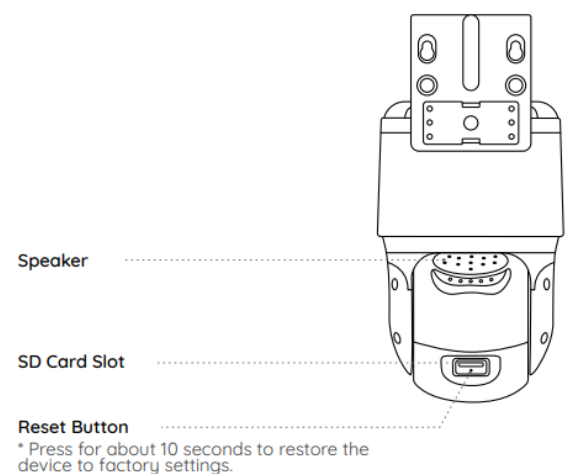
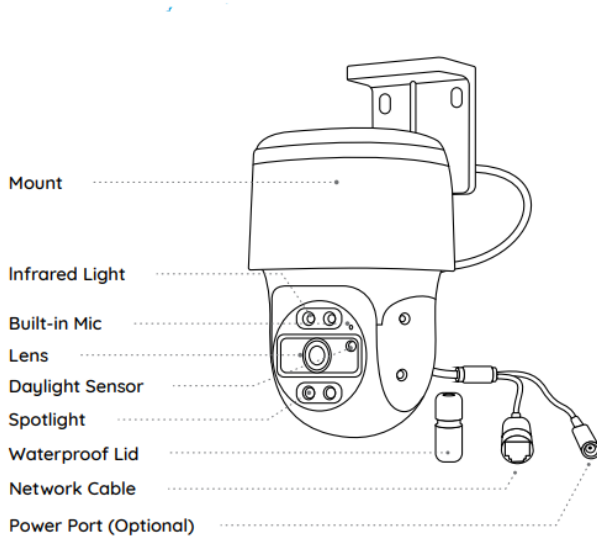

Connection Diagram

Before using the camera, please connect your camera as instructed below to finish initial setup.

1. Connect the camera to a Reolink NVR (not included) with an Ethernet cable.
2. Connect the NVR to your router, and then power on the NVR.

NOTE: The camera should be powered with a 12V DC adapter or a PoE powering device such as a PoE injector, PoE switch or Reolink NVR (not included in the package).

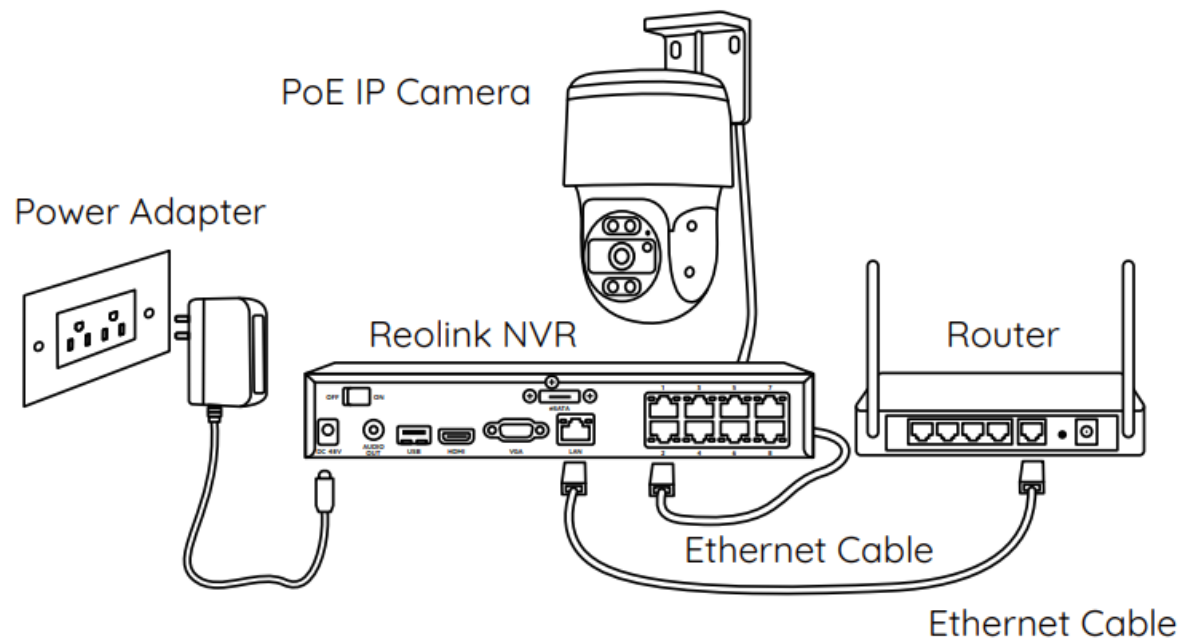

You may also connect the camera to a PoE switch or PoE injector.

Set UP the Camera

Download and launch the Reolink App or Client software, and follow the onscreen instructions to finish the initial setup.

On Smartphone



Scan to download the Reolink App.

On PC

Download the path of the Reolink Client: Go to <https://reolink.com>>Support>App & Client.

NOTE:

- If you are connecting the PoE camera to a Reolink PoE NVR, please set up the camera via the NVR interface.

Mount the Camera to the Ceiling

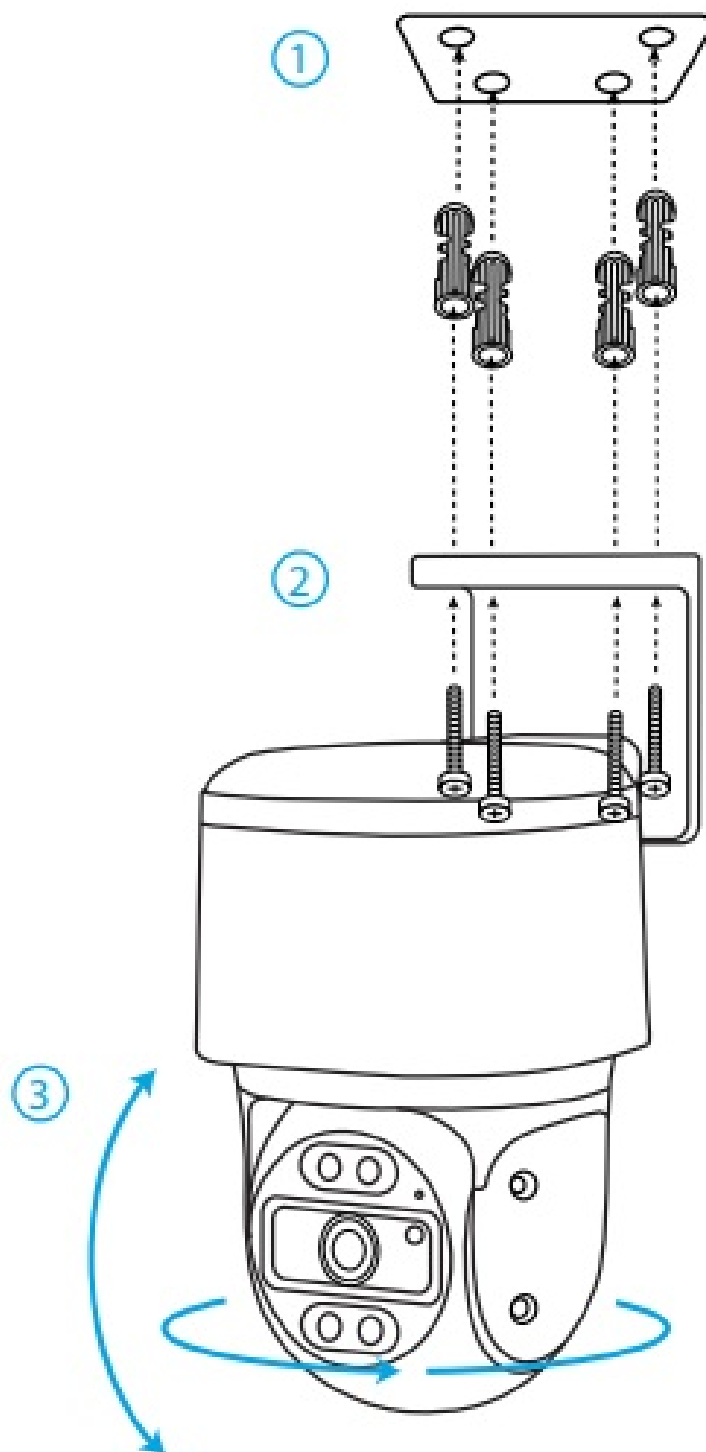

1. Drill holes in accordance with the mounting hole template.
2. Install the mount base with screws included in the package.
3. To adjust the camera direction, you may control the camera to pan and tilt via the Reolink App or Client.
 - **NOTE:** Use the drywall anchors included in the package if needed.

Troubleshooting

The camera is not powering on

If your camera is not powering on, please try the following solutions:

- Make sure your camera is powered on properly. The PoE camera should be powered by a PoE switch/injector,

- a Reolink NVR or a 12V power adapter.
- If the camera is connected to a PoE device as listed above, connect it to another PoE port and check again.
- Try again with another Ethernet cable.

The picture is not clear

If the picture from the camera is not clear, please try the following solutions:

- Check the camera lens for dirt, dust or spiderwebs. Please clean with a soft, clean cloth.
- Point the camera to a well-lit area. The lighting condition will affect the picture quality a lot.
- Upgrade the firmware of your camera to the latest version.
- Restore the camera to factory settings and check it again.

Specification

Hardware Features

- **Infrared Night Vision:** 15 Meters
- **Day/Night Mode:** Auto switchover

General

- **Dimension:** 248 x 110x 147mm
- **Weight:** 1.21KG
- **Operating Temperature:** -10°C~+55°C (14°F~131°F)
- **Operating Humidity:** 10%~90%

For more specifications, visit <https://reolink.com>

Notification of Compliance

FCC Compliance Statement

This device complies with Part 15 of the FCC Rules. Operation is subject to the following two conditions:(1) this device may not cause harmful interference, and (2) this device must accept any interference received,including interference that may cause undesired operation.

NOTE: This equipment has been tested and found to comply with the limits for a Class B digital device, pursuant to part 15 of the FCC Rules. These limits are designed to provide reasonable protection against harmful interference in a residential installation. This equipment generates uses and can radiate radio frequency energy and, if not installed and used in accordance with the instructions, may cause harmful interference to radio communications. However, there is no guarantee that interference will not occur in a particular installation. If this equipment does cause harmful interference to radio or television reception, which can be determined by turning the equipment off and on, the user is encouraged to try to correct the interference by one or more of the following measures:

- Reorient or relocate the receiving antenna.
- Increase the separation between the equipment and the receiver.

- Connect the equipment to an outlet on a circuit different from that to which the receiver is connected.
- Consult the dealer or an experienced radio/TV technician for help.

Caution: Changes or modifications not expressly approved by the party responsible for compliance could void the user's authority to operate the equipment.

ISED Compliance Statements

This Class B digital apparatus complies with Canadian ICES-003.



Reolink declares that this device is in compliance with the essential requirements and other relevant provisions of EMC Directive 2014/30/EU and LVD 2014/35/EU.

UKCA Declaration of Conformity

Reolink declares that this product is in compliance with the Electromagnetic Compatibility Regulations 2016 and Electrical Equipment Safety Regulations 2016.



Correct Disposal of This Product

This marking indicates that this product should not be disposed of with other household wastes. throughout the EU. To prevent possible harm to the environment or human health from uncontrolled waste disposal, recycle it responsibly to promote the sustainable reuse of material resources. To return your used device, please use the return and collection systems or contact the retailer where the product was purchased. They can take this product for environmentally safe recycling.

Limited Warranty

This product comes with a 2-year limited warranty that is valid only if purchased from the Reolink Official Store or a Reolink authorized reseller. Learn more: <https://reolink.com/warranty-and-return>.

NOTE: We hope that you enjoy the new purchase. But if you are not satisfied with the product and plan to return it, we strongly suggest that you reset the camera to factory default settings before returning it.

Terms and Privacy

Use of the product is subject to your agreement to the Terms of Service and Privacy Policy at reolink.com. Keep out of reach of children.

End User License Agreement

By using the Product Software that is embedded on the Reolink product, you agree to the terms of this End User License Agreement ("EULA") between you and Reolink. Learn more: <https://reolink.com/eula/>.

Technical Support

If you need any technical help, please visit our official support site and contact our support team before returning the products,

<https://support.reolink.com>

Terms and Privacy

Use of the product is subject to your agreement to the Terms of Service and Privacy Policy at reolink.com. Keep out of reach of children.

Technical support

If you need any technical help, please visit our official support site and contact our support team before returning the products:

<https://support.reolink.com>.

EU /REP /Product Ident GmbH

- Hoferstasse 9B, 71636 Ludwigsburg, Germany
- Email: prodsg@libelleconsulting.com

UK /REP/APEX CE SPECIALISTS LIMITED

- Addr.: 89 Princess Street, Manchester, M14HT, UK
- Email: info@apex-ce.com
- FB:@ReolinkTech
- <https://reolink.com>

Documents / Resources

	reolink RLC-D4K30 PoE IP Camera [pdf] User Guide RLC-D4K30 PoE IP Camera, RLC-D4K30, PoE IP Camera, IP Camera, Camera
---	--

References

- [ce.com](#)
- [Reolink Official: Security Cameras and Systems for Home & Business](#)
- [Reolink Official: Security Cameras and Systems for Home & Business](#)
- [Warranty & Return – Reolink](#)
- [Reolink Support - Official Reolink Help Center](#)
- [User Manual](#)

