

REOLINK RLC-840WA 4K WiFi 6 CAMERA



# reolink RLC-840WA 4K WiFi 6 Camera User Guide

[Home](#) » [reolink](#) » reolink RLC-840WA 4K WiFi 6 Camera User Guide 

## Contents

- 1 [reolink RLC-840WA 4K WiFi 6 Camera](#)
- 2 [Specifications](#)
- 3 [Product Usage Instructions](#)
- 4 [Adjusting Camera Viewing Angle](#)
- 5 [What's in the Box](#)
- 6 [Camera Introduction](#)
- 7 [Connection Diagram](#)
- 8 [Set up the Camera](#)
- 9 [Mount the Camera](#)
- 10 [Troubleshooting](#)
- 11 [Specification](#)
- 12 [Notification of Compliance](#)
- 13 [Limited Warranty](#)
- 14 [Documents / Resources](#)
  - 14.1 [References](#)
- 15 [Related Posts](#)



reolink RLC-840WA 4K WiFi 6 Camera



## Specifications

- **Model:** RLC-840WA
- **Resolution:** 4.5M
- **Power:** Power Adapter
- **Features:** Built-in Mic, 3000K Warm Lights, IR LEDs, Daylight Sensor, Waterproof Lid
- **Storage:** microSD Card Slot
- **Reset:** Reset Button
- **Connectivity:** Ethernet Cable

## Product Usage Instructions

### What's in the Box

The package includes the camera, power adapter, pack of screws, extension cable, mounting template, reset needle, Ethernet cable, and quick start guide.

### Camera Introduction

The camera features a built-in mic, warm lights, IR LEDs, daylight sensor, waterproof lid, power port, network cable port, microSD card slot, speaker, and reset button.

### Connection Diagram

#### Steps:

1. Connect the camera to a LAN port on your router using an Ethernet cable.
2. Power on the camera using the provided power adapter.

### Set up the Camera

Download and launch the Reolink App or Client software to complete the initial setup by following the on-screen instructions.

### Mount the Camera Installation Tips:

1. Place the mounting template on the ceiling and drill holes at the marked spots.
2. Remove the dome cover from the camera base using a hex key.
3. Securely attach the camera base to the ceiling.

## Adjusting Camera Viewing Angle

### Steps:

1. Align the arrows and notch on the camera base and module to adjust the viewing angle.
2. Tighten the screws to attach the dome cover to the camera base.

- **Camera is not Powering on**

If your camera is not powering on, try checking the power source and connections. If issues persist, contact Reolink Support.

- **Infrared LEDs Stop Working**

If the Infrared LEDs stop working, ensure they are enabled in settings. Contact Reolink Support if problems persist.

- **Picture is not Clear**

If the picture quality is poor, adjust camera settings and ensure proper positioning. Contact Reolink Support for further assistance.

## What's in the Box



Camera



4.5M Power\*  
Extension Cable



Power Adapter\*

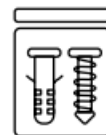

Pack of Screws



1M  
Ethernet Cable

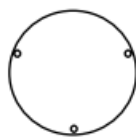

Mounting  
Template



Reset Needle



Surveillance  
Sticker



Quick Start Guide

## Camera Introduction

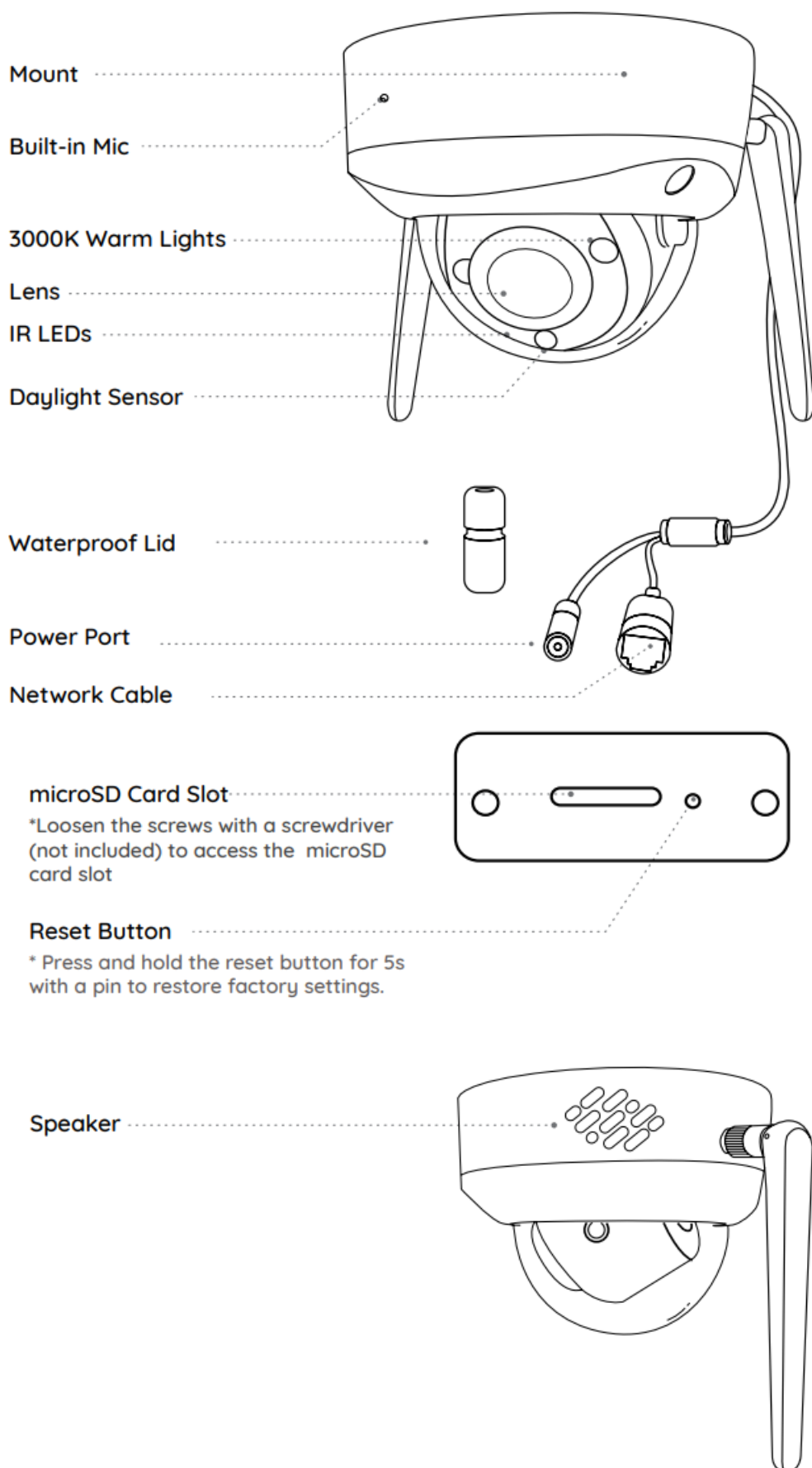

## Connection Diagram

Before initial setup, follow the steps below to connect your camera.

1. Connect the camera to a LAN port on your router with an Ethernet cable.

2. Use the power adapter to power on the camera.

**NOTE:**

Ensure that the antennas are installed before connecting the camera

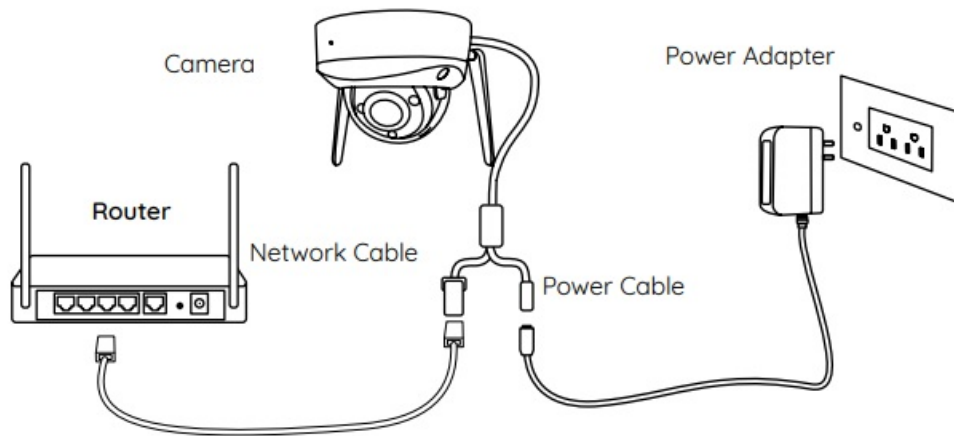

## Set up the Camera

Download and launch the Reolink App or Client software, and follow the onscreen instructions to finish initial setup.

- **On Smartphone**

Scan to download the Reolink App.



- **On PC**

Download path of the Reolink Client: Go to <https://reolink.com>Support>App&Client>.

**NOTE:**

- When setting up the WiFi camera, you need to follow the onscreen instructions to finish the WiFi configuration first.
- Once the camera successfully connects to the WiFi network, you can disconnect the Ethernet cable. The camera will now operate wirelessly.

## Mount the Camera

### Installation Tips

- Do not face the camera towards any light sources.
- Do not remove the protective film from the dome cover until the installation is complete.

- Do not point the camera towards a glass window. Or, it may result in poor image quality because of the window glare by infrared LEDs, ambient lights or status lights.
- Do not place the camera in a shaded area and point it towards a well-lit area. Or, it may result in poor image quality. To ensure the best image quality, the lighting condition for both the camera and the capture object shall be the same.
- To ensure better image quality, it's recommended to clean the dome cover with a soft cloth from time to time.
- Do not remove the protective film from the dome cover until the installation is complete.
- Make sure the power ports are not directly exposed to water or moisture and not blocked by dirt or other elements.
- With IP waterproof ratings, the camera can work properly under conditions like rain and snow. However, it doesn't mean the camera can work underwater.
- Do not install the camera at places where rain and snow can hit the lens directly.

## Install the Camera

1. Put the mounting template on the ceiling and drill holes at the indicated locations, then insert the drywall anchors.
2. Screw the dome cover off the camera base with the hex key.  
**NOTE:** Keep the protective film on the dome cover until the installation is complete.
3. Screw the camera base to the ceiling.

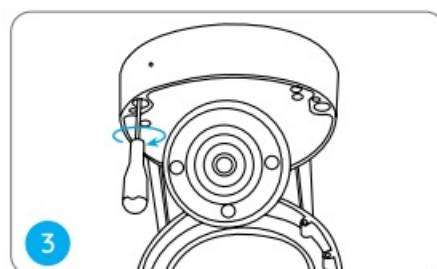
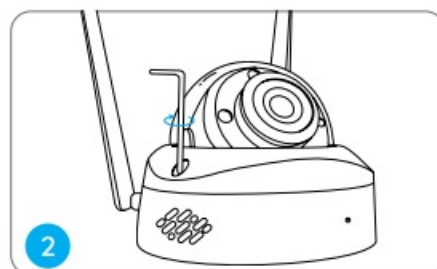
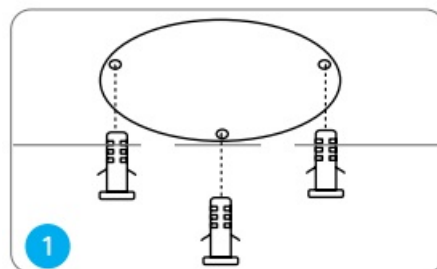

4. Adjust the camera's viewing angle as needed.
5. Align the arrows and the notch according to the diagram.
  1. Arrows on camera base
  2. Notch on camera module
  3. Arrow on camera top

6. Attach the dome cover to the camera base by tightening the screws.

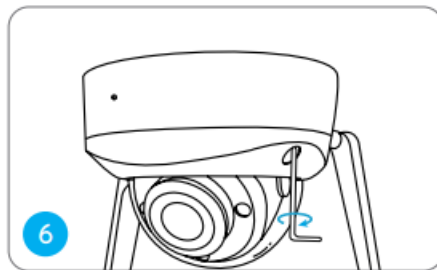
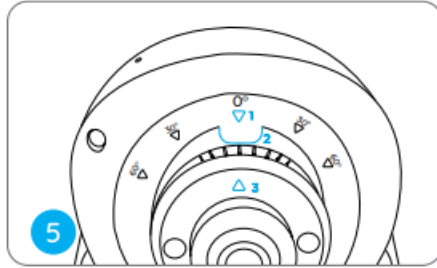
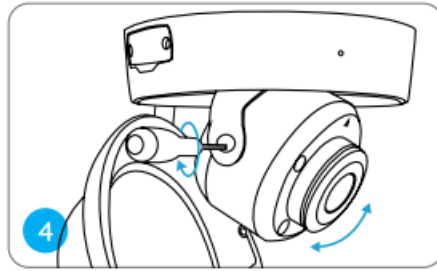

**NOTE:** Remove the protective film from the dome cover after the installation.

## Troubleshooting

### The camera is not Powering on

If your camera is not powering on, please try the following solutions:

- Please check whether the outlet is working properly or not. Try to plug the camera into a different outlet and see if it works.
- Please check whether the DC adapter is working or not. If you have another 12V DC power adapter that is working, please use another power adapter and see if it works.

If these won't work, contact Reolink Support at <https://support.reolink.com/>.

### Infrared LEDs Stop Working

If the Infrared LEDs of your camera stop working, please try the following solutions:

- Enable infrared lights on Device Settings page via Reolink App/Client.
- Check if the Day/Night mode is enabled and set up auto infrared lights at night on Live View page via Reolink App/Client.
- Upgrade the firmware of your camera to the latest version.
- Restore the camera to factory settings and check out the infrared light settings again.

If these won't work, contact Reolink Support at <https://support.reolink.com/>.

### **The picture is not Clear**

If the picture from the camera is not clear, please try the following solutions:

- Check the camera dome cover for dirt, dust or spiderwebs, and clean the dome cover with a soft, clean cloth. The dust-absorber included in the package is recommended.
- Point the camera to a well-lit area, as the lighting condition will affect the picture quality a lot.
- Upgrade the firmware of your camera to the latest version.
- Restore the camera to factory settings and check out again.

### **Specification**

- **Dimension:**  $\Phi 117 \times 86 \text{mm}$
- **Weight:** 604.1g
- **Operating Temperature:**  $-10^{\circ}\text{C} \sim +55^{\circ}\text{C}$  ( $14^{\circ}\text{F} \sim 131^{\circ}\text{F}$ )

For more Specifications, visit <https://reolink.com/>.

### **Notification of Compliance**

#### **FCC Compliance Statement**

This device complies with Part 15 of the FCC Rules.

#### **Operation is subject to the following two conditions:**

1. this device may not cause harmful interference, and
2. this device must accept any interference received, including interference that may cause undesired operation.

#### **Note:**

This equipment has been tested and found to comply with the limits for a Class B digital device, pursuant to Part 15 of the FCC Rules. These limits are designed to provide reasonable protection against harmful interference in a residential installation. This equipment generates, uses and can radiate radio frequency energy and, if not installed and used in accordance with the instructions, may cause harmful interference to radio communications. However, there is no guarantee that interference will not occur in a particular installation. If this equipment does cause harmful interference to radio or television reception, which can be determined by turning the equipment off and on, the user is encouraged to try to correct the interference by one or more of the following measures:

- Reorient or relocate the receiving antenna.
- Increase the separation between the equipment and receiver.
- Connect the equipment into an outlet on a circuit different from that to which the receiver is connected.
- Consult the dealer or an experienced radio/TV technician for help.

**Caution:** Changes or modifications not expressly approved by the party responsible for compliance could void the user's authority to operate the equipment.

#### **FCC Radiation Exposure statement**

This equipment complies with FCC radiation exposure limits set forth for an uncontrolled environment. This



equipment should be installed and operated with minimum distance 20cm between the radiator and your body.

### **ISED Compliance Statements**

This device contains licence-exempt transmitter(s)/receiver(s) that comply with Innovation, Science and Economic Development Canada's licence-exempt RSS(s).

### **Operation is subject to the following two conditions:**

1. This device may not cause interference.
2. This device must accept any interference, including interference that may cause undesired operation of the device

### **ISED Radiation Exposure statement**

This equipment complies with IC RSS-102 radiation exposure limits set forth for an uncontrolled environment. This equipment should be installed and operated with minimum distance 20 cm between the radiator and your body.

### **Simplified EU Declaration of Conformity**

Reolink declares that this device is in compliance with the essential requirements and other relevant provisions of Directive 2014/53/EU and Directive 2014/30/EU. The functions of Wireless Access Systems including Radio Local Area Networks(WAS/RLANs) within the band 5150-5350 MHz for this device are restricted to indoor use only within all European Union countries (BE/BG/CZ/DK/DE/EE/IE/EL/ES/FR/HR/ IT/CY/LV/LT/ LU/HU/MT/NL/AT/PL/PT/RO/SI/SK/FI/SE/TR/N O/CH/IS/LI/UK(NI)

### **Correct Disposal of This Product**

This marking indicates that this product should not be disposed with other household wastes. throughout the EU. To prevent possible harm to the environment or human health from uncontrolled waste disposal, recycle it responsibly to promote the sustainable reuse of material resources. To return your used device, please use the return and collection systems or contact the retailer where the product was purchased. They can take this product for environmentally safe recycling.

### **Limited Warranty**

This product comes with a 2-year limited warranty that is valid only if purchased from Reolink Official Store or a Reolink authorized reseller Learn more: <https://reolink.com/warranty-and-return/>.

### **Terms and Privacy**

Use of the product is subject to your agreement to the Terms of Service and Privacy Policy at reolink.com. Keep out of reach of children.

**The radio transmitter IC:** 26839-2310A has been approved by Innovation, Science and Economic Development Canada to use the following antenna types with a specified maximum allowable gain. Antenna types not included in this list whose gain is higher than the maximum gain of any of the listed types are strictly prohibited from use with this device.

Type of antenna	External antenna
Antenna Gain	2400-2500MHz(3.01dBi) 5150-5850MHz (4.38dBi)
Impedance	50hm
Manufacture	Shenzhen Be-Comfortable Technology Co. Ltd

## Documents / Resources

	<a href="#">reolink RLC-840WA 4K WiFi 6 Camera</a> [pdf] User Guide 2310A, 2AYHE-2310A, 2AYHE2310A, RLC-840WA 4K WiFi 6 Camera, RLC-840WA, RLC-840W A WiFi 6 Camera, 4K WiFi 6 Camera, WiFi 6 Camera, 4K Camera, Camera
---	---

## References

- [🔗 Reolink Official: Security Cameras and Systems for Home & Business](#)
- [🔗 Reolink Official: Security Cameras and Systems for Home & Business](#)
- [🔗 Warranty & Return – Reolink](#)
- [🔗 Reolink Support - Official Reolink Help Center](#)
- [User Manual](#)

### Manuals+, Privacy Policy

This website is an independent publication and is neither affiliated with nor endorsed by any of the trademark owners. The "Bluetooth®" word mark and logos are registered trademarks owned by Bluetooth SIG, Inc. The "Wi-Fi®" word mark and logos are registered trademarks owned by the Wi-Fi Alliance. Any use of these marks on this website does not imply any affiliation with or endorsement.