

**reolink**  
**RLC-510WA 5MP**  
**Wireless WiFi**  
**Smart Camera**



# reolink RLC-510WA 5MP Wireless WiFi Smart Camera User Guide

[Home](#) » [reolink](#) » reolink RLC-510WA 5MP Wireless WiFi Smart Camera User Guide 

## Contents

- [1 reolink RLC-510WA 5MP Wireless WiFi Smart Camera](#)
- [2 Product Usage Instructions](#)
- [3 Specifications](#)
- [4 Setup and Install](#)
- [5 Install the Camera](#)
- [6 FAQ](#)
- [7 Documents / Resources](#)
  - [7.1 References](#)



**reolink RLC-510WA 5MP Wireless WiFi Smart Camera**



## Product Usage Instructions

- Tap the icon on the top right corner.
- Scan the QR code on the back of the camera or manually input UID/IP.
- Create a password for your camera and name it.
- Select the WiFi network, enter the password, and save the network configuration.
- Once done, the camera initialization is finished.
- Drill holes according to the mounting hole template.
- Install the mount base using the provided screws.
- Run the cable through the cable notch and adjust the antenna position for WiFi cameras.
- Adjust the camera angle using the adjustment knob or screw.

## RLC-510WA

- RLC-510WA with 5MP/4MP super HD provides you with a clearer visual quality & smoother live viewing experience.
- You can stay better informed with the hard-to-see details captured by the camera.

## Specifications

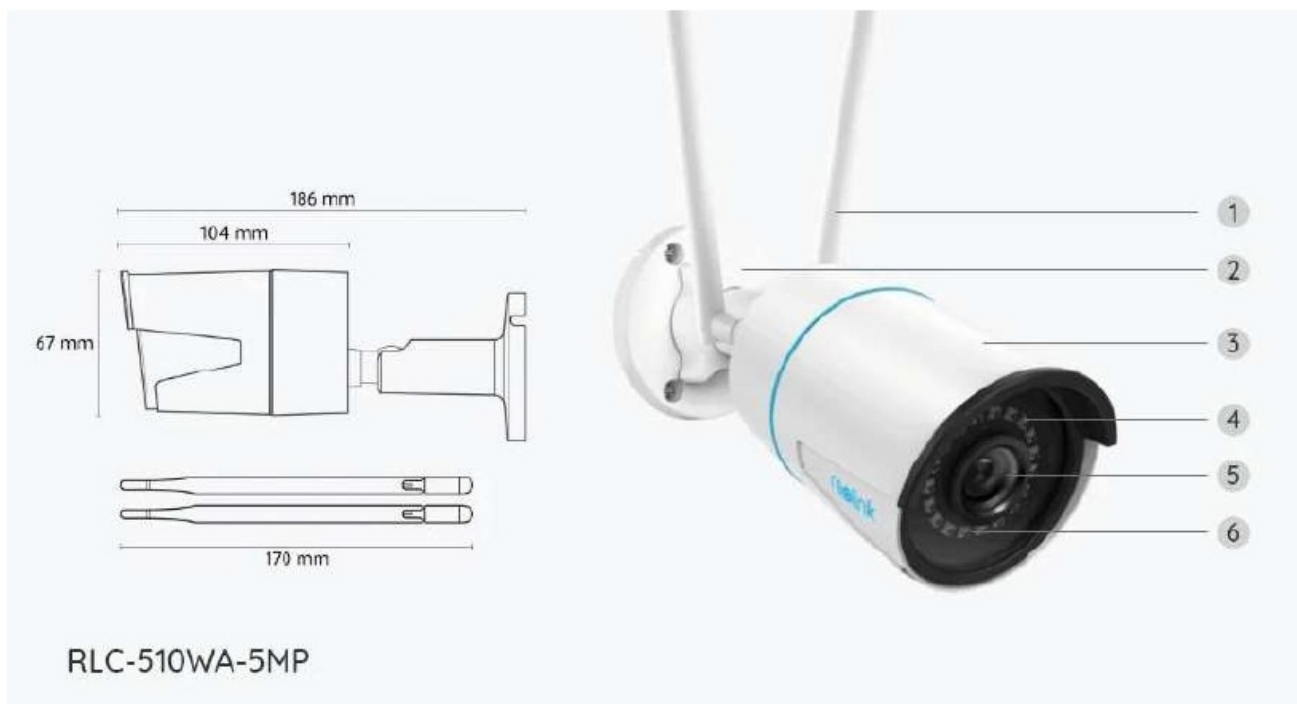

1	Antenna
2	Mount
3	Metal Aluminum Case
4	18 IR LEDs
5	High-Definition Lens (f=4.0mm)
6	Daylight Sensor

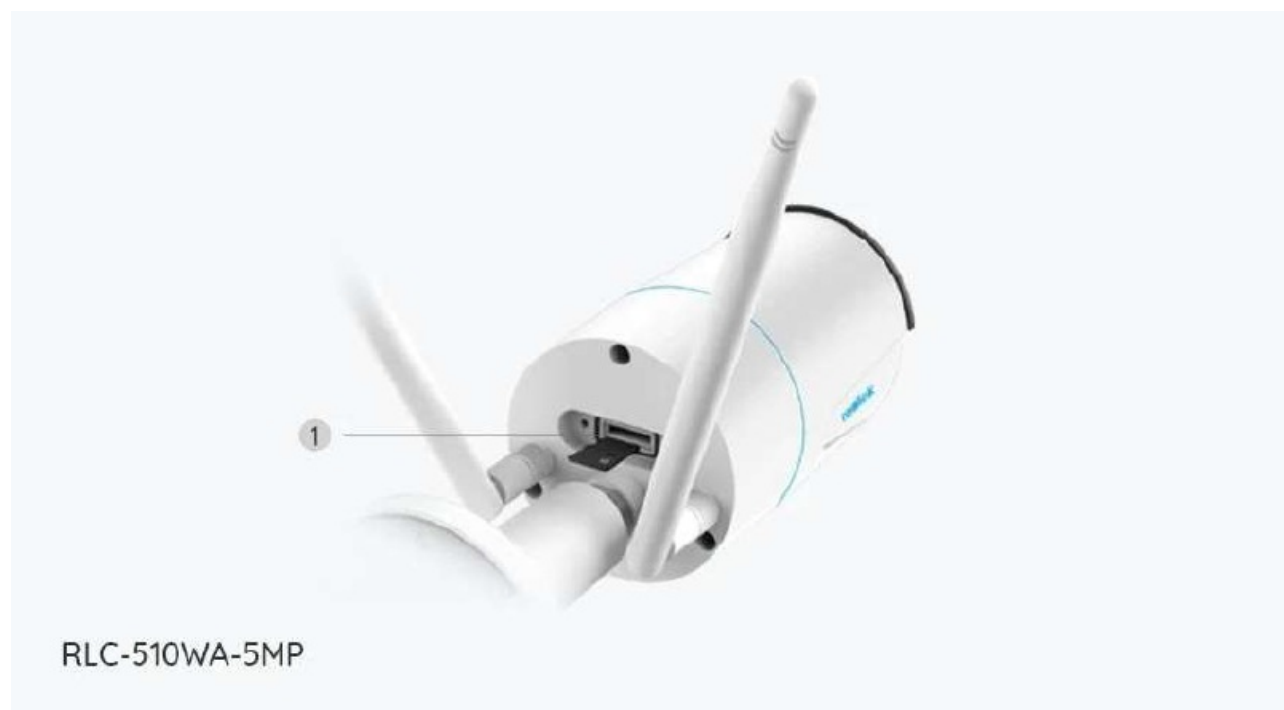

1. Micro SD Card Slot



1	Power
2	Reset Button
3	Network
4	Waterproof Lid

## Setup and Install

### Set up the Camera

What's in the Box

**Note:** The package content may vary and update with different versions and platforms, please take the below information only for reference. And the actual package content is subject to the latest information on the product selling page.

## RLC-510WA



RLC-510WA\*1



1m Network  
Cable\*1



Quick Start Guide\*1



Surveillance Sticker\*1



Pack of Screws\*1

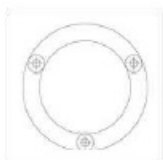

Mounting Template \*1



Wrench\*1



4.5m Power Extension  
Cable \*1



Power Adapter \*1

### Set up the Camera on the App

For Reolink WiFi cameras with LAN ports but without voice prompts, here is a simple guide for you to get the initial setup done.

- **Step 1.** Tap the icon  on the top right corner.

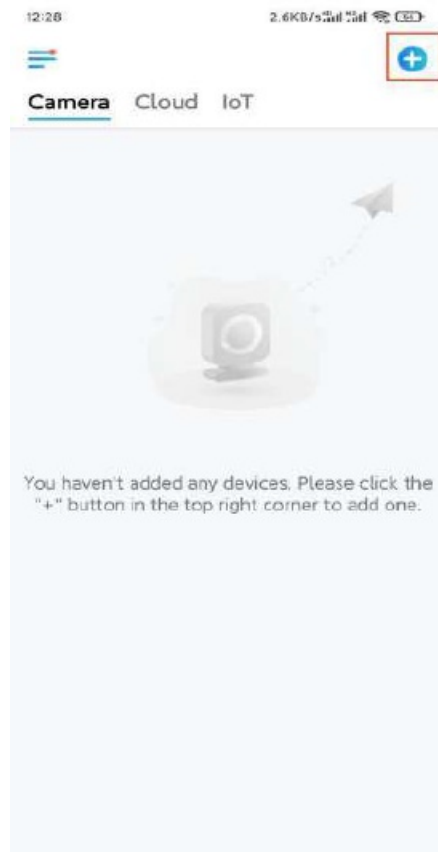

**Note:** If you've enabled the Add Device Automatically option on the App's Settings page, you can tap this device on the Devices page and turn to Step 3 directly.

- **Step 2.** Scan the QR code on the back of the camera. You may tap Light to enable a flashlight when setting up the camera in a dark environment.
- If the phone doesn't respond, please tap Input UID/IP and then manually type in the UID (16-digit characters under the QR code of the camera). Then tap Next.

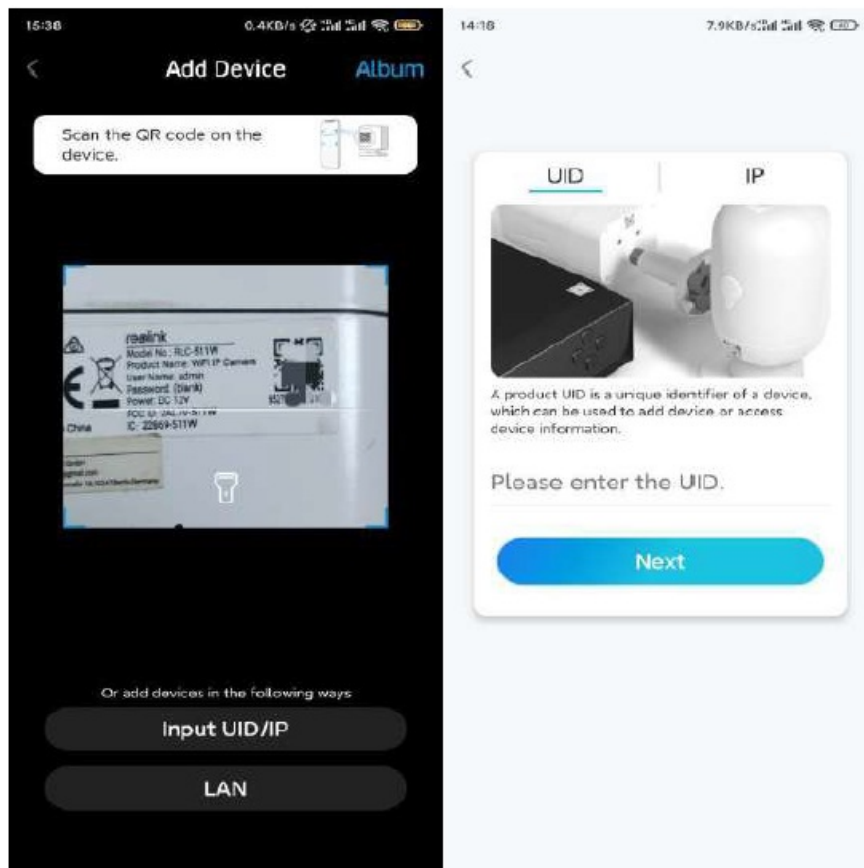

- **Step 3.** Create the password for your camera. Then tap Next.



- **Step 4.** Name your camera. Then tap **Next**.



- **Step 4.** Name your camera. Then tap Next.

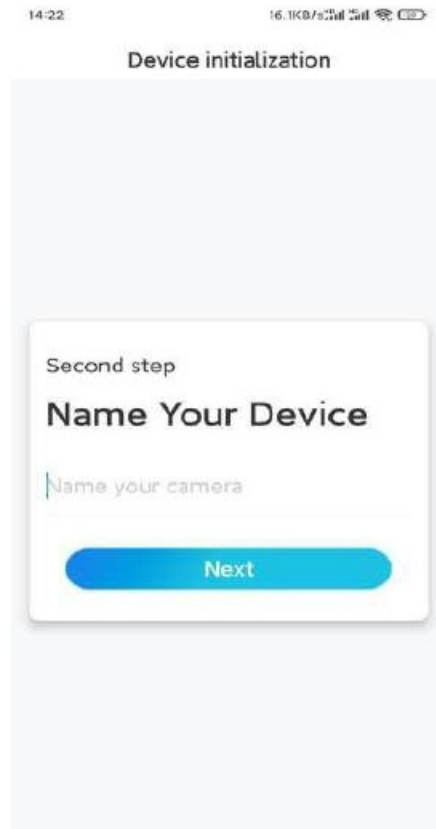

- **Step 5.** Tap the WiFi network you want to join and enter the password of the WiFi network. Then tap Save to save the network configuration.

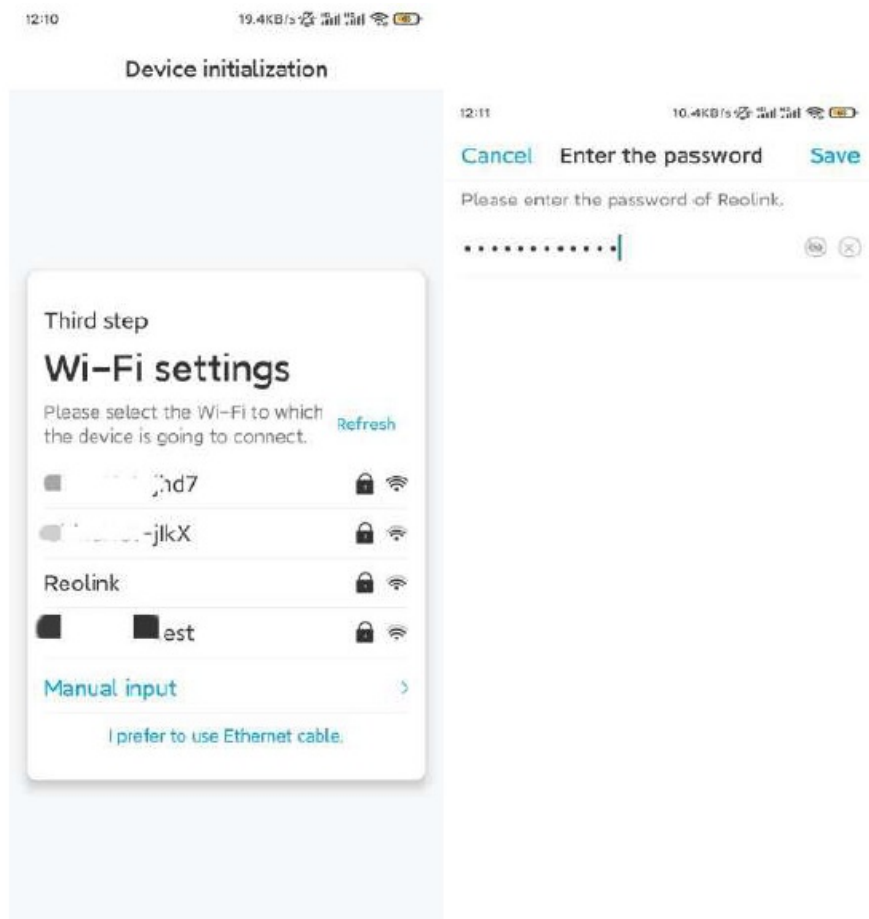



- **Step 6.** Done! The initialization of your camera is finished.

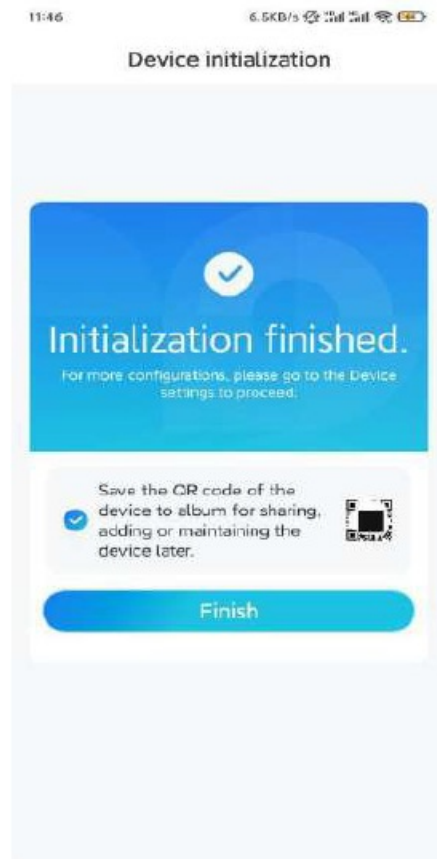

**Note:** If this device can't connect to the WiFi after you remove the Ethernet cable, you can connect it to the router again and see if it can pass the WiFi test.

## Install the Camera

Please follow the steps below to install the camera.

**Step 1.** Drill holes under the mounting hole template.

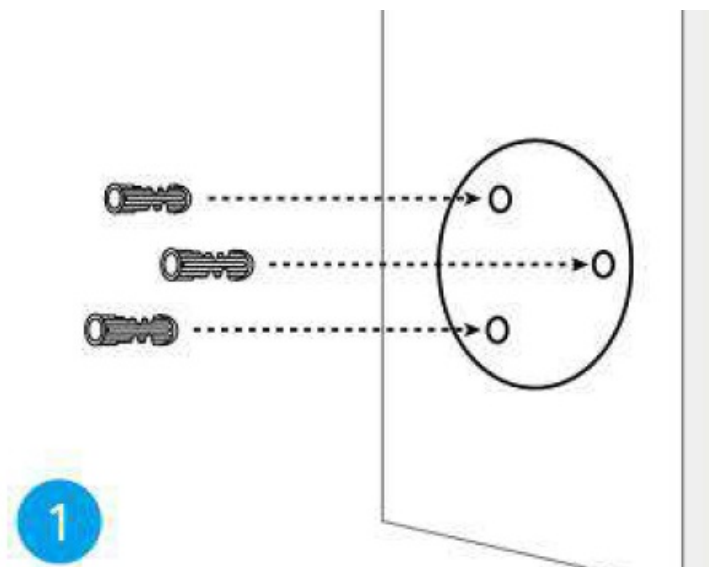

- **Step 2.** Install the mount base with the mounting screws included in the package.

(For WiFi cameras, please install the antenna in advance)

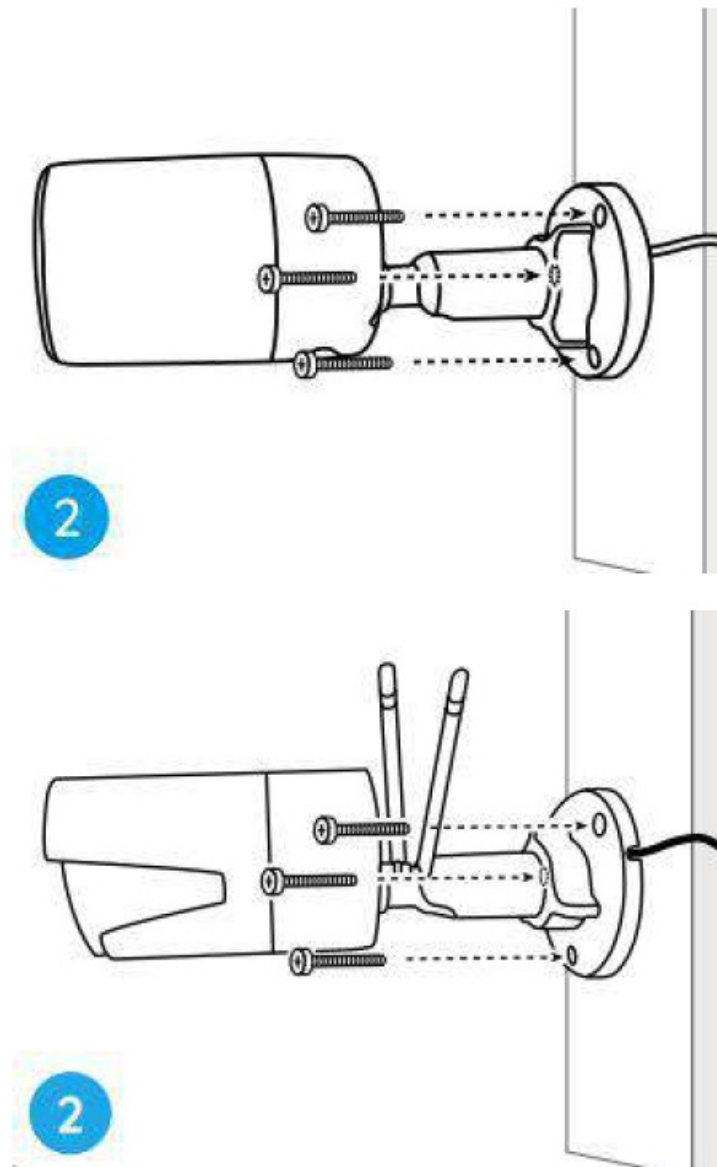

## Notes

- Run the cable through the cable notch on the mount base.
- As for the WiFi camera, it is recommended that the antennas be installed upward or horizontally for better WiFi connection.
- **Step 3.** Loosen the adjustment knob by twisting it counterclockwise on the security mount, and turn the camera to get an ideal view.

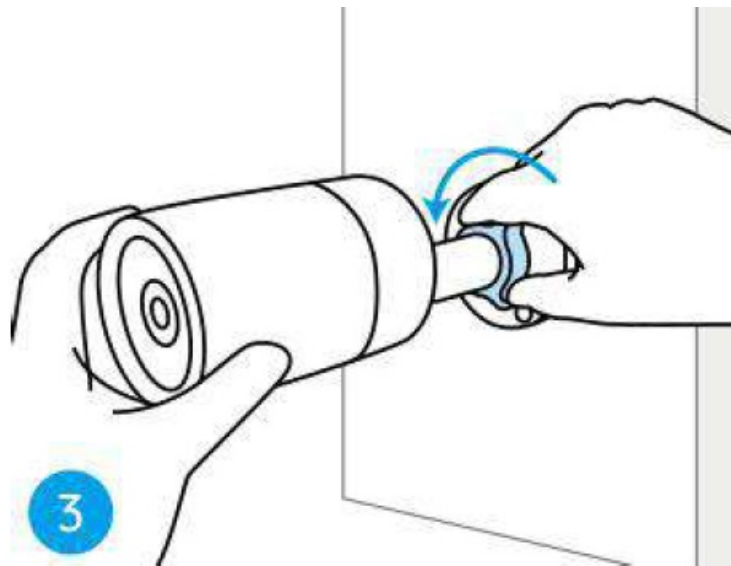

- **Step 4.** Turn the knob clockwise to fix the camera in place.

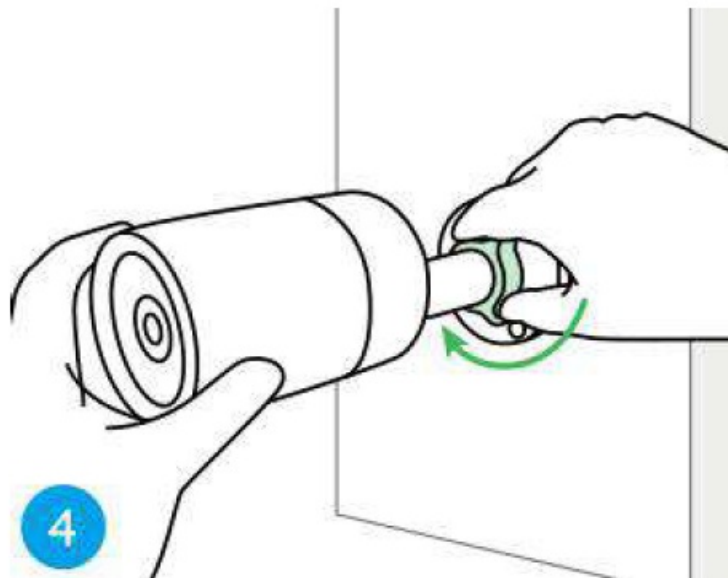

**Note:** If your camera has another mount without the adjusting knob, please loosen the adjusting screw with the provided hex key and turn the camera as shown below to adjust the angle.

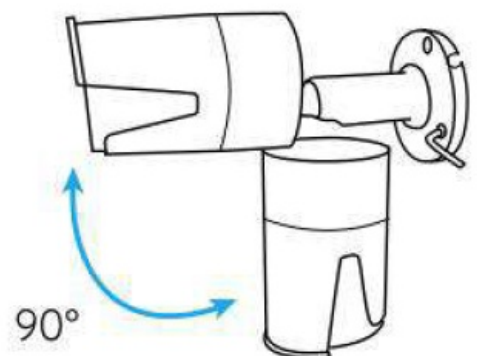
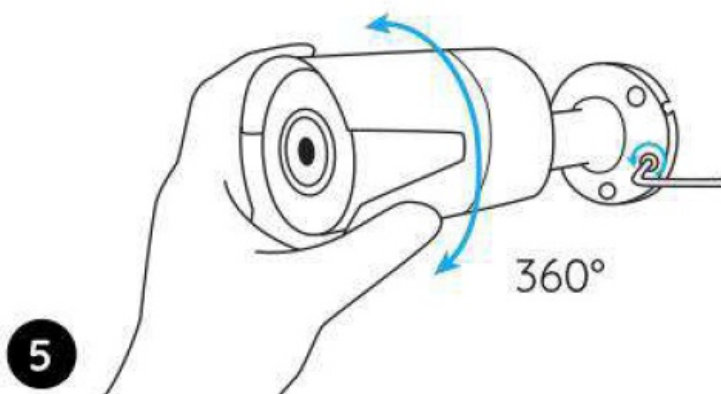

- **Q: What should I do if my camera fails to connect to WiFi?**
  - **A:** If the camera can't connect to WiFi after removing the Ethernet cable, reconnect it to the router and perform a WiFi test.

**Documents / Resources**

	<p><a href="#">reolink RLC-510WA 5MP Wireless WiFi Smart Camera</a> [pdf] User Guide</p> <p>RLC-510WA, RLC-510WA 5MP Wireless WiFi Smart Camera, 5MP Wireless WiFi Smart Camera, Wireless WiFi Smart Camera, WiFi Smart Camera, Smart Camera</p>
---	--

**References**

-  [Your Ultimate Resource for Millions of User Manuals](#)
- [User Manual](#)

[Manuals+](#), [Privacy Policy](#)

This website is an independent publication and is neither affiliated with nor endorsed by any of the trademark owners. The "Bluetooth®" word mark and logos are registered trademarks owned by Bluetooth SIG, Inc. The "Wi-Fi®" word mark and logos are registered trademarks owned by the Wi-Fi Alliance. Any use of these marks on this website does not imply any affiliation with or endorsement.