



reolink RLC-1212A Intelligent Poe Bullet Camera Instruction Manual

[Home](#) » [reolink](#) » reolink RLC-1212A Intelligent Poe Bullet Camera Instruction Manual 

reolink RLC-1212A Intelligent Poe Bullet Camera



Contents

- 1 What's in the Box
- 2 Camera Introduction
- 3 Connection Diagram
- 4 Set up the Camera
- 5 Mount the Camera
- 6 Troubleshooting
- 7 Specifications
- 8 Notification Of Compliance
- 9 Limited Warranty
- 10 Documents / Resources
 - 10.1 References

What's in the Box

- Camera

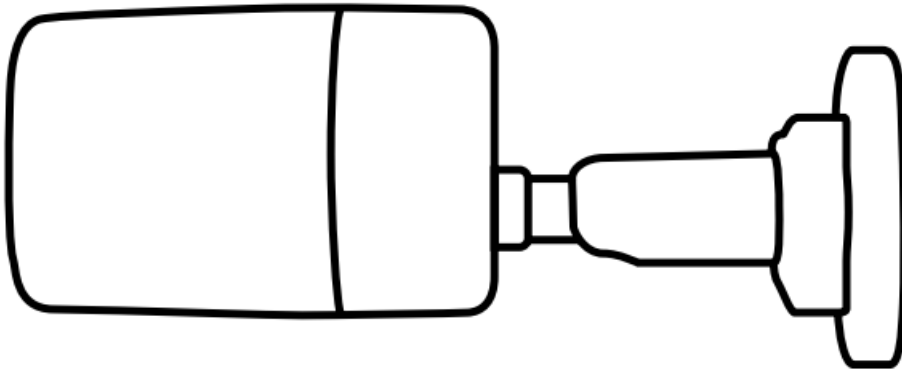

- Waterproof Lid

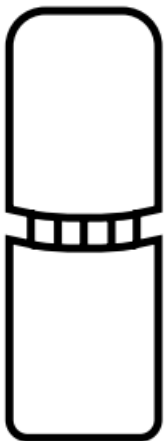

- Ethernet Cable

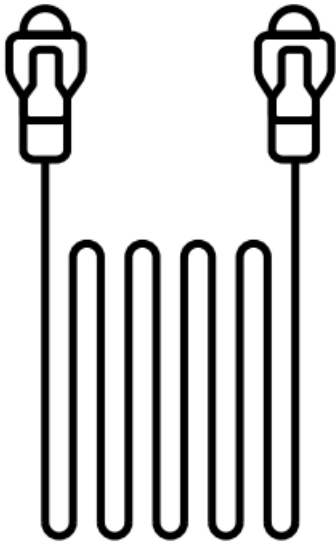

- Quick Start Guide



- Surveillance Sign



- Mounting Hole Template

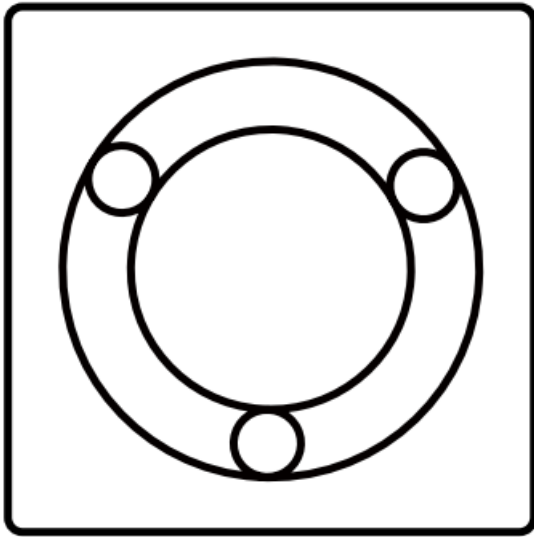

- Pack of Screws

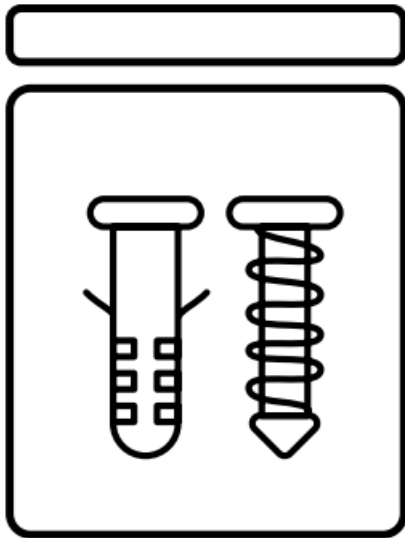

Camera Introduction

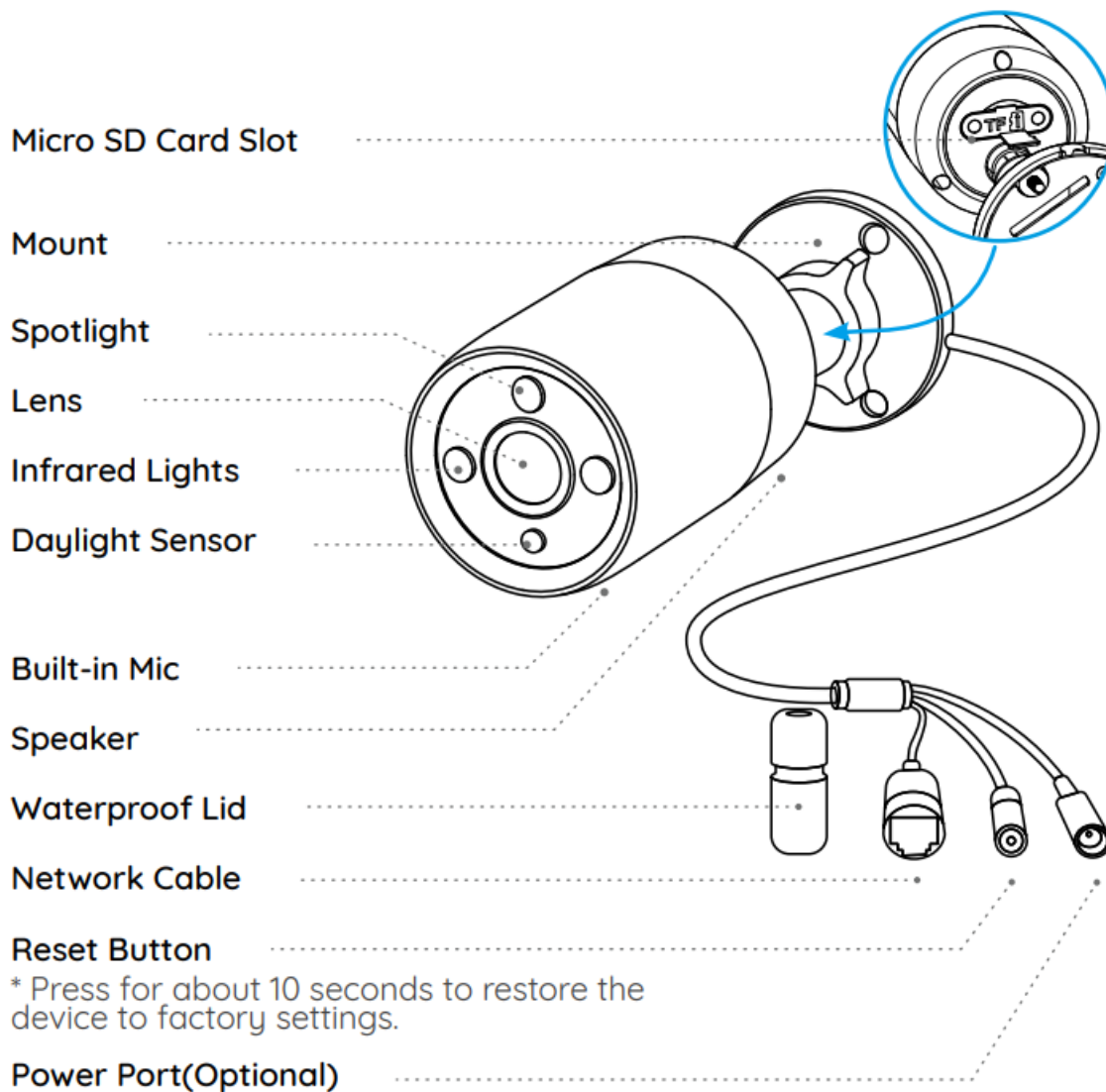

Connection Diagram

Before using the camera, please connect your camera as instructed below to finish initial setup.

1. Connect the camera to a Reolink NVR (not included) with an Ethernet cable.
2. Connect the NVR to your router, and then power on the NVR.

NOTE: The camera should be powered with a 12V DC adapter or a PoE powering device such as PoE injector, PoE switch or Reolink NVR (not included in the package).

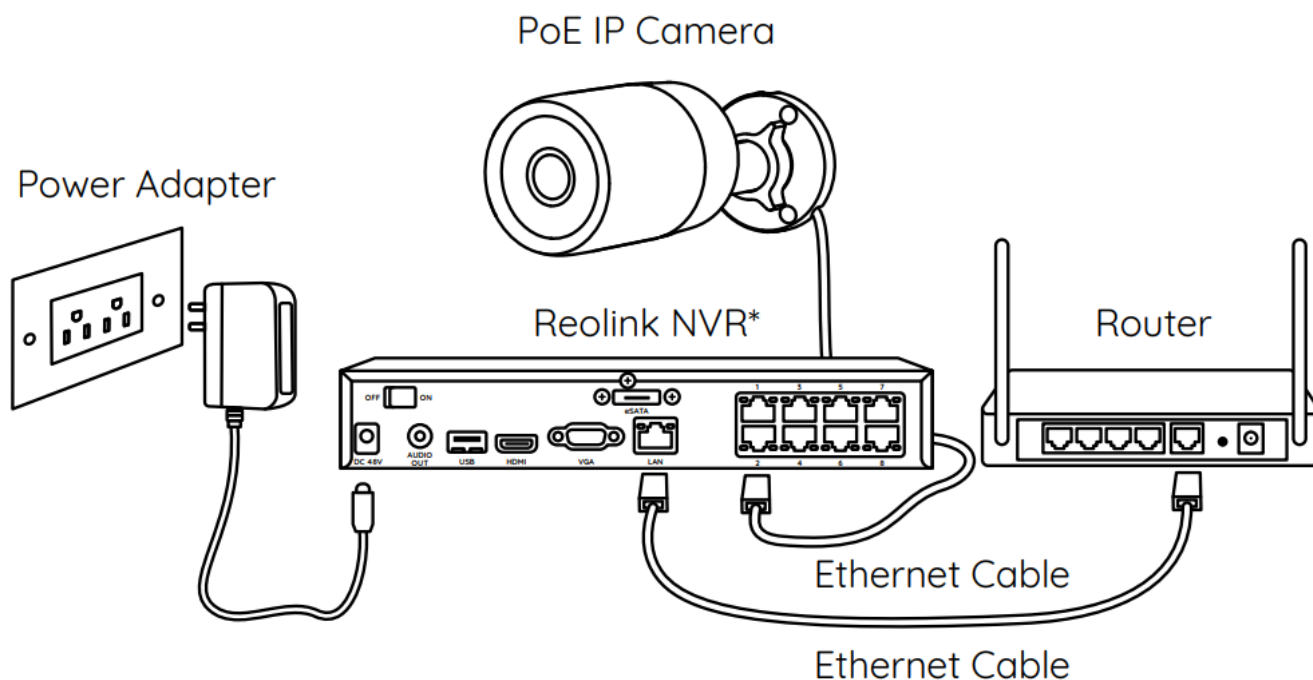

* You may also connect the camera to a PoE switch or PoE injector.

Set up the Camera

Download and launch the Reolink App or Client software, and follow the onscreen instructions to finish initial setup.

- On Smartphone

Scan to download the Reolink App.

NOTE: If you are connecting the camera to a Reolink PoE NVR, please set up the camera via the NVR interface.

Mount the Camera

Installation Tips

- Do not face the camera towards any light sources.
- Do not point the camera towards a glass window. Or, it may result in poor image quality because of the window glare by infrared LEDs, ambient lights or status lights.
- Do not place the camera in a shaded area and point it towards a well-lit area. Or, it may result in poor image quality. To ensure best image quality, the lighting condition for both the camera and the capture object shall be the same.
- To ensure better image quality, it's recommended to clean the lens with a soft cloth from time to time.
- Make sure the power ports are not directly exposed to water or moisture and not blocked by dirt or other elements.
- With IP waterproof ratings, the camera can work properly under conditions like rain and snow. However, it doesn't mean the camera can work underwater.
- Do not install the camera at places where rain and snow can hit the lens directly.
- The camera may work in extreme cold conditions as low as -25°C. Because when it is powered on, the camera will produce heat. You may power on the camera indoors for a few minutes before installing it outdoors.

Install the Camera

- Drill holes in accordance with the mounting hole template.

NOTE: Use the drywall anchors included in the package if needed.

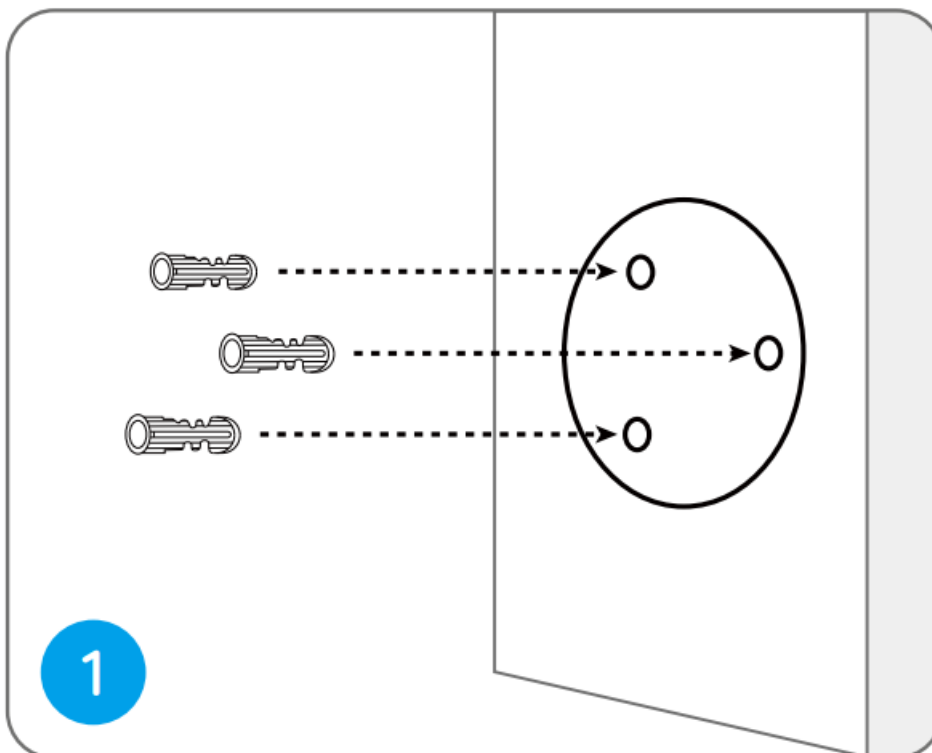

- Install the mount base with the mounting screws included in the package.

NOTE: Run the cable through the cable notch on the mount base.

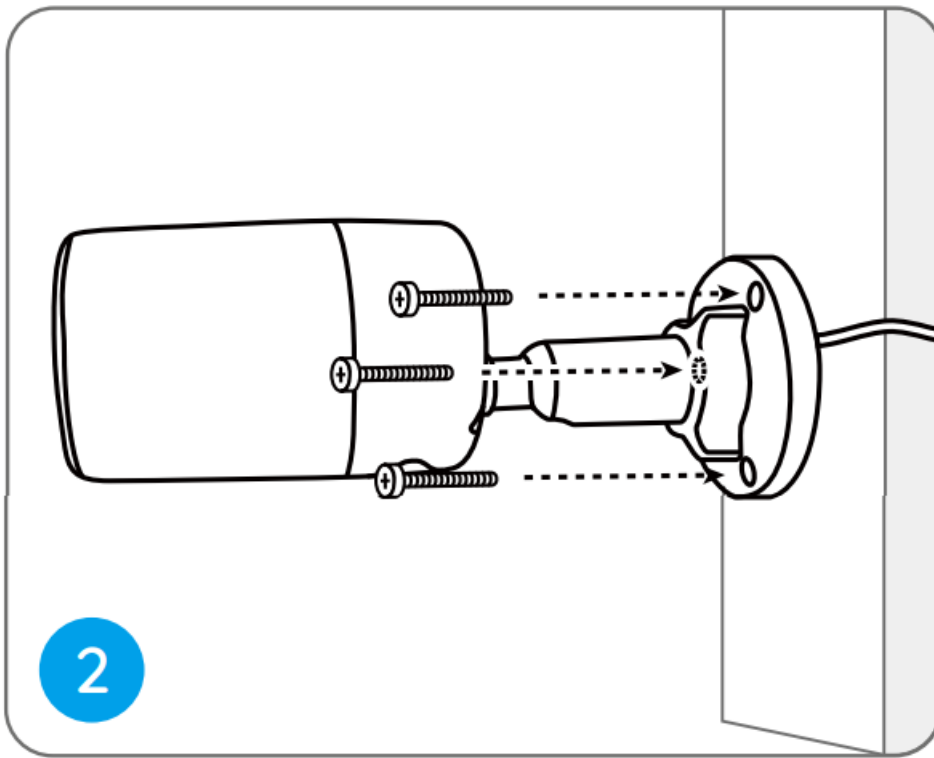

- To get the best field of view, loosen the adjustment knob on security mount and turn the camera.

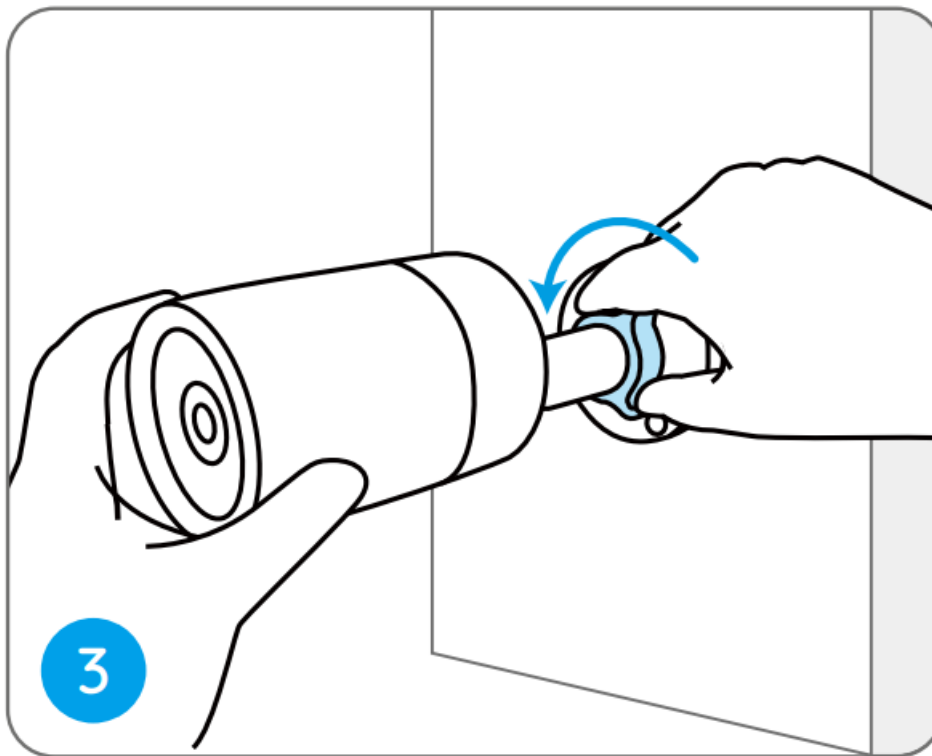

- Stiffen the adjustment knob to lock the camera.

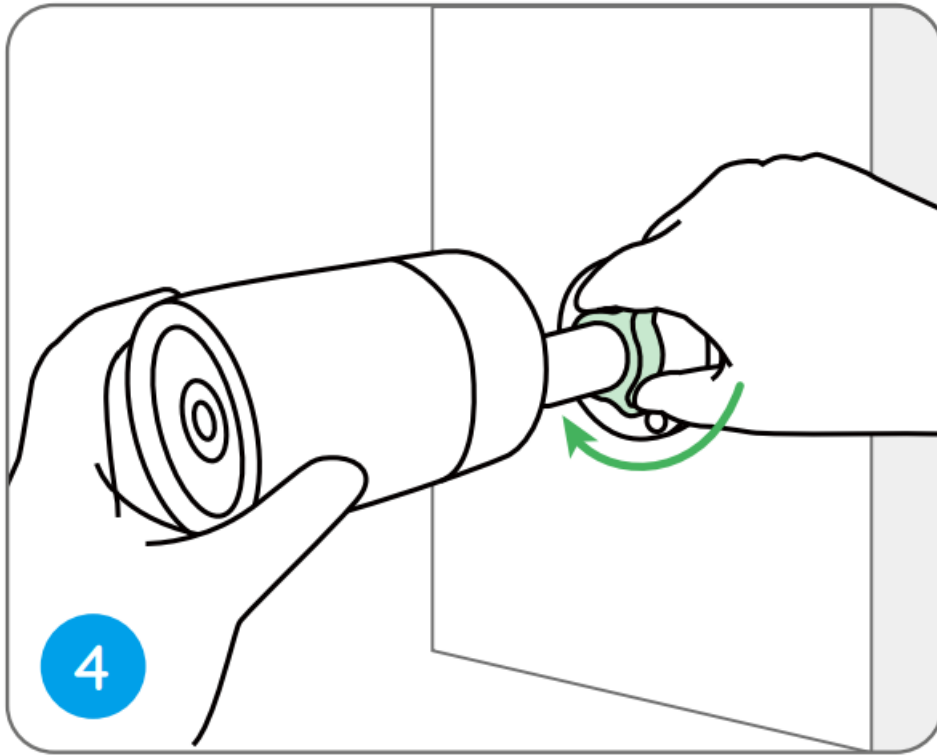

Troubleshooting

Camera is not Powering On

If your camera is not powering on, please try the following solutions:

- Make sure your camera is powered properly. The PoE camera should be powered by a PoE switch/injector, the Reolink NVR or a 12V power adapter.
- If the camera is connected to a PoE device as listed above, connect the camera to another PoE port and see if the camera will power on.
- Try again with another Ethernet cable.

Picture is not Clear

If the picture from the camera is not clear, please try the following solutions:

- Check the camera lens for dirt, dust or spiderwebs, please clean the lens with a soft, clean cloth.
- Point the camera to a well-lit area, the lighting condition will affect the picture quality a lot.
- Upgrade the firmware of your camera to the latest version.
- Restore the camera to factory settings and check out again.

Spotlight is not On

If the spotlight on your camera is not on, please try the following solutions:

- Ensure the spotlight is enabled under Device Settings page via Reolink App/Client.
- Upgrade the firmware of your camera to the latest version.

- Restore the camera to factory settings and check out the spotlight light settings again.

Specifications

Hardware Features

Power: By PoE (802.3af)/DC 12V

Day/Night Mode: Auto Switchover

General

Operating Temperature: -10°C to 55°C (14°F to 131°F)

Operating Humidity: 10%-90%

Notification Of Compliance

FCC Compliance Statement

This device complies with Part 15 of FCC Rules. Operation is subject to the following two conditions: **(1)** this device may not cause harmful interference, and **(2)** this device must accept any interference received, including interference that may cause undesired operation.

NOTE: This equipment has been tested and found to comply with the limits for a Class B digital device, pursuant to Part 15 of the FCC Rules. These limits are designed to provide reasonable protection against harmful interference in a residential installation.



Simplified EU Declaration of Conformity

Reolink declares that this device is in compliance with the essential requirements and other relevant provisions of Directive 2014/30/EU.



Correct Disposal of This Product

This marking indicates that this product should not be disposed with other household wastes. Throughout the EU. To prevent possible harm to the environment or human health from uncontrolled waste disposal, recycle it responsibly to promote the sustainable reuse of material resources. To return your used device, please use the return and collection systems or contact the retailer where the product was purchased. They can take this product for environmentally safe recycling.

Limited Warranty

This product comes with a 2-year limited warranty that is valid only if purchased from Reolink Official Store or a Reolink authorized reseller.

NOTE: We hope that you enjoy the new purchase. But if you are not satisfied with the product and plan to return, we strongly suggest that you reset the camera to factory default settings before returning.

Terms and Privacy

Use of the product is subject to your agreement to the Terms of Service and Privacy Policy Keep out of reach of children.

End User License Agreement

By using the Product Software that is embedded on the Reolink product, you agree to the terms of this End User License Agreement ("EULA") between you and Reolink.



Documents / Resources

	reolink RLC-1212A Intelligent Poe Bullet Camera [pdf] Instruction Manual RLC-1212A Intelligent Poe Bullet Camera, RLC-1212A, Intelligent Poe Bullet Camera, Poe Bullet Camera, Bullet Camera, Camera
------------------------------------------------------------------------------------	-------------------------------------------------------------------------------------------------------------------------------------------------------------------------------------------------------------------------

References

- [User Manual](#)