



reolink Go PT Digital Outdoor Security Camera User Guide

[Home](#) » [reolink](#) » reolink Go PT Digital Outdoor Security Camera User Guide 

reolink Go PT Digital Outdoor Security
Camera User Guide



Reolink Go PT Operational Instruction

April, 2020
QSG1_A

Contents

- [1 What's in the Box](#)
- [2 Camera Introduction](#)
- [3 Insert the SIM Card and SD Card](#)
- [4 Register on Network \(Camera Initial Setup\)](#)
- [5 Set up Camera on Reolink App \(For Smartphone\)](#)
- [6 Notes on Camera Installation](#)
- [7 Charge the Battery](#)
- [8 Install the Security Mount](#)
- [9 Attach the Camera to a Tree](#)
- [10 Troubleshooting](#)
- [11 Specifications](#)
- [12 Notification of Compliance](#)
- [13 Documents / Resources](#)
 - [13.1 References](#)
- [14 Related Posts](#)

What's in the Box

Reolink Go PT ×1
Antenna x1
Camera Bracket ×1
Micro USB Cable ×1
Quick Start Guide ×1
Surveillance Sign ×1
Mounting Hole Template ×1
Reset Needle/Screws (in pack) ×1

Camera Introduction



Insert the SIM Card and SD Card

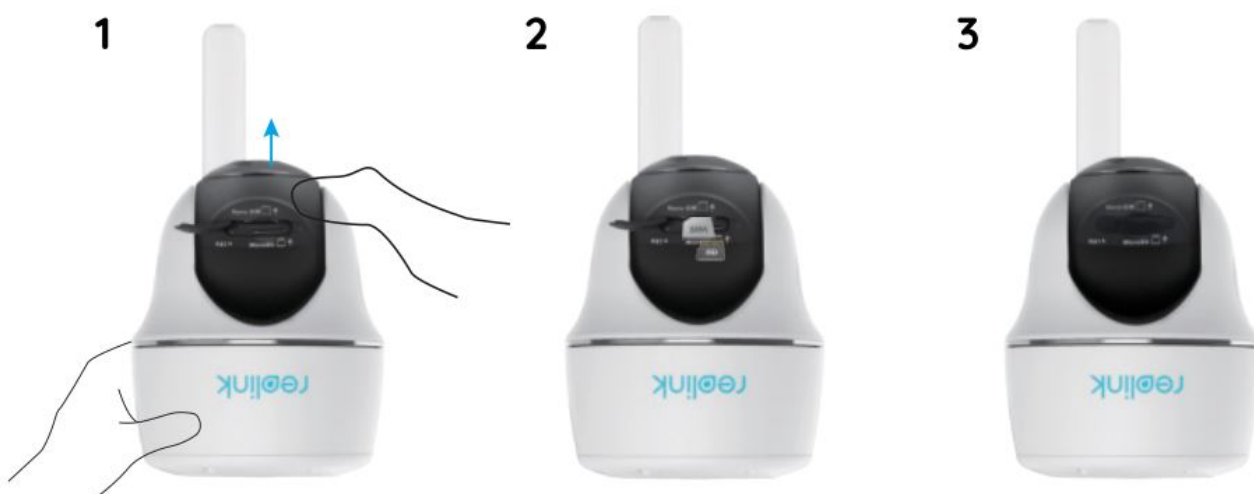

1. Rotate the camera lens, and remove the rubber cover.

2. Insert the SIM card.

◆The SIM card slot is above the SD card slot. When inserting it in, please note that gold contacts on the SIM card shall face down, and the trimmed corner shall be inside the camera.

◆The SD card slot is below the SIM card slot. When inserting it in, please note that gold contacts on the SD card shall face up.

3. With these done, please press the rubber cover firmly for better waterproof performance.

◆ Tips on How to Choose the Right SIM Card

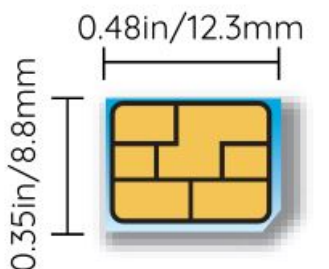

Nano-SIM / 4FF

Required size of a nano SIM card:

- The SIM card shall support WCDMA and FDD LTE.
- Some SIM cards have a PIN code. Please use your smartphone to disable the PIN first.
- Activate the card on your smartphone or with your network carrier before inserting it into the camera.
- If the SIM card is not purchased from the supported carrier, you may need to manually import the APN settings. Please find instructions at <https://support.reolink.com> or contact Reolink support.

NOTICE: Please make sure the SIM card can work for your smartphone.

Register on Network (Camera Initial Setup)



1. After inserting the SIM card, you can turn on the camera.



2. Wait a few seconds and a red light will be on and solid for a couple of seconds. Then it will go out.



3. A blue LED will flash for a few seconds and then go solid before going out. You will hear a voice prompt "Network connection succeeded", which means the camera has been successfully connected to the network.

NOTICE: You may also run into the following situations:

	Voice Prompt	Camera Status	Solutions
1	"SIM card cannot be recognized"	Camera cannot recognize this SIM card.	1. Check if the SIM card is facing the reverse direction. 2. Check if the SIM card is not fully inserted and insert it again
2	"The SIM card is locked with a PIN. Please disable it"	Your SIM card has a PIN.	Put the SIM card into your mobile phone and disable the PIN.
3	"Not registered on network. Please activate your SIM card and check the signal strength"	Camera fails to register to the operator network.	1. Check whether your card is activated or not. If not, please call your operator to activate the SIM card. 2. The signal is weak at the current position. Please move the camera to a location with better signal. 3. Check if you are using the correct version of the camera.
4	"Network connection failed"	Camera fails to connect to the server.	The camera will be in Standby mode and reconnect later.
5	"Data call failed. Please confirm your cellular data plan is available or import the APN settings"	The SIM card has run out of data or APN settings are not correct.	1. Please check whether the data plan for the SIM card is still available. 2. Import the correct APN settings to the camera.

Set up Camera on Reolink App (For Smartphone)

Download and install the Reolink App on App Store (for iOS) and Google Play (for Android).



CE



1. Please click the “” button on the top right corner to add the camera.
2. Scan the QR code at the bottom of the camera and follow the steps to complete the setup.
3. After creating a password for your camera, please follow the steps to sync the time. Then, you can start the live view or go to “Device Settings”.



Battery Status



Menu



Add New Device



Enable/Disable PIR Motion Sensor
(In default, the PIR sensor is enabled.)



Device Settings



Access the Live View

Notes on Camera Installation



In order to maximize the waterproof performance and the PIR motion sensor's efficiency, you'd better install Reolink Go PT upside down only when mounting it up outdoors.

Find the Best Spot for the Camera

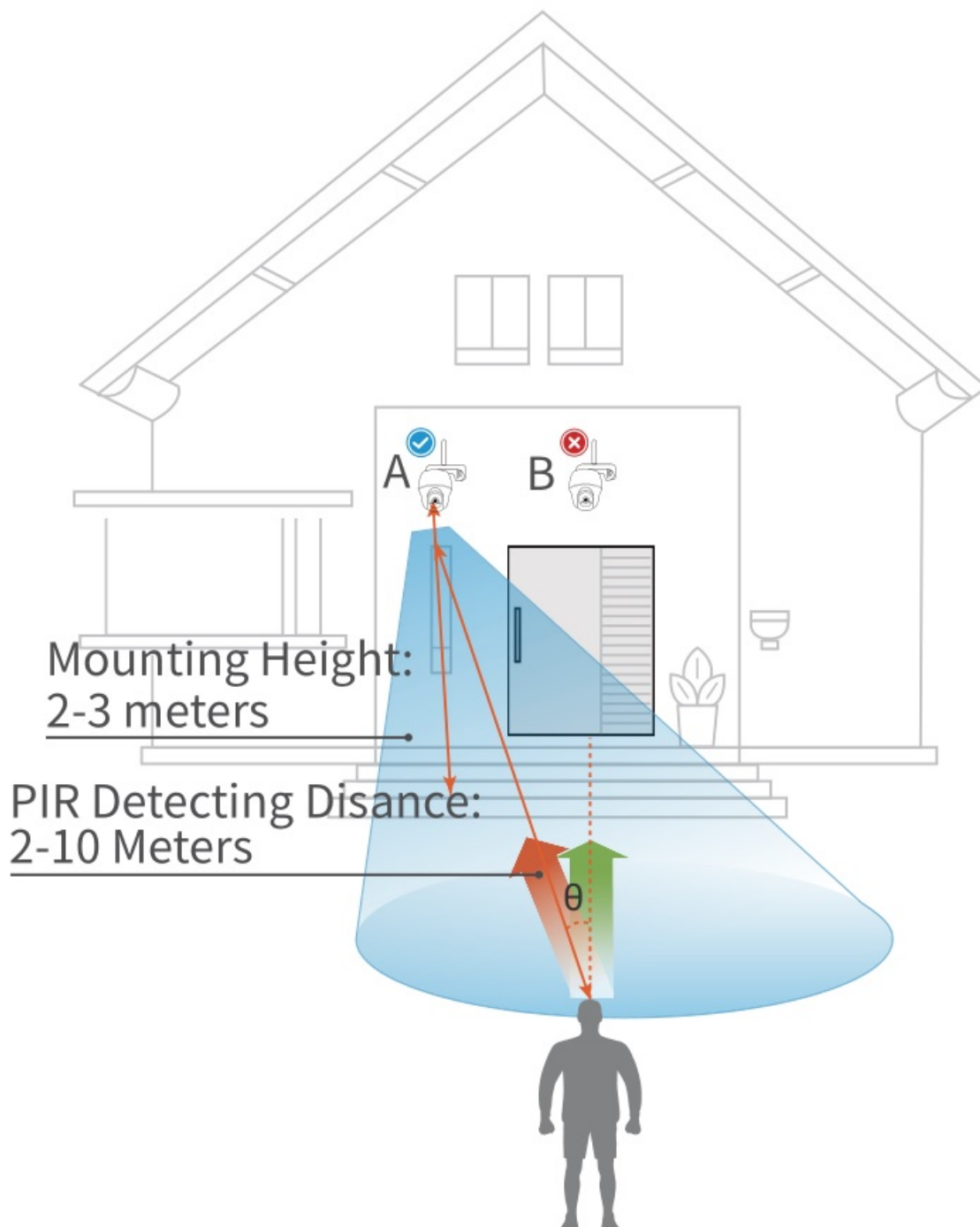

Please install the camera 2-3 meters (7-10 ft) above the ground. The detection range of the motion sensor would be maximized at such a height.

For effective motion detection, please install the camera angularly and the angle between the PIR sensor and the detected object must be larger than 10° .

NOTICE: Due to the limitation of PIR sensor detection, if a moving object approaches the PIR sensor vertically (the direction of the orange arrow in the image), the camera may fail to detect motion.

◆ PIR Sensor Detecting Distance

The PIR detection range can be customized to meet your specific needs. You can refer to the following table to set it up in Reolink App.

Sensitivity	Value	Detecting Range (For moving and living things)
Low	0 - 50	Up to 5 meters (16ft)
Mid	51 - 80	Up to 8 meters (26ft)
High	81 - 100	Up to 10 meters (33ft)

NOTICE: The path to adjust the PIR sensitivity on Reolink App: Device Settings-> PIR Settings-> Sensitivity



Important Notes on Reducing False Alarms

To reduce false alarms, please note that:

- Do not face the camera towards any objects with bright lights, including sunshine, bright lamp lights, etc.
- Do not place the camera too close to a place with heavy traffic. Based on our numerous tests, the recommended distance between the camera and the vehicle is 16 meters (52ft).
- Do not place the camera near any outlets, including air conditioner vents, humidifier outlets, heat transfer vents of projectors, etc.
- Do not install the camera at places with strong wind.
- Do not face the camera towards any mirror.
- Keep the camera at least 1 meter away from any wireless devices, including Wi-Fi routers and phones to avoid wireless interference.

Charge the Battery



1. Charge the battery with a power adapter.



2. Charge the battery with the Reolink solar panel.

Charging indicator: ● Orange LED: Charging ● Green LED: Fully charged

NOTICE:

- The battery is a built-in one. Please do not remove it from the camera.
- Please note that the solar panel is NOT included in the package. You can buy one on Reolink's official online store.



Important Notes on Rechargeable Battery Usage

Reolink Go PT is not designed for 24/7 full capacity running or around-the-clock live streaming. It's designed to record motion events and remotely view live streaming only when you need it. Learn useful tips on how to extend the battery life in this post:

<https://support.reolink.com/hc/en-us/articles/360006991893>

Install the Security Mount

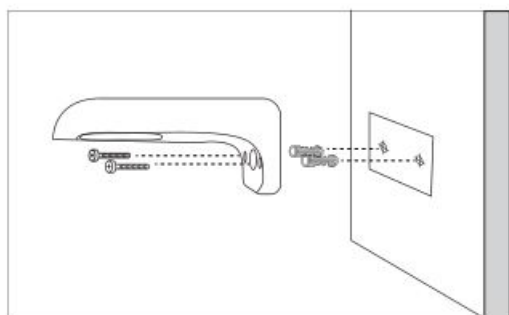

Step 1

Drill holes in accordance with the mounting hole template and screw the security mount to the wall. If you are mounting the camera to a masonry or on any other hard surface, remember to insert the plastic anchors into the hole.

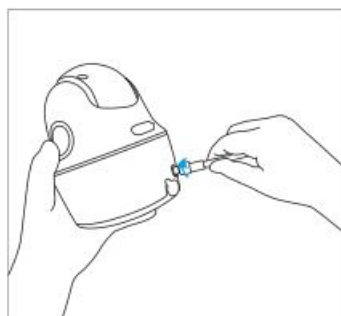

Step 2

Install the antenna to the camera.

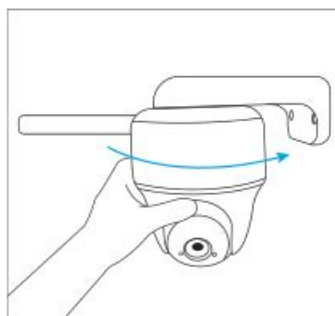

Step 3

Screw the camera to the security mount and adjust to the proper direction.

NOTICE: For better 4G signal strength, it is best to install the antenna upwards or horizontally.

Attach the Camera to a Tree

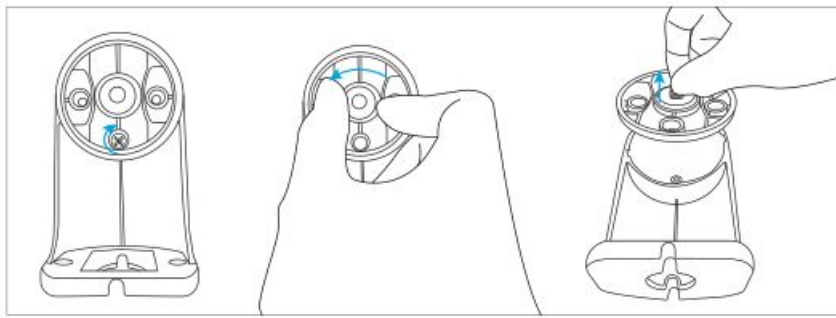

Step 1
Loosen the screw on the security mount and remove the tree mount.

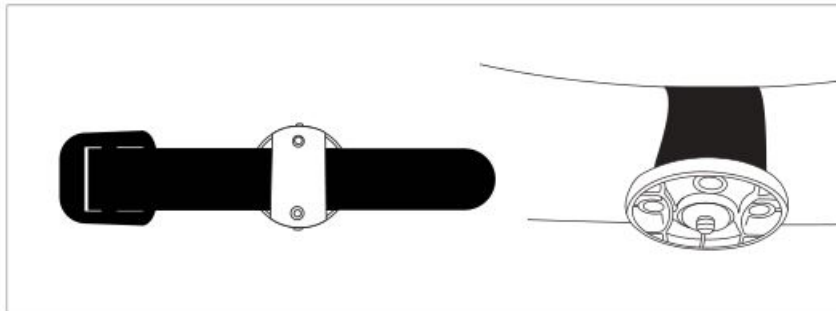

Step 2
Thread the loop strap through the slots and fasten the strap

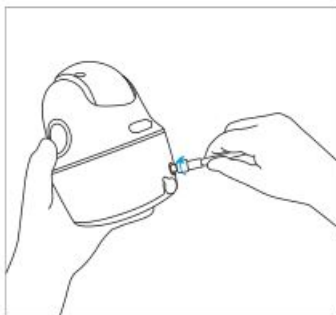

Step 3
Install the antenna to the camera.

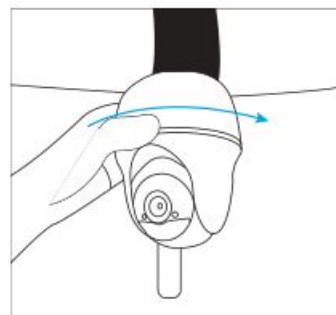

Step 4
Screw the camera to the security mount.

Troubleshooting

◆ Camera is not turning on

If your camera is not turning on, please apply the following solutions:

- Make sure you've turned the power button on.
- Charge the battery with a DC 5V/2A power adapter. When the green light is on, the battery is fully charged.
- If it still doesn't work, please contact Reolink Support <https://support.reolink.com>.

PIR sensor fails to trigger alarm

- If the PIR sensor fails to trigger any kind of alarm within the covered area, please apply the following solutions:
- Tap on Reolink App and go to Device Settings
-> PIR Settings. Check if the Time Schedule, Sensitivity and Action settings are enabled and set properly.
- Adjust the camera angle so as to improve its motion detection performance.
- Reset the camera and see if it works.
- If it still doesn't work, please contact Reolink Support <https://support.reolink.com>.

- **Failed to reset the camera**

Please strictly follow the steps below in order to reset the camera successfully:

- If the camera has already powered on for a long time, please use the reset needle to press the reset button for about 3 seconds. After hearing a ding-dong sound, release the reset button.
- If the camera just starts up, please wait for about 20 seconds. After you see a flashing blue or red LED, use the reset needle to press the reset button.
- If it still doesn't work, please contact Reolink Support <https://support.reolink.com>.

Specifications

Video

Video resolution: 1080p HD at 15 frames/sec

Field of View: 105° diagonal

Night Vision: Up to 10 m (33 ft)

PIR Detection & Alerts

PIR Detecting Distance: Adjustable up to 10m (33ft)

PIR Detection Angle: 90° horizontal

Audio Alert: Customized voice-recordable alerts

Other Alerts: Instant email alerts and push notifications

General

Operating Temperature: -10° to 55° C (14° to 131° F)

Weather resistance: IP65 certified

weatherproof

Size: 75×113 mm

Weight: 485 g (17.1 oz)

Notification of Compliance

FCC Compliance Statement

This device complies with Part 15 of FCC Rules. Operation is subject to the following two conditions: (1) this device may not cause harmful interference, and (2) this device must accept any interference received, including interference that may cause undesired operation. For more information, visit: <https://reolink.com/fcc-compliance-notice/>.



Simplified EU Declaration of Conformity

Reolink Communications declares that this device is in compliance with the essential requirements and other relevant provisions of Directive 2014/53/EU.



—Correct Disposal of this product

This marking indicates that this product should not be disposed with other household wastes throughout the EU. To prevent possible harm to the environment or human health from uncontrolled waste disposal, recycle it responsibly to promote the sustainable reuse of material resources. To return your used device, please use the return and collection systems or contact the retailer where the product was purchased. They can take this product for environment safe recycling.

Limited warranty

This product comes with a 2-year limited warranty that is valid only if purchased from Reolink Official Store or a Reolink authorized reseller. Learn more: <https://reolink.com/warranty-and-return/>.

Terms and Privacy

Use of the product is subject to your agreement to the Terms of Service and Privacy Policy at reolink.com. Keep out of reach of children.

End User License Agreement

By using the Product Software that is embedded on the Reolink product, you agree to the terms of this End User License Agreement ("EULA") between you and Reolink. Learn more: <https://reolink.com/eula/>.

ISED Radiation Exposure Statement

This equipment complies with RSS-102 radiation exposure limits set forth for an uncontrolled environment. This equipment should be installed and operated with a minimum distance 20cm between the radiator & your body.

Technical Support

If you need any technical help, please visit our official support site and contact our support team before returning the products, <https://support.reolink.com>.

SHENZHEN BAICHUAN SECURITY TECHNOLOGY CO., LTD.

2-4th Floor, Building 2, YuanLing Industrial Park, ShangWu, Shiyan Street, Bao'an District, Shenzhen, China

<https://reolink.com>

<https://support.reolink.com>

Documents / Resources

	reolink Go PT Digital Outdoor Security Camera [pdf] User Guide Go PT Digital Outdoor Security Camera
---	---

References

- [🔗 Reolink: Global Innovator in Smart Home Security and Camera Solutions](#)
- [🔗 Reolink: Global Innovator in Smart Home Security and Camera Solutions](#)
- [🔗 Reolink: Global Innovator in Smart Home Security and Camera Solutions](#)
- [🔗 Reolink® Deutschland: Zuverlässige Sicherheitslösungen im DIY-Stil](#)
- [🔗 Garantie & Rückgabe – Reolink](#)
- [🔗 Warranty & Return – Reolink](#)
- [🔗 Reolink Support - Official Reolink Help Center](#)
- [🔗 How to Extend the Battery Life of Reolink Battery Powered Cameras](#)