

reolink FE-W Fisheye Camera Wi-Fi 2K



# reolink FE-W Fisheye Camera Wi-Fi 2K User Guide

[Home](#) » [reolink](#) » reolink FE-W Fisheye Camera Wi-Fi 2K User Guide 

## Contents

- [1 reolink FE-W Fisheye Camera Wi-Fi 2K](#)
- [2 Product Information](#)
- [3 Product Usage Instructions](#)
- [4 What's in the Box](#)
- [5 Camera Introduction](#)
- [6 Set up the Camera](#)
- [7 Mount the Camera](#)
- [8 Troubleshooting](#)
- [9 Specifications](#)
- [10 Notification of Compliance](#)
- [11 Documents / Resources](#)
  - [11.1 References](#)



reolink FE-W Fisheye Camera Wi-Fi 2K



## **Product Information**

### **Specifications:**

- Camera
- Mount Base
- Power Adapter
- 1m Ethernet Cable

## **Product Usage Instructions**

### **Set up the Camera:**

#### **Set up the Camera on the Phone:**

1. Scan to download the Reolink App from the App Store or Google Play Store.
2. Power on the camera.
3. Launch the Reolink App. Click the button in the top right corner and scan the QR code on the camera to add it.
4. Follow the onscreen instructions to finish the initial setup.

#### **Set up the Camera on PC (Optional):**

1. Download and install the Reolink Client from the Support section.
2. Power on the camera.
3. Launch the Reolink Client. Click the button and enter the UID number of the camera to add it.
4. Follow the onscreen instructions to finish the initial setup.

## Mount the Camera:

### Mount the Camera to the Wall:

1. Attach the camera to the base and rotate the camera clockwise to lock it in position. Ensure alignment of orientation arrow on the camera and lock on the base.
2. To remove the camera from the mount base, press the release mechanism and rotate the camera counterclockwise.

### Mount the Camera to Ceiling:

1. Drill holes following mounting hole template. Use drywall anchors if needed.
2. Secure the mount base to ceiling with screws.
3. Run cable through cable groove on mount base and rotate camera counterclockwise to lock it in position. Ensure fitting of three mounting holes into the mount base.

## FAQ:

### • Infrared LEDs Stop Working:

If the infrared LEDs stop working, try power cycling the camera by turning it off and on again. Check for any obstructions blocking the LEDs or ensure that night vision mode is enabled in camera settings.

### • Failed to Upgrade the Firmware:

If you encounter issues upgrading firmware, make sure you have a stable internet connection. Check if the firmware file is compatible with your camera model. Try performing the firmware upgrade process again after ensuring proper compatibility and connectivity.

## What's in the Box

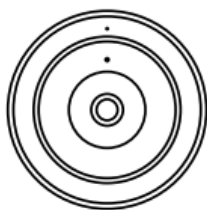

Camera



Mount Base

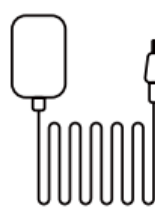

Power Adapter

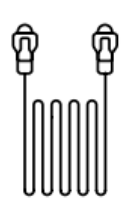

1m Ethernet Cable

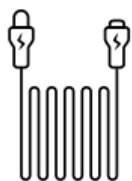

Power Extension Cable

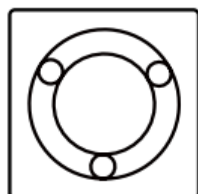

Mounting Hole Template



Quick Start Guide



Surveillance Sign

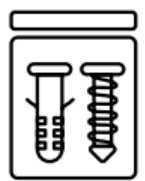

Pack of Screws

## Camera Introduction

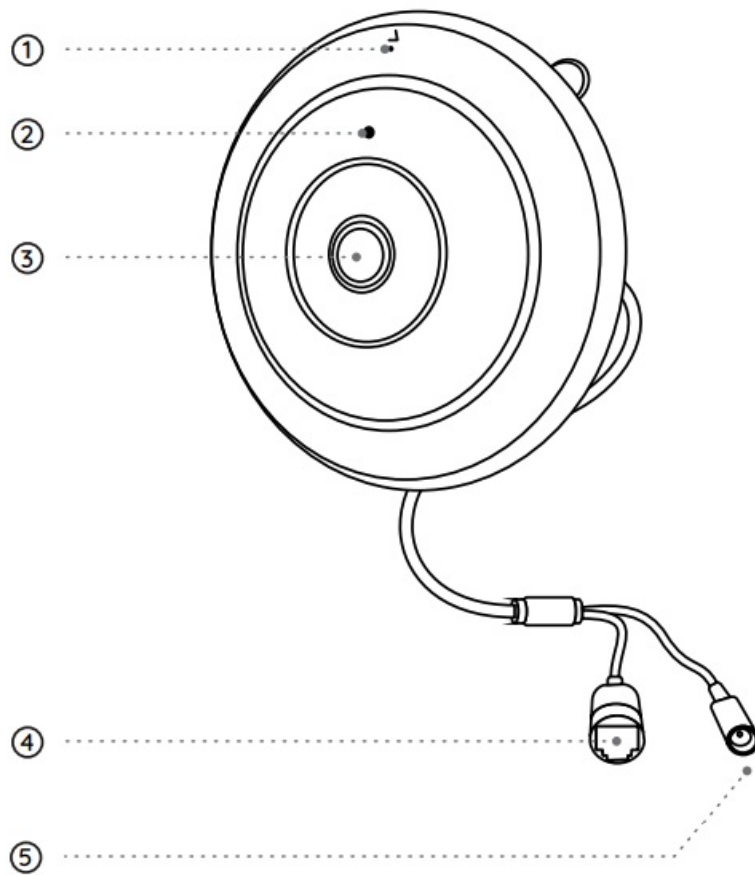

1. Built-in Mic
2. Daylight Sensor
3. Lens
4. Ethernet Port
5. Power Port

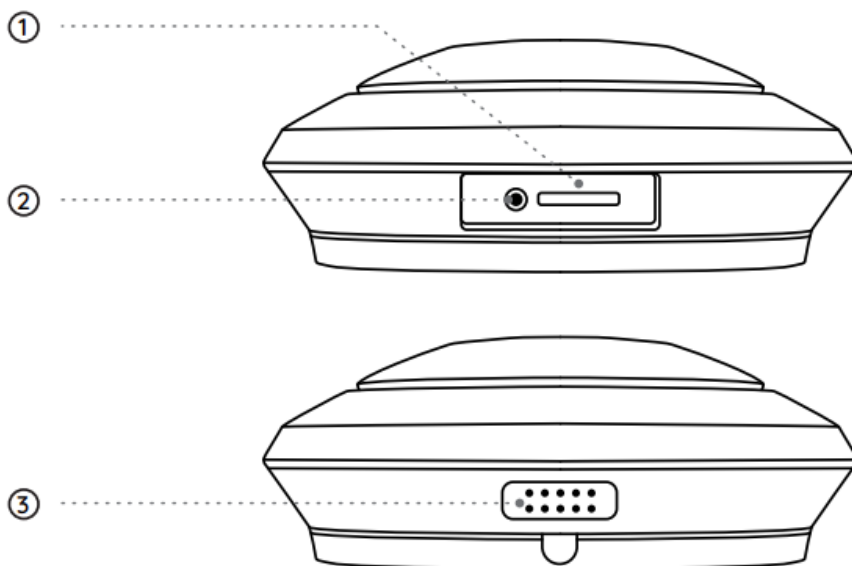

① Micro SD Card Slot

② Reset Button

\* Press the reset button with a pin to restore factory settings.

③ Speaker

## Set up the Camera

### Set up the Camera on Phone

- **Step 1** Scan to download the Reolink App from the App Store or Google Play Store.



**NOTE:** If the Reolink App is already existed, please check if it is the newest; if no, please update it.

- **Step 2** Power on the camera.
- **Step 3** Launch the Reolink App. Click the “+” button in the top right corner and scan the QR code on the camera to add it.

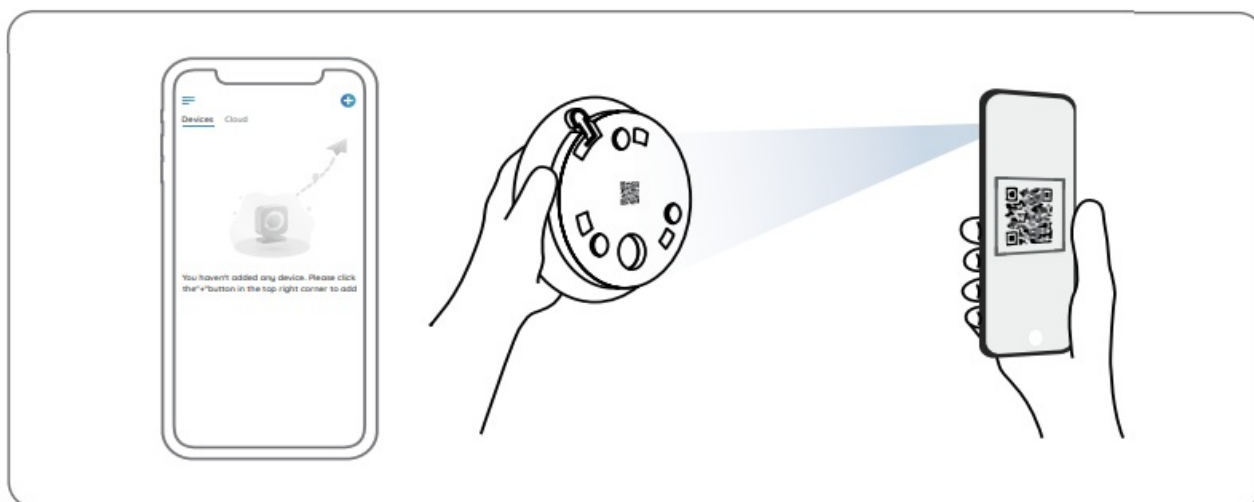

- **Step 4** Follow the onscreen instructions to finish the initial setup.

### Set up the Camera on PC (Optional)

- Step 1 Download and install the Reolink Client. Support >App & Client
- Step 2 Power on the camera.
- Step 3 Launch the Reolink Client. Click the “+” button and input the UID number of the camera to add it.
- Step 4 Follow the onscreen instructions to finish the initial setup.

### Mount the Camera

#### Installation Tips

- Do not face the camera towards any light sources.
- Do not point the camera towards a glass window. Or, it may result in poor image quality because of the window glare by infrared LEDs, ambient lights or status lights.
- Do not place the camera in a shaded area and point it towards a well-lit area. Or, it may result in poor image quality. To ensure best image quality, the lighting condition for both the camera and the capture object shall be the same.
- To ensure better image quality, it's recommended to clean the lens with a soft cloth from time to time.

- Make sure the power ports are not directly exposed to water or moisture and not blocked by dirt or other elements.
- Do not install the camera at places where rain and snow can hit the lens directly.

### Mount the Camera to the Wall

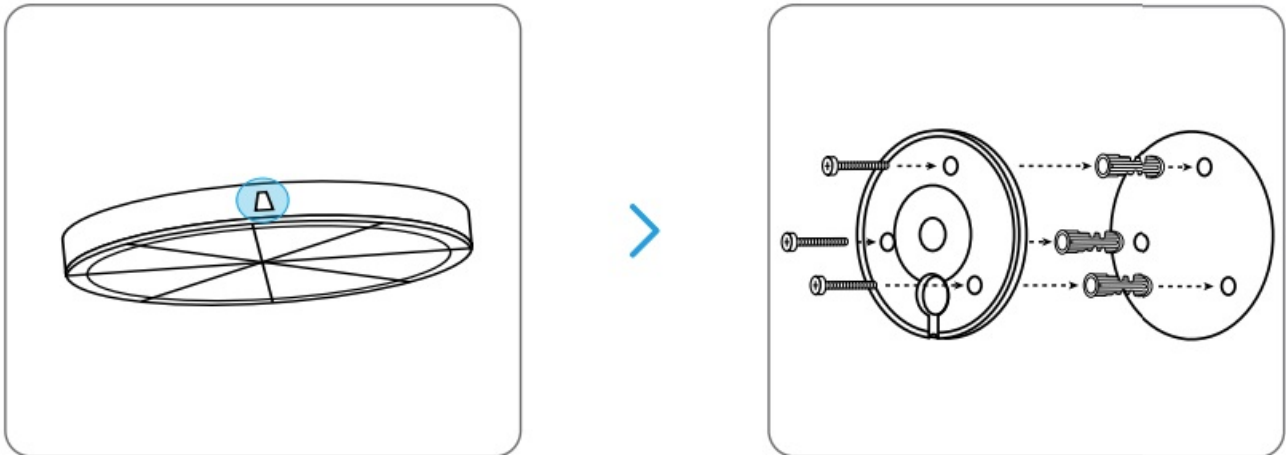

1. Before drilling the required holes, mark the direction of the lock printed on the mounting base. Make sure the lock is facing up, as shown in the diagram. This will help you align the mount base in the same orientation when installing.
2. Drill holes by the mounting hole template. Use the drywall anchors included in the package if needed. And use screws to secure the mount base to the wall with its cable groove facing downward.
3. Run the cable of the fisheye camera through the cable groove on the mount base.

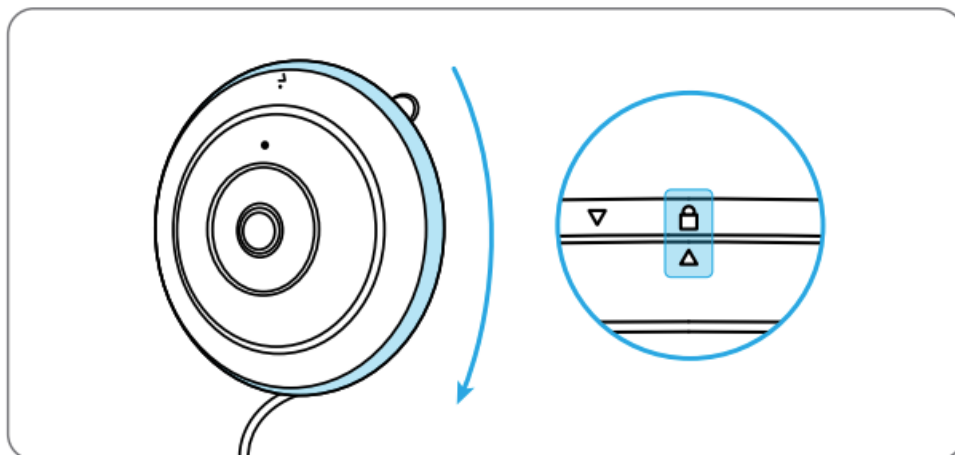

4. Attach the camera to the base and rotate the camera clockwise to lock it in position. Make sure the orientation arrow on the camera and the lock on the base are aligned.

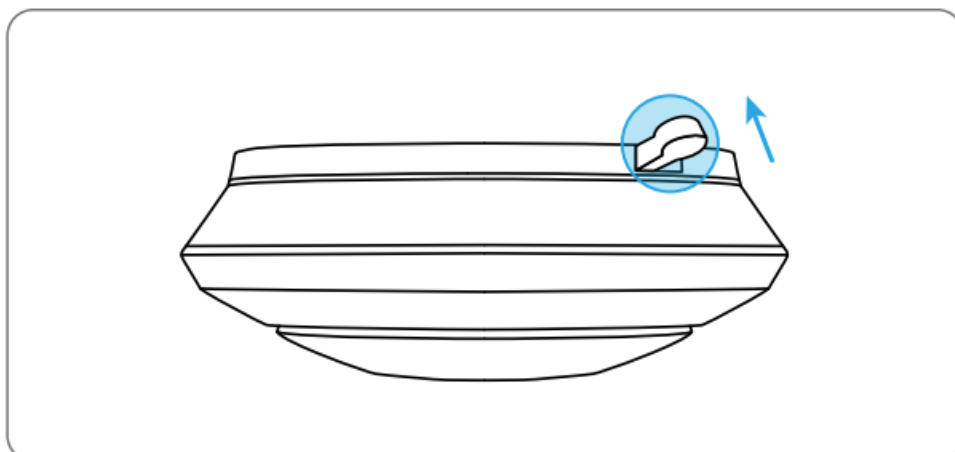

5. If you want to remove the camera from the mount base, press the release mechanism and rotate the camera counterclockwise.

## Mount the Camera to the Ceiling

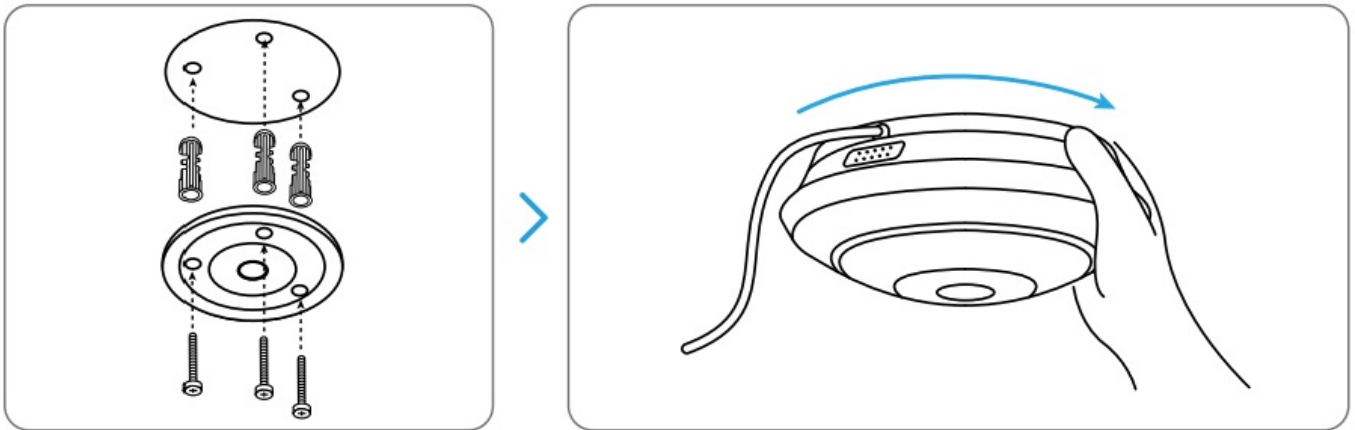

1. Drill holes by the mounting hole template. Use the drywall anchors included in the package if needed.
2. Secure the mount base to the ceiling with screws.
3. Run the cable of the fisheye camera through the cable groove on the mount base, and rotate the camera counterclockwise to lock it in position.

**NOTE:** Fit the three mounting holes of the camera into the mount base.

## Troubleshooting

### Infrared LEDs Stop Working

If the Infrared LEDs of your camera stop working, please try the following solutions:

- Enable infrared lights on Device Settings page via Reolink App/Client.
- Check if the Day/Night mode is enabled and set up auto infrared lights at night on Live View page via Reolink App/Client.
- Upgrade the firmware of your camera to the latest version.
- Restore the camera to factory settings and check out the infrared light settings again.

If these won't work, contact Reolink Support.

### Failed to Upgrade the Firmware

If you fail to upgrade the firmware for the camera, try the following solutions:

- Check out the current camera firmware and see if it is the latest one.
- Make sure that you download the correct firmware from Download Center.
- Make sure that your PC is working on a stable network.

If these won't work, contact Reolink Support

## Specifications

### Hardware Features

- **Night Vision:** 8 Meters
- **Day/Night Mode:** Auto Switchover

## General

- **Operating Temperature:** -10°C to 55°C (14°F to 131°F)
- **Operating Humidity:** 10%-90%

## Notification of Compliance

### FCC Compliance Statement

This device complies with Part 15 of the FCC Rules. Operation is subject to the following two conditions: this device may not cause harmful interference, and this device must accept any interference received, including interference that may cause undesired operation.

**NOTE:** This equipment has been tested and found to comply with the limits for a Class B digital device, under part 15 of the FCC Rules. These limits are designed to provide reasonable protection against harmful interference in a residential installation. This equipment generates uses and can radiate radio frequency energy and, if not installed and used by the instructions, may cause harmful interference to radio communications. However, there is no guarantee that interference will not occur in a particular installation. If this equipment does cause harmful interference to radio or television reception, which can be determined by turning the equipment off and on, the user is encouraged to try to correct the interference by one or more of the following measures:

- Reorient or relocate the receiving antenna.
- Increase the separation between the equipment and the receiver.
- Connect the equipment into an outlet on a circuit different from that to which the receiver is connected.
- Consult the dealer or an experienced radio/TV technician for help.

Changes or modifications not expressly approved by the party responsible for compliance could void the user's authority to operate the equipment.

### FCC RF Exposure Warning Statements

This equipment complies with FCC radiation exposure limits set forth for an uncontrolled environment. This equipment shall be installed and operated with minimum distance 20cm between the radiator & body.

### Simplified EU Declaration of Conformity

Reolink declares that the WiFi camera is in compliance with the essential requirements and other relevant provisions of Directive 2014/53/EU, the PoE camera and NVR is in compliance with Directive 2014/30/EU.

### Correct Disposal of This Product

This marking indicates that this product should not be disposed of with other household wastes throughout the EU. To prevent possible harm to the environment or human health from uncontrolled waste disposal, recycle it responsibly to promote the sustainable reuse of material resources. To return your used device, please use the return and collection systems or contact the retailer where the product was purchased. They can take this product for environment safe recycling.

### Limited Warranty

This product comes with a 2-year limited warranty that is valid only if purchased from Reolink Official Store or a



Reolink authorized reseller.

**NOTE:** We hope that you enjoy the new purchase. But if you are not satisfied with factory default settings and take out the inserted SD card before

### Terms and Privacy

Use of the product is subject to your agreement to the Terms of Service and Privacy Polic. Keep out of reach of children.

### End User License Agreement

By using the Product Software that is embedded on the Reolink product, you agree to the terms of this End User License Agreement ("EULA") between you and Reolink.

### ISED Statements

This device contains licence-exempt transmitter(s)/receiver(s) that comply with Innovation, Science and Economic Development Canada's licence-exempt RSS(s). Operation is subject to the following two conditions:

1. This device may not cause interference.
2. This device must accept any interference, including interference that may cause undesired operation of the device.

### Radio Frequency Exposure Statement for IC

This equipment complies with IC exposure limits set forth for an uncontrolled environment. The device can be used in portable exposure conditions. This equipment shall be installed and operated with minimum distance 20cm between the radiator & body.

OPERATING FREQUENCY(For WiFi Version) (the maximum transmitted power)

- 2412MHz—2472MHz (18dBm)
- 5150MHz—5350MHz (16dBm)
- 5470MHz—5725MHz (16dBm)

### Technical Support

If you need any technical help, please visit our official support site and contact our support team before returning the products.

---

## Documents / Resources

	<a href="#">reolink FE-W Fisheye Camera Wi-Fi 2K</a> [pdf] User Guide FE-W Fisheye Camera Wi-Fi 2K, FE-W, Fisheye Camera Wi-Fi 2K, Camera Wi-Fi 2K, Wi-Fi 2K, 2K
---	---

## References

- [User Manual](#)

## **Manuals+. Privacy Policy**

This website is an independent publication and is neither affiliated with nor endorsed by any of the trademark owners. The "Bluetooth®" word mark and logos are registered trademarks owned by Bluetooth SIG, Inc. The "Wi-Fi®" word mark and logos are registered trademarks owned by the Wi-Fi Alliance. Any use of these marks on this website does not imply any affiliation with or endorsement.