



# Reolink Argus PT Ultra WiFi IP Camera User Guide

[Home](#) » [reolink](#) » Reolink Argus PT Ultra WiFi IP Camera User Guide

## Contents [ [hide](#) ]

- [1 Argus PT Ultra WiFi IP Camera](#)
- [2 Product Information](#)
- [3 Product Usage Instructions](#)
- [4 Troubleshooting](#)
- [5 What's in the Box](#)
- [6 Set up the Camera](#)
- [7 Troubleshooting](#)
- [8 Specification](#)
- [9 Notification of Compliance](#)
- [10 FCC Compliance Statements](#)
- [11 Limited Warranty](#)
- [12 Documents / Resources](#)
  - [12.1 References](#)
- [13 Related Posts](#)



**Argus PT Ultra WiFi IP Camera**



## Product Information

The Argus PT Ultra is a wireless camera that comes with a camera bracket, mount base, Type-C cable, antenna, reset needle, quick start guide, surveillance sign, pack of screws, mounting template, and hex key. It has a daylight sensor, built-in PIR sensor, built-in microphone, and a charging port. The camera has a standby and working status indicator. It can be set up using a smartphone or PC and can be charged with a power adapter or Reolink Solar Panel (not included in the package).

## Product Usage Instructions

### Set up the Camera Using a Smartphone

1. Download the Reolink App from the App Store or Google Play store by scanning the QR code provided in the quick start guide.
2. Turn on the power switch to power on the camera.
3. Follow the in-app instructions to set up the camera.

### Set up the Camera on PC (Optional)

1. Download and install the Reolink Client software from the Reolink website.
2. Connect the camera to your PC using the Type-C cable.
3. Follow the in-software instructions to set up the camera.

### Charge the Camera

It's recommended to fully charge the battery before mounting the camera. The camera can be charged with a power adapter (not included) or Reolink Solar Panel (not included if you only purchase the camera). To charge the camera:

1. Connect the power adapter or solar panel to the charging port of the camera.
2. The charging indicator will turn orange when the camera is charging and green when it's fully charged.

### Install the Camera

The camera can be mounted on a wall, ceiling, or loop strap. To mount the camera:

1. Drill holes in accordance with the mounting hole template and screw the camera bracket to the wall.
2. Install the antenna to the camera.
3. To mount the camera on a ceiling, install the mount base to the ceiling, align the camera with the bracket, and turn the camera unit clockwise to lock it in position.
4. To mount the camera with a loop strap, follow the safety instructions provided in the quick start guide.

## Troubleshooting

If your camera is not powering on or you cannot scan the QR code on your phone, try the following solutions:

- Check if the power switch is turned on.
- Make sure the battery is fully charged.
- Reset the camera using the reset needle.
- If these won't work, contact Reolink Support.

**Note:** Always follow local waste and recycle laws when disposing of used batteries.

## What's in the Box

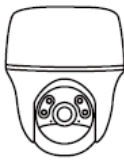

Camera

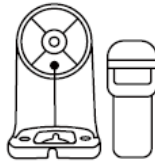

Camera Bracket



Mount Base



Type-C Cable



Antenna



Reset Needle



Quick Start Guide



Surveillance Sign

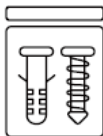

Pack of Screws



Mounting Template



Hex Key

## Camera Introduction

1. Lens
2. IR LEDs
3. Spotlight

4. Daylight Sensor
5. Built-in PIR Sensor
6. Built-in Mic
7. Status LED
8. Speaker
9. Reset Hole

\* Press for more than five seconds to restore the device to default settings.

10. Micro SD Card Slot

\* Rotate the camera's lens to find the reset hole and the SD card slot.

11. Power Switch
12. Antenna
13. Charging Port
14. Battery Status LED

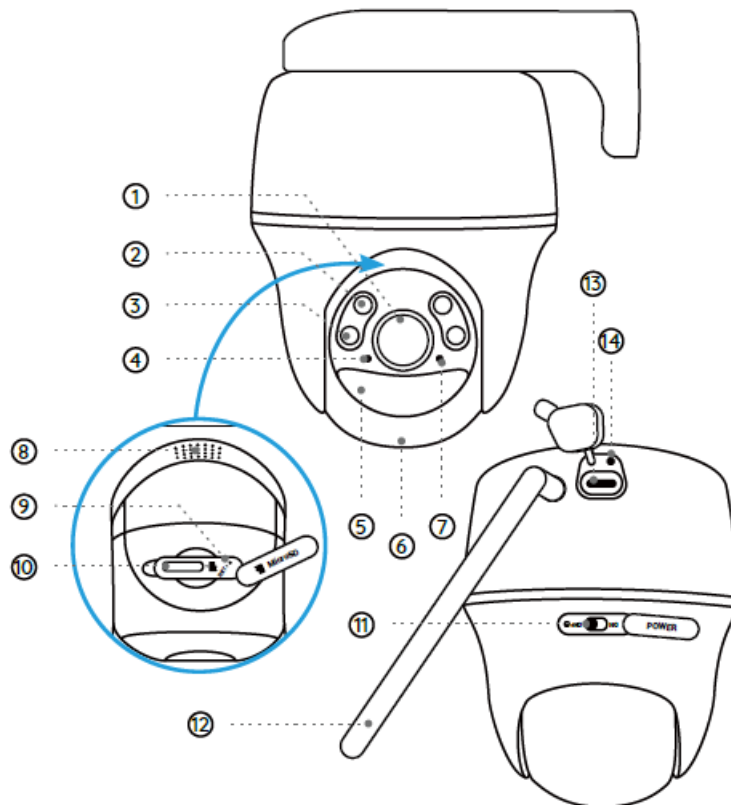

#### Different states of the status LED:

- **Red Light:** WiFi connection failed Blinking: Standby status
- **Blue Light:** WiFi connection succeeded On: Working status

#### Set up the Camera

##### Set up the Camera Using a Smartphone

- **Step 1:** Scan to download the Reolink App from the App Store or Google Play store.



- **Step 2:** Turn on the power switch to power on the camera.

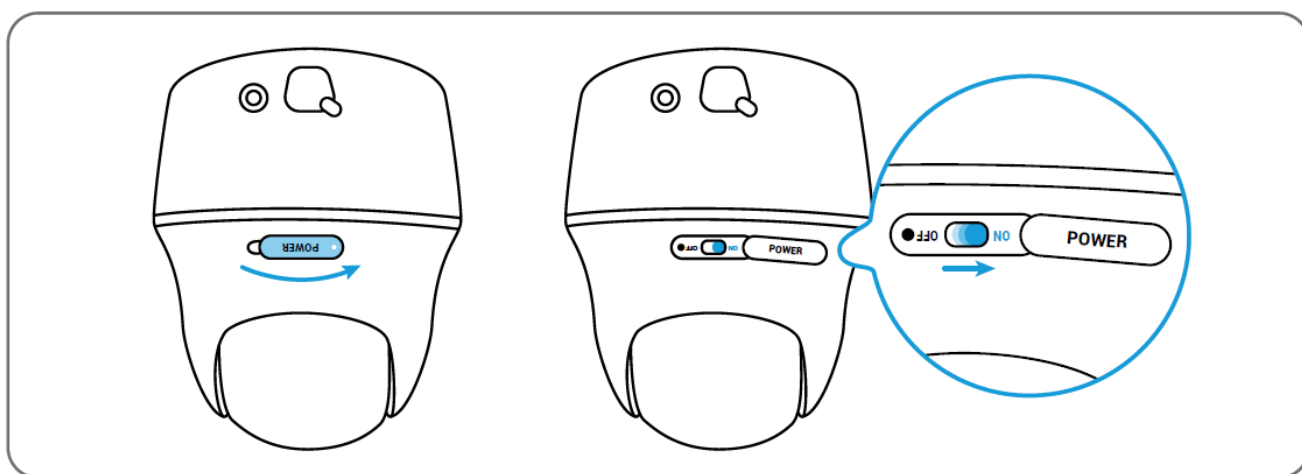

- **Step 3:** Launch the Reolink App, click the "+" button in the top right corner to add the camera. Scan the QR code on the device and follow the onscreen instructions to finish initial setup.

**NOTE:** This device supports 2.4 GHz and 5 GHz Wi-Fi networks. It is recommended to connect the device to 5 GHz Wi-Fi for a better network experience.

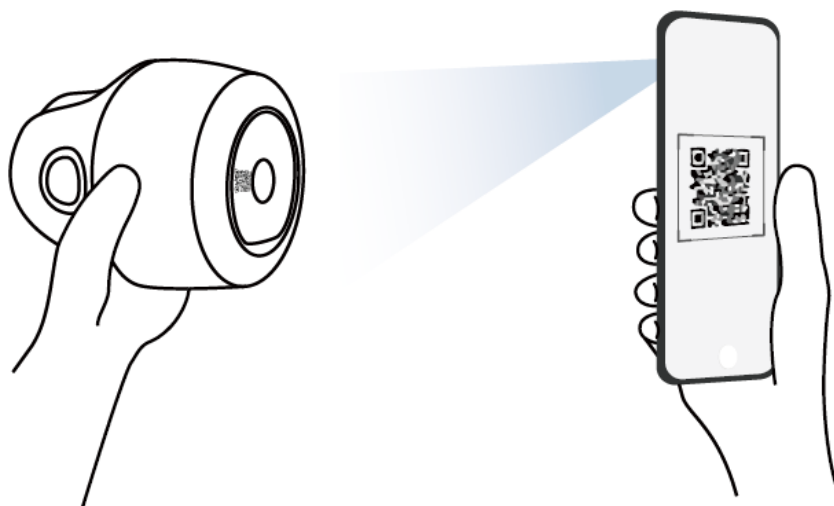
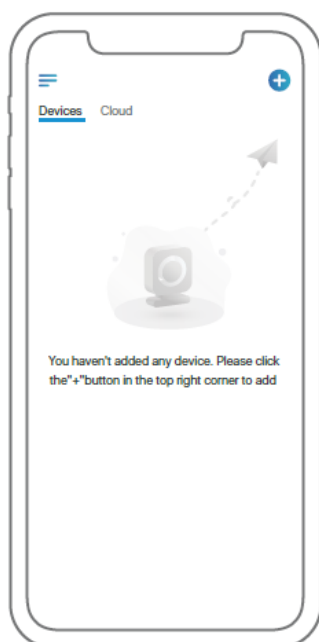

## Set up the Camera on PC (Optional)

- **Step 1:** Download and install the Reolink Client: Go to <https://reolink.com>Support>App&Client>.
- **Step 2:** Launch the Reolink Client, click the " " button, input the UID code of the camera to add it and follow the onscreen instructions to finish initial setup.

## Charge the Camera

It's recommend to fully charge the battery before mounting the camera.

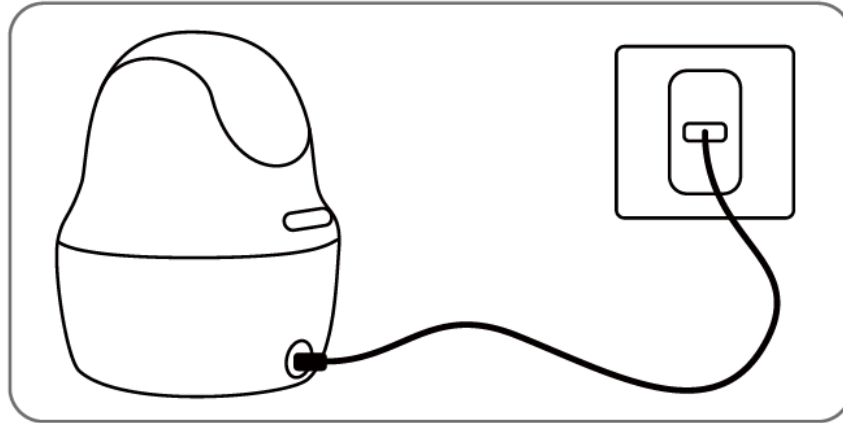

Charge the battery with a power adapter.(not included)

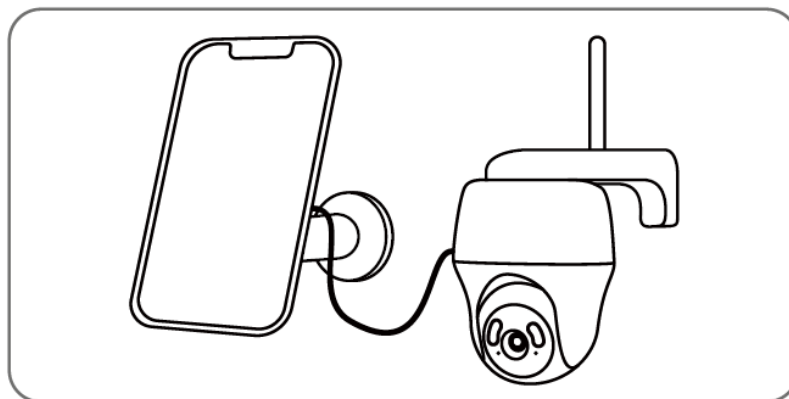

Charge the battery with the Reolink Solar Panel (Not included if you only purchase the camera).

## Charging Indicator:

- Orange LED: Charing
- Green LED: Fully charged

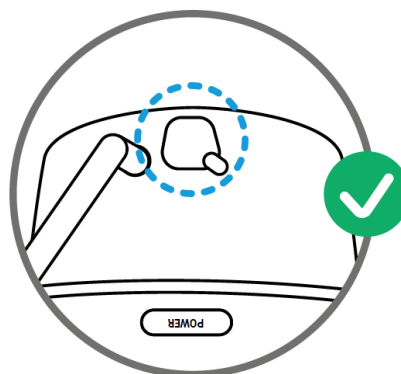

For better weatherproof performance, please always cover the charging port with the rubber plug after charging the battery.

## Install the Camera

- Install the camera 2-3 meters (7-10 ft) above the ground. This height maximizes the detection range of the PIR motion sensor.
- For better motion detection performance, please install the camera angularly.

**NOTE:** If a moving object approaches the PI sensor vertically, the camera may fail to detect motion.

## Mount the Camera

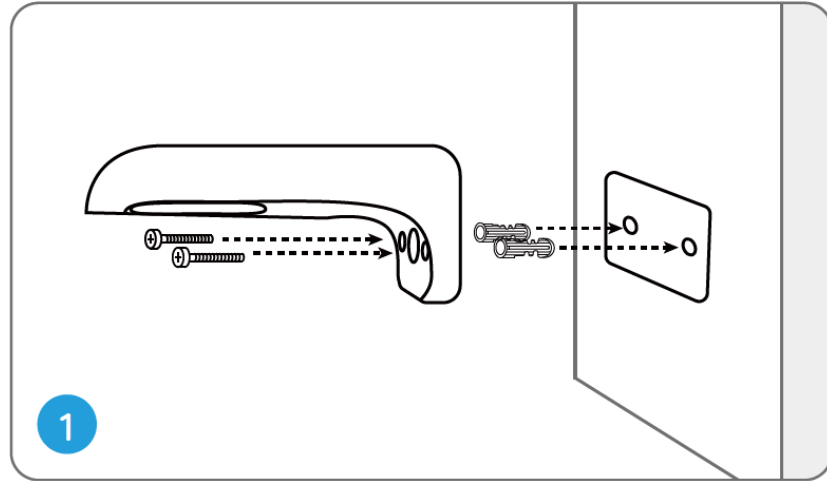

Drill holes in accordance with the mounting hole template and screw the camera bracket to the wall.

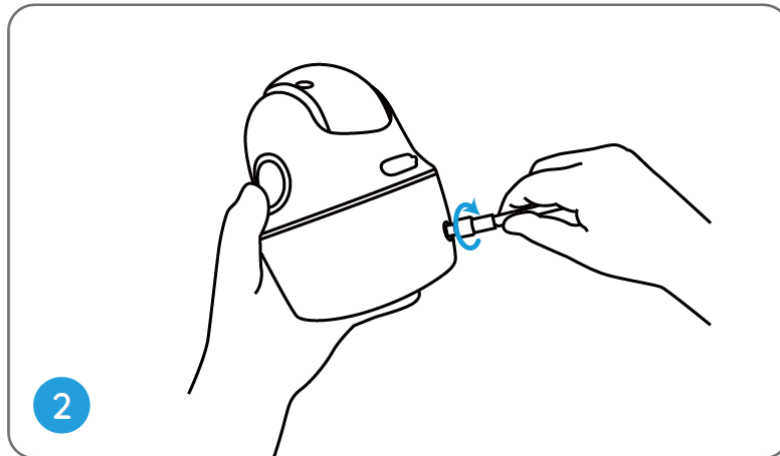

Install the antenna to the camera

**NOTE:** Use the drywall anchors included in the package if needed.

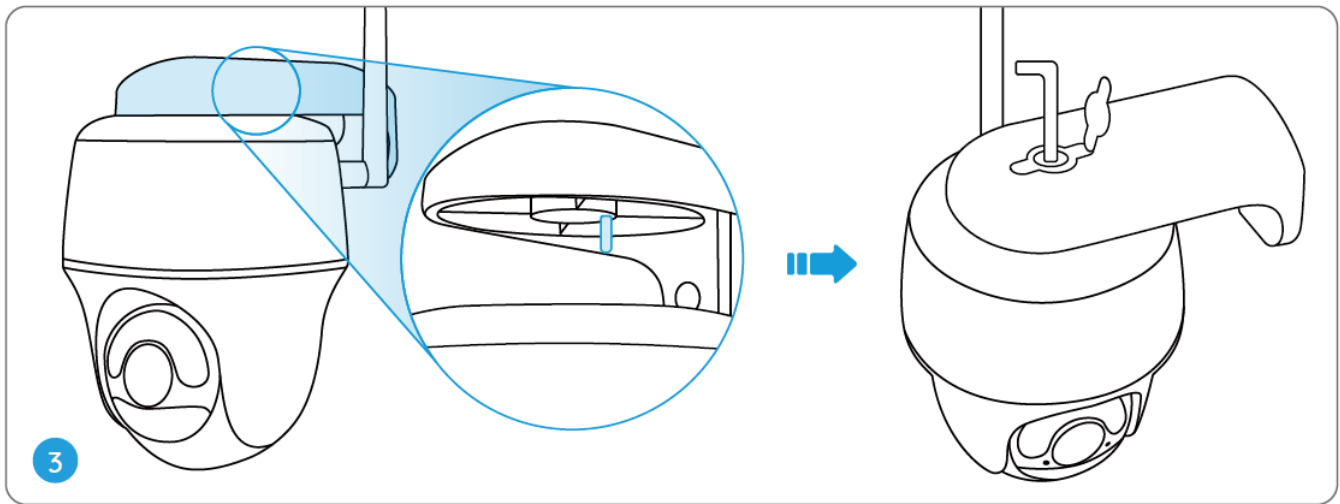

Align the white hole on the camera top with the white hollow screw on the bracket. Use a wrench and a hex head screw provided to secure the camera into place. Then cover the rubber plug

### Mount the Camera to Ceiling

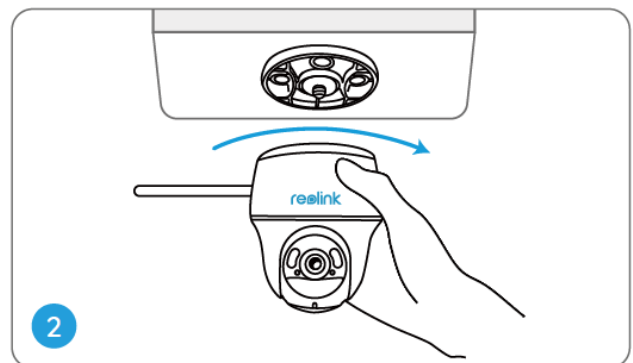
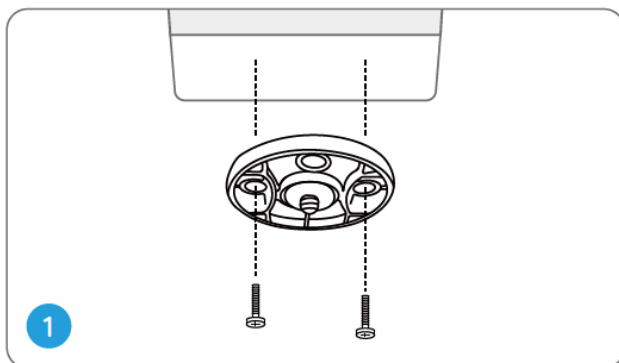

Install the mount base to the ceiling. Align the camera with the bracket and turn the camera unit clockwise to lock it in position.

### Install the Camera with Loop Strap

You are allowed to strap the camera to a pillar with both the security mount and ceiling bracket. Thread the provided strap to the plate and fasten it to a pillar. Next, attach the camera to the plate and you are good to go.

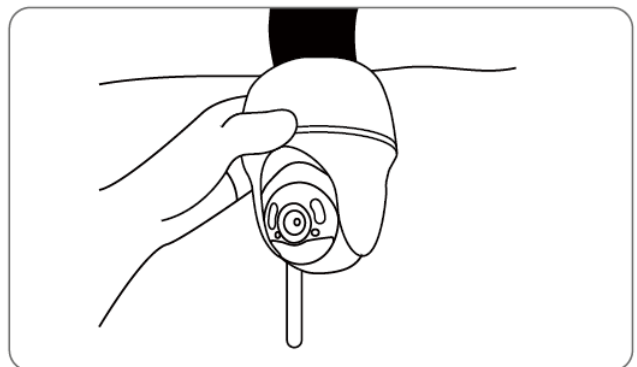
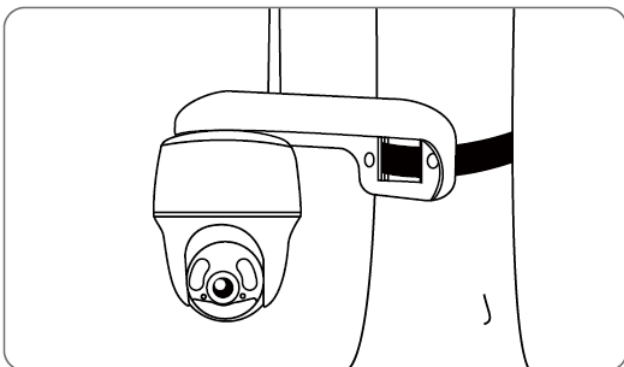

### Safety Instructions of Battery

Usage The camera is not designed for running 24/7 at full capacity or around-the-clock live streaming. It's designed to record motion events and to live view remotely only when you need it. Learn useful tips on how to extend the battery life in this post: <https://support.reolink.com/hc/en-us/articles/360006991893>

1. The battery is built-in, so do not remove it from the camera.
2. Charge the rechargeable battery with a standard and high-quality DC 5V/9V battery charger or Reolink solar



- panel. Do not charge the battery with solar panels from any other brands.
3. Charge the battery when temperatures are between 0°C and 45°C and always use the battery when temperatures are between -20°C and 60°C.
  4. Do not charge, use or store the battery near any ignition sources, such as fire or heaters.
  5. Do not use the battery if it gives off an odor, generates heat, becomes discolored or deformed, or appears abnormal in any ways. If the battery is being used or charged, remove the battery from the device or the charger immediately, and stop using it.
  6. Always follow the local waste and recycle laws when you get rid of the used battery.

## **Troubleshooting**

### **Camera is Not Powering On**

If your camera is not powering on, please try the following solutions:

- Make sure the power switch is turned on
- Charge the battery with a DC 5V/2A power adapter.

When the green light is on, the battery is fully charged. If these won't work, contact Reolink Support.

### **Failed to Scan QR Code on the Phone**

If you cannot scan the QR code on your phone, please try the following solutions:

- Remove the protective film from the camera lens.
- Wipe the camera lens with a dry paper/ towel/tissue
- Vary the distance between your camera and the mobile phone so that the camera can focus better.
- Try to scan the QR code under sufficient lighting.

If these won't work, contact Reolink Support.

## **Specification**

- Operating Temperature: -10°C to 55°C (14°F to 131°F)
- Size: 98 × 112 mm
- Weight (Battery included): 481g

For more specifications, visit the Reolink official website.

## **Notification of Compliance**

### **CE Declaration of Conformity**

Hereby, Reolink declares that the radio equipment type – Argus PT Ultra is in compliance with Directive 2014/53/EU. The full text of the EU declaration of conformity is available at a paper copy provided with the shipped product.

### **UKCA Declaration of Conformity**

Hereby, Reolink declares that the radio equipment type-Argus PT Ultra is in compliance with UK Radio Equipment Regulation 2017. The full text of the UK declaration of conformity is available at a paper copy provided with the

shipped product.

## **FCC Compliance Statements**

This device complies with Part 15 of the FCC Rules.

### **Operation is subject to the following two conditions:**

1. This device may not cause harmful interference, and
2. This device must accept any interference received, including interference that may cause undesired operation.

**Note:** This equipment has been tested and found to comply with the limits for a Class B digital device, pursuant to Part 15 of the FCC Rules. These limits are designed to provide reasonable protection against harmful interference in a residential installation. This equipment generates, uses and can radiate radio frequency energy and, if not installed and used in accordance with the instructions, may cause harmful interference to radio communications. However, there is no guarantee that interference will not occur in a particular installation. If this equipment does cause harmful interference to radio or television reception, which can be determined by turning the equipment off and on, the user is encouraged to try to correct the interference by one or more of the following measures:

- Reorient or relocate the receiving antenna.
- Increase the separation between the equipment and receiver.
- Connect the equipment into an outlet on a circuit different from that to which the receiver is connected.
- Consult the dealer or an experienced radio/ TV technician for help.

**Caution:** Changes or modifications not expressly approved by the party responsible for compliance could void the user's authority to operate the equipment.

## **FCC Radiation Exposure statement**

This equipment complies with FCC radiation exposure limits set forth for an uncontrolled environment. This equipment should be installed and operated with minimum distance 20cm between the radiator and your body.

## **ISED Compliance Statements**

This device contains licence-exempt transmitter(s)/receiver(s) that comply with Innovation, Science and Economic Development Canada's license-exempt RSS(s).

### **Operation is subject to the following two conditions:**

1. This device may not cause interference.
2. This device must accept any interference, including interference that may cause undesired operation of the device.

## **ISED Radiation Exposure statement**

This equipment complies with IC RSS-102 radiation exposure limits set forth for an uncontrolled environment. This equipment should be installed and operated with minimum distance 20 cm between the radiator and your body.

**Note:** Operation of 5150-5250 MHz is restricted to indoor use only in Canada.

## Limited Warranty

This product comes with a 2-year limited warranty that is valid only if purchased from Reolink Official Store or a Reolink authorized reseller.

Learn more: <https://reolink.com/warranty-and-return/>. Terms and Privacy Use of the product is subject to your agreement to the Terms of Service and Privacy Policy at [reolink.com](https://reolink.com). Keep out of reach of children.

## WiFi Operating Frequency

- OPERATING FREQUENCY : (the maximum transmitted power)

2.4GHz: 2412MHz-2472MHz

(EIRP:17.52dBm) (Only for EU/UK)

5GHz: 5180MHz-5240MHz

5260MHz-5320MHz

5500MHz-5700MHz

(EIRP:13.87dBm) (Only for EU/UK) 5.8GHz:

5745MHz-5825MHz (EIRP:13.98dBm) (Only for EU/UK)



The functions of Wireless Access Systems including Radio Local Area Networks (WAS/RLANs) within the band 5150-5350 MHz for this device are restricted to indoor use only within all European Union countries (BE/BG/CZ/ DK/ DE/EE/IE/EL/ES/FR/HR/ IT/CY/LV/LT/ LU/HU/MT/L/AT/PL/PT/RO/SI/SK/FI/ SE/TR/N O/CH/IS/LI/UK(NI))

## Correct Disposal of This Product



■ This marking indicates that this product should not be disposed with other household wastes. throughout the EU. To prevent possible harm to the environment or human health from uncontrolled waste disposal, recycle it responsibly to promote the sustainable reuse of material resources. To return our used device, please use the return and collection systems or contact the retailer where the product was purchased. They can take this product for environmentally safe recycling.

The user manual for LE-LAN devices shall contain instructions related to the restrictions mentioned in the above sections, namely that:

1. The device for operation in the band 5150- 5250 MHz is only for indoor use to reduce the potential for harmful interference to co- channel mobile satellite systems; it.
2. For devices with detachable antenna(s), the maximum antenna gain permitted for devices in the bands 5250- 5350 MHz and 5470-5725 MHz shall be such that the equipment still complies with the eir.p. limit;
3. For devices with detachable antenna(s), the maximum antenna gain permitted for devices in the band 5725- 5850 MHz shall be such that the equipment still complies with the eir.p. limits as appropriate; and

## Statement

This radio transmitter [26839-2302A1 has been approved by Innovation, Science and Economic Development Canada to operate with the antenna types listed below, with the maximum permissible gain indicated. Antenna types not included in this list that have a gain greater than the maximum gain indicated for any tupe listed are strictly prohibited for use with this device.

## Technical Support

If you need any technical help, please visit our official support site and contact our support team before returning the products, <https://support.reolink.com>.

## Product Ident GmbH

Hoferstasse 9B, 71636 Ludwigsburg, Germany

Email: [prodsg@libelleconsulting.com](mailto:prodsg@libelleconsulting.com)

## APEX CE SPECIALISTS LIMITED

89 Princess Street, Manchester, M14HT, UK

Email: [info@apex-ce.com](mailto:info@apex-ce.com)

## Documents / Resources

	<a href="#">Reolink Argus PT Ultra WiFi IP Camera</a> [pdf] User Guide 2302A, 2AYHE-2302A, 2AYHE2302A, 58.03.001.0306, Argus PT Ultra WiFi IP Camera, Argus PT Ultra, WiFi IP Camera, IP Camera, Camera
---	--

## References

- [ce.com](#)
- [Reolink: Global Innovator in Smart Home Security and Camera Solutions](#)
- [Reolink Support - Official Reolink Help Center](#)