



# reolink Argus Eco Solar Powered Wifi Camera WaterProof User Manual

[Home](#) » [reolink](#) » reolink Argus Eco Solar Powered Wifi Camera WaterProof User Manual 

reolink Argus Eco Solar Powered Wifi Camera WaterProof



## Contents

- [1 What's in the Box](#)
- [2 Camera Introduction](#)
- [3 Set up the Camera](#)
- [4 Charge the Battery](#)
- [5 Install the Camera](#)
- [6 Notes on PIR Motion Sensor](#)
- [7 Important Notes on Rechargeable Battery Usage](#)
- [8 Troubleshooting](#)
- [9 Specifications](#)
- [10 Notification of Compliance](#)
- [11 Customer Support](#)
- [12 Documents / Resources](#)
  - [12.1 References](#)
- [13 Related Posts](#)

## What's in the Box

- Argus Eco (with Battery)

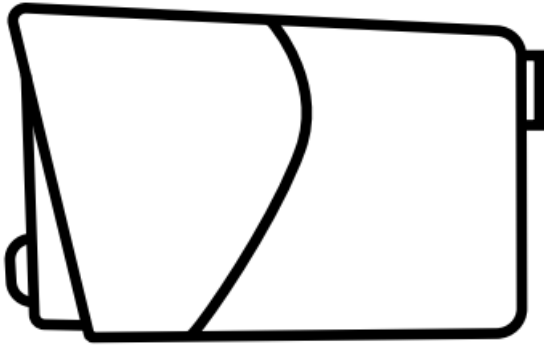

- Antenna



- Outdoor Security Mount

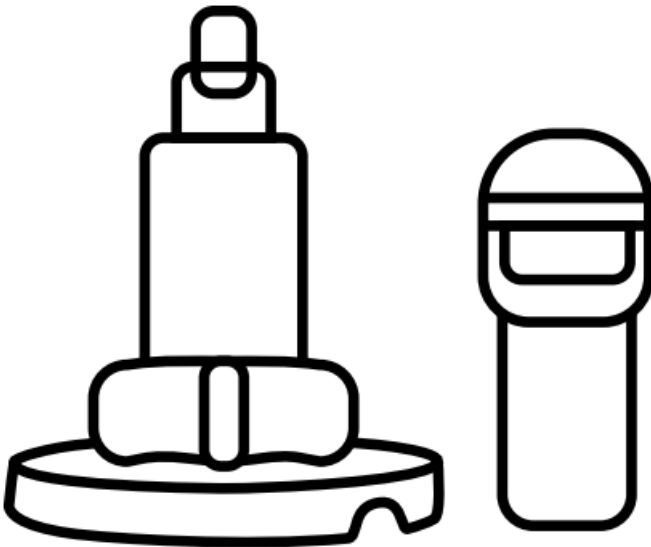

- Reset Needle



- Surveillance Sign



- Mounting Quick Start Guide Hole Template

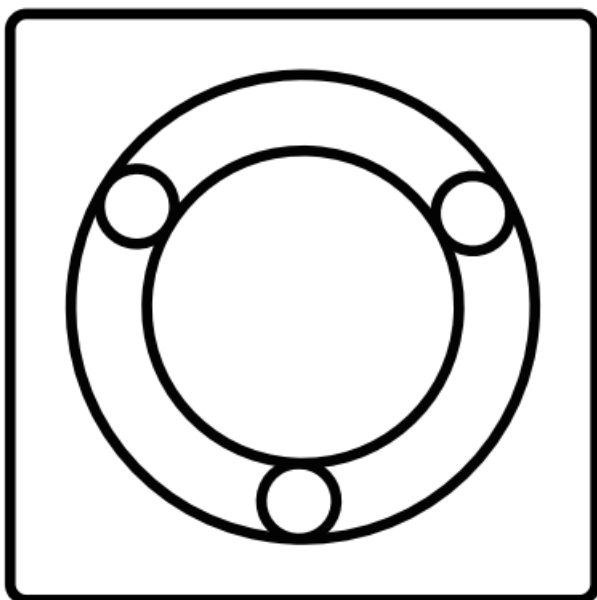

- Micro USB Cable

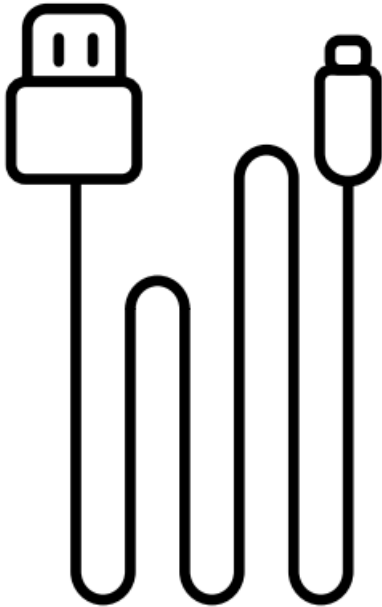

- Pack of Screws

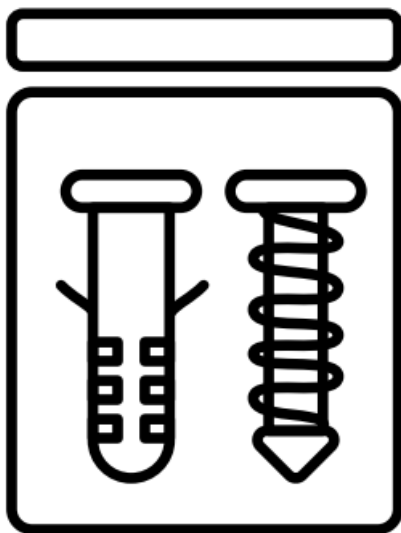

- Quick Start Guide



## Camera Introduction

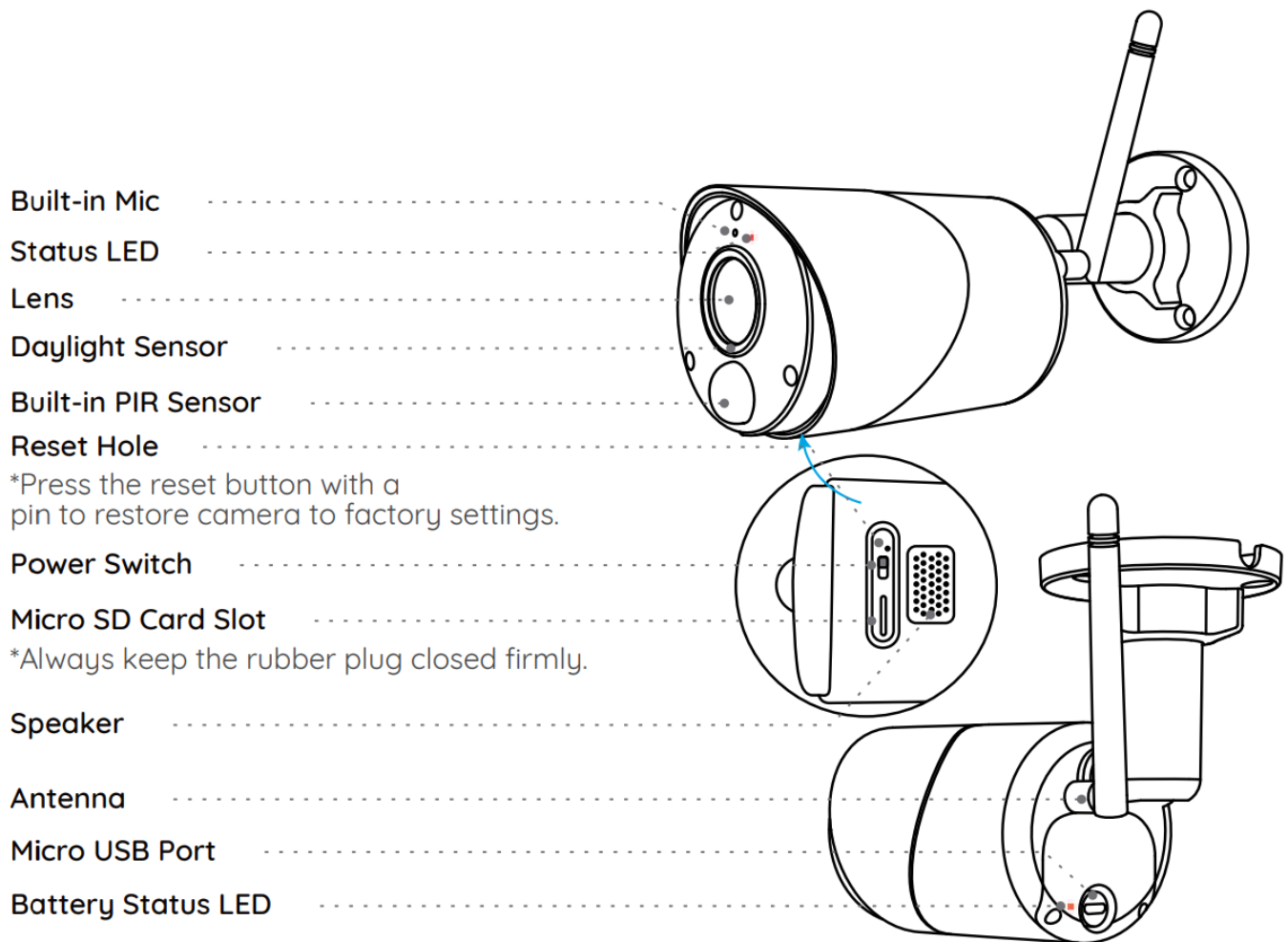

### Different states of the status LED:



**Red Light:** WiFi connection failed



**Blue Light:** WiFi connection succeeded

**Blinking:** Standby status

**On:** Working status

### Set up the Camera

Download and launch the Reolink App or Client software, and follow the onscreen instructions to finish initial setup.

#### • On Smartphone

Scan to download the Reolink App.

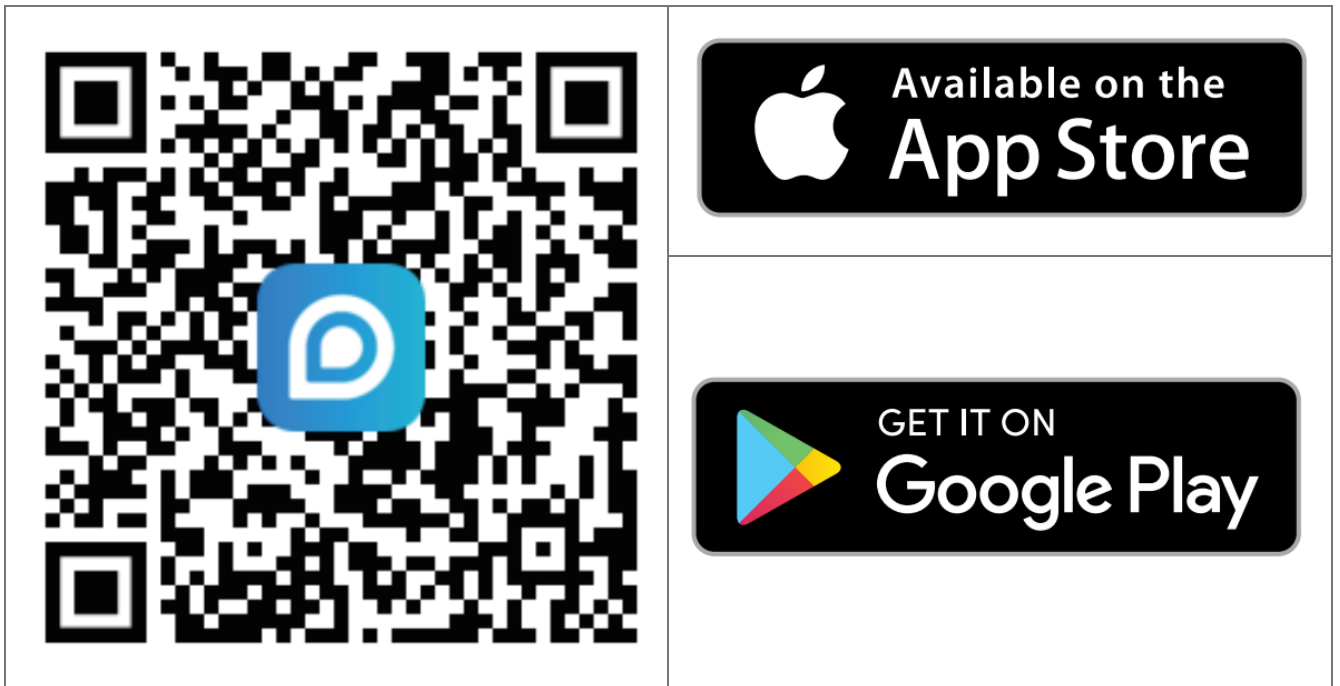

- On PC

Download path of the Reolink Client: Go to [reolink.com](https://reolink.com) > Support > App & Client

### Charge the Battery

It's recommended to fully charge the battery before mounting the camera outdoors.

- Charge the battery with a power adapter. (not included).

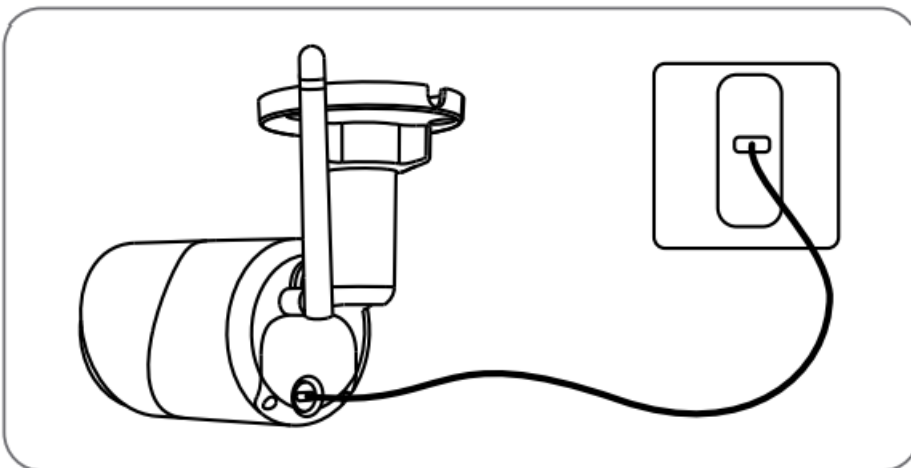

- Charge the battery with Reolink Solar Panel (Not included if you only purchase the camera).

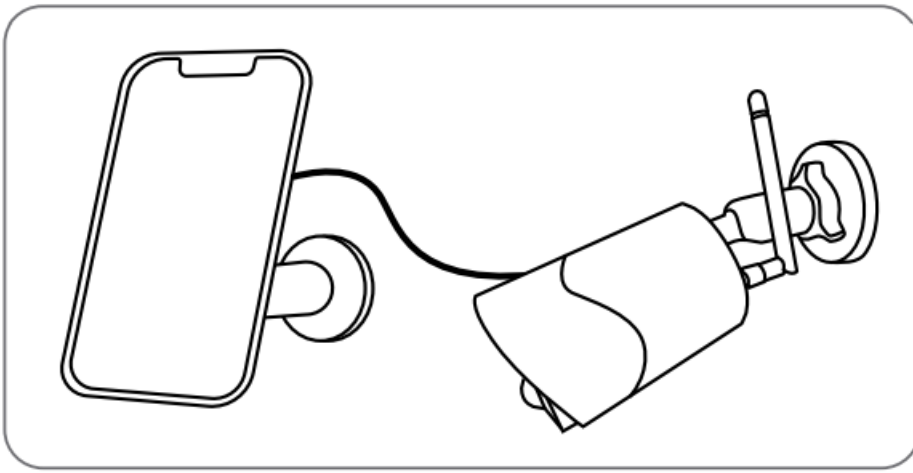

- For better weatherproof performance, please always cover the USB charging port with the rubber plug after charging the battery.

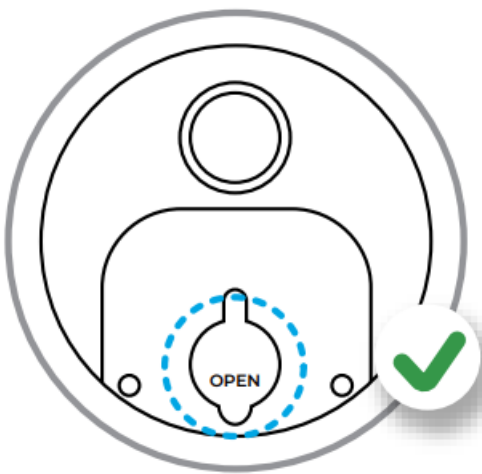

#### Charging indicator:



**Orange LED:** Charging



**Green LED:** Fully charged

#### Install the Camera

- Install the camera 2-3 meters (7-10 ft) above the ground. This height maximizes the detection range of the PIR motion sensor.
- For better motion detection performance, please install the camera angularly.

**NOTE:** If a moving object approaches the PIR sensor vertically, the camera may fail to detect motion.



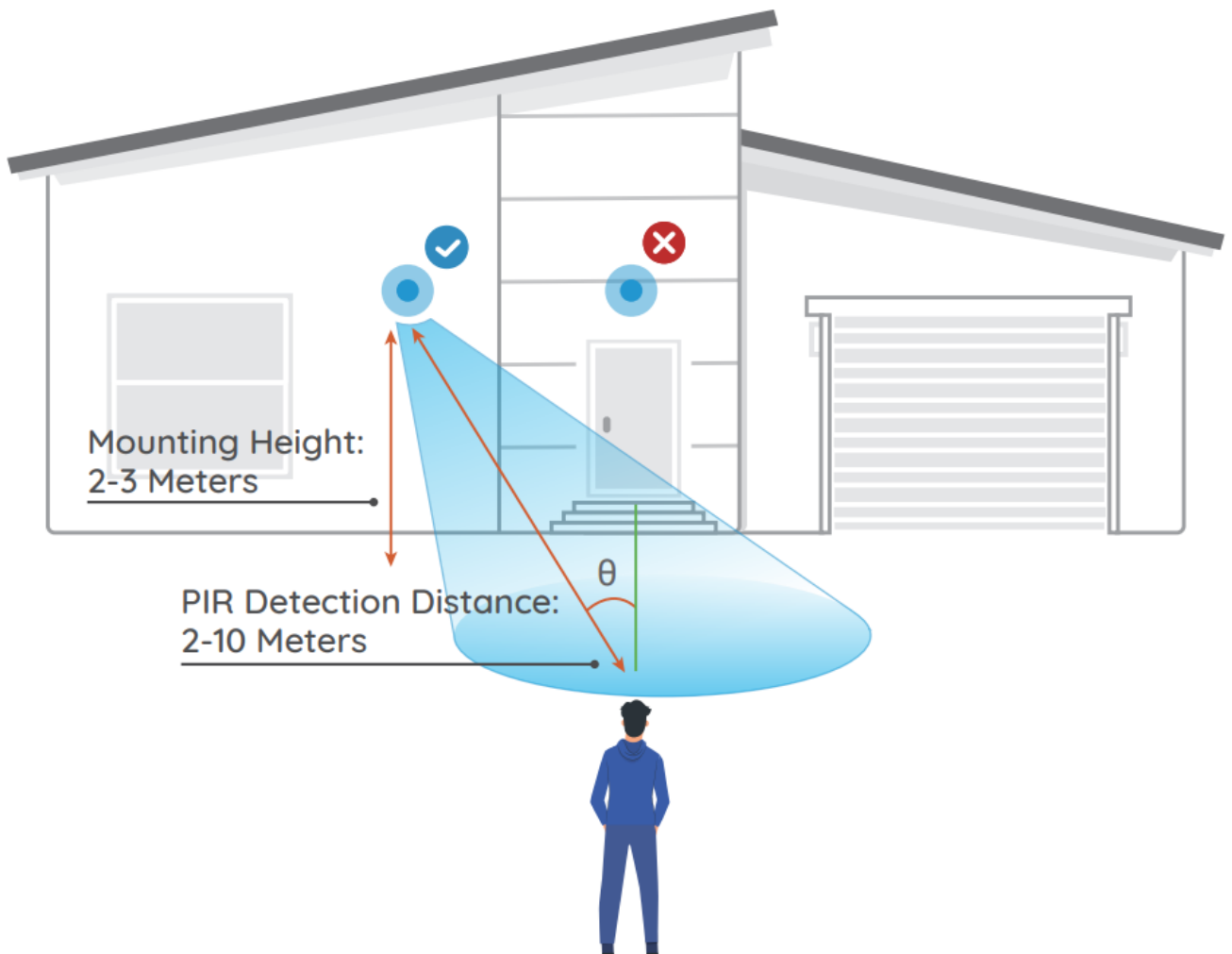

### Mount the Camera to Wall

1. Drill holes in accordance with a mounting hole template and screw the security mount into the wall. If you are mounting the camera on any hard surface, insert plastic anchors into the holes first.

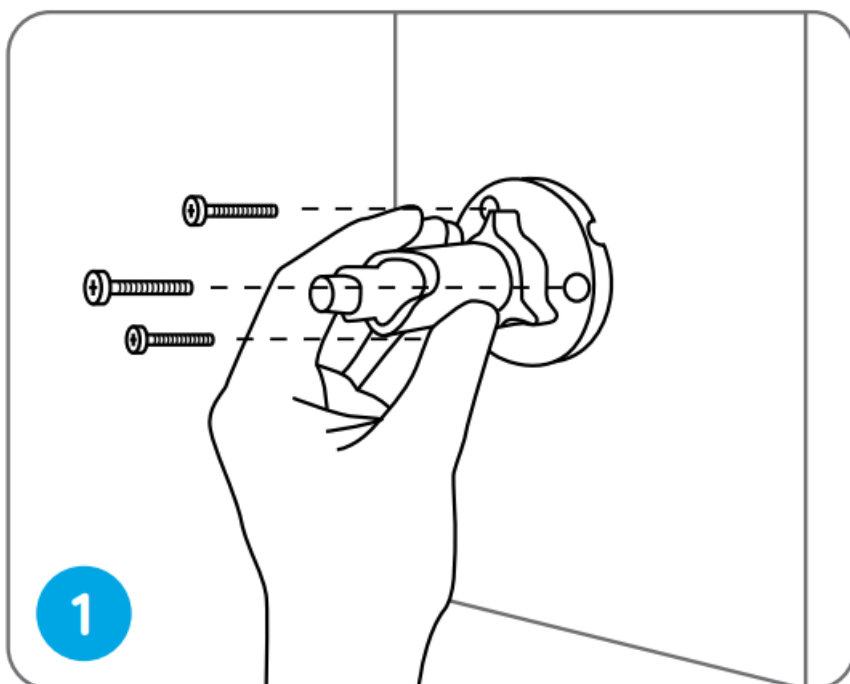

2. Screw the antenna to the camera and then install the camera to the security mount.

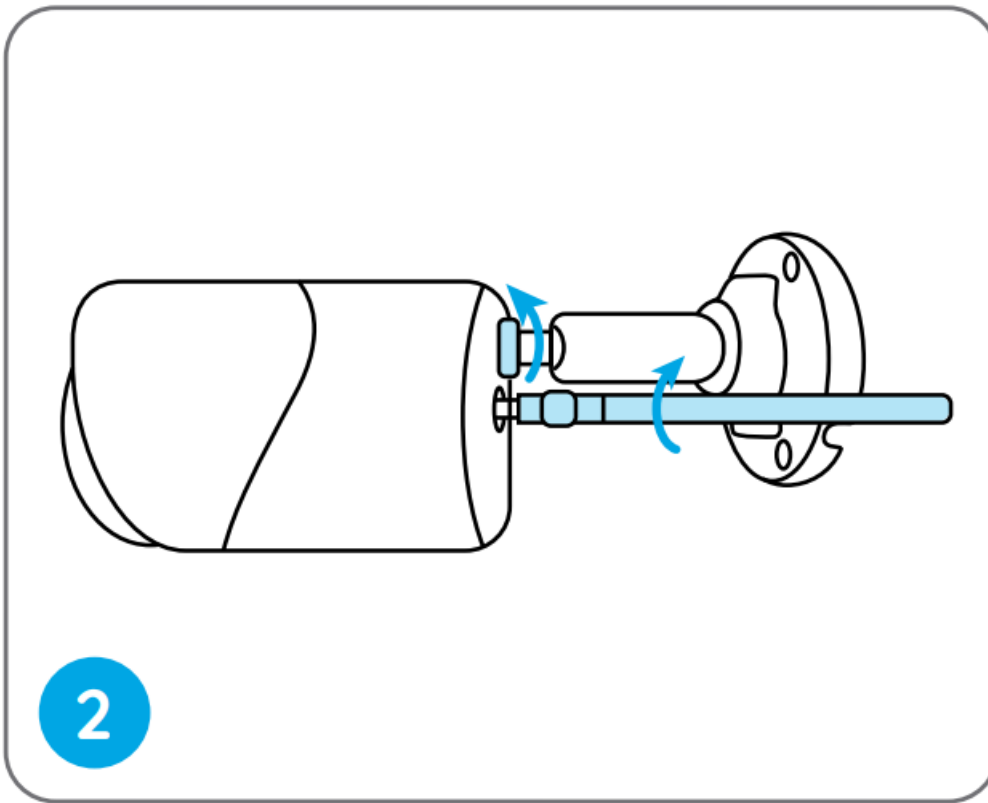

3. Loose the adjusting knob on the mount and adjust the camera to the proper direction.

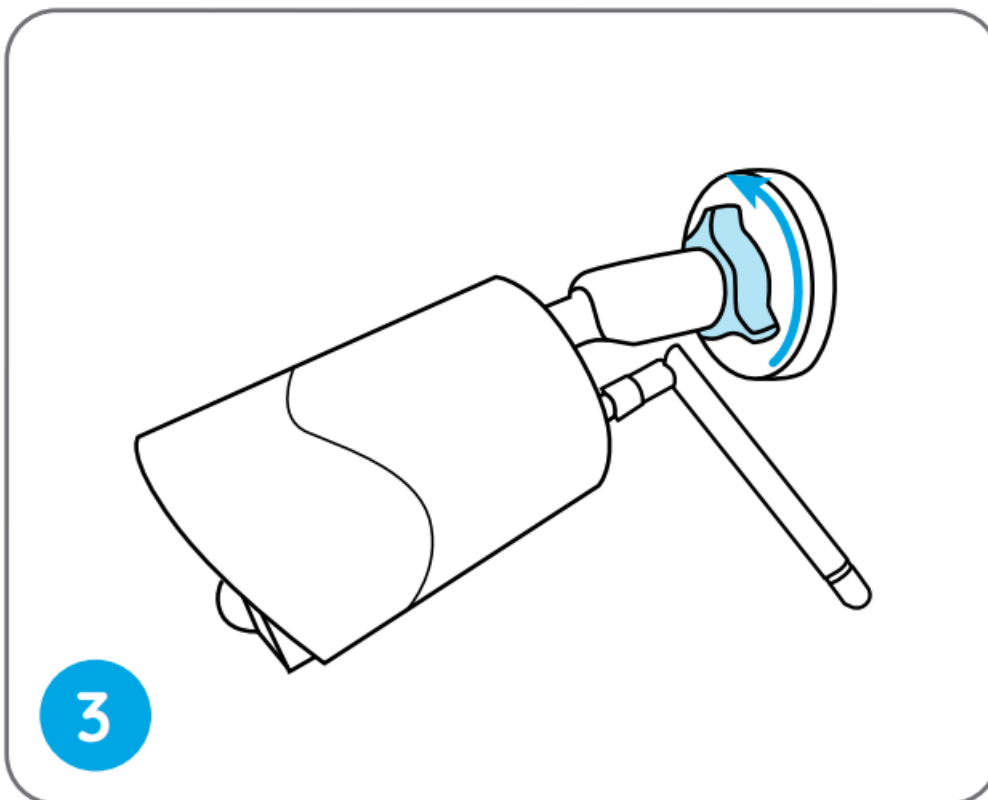

4. Stiffen the adjustment knob to lock the camera.

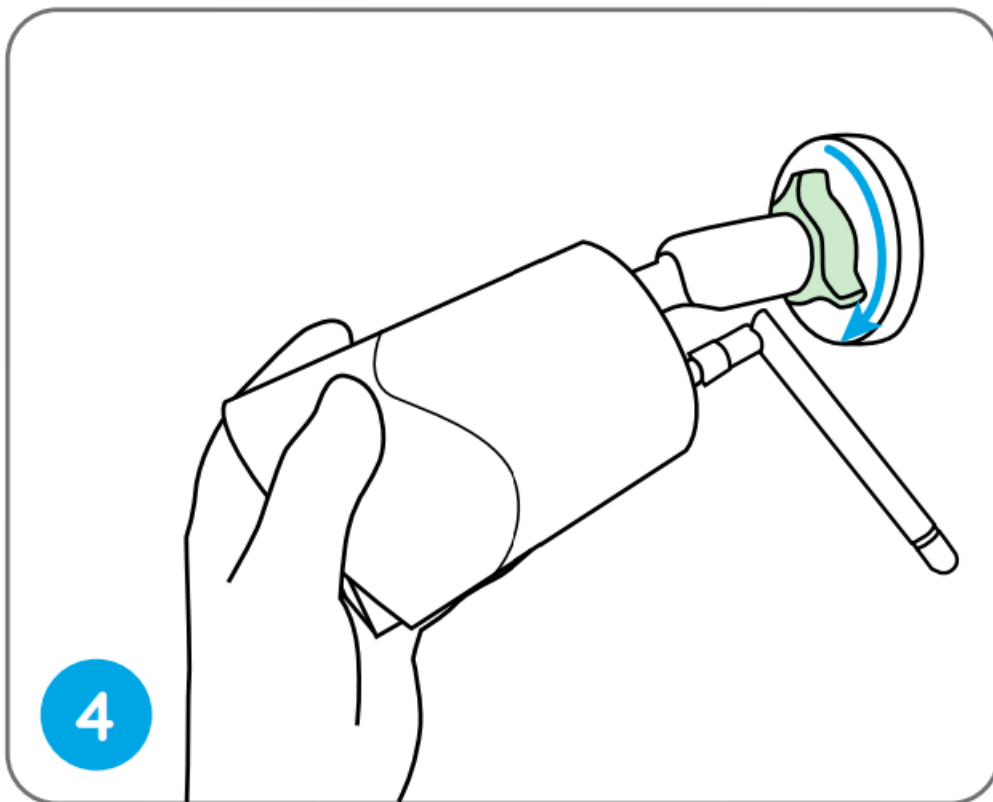

#### Attach the Camera to a Tree

1. Thread the provided strap to the mounting plate.

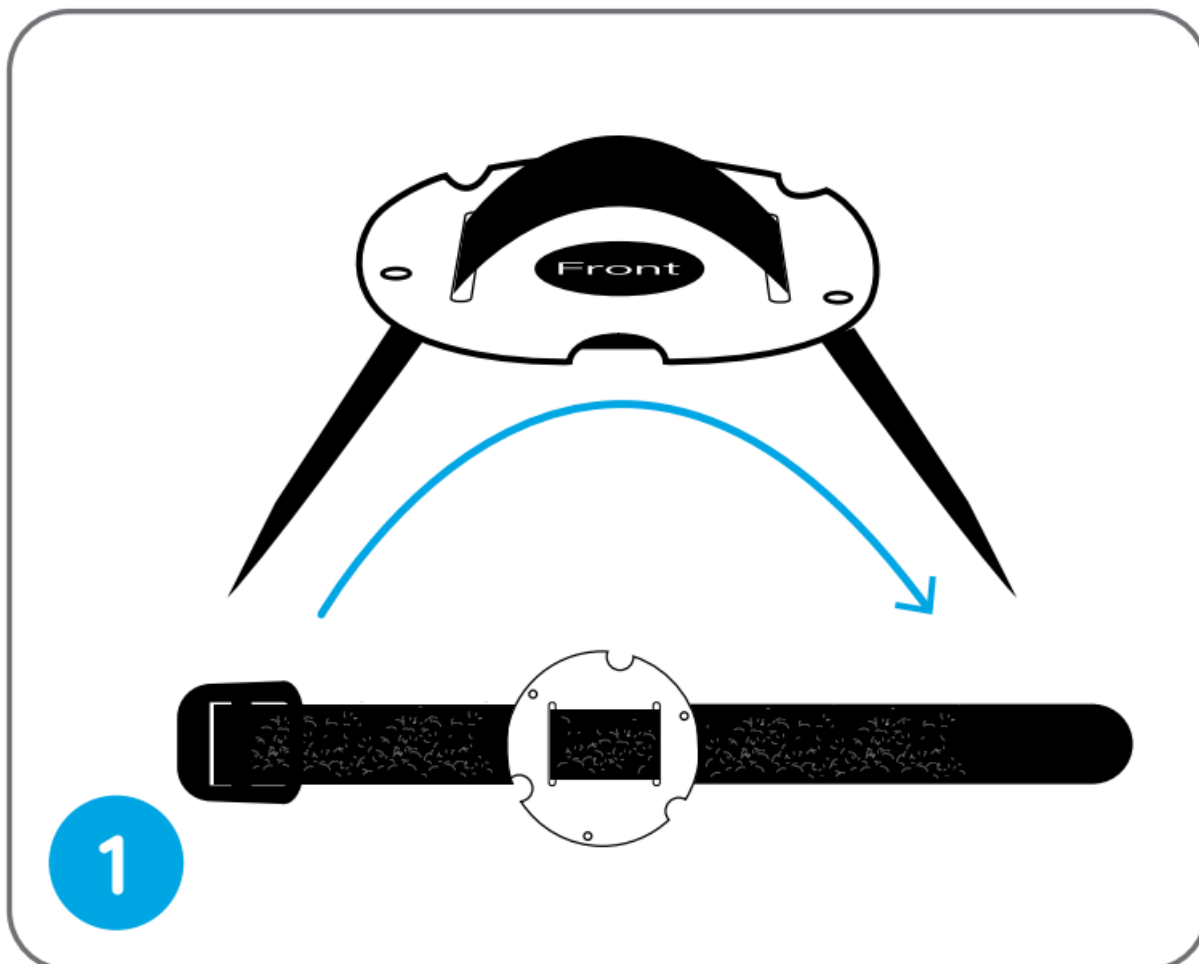

2. Attach the plate to the security mount with the smaller screws.

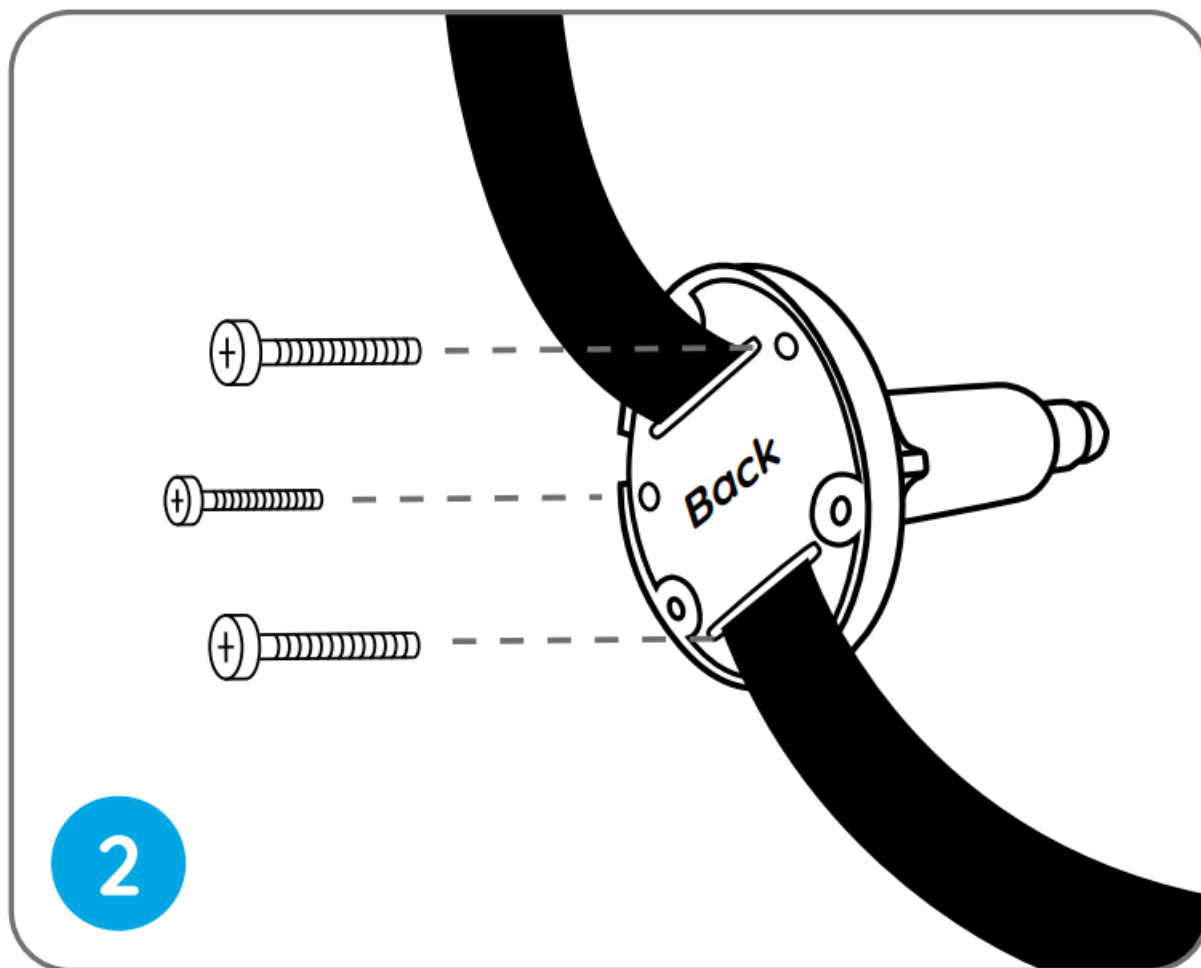

3. Fasten the security mount to a tree.

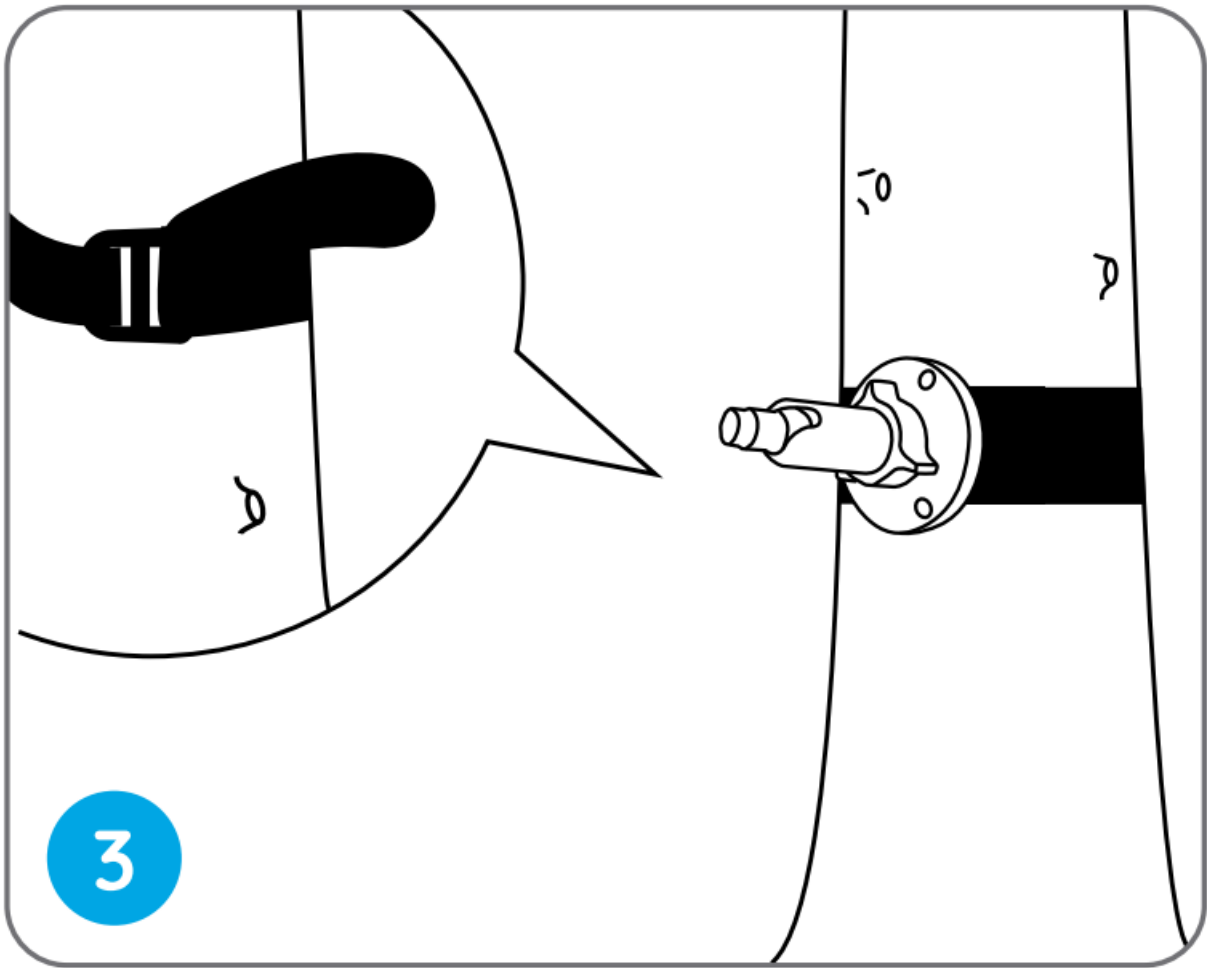

4. Install the camera and adjust the camera angles as instructed in step 3 in the previous installation guide.

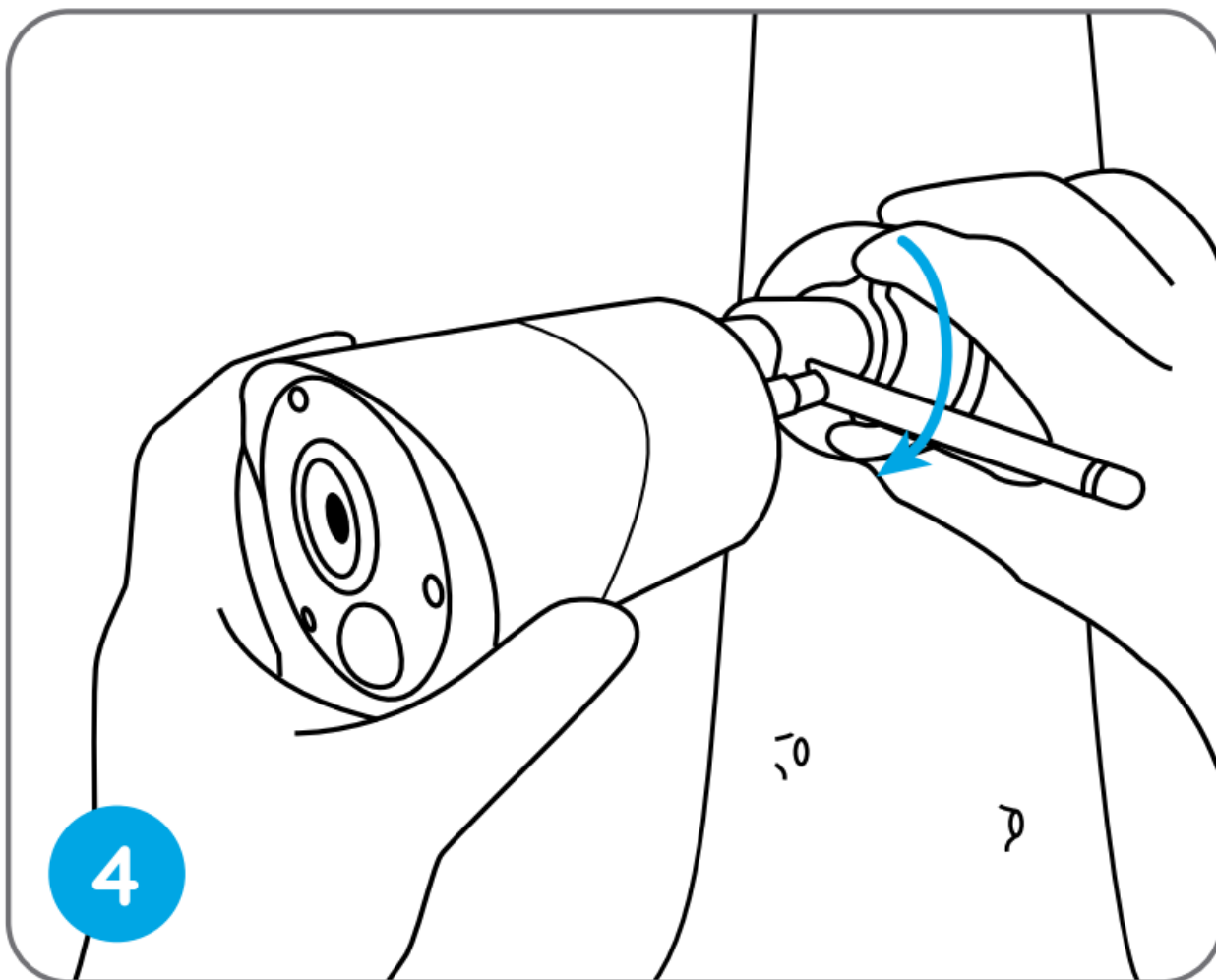

## Notes on PIR Motion Sensor

### PIR Sensor Detection Distance

The PIR detection range can be customized to meet your specific needs. You can refer to the following table to set it up in Device Settings via Reolink App.

Sensitivity	Value	Detection Distance (For moving and living objects)
Low	0 – 50	Up to 5 meters (16ft)
Mid	51 – 80	Up to 8 meters (26ft)
High	81 – 100	Up to 10 meters (33ft)

**NOTE:** Higher sensitivity offers longer detection distance but it may lead to more false alarms. It's recommended to set up the sensitivity level to “Low” or “Mid” when you install the camera outdoors.



### Important Notes on Reducing False Alarms

- Do not face the camera towards any objects with bright lights, including sunshine, bright lamp lights, etc.
- Do not place the camera too close to a place with heavy traffic. Based on our numerous tests, the

recommended distance between the camera and the vehicle would be 16 meters (52ft).

- Do not place the camera near outlets, including the air conditioner vents, humidifier outlets, the heat transfer vents of projectors, etc.
- Do not install the camera at places with strong wind.
- Do not face the camera towards a mirror.
- Keep the camera at least 1 meter away from any wireless devices, including WiFi routers and phones in order to avoid wireless interference.

## **Important Notes on Rechargeable Battery Usage**

Reolink Argus Eco is not designed for 24/7 full capacity running or around-the-clock live streaming. It's designed to record motion events and remotely view live streaming only when you need it.

1. Charge the rechargeable battery with a standard and high-quality DC 5V/9V battery charger or Reolink solar panel. Do not charge the battery with solar panels from any other brands.
2. Charge the battery when temperatures are between 0°C and 45°C and always use the battery when temperatures are between -20°C and 60°C.
3. Keep the USB charging port dry, clean and free of any debris and cover the USB charging port with the rubber plug when the battery is fully charged.
4. Do not disassemble, cut, puncture, short-circuit the battery, or dispose of the battery in water,
5. Do not charge, use or store the battery near any ignition sources, such as fire or heaters. fire, microwave ovens and pressure vessels.
6. Do not use the battery if it gives off an odor, generates heat, becomes discolored or deformed, or appears abnormal in any ways. If the battery is being used or charged, turn off the power switch or remove the charger immediately, and stop using it.
7. Always follow the local waste and recycle laws when you get rid of the used battery.

## **Troubleshooting**

### **Camera is not Powering on**

If your camera is not powering on, please apply the following solutions:

- Make sure the power switch is turned on.
- Charge the battery with a DC 5V/2A power adapter. When the green light is on, the battery is fully charged.

If these won't work, please contact Reolink Support.

### **Failed to Scan the QR Code on the Phone**

If the camera cannot scan the QR code on your phone, please try the following solutions:

- Remove the protective film from the camera lens.
- Wipe the camera lens with a dry paper/towel/tissue.
- Vary the distance between your camera and the mobile phone so that the camera can focus better.

- Try to scan the QR code under sufficient lighting.

If these won't work, please contact Reolink Support.

## WiFi Connection Failed During Initial Setup Process

If the camera fails to connect to WiFi, please try the following solutions:

- Please make sure the WiFi band is 2.4GHz, the camera does not support 5GHz.
- Ensure that you have entered the correct WiFi password.
- Put the camera closer to your router to ensure a strong WiFi signal.
- Change the encryption method of the WiFi network to WPA2-PSK/WPA-PSK (safer encryption) on your router interface.
- Change your WiFi SSID or password and make sure that SSID is within 31 characters and password is within 64 characters.
- Set your password using only the characters available on the keyboard.

If these won't work, please contact Reolink Support.

## Specifications

### Video

**Video Resolution:** 2312 x 1304@15FPS

**Field of View:** Horizontal: 88° / Vertical: 50°

**Night Vision:** Up to 10m (33 ft)

### PIR Detection & Alerts

**PIR Detection Distance:** Adjustable/up to 10m (33 ft)

**PIR Detection Angle:** 100° horizontal

**Audio Alert:** Customized voice-recordable alerts

**Other Alerts:** Instant email alerts and push notifications

### General

**Operating Temperature:** -10°C to 55°C (14°F to 131°F)

**Weather Resistance:** IP65 certified weatherproof

**Size:** 71 x 186 mm

**Weight (Battery included):** 320g (11.2 oz)

## Notification of Compliance

### FCC Compliance Statement

This device complies with Part 15 of FCC Rules. Operation is subject to the following two conditions: (1) this device may not cause harmful interference, and (2) this device must accept any interference received, including

**Operating Temperature:** -10°C to 55°C (14°F to 131°F)

**Weather Resistance:** IP65 certified **weatherproof** **Size:** 71 x 186 mm interference that may cause undesired



operation.



#### **Simplified EU Declaration of Conformity**

Reolink declares that this device is in compliance with the essential requirements and other relevant provisions of Directive 2014/53/EU.



#### **Correct Disposal of This Product**

This marking indicates that this product should not be disposed with other household wastes throughout the EU. To prevent possible harm to the environment or human health from uncontrolled waste disposal, recycle it responsibly to promote the sustainable reuse of material resources. To return your used device, please use the return and collection systems or contact the retailer where the product was purchased. They can take this product for environment safe recycling.

#### **Limited Warranty**

This product comes with a 2-year limited warranty that is valid only if purchased from Reolink Official Store or a Reolink authorized reseller.

**NOTE:** We hope that you enjoy the new purchase. But if you are not satisfied with the product and plan to return, we strongly suggest that you reset the camera to factory default settings and take out the inserted SD card before returning.

#### **Terms and Privacy**

Use of the product is subject to your agreement to the Terms of Service and Privacy Policy at [reolink.com](https://reolink.com). Keep out of reach of children.

#### **End User License Agreement**

By using the Product Software that is embedded on the Reolink product, you agree to the terms of this End User License Agreement ("EULA") between you and Reolink.

#### **ISED Radiation Exposure Statement**

This equipment complies with RSS-102 radiation exposure limits set forth for an uncontrolled environment. This equipment should be installed and operated with minimum distance 20cm between the radiator & your body.

#### **OPERATING FREQUENCY**

(the maximum transmitted power)

2412MHz—2472MHz (18dBm)

Customer Support

REOLINK INNOVATION LIMITED  
FLAT/RM 705 7/F FA YUEN COMMERCIAL BUILDING 75-77 FA YUEN STREET MONG KOK KL HONG KONG



Product Ident GmbH

Hoferstasse 9B, 71636 Ludwigsburg, Germany [prodsg@libelleconsulting.com](mailto:prodsg@libelleconsulting.com)



APEX CE SPECIALISTS LIMITED

89 Princess Street, Manchester, M1 4HT, UK [info@apex-ce.com](mailto:info@apex-ce.com)



Documents / Resources

	<a href="#">reolink Argus Eco Solar Powered Wifi Camera WaterProof</a> [pdf] User Manual Argus Eco Solar Powered Wifi Camera WaterProof, Argus Eco, Solar Powered Wifi Camera WaterProof, Powered Wifi Camera WaterProof, Wifi Camera WaterProof, Camera WaterProof, WaterProof
--	--

References

- [Reolink Official: Security Cameras and Systems for Home & Business](#)
- [User Manual](#)