



reolink A2KPTSM Argus PT Plus Camera Instruction Manual

[Home](#) » [reolink](#) » reolink A2KPTSM Argus PT Plus Camera Instruction Manual 

Contents

- 1 reolink A2KPTSM Argus PT Plus Camera
- 2 Product Information
 - 2.1 What's in the Box
 - 2.2 Camera Introduction
- 3 Product Usage Instructions
 - 3.1 Set up the Camera
 - 3.2 Charge the Camera
 - 3.3 Install the Camera
- 4 Safety Instructions of Battery Usage
- 5 Troubleshooting
- 6 Specification
- 7 Notification of Compliance
- 8 FCC Radiation Exposure statement
- 9 Limited Warranty
- 10 Terms and Privacy
- 11 WiFi Operating Frequency
- 12 FAQ (Frequently Asked Questions)
- 13 Technical Support
- 14 Documents / Resources
 - 14.1 References



reolink A2KPTSM Argus PT Plus Camera



Specifications

- **Model:** Argus PT Ultra, Argus PT Plus 4K, Reolink Argus PT, Reolink Argus PT Plus
- **Manufacturer:** Reolink Innovation Limited
- **Address:** FLAT/RM 705 7/F FA YUEN COMMERCIAL BUILDING 75-77 FA YUEN STREET MONG KOK KL HONG KONG
- **EU Representative:** Product Ident GmbH, Hoferstasse 9B, 71636 Ludwigsburg, Germany
- **Email (EU):** prodsg@libelleconsulting.com
- **UK Representative:** APEX CE SPECIALISTS LIMITED, 89 Princess Street, Manchester, M14HT, UK
- **Email (UK):** info@apex-ce.com

Product Information

What's in the Box

- camera
- Camera Bracket
- Mount Base
- Type-C Cable
- Antenna
- Reset Needle
- Quick Start Guide
- Surveillance Sign
- Pack of Screws
- Mounting Template
- Hex Key

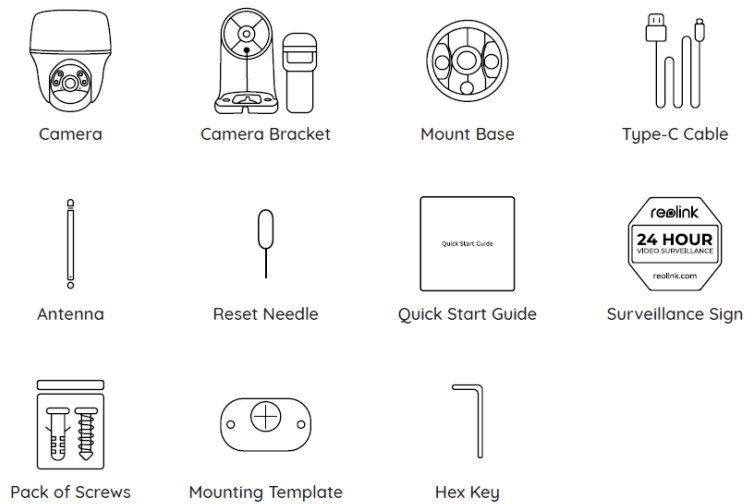

Camera Introduction

1. Lens
2. IR LEDs
3. spotlight
4. Daylight Sensor
5. Built-in PIR Sensor
6. Built-in Mic
7. Status LED
8. Speaker
9. Reset Hole (Press for more than five seconds to restore the device to default settings)
10. Micro SD Card Slot (Rotate the camera's lens to find the reset hole and the SD card slot)
11. Power Switch
12. Antenna
13. Charging Port
14. Battery Status LED

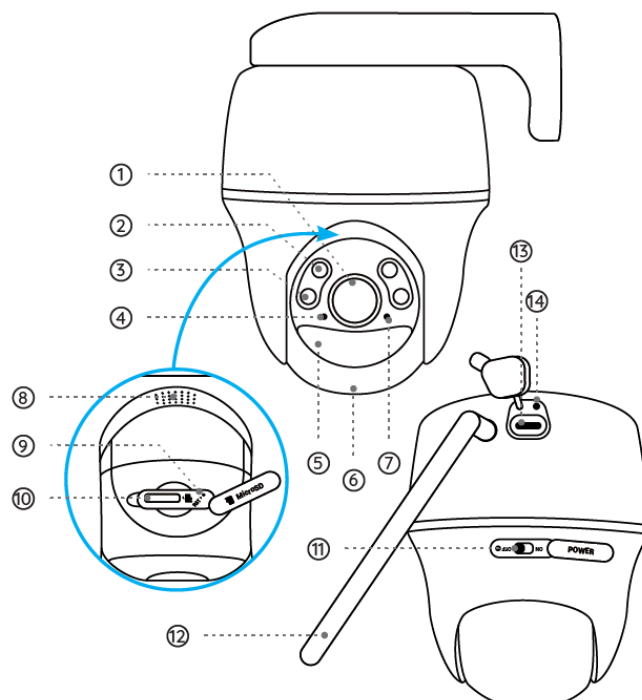

(Different states: Red Light – WiFi connection failed, Blue Light – WiFi connection succeeded, Blinking Standby status, On – Working status)

Different states of the status LED:

- **Red Light:** WiFi connection failed
- **Blue Light:** WiFi connection succeeded
- **Blinking:** Standby status
- **On:** Working status

Product Usage Instructions

Set up the Camera

Set up the Camera Using a Smartphone

1. Scan to download the Reolink App from the App Store or Google Play store.



2. Turn on the power switch to power on the camera.

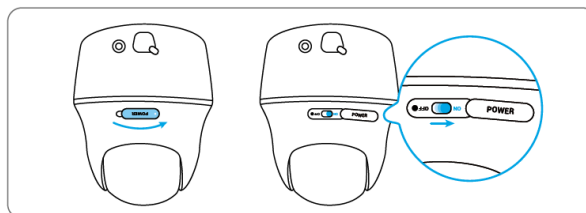

3. Launch the Reolink App, click the button in the top right corner to add the camera. Scan the QR code on the device and follow the onscreen instructions to finish initial setup.

NOTE: This device supports 2.4 GHz and 5 GHz Wi-Fi networks. It is recommended to connect the device to 5 GHz Wi-Fi for a better network experience.

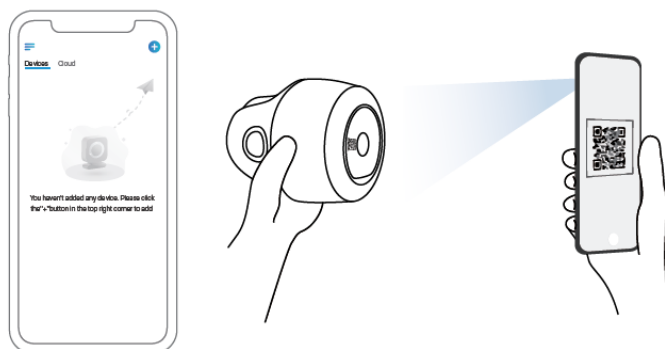

Set up the Camera on PC (Optional)

1. Download and install the Reolink Client from <https://reolink.com>Support>App&Client>.

2. Launch the Reolink Client, click the button, input the UID code of the camera to add it, and follow the onscreen instructions to finish initial setup.

Charge the Camera

It's recommended to fully charge the battery before mounting the camera.

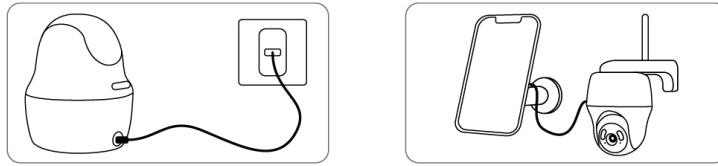

- Charge the battery with a power adapter (not included).
- Charge the battery with the Reolink Solar Panel (Not included if you only purchase the camera).

Charging Indicator:

- Orange LED
 - Charging,
- Green LED
 - Fully charged.

For better weatherproof performance, please always cover the USB charging port with the rubber plug after charging the battery.



Install the Camera

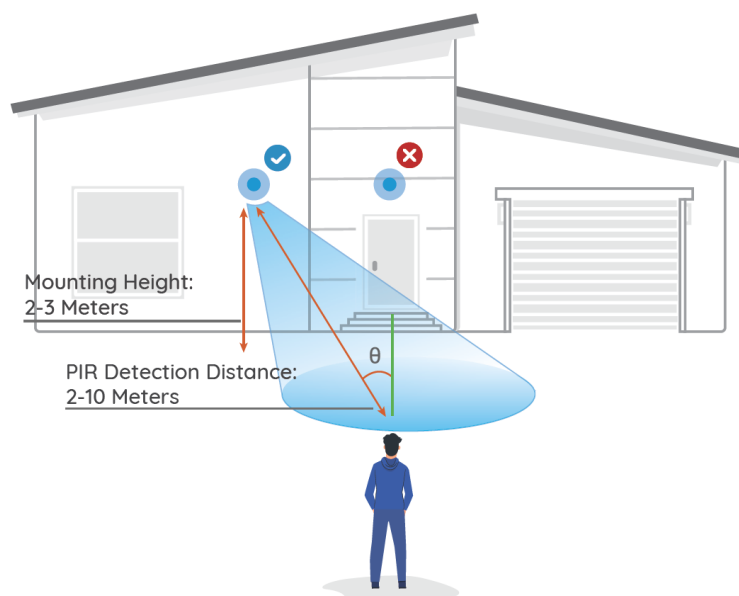

Notes on Camera Installation Position

- Mounting Height: 2-3 Meters

- PIR Detection Distance: 2-10 Meters
- NOTE: If a moving object approaches the PIR sensor vertically, the camera may fail to detect motion.
- The camera MUST be installed upside down for better waterproof performance and better PIR motion sensor's efficiency.
- Install the camera 2-3 meters (7-10 ft) above the ground. This height maximizes the detection range of the PIR motion sensor.
- For better motion detection performance, please install the camera angularly.

Mount the Camera

1. Drill holes by the mounting hole template and screw the camera bracket to the wall.
2. Install the antenna to the camera.

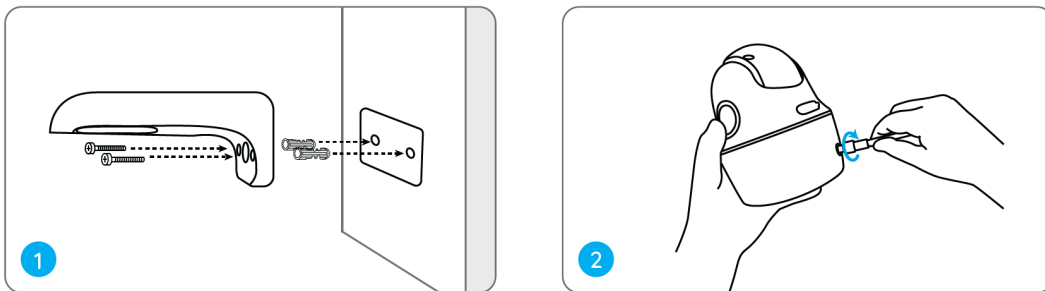

NOTE: Use the drywall anchors included in the package if needed.

3. Align the white hole on the camera top with the white hollow screw on the bracket. Use a wrench and a hex head screw provided to secure the camera into place. Then cover the rubber plug.

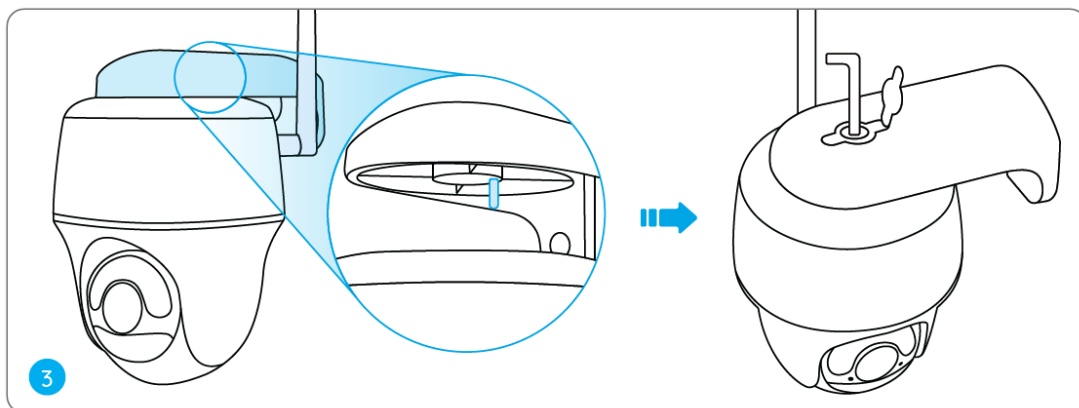

Mount the Camera to Ceiling

1. Install the mount base to the ceiling. Align the camera with the mount base and turn the camera unit clockwise to lock it in position.

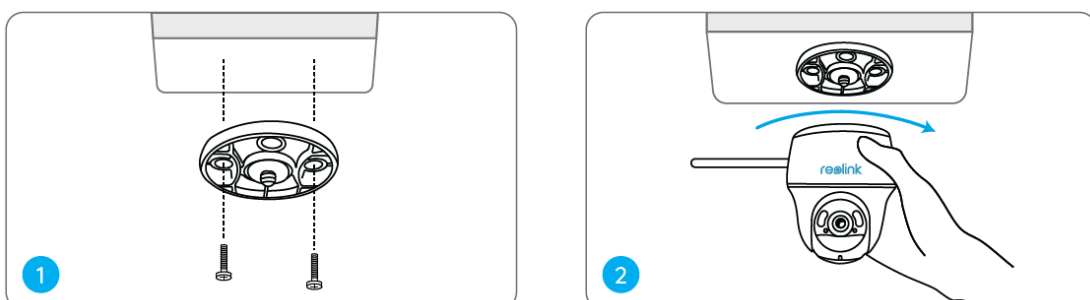

Install the Camera with Loop Strap

You are allowed to strap the camera to a tree with both the security mount and ceiling bracket. Thread the provided strap to the plate and fasten it to a tree. Next, attach the camera to the plate and you are good to go.

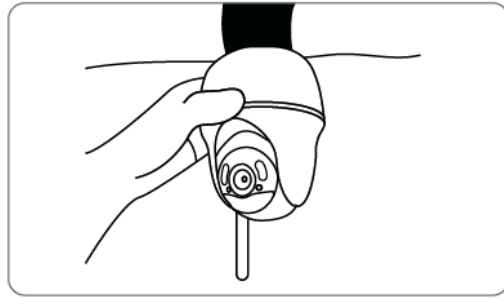
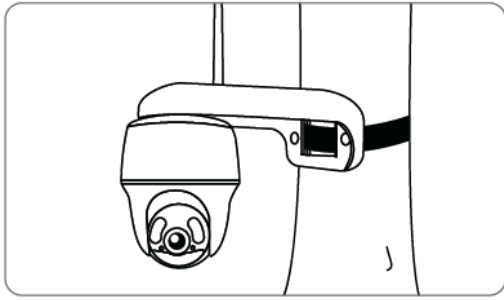

Safety Instructions of Battery Usage

The camera is not designed for running 24/7 at full capacity or around-the-clock live streaming. It's designed to record motion events and to live view remotely only when you need it. Learn useful tips on how to extend the battery life in this post: <https://support.reolink.com/hc/en-us/articles/360006991893>

1. Do not remove a built-in battery from the camera.
2. Charge the battery with a standard and high-quality DC 5V battery charger or Reolink solar panel. It's not compatible with solar panels from any other brands.
3. Charge the battery only if in temperatures between 0°C and 45°C. The battery is intended for use only in temperatures between -10°C and 55°C.
4. Keep the charging port dry, clean and free of any debris. Cover it with the rubber plug after the battery is fully charged.
5. Do not charge, use or store the battery next to areas that may become hot. Examples include but are not limited to, on or near a space heater, cooking surface, cooking appliance, iron, radiator, or fireplace.
6. Do not use the battery if its case appears damaged, swollen, or compromised. Examples include but are not limited to, leaking, odours, dents, corrosion, rust, cracks, swelling, melting, and scratches.
7. Always follow the local waste and recycling laws to dispose of used batteries.

Troubleshooting

The camera is Not Powering On

If your camera is not powering on, please try the following solutions:

- Make sure the power switch is turned on.
- Charge the battery with a DC 5V/2A power adapter. When the green light is on, the battery is fully charged

If these won't work, contact Reolink Support.

Failed to Scan QR Code on the Phone

If you cannot scan the QR code on your phone, please try the following solutions:

- Remove the protective film from the camera lens.
- Wipe the camera lens with a dry paper/ towel/tissue.
- Vary the distance between your camera and the mobile phone so that the camera can focus better.
- Try to scan the QR code under sufficient lighting.

If these won't work, contact Reolink Support.

Failed to Connect to WiFi During Initial Setup Process

If the camera fails to connect to WiFi, please try the following solutions:

- Ensure that you have entered the correct WiFi password.
- Put the camera closer to your router to ensure a strong WiFi signal.
- Change the encryption method of the WiFi network to WPA2-PSK/WPA-PSK (safer encryption) on your router interface.
- Change your WiFi SSID or password and make sure that SSID is within 31 characters and password is within 64 characters.

If these won't work, contact Reolink Support.

Specification

Operating Temperature: -10°C to 55°C (14°F to 131°F)

Size: 98 x 122 mm

Weight (Battery included): 481g

For more specifications, visit the Reolink official website.

Notification of Compliance



CE Declaration of Conformity

Reolink declares that this device is in compliance with the essential requirements and other relevant provisions of Directive 2014/53/EU and Directive 2014/30/EU.

UKCA Declaration of Conformity

Reolink declares that this product is in compliance with Radio Equipment Regulations 2017 and Electromagnetic Compatibility Regulations 2016.

FCC Compliance Statements

This device complies with Part 15 of the FCC Rules.

Operation is subject to the following two conditions:

1. this device may not cause harmful interference, and
2. this device must accept any interference received, including interference that may cause undesired operation.

Note: This equipment has been tested and found to comply with the limits for a Class B digital device, pursuant to Part 15 of the FCC Rules. These limits are designed to provide reasonable protection against harmful interference in a residential installation.

This equipment generates, uses and can radiate radio frequency energy and, if not installed and used in accordance with the instructions, may cause harmful interference to radio communications. However, there is no guarantee that interference will not occur in a particular installation. If this equipment does cause harmful interference to radio or television reception, which can be determined by turning the equipment off and on, the user is encouraged to try to correct the interference by one or more of the following measures:

- Reorient or relocate the receiving antenna.

- Increase the separation between the equipment and receiver.
- Connect the equipment into an outlet on a circuit different from that to which the receiver is connected.
- Consult the dealer or an experienced radio/ TV technician for help.

Caution: Changes or modifications not expressly approved by the party responsible for compliance could void the user's authority to operate the equipment.

FCC Radiation Exposure statement

This equipment complies with FCC radiation exposure limits set forth for an uncontrolled environment. This equipment should be installed and operated with a minimum distance 20cm between the radiator and your body.

ISED Compliance Statements

This device contains licence-exempt transmitter(s)/receiver(s) that comply with Innovation, Science and Economic Development Canada's licence-exempt RSS(s).

Operation is subject to the following two conditions:

1. This device may not cause interference.
2. This device must accept any interference, including interference that may cause undesired operation of the device.

ISED Radiation Exposure Statement

This equipment complies with IC RSS-102 radiation exposure limits set forth for an uncontrolled environment. This equipment should be installed and operated with a minimum distance of 20 cm between the radiator and your body.

NOTE: Operation of 5150-5250 MHz is restricted to indoor use only in Canada.



Correct Disposal of This Product

This marking indicates that this product should not be disposed of with other household wastes throughout the EU. To prevent possible harm to the environment or human health from uncontrolled waste disposal, recycle it responsibly to promote the sustainable reuse of material resources. To return your used device, please use the return and collection systems or contact the retailer where the product was purchased. They can take this product for environmentally safe recycling.

Limited Warranty

This product comes with a 2-year limited warranty that is valid only if purchased from Reolink Official Store or a Reolink authorized reseller. Learn more: <https://reolink.com/warranty-and-return/>.

Terms and Privacy

Use of the product is subject to your agreement to the Terms of Service and Privacy Policy at reolink.com. Keep out of reach of children.

WiFi Operating Frequency

OPERATING FREQUENCY : (the maximum transmitted power)

- **2.4GHz:** (For 2.4GHz camera only):
 - 2412MHz — 2472MHz (EIRP < 20 dBm)
 - 5GHz:
 - 5150MHz — 5250MHz (EIRP < 23 dBm)
 - 5745MHz — 5825MHz (EIRP < 14 dBm)



The functions of Wireless Access Systems including Radio Local Area Networks(WAS/RLANs) within the band 5150-5350 MHz for this device are restricted to indoor use only within all European Union countries (BE/BG/CZ/DK/DE/EE/IE/EL/ES/FR/HR/ IT/CY/LV/LT/LU/HU/MT/NL/AT/PL/PT/RO/SI/SK/FI/SE/TR/N O/CH/IS/LI/UK(NI))

FAQ (Frequently Asked Questions)

Q: What are the supported Wi-Fi networks?

A: The device supports both 2.4 GHz and 5 GHz Wi-Fi networks. It is recommended to connect to a 5 GHz Wi-Fi network for a better network experience.

Q: How can I charge the camera?

A: You can charge the camera using a power adapter (not included) or with the Reolink Solar Panel (not included if you only purchase the camera). The charging indicator will show an orange LED when charging and a green LED when fully charged.

Q: What is the recommended mounting height for the camera?

A: The recommended mounting height for the camera is 2-3 meters.

Q: How far can the PIR sensor detect motion?

A: The PIR sensor can detect motion within a distance of 2-10 meters.

Technical Support

If you need any technical help, please visit our official support site and contact our support team before returning the products, <https://support.reolink.com>.

Product Ident GmbH
Hoferstasse 9B, 71636 Ludwigsburg, Germany
Email: prodsg@libelleconsulting.com

APEX CE SPECIALISTS LIMITED

Addr.: 89 Princess Street, Manchester, M14HT, UK
Email: info@apex-ce.com

May 2023 QSG1_A 58.03.005.0110

@ReolinkTech
<https://reolink.com>

Documents / Resources

	reolink A2KPTSM Argus PT Plus Camera [pdf] Instruction Manual A2KPTSM Argus PT Plus Camera, A2KPTSM, Argus PT Plus Camera, PT Plus Camera, Plus Camera, Camera
---	---

References

- [ce.com](#)
- [Reolink Official: Security Cameras and Systems for Home & Business](#)
- [Reolink Official: Security Cameras and Systems for Home & Business](#)
- [Warranty & Return – Reolink](#)
- [Reolink Support - Official Reolink Help Center](#)
- [How to Extend the Battery Life of Reolink Battery Powered Cameras](#)
- [User Manual](#)