



# Reolink 500WB4 5MP Wireless Security Camera System User Guide

[Home](#) » [reolink](#) » Reolink 500WB4 5MP Wireless Security Camera System User Guide 

## Contents

- 1 Reolink 500WB4 5MP Wireless Security Camera System User Guide
- 2 What's in the Box
- 3 NVR Introduction
- 4 Different states of the status LEDs:
- 5 Camera Introduction
- 6 Network Topology Diagram
- 7 NOTE:
- 8 Connection Diagram
- 9 Access the NVR via Smartphone or PC
- 10 Mount Tips for the Camera
- 11 Installation Tips
- 12 Troubleshooting
- 13 Camera Not Displaying Images on the Monitor Cause 1 Camera is not Powering on
- 14 Solutions:
- 15 Cause 2 Incorrect Account Name or PasswordSolution:
- 16 Cause 3 Camera is not Assigned to a Channel
- 17 Cause 4 No Wi-Fi After Removing the Ethernet Cable
- 18 Specification
- 19 NVR
- 20 Camera
- 21 Notification of Compliance
- 22 FCC Compliance Statements
- 23 FCC Radiation Exposure statement
- 24 ISED Compliance Statements
- 25 ISED Radiation Exposure statement
- 26 Simplified EU Declaration of Conformity
- 27 Wi-Fi Operating Frequency
- 28 UKCA Declaration of Conformity
- 29 Limited Warranty
- 30 Terms and Privacy
- 31 Read More About This Manual & Download PDF:
- 32 Documents / Resources
  - 32.1 References

## Reolink 500WB4 5MP Wireless Security Camera System User Guide



## What's in the Box

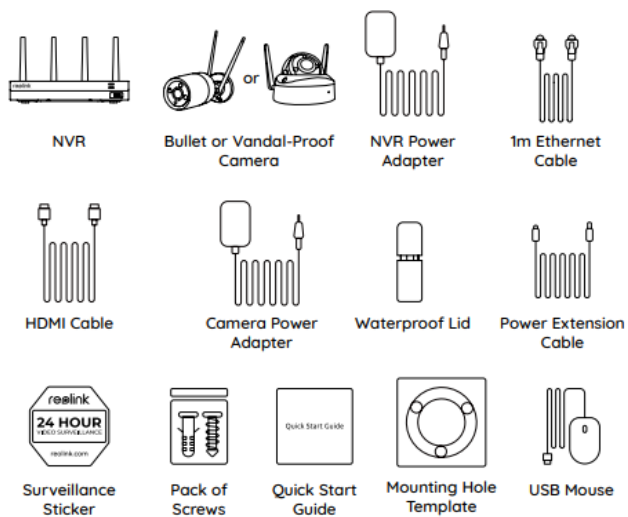

## NVR Introduction

1. Power LED
2. HDD LED
3. USB Port
4. Reset
5. Power Input
6. USB Port
7. HDMI Port
8. VGA Port
9. Audio Out
10. LAN Port(For Internet)

### Different states of the status LEDs:

Power LED: Solid green to indicate the NVR is powered on.  
HDD LED: Flashing red to indicate the hard drive is operating properly.

## Camera Introduction

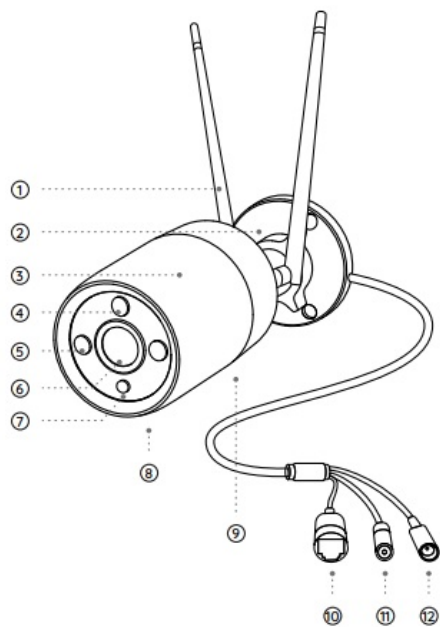

1. Antenna
2. Mount
3. Metal Aluminum Case
4. Spotlight
5. IR LEDs
6. Lens
7. Daylight Sensor
8. Built-in Mic
9. Speaker
10. Network Port
11. Reset Button
  - \* Press for about 10 seconds to restore the device to factory settings
12. Power Port

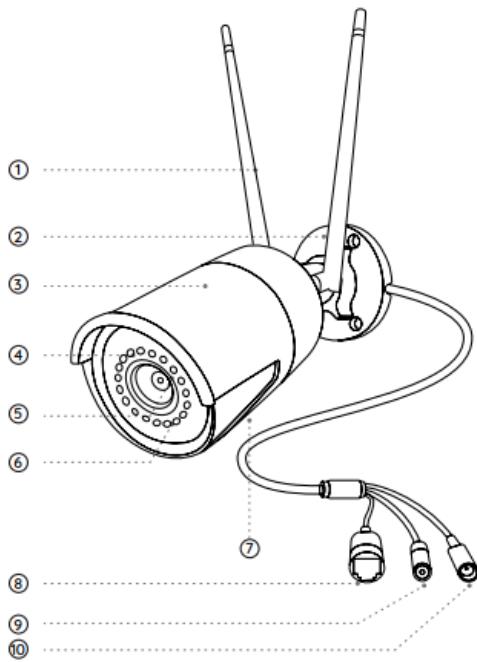

1. Antenna
2. Mount
3. Metal Aluminum Cas
4. Infrared Lights
5. High Definition Lens
6. Daylight Senso
7. Built-in Mic
8. Network Cable
9. Reset Butto

Press for about 10 seconds to restore factory settings.

10. Power Cable

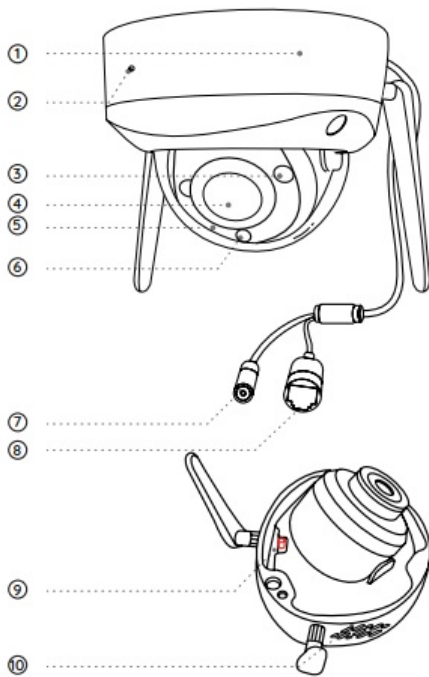

1. Mount
2. Built-in Mic
3. Spotlight
4. Lens
5. IR LEDs
6. Daylight Sensor
7. Power Port
8. Network Cable
9. Reset Button

To reset the camera, loosen the dome cover with the hex key, then press and hold the button for 10s.

10. Speaker

## Network Topology Diagram

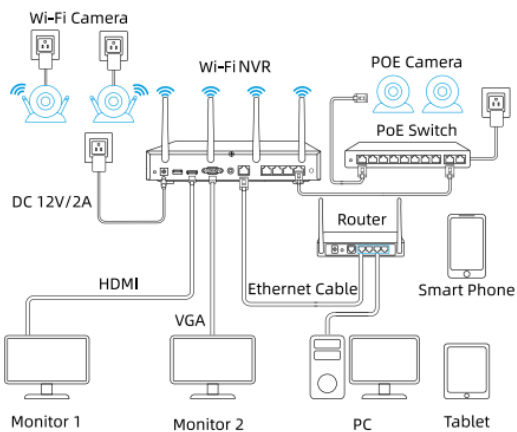

## NOTE:

1. The NVR is compatible with both Wi-Fi and PoE cameras and allows the connection of up to 12

2. When connecting a PoE camera to the NVR, a power adapter is re-quired to power the camera on.
3. To connect multiple PoE cameras, consider using a PoE switch for effi-
4. It's recommended to directly sync Wi-Fi info from the NVR to the cam- era for optimal

## Connection Diagram

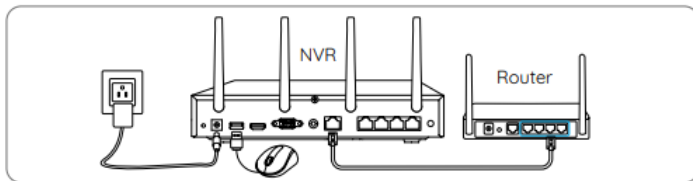

1. Power on the NVR with the provided 12V power
2. Connect the NVR to your router with an Ethernet cable if you want to remotely access your NVR via your smartphone or

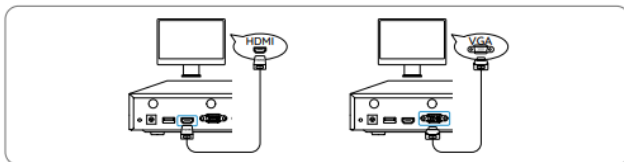

3. Connect the mouse to the USB port of the
4. Connect the NVR to the monitor with a VGA or HDMI 5. Follow the steps on the monitor to complete the initial setup.

NOTE: There is no VGA cable and monitor included in the package.

6. Power on your WiFi cameras and connect them to the LAN ports (for IPC) on the NVR via Ethernet



7. Click Sync Wi-Fi Info to connect the cameras to the NVR's Wi-Fi. After the synchronization succeeded, remove the Ethernet cables and wait for a few seconds for them to be reconnected wirelessly. 9. Once the Wi-Fi configuration succeeds, the cameras can be installed at the desired location.

## Access the NVR via Smartphone or PC

1. UID is disabled by To enable remote access via your smartphone or computer, navigate to Settings > System > Info on the monitor.
2. Connect the NVR to a router using the included Ethernet 3. Download and launch the Reolink App or Client and follow the instructions to access the NVR.

- On Smartphone Scan to download the Reolink App On PC
- Download path: Go to <https://reolink.com> > Support > App & Client.



## Mount Tips for the Camera

### Installation Tips

- Do not face the camera towards any light
- Do not point the camera towards a glass Or, it may result in poor image quality because of the window glare by infrared LEDs, ambient lights or status lights.
- Do not place the camera in a shaded area and point it towards a well-lit area. Or, it may result in poor image quality. To ensure best image quality, the lighting condition for both the camera and the capture object shall be the same.
- To ensure better image quality, it's recommended to clean the lens with a soft cloth from time to
- Make sure the power ports are not directly exposed to water or moisture and not blocked by dirt or other
- With IP waterproof ratings, the camera can work properly under conditions like rain and However, it doesn't mean the camera can work underwater.
- Do not install the camera at places where rain and snow can hit the lens
- Do not remove the protective film from the dome cover until the installation is complete.
- The camera may work in extreme cold conditions as low as -10°C. Because when it is powered on, the camera will produce You may power on the camera indoors for a few minutes before installing it outdoors.

### Troubleshooting

#### Camera Not Displaying Images on the Monitor Cause 1 Camera is not Powering on

##### Solutions:

- Cover the camera's IR LEDs to see if they light

#### Cause 2 Incorrect Account Name or PasswordSolution:

Login to the NVR, go to Settings > Channel page and click Modify to input the correct password for the camera. If you forget your password, please reset your camera to reset the password to default (blank).

#### Cause 3 Camera is not Assigned to a Channel

##### Solution:

Go to Settings > Channel page, click the channel you want, and then select your camera for that channel. If all



channels are already in use, please delete the offline camera from the NVR. Then the channel this camera was taken is free now.

NOTE: Please install the cameras within the NVR's signal range.

## **Cause 4 No Wi-Fi After Removing the Ethernet Cable**

Solutions:

- Connect the camera to the NVR with an Ethernet Go to Network> Wi-Fi > Settings on the monitor to sync the NVR's Wi-Fi.
- Install the camera within the NVR's signal
- Install antennas on the camera and the

If these won't work, please contact Reolink Support <https://support.reolink.com>

## **Specification**

### **NVR**

Operating Temperature: -10°C to 45°C RLN12W Size: 255 x 49.5 x 222.7mm

Weight: 1.4kg, for RLN12W

### **Camera**

Operating Temperature: -10°C~+55°C (14°F~131°F) Operating Humidity: 10%~90%

Weatherproof: IP67

## **Notification of Compliance**

### **FCC Compliance Statements**

This device complies with Part 15 of the FCC Rules. Operation is subject to the following two conditions: (1) this device may not cause harmful interference, and (2) this device must accept any interference received, including interference that may cause undesired operation.

Note: This equipment has been tested and found to comply with the limits for a Class B digital device, pursuant to Part 15 of the FCC Rules. These limits are designed to provide reasonable protection against harmful interference in a residential installation. This equipment generates, uses and can radiate radio frequency energy and, if not installed and used in accordance with the instructions, may cause harmful interference to radio communications. However, there is no guarantee that interference will not occur in a particular installation. If this equipment does cause harmful interference to radio or television reception, which can be determined by turning the equipment off and on, the user is encouraged to try to correct the interference by one or more of the following measures:

- Reorient or relocate the receiving
- Increase the separation between the equipment and
- Connect the equipment into an outlet on a circuit different from that to which the receiver is connected.
- Consult the dealer or an experienced radio/TV technician for

Caution: Changes or modifications not expressly approved by the party responsible for compliance could void the user's authority to operate the equipment.

## FCC Radiation Exposure statement

This equipment complies with FCC radiation exposure limits set forth for an uncontrolled environment. This equipment should be installed and operated with minimum distance 20cm between the radiator and your body.

## ISED Compliance Statements

This device contains licence-exempt transmitter(s)/receiver(s) that comply with Innovation, Science and Economic Development Canada's licence-exempt RSS(s). Operation is subject to the following two conditions:

- This device may not cause
- This device must accept any interference, including interference that may cause undesired operation of the L' émetteur/récepteur exempt de licence contenu dans le présent appareil est conforme aux CNR d'Innovation, Sciences et Développement économique Canada applicables aux appareils radio exempts de licence. L' exploitation est autorisée aux deux conditions suivantes :
- L' appareil ne doit pas produire de brouillage;
- L' appareil doit accepter tout brouillage radioélectrique subi, même si le brouillage est susceptible d'en compromettre le15 English

## ISED Radiation Exposure statement

This equipment complies with IC RSS-102 radiation exposure limits set forth for an uncontrolled environment. This equipment should be installed and operated with minimum distance 20 cm between the radiator and your body.

Cet équipement est conforme aux limites d'exposition aux radiations IC CNR-102 établies pour un environnement non contrôlé. Cet équipement doit être installé et utilisé avec une distance minimale de 20 cm entre le radiateur et votre corps. Cet émetteur ne doit pas être colocalisé ou fonctionner en conjonction avec une autre antenne ou un autre émetteur. Operation of 5150-5250 MHz is restricted to indoor use only.

Le fonctionnement de 5150-5250 MHz est limité à une utilisation en intérieur uniquement.

## Simplified EU Declaration of Conformity

Reolink declares that this device is in compliance with the essential requirements and other relevant provisions of Directive 2014/53/EU and Directive 2014/30/EU.

## Wi-Fi Operating Frequency

OPERATING FREQUENCY :

2.4 GHz EIRP < 20dBm      5 GHz EIRP < 20dBm      5.8GHz EIRP < 14dBm

The functions of Wireless Access Systems including Radio Local Area Networks(WAS/RLANs) within the band 5150-5350 MHz for this device are restricted to indoor use only within all European Union countries (BE/BG/CZ/DK/DE/EE/IE/EL/ES/FR/HR/ IT/CY/LV/LT/ LU/HU/MT/NL/AT/PL/PT/RO/SI/SK/FI/SE/TR/N O/CH/IS/LI/UK(NI)

## UKCA Declaration of Conformity

Reolink declares that this product is in compliance with Electromagnetic Compatibility Regulations 2016 and Electrical Equipment Safety Regulations 2016.

Correct Disposal of This Product

This marking indicates that this product should not be disposed with other household wastes.throughout the EU. To prevent possible harm to the environment or human health from uncontrolled waste disposal, recycle it responsibly to promote the sustainable reuse of material resources. To return your used device, please use the return and collection systems or contact the retailer where the product was purchased. They can take this product for environmentally safe recycling.

Limited Warranty

This product comes with a 2-year limited warranty that is valid only if purchased from Reolink Official Store or a Reolink authorized reseller. Learn more: <https://reolink.com/warranty-and-return/>.

Terms and Privacy

Use of the product is subject to your agreement to the Terms of Service and Privacy Policy at [reolink.com](https://reolink.com). Keep out of reach of children.

Read More About This Manual & Download PDF:

Documents / Resources

	<a href="#">Reolink 500WB4 5MP Wireless Security Camera System</a> [pdf] User Guide 500WB4 5MP Wireless Security Camera System, 500WB4, 5MP Wireless Security Camera System, Security Camera System, Camera System
-------------------------------------------------------------------------------------	-----------------------------------------------------------------------------------------------------------------------------------------------------------------------------------------------------------------------

References

- [🔗 Reolink Official: Security Cameras and Systems for Home & Business](#)
- [🔗 Reolink Official: Security Cameras and Systems for Home & Business](#)
- [🔗 Warranty & Return – Reolink](#)
- [🔗 Reolink Support - Official Reolink Help Center](#)
- [User Manual](#)

[Manuals+](#), [Privacy Policy](#)

This website is an independent publication and is neither affiliated with nor endorsed by any of the trademark owners. The "Bluetooth®" word mark and logos are registered trademarks owned by Bluetooth SIG, Inc. The "Wi-Fi®" word mark and logos are registered trademarks owned by the Wi-Fi Alliance. Any use of these marks on this website does not imply any affiliation with or endorsement.