



reolink 2302B Argus Eco Wi-Fi Camera Instruction Manual

[Home](#) » [reolink](#) » reolink 2302B Argus Eco Wi-Fi Camera Instruction Manual 

Contents

- [1 reolink 2302B Argus Eco Wi-Fi Camera](#)
- [2 Specifications](#)
- [3 What's in the Box](#)
- [4 Camera Introduction](#)
- [5 Set up the Camera](#)
- [6 Install the Camera](#)
- [7 Notes on PIR Motion Sensor](#)
- [8 Troubleshooting](#)
- [9 FAQs](#)
- [10 Documents / Resources](#)
 - [10.1 References](#)
- [11 Related Posts](#)



reolink 2302B Argus Eco Wi-Fi Camera



Specifications

PIR Detection & Alerts

- **PIR Detection Distance:** Adjustable/up to 10m (33 ft)
- **PIR Detection Angle:** 100° horizontal
- **Audio Alert:** Customized voice-recordable alerts
- **Other Alerts:** Instant email alerts and push notifications

General

- **Operating Temperature:** -10°C to 55°C (14°F to 131°F)
- **Size:** 71 x 191 mm
- **Weight (Battery included):** 339g

What's in the Box



Argus Eco
(with Battery)



Security Mount



Antenna



Reset Needle



Surveillance Sign



Quick
Start Guide

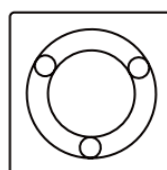

Mounting
Hole Template

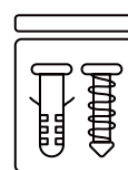

Pack of Screws

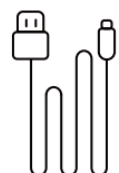

USB-C Cable

Camera Introduction

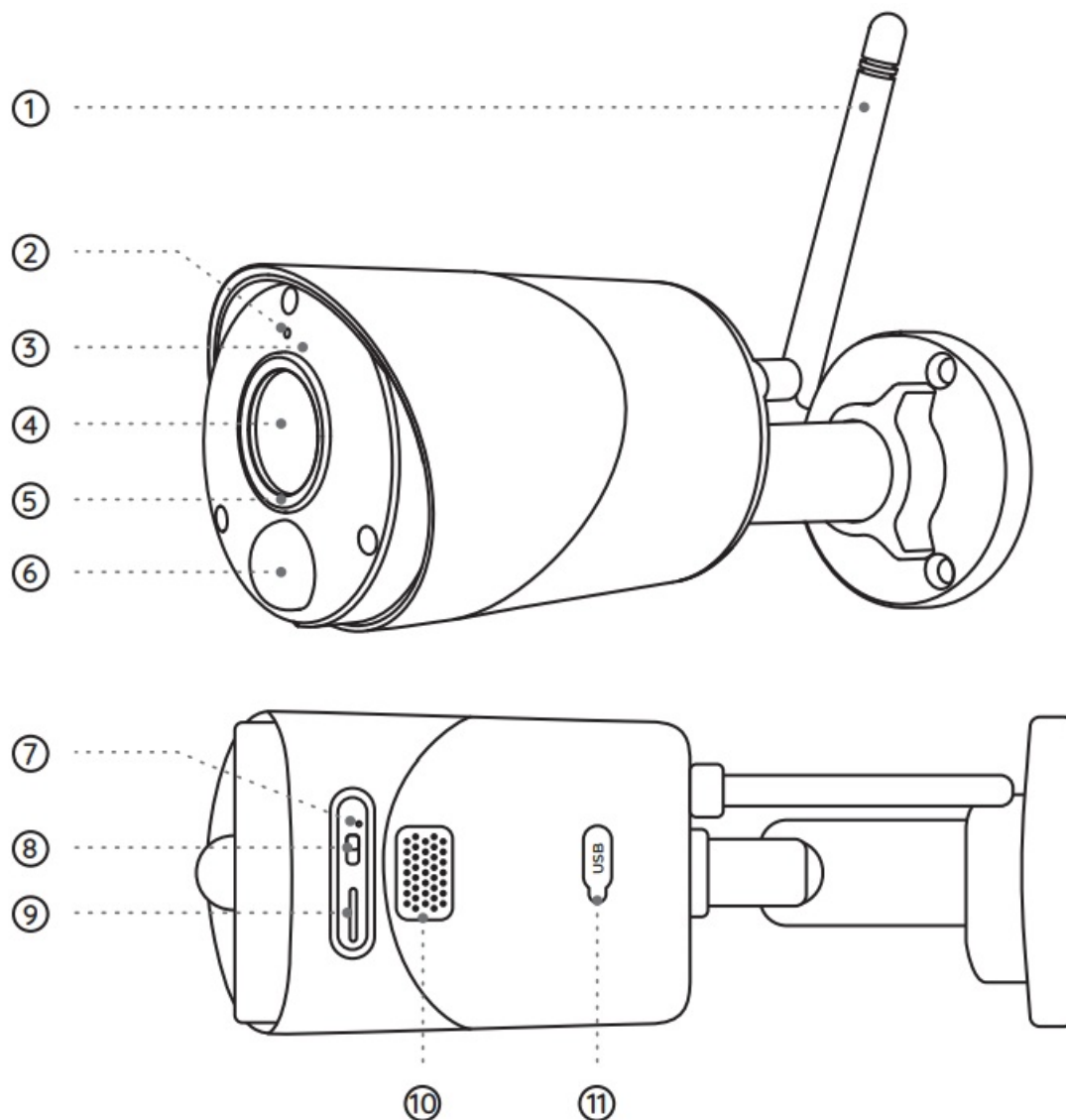

1. Antenna
2. Built-in Mic
3. Status LED
4. Lens
5. Daylight Sensor
6. Built-in PIR Sensor
7. Reset Hole

Press the reset button with a pin to store the camera in the factory settings

8. Power Switch
9. Micro SD Card Slot

*Always keep the rubber plug closed firmly.

10. Speaker
11. Power Port

Different states of the status LED:

- **Red Light:** WiFi connection failed
- **Blue Light:** WiFi connection succeeded
- **On:** Working status

- **Blinking:** Standby status

Set up the Camera

Download and Launch the Reolink App or Client software, and follow the onscreen instructions to finish the initial setup.

On Smartphone

Scan to download the Reolink App.



On PC

Download the path of the Reolink Client: Go to <https://reolink.com>Support>App&Client>.

Charge the Battery

It's recommended to fully charge the battery before mounting the camera.

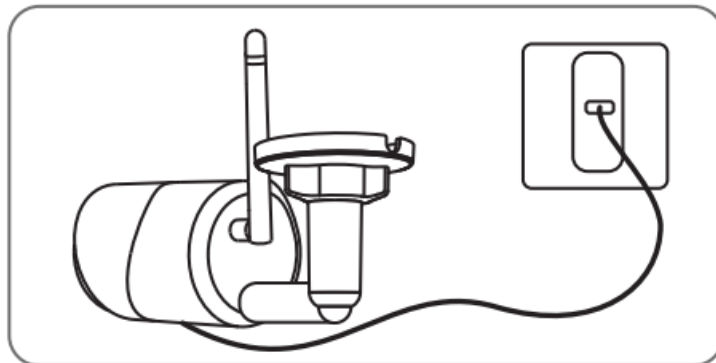

Charge the battery with a power adapter. (not included).

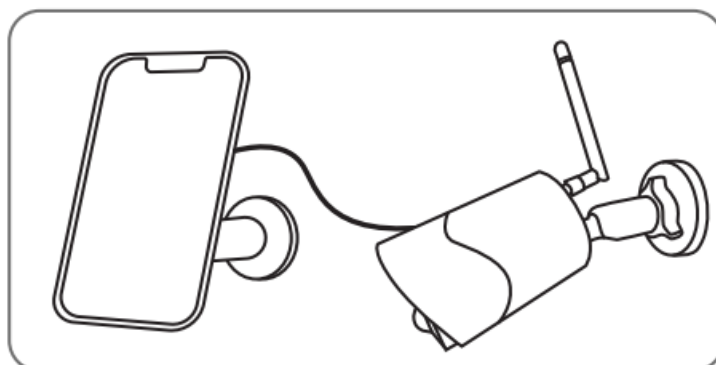

Charge the battery with Reolink Solar Panel (Not included if you only purchase the camera).

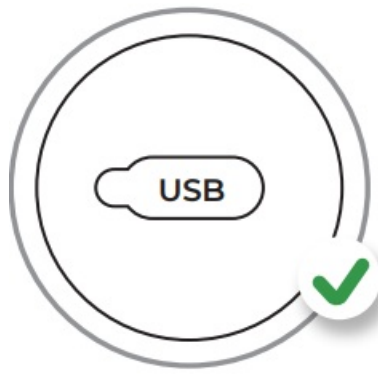

For better weatherproof performance, please always cover the charging port with the rubber plug after charging the battery.

Charging indicator:

- **Orange LED:** Charging
- **Green LED:** Fully charged

Install the Camera

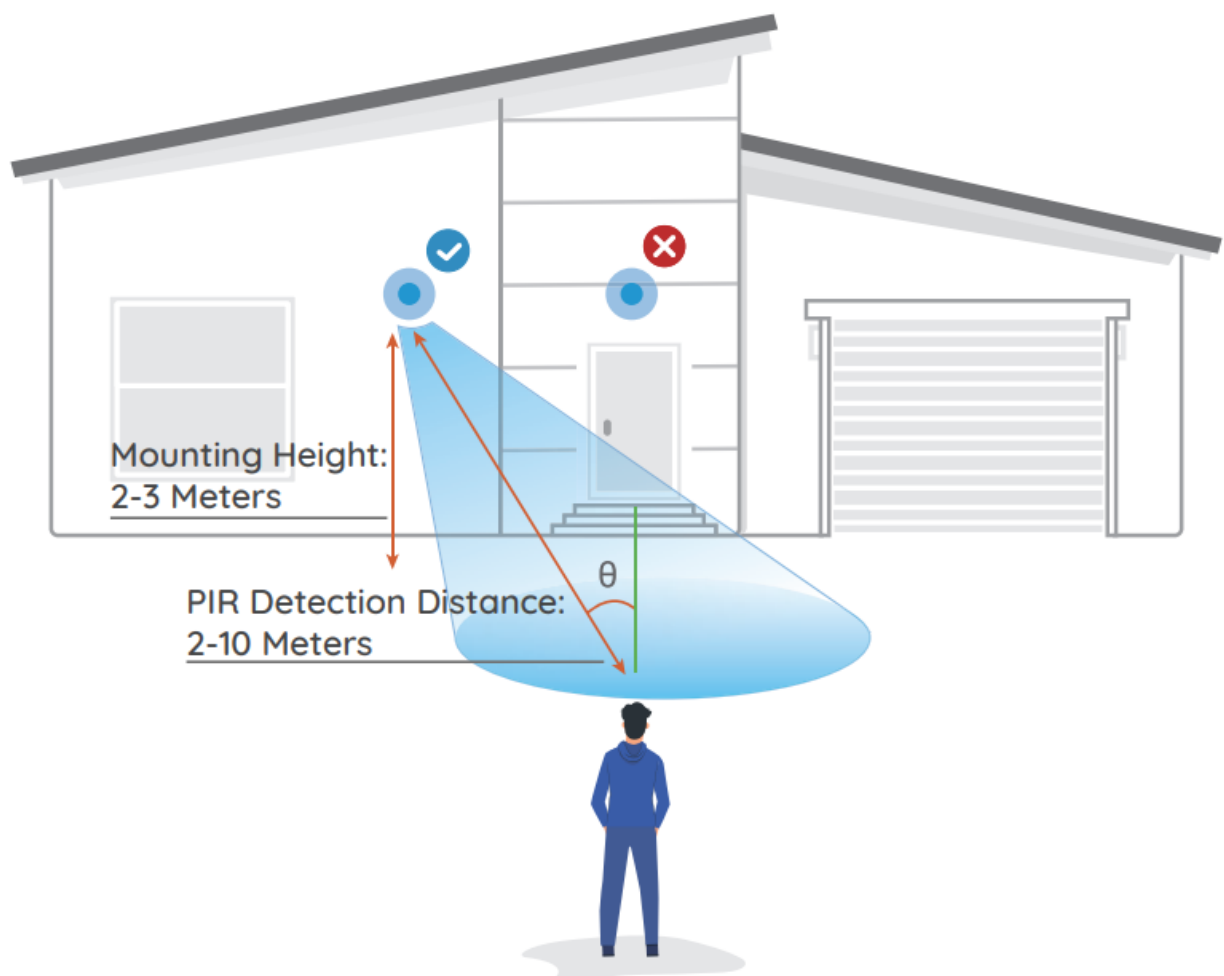

- Install the camera 2-3 meters (7-10 ft) above the ground. This height maximizes the detection range of the PIR motion sensor.
- For better motion detection performance, please install the camera angularly.

NOTE: If a moving object approaches the PIR sensor vertically, the camera may fail to detect motion.

Mount the Camera to the Wall

1. Drill holes with a mounting hole template and screw the security mount into the wall. If you are mounting the camera on any hard surface, insert plastic anchors into the holes first.

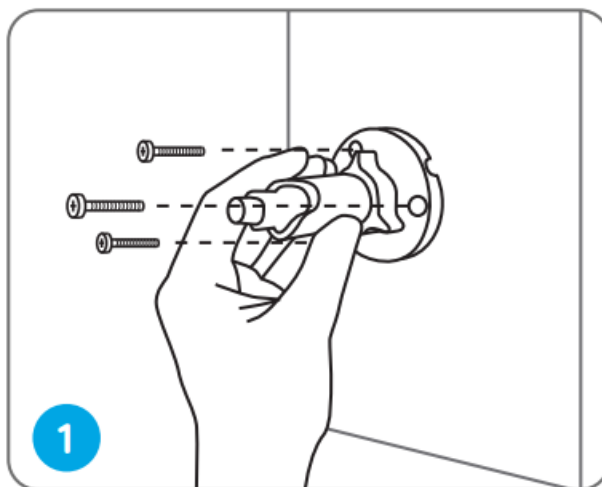

2. Install the camera on the security mount.

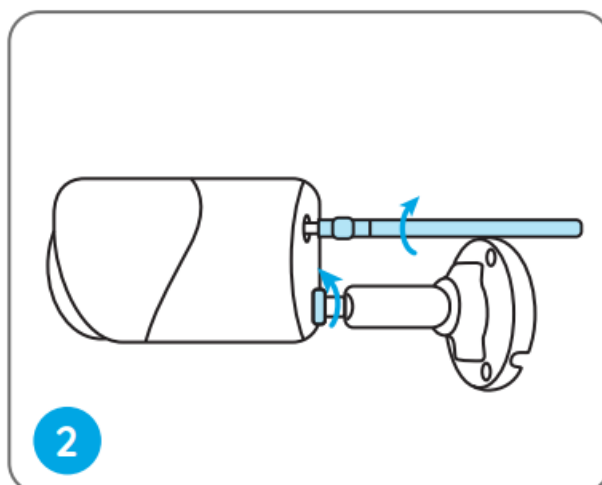

3. To get the best field of view, loosen the adjustment knob on the security mount and turn the camera.

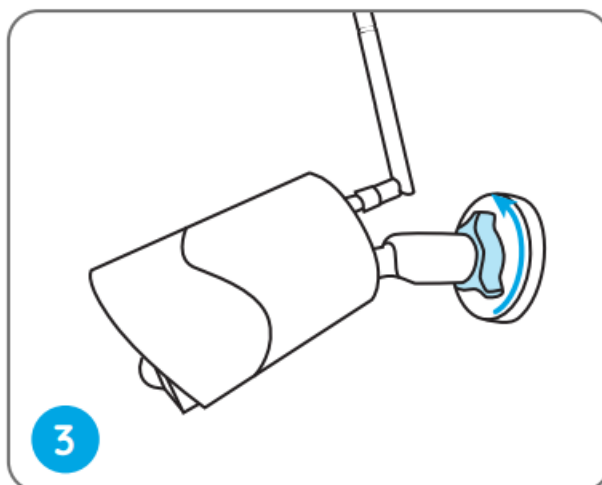

4. Stiffen the adjustment knob to lock the camera.

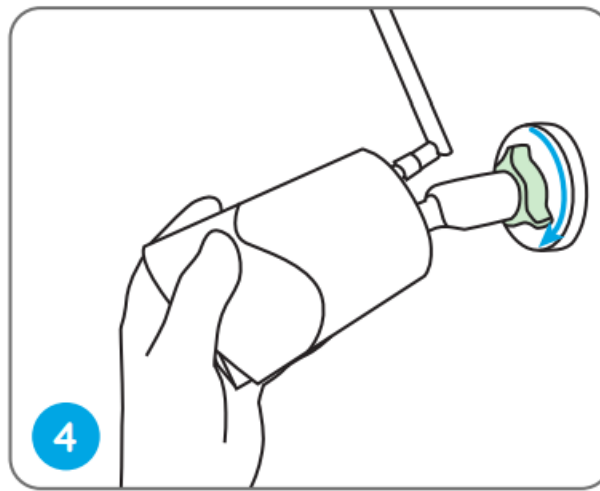

Attach the Camera to a Tree

1. Thread the provided strap to the mounting plate.

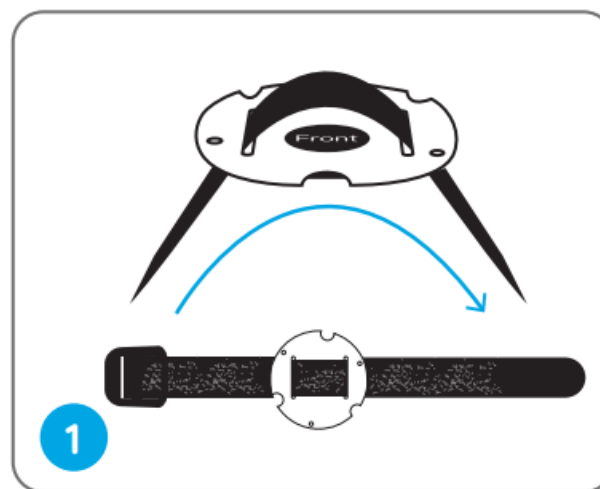

2. Attach the plate to the security mount with the smaller screws.

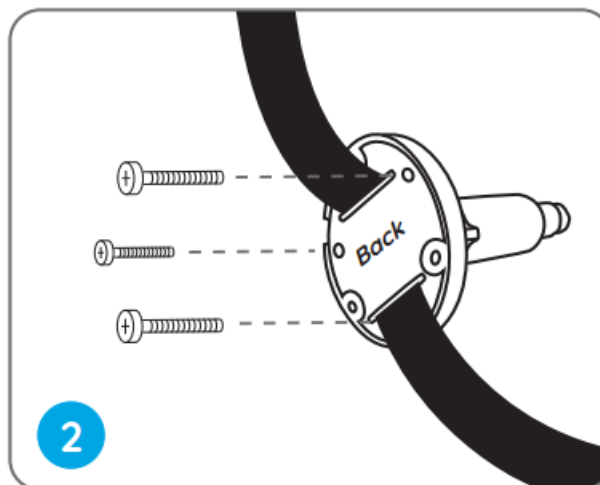

3. Fasten the security mount to a tree.

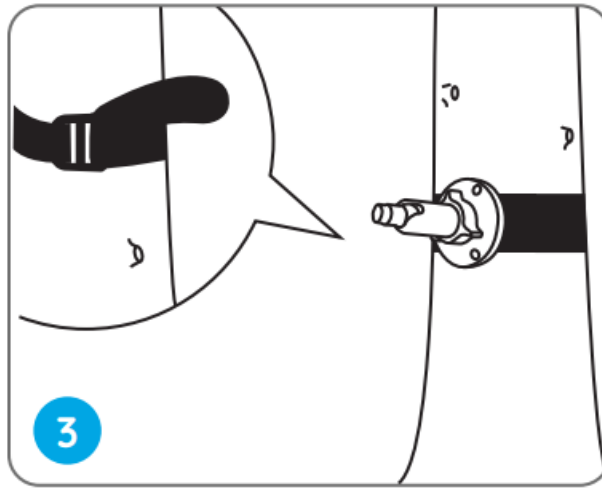

4. Install the camera and adjust the camera angles as instructed in steps 2 & 4 in the previous installation guide.

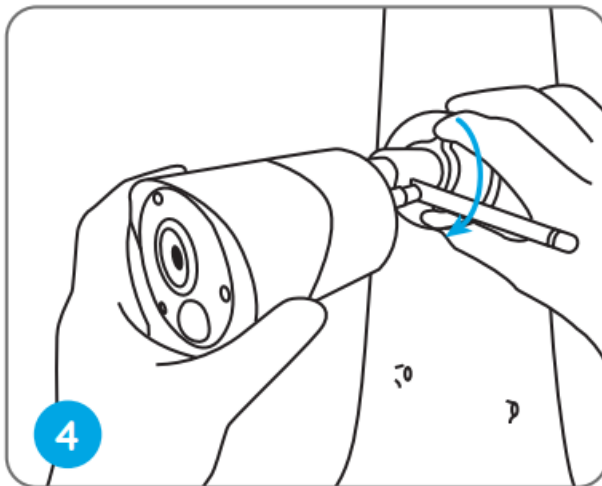

Notes on PIR Motion Sensor

PIR Sensor Detection Distance

The PIR detection range can be customized to meet your specific needs. You can refer to the following table to set it up in Device Settings via Reolink App.

Sensitivity	Value	Detection Distance (For moving and living objects)
Low	0 - 50	Up to 5 meters (16ft)
Mid	51 - 80	Up to 8 meters (26ft)
High	81 - 100	Up to 10 meters (33ft)

NOTE: Higher sensitivity offers a longer detection distance but it may lead to more false alarms. It's recommended to set up the sensitivity level to "Low" or "Mid" when you install the camera outdoors.

Important Notes on Reducing False Alarms

- Do not face the camera towards any objects with bright lights, including sunshine, bright lamp lights, etc.
- Do not place the camera too close to a place with heavy traffic. Based on our numerous tests, the recommended distance between the camera and the vehicle would be 16 meters (52ft).
- Do not place the camera near outlets, including the air conditioner vents, humidifier outlets, the heat transfer vents of projectors, etc.

- Do not install the camera in places with strong wind.
- Do not face the camera towards a mirror.
- Keep the camera at least 1 meter away from any wireless devices, including WiFi routers and phones to avoid wireless interference.

Important Notes on Rechargeable Battery Usage

Reolink Argus Eco is not designed for 24/7 full-capacity running or around-the-clock live streaming. It's designed to record motion events and remotely view live streaming only when you need it. Learn useful tips on how to extend the battery life in this post: <https://support.reolink.com/hc/en-us/articles/360006991893>.

1. Charge the rechargeable battery with a standard and high-quality DC 5V/9V battery charger or Reolink solar panel. Do not charge the battery with solar panels from any other brands.
2. Charge the battery when temperatures are between 0°C and 45°C and always use the battery when temperatures are between -20°C and 60°C.
3. Keep the USB charging port dry, clean, and free of any debris, and cover the USB charging port with the rubber plug when the battery is fully charged.
4. Do not charge, use, or store the battery near any ignition sources, such as fires or heaters.
5. Do not disassemble, cut, puncture, short-circuit the battery, or dispose of the battery in water, fire, microwave oven, and pressure vessels.
6. Do not use the battery if it gives off an odor, generates heat, becomes discolored or deformed, or appears abnormal in any way. If the battery is being used or charged, turn off the power, remove the charger immediately, and stop using it.
7. Always follow the local waste and recycle laws when you get rid of the used battery.

Troubleshooting

The camera is not Powering on

If your camera is not powering on, please apply the following solutions:

- Make sure the power switch is turned on.
- Charge the battery with a DC 5V/ 2A power adapter. When the green light is on, the battery is fully charged.

If these won't work, please contact Reolink Support at <https://support.reolink.com/>.

Failed to Scan the QR Code on the Phone

If the camera cannot scan the QR code on your phone, please try the following solutions:

- Remove the protective film from the camera lens.
- Wipe the camera lens with a dry paper/towel/tissue.
- Vary the distance between your camera and the mobile phone so that the camera can focus better.
- Try to scan the QR code under sufficient lighting.

If these won't work, please contact Reolink Support at <https://support.reolink.com/>.

WiFi Connection Failed During Initial Setup Process

If the camera fails to connect to Wifi, please try the following solutions:

- Please make sure the WiFi band is 2.4GHz, the camera does not support 5GHz.
- Ensure that you have entered the correct WiFi password.
- Put the camera closer to your router to ensure a strong WiFi signal.
- Change the encryption method of the WiFi network to WPA2-PSK/WPA-PSK (safer- encryption) on your router interface.
- Change your WiFi SSID or password and make sure that the SSID is within 31 characters and the password is within 64 characters.
- Set your password using only the characters available on the keyboard.

If these won't work, please contact Reolink Support at <https://support.reolink.com/>.

Notification of Compliance

FCC Compliance Statement

This device complies with Part 15 of the FCC Rules. Operation is subject to the following two conditions:

1. this device may not cause harmful interference, and
2. this device must accept any interference received, including interference that may cause undesired operation.

NOTE: This equipment has been tested and found to comply with the limits for a Class B digital device, under Part 15 of the FCC Rules. These limits are designed to provide reasonable protection against harmful interference in a residential installation. This equipment generates, uses, and can radiate radio frequency energy and, if not installed and used by the instructions, may cause harmful interference to radio communications. However, there is no guarantee that interference will not occur in a particular installation. If this equipment does cause harmful interference to radio or television reception, which can be determined by turning the equipment off and on, the user is encouraged to try to correct the interference by one or more of the following measures.

- Reorient or relocate the receiving antenna.
- Increase the separation between the equipment and the receiver.
- Connect the equipment to an outlet on a circuit different from that to which the receiver is connected.
- Consult the dealer or an experienced radio/ TV technician for help.

Caution: Changes or modifications not expressly approved by the party responsible for compliance could void the user's authority to operate the equipment.

FCC Radiation Exposure Statement

This equipment complies with FCC radiation exposure limits set forth for an uncontrolled environment. This equipment should be installed and operated with a maximum distance of 20cm between the radiator and your body.

Limited Warranty

This product comes with a 2-year limited warranty that is valid only if purchased from the Reolink Official Store or a Reolink authorized reseller. Learn more: <https://reolink.com/warranty-and-return/>.

EU REP) Product Ident GmbH

Hoferstasse 9B, 71636 Ludwigsburg, Germany

Email: prodsg@libelleconsulting.com

UK REP) APEX CE SPECIALISTS LIMITED

Addr.: 89 Princess Street, Manchester, M14HT, UK
Email: info@apex-ce.com

FAQs

Q: How can I customize the PIR sensor detection distance?

A: You can customize the PIR sensor detection distance by adjusting the sensitivity levels (Low, Mid, High) in the Device Settings through the Reolink App.

Documents / Resources

	reolink 2302B Argus Eco Wi-Fi Camera [pdf] Instruction Manual 2302B, 2302B Argus Eco Wi-Fi Camera, Argus Eco Wi-Fi Camera, Wi-Fi Camera, Camera
---	--

References

- [ce.com](#)
- [Reolink Official: Security Cameras and Systems for Home & Business](#)
- [reolink.com/warranty-and-return/](#)
- [Reolink Support - Official Reolink Help Center](#)
- [Reolink Support - Official Reolink Help Center](#)
- [Not Found - Reolink Support](#)
- [How to Extend the Battery Life of Reolink Battery Powered Cameras](#)
- [User Manual](#)

[Manuals+](#), [Privacy Policy](#)

This website is an independent publication and is neither affiliated with nor endorsed by any of the trademark owners. The "Bluetooth®" word mark and logos are registered trademarks owned by Bluetooth SIG, Inc. The "Wi-Fi®" word mark and logos are registered trademarks owned by the Wi-Fi Alliance. Any use of these marks on this website does not imply any affiliation with or endorsement.