



**RCX  
Series  
Room  
Controller**



# REGIN RCX Series Room Controller Instruction Manual

[Home](#) » [REGIN](#) » REGIN RCX Series Room Controller Instruction Manual 

## Contents

- [1 REGIN RCX Series Room Controller](#)
- [2 Product Information](#)
- [3 Product Usage Instructions](#)
- [4 FAQ](#)
- [5 Installation](#)
- [6 Remove cover](#)
- [7 Wiring](#)
- [8 Documents / Resources](#)
  - [8.1 References](#)



**REGIN RCX Series Room Controller**



## Product Information

### Specifications

- **Model:** RCX-...
- **Compliance:** Directive 2014/53/EU, EN IEC 60730-1
- **Control Class:** A
- **Approval:** CE-mark
- **Availability:** App Store, Google Play

### Product Usage Instructions

#### Installation

1. Ensure power supply is disconnected before installation or maintenance.
2. Installation should comply with local safety regulations.
3. Installation or maintenance should be done by qualified personnel only.
4. Remove cover before proceeding with wiring.

#### Wiring

- Use a cable of length 1.6m for wiring.
- Follow the wiring instructions provided in the manual for proper connection.

### App & Application Tool

- Download Regin:GO 2 from the App Store or Google Play for application usage.

- Refer to the Application Tool section in the manual for additional information.

## FAQ

### **Q: Where can I find more information about the product?**

**A:** More information about the product can be found in the manual available for download at [www.regincontrols.com](http://www.regincontrols.com).

### **Q: Can the product be used in all countries within the European Union?**

**A:** Yes, the product is approved for use in all countries within the European Union and carries the CE-mark.

**Note!** More information about the product can be found in the manual, which is available for download from [www.regincontrols.com](http://www.regincontrols.com)

## Caution!

- Read and understand the instruction before using the product.
- Ensure that the installation complies with local safety regulations.
- Before installation or maintenance, the power supply should first be disconnected. Installation or maintenance of this unit should only be carried out by qualified personnel. The manufacturer is not responsible for any eventual damage or injury caused by inadequate skills during installation, or through removal of or deactivation of any safety devices.

## Installation

### STEP 1

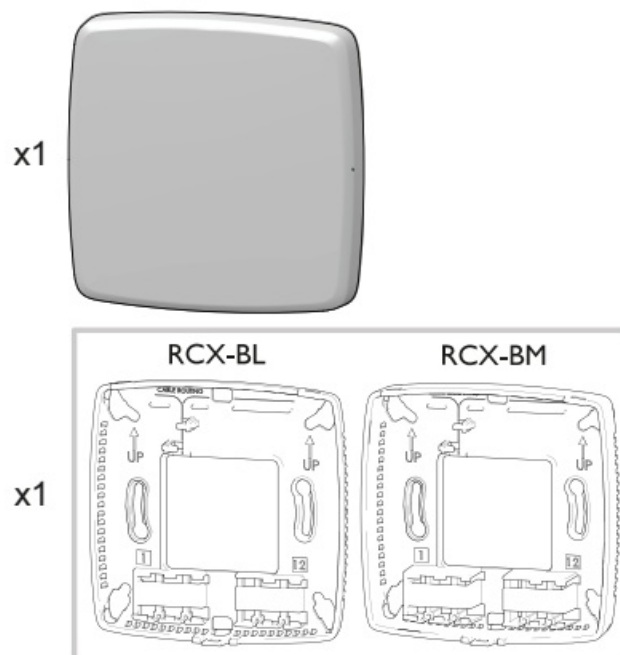

### STEP 2

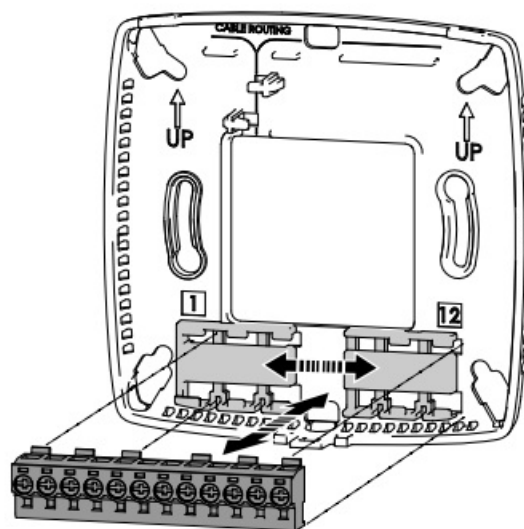

### STEP 3

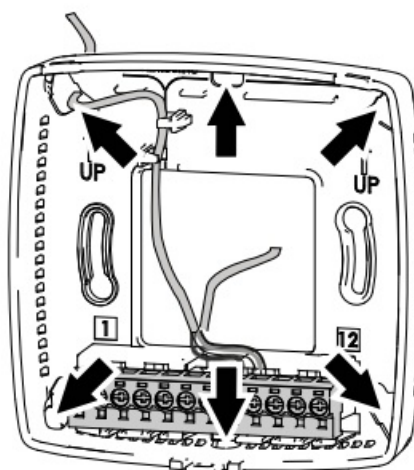
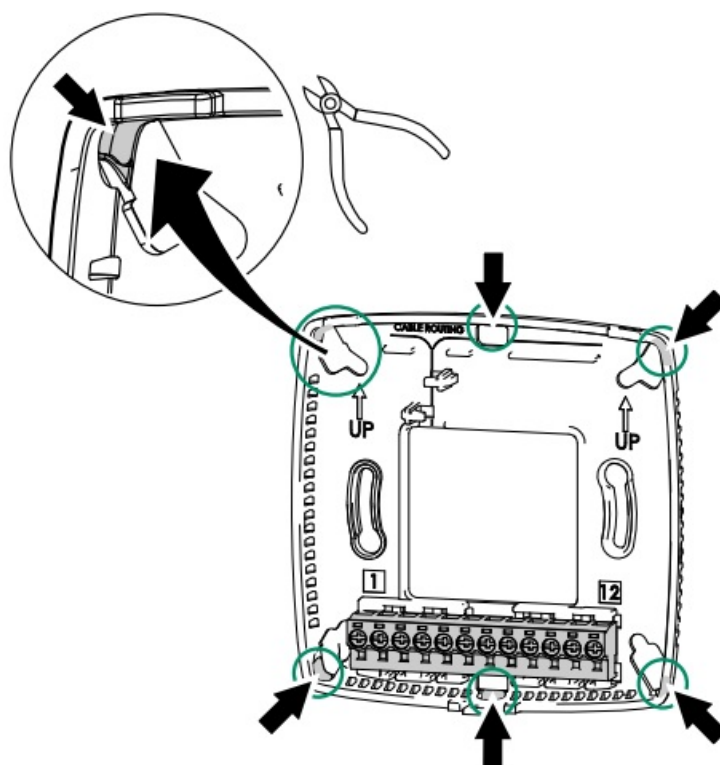

### STEP 4

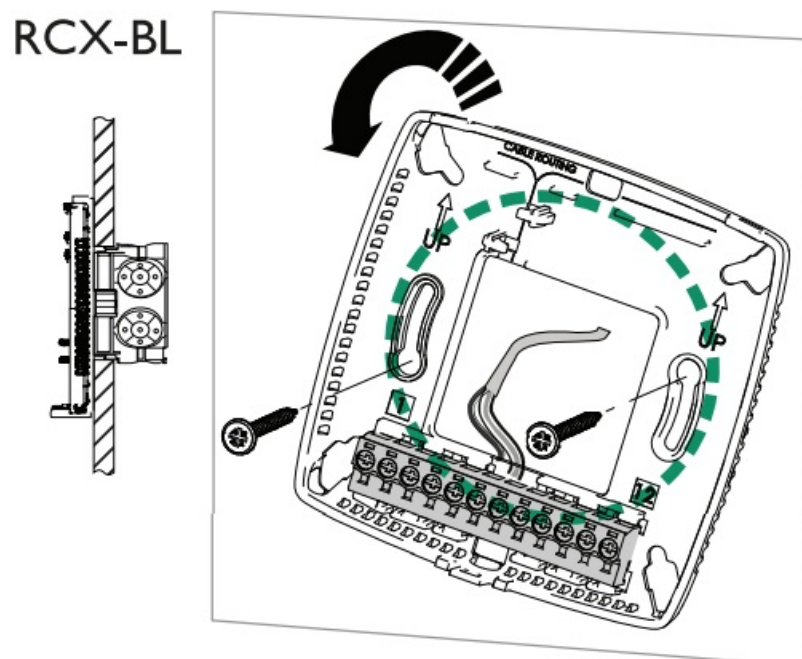
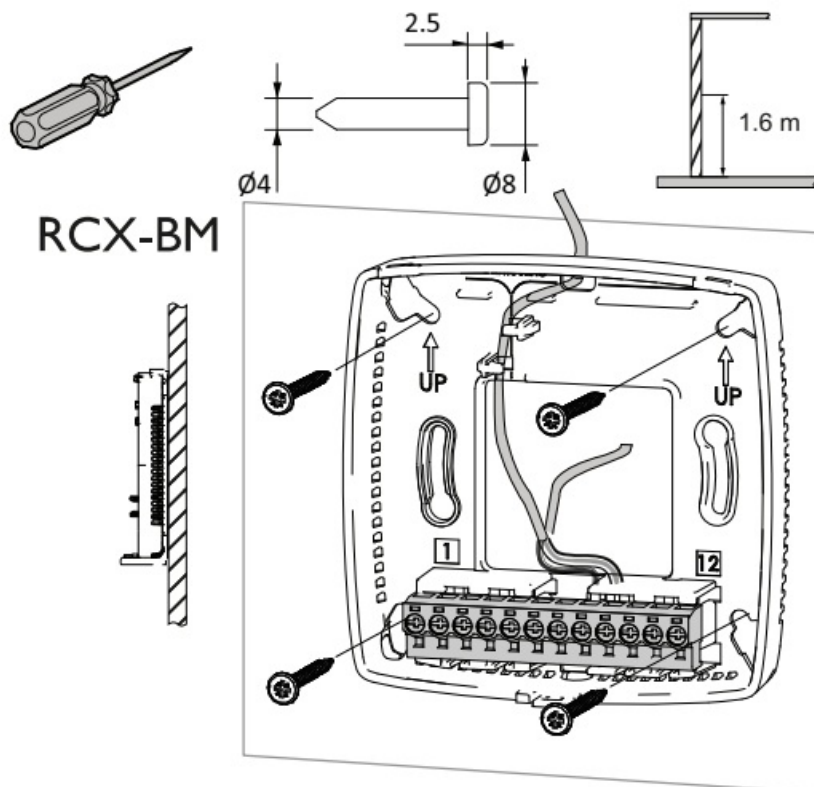

STEP 5

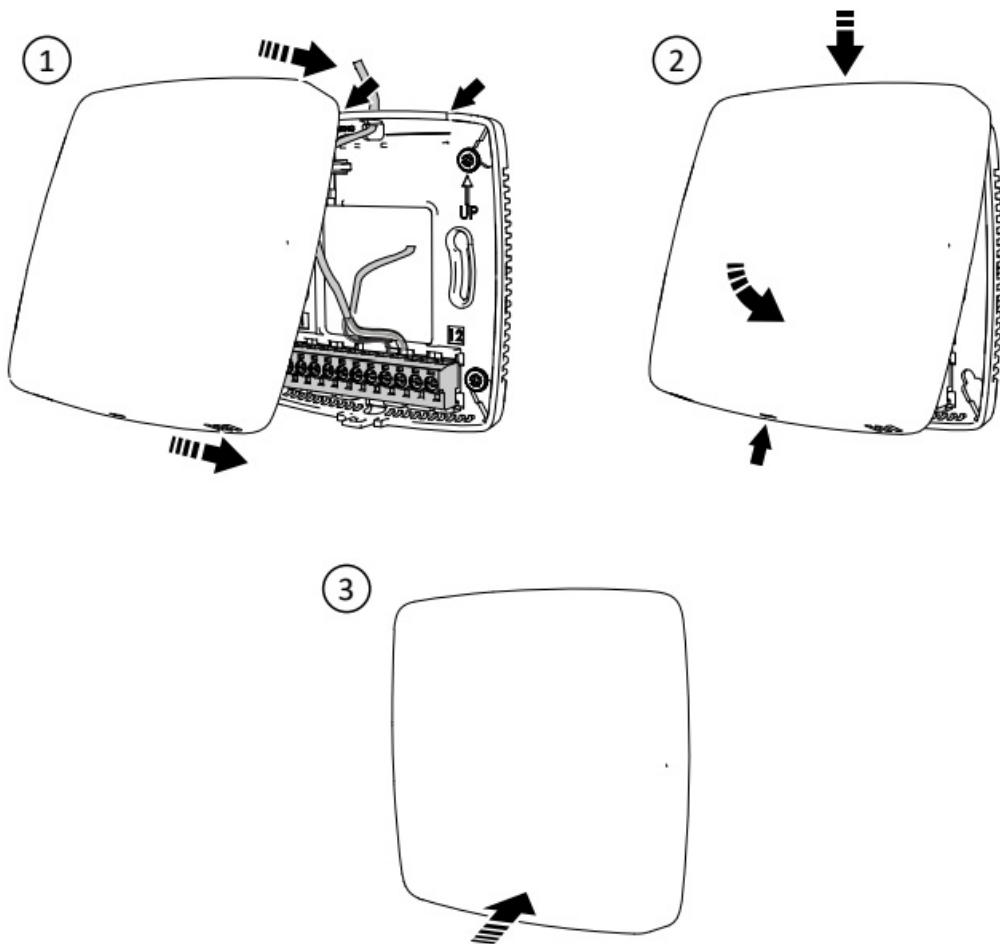

**Remove cover**

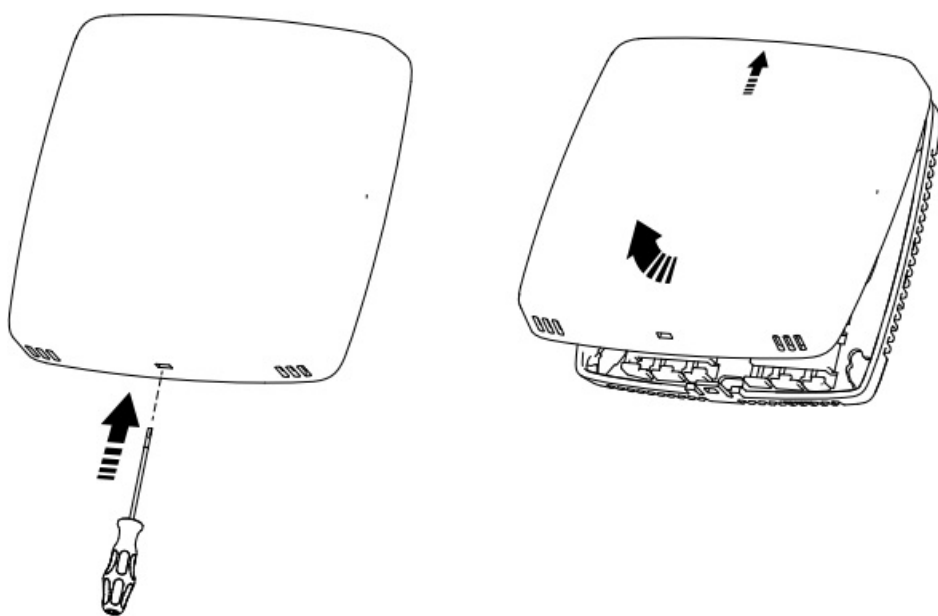

**Wiring**

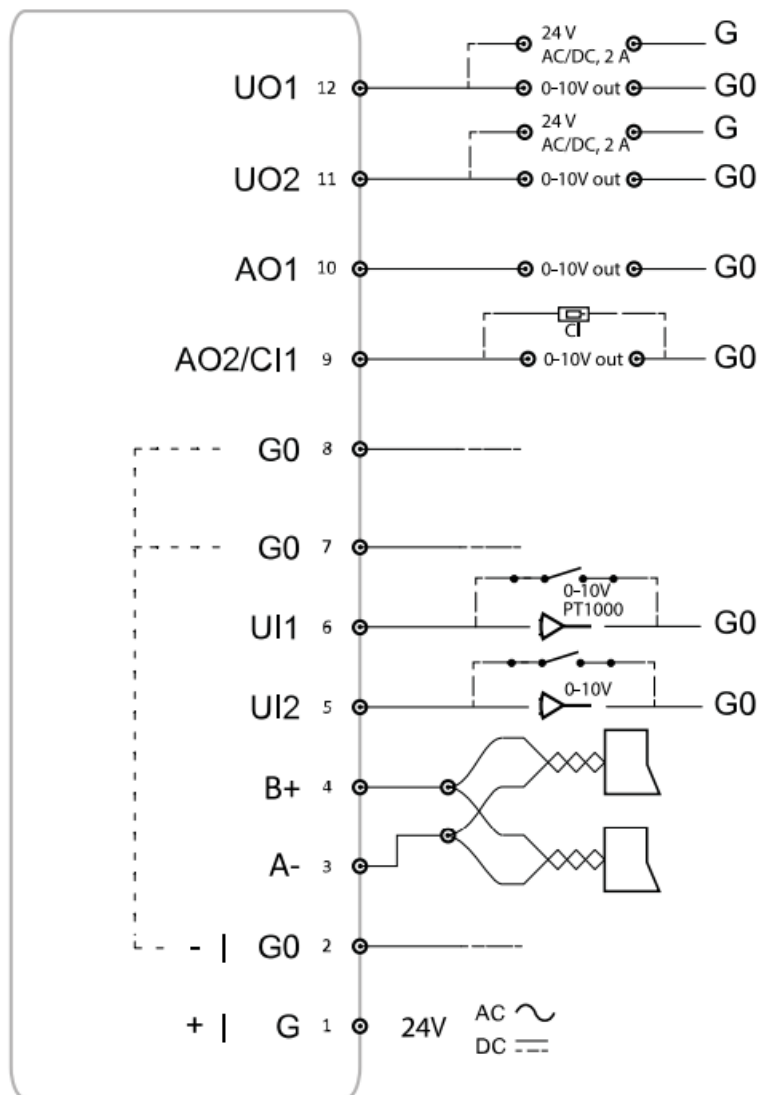

## App & Application tool



Hereby, Regin declares that the radio equipment type ,Regio RCX series is in compliance with Directive 2014/53/EU.

Regio RCX series complies with EN IEC 60730-1 as a class A control.  
This radio equipment device is approved for use in all countries within the European union.

This product carries the CE-mark. More information is available at [www.regincontrols.com](http://www.regincontrols.com).

## Documents / Resources

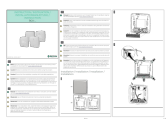

[REGIN RCX Series Room Controller](#) [pdf] Instruction Manual  
RCX Series Room Controller, RCX Series, Room Controller, Controller

## References

- [User Manual](#)

### Manuals+. [Privacy Policy](#)

This website is an independent publication and is neither affiliated with nor endorsed by any of the trademark owners. The "Bluetooth®" word mark and logos are registered trademarks owned by Bluetooth SIG, Inc. The "Wi-Fi®" word mark and logos are registered trademarks owned by the Wi-Fi Alliance. Any use of these marks on this website does not imply any affiliation with or endorsement.