



## redsbaby ONIX Pram Organiser Instruction Manual

[Home](#) » [Redsbaby](#) » redsbaby ONIX Pram Organiser Instruction Manual 

# redsbaby®

### Pram Organiser

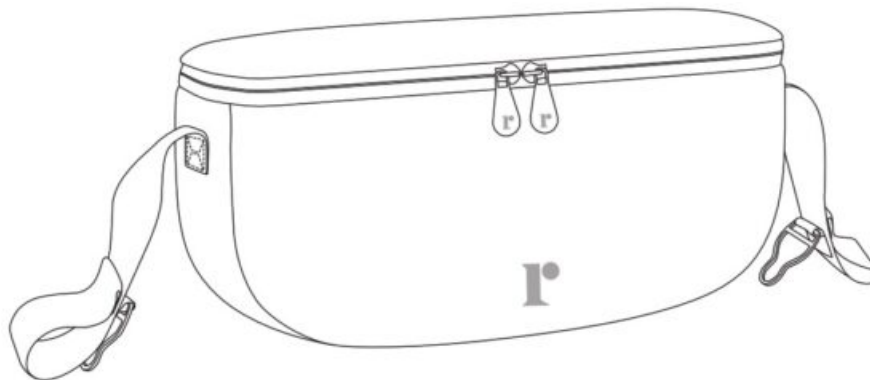

COMPATIBLE WITH: REDSBABY AERON, JIVE, METRO, NUVO AND ONIX

#### Contents

- [1 How to use](#)
- [2 Documents / Resources](#)
- [2.1 References](#)

#### How to use

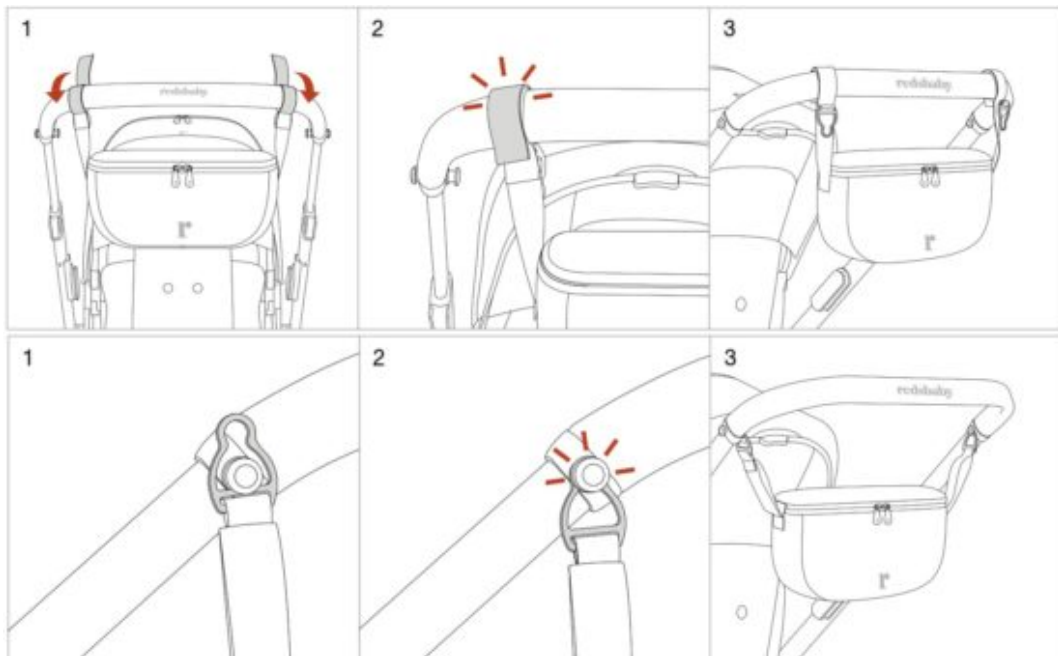

**IMPORTANT** – Read these instructions carefully before use and keep for future reference. Follow the warnings and instructions of the compatible pram this product is designed to be used with before use.

**WARNING** – Maximum load capacity is 1kg (2.2lbs). Exceeding this weight limit may cause the stroller to tip over. Do not place hot drinks or food in this item as it may injure you or your child.

‘REDSBABY’ is a registered trademark of Redsbaby Pty Ltd. ACN 625 563 519. ©Redsbaby Pty Ltd 2024.  
 Redsbaby Australia 729 Elizabeth Street Zetland 2017 NSW Australia  
 The information in this manual is subject to change without notice. There may be variations between the product you receive and the product depictions in this product guide. Redsbaby will not be liable for technical errors or omissions contained within this guide.

[REDSBABY.COM](https://www.redsbaby.com)  
 @REDSBABY  
 PO-AG-V2408

## Documents / Resources

	<p><a href="#">redsbaby ONIX Pram Organiser</a> [pdf] Instruction Manual            AERON, JIVE, METRO, NUVO, ONIX, ONIX Pram Organiser, ONIX, Pram Organiser, Organise            r</p>
--	--

## References

- [User Manual](#)

### [Manuals+](#), [Privacy Policy](#)

This website is an independent publication and is neither affiliated with nor endorsed by any of the trademark owners. The "Bluetooth®" word mark and logos are registered trademarks owned by Bluetooth SIG, Inc. The "Wi-Fi®" word mark and logos are registered trademarks owned by the Wi-Fi Alliance. Any use of these marks on this website does not imply any affiliation with or endorsement.