



REDLINE FORD F150 All Models with BLIS/Backup Camera/Assist Sensor User Guide

[Home](#) » [REDLINE](#) » REDLINE FORD F150 All Models with BLIS/Backup Camera/Assist Sensor User Guide 

*REDLINE FORD F150 All Models with BLIS/Backup
Camera/Assist Sensor User Guide*

REDLINE

QUICK CONNECT

EXPANSION ADAPTER

FOR FORD F150 **2015-2020** ALL MODELS WITH BLIS/BACKUP CAMERA/ASSIST SENSOR

Hello Fellow OPT7-ites, Introducing the Redline Quick Connect Harness to Flat
4-Pin Extension Adapter Harness

The OPT7 Redline Quick Connect Expansion Adapter Harness is purpose-built to be used as a trailer accessory for 15-20 F150 all models. It provides a plug-and-play style that allows you to quickly, seamlessly and virtually hidden installation without cutting or splicing your factory harnesses.

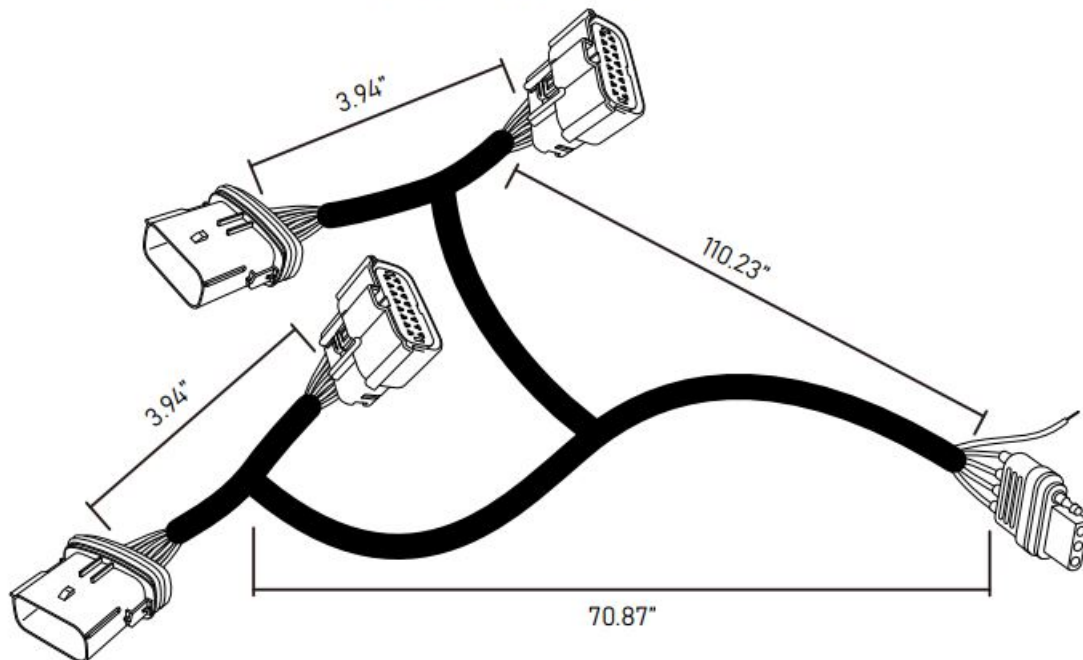

Contents

- [1 Installation](#)
- [2 HOW TO CONNECT](#)
- [3 DISCLAIMER](#)
- [4 Documents / Resources](#)
- [5 Related Posts](#)

Installation

Open up your tailgate first.

Next, locate the two bolts that lock the tail light (See Figure 1) and loosen them.

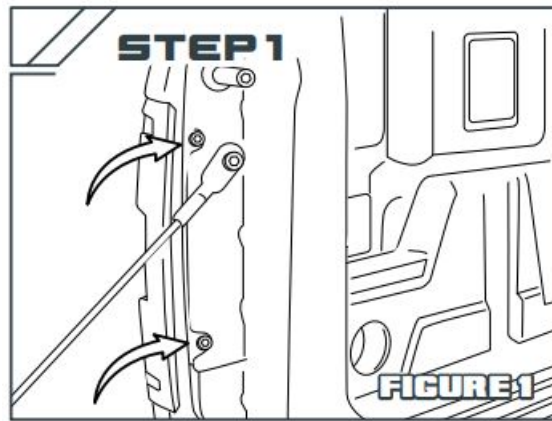

Slowly move the loose tail light until it is completely removed(See Figure 2).

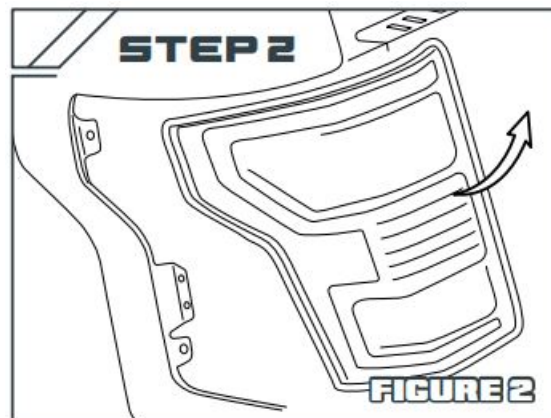

Important

There are two plastic clips on the inside of the tail light for fixing, please be careful not to break it when removing it.

Locate the OEM wiring harness (See Figure 3) and unplug it from the tail light assembly by lightly pressing the Release-Latch on the connector.

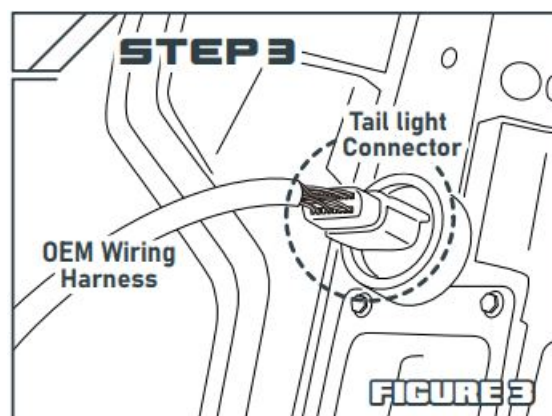

HOW TO CONNECT

PnP EXPANSION ADAPTER TO YOUR TAILLIGHTS

Step 4

To make it easier for you to identify the signal location represented by the Connector/Wiring. Please read the relevant wiring instructions carefully before commencing any work.(See Figure 4)

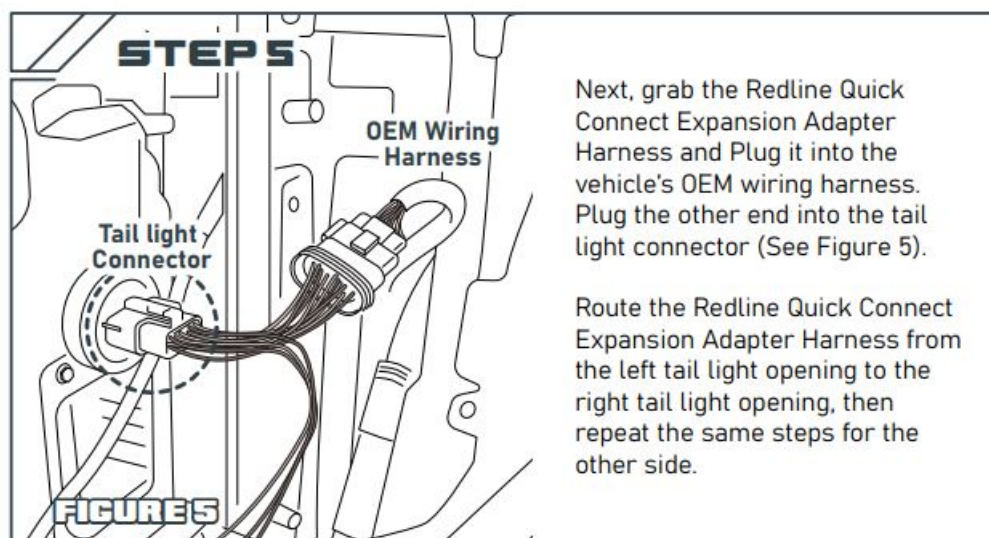
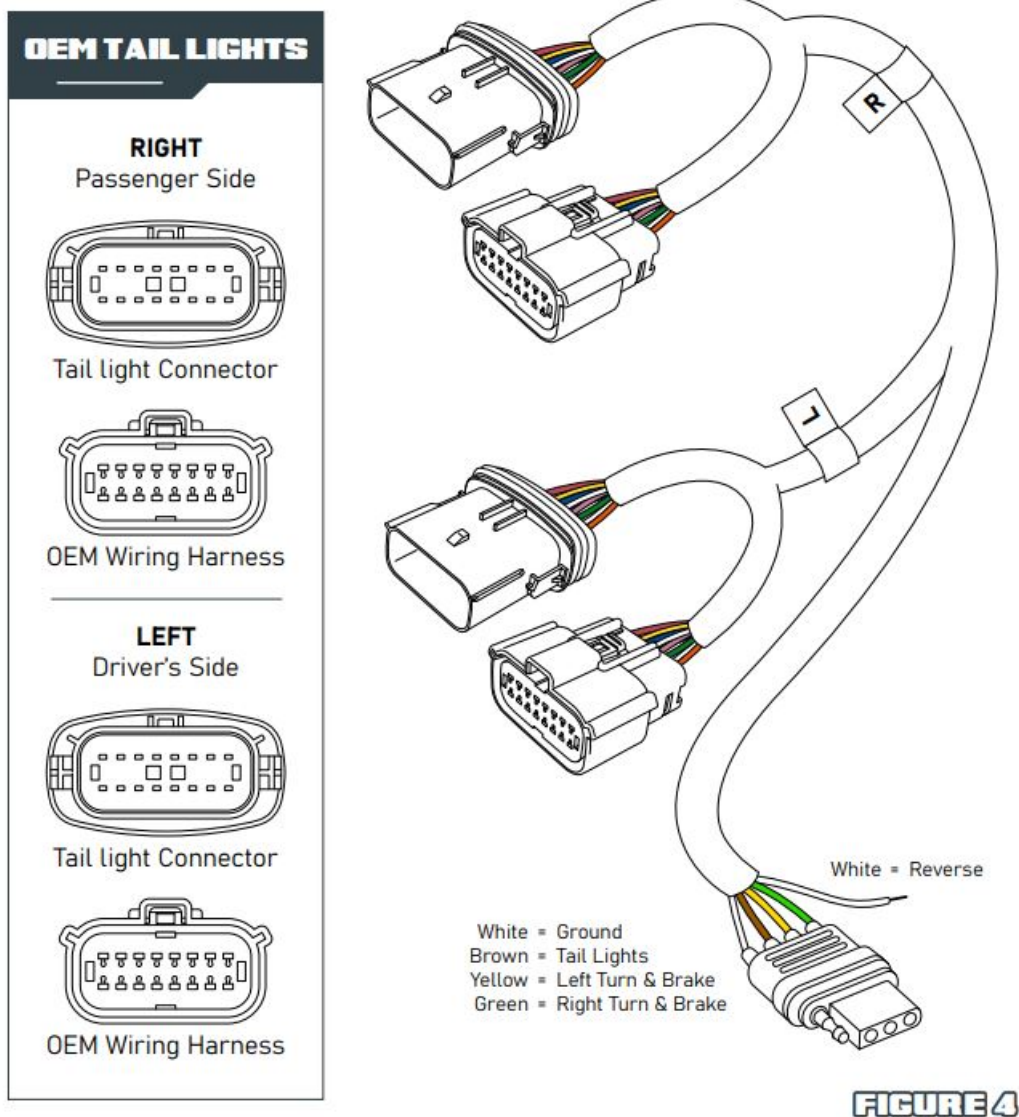

Step 6 Use some zip ties to secure the flat 4PIN trailer connector and reverse wire in place along the inner bumper.

Step 7 Finally, connect the available tailgate light bar to the 4PIN trailer connector and reverse wire for full functionality testing

DISCLAIMER

OPT7 Lighting is not liable for damages or personal injuries while installing this product. The Installation Guide is intended as assistance to reduce setup time. OPT7 Lighting assumes no responsibility for improper installation. If you are unfamiliar with your vehicle or inexperienced with aftermarket upgrades, please seek professional assistance.

OPT7 recommends installation for safety and guidance. Modified installations or installation recommendations not specified by OPT7 Lighting will void product warranty.

Documents / Resources

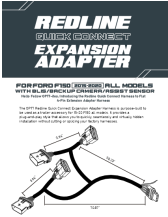
	<p>REDLINE FORD F150 All Models with BLIS/Backup Camera/Assist Sensor [pdf] User Guide</p> <p>e</p> <p>FORD F150 All Models with BLIS Backup Camera Assist Sensor, FORD F150 All Models with BLIS, FORD F150, Backup Camera, Assist Sensor</p>
---	--