



REDBACK A 4437 4 Channel Mixer With Mute Trigger Instruction Manual

[Home](#) » [redback](#) » REDBACK A 4437 4 Channel Mixer With Mute Trigger Instruction Manual 

Contents

- [1 REDBACK A 4437 4 Channel Mixer With Mute Trigger](#)
- [2 Product Usage Instructions](#)
- [3 INTRODUCTION](#)
- [4 FEATURES](#)
- [5 FRONT PANEL GUIDE](#)
- [6 REAR PANEL CONNECTIONS](#)
- [7 SPECIFICATIONS](#)
- [8 Documents / Resources](#)
 - [8.1 References](#)
- [9 Related Posts](#)



REDBACK A 4437 4 Channel Mixer With Mute Trigger



Product Specifications

- Model: A 4437
- Channels: 4

- Mute Trigger: Yes
- Input Types: Mic/Line (XLR/RCA)
- Input Sensitivity: Adjustable from 100mV to 1V
- Phantom Power: Available on all inputs
- Output Types: Balanced XLR, Stereo RCA

Product Usage Instructions

1. Installation

Before installation, carefully read the user manual from front to back for important setup instructions. Failure to follow these instructions may result in the unit not functioning as designed.

2. Input Configuration

The mixer has four mic/line inputs that can be configured for either balanced mic via 3 pin XLR or line inputs via RCA. Use the rear-mounted DIP switches to adjust line input sensitivity from 100mV to 1V.

3. Phantom Power

Phantom power is available on all inputs. Ensure that your microphones or devices support phantom power if you intend to use this feature.

4. Output Connections

The outputs can be connected using either balanced 3 pin XLR or stereo RCA connectors based on your setup requirements.

Frequently Asked Questions (FAQ)

• **Q: Can I use this mixer for both regular PA/BGM and emergency evacuation systems?**

A: Yes, this mixer is designed to work as a stand-alone audio processor for both types of systems. It has inputs for microphone and music sources, along with Mute contacts connected to the Fire Indicator Board for emergency situations.

• **Q: How do I adjust the input sensitivity?**

A: You can adjust the line input sensitivity using the DIP switches located at the rear of the mixer. The sensitivity can be set from 100mV to 1V based on your requirements.

• **Q: Is local servicing available for this product?**

A: Yes, Redback offers comprehensive parts & labor warranty on almost every Australian Made Redback public address product, ensuring prompt local servicing in case of any issues.

Redback® A 4437 Mixer 4 Input with Mute

Operating Manual

A 4437 4 CHANNEL MIXER WITH MUTE TRIGGER

IMPORTANT NOTE:

Please read these instructions carefully from front to back prior to installation. They include important setup instructions.

Failure to follow these instructions may prevent the unit from working as designed.

User manual revision number: 1.0 12/08/2024



REDBACK

You may be surprised to learn that Redback is still manufacturing hundreds of product lines right here in Australia. We have resisted the move offshore by offering our customers better quality products with innovations to save them time and money.

Our Balcatta production facility manufactures/assembles

Redback public address products

One-shot speaker & grill combinations

Zip-Rack 19 inch rack frame products

We strive to support local suppliers wherever possible in our supply chain, helping to support Australia's manufacturing industry.

Redback Audio Products

100% developed, designed & assembled in Australia.

Since 1976 we have been manufacturing Redback amplifiers in Perth, Western Australia. With over 40 years experience in the commercial audio industry, we offer consultants, installers and end users reliable products of high build quality with local product support. We believe there is significant added value for customers when purchasing an Australian made Redback amplifier or PA product.

Local support & feedback.

Our best product features come as a direct result of feedback from our customers, and when you call us, you speak to a real person – no recorded messages, call centres or automated push button options.

It's not only the assembly team at Redback who are employed as a direct result of your purchase, but hundreds more

at local companies used in the supply chain.

Industry leading 10 year warranty.

There's a reason we have the industry leading DECADE warranty. It's because of a long tried and tested history of bullet – proof reliability. We've heard PA contractors tell us they still see the original Redford amplifier still in service in schools.

We offer this comprehensive parts & labour warranty on almost every Australian Made Redback public address product. This offers both installers and end users peace of mind that they will receive prompt local servicing in the rare event of any problems.

INTRODUCTION

Many large commercial buildings these days employ two PA systems. One is the traditional PA/BGM system for every day paging and music distribution. The second is a stand alone emergency evacuation PA system for use in the event of a fire or other emergency. This mixer has been designed for such installations.

It works as a stand alone audio processor with four mic/line inputs for microphone and music sources. Plus it has a set of Mute contacts connected to the buildings Fire Indicator Board (FIB). When the FIB operates it triggers

these contacts, rendering the local PA/BGM system inoperative so the main emergency evacuation system has precedence.

All inputs can be configured for either balanced mic via 3 pin XLR or line inputs via RCA. Line input sensitivity is adjustable from 100mV to 1V using rear mounted DIP switches. Phantom power is also available on all inputs.

Outputs are either balanced 3 pin XLR or stereo RCA connectors.

Individual & master level controls are provided on the front panel along with recessed treble and bass adjustments. Provision is included for the A4573 alert/evac module which generates pre chime, bell, alert and evacuation tones. The alert tone can function continuously, or switch to evac tone after a preset time delay (adjustable 30 seconds to 4.5 min-utes). Simply connects to the mixer internally via the cable provided.

FEATURES

- Four input channels
- Individual level, bass and treble control on all inputs
- 3.5mm music input
- Adjustable input sensitivity on line inputs
- Adjustable Vox sensitivity
- Phantom power ON/OFF for mic inputs
- 24V DC battery back up terminals
- Mute trigger
- Provision for Alert/Evac tone generator module
- 10 Year Warranty
- Australian Designed and Manufactured

WHAT'S IN THE BOX

A 4437 Mixer 4 Channel with MP3 Message player

24V DC Plugpack

Instruction Booklet

FRONT PANEL GUIDE

Fig 1 shows the layout of the A 4437 front panel.

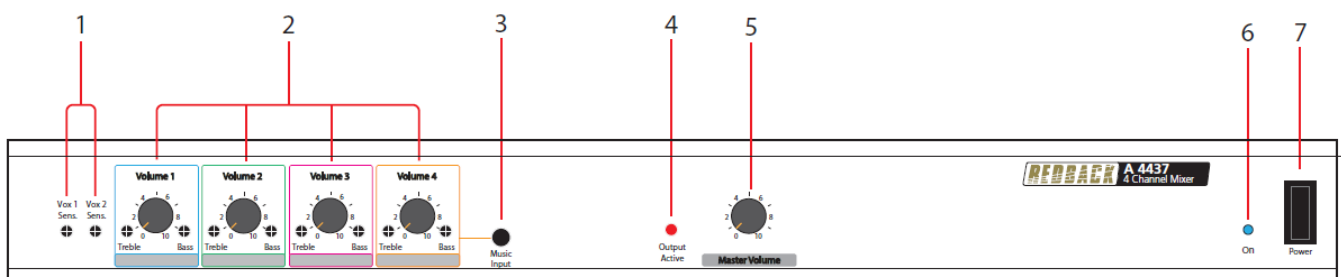

Fig 1

1. VOX 1 Sensitivity

This sets the VOX sensitivity of input 1. When the VOX is active on input 1, inputs 2-4 are muted.

VOX 2 Sensitivity

This sets the VOX sensitivity of input 2. When the VOX is active on input 2, inputs 3-4 are muted.

2. Inputs 1-4 volume controls

Use these controls to adjust the output volume, bass and treble of inputs 1-4.

3. Music input

This input will override input 4 when connected. Use this for connection of portable music players. (Note 1: this input has a fixed input sensitivity).

(Note 2: switch 1 on DIP4 must be set to ON to enable this function).

4. Output Active Indicator

This led indicates when the unit has an output signal present.

5. Master Volume

Use these controls to adjust the output volume, bass and treble of the master volume.

6. On Indicator

This led indicates when the unit has power.

7. Power Switch

Use this switch to turn the unit on.

REAR PANEL CONNECTIONS

Fig 2 shows the layout of the A 4437 rear panel.

1.

Fig 2 shows the layout of the A 4437 rear panel.

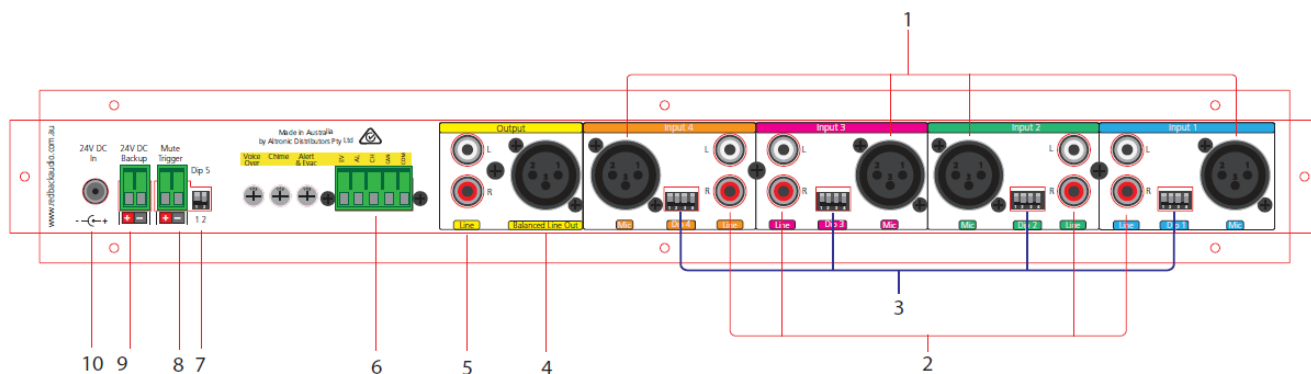

Fig 2

Microphone Inputs

There are four microphone inputs which all incorporate a 3 pin balanced XLR. Phantom power is available at each Mic input and is selected via DIP switches on DIP1 – DIP4 (For more details see DIP switch settings).

2. RCA Unbalanced Line Inputs

The line inputs are dual RCA connectors which are internally mixed to produce a mono input signal. The input sensitivity of these inputs can be adjusted to 100mV or 1V via the DIP switches.

3. DIP Switches DIP1 – DIP4

These are used to select various options such as phantom power on mic inputs, Vox options and input sensitivities. Refer to DIP Switch Settings section.

4. Preamp Out (Balanced Line Output)

A 3 pin 600ohm 1V balanced XLR output is provided for passing the audio signal on to a slave amplifier or to record the output of the amplifier.

5. Line Out

Dual RCA's provide a line level output for recording purposes or to pass the output on to another amplifier.

6. Optional A 4573 Alert/Evac Module

Install this module to provide emergency evacuation tones which override all inputs except input 1. (see section 2.2 for more details).

7. DIP Switch DIP 5

These switches provide the options for the Mute trigger (see DIP switch settings for more details).

8. Mute Trigger

This connector is used to activate the Mute function. (see section 8.0 for more details).

9. 24V DC Input (Backup)

Connects to a 24V DC backup supply with at least 1 amp current capacity. (Please observe the polarity)

10. 24V DC input

Connects to a 24V DC Plugpack with 2.1mm Jack.

DIP Switch settings

The A 4437 has various options which are enabled via the DIP switches 1-5.

DIP 1-4 set the input level sensitivity, phantom power and priorities for inputs 1-4 as outlined below. (* Priority/VOX muting is only available for Mic inputs 1-2. Line Inputs 3-4 have no priority levels.)

IMPORTANT NOTE:

Ensure power is switched off when adjusting DIP switches. New settings will be effective when power is switched back on.

- DIP 1
 - Switch 1 – Input 1 Select – OFF – Mic, ON – Unbalanced Line Input
 - Switch 2 – Sets Input 1 sensitivity to either ON – 1V or OFF – 100mV. (This affects the unbalanced Line Input only) Switch 3 – Sets Input 1 priority or VOX to ON or OFF.
 - Switch 4 – Enables Phantom power to the Mic on input 1.
- DIP 2
 - Switch 1 – Input 2 Select – OFF – Mic, ON – Unbalanced Line Input
 - Switch 2 – Sets Input 2 sensitivity to either ON -1V or OFF -100mV. (This affects the unbalanced Line Input only) Switch 3 – Sets Input 2 priority or VOX to ON or OFF.
 - Switch 4 – Enables Phantom power to the Mic on input 2.
- DIP 3
 - Switch 1 – Input 3 Select – OFF – Mic, ON – Unbalanced Line Input
 - Switch 2 – Sets Input 3 sensitivity to either ON – 1V or OFF – 100mV. (This affects the unbalanced Line Input only) Switch 3 – Not used
 - Switch 4 – Enables Phantom power to the Mic on input 3.
- DIP 4
 - Switch 1 – Input 4 Select – OFF – Mic, ON – Line/Music input (Must be set to ON for Music Input to operate)
 - Switch 2 – Sets Input 4 sensitivity to either ON – 1V or OFF – 100mV. (This affects the unbalanced Line Input only) Switch 3 – Not used
 - Switch 4 – Enables Phantom power to the Mic on input 4.
- Input 1: When VOX is enabled on input 1 it will override inputs 2 – 4. Input 2: When VOX is enabled on input 2 it will override inputs 3 – 4.
- DIP 5
 - Switch 1 – ON – The mixer output will mute when the mute trigger contacts are open. Normal mixer operation when contacts shorted.

OFF – The output will mute when 24V DC is applied to the mute contacts.

Normal mixer operation when no voltage applied to mute contacts.

- Switch 2 – Not used

Alert/Evac Module

- The optional A 4573 Alert/Evac module can be fitted to provide pre-chime, bell, alert and evacuation tones. The alert tone can function continuously, or switch to evac tone after a preset time delay (adjustable 30 seconds to 4.5 minutes).
- The alert/evac module when activated will override inputs 2-4.
- The trimpots are used to adjust the output levels of the alert and evacuation tone and the chime and voice over message. Use the contact triggers to activate the chime tones, the alert tone, the evacuation tone and to cancel any of the tones once triggered. All tones & cancel function are operated by a closing contact to ground. This could be triggered via build-ing fire indicator board, break glass alarm, remote wall plates etc.

To install the A 4573 follow these steps.

1. Disconnect power from the A 4437
2. Remove the lid.
3. Remove the blank metal plate from the rear of the A 4437.
4. Slip the A 4573 through the hole and plug the cable into the header socket as show in figure 3.
5. Screw the A 4573 into the rear of the A 4437 with the screws supplied with the A 4573.
6. Refer to the A 4573 for DIP switch settings and options required.
7. Replace lid on A 4437.

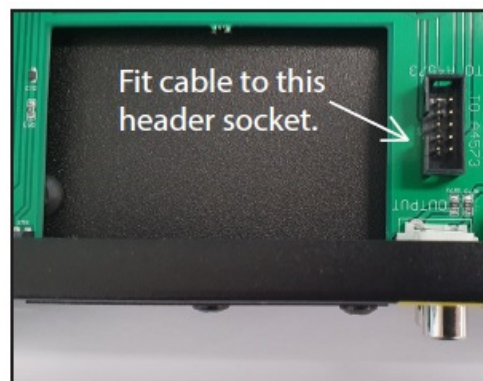

Fig 3

Mute Function

The output of the A 4437 mixer can be muted by using the Mute contacts in combination with switch 1 of DIP5 (refer to DIP switch settings).

There are two methods to activate the mute function.

1. The first requires the use of a closing contact on the mute contacts. This could be triggered via a building fire indicator board, break glass alarm, remote wall plates etc.

With DIP5 switch 1 set to ON, any open connection on the mute contacts as shoen in figure 4 will mute the output of the mixer. While the contacts are closed the mixer will operate normally.\

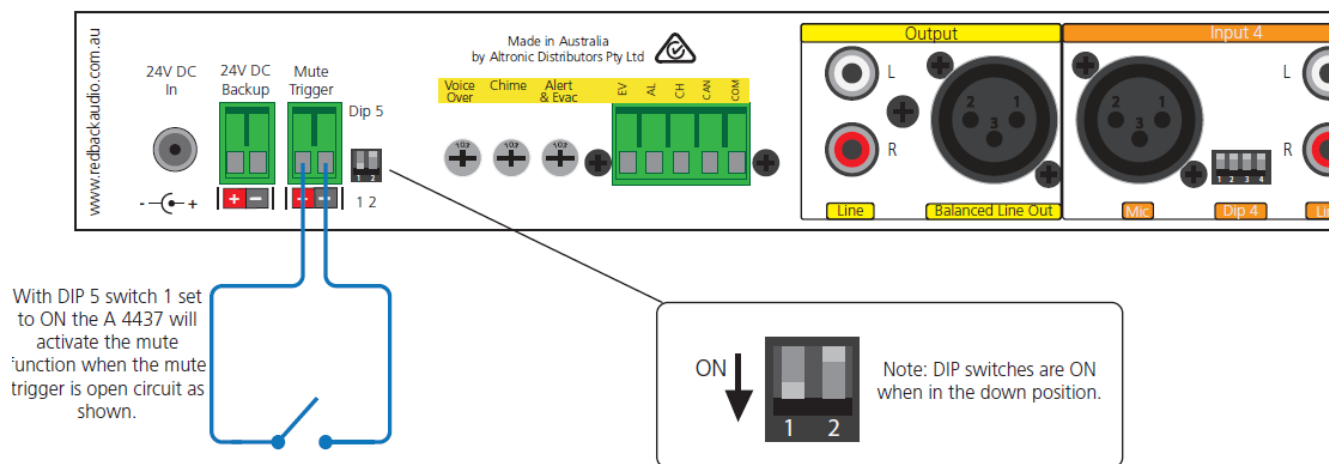

Fig 4 DIP 5 switch 1 set to ON. Mute activated by open circuit on Mute Trigger terminals.

2. The second method makes use of 24V DC on the mute contacts.

With DIP5 switch 1 set to OFF, apply 24V DC to the mute contacts as shown in figure 5 to activate the mute function.

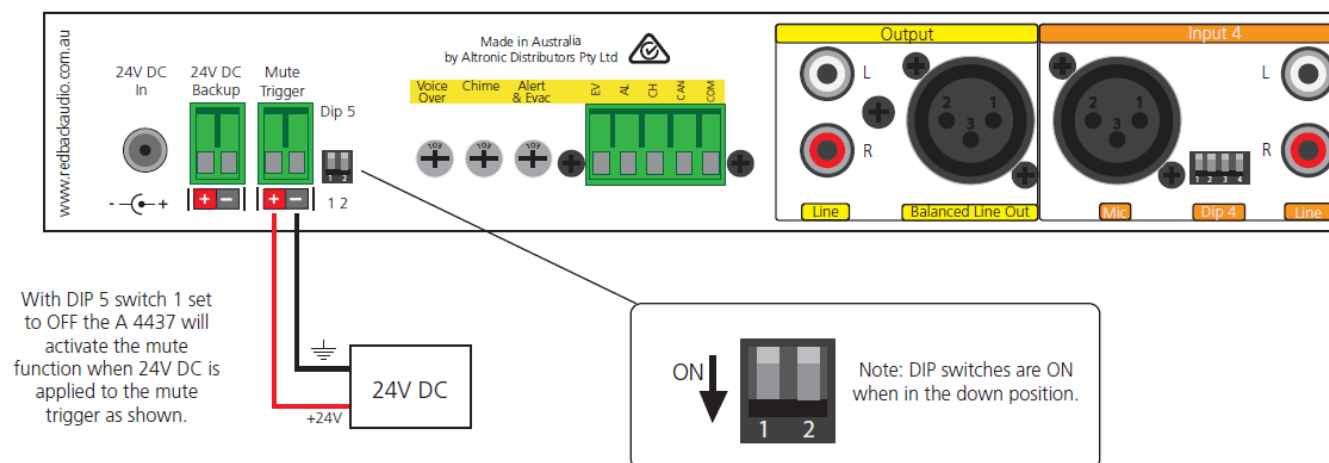

Fig 5 DIP 5 switch 1 set to OFF. Mute activated by applying 24V DC to Mute Trigger terminals.

SPECIFICATIONS

- OUTPUT LEVEL:.....0dBm
- DISTORTION:.....0.01%
- FREQ. RESPONSE:.....140Hz – 20kHz
- SENSITIVITY
- Mic inputs:3mV balanced
- Line inputs:.....100mV-1V
- OUTPUT CONNECTORS
- Line out:3 pin XLR balanced or 2 x RCA
- Switched out:Screw terminals
- INPUT CONNECTORS
- Inputs:3 pin XLR balanced or 2 x RCA 3.5mm stereo jack front panel
- 24V DC power:Screw terminals
- 24V DC Power:2.1mm DC Jack

- Mute trigger:Screw Terminals

CONTROLS:

- Power:.....Standby Switch
- Bass:.....±10dB @ 100Hz
- Treble:.....±10dB @ 10kHz
- Master:Volume
- Inputs 1-4:Volume
- INDICATORS:.....Power on, output active
- POWER SUPPLY:..... 24V DC
- DIMENSIONS:≈..... 482W x 175D x 44H
- WEIGHT: ≈..... 2.1 kg
- COLOUR:Black

Specifications subject to change without notice

8 Redback® Proudly Made In Australia

www.redbackaudio.com.au

Documents / Resources



[REDBACK A 4437 4 Channel Mixer With Mute Trigger](#) [pdf] Instruction Manual
A 4437, A 4437 4 Channel Mixer With Mute Trigger, A 4437, 4 Channel Mixer With Mute Trigger, Channel Mixer With Mute Trigger, Mixer With Mute Trigger, With Mute Trigger, Mute Trigger, Trigger

References

- [Redbackaudio.com](http://www.Redbackaudio.com)
- [User Manual](#)

[Manuals+](#), [Privacy Policy](#)

This website is an independent publication and is neither affiliated with nor endorsed by any of the trademark owners. The "Bluetooth®" word mark and logos are registered trademarks owned by Bluetooth SIG, Inc. The "Wi-Fi®" word mark and logos are registered trademarks owned by the Wi-Fi Alliance. Any use of these marks on this website does not imply any affiliation with or endorsement.