

REDATOM RED120FTE64 Large Fixed Tilt & Extend TV Mount



# REDATOM RED120FTE64 Large Fixed Tilt & Extend TV Mount Instruction Manual

[Home](#) » [REDATOM](#) » REDATOM RED120FTE64 Large Fixed Tilt & Extend TV Mount Instruction Manual 

## Contents

- [1 REDATOM RED120FTE64 Large Fixed Tilt & Extend TV Mount](#)
- [2 Product Information](#)
- [3 Product Usage Instructions:](#)
- [4 DISCLAIMER – WARNING INFORMATION](#)
- [5 TOOLS NEEDED](#)
- [6 HARDWARE PRODUCT NUMBER](#)
- [7 PRODUCT COMPONENT PARTS](#)
- [8 Assembly](#)
- [9 Installation](#)
- [10 WARRANTY INFORMATION](#)
- [11 Documents / Resources](#)
  - [11.1 References](#)
- [12 Related Posts](#)



**REDATOM RED120FTE64 Large Fixed Tilt & Extend TV Mount**

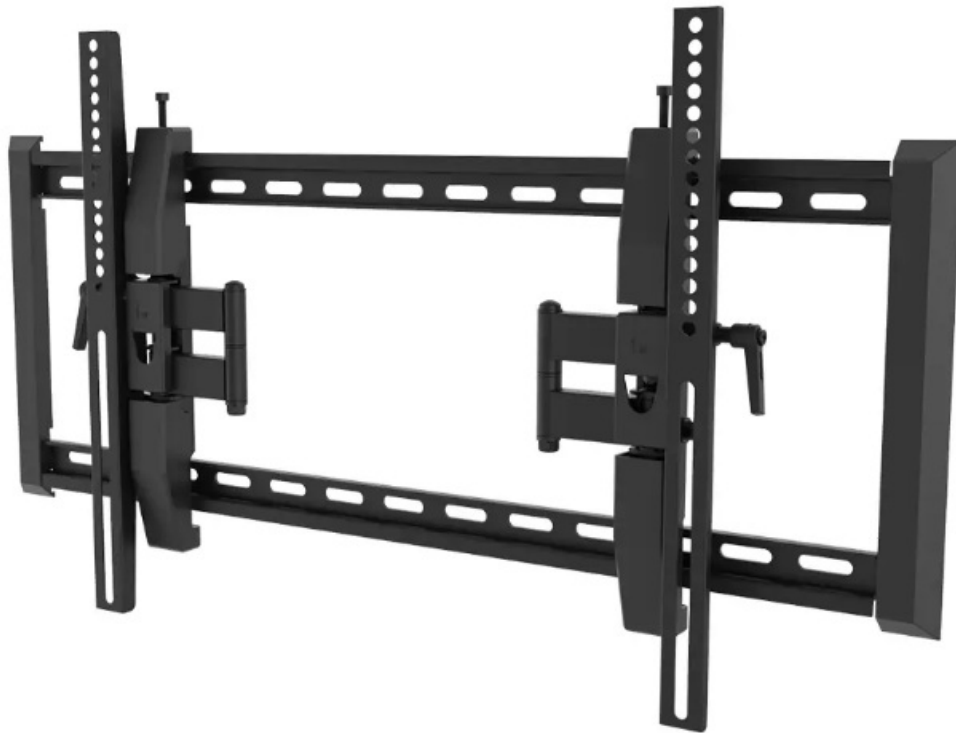

## Product Information

### Specifications:

- Product Name: Large Fixed, Tilt, & Extend TV Mount
- Model: V1
- Product Number: RED120FTE64
- Max Loading Weight: 120 lbs
- Max Screen Size: 90 inches
- VESA Mounting Pattern Minimum: 100mm x 100mm, Maximum: 700mm x 400mm

### Product Usage Instructions:

#### • Step 1: Attaching Vertical Rails to TV Back

Before installing vertical rails, ensure the VESA pattern compatibility:

- If VESA pattern is larger than 200mm x 200mm, attach vertical rails with tension handles facing out.
- If VESA pattern is 200mm x 200mm or smaller, attach vertical rails with tension handles inside.

#### • Step 2: Connecting Universal Vertical Rails to Flat Panel

Depending on the type of flat panel (flat back or curved back), connect the universal vertical rails accordingly. Use spacers for cable clearance if needed.

#### • Step 3: Installing on Wood Stud or Concrete Wall

For wood stud installation, mark the locations and use a drill template for pilot holes. For concrete installation, mark the locations and drill pilot holes.

#### • Step 4: Attaching Panel to Wall Plate & Adjusting Tilt Angle

Secure the TV with vertical rails to the wall plate using appropriate hardware. Adjust the tilt angle as desired.

#### • Step 5: Adjusting Tilt Tension & Leveling

After installation, adjust the tilt tension for optimal viewing experience. Use the included bubble level for post-

installation leveling.

## FAQs:

### 1. What is the maximum screen size supported by the TV mount?

The TV mount supports a maximum screen size of 90 inches.

### 2. Can I use the TV mount for TVs heavier than 120 lbs?

No, using the TV mount with products heavier than the specified weight may result in instability and personal injury.

### 3. What tools are required for installation?

The tools required include a drill, socket wrench, screwdriver, and pencil for marking.

### 4. How do I adjust the tilt angle of the TV after installation?

You can adjust the tilt angle by loosening or tightening the screws connecting the TV to the wall plate.

## Large Fixed, Tilt, & Extend TV Mount

RED120FTE64

## INSTRUCTION MANUAL

**CAUTION:** THE MAXIMUM LOADING WEIGHT IS 120 LBS. USE WITH PRODUCTS HEAVIER THAN THE MAXIMUM WEIGHT INDICATED MAY RESULT IN INSTABILITY AND POSSIBLE PERSONAL INJURY

**Max Screen Size:** 90"

## QUESTIONS?

NEED HELP?

[info@redatomproducts.com](mailto:info@redatomproducts.com)

## DISCLAIMER – WARNING INFORMATION

- **Disclaimer** –. RED ATOM has extended every effort to ensure to accuracy and completeness of this manual. However, RED ATOM does not claim that the information covers all installation and or operational variables. The information contained in this document is subject to change without notice or obligation of any kind. Regarding the information contained herein, RED ATOM makes no representation of warranty, expressed or implied, and assumes no responsibility for accuracy, sufficiency, or completeness of the information contained in this document.
- **WARNING:** FAILURE TO READ, THOROUGHLY UNDERSTAND, AND FOLLOW ALL INSTRUCTIONS CAN RESULT IN SERIOUS PERSONAL INJURY, DAMAGE TO PERSONAL PROPERTY, OR VOIDING OF FACTORY WARRANTY!
- It is the responsibility of the installer to ensure all components are properly assembled and installed using the instructions provided. If you do not understand these instructions or have any questions or concerns, please contact customer service at [info@redatomproducts.com](mailto:info@redatomproducts.com)
- Do not attempt to install or assemble this product if the product or hardware is damaged or missing. The included hardware is designed for use on vertical walls constructed of wood studs or solid concrete. A wood stud wall is defined as consisting of a minimum of 2×4 wooden studs (2" wide by 4" deep) with a maximum of 5/8" drywall. The included hardware is not designed for use with metal studs or cinderblock walls. If you're uncertain about the construction of your wall, then please consult a qualified contractor or installer for

assistance. For a safe installation, the wall you are mounting to must support 4 times the weight of the total load. If not, then the surface must be reinforced to meet this standard. The installer is responsible for verifying that the wall structure and hardware used in any installation method will safely support the total load.

## TOOLS NEEDED

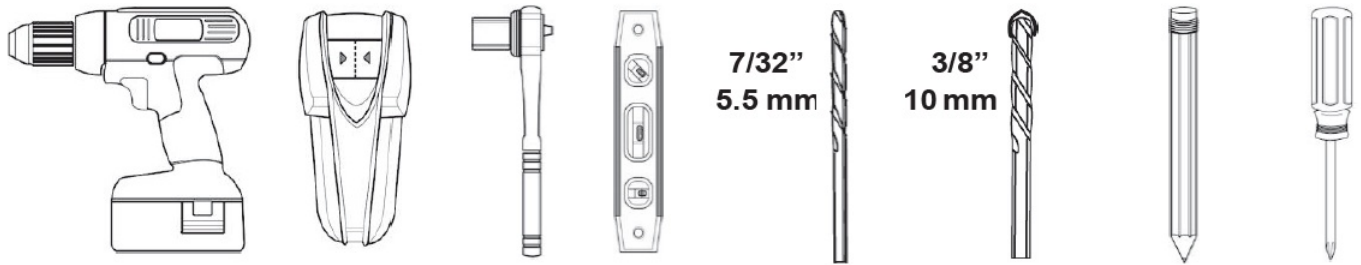

## SYMBOLS



## HARDWARE PRODUCT NUMBER

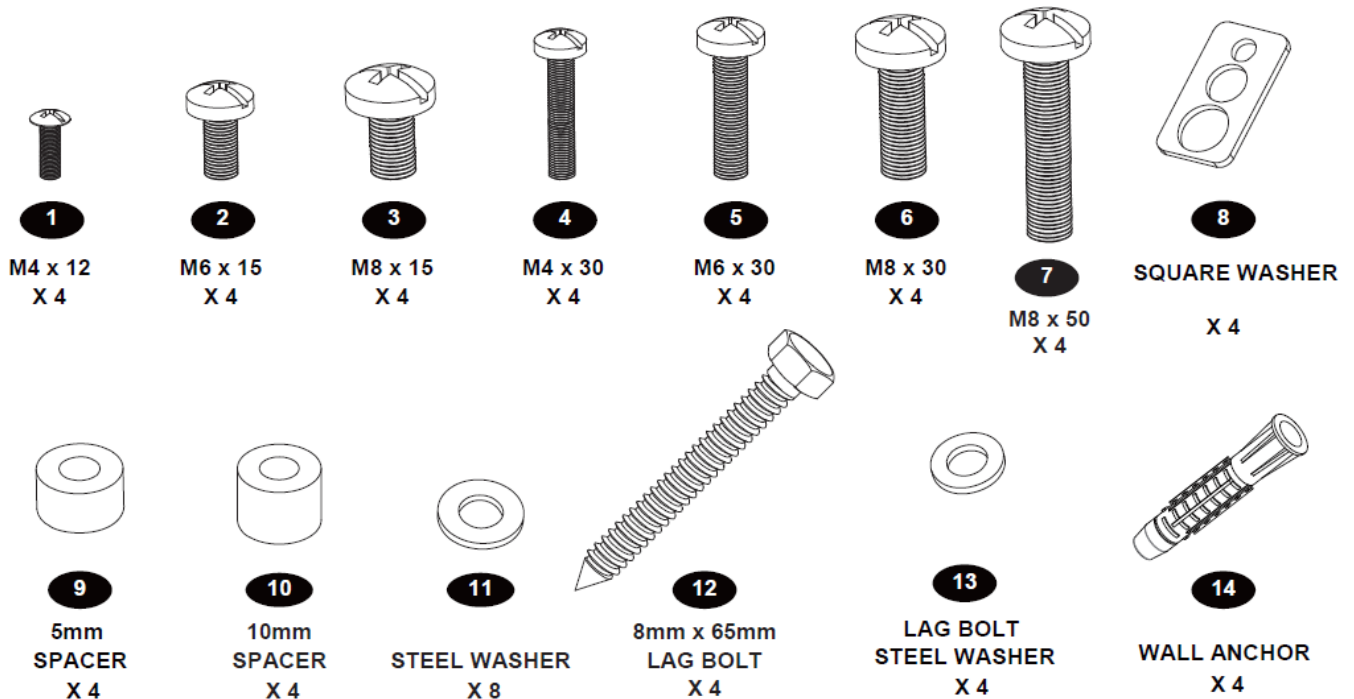

## PRODUCT COMPONENT PARTS

### VESA Mounting Pattern (W x H)

- **Minimum:** 100mm x 100mm
- **Maximum:** 700mm x 400mm

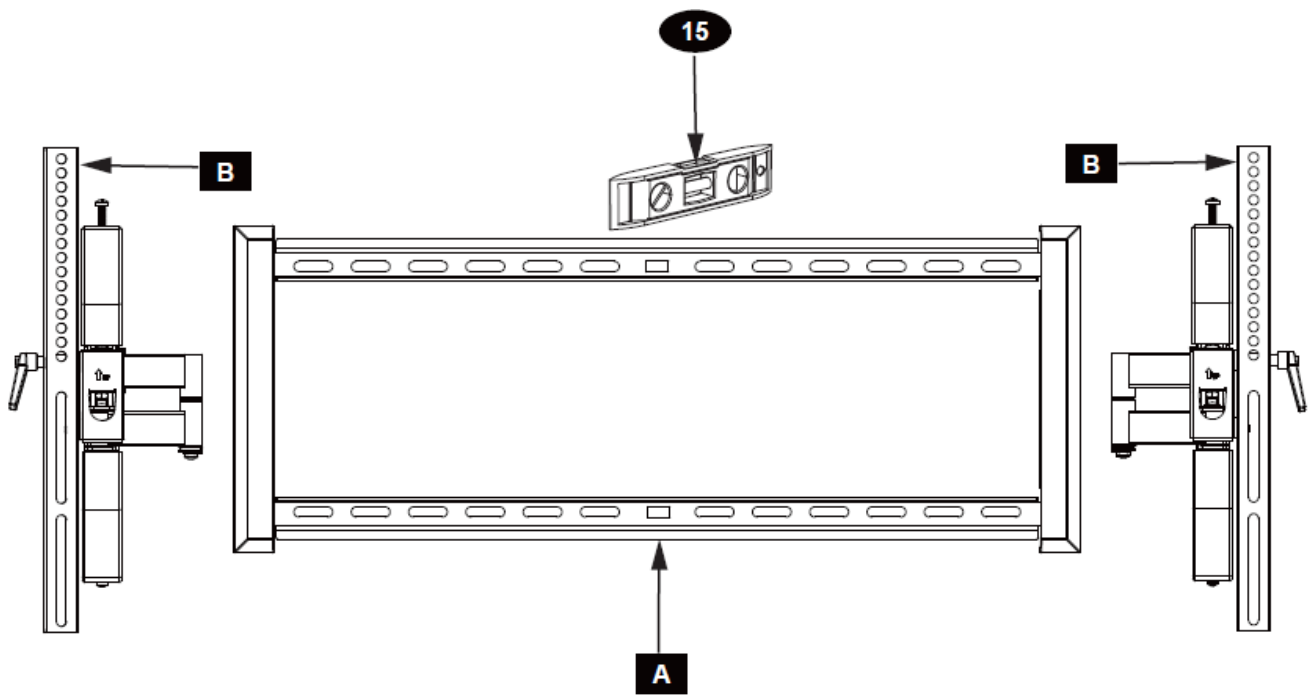

Product Components			
		Qty	Description
Part #	15	1	Bubble Level
Contents			
A		1	Wall Plate
B		2	Universal Vertical Rails

**IMPORTANT:** BEFORE INSTALLING VERTICAL RAILS TO TV BACK

- When VESA pattern is larger than 200mm x 200mm, the vertical rails should be attached to the TV with tension handles facing out as shown.

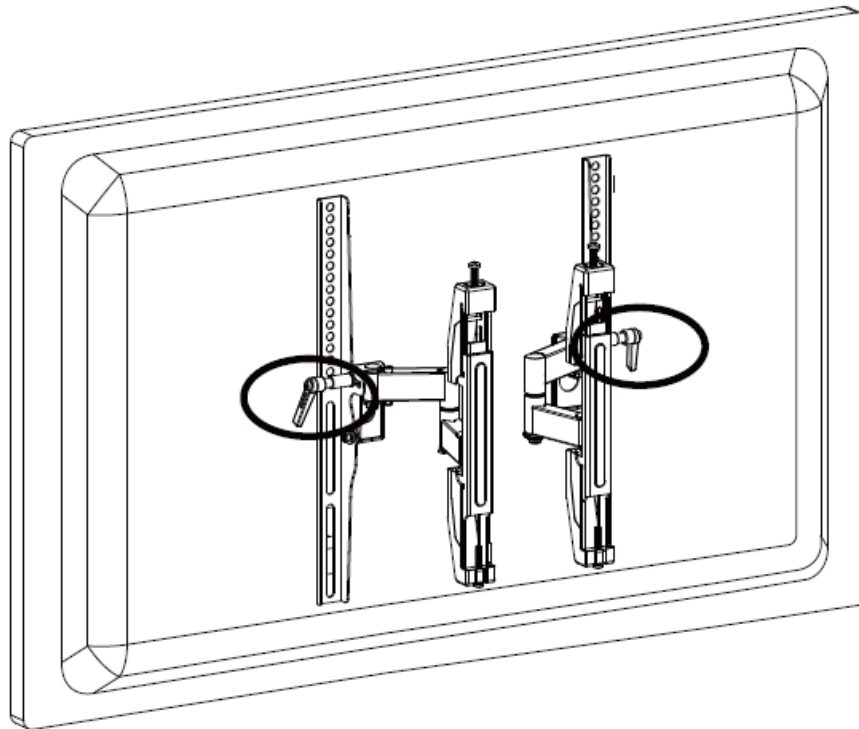

- When VESA pattern is 200mm x 200mm or smaller, the vertical rails should be attached to TV with tension handles inside as shown.

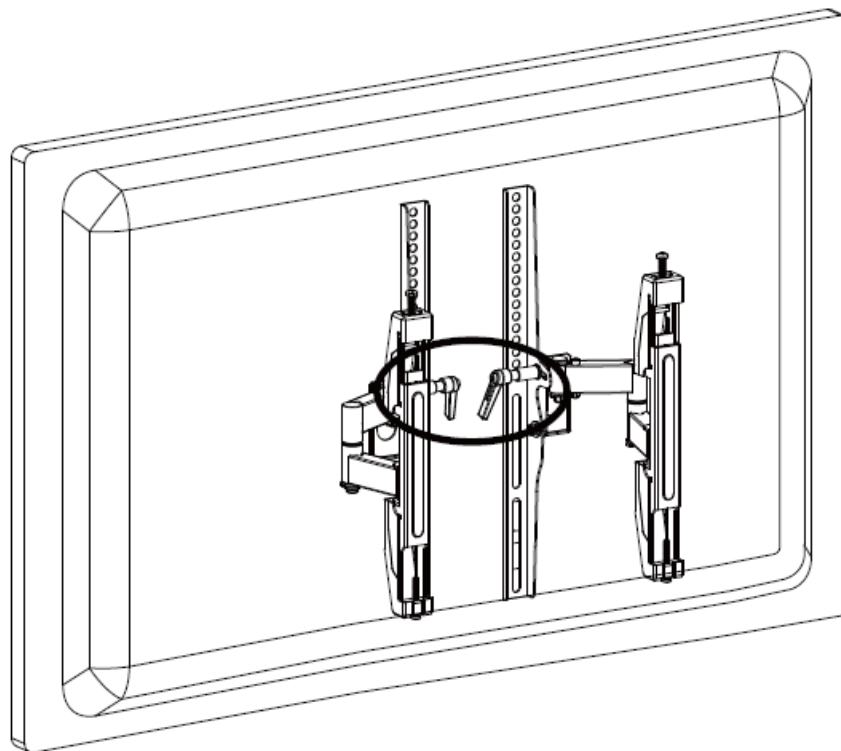

## Assembly

- **STEP 1A – FLAT BACK FLAT PANEL (UNIVERSAL VERTICAL RAILS)**

Connect Universal Vertical Rails to flat panel

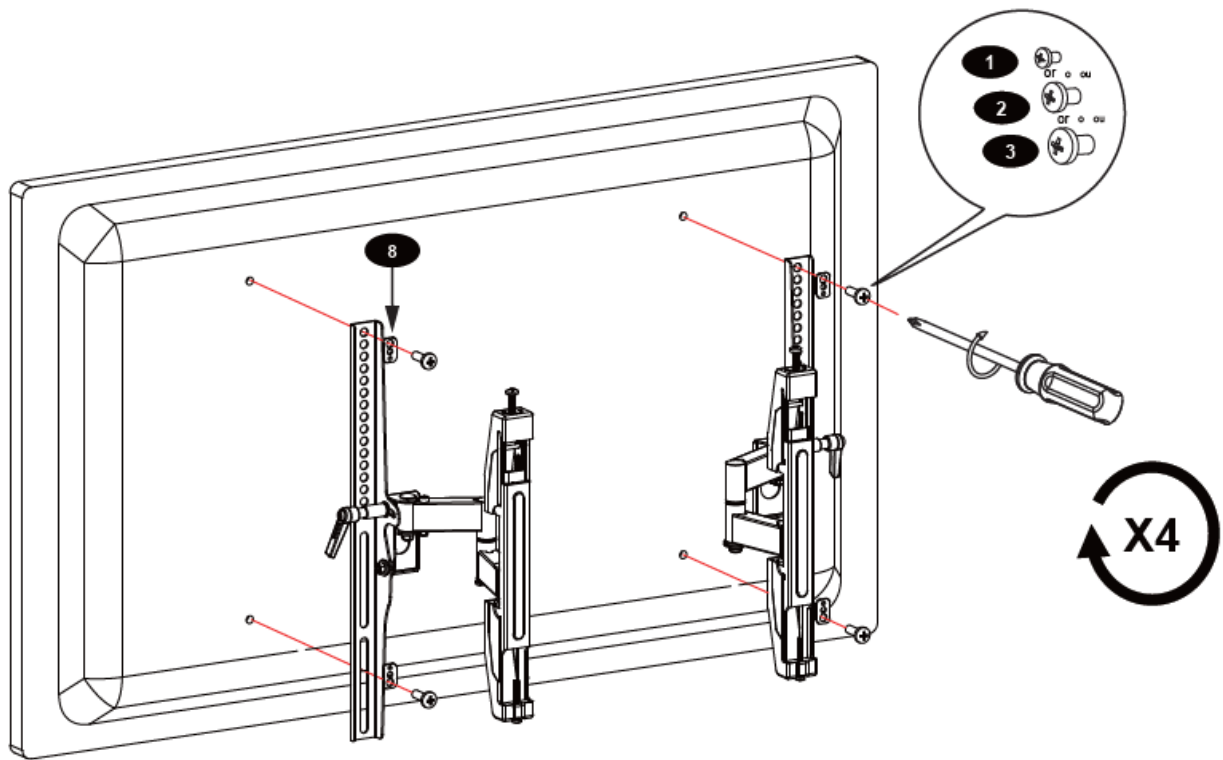

### • STEP 1B – CURVED BACK FLAT PANEL (UNIVERSAL VERTICAL RAILS)

Connect Universal Vertical Rails to flat panel

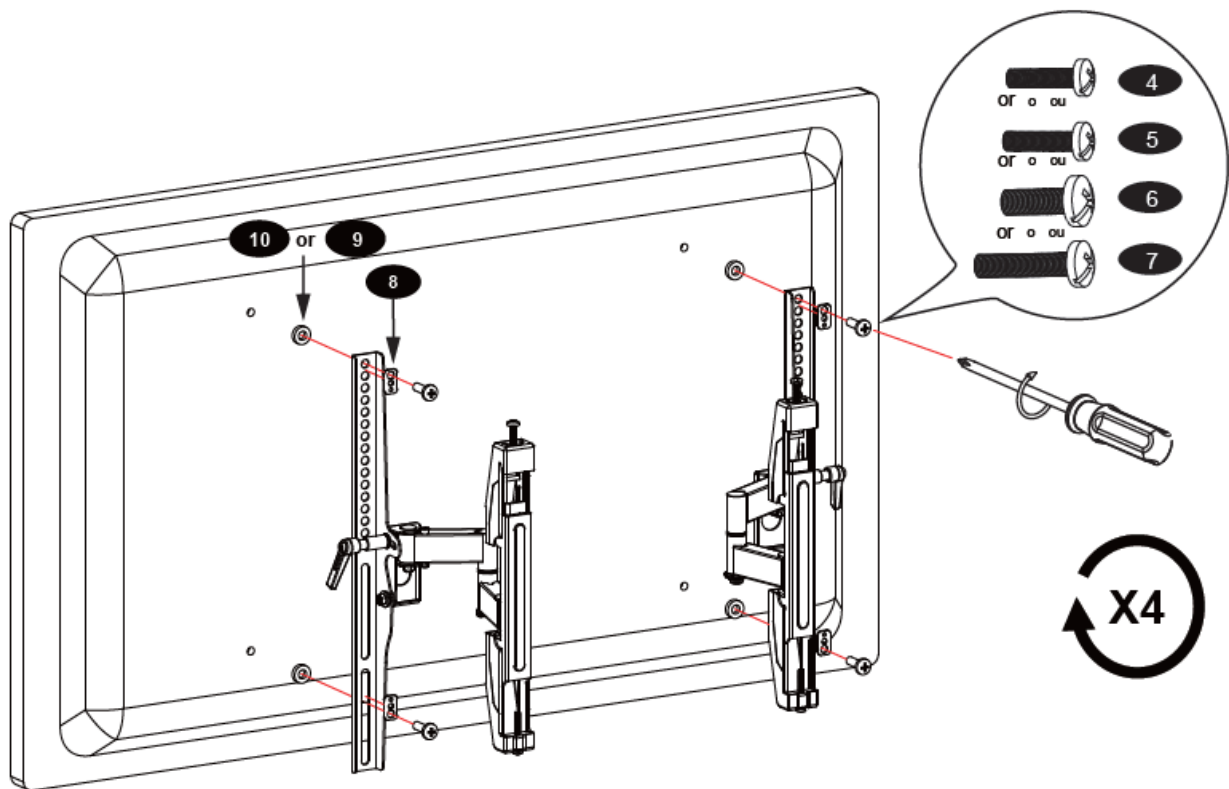

Spacers can also be used to provide clearance for cables and connectors

## Installation

### STEP 1- USE M8 STEEL WASHER IF THE PHILLIPS SCREWS FROM THE MONITOR KIT ARE TOO LONG

- Diagrams show two options for using additional washers if hardware screws are too long to properly tighten into back of flat panel television.

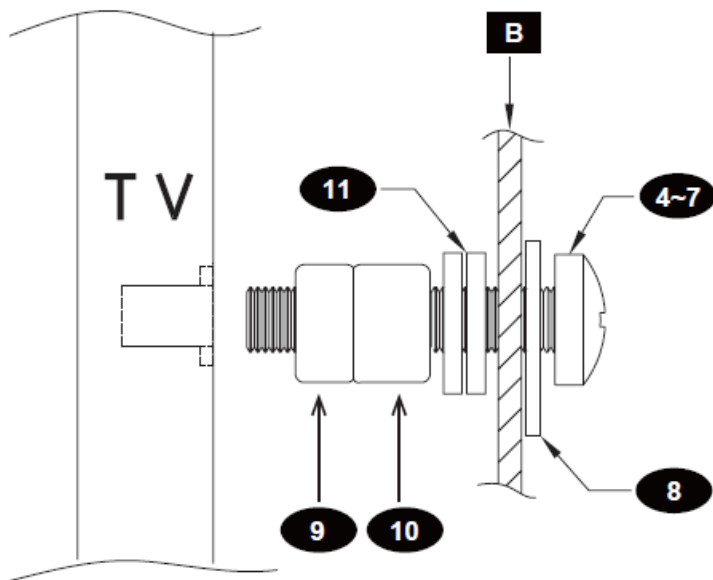

**OPT  
A**

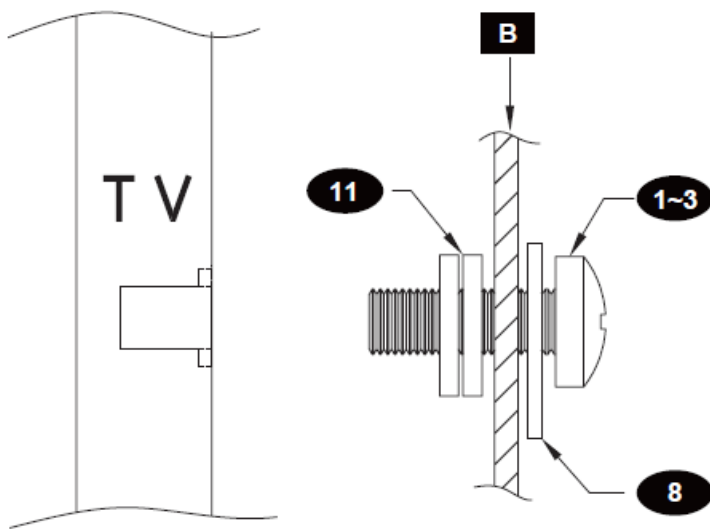

**OPT  
B**

- Select the proper spacers or spacer suit as below if necessary

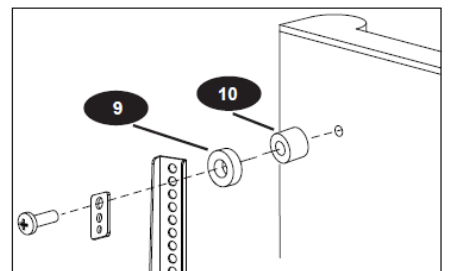
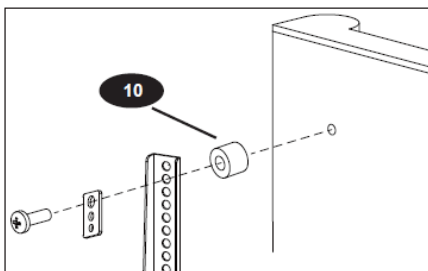
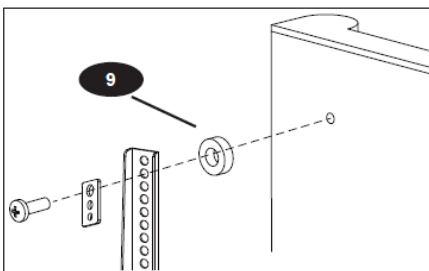

- **STEP 2A- WOOD STUD INSTALLATION (CONCRETE INSTALLATION SKIP TO STEP 3)**

Find stud and mark edge and center locations

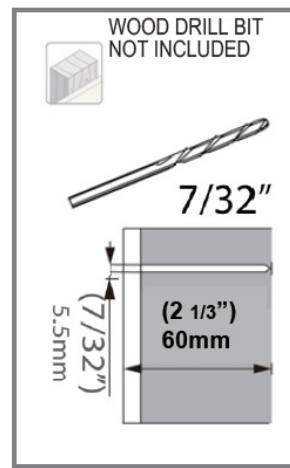
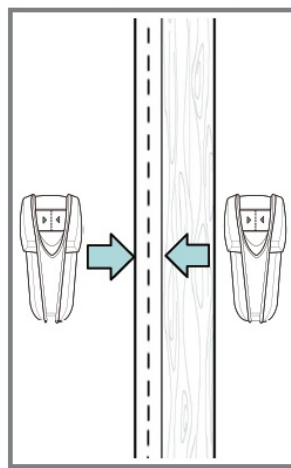
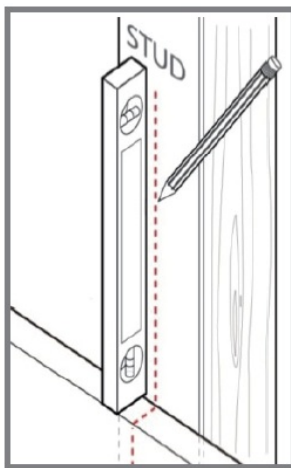

- STEP 2B- USE TEMPLATE TO MARK WALL FOR PILOT HOLES

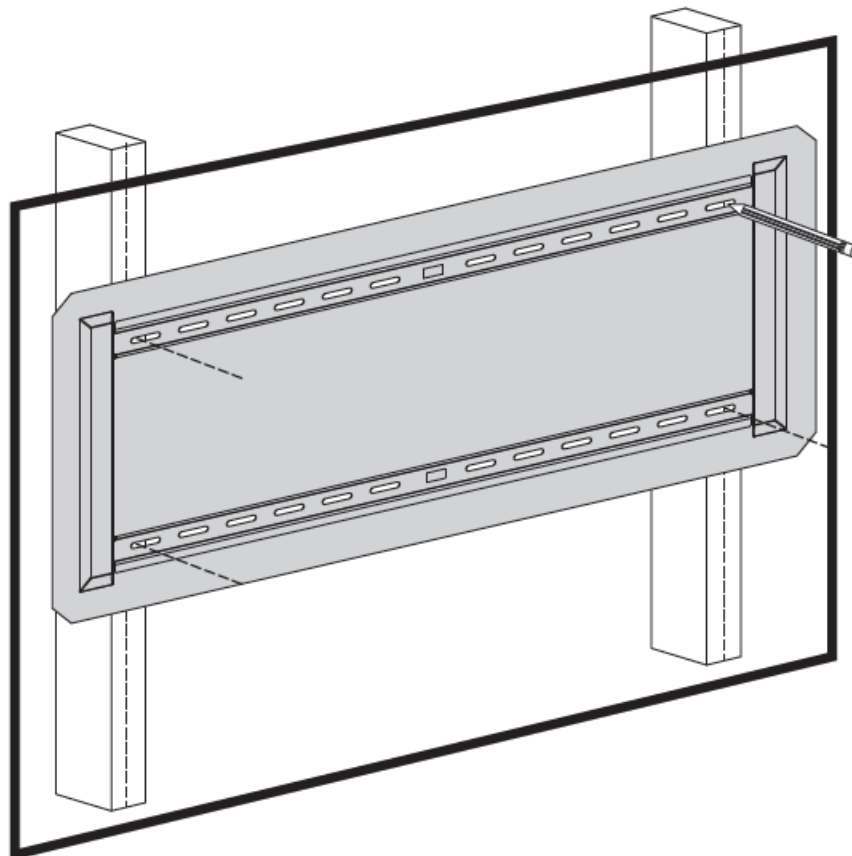

- STEP 2C – DRILL PILOT HOLE AND MOUNT WALL PLATE

Drill Pilot Hole

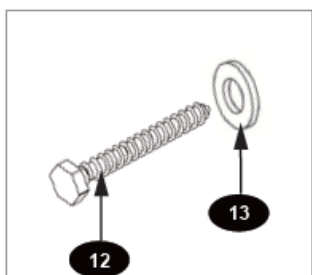
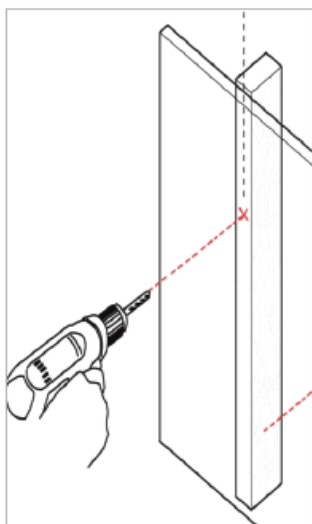

Mount wall plate

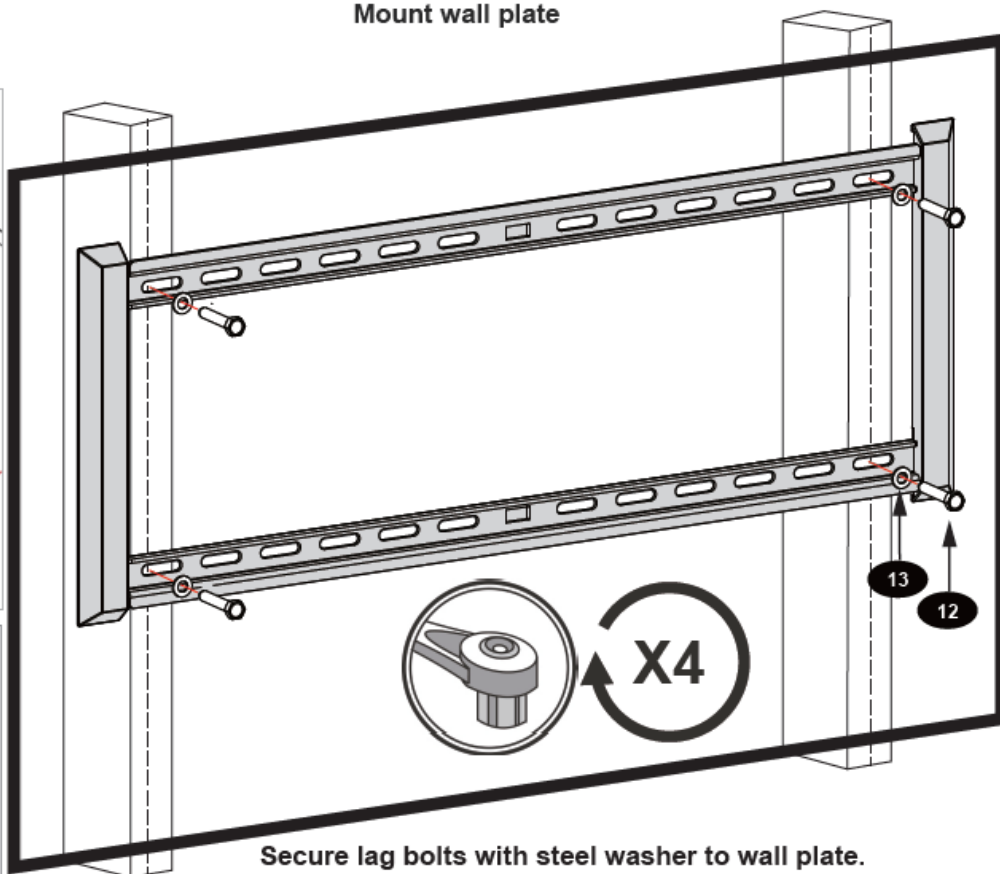

### • STEP 3A – SOLID CONCRETE INSTALLATION

Use wall plate to mark mounting locations/ drill pilot holes

Level

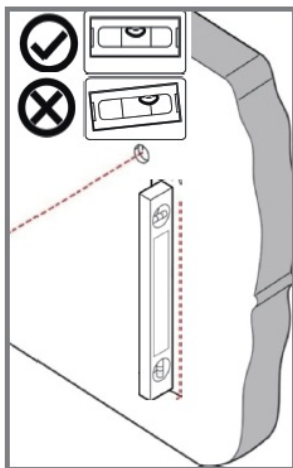

Solid Concrete

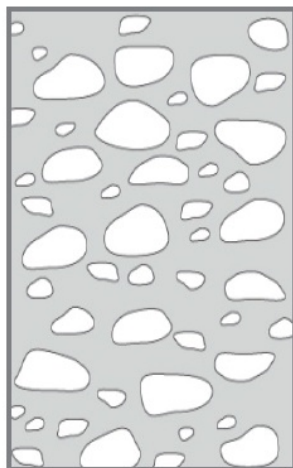

Drill Bit

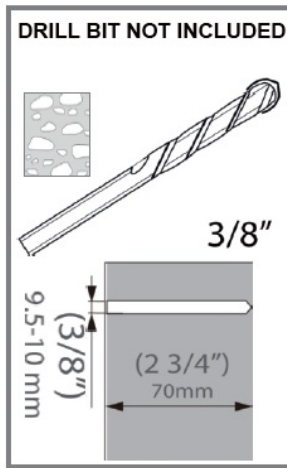

Drill Pilot Hole

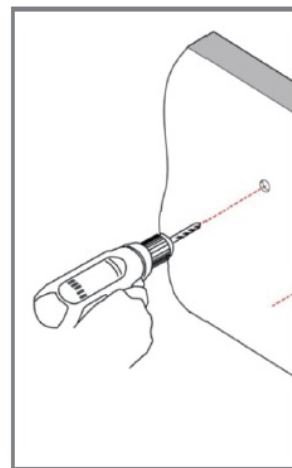

### • STEP 3B- USE TEMPLATE TO MARK WALL FOR PILOT HOLES

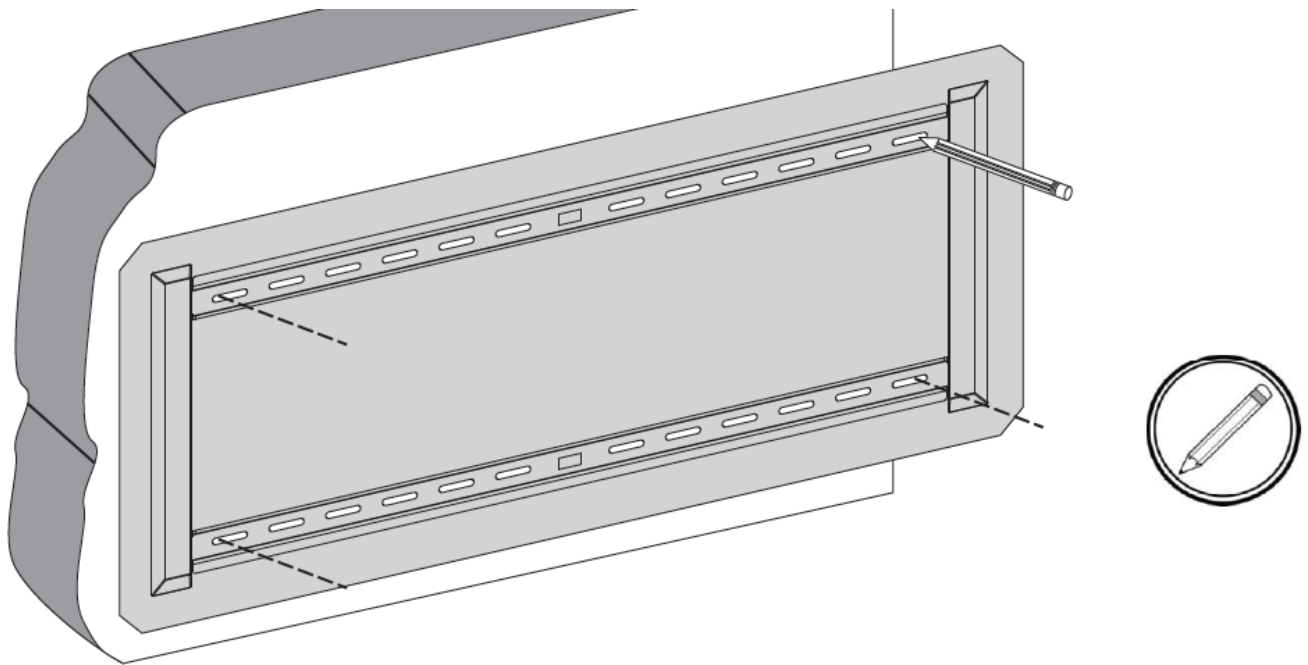

• STEP 3C – DRILL PILOT HOLES AND MOUNT WALL PLATE

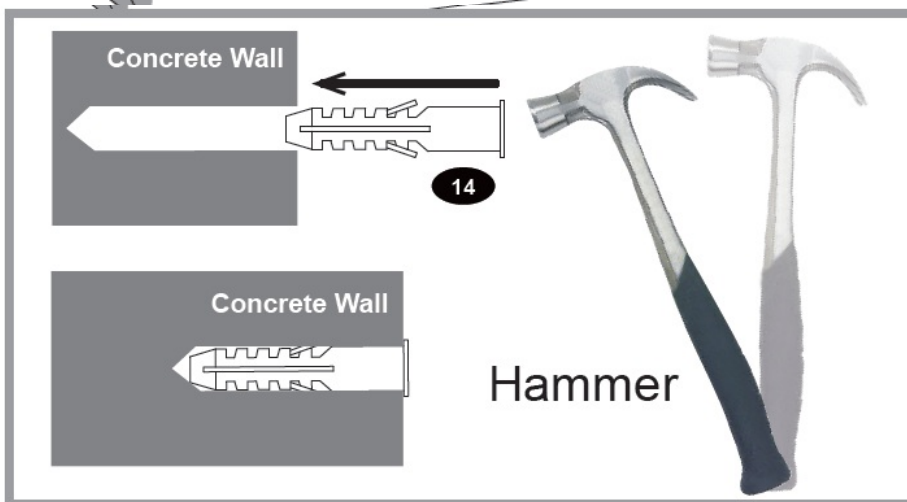
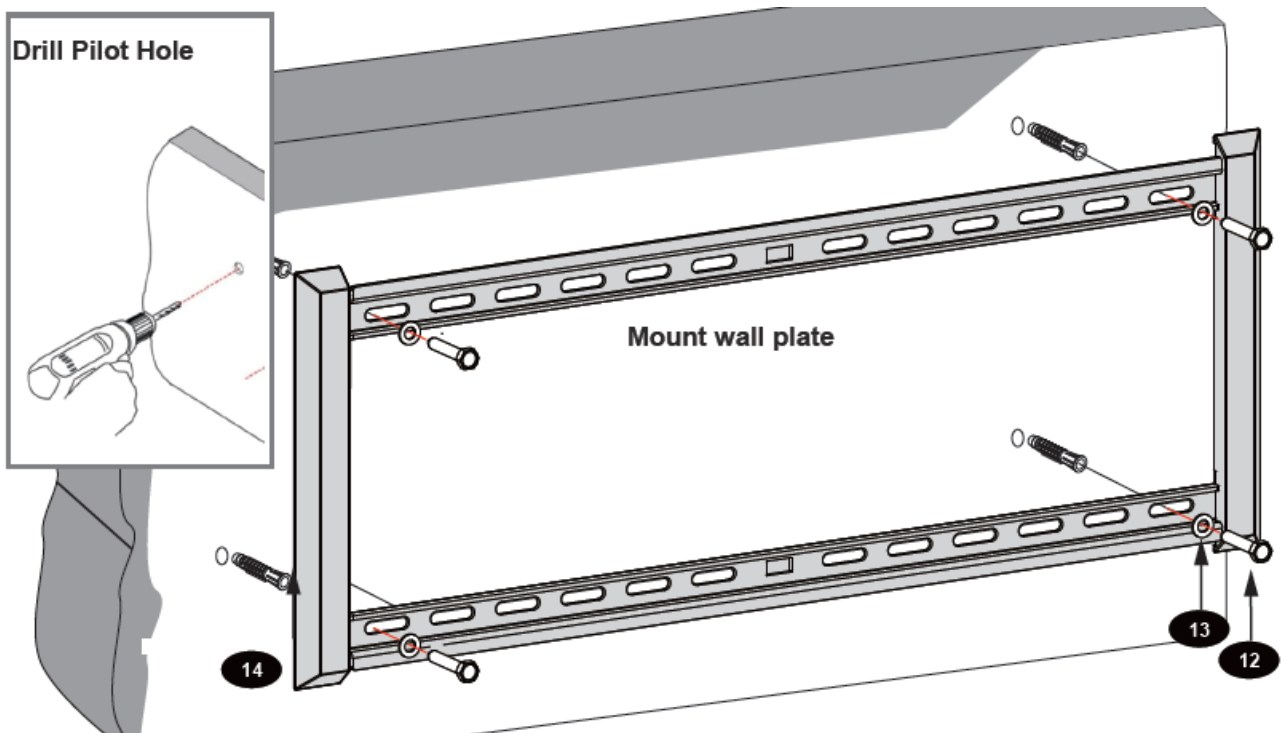

Insert wall Anchors  
gently into concrete wall  
with hammer if necessary

• STEP 4A- ATTACH PANEL TO WALL PLATE & ADJUST TILT ANGLE

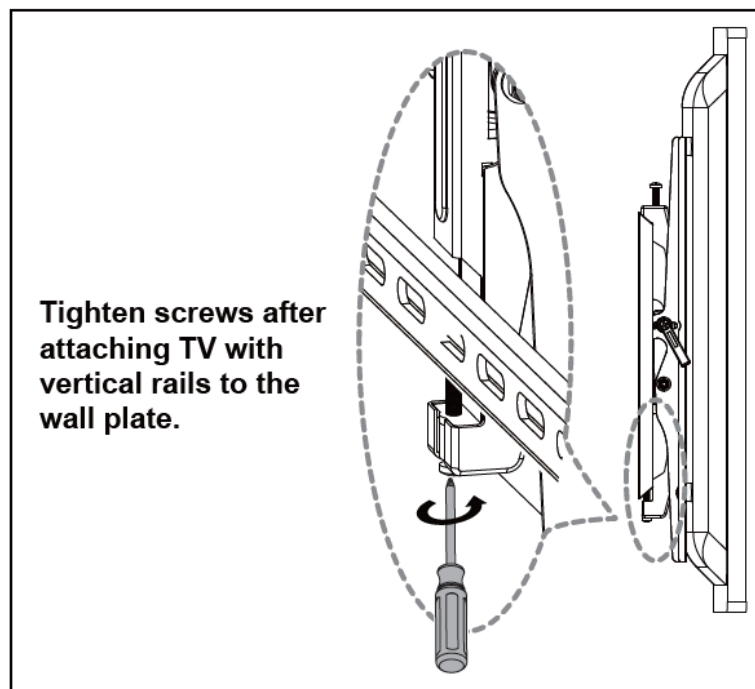
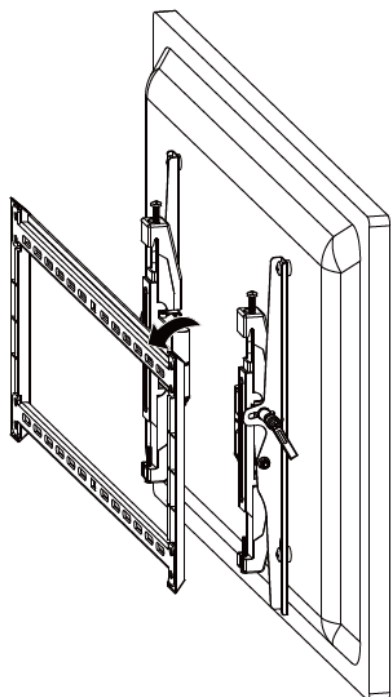

• **STEP 5 – ADJUST TILT TENSION/ POST INSTALLATION LEVEL**

Maximum leveling adjustment 0.5"

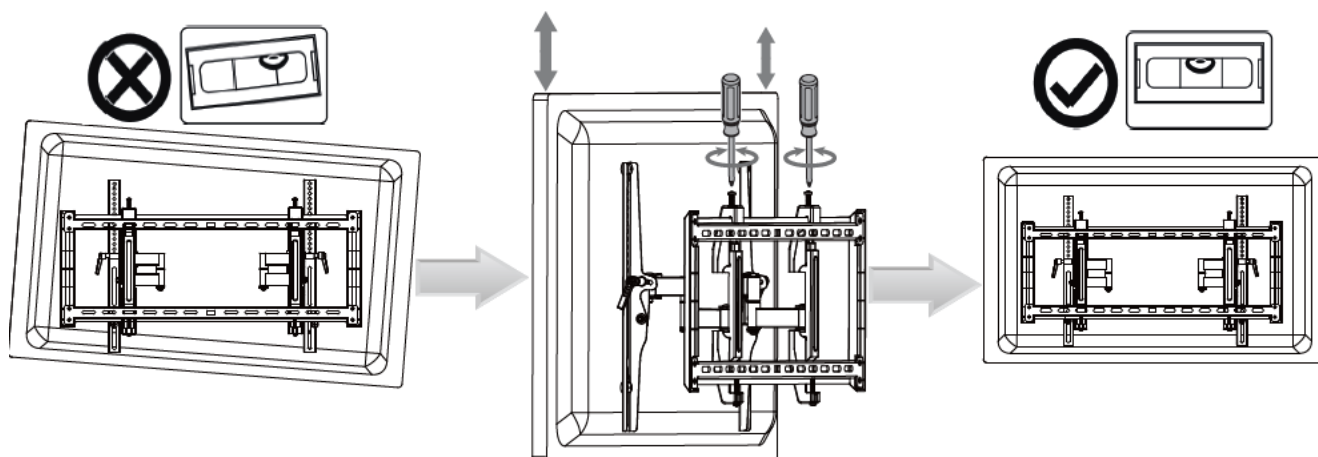

• **STEP 6- ATTACH PANEL TO WALL PLATE & ADJUST TILT ANGLE**

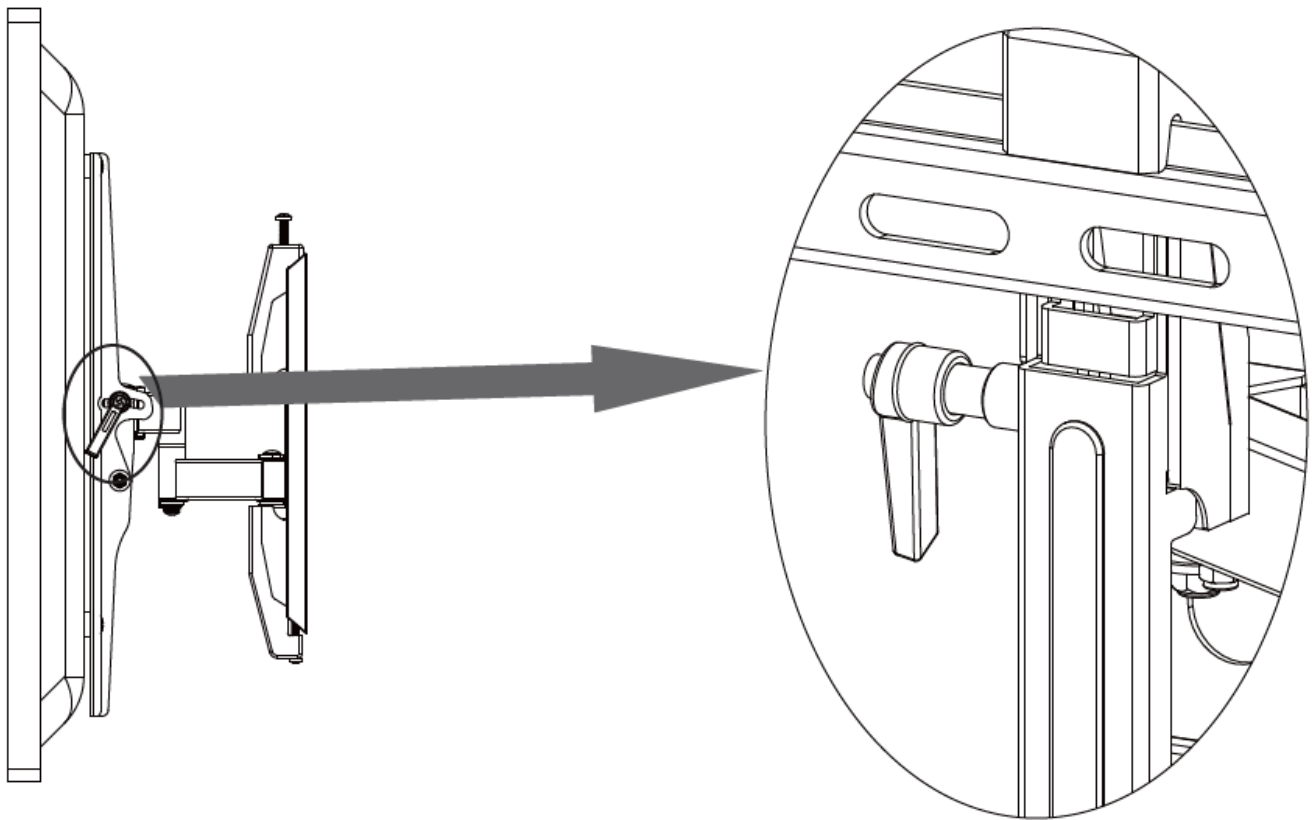

1. Rotate handle clockwise as far as possible.
2. Pull handle to side laterally (against spring tension) and rotate counter-clockwise
3. Repeat steps a) and b) until TV holds desired tilt.

**OPTIONAL- DUAL ARM CAN BE EXTENDED FROM 2" TO 8" IF NECESSARY**

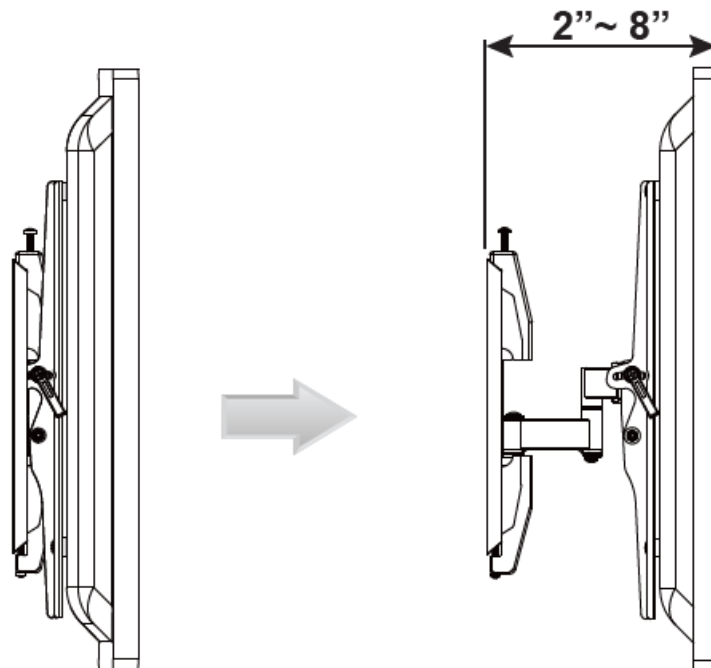

## WARRANTY INFORMATION

- This warranty applies to US Residents who purchase from an authorized RED ATOM Dealer. RED ATOM products are covered against defects in materials and workmanship for 5 years. RED ATOM will repair or

replace the defective component or product, at its sole discretion. Failure to follow product care instructions from RED ATOM will result in void of warranty.

- To obtain warranty service, contact RED ATOM customer service at [info@redatomproducts.com](mailto:info@redatomproducts.com) . You must supply a copy of your original receipt. If your product must be shipped to RED ATOM for inspection, you will be responsible for the shipping charges. Replacement product shipped to you will be returned freight pre-paid.
- RED ATOM disclaims any liability for modifications, improper installations, installations over the specified weight range, or failure to follow care instructions provided by RED ATOM. To the maximum extent permitted by law, RED ATOM disclaims any other warranties, expressed or implied, including warranties of fitness for a particular purpose and warranties of merchantability. RED ATOM will not be liable for any damages arising out of the use of, or inability to use, RED ATOM products.
- This warranty gives you specific legal rights, and you may also have other rights which vary from state to state.
- Specifications are subject to change without prior notice.

## NEED HELP?

[info@redatomproducts.com](mailto:info@redatomproducts.com)

---

## Documents / Resources

	<p><a href="#">REDATOM RED120FTE64 Large Fixed Tilt &amp; Extend TV Mount</a> [pdf] Instruction Manual RED120FTE64 Large Fixed Tilt Extend TV Mount, RED120FTE64, Large Fixed Tilt Extend TV Mount, Fixed Tilt Extend TV Mount, Tilt Extend TV Mount, Extend TV Mount, TV Mount, Mount</p>
---	--

## References

- [User Manual](#)

### Manuals+, Privacy Policy

This website is an independent publication and is neither affiliated with nor endorsed by any of the trademark owners. The "Bluetooth®" word mark and logos are registered trademarks owned by Bluetooth SIG, Inc. The "Wi-Fi®" word mark and logos are registered trademarks owned by the Wi-Fi Alliance. Any use of these marks on this website does not imply any affiliation with or endorsement.