

REDARC Setting A Pin Code To Lock Configurations Android User Guide

[Home](#) » [REDARC](#) » REDARC Setting A Pin Code To Lock Configurations Android User Guide 

Contents

1 REDARC Setting A Pin Code To Lock Configurations Android

2 CONFIGURATIONS – ANDROID

3 CONFIGURATIONS – ANDROID

4 Documents / Resources

5 Related Posts



REDARC Setting A Pin Code To Lock Configurations Android

Enter PIN

Tap Continue when finished.

....

CANCEL CONTINUE

1 2 ABC 3 DEF

4 GHI 5 JKL 6 MNO

7 PQRS 8 TUV 9 WXYZ

⌫ 0 Done

CONFIGURATIONS – ANDROID

In certain situations, it may be preferable to lock access to a RedVision configuration so that end users can't change the configuration (and therefore the functionality) of a RedVision system. This can be done at the time the configuration is created or it can be added at a later date. A PIN can be added to any configuration via the RedVision Configurator App.

Please note: If a PIN is added and uploaded to a RedVision system, the configuration cannot be modified at a later date unless the user of the Configurator App has the PIN for that configuration.

1. Open the App and tap "Saved Configurations".



2. Choose the configuration file that you want to add the PIN to... in this case "REDARC BT 50".

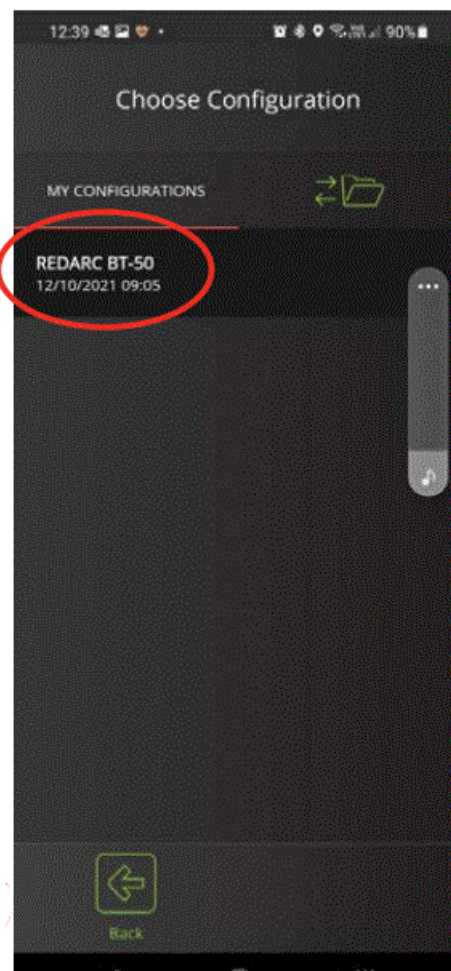

3. Tap the cog/spanner icon in the top right corner.

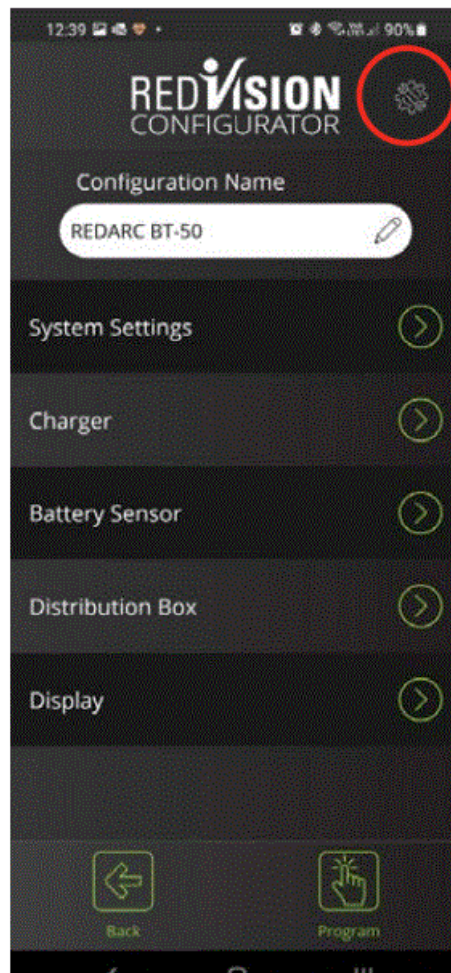

4. Tap “Add PIN”.

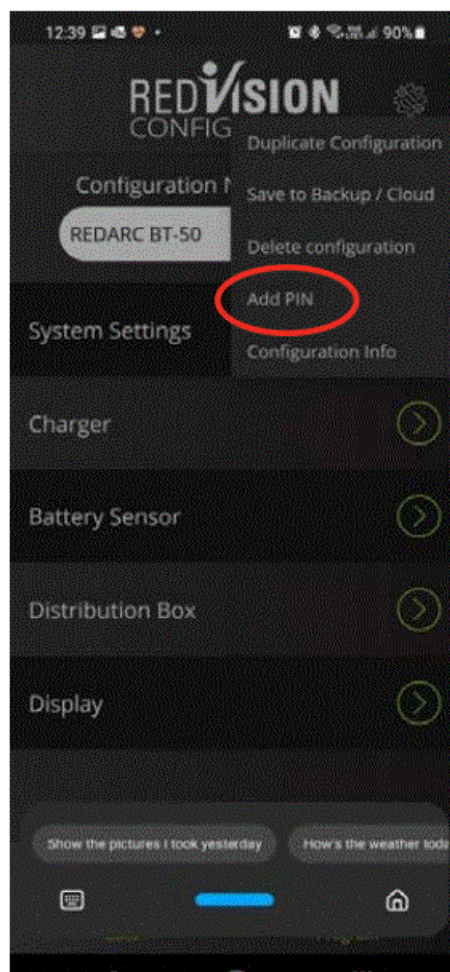

5. Enter your chosen PIN and confirm it.

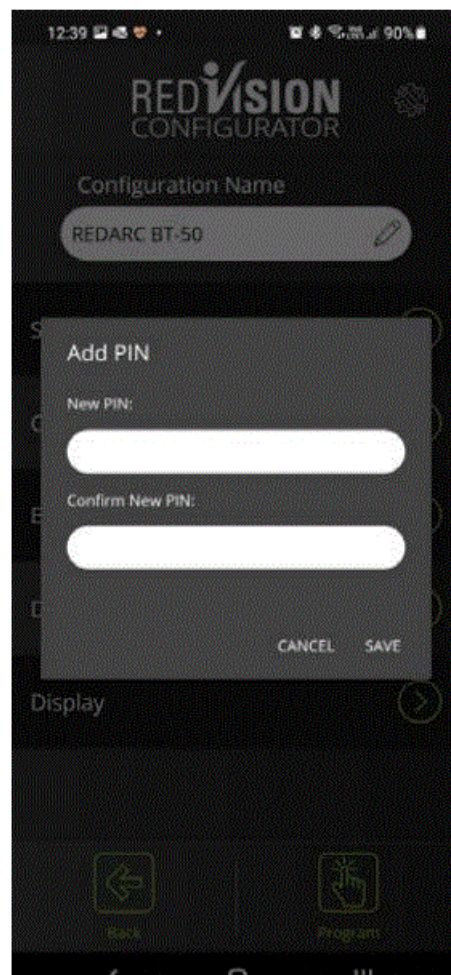

- Each set will have an open padlock beside it. Tap “Back” and reopen the configuration – the padlocks will now be closed.

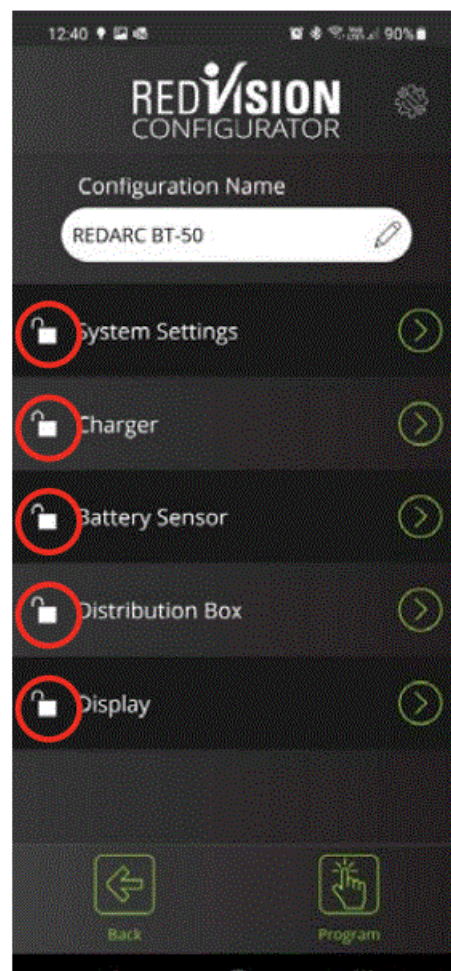

7. If you tap on any of them, a popup will appear allowing you to enter the pin and unlock the configuration.

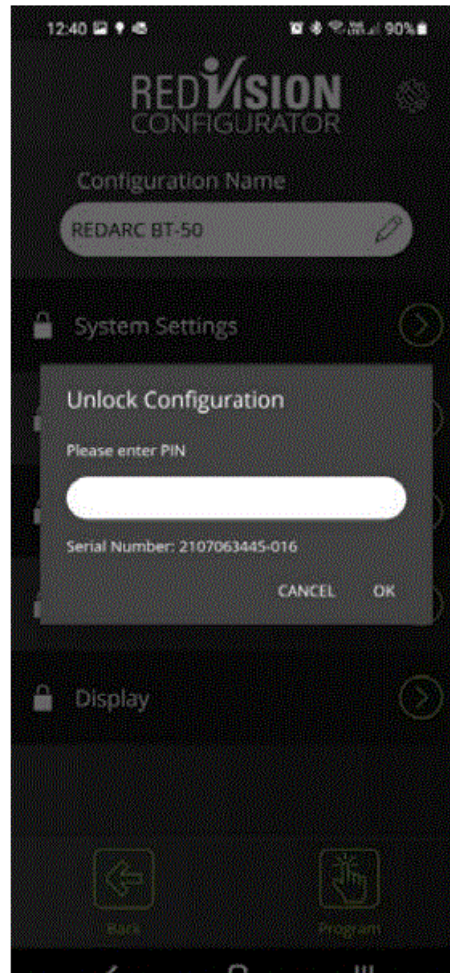

CONFIGURATIONS – ANDROID

In certain situations, it may be preferable to lock access to a RedVision configuration so that end users can't change the configuration (and therefore the functionality) of a RedVision system. This can be done at the time the configuration is created or it can be added at a later date. A PIN can be added to any configuration via the RedVision Configurator App.

Please note: If a PIN is added and uploaded to a RedVision system, the configuration cannot be modified at a later date unless the user of the Configurator App has the PIN for that configuration.

1. Open the App and tap "Open Configuration".



2. Choose the configuration file that you want to add the PIN to... in this case "REDARC BT 50".

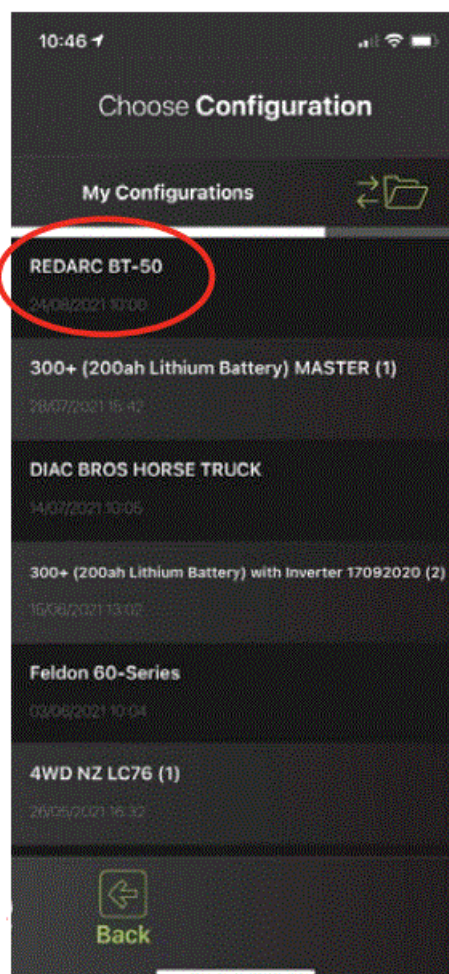

3. Tap the cog/spanner icon in the top right corner.

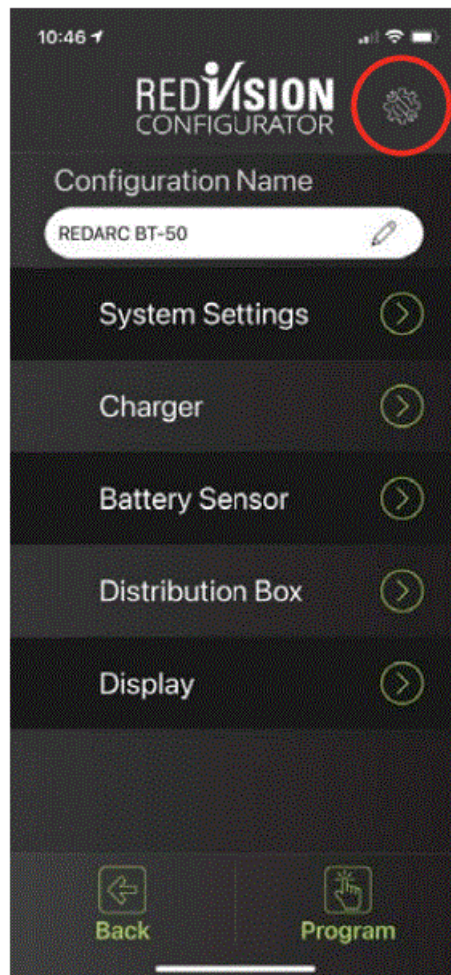

4. Tap "Add Installer Pin".

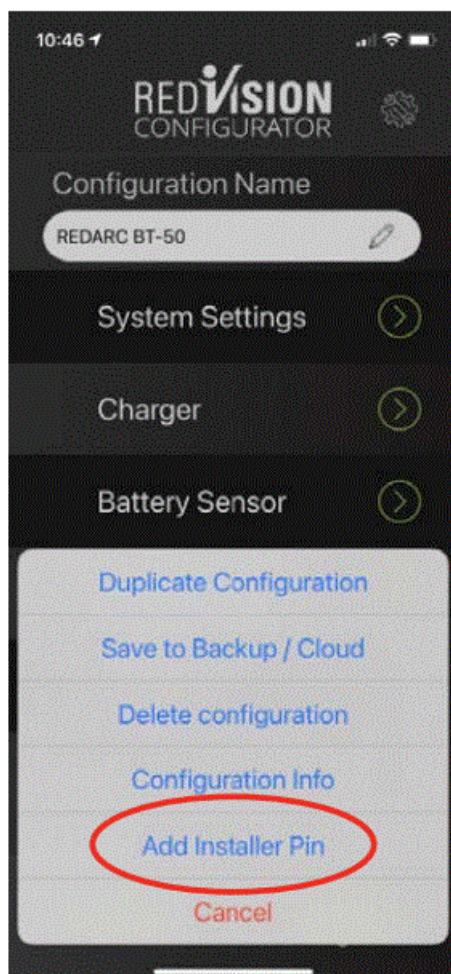

5. .Enter your chosen PIN and confirm it.

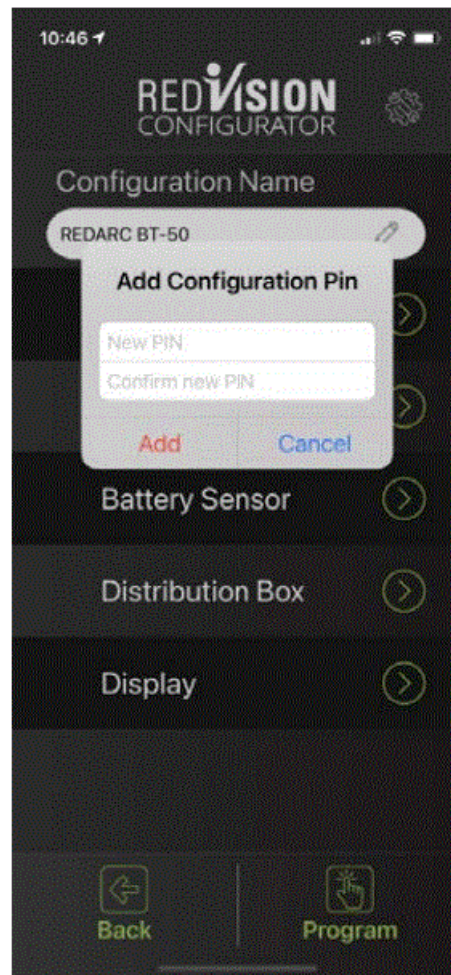

6. You can now see that each setting has a padlock icon beside it.

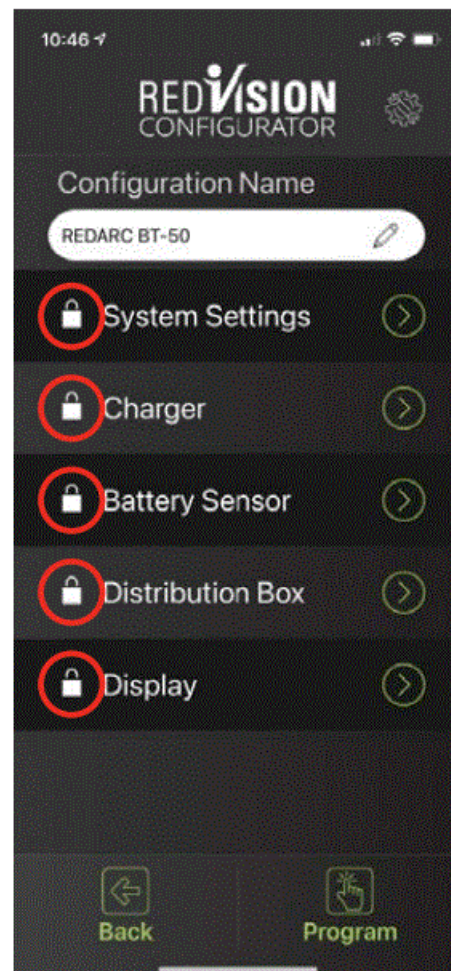

7. .If you tap on any of them, a popup will appear allowing you to enter the pin and unlock the configuration.

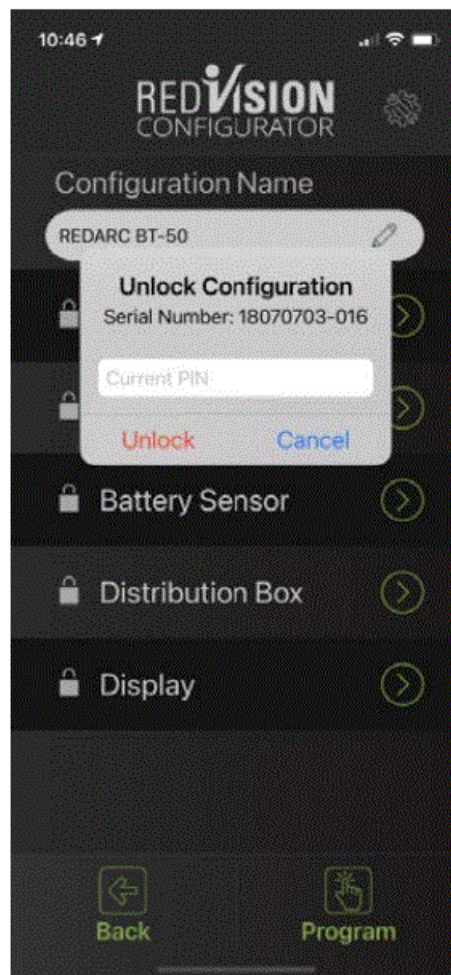

Documents / Resources

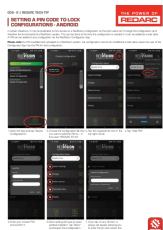
	<p>REDARC Setting A Pin Code To Lock Configurations Android [pdf] User Guide Setting A Pin Code To Lock Configurations Android</p>
---	--