



RED LION RL-WCS50TA Automatic Sewage System Owner's Manual

[Home](#) » [RED LION](#) » RED LION RL-WCS50TA Automatic Sewage System Owner's Manual 

RED LION RL-WCS50TA Automatic Sewage System



Contents

- [1 IMPORTANT INFORMATION](#)
- [2 SAFETY INSTRUCTIONS](#)
- [3 INSTALLATION](#)
- [4 REPLACEMENT PARTS](#)
- [5 Customer Support](#)
- [6 Documents / Resources](#)
 - [6.1 References](#)
- [7 Related Posts](#)

IMPORTANT INFORMATION

The RL-WCSS0TA Sewage Basin System is ideal for the collection and removal of sewage, effluent, drainage, or seepage water from low lying areas.

This product is covered by a Limited Warranty for a period of 2 years from the date of original purchase by the consumer. For complete warranty information, refer to redlionproducts.com.

SAFETY INSTRUCTIONS

This equipment should be installed and serviced by technically qualified personnel who are familiar with the

correct selection and use of appropriate tools, equipment, and procedures. Failure to comply with national and local electrical and plumbing codes and within Red Lion recommendations may result in electrical shock or fire hazard, unsatisfactory performance, or equipment failure.

Know the product's application, limitations, and potential hazards. Read and follow these instructions and those provided with the pump carefully to avoid injury and property damage. Do not disassemble or repair unit unless described in this manual.

Failure to follow installation or operation procedures and all applicable codes may result in the following hazards:



WARNING



Risk of severe injury or death by electrical shock.

- Check local electrical and building codes before installation. The installation must be in accordance with their regulations as well as the most recent National Electrical Code (NEC) and the Occupational Safety and Health Act (OSHA) .



CAUTION



Risk of bodily injury, electric shock, or equipment damage.

- This equipment must not be used by children or persons with reduced physical, sensory or mental abilities, or lacking in experience and expertise, unless supervised or instructed. Children may not use the equipment, nor may they play with the unit or in the immediate vicinity.
- Operation of this equipment requires the detailed installation and operating instructions provided in this manual and the pump manual. Read entirety of all manuals before starting installation and operation. End User should receive and retain all manuals for future use.
- Keep safety labels clean and in good condition.
- Keep work area clean, well-lit, and uncluttered.
- Wear safety glasses while installing or performing maintenance on the pump.

INSTALLATION

The cover has three prefabricated holes, one to fit the 2-hole cord grommet, one to fit the 2-inch flange, and one to fit the 3-inch flange or 3 to 2-inch reducer flange.

1. Remove bolts and washers in cover and set aside.
2. Place the gasket tape around circumference of basin inside of bolt circle.
3. Install the pump in the basin.

4. Connect the discharge piping.

- Install the check valve horizontally or at an angle less than 45°.

5. Install a float switch 4 in. (10.2 cm) above discharge of pump with a 3.5-in. (8.9 cm) tether length.

IMPORTANT: Do not let float switch contact pump, plumbing, or side of basin during operation.

- Refer to float switch instruction manual to verify the ON/OFF levels are within specification.

6. Lubricate the Adaptaflex flanges and the pipes with petroleum jelly or liquid dish soap.

7. Install the Adaptaflex flange that fits the discharge on the underside of the cover.

- Route the power cord and float switch cord through the smallest hole in the cover.
- Slide the cover over the discharge pipe.

8. Place the power cord and float switch cord in the grommet openings.

- Push the grommet into that hole.

9. Install an Adaptaflex flange in the hole that corresponds to the vent pipe.

- Press the pipe into the flange 2 to 3 inches.

10. Install the 4-inch Adaptaflex flange onto the intake pipe.

- Press the pipe into the flange 2 to 3 inches.

11. Install bolts and washers in cover.

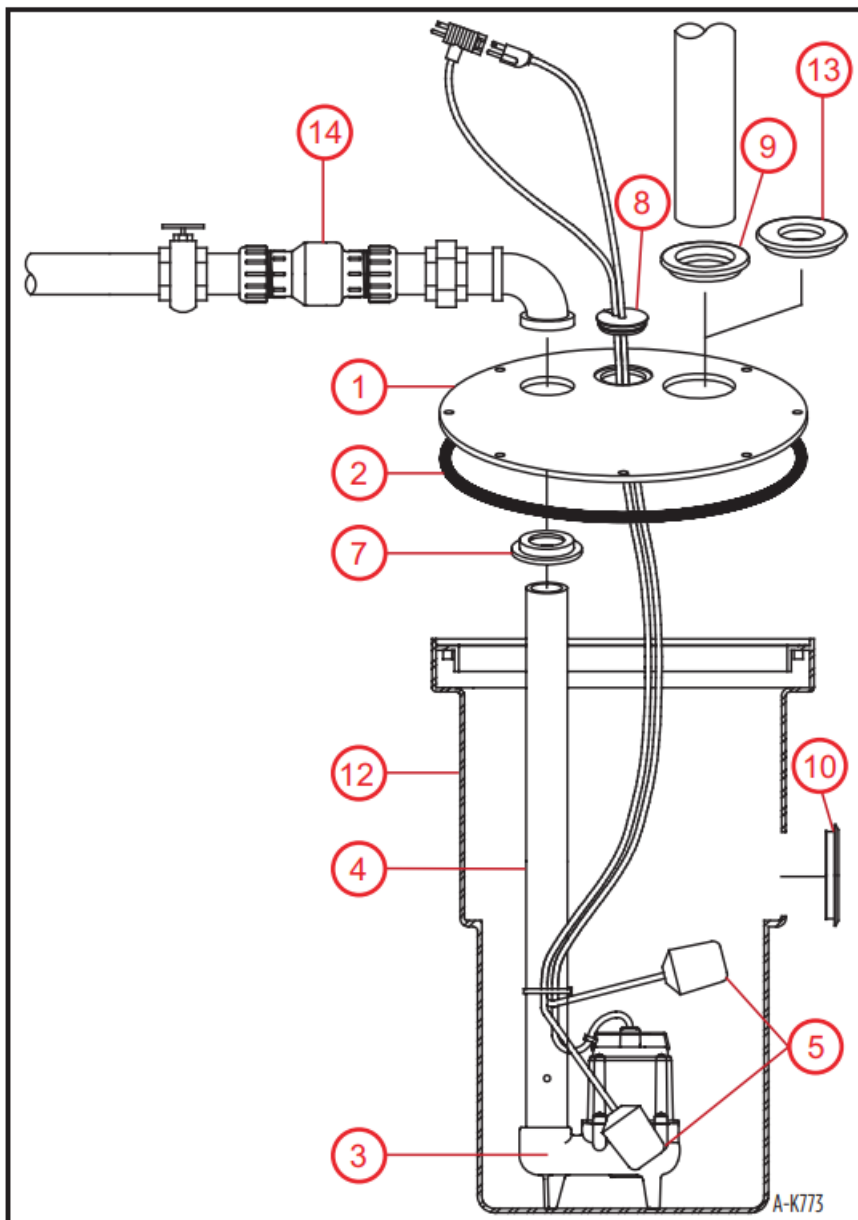

REPLACEMENT PARTS

Item	Description	Part Number
1	Cover	113057
1, 7, 8, 9, 10, 13	Cover Assembly	113058
4	Pipe, Discharge 2 inches (PVC)	113423
7	Flange, 2-inch Pipe	113340
8	Grommet, 2-hole	925020
9	Flange, 3-inch Pipe	113341
10	Flange, Adaptaflex, 4-inch Pipe (for PVC intake)	113417
12	Basin, 18 x 30 inches (457 x 762 mm)	507707
13	Flange, Reducer, 3 to 2 inches	113418
14	Check Valve, 2 inches	940022

Customer Support

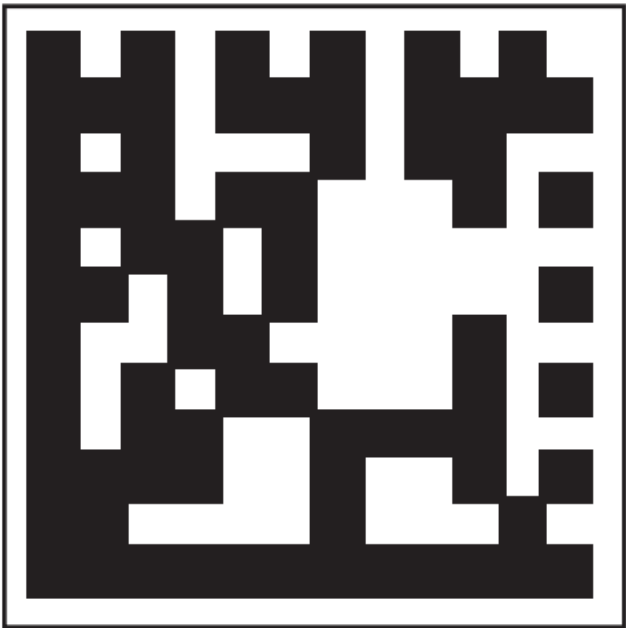

For technical assistance, parts, or repair, please contact:

888.885.9254 | redlionproducts.com



Documents / Resources

	<p>RED LION RL-WCS50TA Automatic Sewage System [pdf] Owner's Manual 14942749, RL-WCS50TA Automatic Sewage System, Automatic Sewage System, Sewage Sys tem</p>
--	---

References

- [User Manual](#)