



RED DEVIL RX 7000 Series AMD Radeon Graphics Card Installation Guide

[Home](#) » [RED DEVIL](#) » RED DEVIL RX 7000 Series AMD Radeon Graphics Card Installation Guide 

Contents

- [1 RED DEVIL RX 7000 Series AMD Radeon Graphics Card](#)
- [2 QR CODE](#)
- [3 System Requirements](#)
- [4 Hardware Installation](#)
- [5 Driver Installation](#)
- [6 Addressable RGB \(ARGB\) LED Cable Connection](#)
- [7 Graphics Card Holder Installation Guide](#)
- [8 Documents / Resources](#)
 - [8.1 References](#)
- [9 Related Posts](#)



RED DEVIL RX 7000 Series AMD Radeon Graphics Card



QR CODE



System Requirements

1. **Expansion Slot:** Motherboard with one or more PCI Express x16 slot.
2. **Display:** Monitor or other display device with compatible connectivity to the output interface of your graphics card.
3. **Power requirement:** Power Consumption differs by model.
(For additional support details, please refer to: www.powercolor.com/ to calculate your minimum system power requirement.)
4. **Operation System:** Linux®/Windows® 10/ Windows® 11 (For additional support details, please refer to: <https://www.amd.com/en/support>)

Hardware Installation

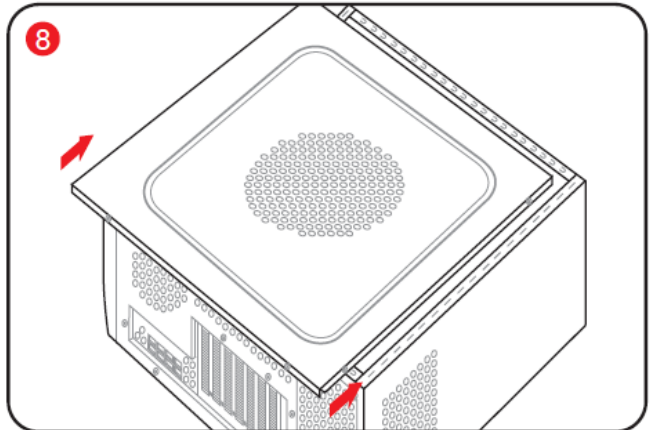
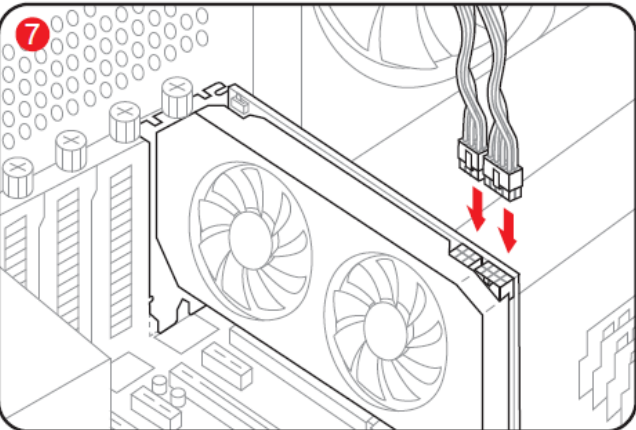
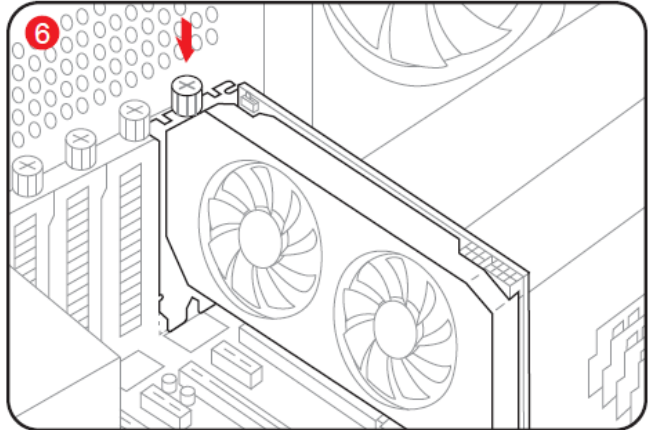
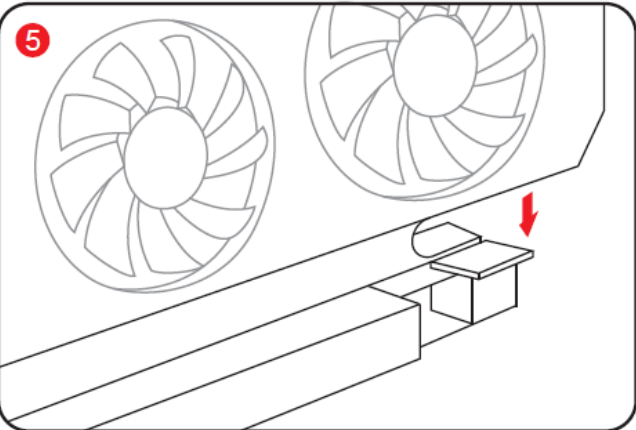
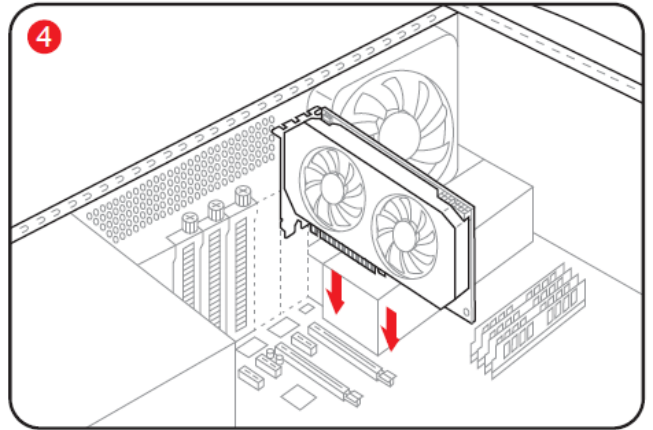
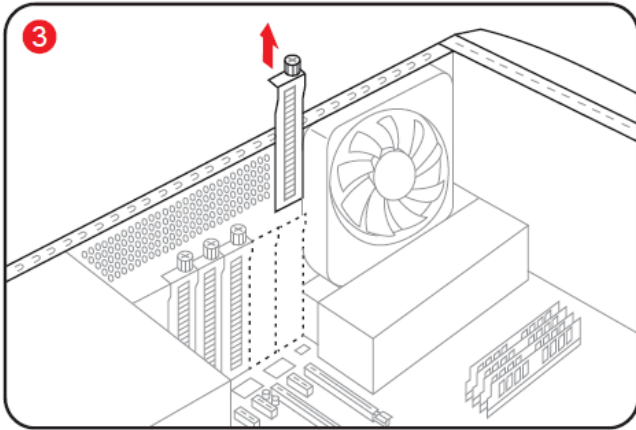
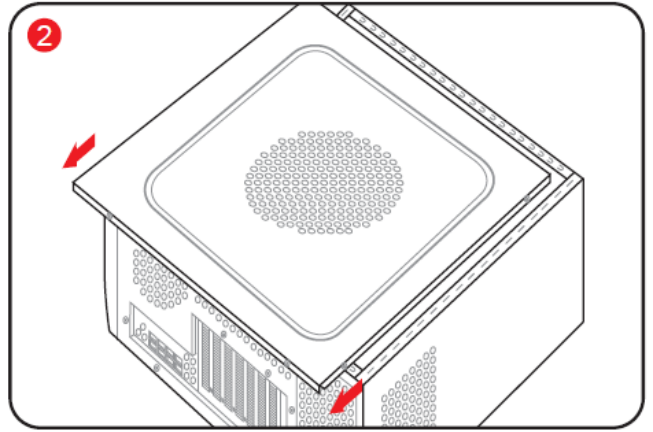
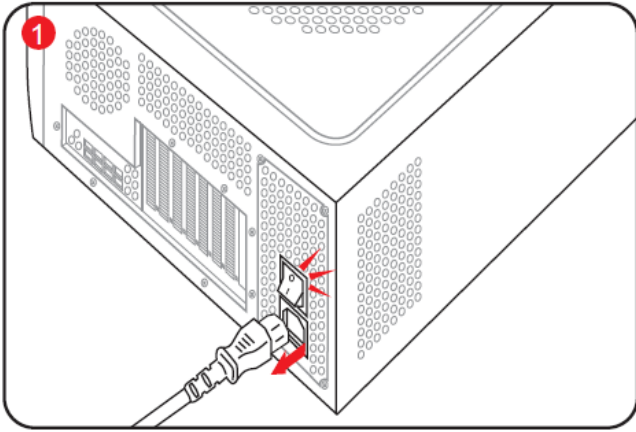

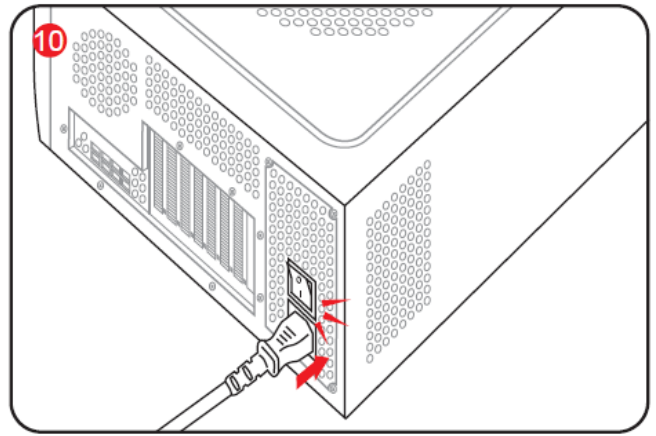
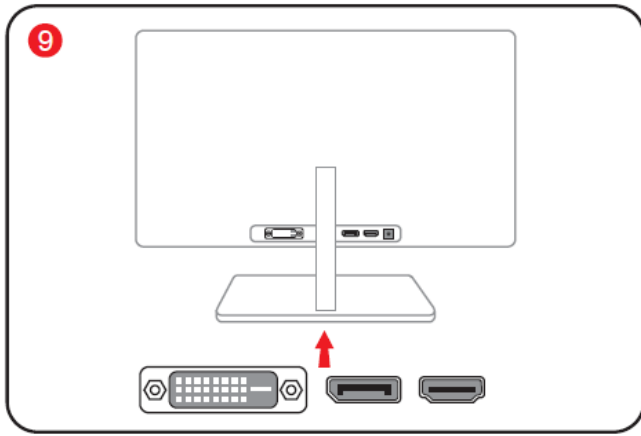

1. Turn off computer, switch off the PSU, and disconnect the power cord.
2. Open the case.
3. Remove any existing graphics card (if applicable) or PCIE slot covers.
4. Insert the Graphics Card into the PCIE slot.
5. Make sure seating is secured with the PCIE locking mechanism in place.
6. Secure graphics card to the PCIE bracket with thumbscrew.
7. Plug in the required external PCIE power connectors (if applicable) from the appropriate PC Power Supply Unit.
8. Close the case.
9. Connect the display cable into the corresponding GPU display output port.
10. Power on System, booting to OS. (Removing all drivers for your previous card and performing a clean install of the new drivers is recommended.)

Driver Installation

1. Please download the driver.
2. Install the driver based on your product.
3. Execute the driver and follow the instruction

Driver Installation Link

- Driver for PowerColor <https://www.powercolor.com/downloads>
- Driver and Support for AMD <https://www.amd.com/en/support>

Additional Support (Optional)

If the graphics card has multiple BIOS switches, you can switch to your personal preference.

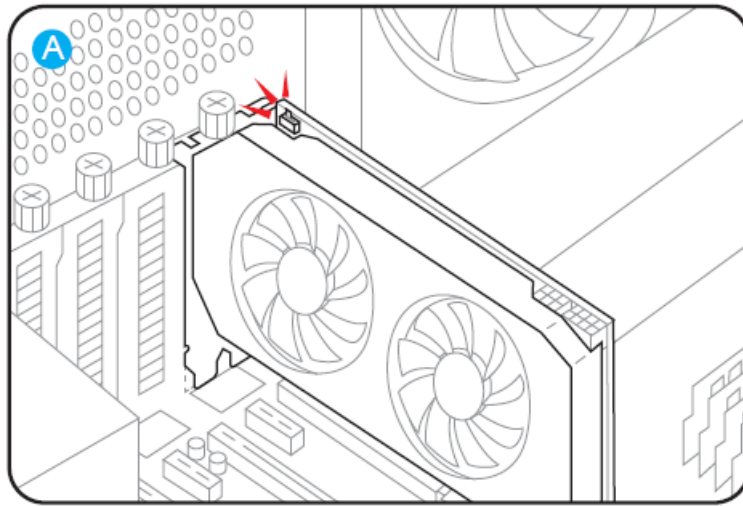

1. Confirm that the computer is powered off and switch the BIOS you want.
2. Reboot your PC. (For additional support details, please refer to: <https://www.powercolor.com/> for specific model support)

LED Software Support (Optional)

For graphics card with RGB functions, the Devil Zone RGB Software will enable color customizations. (For additional support details, please refer to:

<https://www.powercolor.com/downloads> for specific model features)

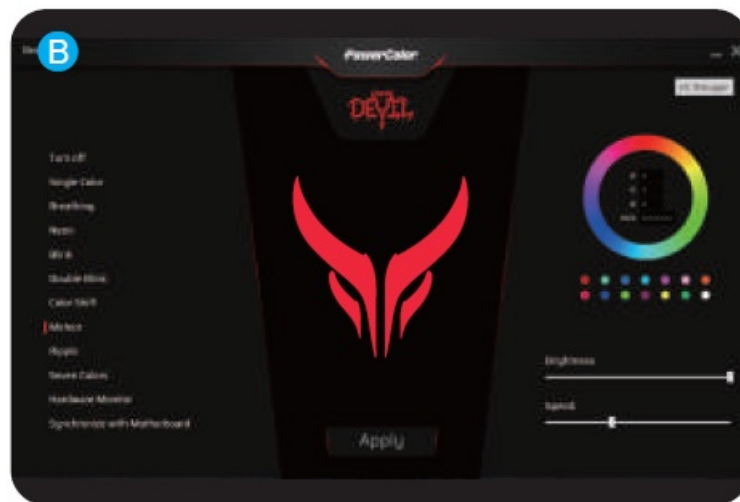

Devil Club (Optional)

Join our DevilClub! If you bought a Red Devil card, you will find invitation code inside the retail box. Join at:

<https://devilclub.powercolor.com/>

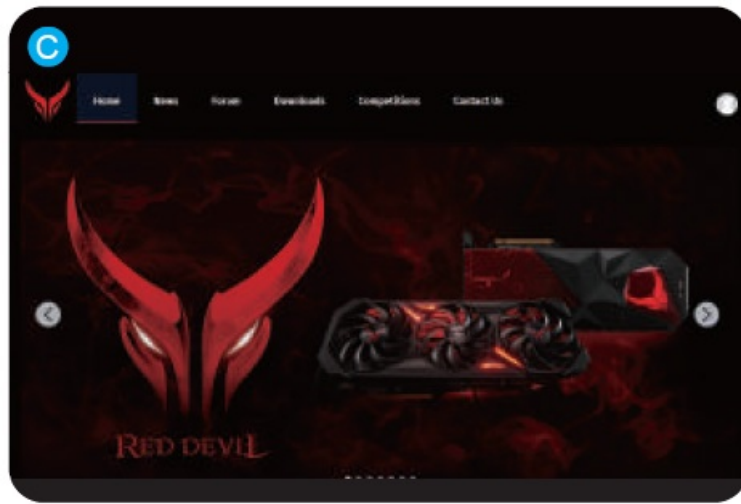

AMD Radeon Setting Software Installation

To take full advantage of the features and capabilities of your Radeon Graphics products, installing the most up-to-date Radeon Software is recommended.

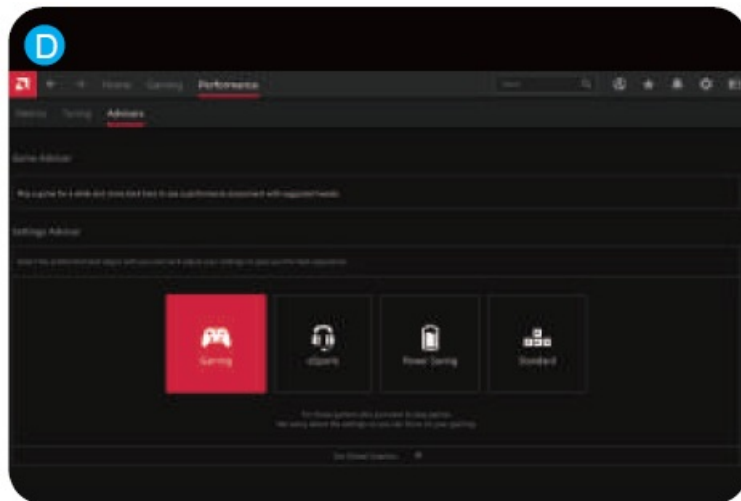

(For more support, visit: <https://www.amd.com/en/support/driverhelp>)

Please make sure you choose “Full Install” when installing the driver to enjoy full function of the software.

Addressable RGB (ARGB) LED Cable Connection

- Connect the ARGB LED cable to the ARGB LED Headers between PowerColor graphics card and your motherboard, the PowerColor LED light can be controlled by PowerColor Devil Zone software or synchronized via motherboard software.
- The factory default setting is controlled by PowerColor Devil Zone, if you want to sync with motherboard software, please disable GPU control on Devil Zone.
- You can also connect another ARGB device to the male connector for syncing with motherboard ARGB control.

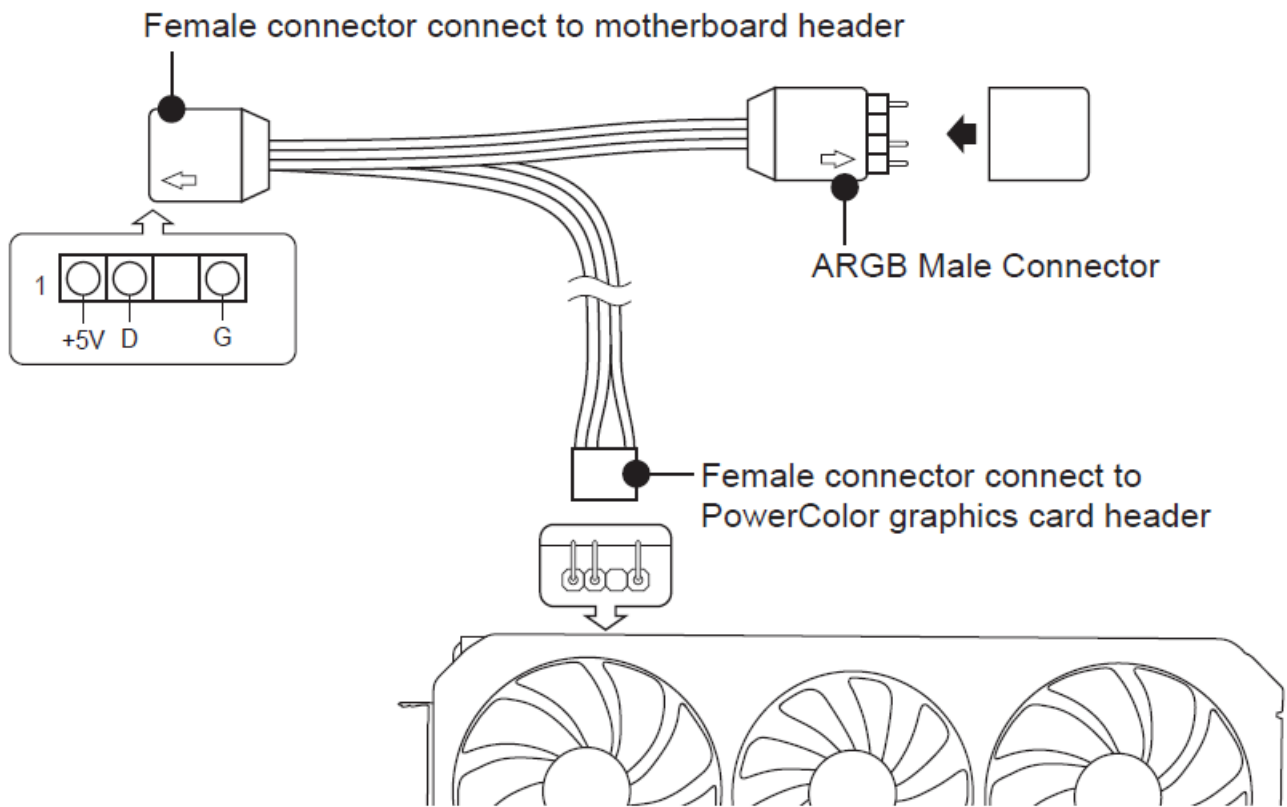

The ARGB LED Header supports ARGB LED cable, with a maximum power rating of 3A (5V) and total length within 2 meters.

Notices:

- Do not install an RGB LED cable in the ARGB LED Header; otherwise the hardware and cable may be damaged.
- Only use the ARGB LED cable to connect on both motherboard and PowerColor graphics card.
- PowerColor graphics card is compatible with motherboards which have headers for ARGB LED cables. The headers should have the 3-pin configuration. For further information concerning compatibility, refer to the manual of your mainboard, or visit the manufacturer's website.
- To avoid damaging any hardware, please make sure the system is turned off and the power cord is unplugged before connecting or removing the ARGB LED cable

Graphics Card Holder Installation Guide

Contents

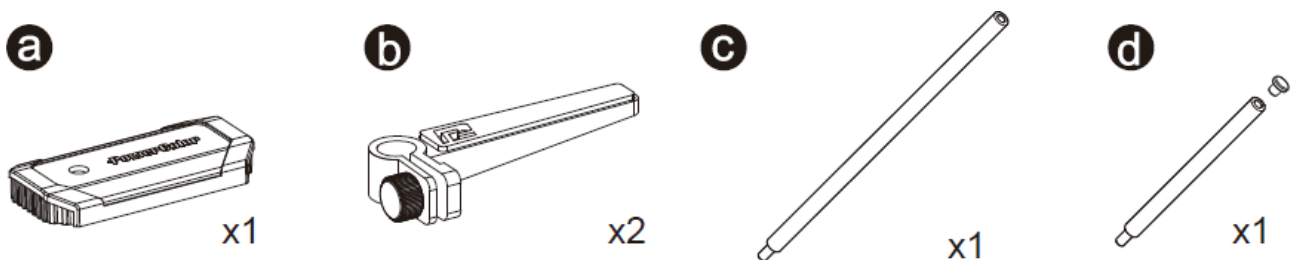

Instructions

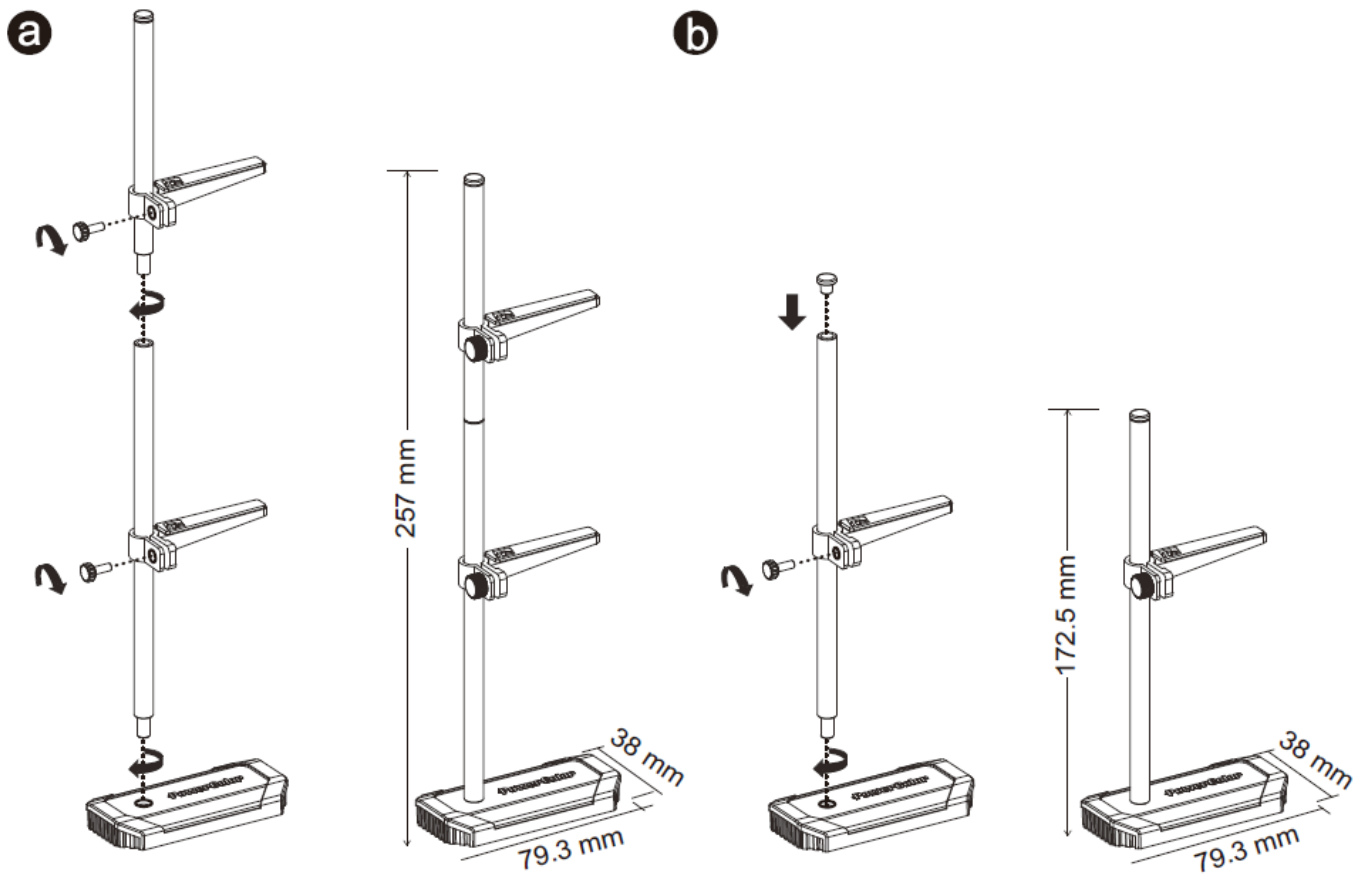



















Documents / Resources

	<p>RED DEVIL RX 7000 Series AMD Radeon Graphics Card [pdf] Installation Guide RX 7000 Series AMD Radeon Graphics Card, RX 7000 Series, AMD Radeon Graphics Card, R adeon Graphics Card, Graphics Card</p>
---	---

References

- [AMD Drivers and Support | AMD](#)
- [Login – PowerColor DevilClub](#)
- [AMD ■■■■ ■■■■ | AMD](#)
- [AMD ■■■■ ■■■■ | AMD](#)
- [PowerColor](#)
- [PowerColor](#)
- [Login – PowerColor DevilClub](#)
- [Login – PowerColor DevilClub](#)
- [AMD | together we advance_](#)
- [AMD Treiber und Support | AMD](#)
- [AMD Software Hilfecenter | AMD](#)
- [AMD | together we advance_](#)
- [AMD Drivers and Support | AMD](#)

-  [AMD Software Help Center | AMD](#)
-  [Controladores de AMD y compatibilidad | AMD](#)
-  [Centro de ayuda de AMD Software | AMD](#)
-  [AMD | AMD](#)
-  [AMD | AMD](#)
-  [AMD Software | AMD](#)
-  [AMD | together we advance](#)
-  [Drivers e suporte da AMD | AMD](#)
-  [Central de ajuda de software AMD | AMD](#)
-  [AMD Drivers and Support | AMD](#)
-  [AMD Software Help Center | AMD](#)
-  [AMD | AMD](#)
-  [AMD | AMD](#)
-  [PowerColor](#)
-  [PowerColor](#)
-  [PowerColor](#)
-  [PowerColor](#)
-  [PowerColor](#)
-  [PowerColor](#)