



Rebel URZ1226-3 Power Socket with Remote Control User Manual

[Home](#) » [Rebel](#) » Rebel URZ1226-3 Power Socket with Remote Control User Manual 

Contents

- [1 Rebel URZ1226-3 Power Socket with Remote Control](#)
- [2 SAFETY INSTRUCTIONS](#)
- [3 PRODUCT DESCRIPTION](#)
- [4 OPERATION](#)
 - [4.1 CLEANING AND MAINTENANCE](#)
- [5 SPECIFICATION](#)
- [6 Documents / Resources](#)
 - [6.1 References](#)
- [7 Related Posts](#)



Rebel URZ1226-3 Power Socket with Remote Control



SAFETY INSTRUCTIONS

Please read this operation instruction carefully before use, and keep it for future reference.

- Protect this product from moisture. Avoid using/storing it in extreme temperatures and high humidity. Do not expose it to direct sunlight and other sources of heat.
- The device is intended for indoor use only.
- Keep the device out of the reach of children.
- Disconnect from power outlet if the device is not going to be used for a long time.
- Use only authorized accessories.
- Do not attempt to repair this device yourself. In case of damage, contact authorized service point for check-up or repair.
- Always disconnect the product from the power outlet before cleaning.
- Clean the device with a soft, dry cloth. Do not use any chemical agents to clean this device.
- Devices range may be decreased, if placed near other electronic devices. Do not plug to the socket appliances with current higher than 4,35 A (about 1000 W).
- To work correctly, the device needs proper ventilation.

This product contains a coin / button cell battery. If the coin / button cell battery is swallowed, it can cause severe internal burns in just 2 hours and can lead to death.

- Keep new and used batteries away from children.
- If the battery compartment does not close securely, stop using the product and keep it away from children.
- If you think batteries might have been swallowed or placed inside any part of the body, seek immediate medical attention.
- Risk of fire or explosion if the battery is replaced by an incorrect type.

PRODUCT DESCRIPTION

1. Socket
2. Function indicator
3. Two-pin earthed socket
4. Remote control
5. Activity indicator
6. ON/OFF buttons

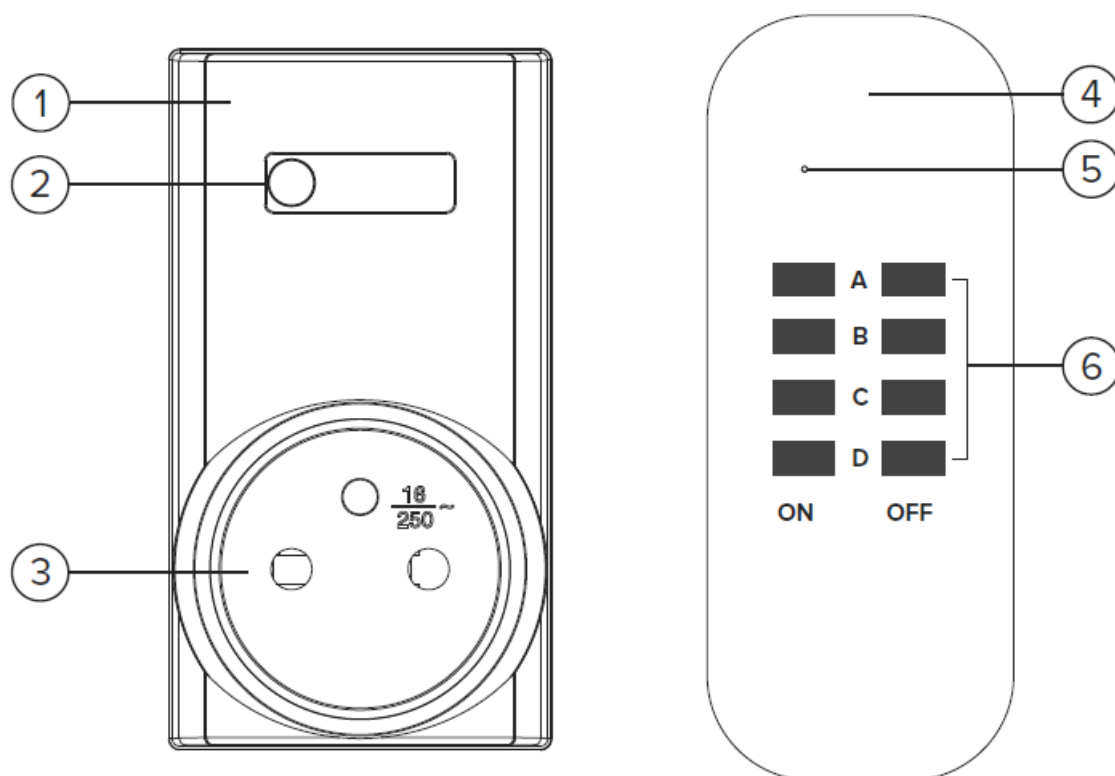

PAIRING REMOTE CONTROL WITH SOCKET SWITCH

Before using the device for the first time, you need to pair the appropriate row of buttons on the remote control with the switch socket. To do this:

- Insert the plug of the socket into the power socket; the red indicator light will flash on the device, which means it is ready for pairing
- on the remote control, press the button from the ON column of any row (A, B, C or D)
- correct pairing will turn on the continuous light of the indicator on the socket

To pair more sockets with the remote control, repeat the procedure using the ON button in a row other than the one currently occupied. To unpair an outlet:

- remove them from the main outlet and plug them back in – pairing mode will start.
- then press the OFF button on the remote control in the row corresponding to the pairing letter you want to delete
- the socket will go back to the pairing mode

OPERATION

1. Connect socket switch to the power supply socket.
2. Connect external device to the socket switch.
3. Press the ON button on the remote control to turn on the corresponding socket accordingly.
4. Press the OFF button on the remote control to turn off the corresponding socket.

CLEANING AND MAINTENANCE

Caution! Risk of electric shock.

1. Prior to cleaning, disconnect the device from power mains socket.
2. Make sure that no liquid gets into the device. The liquid inside the device may lead to a short circuit.
3. Do not use any abrasives or chemical agents to clean this device.
4. Clean the device with a soft, slightly damp cloth.
5. Make sure the device is completely dry before next use.
6. Check battery level regularly..

SPECIFICATION

- Maximum power: 1000 W
- Remote control range: up to 25 m
- Remote control frequency: 433,92 MHz
- Battery: 1x CR2032 3 V
- Power supply: 230 V AC / 50 Hz
- In set: Remote control with batteries, Three switches

LEARN MORE

For more information on this device visit: www.rebelelectro.com.

Read owner's manual carefully before using your device.

Visit www.rebelelectro.com website for more products and accessories.

Lechpol Electronics Leszek Sp.k. hereby declares that Power socket with remote control URZ1226-3 is consistent with directive 2014/53/UE.

Full text of the EU Declaration of Conformity is available at following Internet address: www.lechpol.pl.

Correct Disposal of This Product (Waste Electrical & Electronic Equipment)

(Applicable in the European Union and other European countries with separate collection systems) This marking shown on the product or its literature, indicates that it should not be disposed with other household wastes at the end of its working life. To prevent possible harm to the environment or human health from uncontrolled waste disposal, please separate this from other types of wastes and recycle it responsibly to promote the sustainable reuse of material resources. Household users should contact either the retailer where they purchased this product, or their local government office, for details of where and how they can take this item for environmentally safe recycling. Business users should contact their supplier and check the terms and conditions of the purchase contract. This product should not be mixed with other commercial wastes for disposal.

Made in China for Lechpol Electronics Leszek Sp.k., ul. Garwolińska 1, 08-400 Miętne.

Documents / Resources

 <p>POWER Power socket x3 with remote control</p> <p>USER MANUAL URZ1226-3</p>	<p>Rebel URZ1226-3 Power Socket with Remote Control [pdf] User Manual</p> <p>URZ1226-3, Power Socket with Remote Control, Power Socket, Socket with Remote Control, Socket, URZ1226-3 Socket</p>
--	--

References

- [Lechpol Electronics Leszek - producent i dystrybutor produktów elektronicznych!](#)
- [Rebel Electro - Co weekend SuperOkazje](#)