

REAL AVID AVMSP Master Sight Pusher User Manual

[Home](#) » [REAL AVID](#) » REAL AVID AVMSP Master Sight Pusher User Manual 

REAL AVID AVMSP Master Sight Pusher

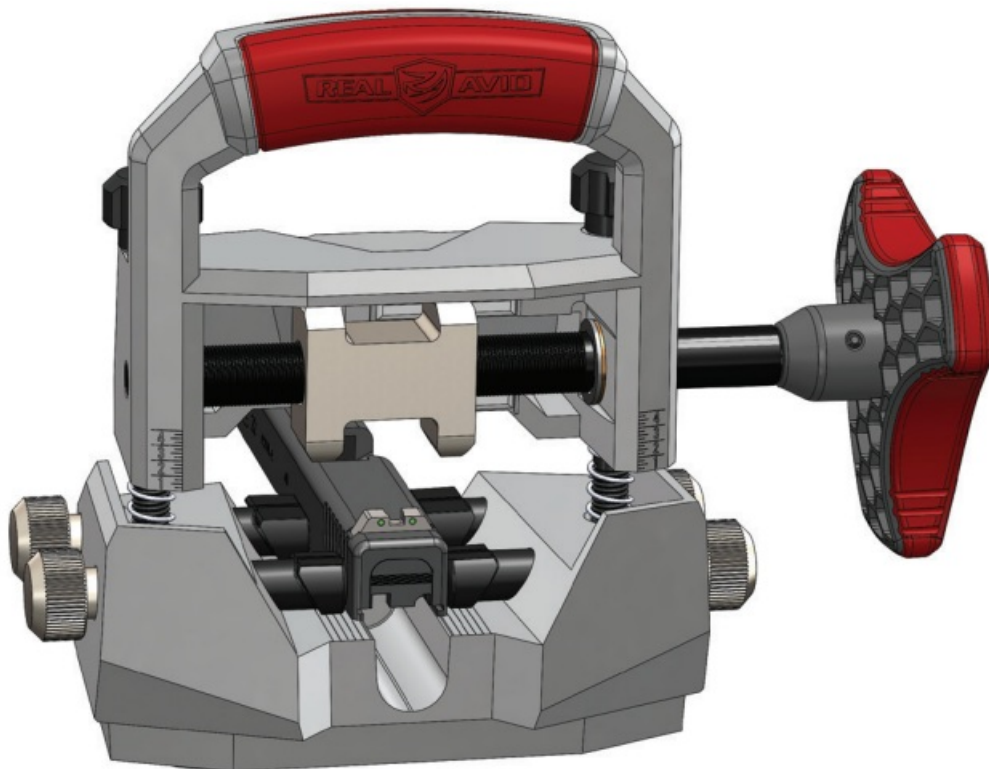

Contents

- [1 INSTRUCTIONS OVERVIEW](#)
- [2 Minimum Height – 18mm/.709" Minimum Width – 23mm/.906"](#)
- [3 SPARE SLIDE CLAMPS AND ADAPTER PLATES](#)
- [4 BEFORE YOU GET STARTED](#)
- [5 CARE & MAINTENANCE](#)
- [6 Documents / Resources](#)
 - [6.1 References](#)
- [7 Related Posts](#)

INSTRUCTIONS OVERVIEW

- Select applicable Reversible Press Block face and return block to center of push rod.

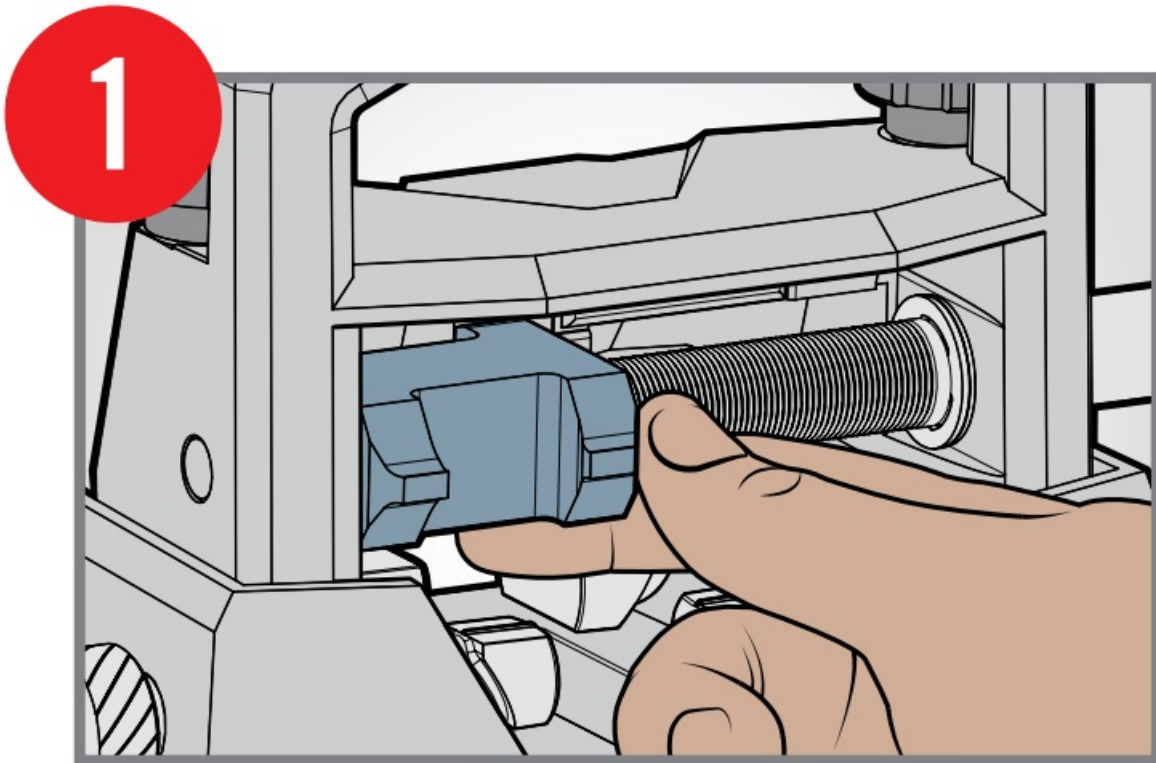

- Align clamp guidelines with center of dovetail slot and secure slide in cradle.

2

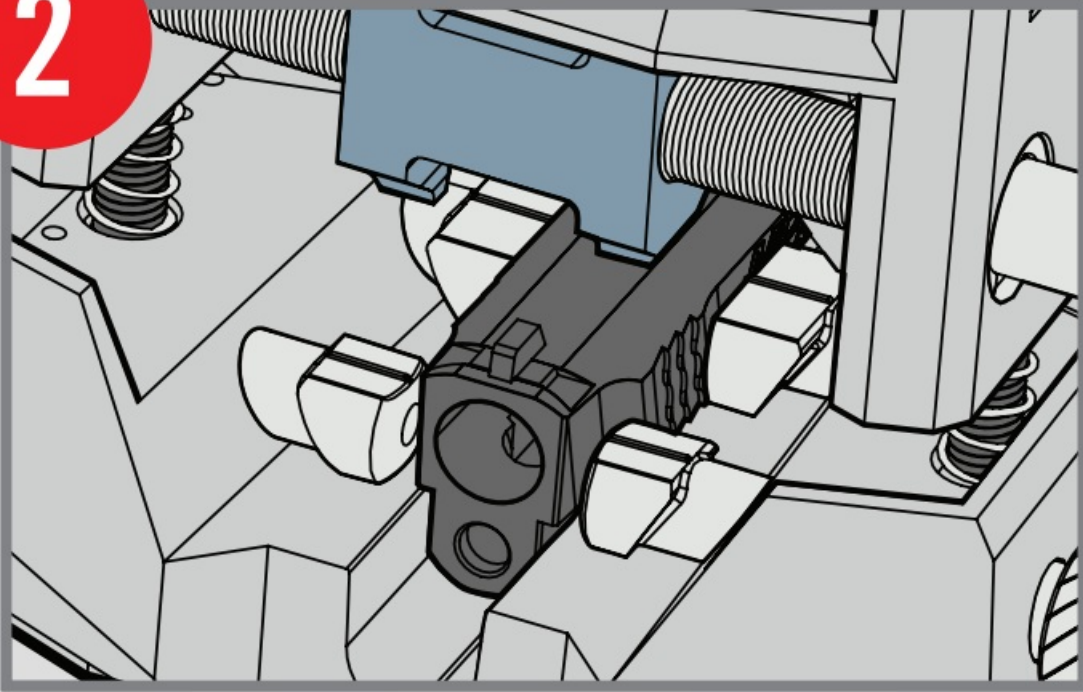

- Lower Reversible Press Block to the appropriate height

3

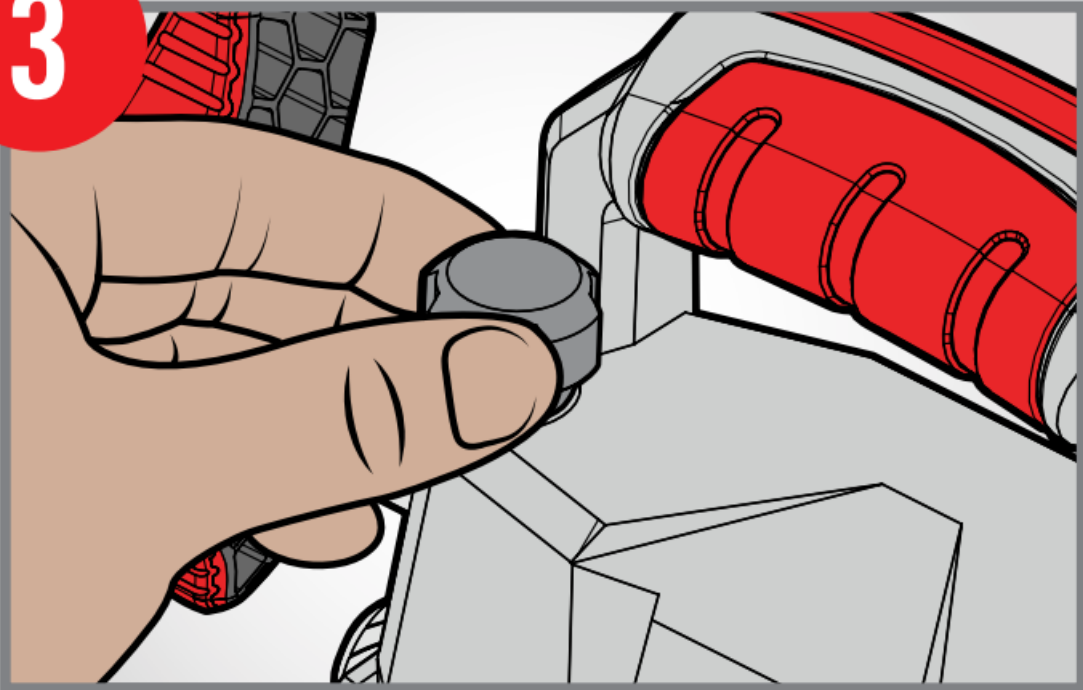

- Snugly tighten vertical stabilizer to hold pistol slide in place.

4

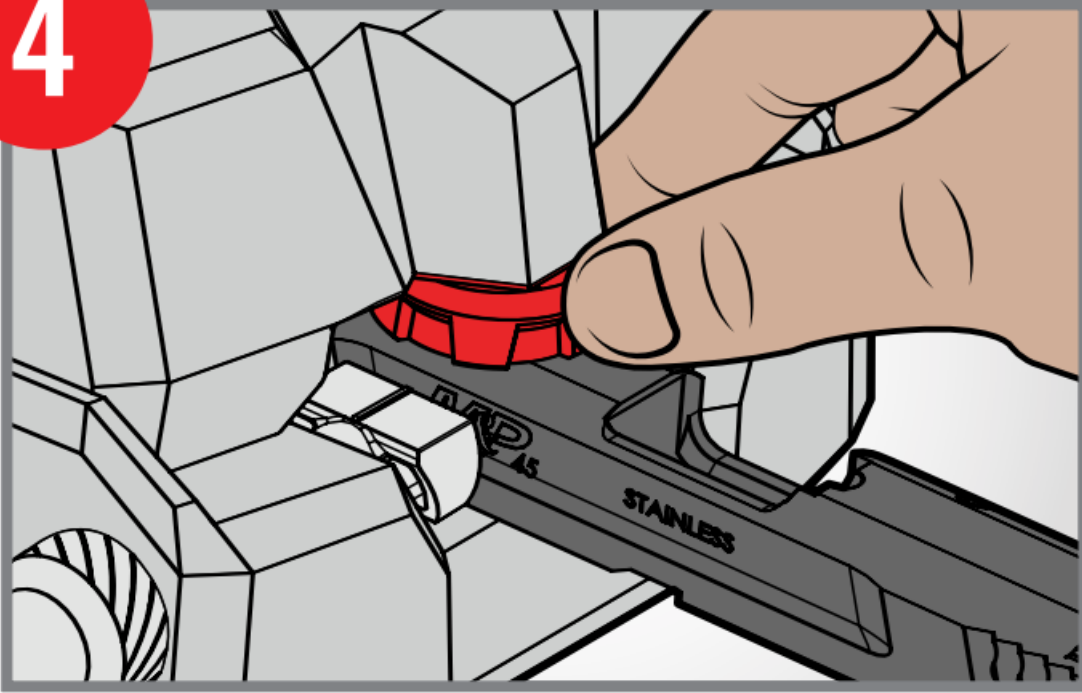

- Confirm alignment with Reversible Press Block and sight.

5

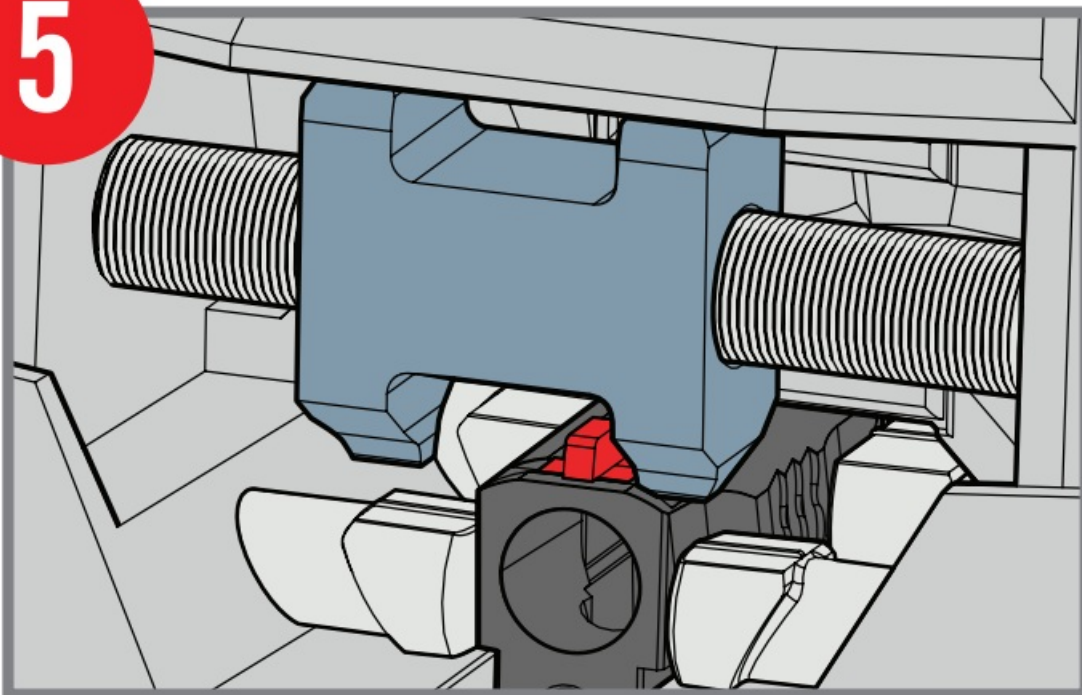

- Turn Easy Torque Handle™ and push sight through dovetail slot

6

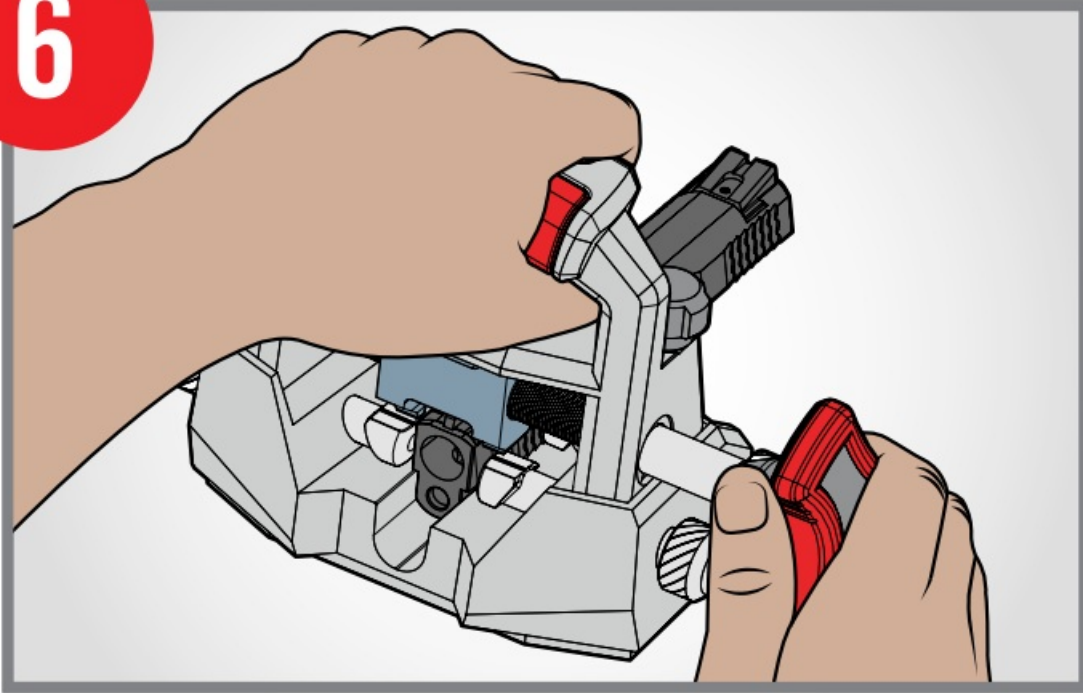

PRECISION ENGINEERED SIGHT CHANGER

Some press-fit sights require installation and removal from the left or right side only and will vary by manufacturer and model. Before proceeding, confirm this requirement with the manufacturer to avoid sight and slide damage.

WARNING: TO AVOID DAMAGE READ USER MANUAL AND REFER TO YOUR GUN MANUAL PRIOR TO USE

The Master Sight Pusher is compatible with most pistol slides. To confirm fitment with your pistol, measure the slide height and width referencing the diagram below.

If your slide does not meet the minimum requirement for either measurement, this tool will be incompatible for that slide

Minimum Height – 18mm/.709" Minimum Width – 23mm/.906"

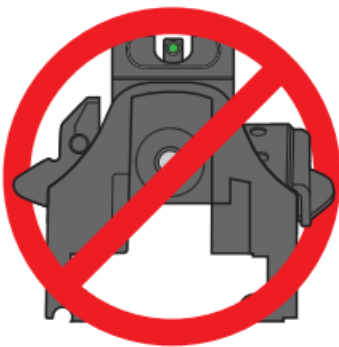
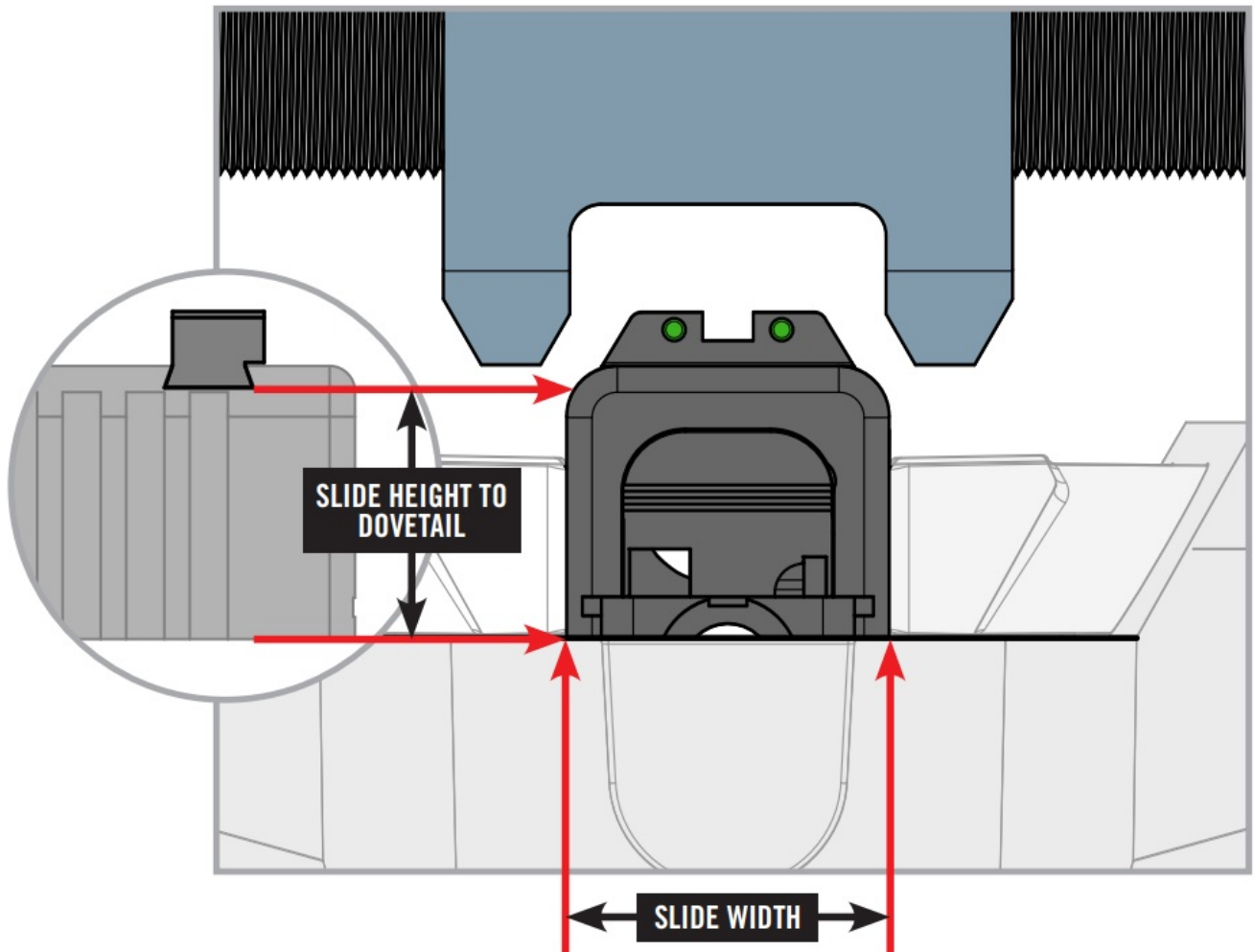

SPARE SLIDE CLAMPS AND ADAPTER PLATES

Due to the press-fit tension of the sight within the dovetail slot and/or the shape of the slide, steel slide clamps may be required to effectively push a particular sight. Provided with the Master Sight Pusher® are additional steel slide clamps for that purpose. These high-strength components expand the capabilities of the Master Sight

Pusher, but they also increase the potential for causing damage to your slide. We recommend starting with the plastic clamp set before moving onto the metal set if necessary. Make sure to apply fresh protective adhesive pads to the metal clamps to reduce the risk of scratches but note: slide damage is still possible. These steel clamps help eliminate the possibility of rotation of the slide within the cradle. Sights that have been factory-installed with hydraulic presses or have a type of thread locker applied are often difficult to remove and may take more pressure to remove and/or install. We recommend checking with the manufacturer for the proper removal procedure of the sight (right to left, left to right). Also be aware that some manufacturers insert a set screw through the bottom of the slide into the sight. Not removing this set screw prior to attempted sight removal can cause damage to your pistol slide. For high-pressure pressed sights, once the direction has been selected, preload the Press Block on the sight and using a ball-peen hammer, give the Easy Torque Handle™ a smack. This should help break free a frozen sight and allow for the Reversible Press Block to begin pushing the sight. For a more difficult sight, applying penetration fluid may help. Following these guidelines and keeping the threaded drive and bearing surfaces well-oiled will ensure years of trouble-free use.

PROVIDED WITH THE MASTER SIGHT PUSHER ARE TWO ADAPTER PLATES TO ACCOMMODATE ADDITIONAL SLIDE SHAPES AND SIZES.

PLATE A

- Is designed to work with slides that are 19.90mm – 23mm wide. Such as some Compact and Sub-Compact pistols. This plate will also work with slides that are less than 18mm tall.

PLATE B

- Is designed to work with slides that are 23mm wide or wider but are less than 18mm tall at dove tail.

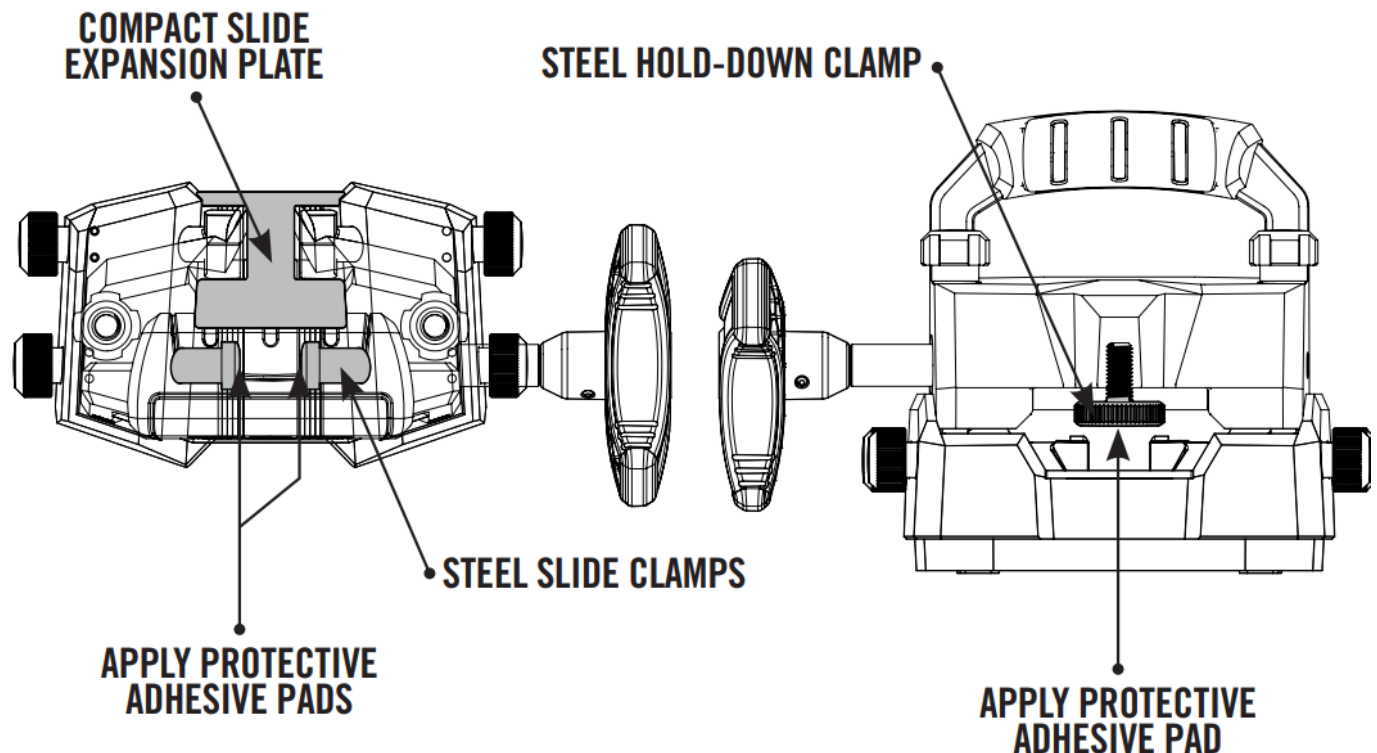

BEFORE YOU GET STARTED

LUBRICATION: Before each and every use, make sure these locations are well oiled. Lubrication is important to increase efficiency and reduce wear.

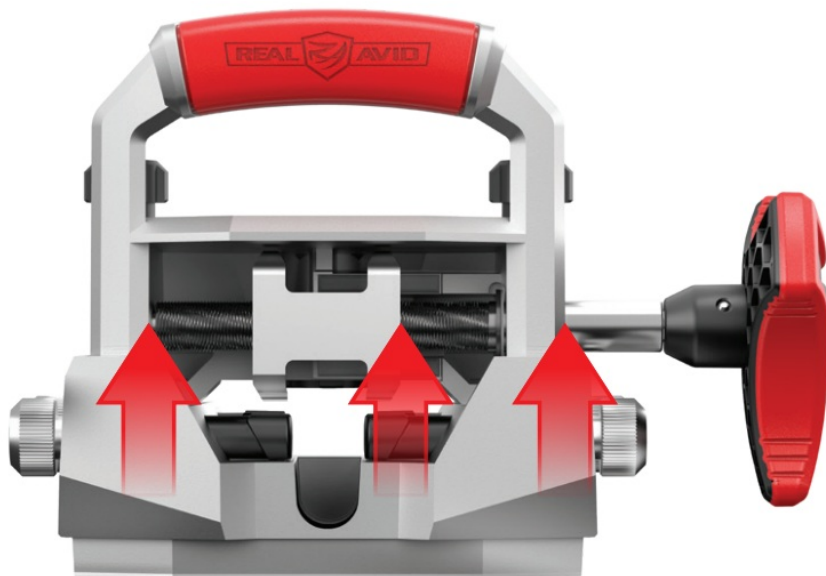

**APPLY OIL
TO BEARING
AND THREAD
SURFACES PRIOR
TO EACH USE**

GUN SAFETY IS A PRIORITY. Before working on any firearm, make sure the gun is unloaded, the chamber is empty and the gun is pointed in a safe direction.

CHANGE YOUR SIGHT — DO IT YOURSELF. INSTALL PRESS FIT SIGHTS IN 6 EASY STEPS.

- 1. SELECT APPLICABLE PRESS BLOCK FACE AND RETURN BLOCK TO CENTER OF PUSH ROD.**

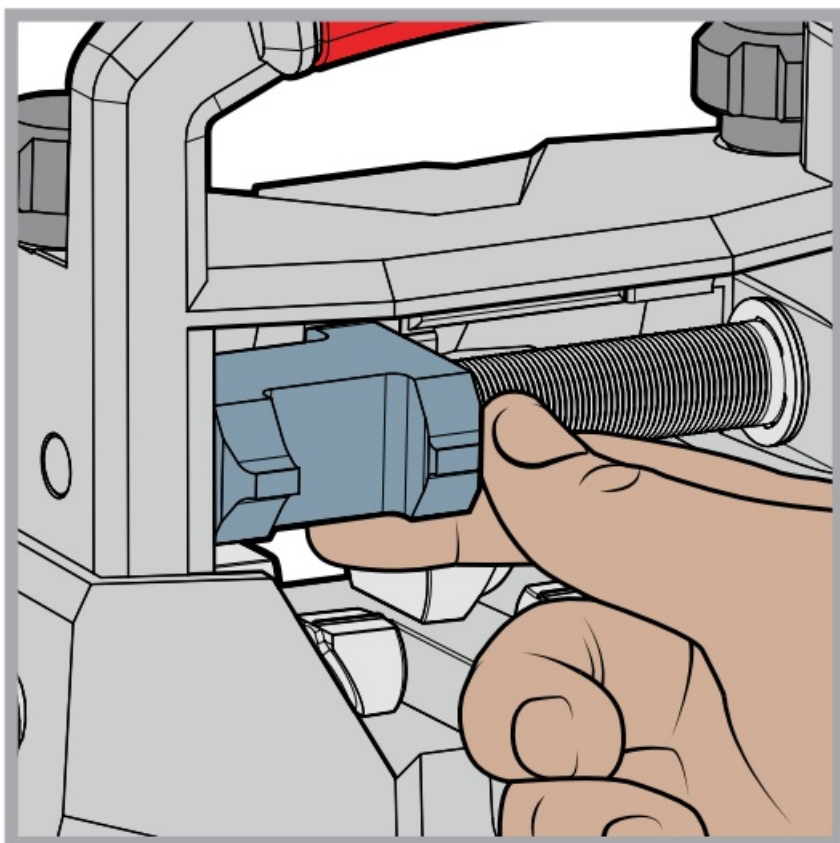

Select appropriate Reversible Press Block orientation. If you would like to use the opposite surface on the Press Block, rotate the crank clockwise to transport the Press Block all the way to the left. At this point, the Press Block should rotate freely without the support wall behind it. With the correct side selected, return the Press Block to the center by rotating the Easy Torque Handle™ counter-clockwise.

Press Block is reversible and provides multiple pushing surfaces to accommodate most press-fit sight profiles.

**FITS ANY DOVETAIL SLOT DOWN
TO 5/32" (4MM) WIDE**

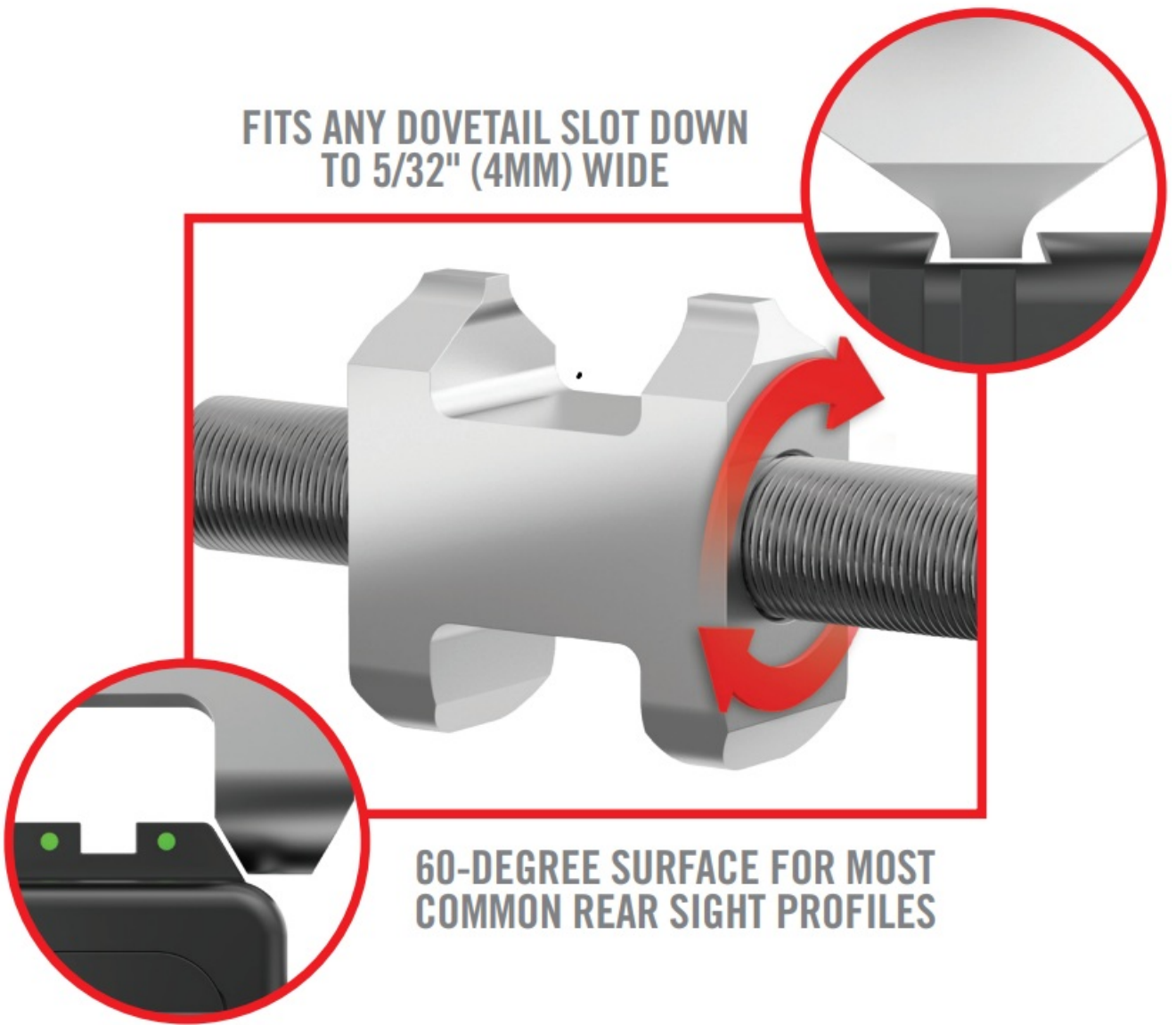

**60-DEGREE SURFACE FOR MOST
COMMON REAR SIGHT PROFILES**

If you have a low-profile sight, or one with a small surface to push on, it is recommended to use the 4mm wide tooth side of the Reversible Press Block. This narrow tooth can reach down inside most dovetails, in order to align the Press Block as low as possible to the sight for maximum leverage.

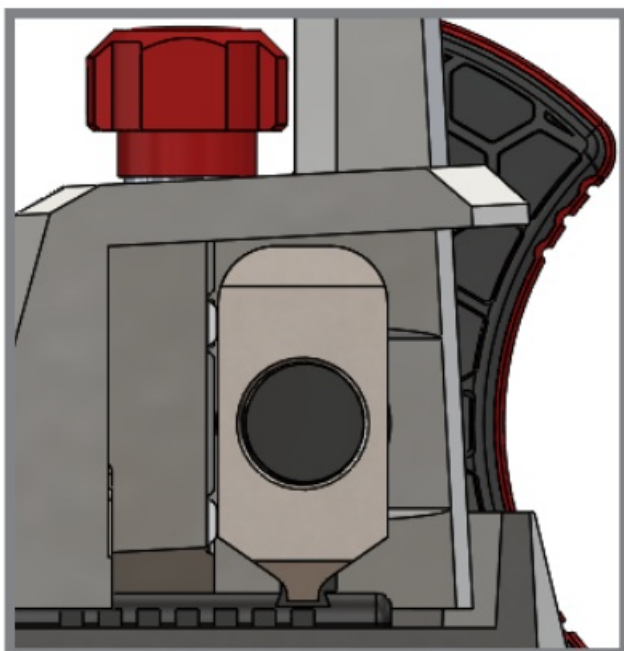

2. ALIGN CLAMP GUIDELINES WITH CENTER OF DOVETAIL AND SECURE SLIDE IN CRADLE.

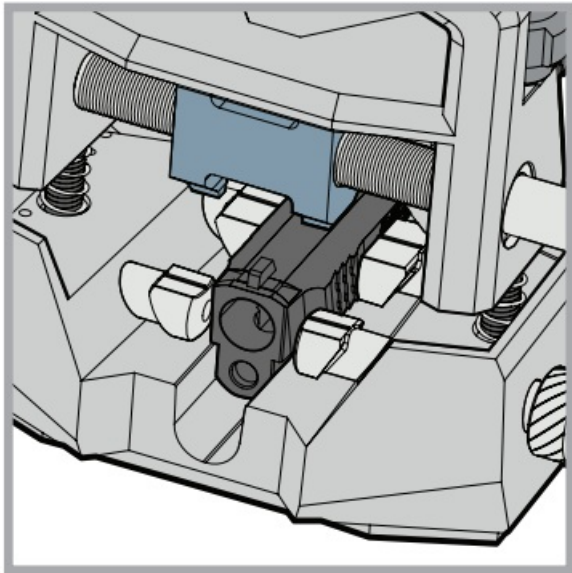

Loosen the two vertical frame bolts to allow for height clearance and help with visibility. Be sure to check the vertical stabilizer, to make sure it is up all the way. Mount pistol slide into slide frame. Center the slide and align front to back, so the sight to be removed or installed is directly under the press block. Tighten the four side clamp knobs to apply a light hold on the slide. This should allow fine tune position adjustments of the slide as you proceed.

MAKE SURE PRESS BLOCK IS CORRECTLY ALIGNED WITH DOVETAIL SLOT AND THAT THE SLIDE IS PARALLEL TO THE LINES RUNNING LENGTHWISE IN THE SLIDE CRADLE TO AVOID DAMAGING SLIDE

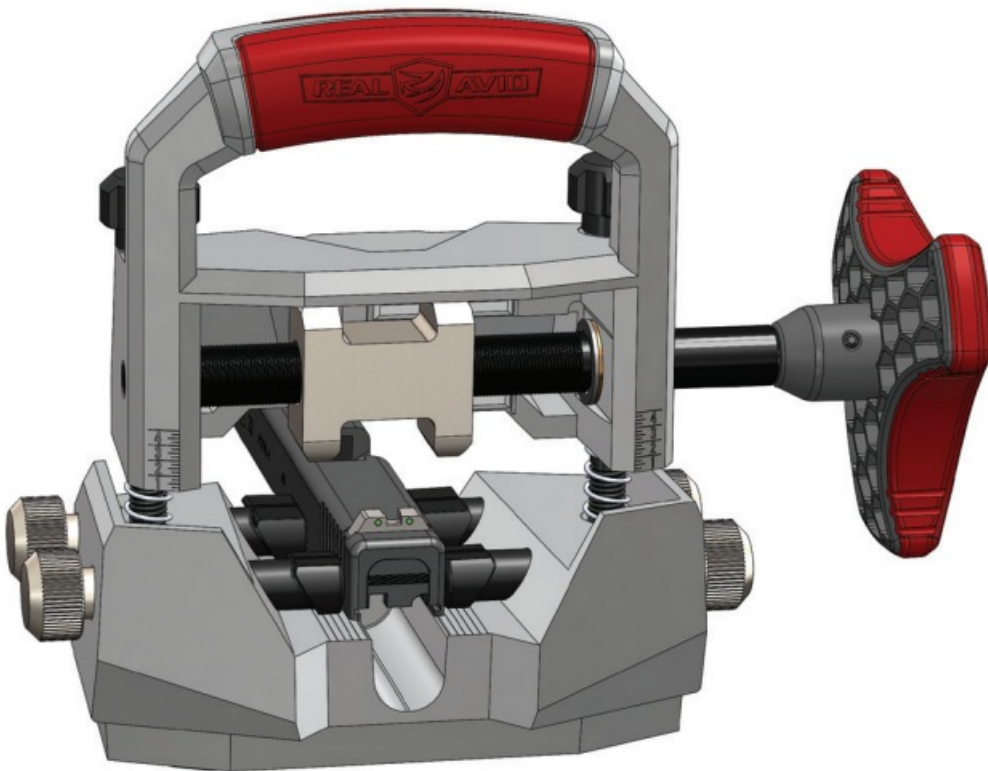

3. LOWER REVERSIBLE PRESS BLOCK TO THE APPROPRIATE HEIGHT.

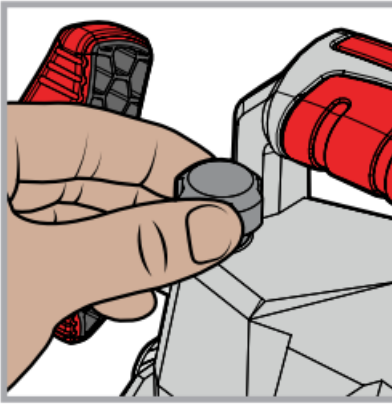

Turn both frame bolts simultaneously to avoid binding and keep upper frame level

Use extreme caution when lowering the Press Block down to its optimum height. It is very easy to misalign features and cause damage to your gun's slide. Using a bright shop light and magnifying lens is highly recommended. Lower the Upper Frame carefully into position by tightening the two frame bolts simultaneously. The height of Reversible Press Block should be predetermined: above the top of slide, or below the slide top and down inside the dovetail. During this process you should make any final front-to-back adjustments to the clamped position of the slide and apply final tightening pressure to the slide clamp knobs.

4. SNUGLY TIGHTEN VERTICAL STABILIZER TO HOLD PISTOL SLIDE IN PLACE.

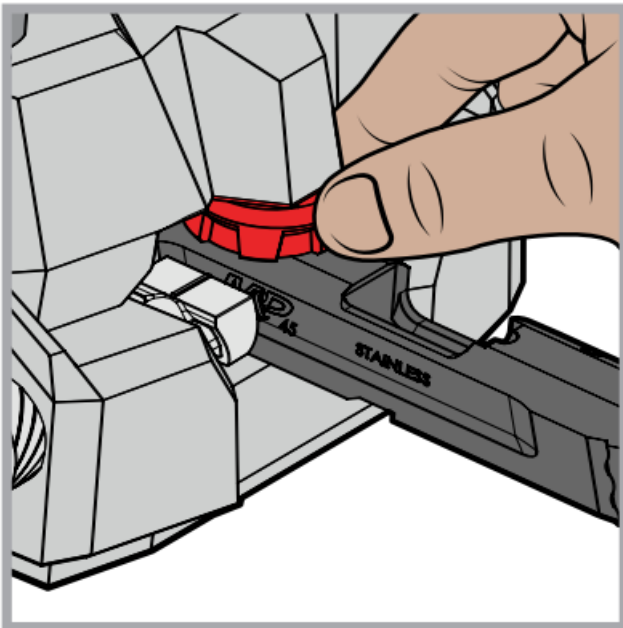

Once the upper frame is moved to the correct position, lower the Vertical stabilizer to the top surface of the slide to completely lock into place prior to pushing sight.

WARNING If over-tightened, it can damage surface finish on slide and bend vertical frame bolts

5. CONFIRM ALIGNMENT WITH REVERSIBLE PRESS BLOCK AND SIGHT.

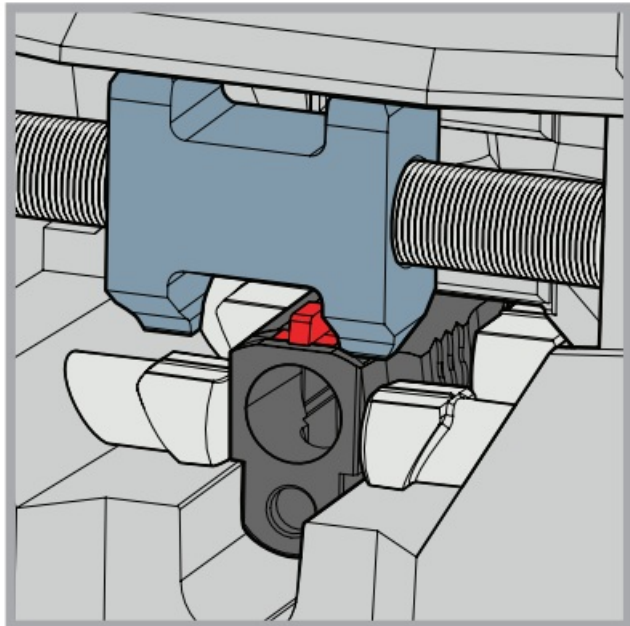

Use this step to ensure everything has remained aligned during the locking process and that the press block remains in correct alignment with the sight or dovetail slot and completely clears the slide to prevent damage. Special Note: when utilizing the 4mm tooth surface to push within the dovetail slot use extreme caution when lowering the Reversible Press Block down to this height. It is very easy to misalign features and cause damage to your gun's slide.

WARNING Failure to align slide properly will cause damage

6. TURN EASY TORQUE HANDLE™ AND PUSH SIGHT THROUGH DOVETAIL SLOT.

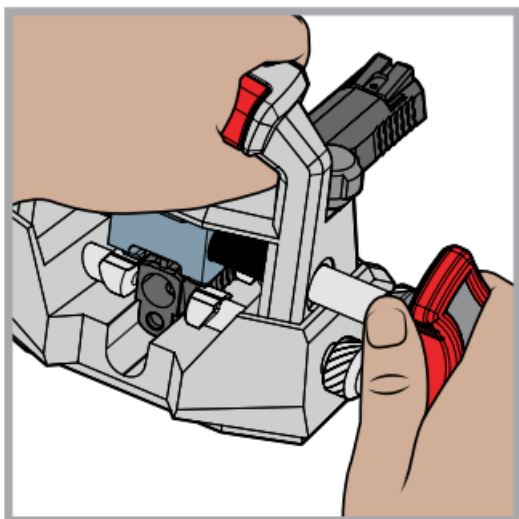

The oversized and comfortable Easy Torque Handle makes turning a breeze.

Turn Easy Torque Handle either clockwise or counterclockwise dependent on the direction you are pushing the sight. Handle should turn easily and you should not feel any binding. If you perceive over-resistance re-check alignment and clearance prior to proceeding.



POWERFUL TORQUE CONTROL

CARE & MAINTENANCE

WARRANTY

LIMITED – 3 YEAR WARRANTY: Master Sight Pusher™ is guaranteed free of defects in materials and workmanship for three years from date of original purchase. Real Avid will replace or repair any product that proves defective upon our inspection. Use of the Master Sight Pusher for anything other than its intended purpose is considered misuse and voids this warranty. For warranty service, send the product, proof of purchase with shipping paid, along with an explanation of the defect, as well as your name, address and phone number to the address below. This warranty excludes damage resulting from deliberate or accidental misuse. Warranty does not cover rust, stains or corrosion, or normal wear and tear. Repair or replacement is the exclusive remedy under this warranty. Real Avid, its partners and affiliates are not liable for incidental or consequential damage resulting from use. Some states do not allow exclusion or limitation of incidental or consequential damages; therefore, the above exclusions may not apply to you. This warranty gives you specific legal rights, and you may have other rights, which vary from state to state.

WARNING: The Master Sight Pusher is designed to push sights up to a maximum torque of 150 inch-lbs. For this reason, do not use the Master Sight Pusher on sights that have been hydraulically pressed by the manufacturer (Springfield XD Series as an example), or any sight requiring more than 150 inch-lbs. of torque to remove. If you experience heavy resistance or binding, it is best to check torque with an inch-lb. torque wrench inserted in to the 3/8" receiver in the center of the Easy Torque Handle™. Do this to ensure the torque limit of the tool is still within the upper operating limit to avoid damage to slide or tool. Operating the tool beyond the 150 inch-lb limit is at your own risk, and not recommended.

As a convenience to you, we have provided additional slide clamps. These parts are purposefully manufactured from plastic to reduce the possibility of scratches to your slide. The high-strength resin is tough, but not indestructible from excessive forces. They are meant to fail before too much force is applied to the sight pusher or to your slide. If you notice continual deformation of these slide clamps, consider improving the fit of new sights by filing their edges. Sights that have been factory installed with hydraulic presses are often damaged during the removal process and are best suited to be cut or hammered out. Following these guidelines and keeping the threaded drive and bearing surfaces well oiled will ensure years of trouble-free use.

WE RECOMMEND NOT EXCEEDING 150 INCH-LBS OF TORQUE WHILE USING THE 3/8" DRIVE

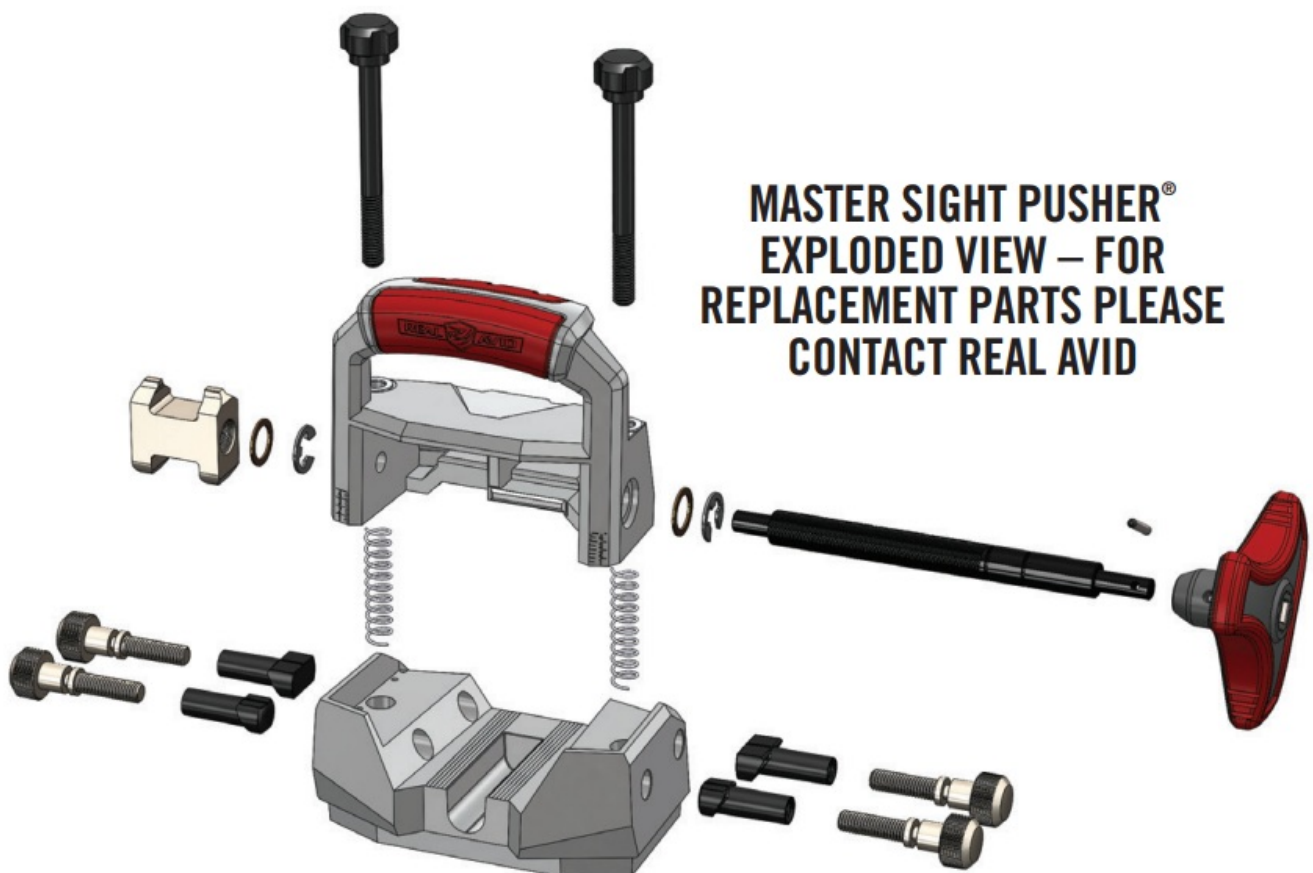

TO FRIENDS AND CUSTOMERS: As the owners of Real Avid®, authenticity isn't just a strategy here. It's a guiding philosophy. It arises out of our faith and personal relationships with Jesus Christ. We know that our creativity and success ultimately comes from Him. He cares about each of us and about our customers. We're not perfect, but we are committed to following Him in our personal and business lives. We look forward to growing our

relationship with you and continuing to earn our place.



FOR PISTOL
COMPATIBILITY
SCAN CODE

Revo Brand Group, LLC
5480 Nathan Lane North, Suite 120
Minneapolis, MN 55442 USA
RealAvid.com • 800-286-0567



Documents / Resources

 The thumbnail shows the cover of the "MASTER SIGHT PUSHER" user manual. It includes the title "MASTER SIGHT PUSHER PRECISION ENGINEER SIGHT CHANGER", a "USER MANUAL" label, and a section titled "INSTRUCTIONS OVERVIEW" with six numbered steps (1-6) illustrating the assembly and use of the device. The Real Avid logo is at the bottom.	<p>REAL AVID AVMSP Master Sight Pusher [pdf] User Manual AVMSP Master Sight Pusher, AVMSP, Master Sight Pusher, Sight Pusher, Pusher</p>
---	--

References

-  [REAL AVID® — UPGRADE TO MASTER GRADE](#)

