

REACHER R3S ALARM CLOCK NOISE MACHINE



## REACHER R3S Alarm Clock Noise Machine User Manual

[Home](#) » [Support](#) » REACHER R3S Alarm Clock Noise Machine User Manual 

### Contents

- 1 REACHER R3S Alarm Clock Noise Machine
- 2 Instructional Video
- 3 Technical Information
- 4 Features
- 5 Quick Getting Start and Time Setting
- 6 Alarm Setting
  - 6.1 Alarm volume set
  - 6.2 Stop the alarm
  - 6.3 Snooze
- 7 White noise sound machine
- 8 Sleep timer
- 9 Soothing Sounds TrackList
- 10 Batteries Operated
- 11 Warranty
- 12 FrequentlyAsked Questions
- 13 Video- Product Overview
- 14 References
- 15 Related Posts



**REACHER R3S Alarm Clock Noise Machine**



## R3S User Manual

Get support at [customer@reachershop.com](mailto:customer@reachershop.com)



## For our valued customers

We would like to thank you very much for your purchase from Reacher. The utmost care has gone into the design and manufacture of your R3S. Please read all of these instructions carefully and keep these in a safe place for future reference.

The R3S helps create perfect sleep environment. It can soothe you with any one of its 12 soothing sounds and wake you up with 6 nature sounds. It is also suitable for children, adults, and senior citizens as it is easy to use and helpful for getting a good night's sleep and refresh you in the morning.

## Instructional Video

We made a instructional video on YouTube as below link and QR code, just need to scan the code or enter the below video link.



## Technical Information

Item Size	58*96*85mm (H x W x D)
weight	235g
Power Requirements	5 Volts, DC, 5W
Speaker Impedance	4.8ohm(RMS)
Display size	71.6 X 39.3 mm
USB output	5V/1A

## Features

- Dual Alarm clock with separate weekend/weekday/ all-7-day mode
- White noise sound machine
- 30 Levels Volume Control
- 0-100 Dimmer
- Sleep timer
- Snooze

- Battery backup
- USB charging port

### Quick Getting Start and Time Setting

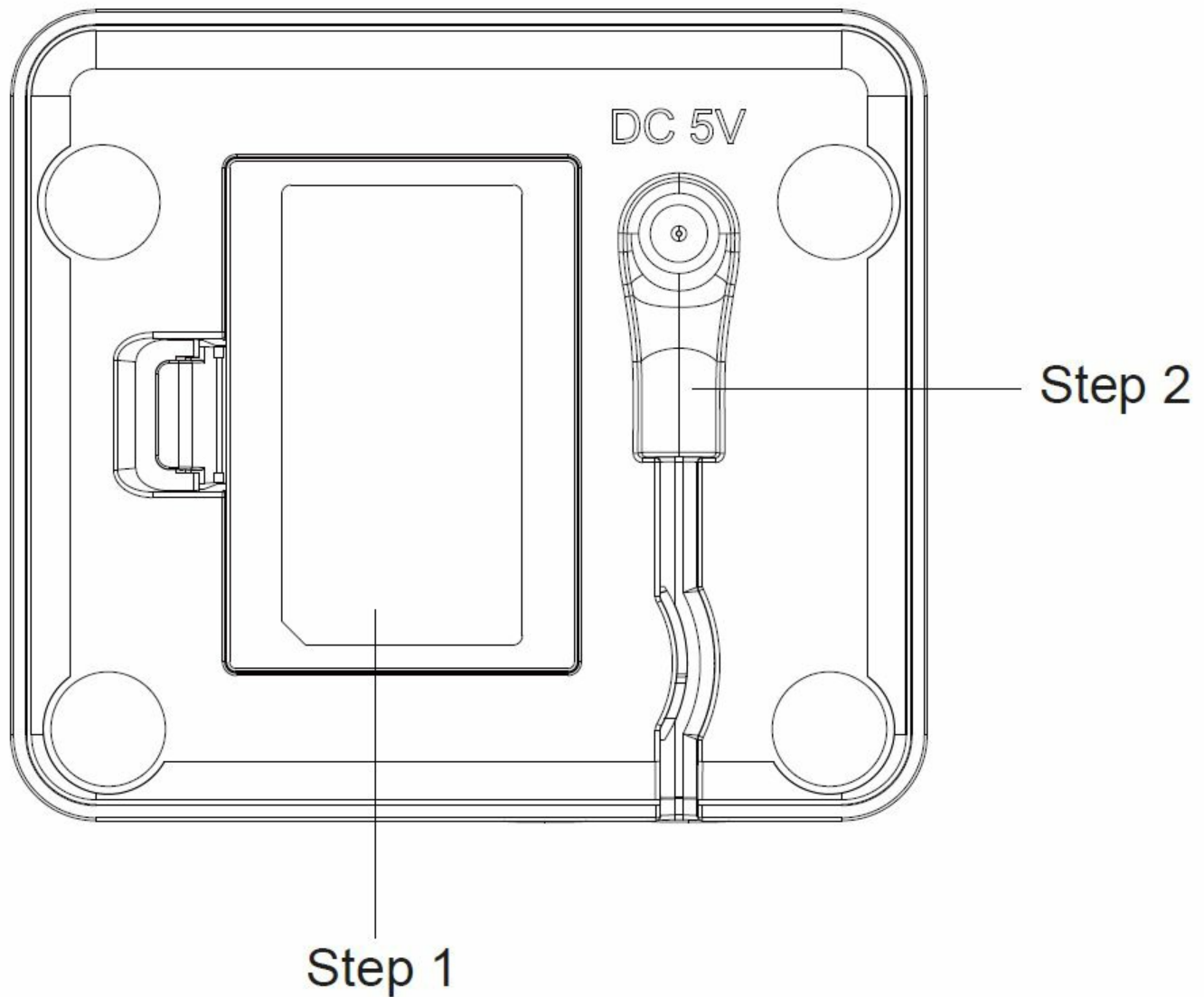

- Step 1: Insert 3 “AAA” batteries to keep working in case of power interruption.
- Step 2: Plug in the adapter into a standard household outlet to get the clock working.

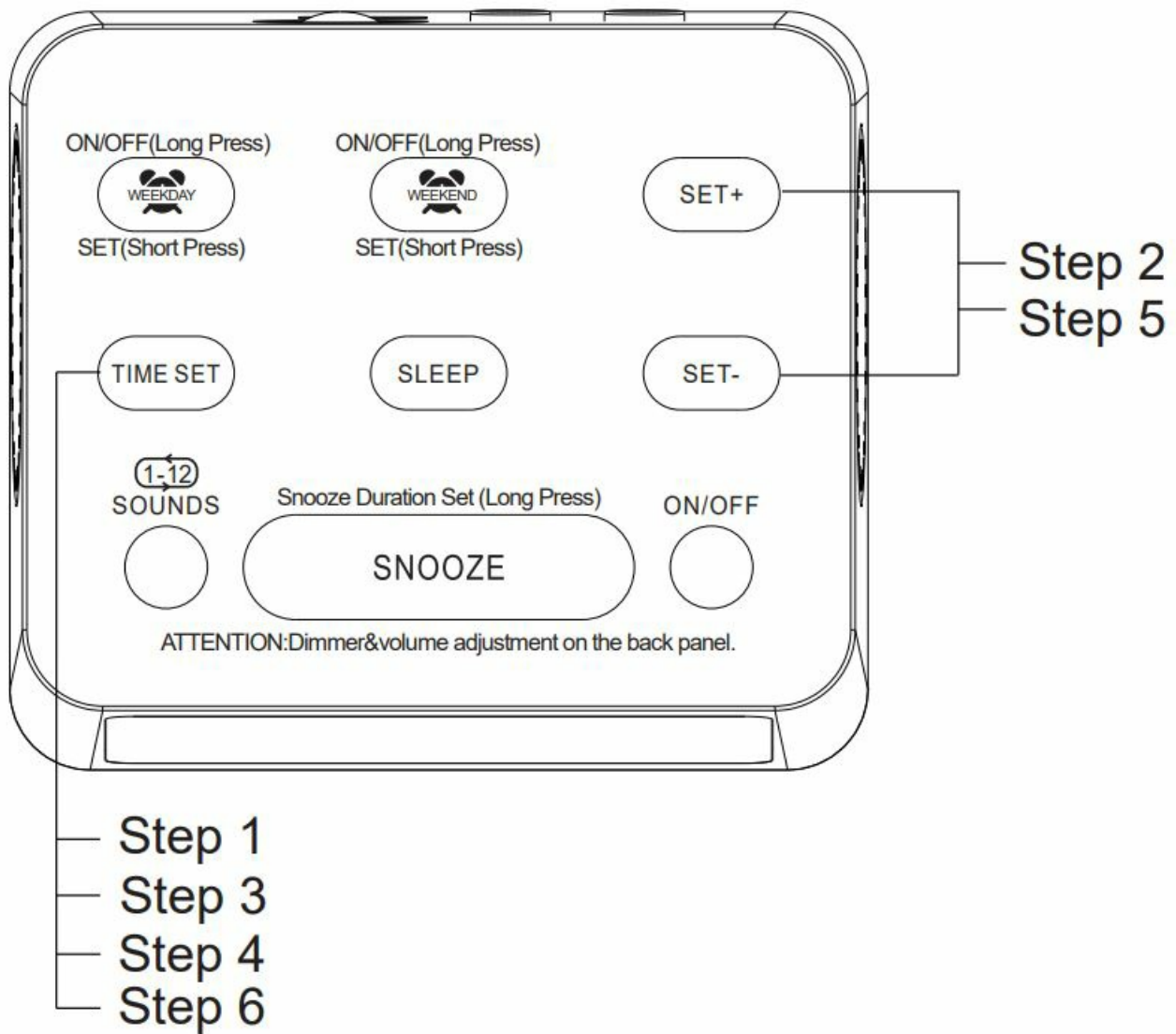

**Note:** The preset time is 12:00 AM (0:00 in military time), so please set your time by 12 hours, NOT military time.

- Step 1: Short Press “TIME SET” to set hours and minutes.
- Step 2: Press “SET+” or “SET-” to adjust the number.
- Step 3: Press “TIME SET” again to choose 12H mode or 24H mode (military time).
- Step 4: After setting the time mode, press “TIME SET” again to set the day of the week.
- Step 5: Press “SET+” or “SET-” to choose the day of the week.
- Step 6: Press “TIME SET” again to finish time setting.

## Alarm Setting

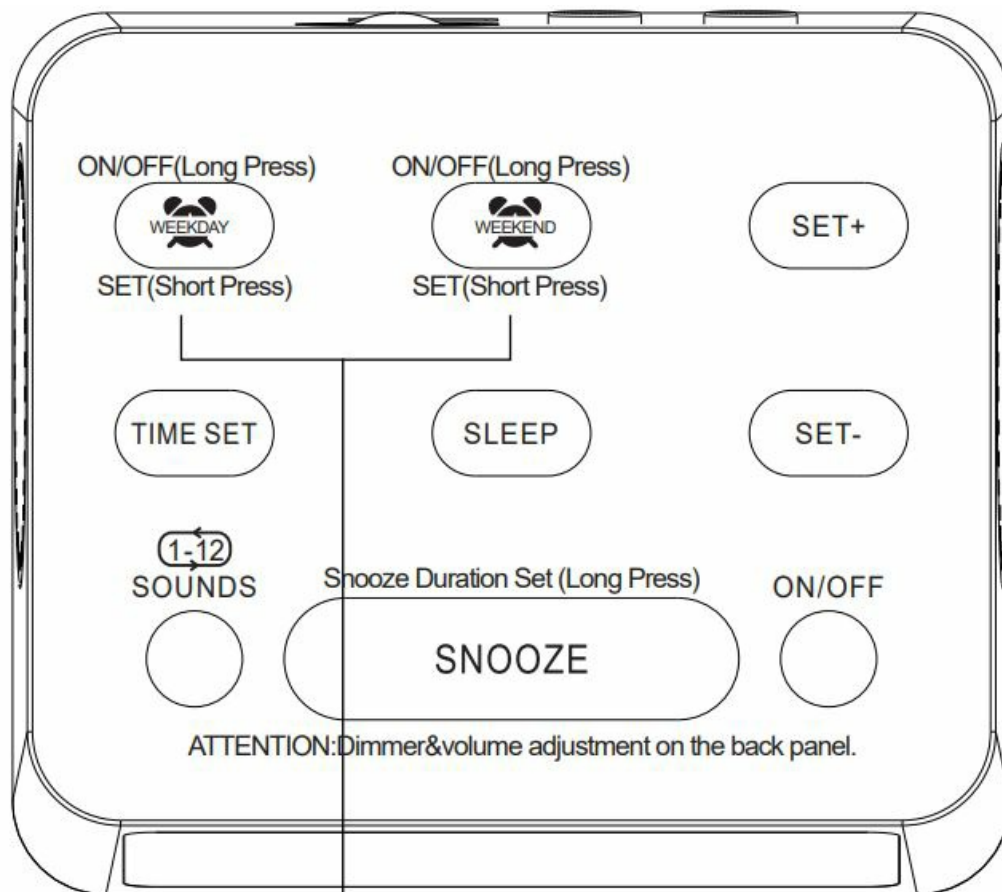

Long press to turn/off the alarm

#### Turn on/off the alarm

Long press "WEEKDAY ALARM" or "WEEKEND ALARM" for 2 seconds to turn on or turn off the alarm.

#### Alarm set

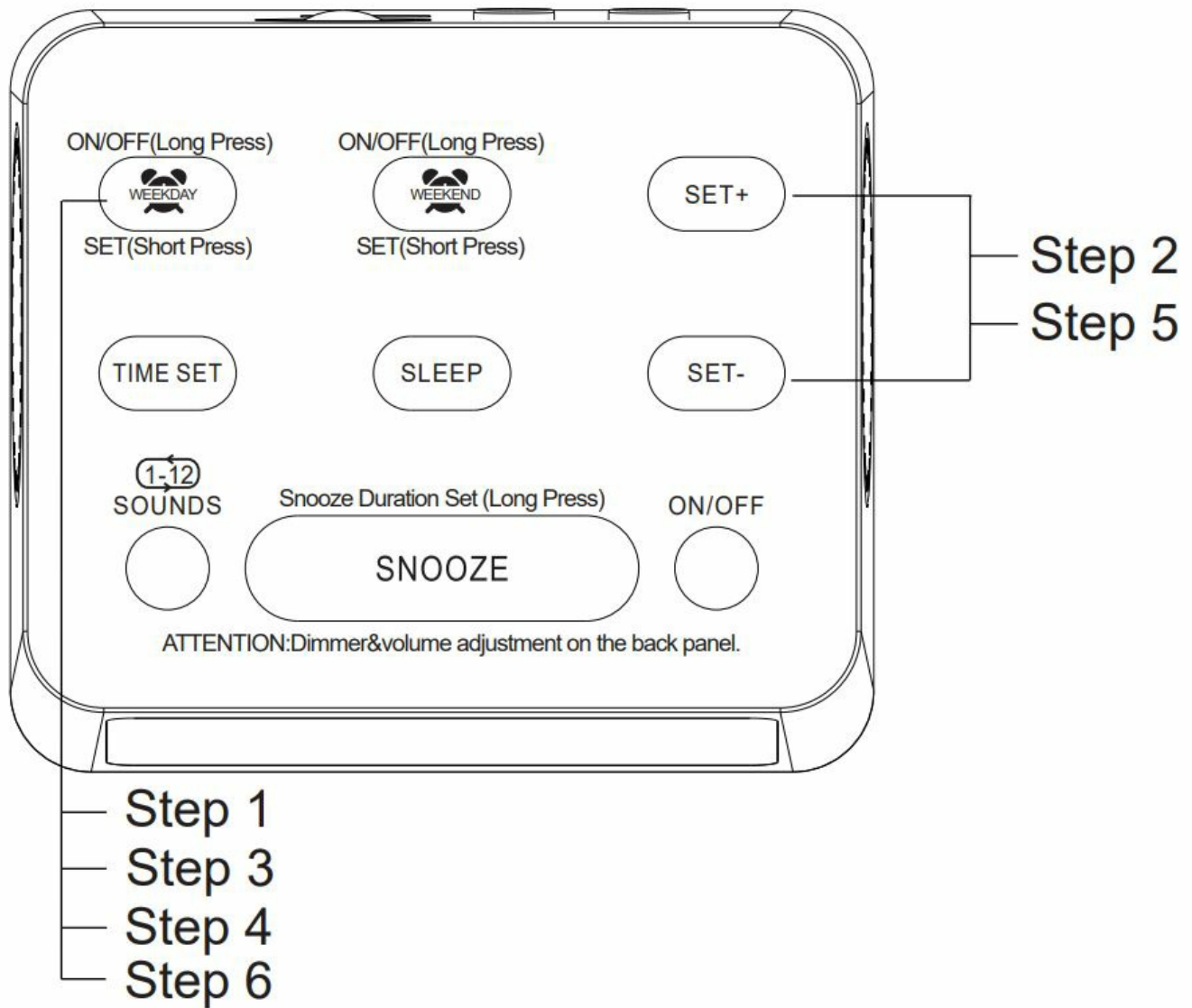

- Step 1: Short press “WEEKDAY ALARM” to set the alarm.
- Step 2: Press “SET+” or “SET-” to adjust hours and minutes.
- Step 3: Short press “WEEKDAY ALARM” to set the alarm mode, press “SET+” or “SET-” to choose the alarm mode you want. You can choose and change weekday alarm mode weekend alarm mode or all-7-day alarm mode for both alarms
- Step 4: Short press “WEEKDAY ALARM” again to set alarm sound.
- Step 5: Press “SET+” or “SET-” to choose from P01-P06. When choosing the alarm sound, you can also adjust the volume(on the back panel) ,5-30 levels are adjustable.
- Step 6: After setting your alarm sound and volume, Short press “WEEKDAY ALARM” to finish alarm setting. You can see the “WEEKDAY ALARM on” from the display.

**Note:** WEEKEND ALARM and WEEKDAY ALARM are set in the same way.

**Alarm volume set**



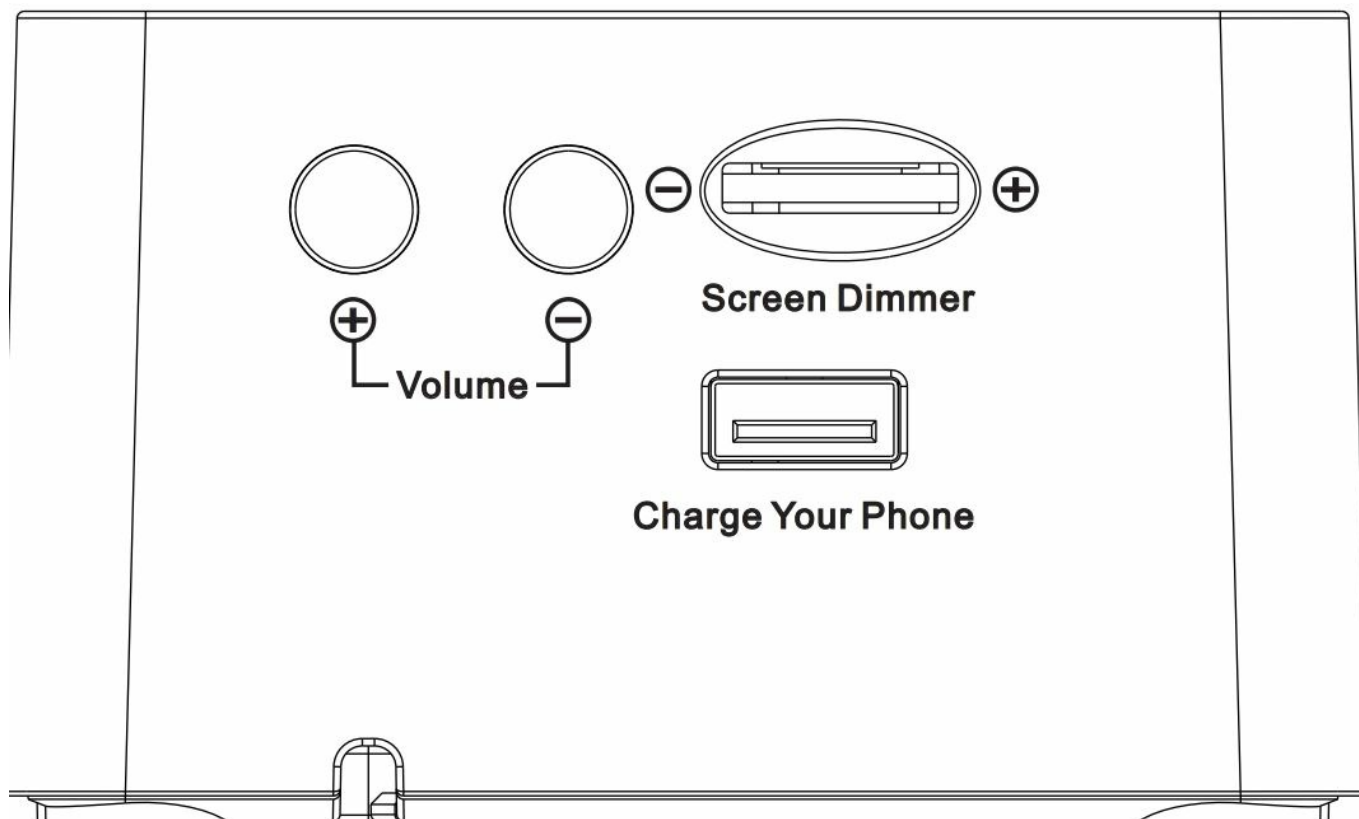

- Short Press "VOLUME +" or "VOLUME -" to adjust the alarm volume.
- Hold "VOLUME +" or "VOLUME -" for quick adjusting and play the alarm sound you set for 5 seconds.

**Note:** There are 30 levels volume to choose from. The preset volume is level 22.

#### Stop the alarm

1. Press any button except "SNOOZE" and "VOLUME+/-" to stop the alarm.
2. If you do not press any button, the alarm will last 30 minutes.

**Note:** the alarm will goes off on next day after you stop the alarm, If you want to turn off the alarm, long press "WEEKDAY ALARM" and display will show "OFF".

#### Snooze

1. When alarm goes off, Press "SNOOZE" to stop the alarm, but it will goes off after 9 minutes.
2. The alarm will last 30 minutes if you do not press any button.
3. You can snooze 6 times, when you press "Snooze" after that, the alarm will not goes off.
4. The snooze time can be adjusted to 1-15 minutes. Hold "SNOOZE" for 2 seconds, There are snooze time and "ZZ" symbol on the display. Then press "SET+/SET-" to adjust.
5. It will quit the setting if you do not press any buttons in 5 seconds.

#### White noise sound machine



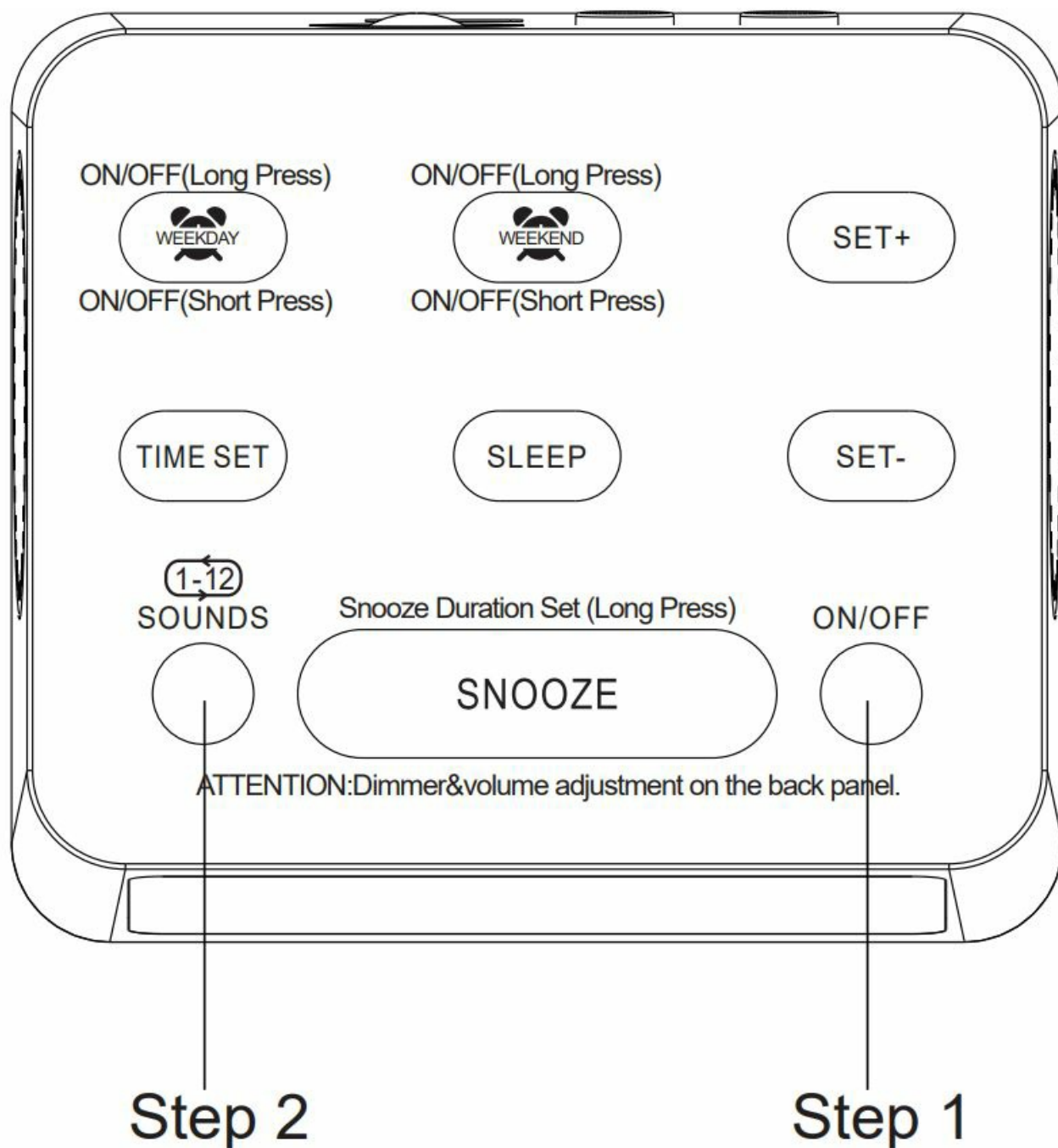

- Step 1: Press “ON/OFF” to turn on or turn off the sound machine. When it is turned on, it will play the first soothing sound. the display show P01).
- Step 2: Press “SOUNDS” to change the Sounds, Press again for next sound. There are 12 sound options.
- Step 3: Press “VOLUME+ / VOLUME-” (on the back) to adjust the volume. (0-30 Levels)

### Sleep timer

You can fall asleep with the radio using the sleep timer, which turns off the radio automatically after a preset duration. Press “SLEEP TIMER”, the duration (in minutes) changes as follows:

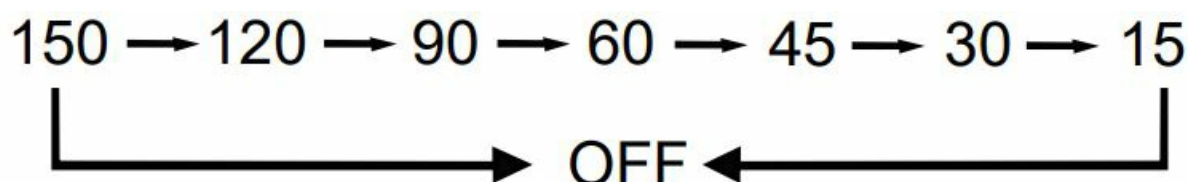

The soothing sound will play for the duration you set, then shut off.

## Dimmer

Rolling the “Screen Dimmer” wheel (on the back) to adjust the brightness of display from 0-100.

## Soothing Sounds TrackList

1.Fan Sound-1	7.Forest
2.Fan Sound-2	8.Lullaby
3.Fan Sound-3	9.Crickets Sound
4.White Noise	10.Rain
5.Pink Noise	11.Thunderstorm
6.Brown Noise	12.Ocean

## Alarm Sounds

- Flute
- Bird
- Piano
- Stream
- Beep
- Bell

## Batteries Operated

- Insert 3 “AAA” batteries to keep the alarm clock working in case of power outage.
- With batteries-only operated, the screen will stay on and the alarm will trigger. Please note that the batteries will drain fast without outlet power. So utilize the plug-in adapter for daily use.

## Warranty

Reacher backs 45-days money back and 12-month warranty for each product. Any questions, Please send email to [customer@reachershop.com](mailto:customer@reachershop.com) for assistance.

## Frequently Asked Questions

How do I set the time on the R3S Alarm Clock Noise Machine?

Follow the steps outlined in the user manual: insert batteries, plug in the adapter, and use the TIME SET button to adjust the hours, minutes, and time mode.

Can I set separate alarms for weekdays and weekends?

Yes, the R3S Alarm Clock Noise Machine allows for dual alarms with separate weekday/weekend/all-7-day modes.

How many soothing sounds does the R3S Alarm Clock Noise Machine offer?

The R3S Alarm Clock Noise Machine provides 12 soothing sounds to help create a perfect sleep environment.

Is the R3S Alarm Clock Noise Machine suitable for children and seniors?

Yes, the R3S Alarm Clock Noise Machine is designed for users of all ages, offering ease of use and assistance in achieving a good night's sleep.

How do I adjust the volume and brightness on the R3S Alarm Clock Noise Machine?

Use the dedicated volume control buttons for adjusting volume levels and the Screen Dimmer wheel on the back for adjusting display brightness.

What are the power requirements for the R3S Alarm Clock Noise Machine?

The R3S Alarm Clock Noise Machine operates on 5 Volts DC, 5W, and can be powered by both adapter and batteries.

Can I customize the alarm sound on the R3S Alarm Clock Noise Machine?

Yes, you can choose from 6 nature sounds for waking up, including flute, bird, piano, stream, beep, and bell.

How do I activate the snooze function on the R3S Alarm Clock Noise Machine?

Press the SNOOZE button to stop the alarm temporarily, and it will go off again after 9 minutes. The snooze time can be adjusted from 1 to 15 minutes.

Does the R3S Alarm Clock Noise Machine have a sleep timer?

Yes, you can set a sleep timer to automatically turn off the soothing sounds after a preset duration using the SLEEP TIMER button.

What should I do if the alarm on the R3S Alarm Clock Noise Machine doesn't go off as scheduled?

Ensure that the alarm is properly set and turned on for the desired days (weekday, weekend, or all-7-day mode). Check the volume level and sound selection to ensure they are set correctly.

How do I troubleshoot if the display on the R3S Alarm Clock Noise Machine is not working?

Verify that the device is properly plugged in and receiving power. Check the batteries if the device is battery-operated. Adjust the brightness using the Screen Dimmer wheel on the back.

Why is the sound output distorted or unclear on the R3S Alarm Clock Noise Machine?

Check the volume level and adjust it accordingly. Ensure that the device is not placed near sources of interference such as electronic devices or wireless signals. Try changing the sound selection to see if the issue persists with different sounds.

### Video- Product Overview



[Download the PDF of REACHER R3S Alarm Clock Noise Machine User Manual content/uploads/2024/03/default.jobtemplate.mp4.480.mp4](#)

Reference: [REACHER R3S Alarm Clock Noise Machine User Manual-device.report](#)



### References

- [User Manual](#)

[Manuals+.](#) [Privacy Policy](#)

This website is an independent publication and is neither affiliated with nor endorsed by any of the trademark owners. The "Bluetooth®" word mark and logos are registered trademarks owned by Bluetooth SIG, Inc. The "Wi-Fi®" word mark and logos are registered trademarks owned by the Wi-Fi Alliance. Any use of these marks on this website does not imply any affiliation with or endorsement.