



Rcom Auto Pumping System User Manual

[Home](#) » [Rcom](#) » Rcom Auto Pumping System User Manual 

Contents

- [1 Rcom Auto Pumping System](#)
- [2 APS Components](#)
- [3 How to Assemble APS \(Automatic Pumping System\)](#)
- [4 Documents / Resources](#)
- [5 Related Posts](#)



Rcom Auto Pumping System



APS (Auto Pumping System) has been upgraded for better product performance. Please refer to this manual for use.



APS Components

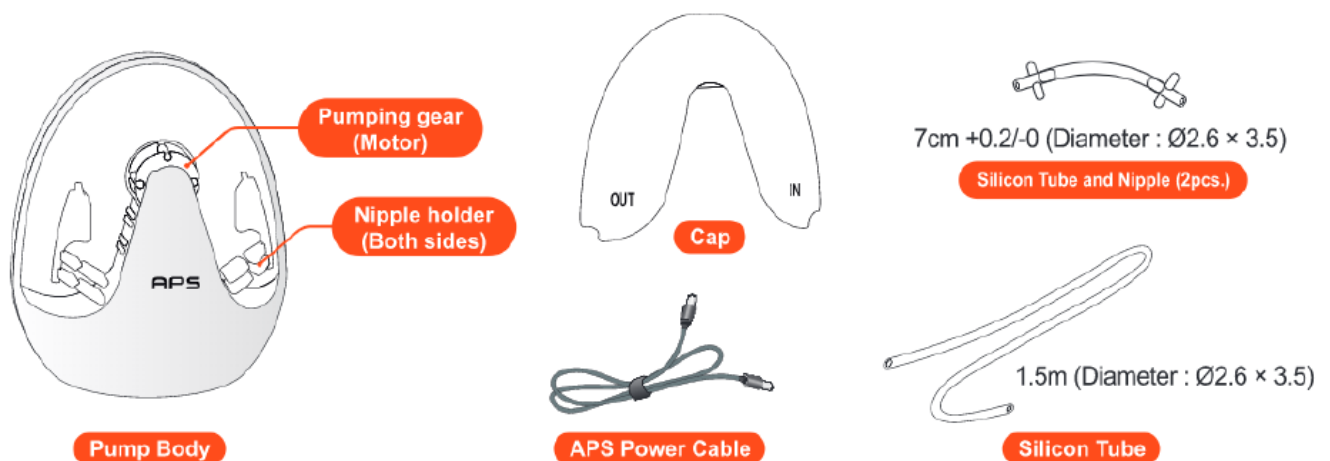

How to Assemble APS (Automatic Pumping System)

The silicone tube may become folded, causing a blockage. Please ensure that any blockages are removed by gentle pulling both ends of the tube before assembly.

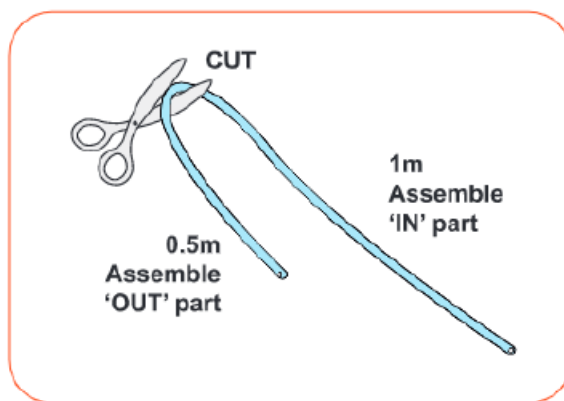

1. Cut the silicone tube to 1m and 0.5m lengths.

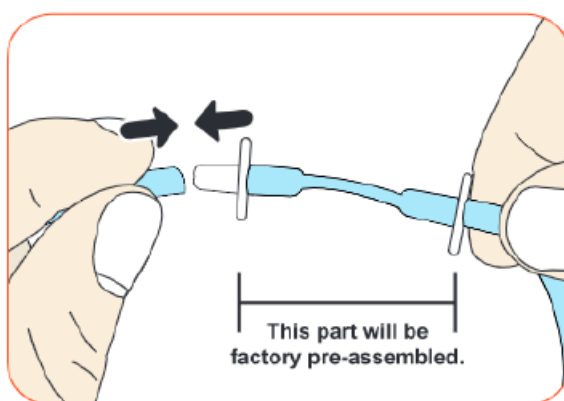

2. Attach the cut parts of the silicone tube onto the nipples on either side of the APS unit.

Please note that pumping performance will be reduced if the silicone tube isn't fitted tightly onto the nipple, or if the tube length is different from [Picture A].

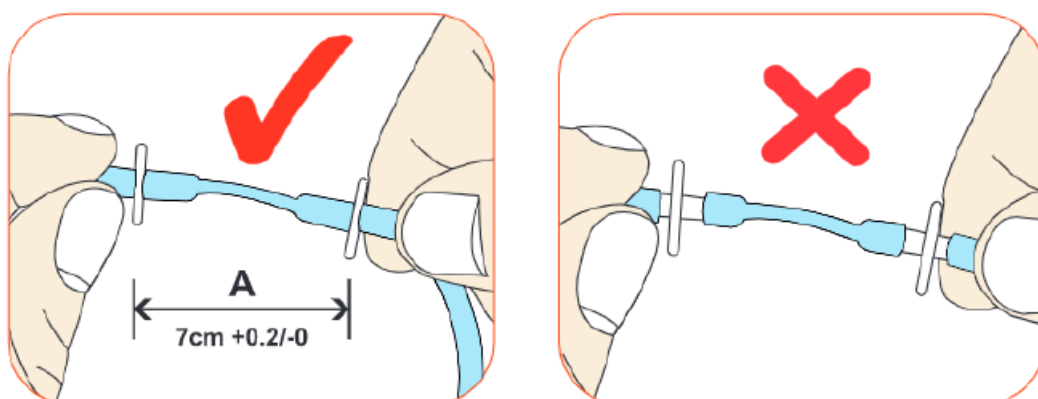

3. As shown in [Picture BI], insert a nipple, attached to 0.5m silicone tube, into the 'OUT' part (left-hand side) of the nipple holder.
4. As shown in [Picture CJ], insert a nipple, attached to 1 m silicone tube, into the 'IN' part (right-hand side) of the nipple holder.

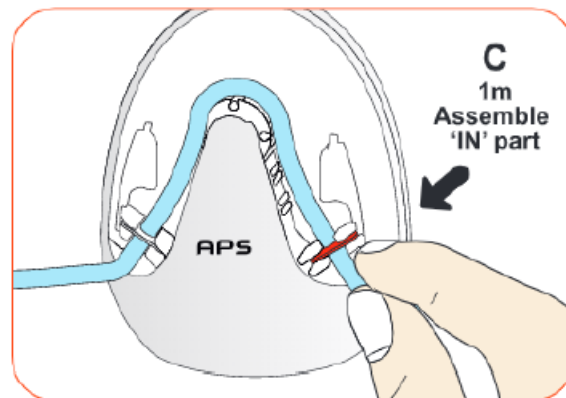
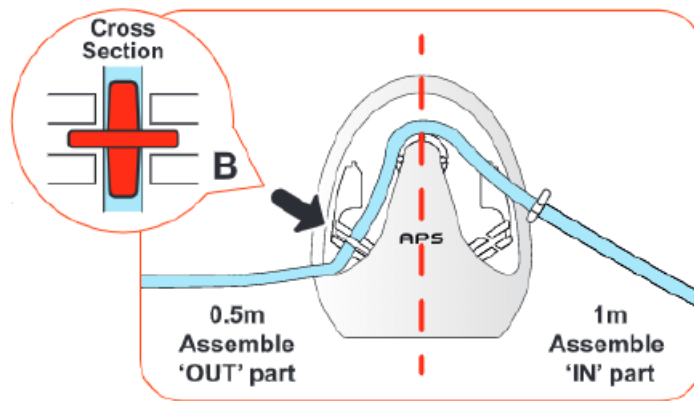

5. Assemble the cap onto the pump body. Please make sure silicone tubes do not get jammed in the cap.
6. Connect the APS power cable onto the power inlet at the back of the pump body.

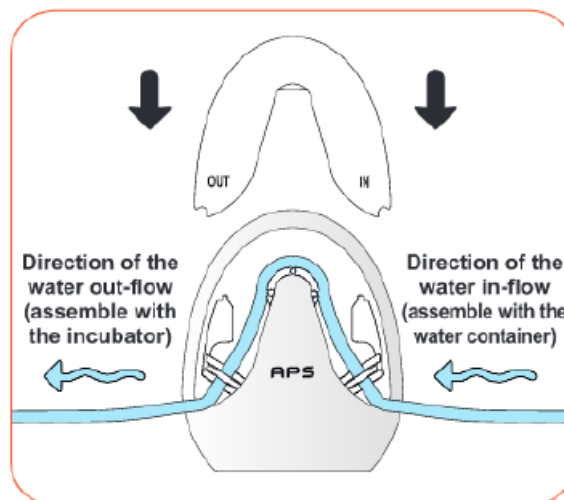

7. Please refer to booklet manual page 16 for how to assemble the APS with the incubator.

As shown, water flows out of the left silicon tube, and comes into the right silicon tube.

Turning direction of the motor

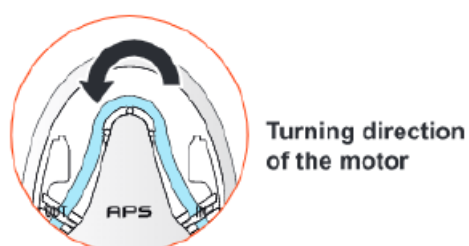

- Complaint Department: 82-55-337-2561
- E-mail Receipt : sales@autoelex.com

Documents / Resources

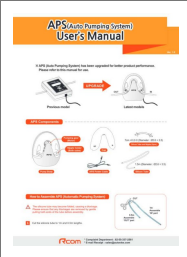
	<p>Rcom Auto Pumping System [pdf] User Manual Auto Pumping System, APS</p>
-----------------------------------------------------------------------------------	------------------------------------------------------------------------------------------------

Manuals+.