



RCA MC1337F Fixed Universal TV Wall Mount Installation Guide

[Home](#) » [RCA](#) » RCA MC1337F Fixed Universal TV Wall Mount Installation Guide 

Contents

- [1 RCA MC1337F Fixed Universal TV Wall Mount](#)
- [2 Questions?](#)
- [3 Tools Required \(Not Included\)](#)
- [4 Package Contents](#)
- [5 Attach the mount arms to your TV](#)
- [6 Installation on wood stud](#)
- [7 Installation on concrete](#)
- [8 Place your TV on the mount](#)
- [9 12-Month Limited Warranty](#)
- [10 Documents / Resources](#)
 - [10.1 References](#)
- [11 Related Posts](#)



RCA MC1337F Fixed Universal TV Wall Mount

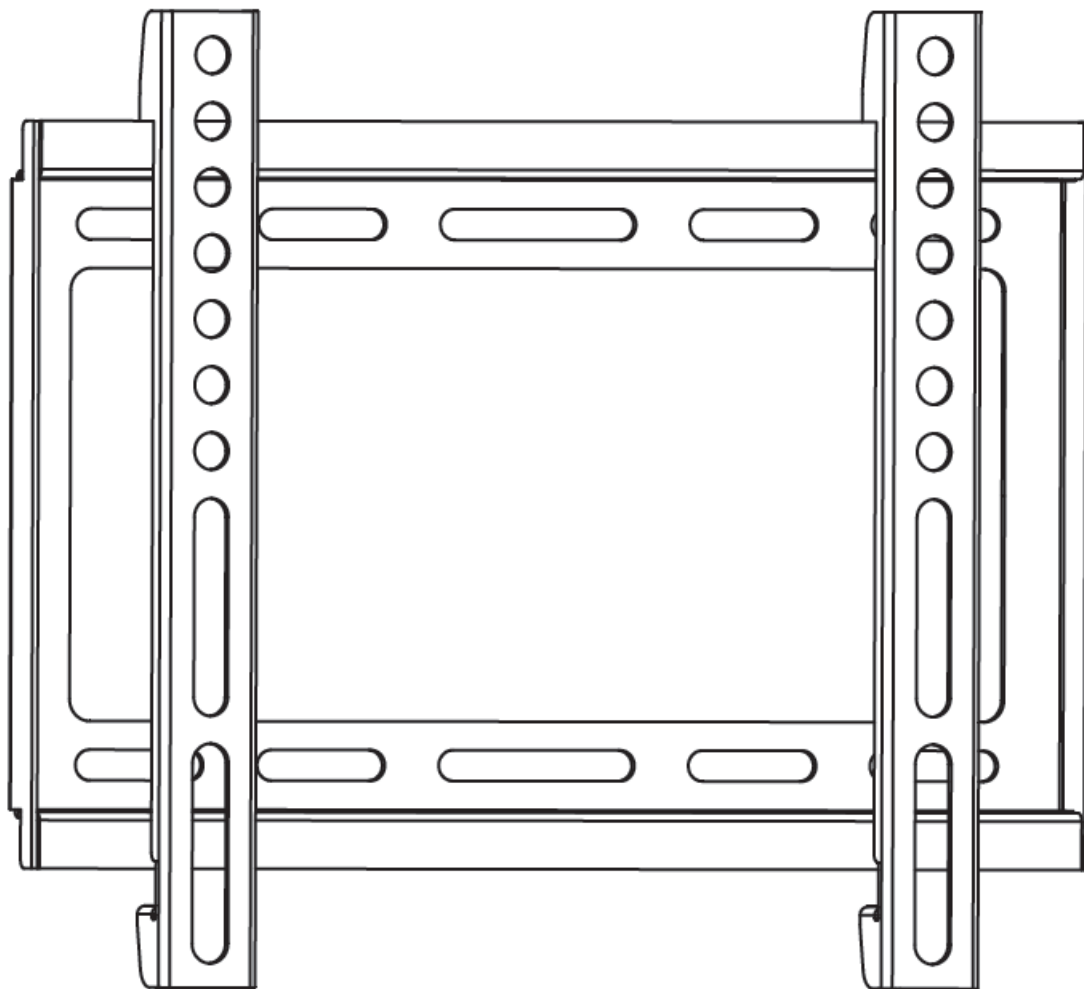

Questions?

Please call us at 1-800-645-7750 or visit RCAAudioVideo.com

DISCLAIMER

Voxx Accessories Corp. has extended every effort to ensure to accuracy and completeness of this manual. However, Voxx Accessories Corp. does not claim that the information covers all installation or operational variables. The information contained in this document is subject to change without notice or obligation of any kind. Regarding the information contained herein, Voxx Accessories Corp. makes no representation of warranty, expressed or implied, and assumes no responsibility for accuracy, sufficiency, or completeness of the information contained in this document.

WARNING INFORMATION

WARNING: FAILURE TO READ, THOROUGHLY UNDERSTAND, AND FOLLOW ALL INSTRUCTIONS CAN RESULT IN SERIOUS PERSONAL INJURY, DAMAGE TO PERSONAL PROPERTY, OR VOIDING OF FACTORY WARRANTY!

It is the responsibility of the installer to ensure all components are properly assembled and installed using the instructions provided. If you do not understand these instructions or have any questions or concerns, please contact customer service at 1-800-645-7750.

Do not attempt to install or assemble this product if the product or hardware is damaged or missing. In the event that replacement parts or hardware are needed, please contact Customer Service at 1-800-645-7750.

International customers needing assistance should contact the Dealer from which they purchased the product.

The included hardware is designed for use on vertical walls constructed of wood studs or solid concrete. A wood stud wall is defined as consisting of a minimum of 2×4 wooden studs (2" wide by 4" deep) with a maximum of 5/8" drywall. The included hardware is not designed for use with metal studs or cinderblock walls. If you're uncertain about the construction of your wall, then please consult a qualified contractor or installer for assistance. For a safe installation, the wall you are mounting to must support 4 times the weight of the total load. If not, then the surface must be reinforced to meet this standard. The installer is responsible for verifying that the wall structure and

hardware used in any installation method will safely support the total load.

Tools Required (Not Included)

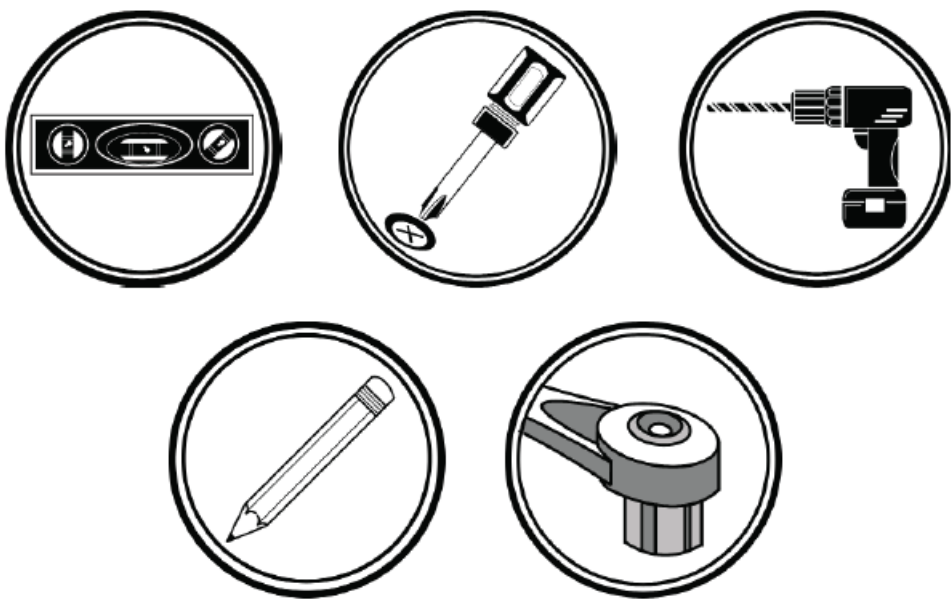

	<div>For drywall installation Pour une installation sur une cloison sèche Para la instalación en mampostería</div> <div>4.5mm (3/16") </div> <div></div>
	<div>For solid wall installation Pour une installation sur un mur plein Para la instalación en pared maciza</div> <div>10mm (3/8") </div> <div>10x55mm (3/8"x2-3/16") </div>

A

Package Contents

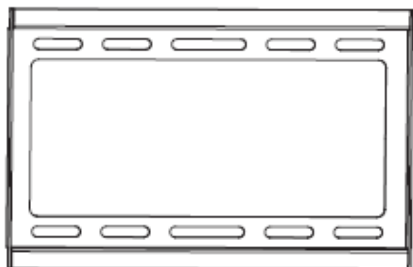

A TV Wall Mount
Support mural pour TV
Soporte de pared para TV

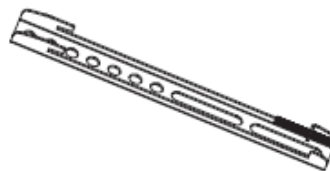

B (x2) Mounting Arms
Bras de montage
Brazos de montaje

Mounting Hardware Bags

Sacs de matériel de montage / Bolsas de tornillería de montaje



M-A (x4)

M4x14 Bolts
Boulons M4x14
Pernos M4x14



M-B (x4)

M5x14 Bolts
Boulons M5x14
Pernos M5x14



M-C (x4)

M6x14 Bolts
Boulons M6x14
Pernos M6x14



M-D (x4)

M8x20 Bolts
Boulons M8x20
Pernos M8x20



M-E (x4)

D5 Spacers
Entretoises D5
Separadores D5



M-F (x4)

D8 Spacers
Entretoises D8
Separadores D8



M-G (x4)

Spacers
Entretoises
Separadores



W-A (x4)

Mounting Screws
Vis de montage
Tornillos de montaje



W-B (x4)

Washers
Rondelles
Arandelas

Attach the mount arms to your TV

IMPORTANT! Use extra care during this part of the installation. If possible, avoid placing your display facedown as it may damage the viewing surface.

NOTE: This mount comes with a selection of different bolt diameters and lengths to accommodate a wide variety of display models. Not all of the hardware in the kit will be used. If you cannot find the appropriate bolt size in the kit provided, consult the manufacturer of your display for more information.

1. Determine the correct length of bolt (M-A/M-B/M-C or M-D) to use.

A. If the back of your display is flat and the mounting holes are flush with the surface, use the shorter bolts from the hardware kit.

B. If the back of your display is curved, has a protrusion, or if the mounting holes are recessed, use the longer bolts. You may also need to use the spacers.

2. Determine the correct diameter of bolt to use by carefully trying one of each size (M-A, M-B, M-C, or M-D)

from the hardware kit. Do not force any of the bolts – if you feel resistance stop immediately and try a smaller diameter bolt.

3. **Attach the mount arms to the back of your display** using the bolts identified in Steps 1 and 2 along with the M-E/M-F washers and spacers if needed.

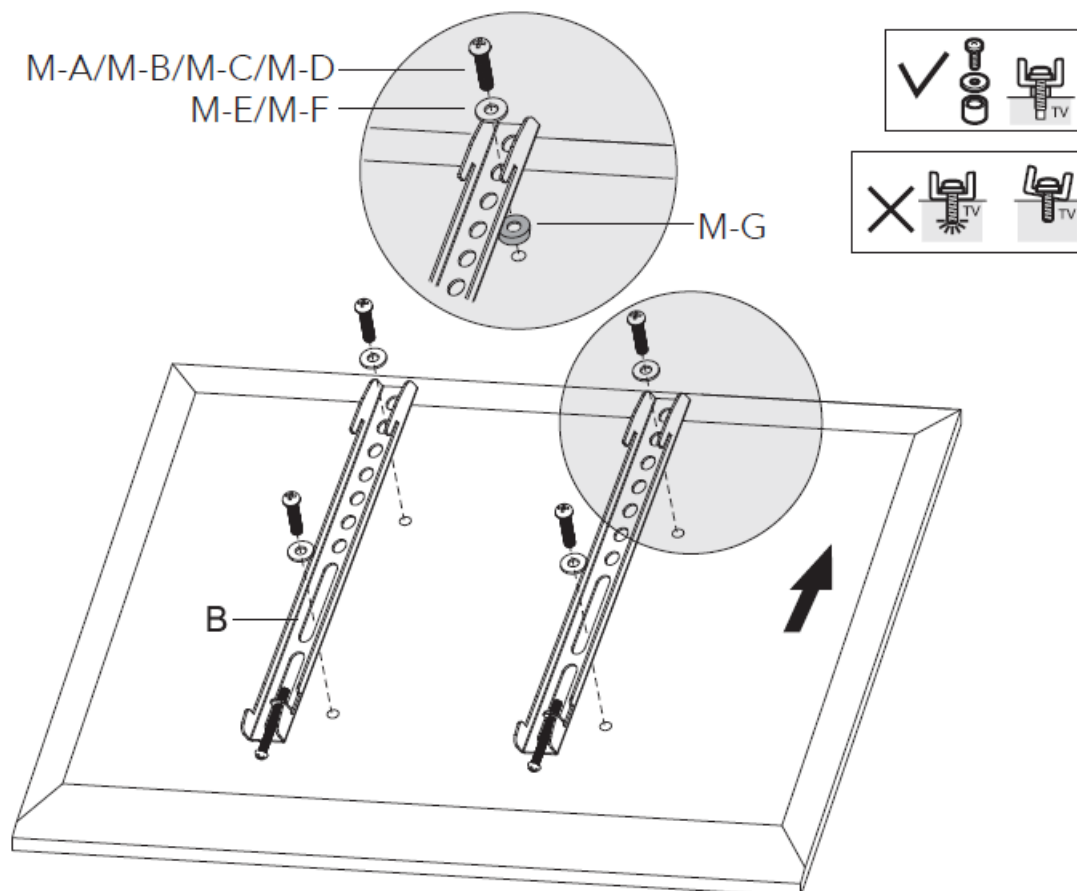

Installation on wood stud

IMPORTANT! For safety reasons, this mount must be secured to a wood stud capable of supporting the combined weight of the mount and display.

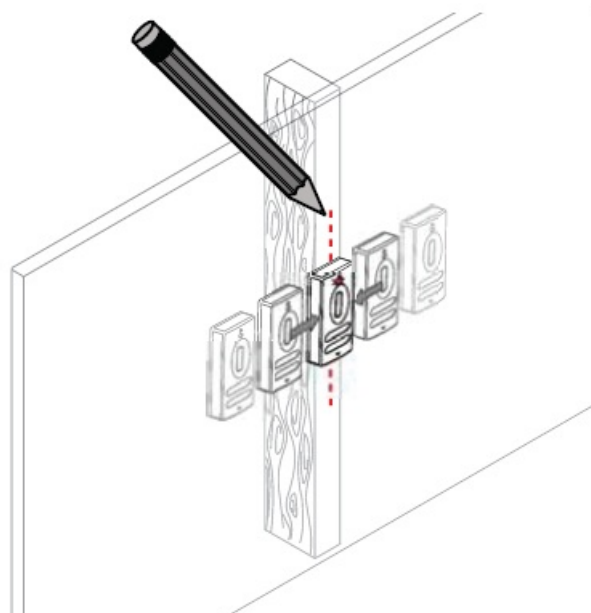

1. Use a stud finder to locate a wood stud where you wish to install your mount. Mark both edges of the stud to

help identify the exact center.

NOTE: You must use the center of the stud to avoid cracking or splitting the wood during installation.

2. Place the base of the mount against the wall over the marked stud. Make sure the base is level and mark where the two mounting screws will go.

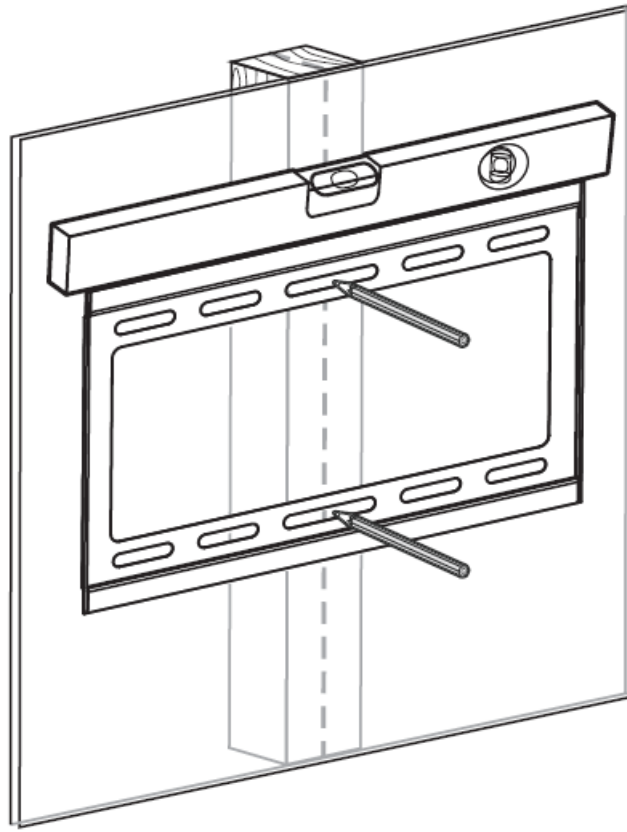

3. Drill 4.5 mm (3/16") pilot holes in the wall 2.2" deep.

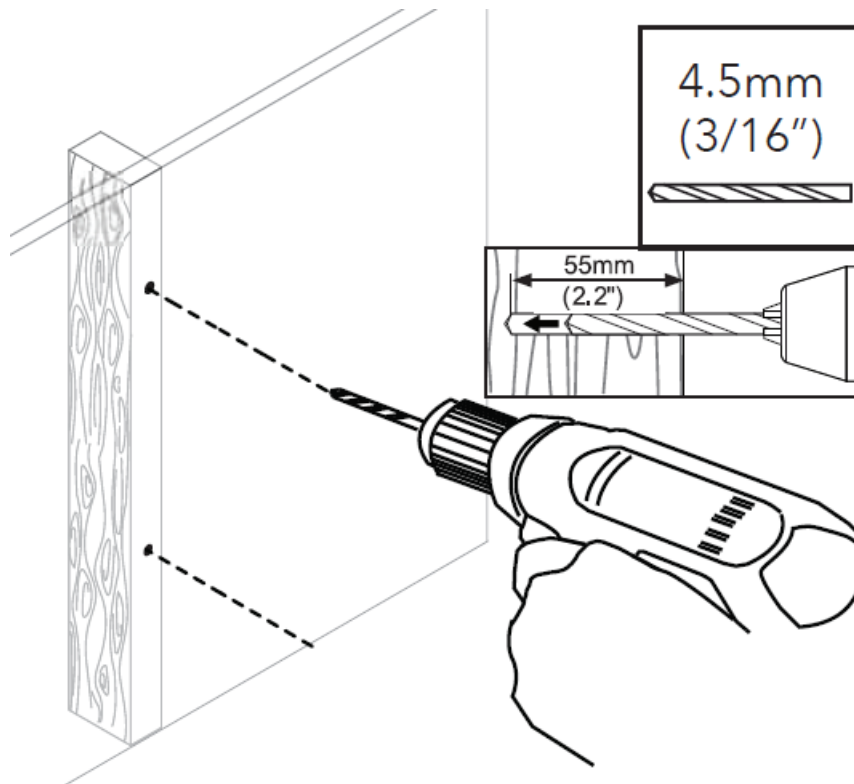

4. Place the base against the wall over the pilot holes.

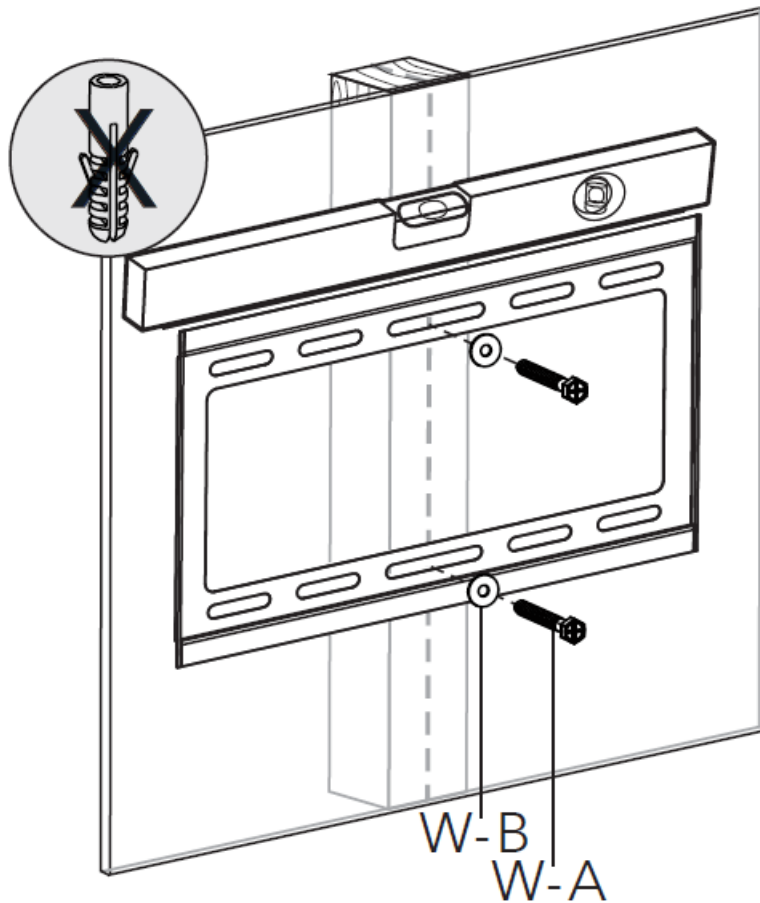

5. Attach the wall mount base and arm to the wall using two of the mounting screws (W-A) and mounting washers (W-B) provided. Do not over-tighten these screws and do not release the wall plate until all screws are in place. Ensure that the wall mount base remains level after all screws are secured.

Installation on concrete

IMPORTANT! For safety reasons, the concrete wall must be capable of supporting the combined weight of the mount and the display. The manufacturer takes no responsibility for failure caused by walls of insufficient strength.

1. Place the base of the mount against the wall where you want to install it. Make sure the base is level and mark where the four mounting screws will go.

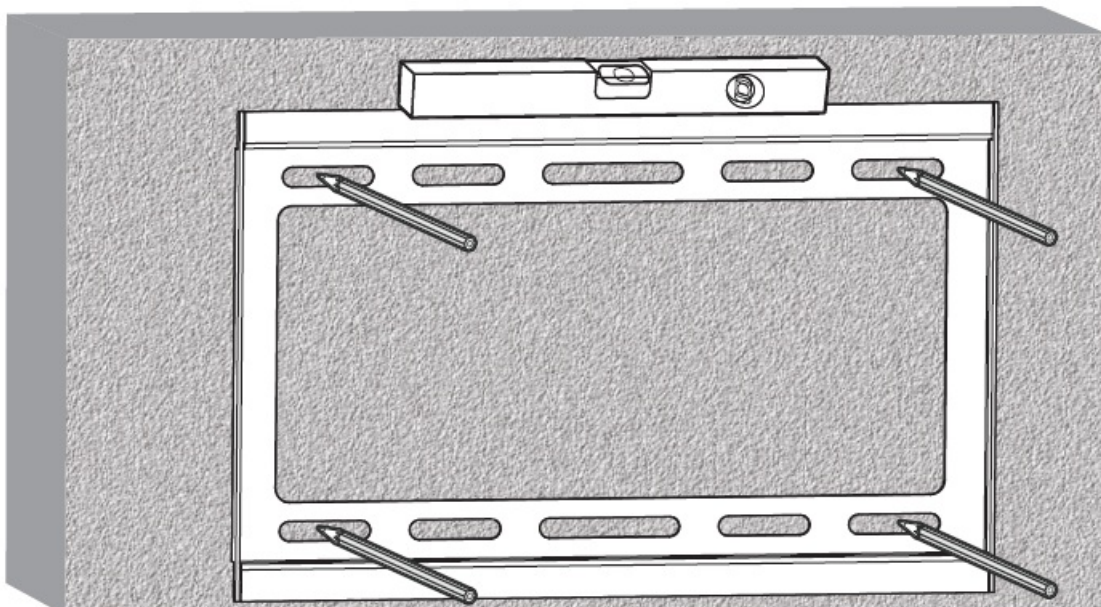

2. Drill four 10 mm (3/8") holes in the wall where you marked, 2.4" deep. Remove any excess dust from the hole.

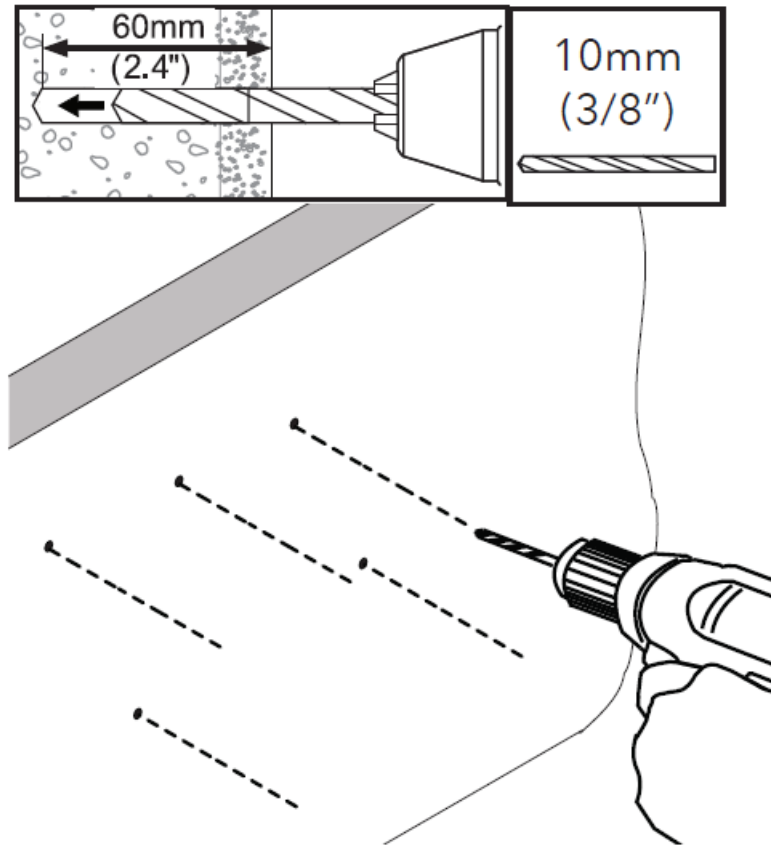

3. Insert a 10x55mm concrete anchor (not provided) into each hole so that it is flush with the concrete surface. A hammer can be used to lightly tap the anchors into place if necessary.

NOTE: If the concrete wall is covered by a layer of plaster or drywall, the concrete anchor must pass completely through the layer to rest flush with the concrete surface.

4. Place the wall plate against the wall over the inserted anchors and attach it using the mounting screws (W-A) and mounting washers (W-B) provided. Do not over-tighten these screws and do not release the wall plate until all screws are in place. Ensure that the wall plate remains level after the screws are secured.

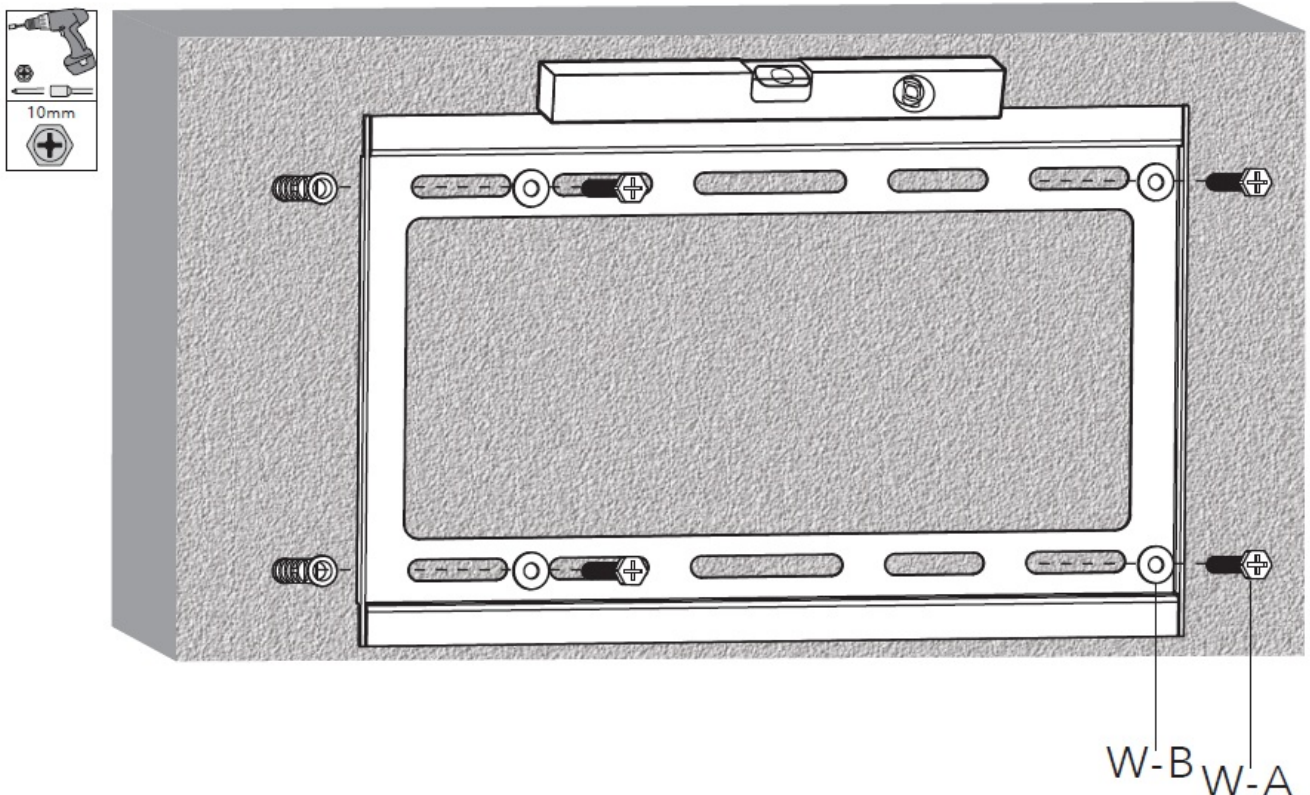

Place your TV on the mount

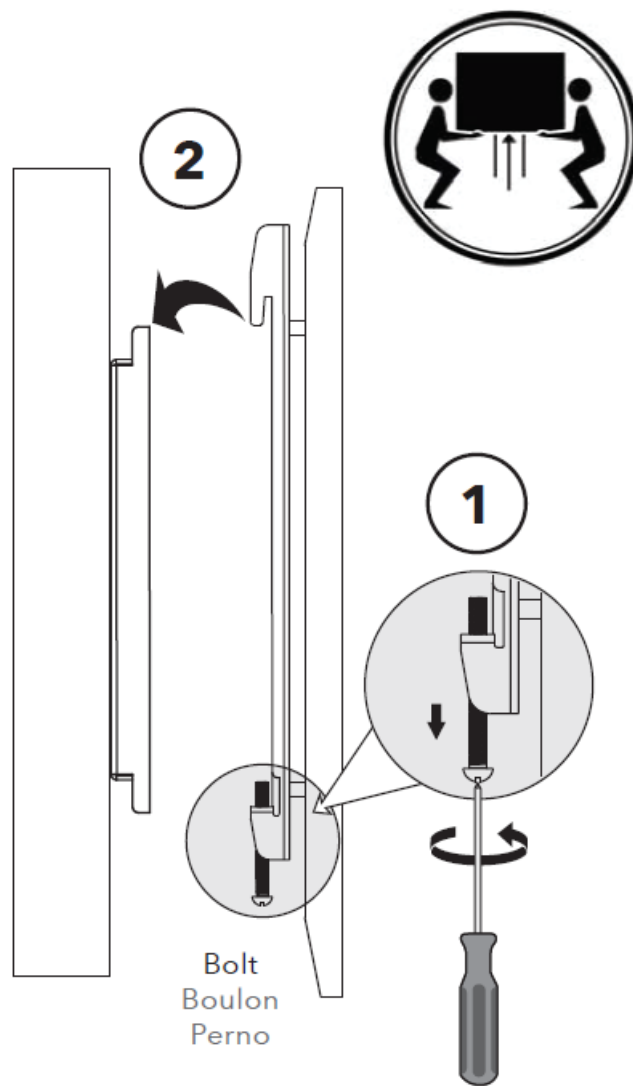

1. Unscrew the bolt at the bottom of each mounting arm so that they leave enough space to mount to the plate.
2. With the help of another person, carefully lift your TV with mounting arms attached and place it on the wall plate. Do not release the display until the mounting

Screw the bolts at the bottom of each mounting arm until they touch the wall plate. This prevents the display from being lifted from the wall plate.

IMPORTANT! These mounting bolts should be used at all times to prevent the display from being accidentally knocked from the mount.

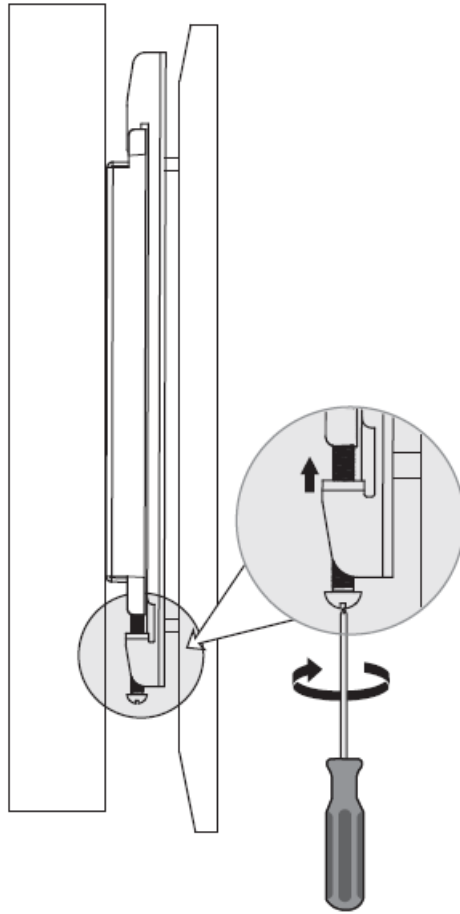

12-Month Limited Warranty

Voxx Accessories Corporation (the "Company") warrants to the original retail purchaser of this product that should this product or any part thereof, under normal use and conditions, be proven defective in material or workmanship within 12 months from the date of original purchase, such defect(s) will be repaired or replaced with new or reconditioned product (at the Company's option) without charge for parts and repair labor. To obtain repair or replacement within the terms of the warranty, the product is to be delivered with proof of warranty coverage (e.g. dated bill of sale), specification of defect(s), transportation prepaid, to an approved warranty station. For the location of the nearest warranty station to you, call toll-free to our control office: 1-800-645-4994.

This Warranty is not transferable and does not cover product purchased, serviced or used outside the United States or Canada. The Warranty does not extend to the elimination of externally generated static or noise. This Warranty does not apply to costs incurred for installation, removal or reinstallation of the product, or, if in the Company's opinion, the product has been damaged through acts of nature, alteration, improper installation, mishandling, misuse, neglect, accident, or the simultaneous use of different battery types (e.g. alkaline, standard or rechargeable). This Warranty does not cover damage caused by an AC adapter not provided with the product.

THE EXTENT OF THE COMPANY'S LIABILITY UNDER THIS WARRANTY IS LIMITED TO THE REPAIR OR REPLACEMENT PROVIDED ABOVE AND, IN NO EVENT, SHALL THE COMPANY'S LIABILITY EXCEED THE PURCHASE PRICE PAID BY PURCHASER FOR THE PRODUCT. This Warranty is in lieu of all other express warranties or liabilities. ANY IMPLIED WARRANTIES, INCLUDING ANY IMPLIED WARRANTY OF MERCHANTABILITY OR FITNESS FOR A PARTICULAR PURPOSE, SHALL BE LIMITED TO DURATION OF THIS WARRANTY. ANY ACTION FOR BREACH OF ANY WARRANTY HEREUNDER, INCLUDING ANY IMPLIED WARRANTY, MUST BE BROUGHT WITHIN A PERIOD OF 24 MONTHS FROM THE DATE OF ORIGINAL PURCHASE. IN NO CASE SHALL THE COMPANY BE LIABLE FOR ANY CONSEQUENTIAL OR INCIDENTAL DAMAGES WHATSOEVER.

No person or representative is authorized to assume for the Company any liability other than expressed herein in

connection with the sale of this product.
Some states/provinces do not allow limitations on how long an implied warranty lasts or the exclusion or limitation of incidental or consequential damage so the above limitations or exclusions may not apply to you. This Warranty gives you specific legal rights and you may also have other rights which vary from state/province to state/province.

Documents / Resources

	<p>RCA MC1337F Fixed Universal TV Wall Mount [pdf] Installation Guide MC1337F, Fixed Universal TV Wall Mount, TV Wall Mount</p>
---	---

References

- [RCAAudiovideo.com](#)