



**V8 Small
Block
Engine Bay**



RC4WD V8 Small Block Engine Bay Instruction Manual

[Home](#) » [RC4WD](#) » RC4WD V8 Small Block Engine Bay Instruction Manual 

Contents

- [1 RC4WD V8 Small Block Engine Bay](#)
- [2 Chevrolet Blazer and K10](#)
- [3 Tips for Assembly](#)
- [4 Warranty](#)
- [5 Parts List](#)
- [6 Dress Up Kit for Chevrolet Blazer and K10](#)
- [7 Warranty](#)
- [8 Accessories for Chevrolet Blazer and K10](#)
- [9 Warranty](#)
- [10 Documents / Resources](#)
 - [10.1 References](#)



RC4WD V8 Small Block Engine Bay



Chevrolet Blazer and K10

Instruction Manual Symbols Key



CA Glue



Drill Hole



Cut with Scissors



Trim with Hobby Knife



Paint



Body Reamer



Attention

Recommended Tools

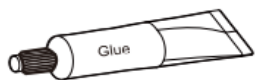

(Foam safe CA, Shoe Goo, E6000, Styrene Glue, Epoxy)



Hex Drivers (1.5mm, 2mm)

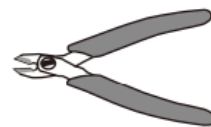

Side Cutters



Hobby Knife

Tips for Assembly

- Use good quality hex drivers to avoid stripping screw heads.
- Use "Step" index for quantity and size of hardware to be used for assembly.
- Do not overtighten screws.

Recommendations for building your Dress up Kit for Engine Bay.

1. Carefully remove all pieces from parts trees with a hobby knife or side cutters. Take care to trim the injection point from the parts.
2. Test fit everything before gluing. Many areas will require extra attention to detail to ensure proper alignment.

Warranty

RC4WD non-electrical products are warranted to be free of defects in materials and workmanship when new. Our limited warranty does not cover damages due to normal wear and tear, user error of assembly or installation, user modifications, user's failure to perform routine maintenance, addition of aftermarket parts or option parts. This warranty lasts 30 days after arrival for original purchaser. In the event of a defect under this warranty, RC4WD will, at our discretion, replace the product, provided our inspection indicates that an original defect exists. RC4WD reserves the right to replace any product which is no longer available with a product of comparable value and function. If RC4WD determines the repair is not covered under warranty guidelines, we will contact you to discuss your options. If you have any questions, please contact us via email at support@rc4wd.com. RC4WD warranties its electronics for 30 days from date of arrival. This covers all electrical items except items that are already noted on the individual product page.

Parts List

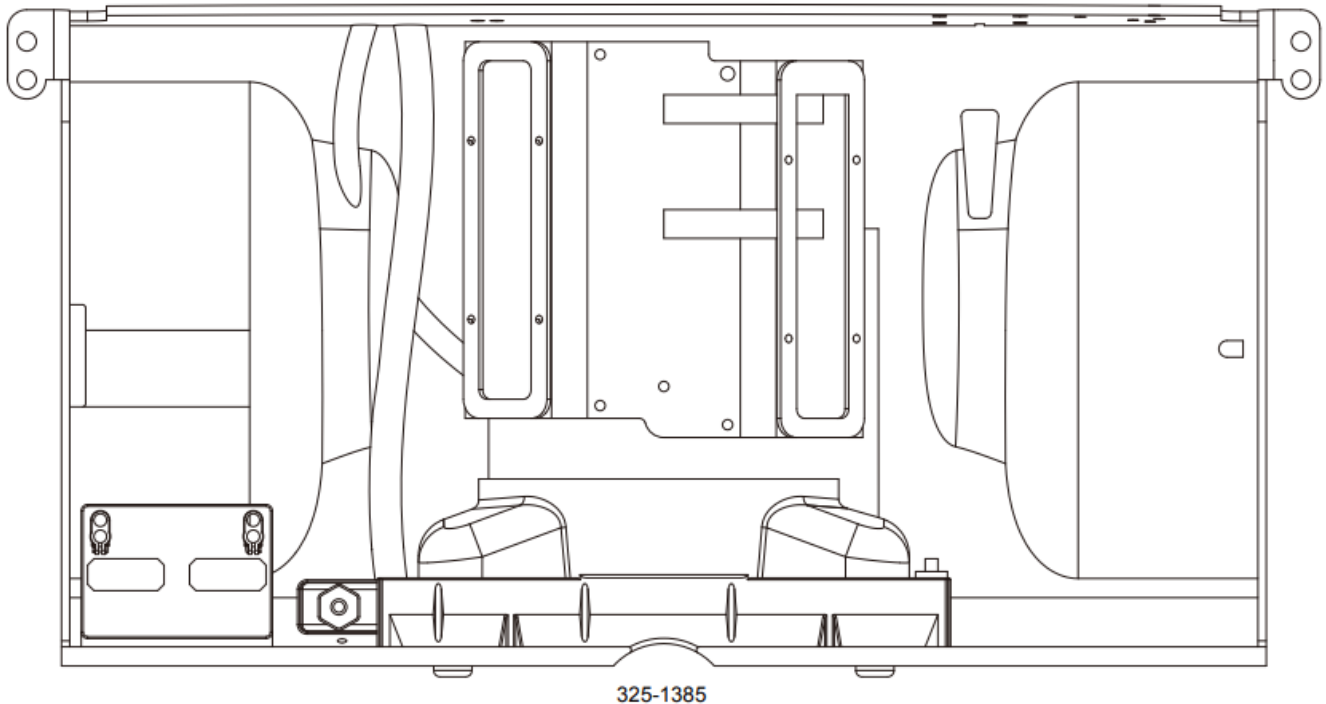



325-1386



325-1387

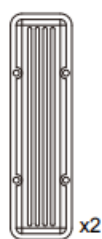

x2

325-1388

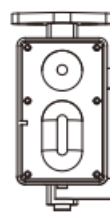

325-1389



325-1390



325-1391



325-1392

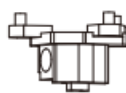

325-1393

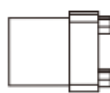

325-1394



325-1395



325-1396



325-1397

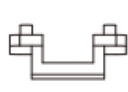

325-1398



325-1399



325-1400



325-1401



325-1402



Z-S2052
M1.6 x 4mm SHSTS



M2x4mm
Cross Round HSTS



Z-S1124
M1.6 x 4mm Hex Bolts



Z-S1759
M1.6 x 5mm Hex Bolts



Z-S1802
M2 x 4mm Hex Bolts



Z-S1196
M2 x 6mm Hex Bolts



Nylon gasket
M2.5x5x0.5mm



Z-S1328
Hex Bolt Tool for M1.6
Scale Bolts (1.5 mm Hex)



Z-S0626
Miniature Scale Hex
Bolt Tool (M2 Hex)

Step 1.

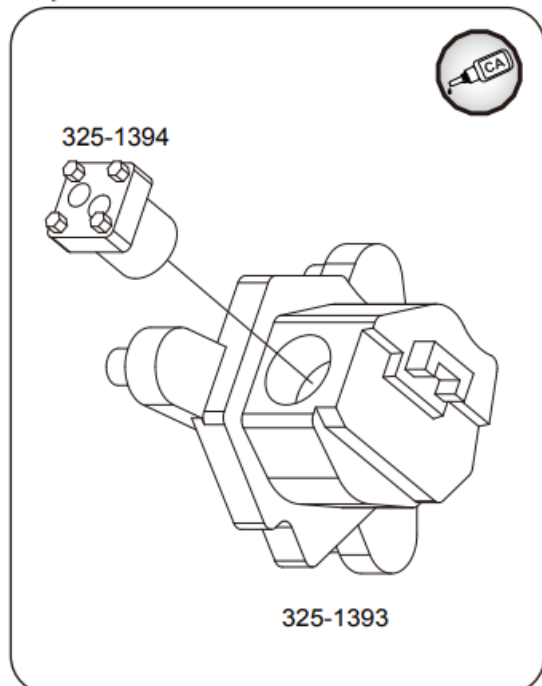

Step 2.

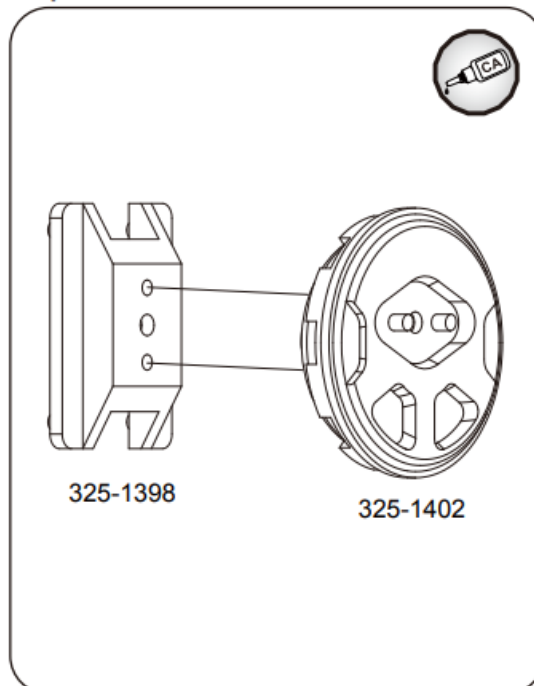

Step 3.

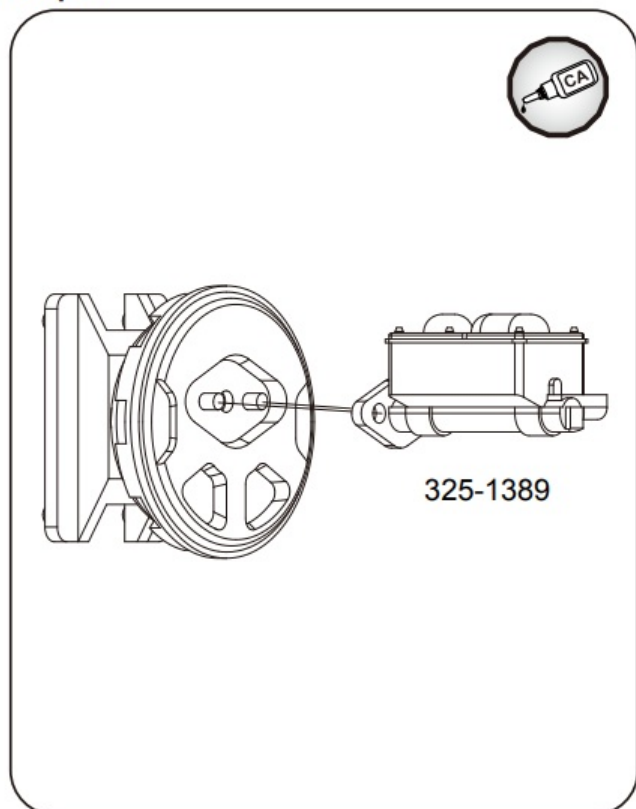

Step 4.

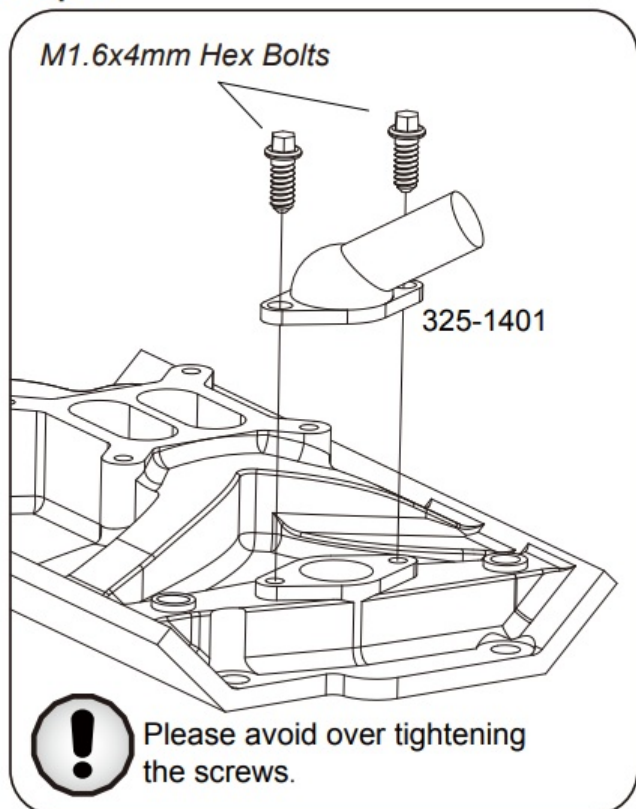

Step 5.

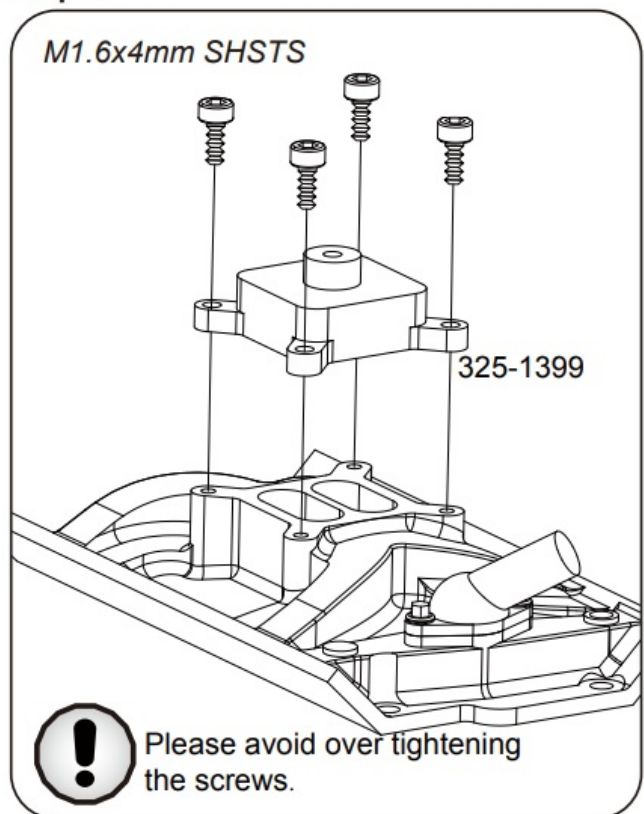

Step 6.

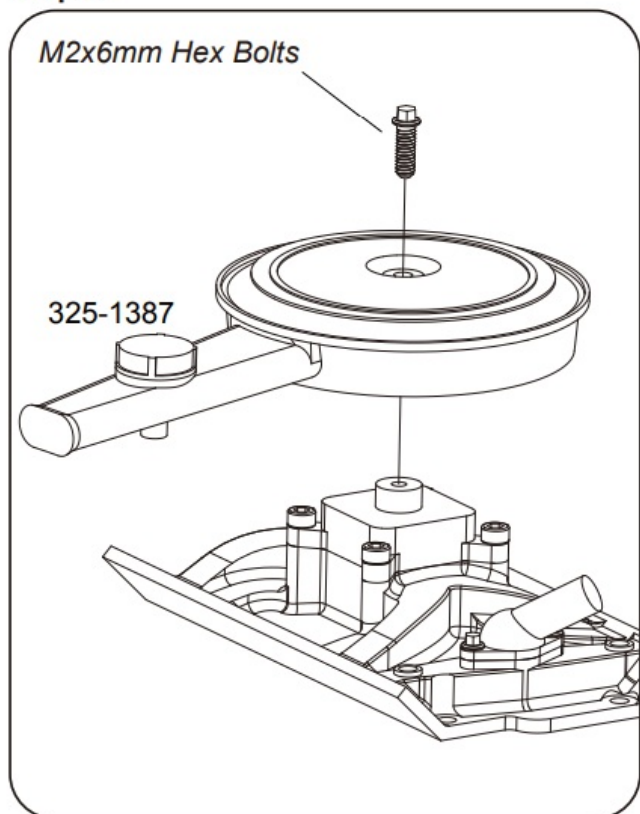

Step 7.

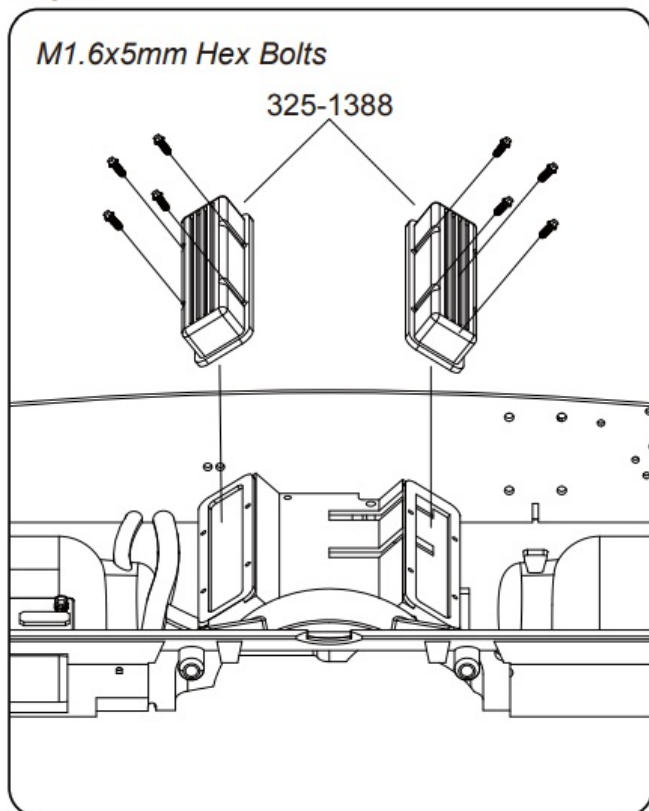

Step 8.

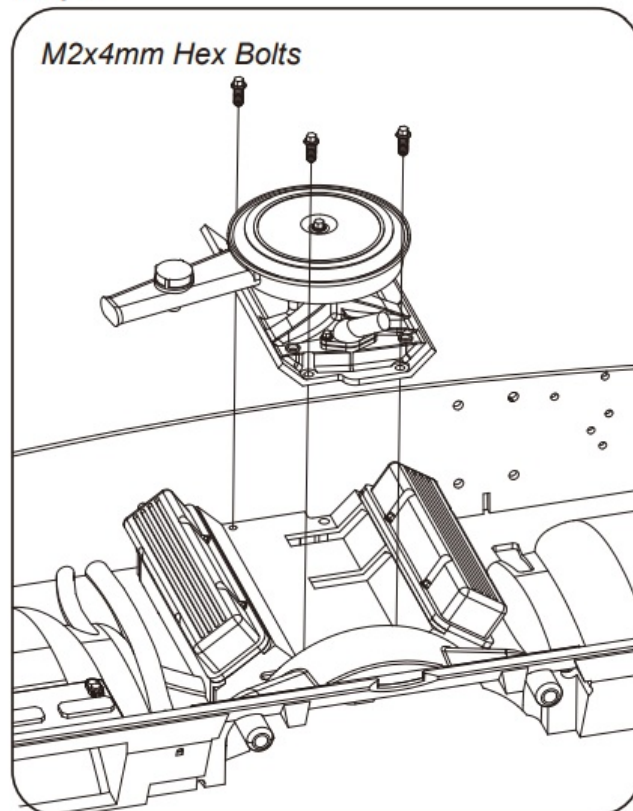

Step 9.

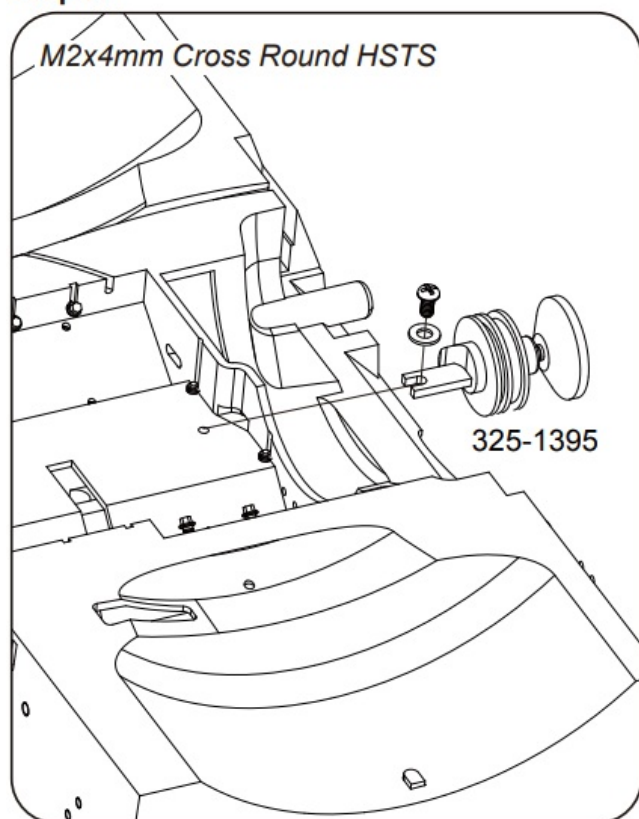

Step 10.

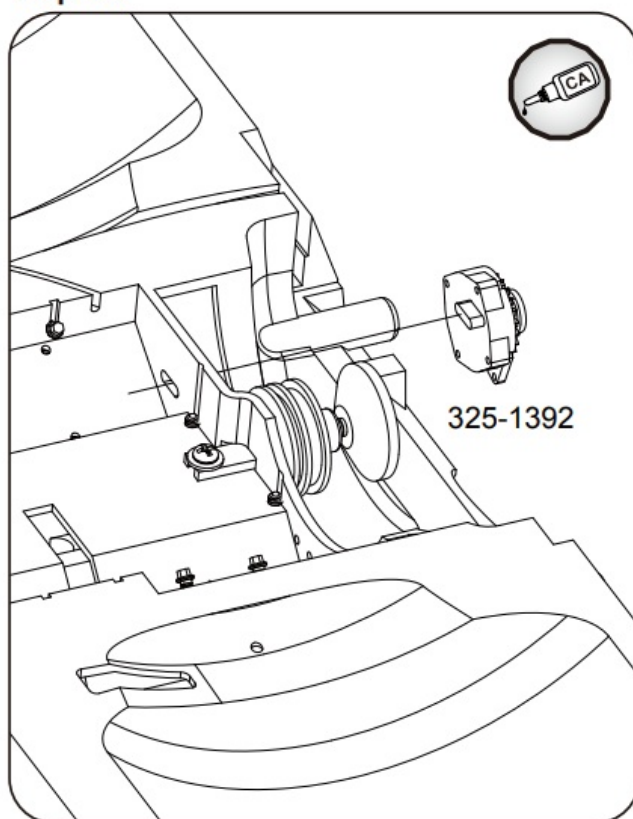

Step 11.

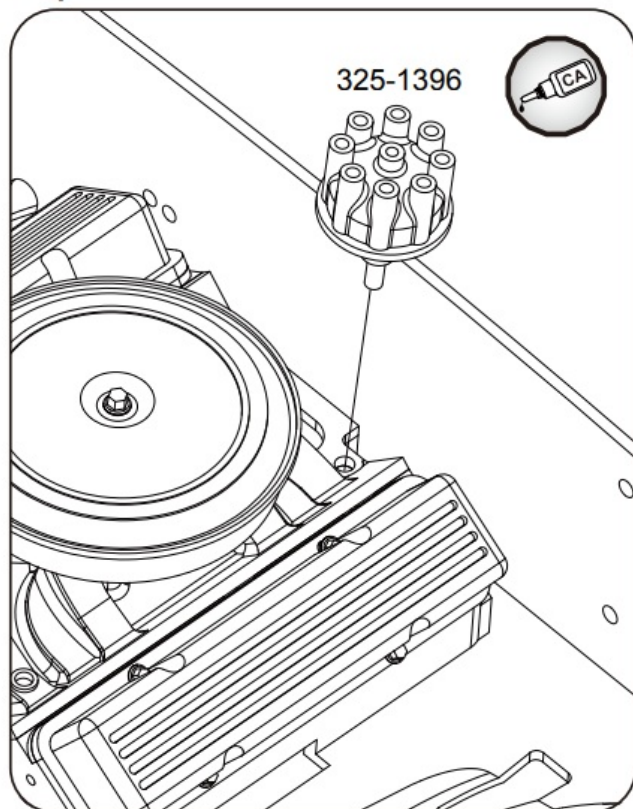

Step 12.

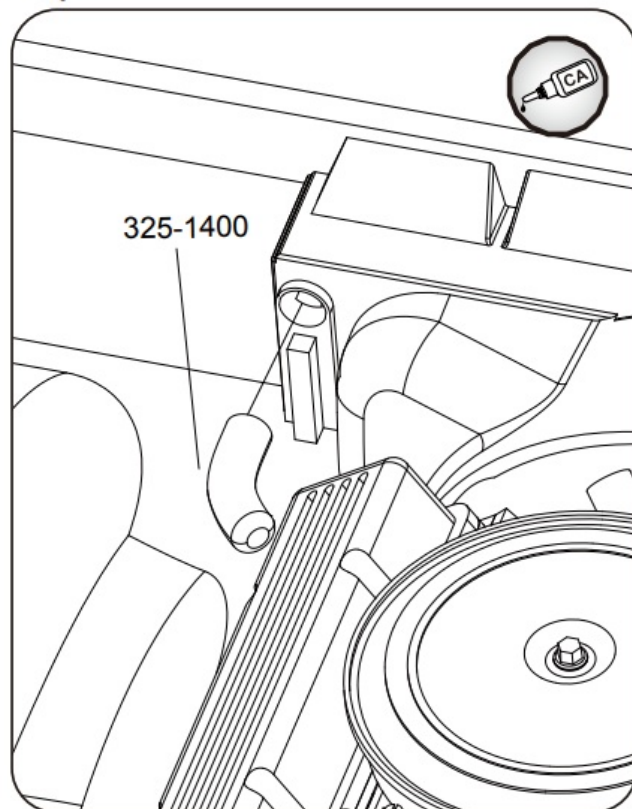

Step 13.

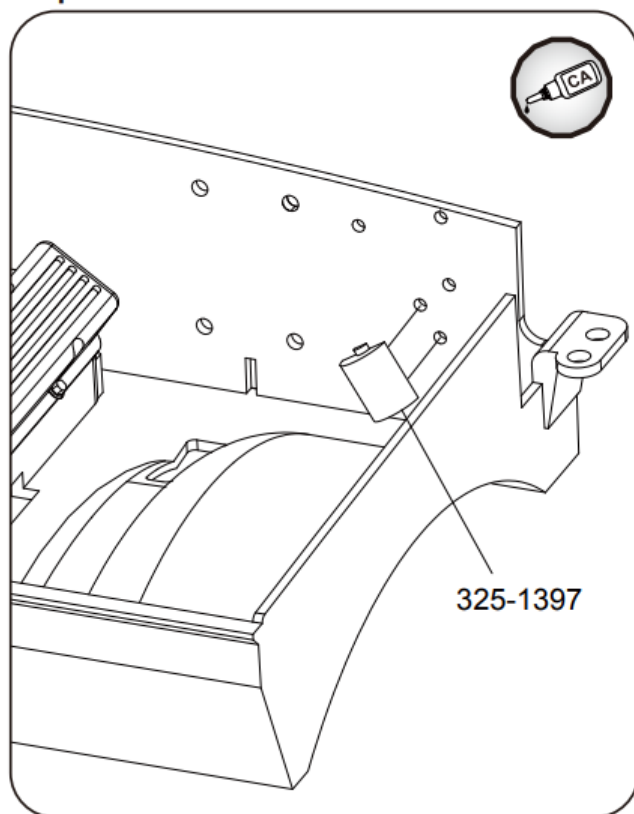

Step 14.

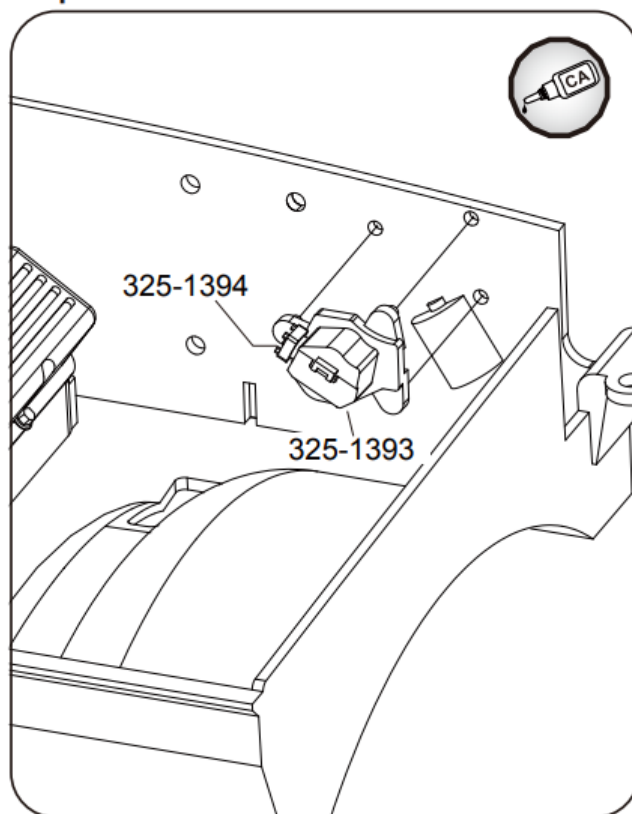

Step 15.

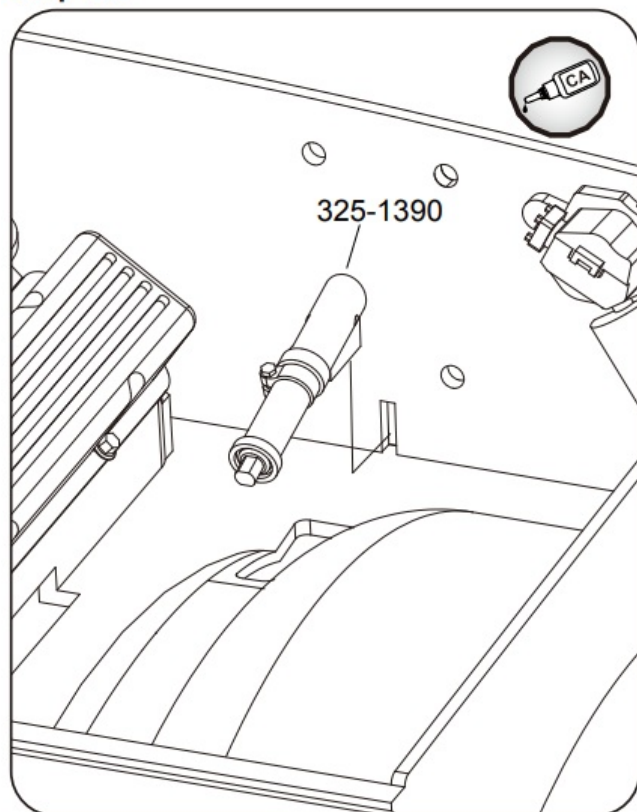

Step 16.

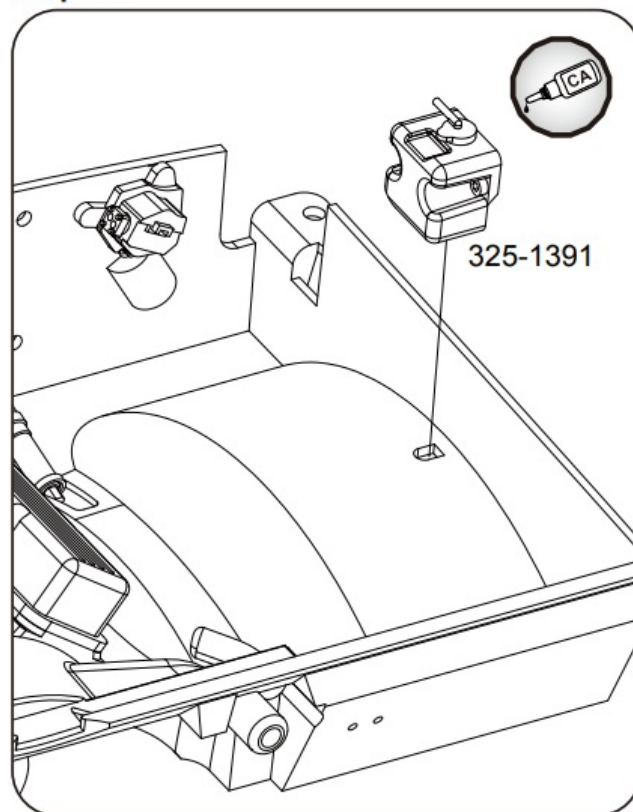

Step 17.

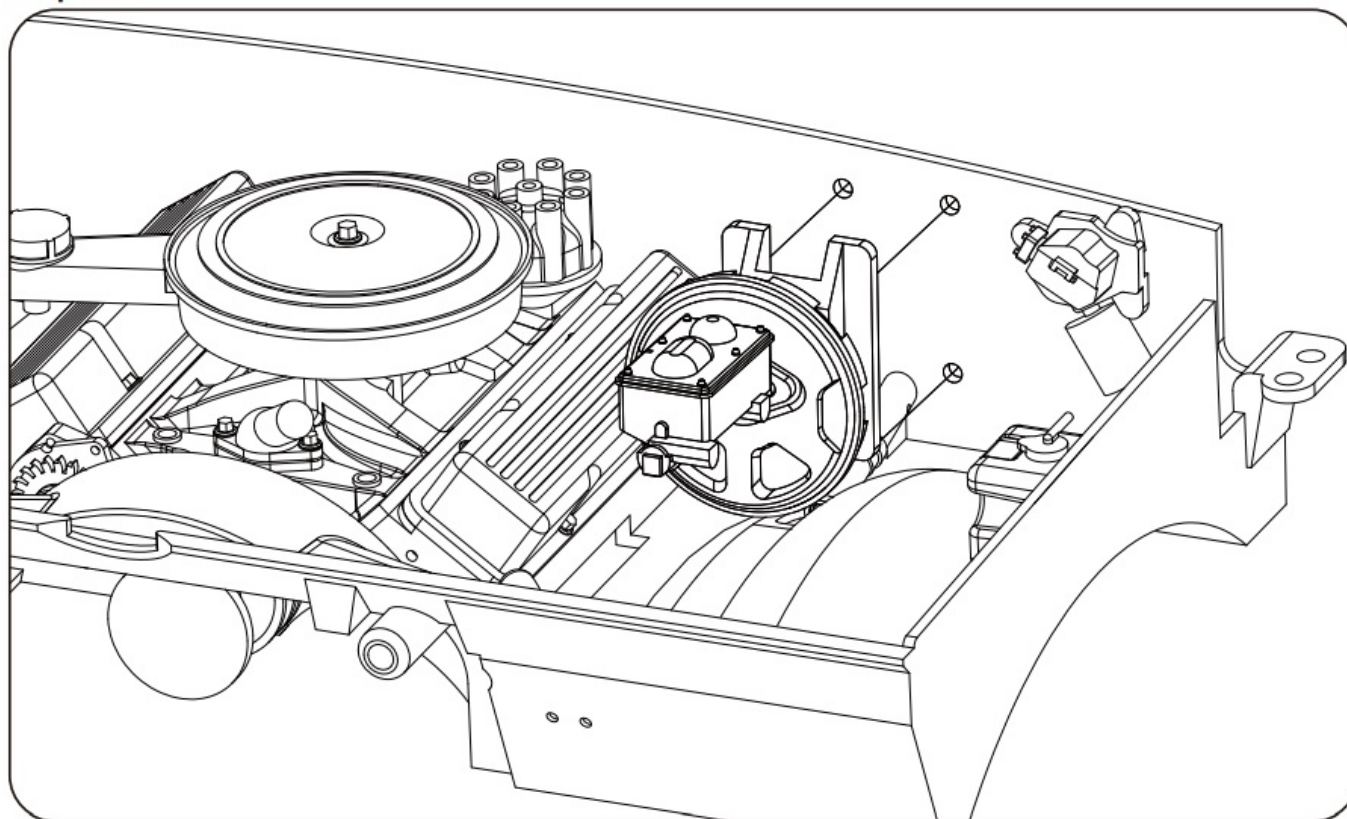

Step 18.

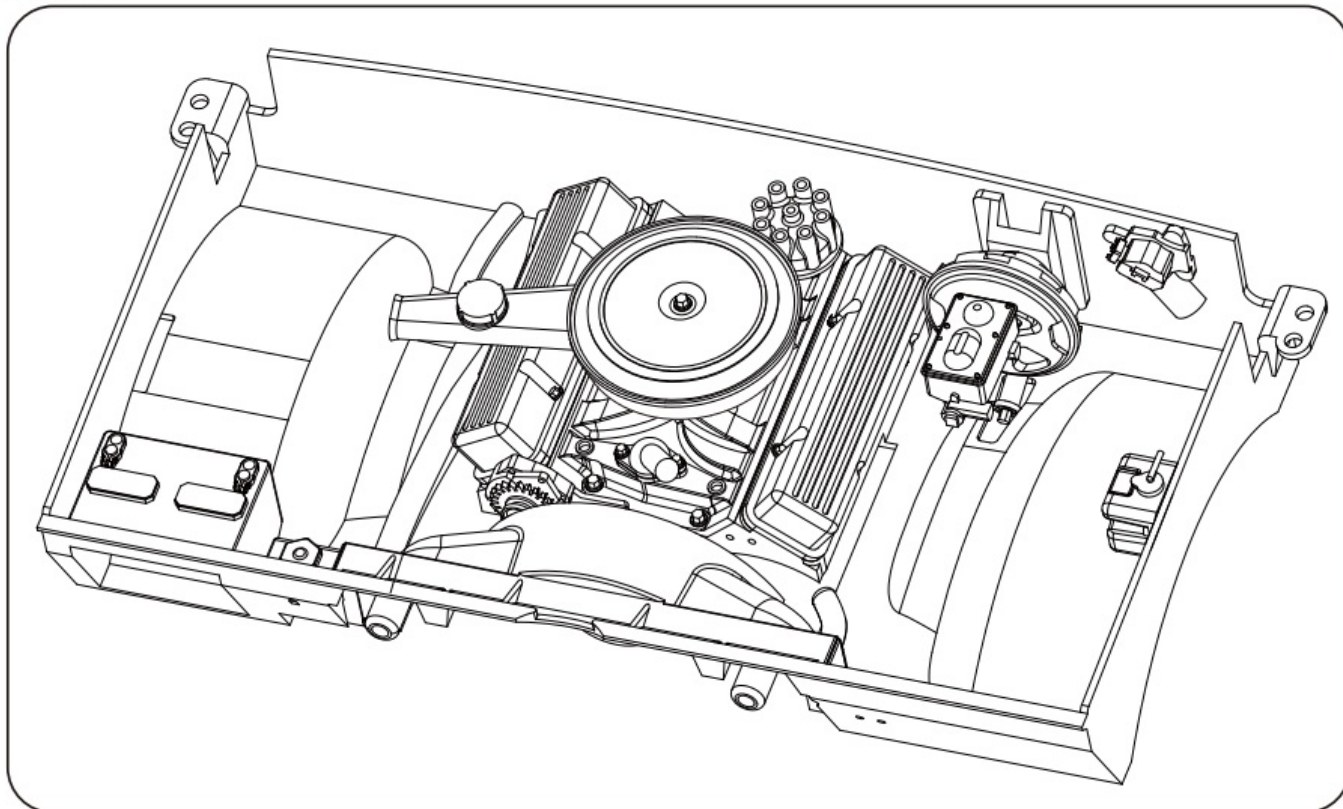

Dress Up Kit for Chevrolet Blazer and K10

Instruction Manual Symbols Key



CA Glue



Drill Hole



Cut with Scissors



Trim with Hobby Knife



Paint



Body Reamer



Attention

Recommended Tools

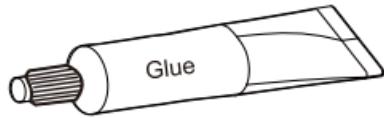

(Foam safe CA, Shoe Goo, E6000, Styrene Glue, Epoxy)

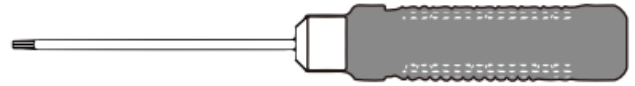

Hex Drivers (1.5mm, 2mm)

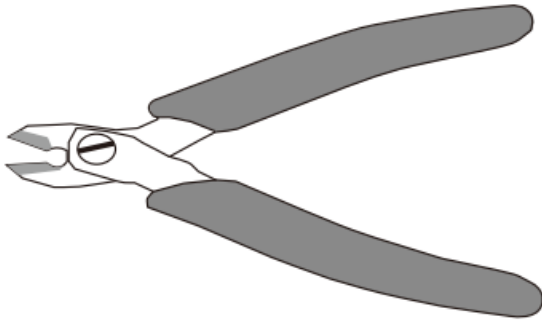

Side Cutters



Hobby Knife

Tips for Assembly

- Use good quality hex drivers to avoid stripping screw heads.
- Use "Step" index for quantity and size of hardware to be used for assembly
- Do not overtighten screws.

Recommendations for building your Dress up Kit for Engine Bay.

1. Carefully remove all pieces from parts trees with a hobby knife or side cutters. Take care to trim the injection point from the parts.
2. Test fit everything before gluing. Many areas will require extra attention to detail to ensure proper alignment.

Warranty

RC4WD non-electrical products are warranted to be free of defects in materials and work-manship when new. Our limited warranty does not cover damages due to normal wear and tear, user error of assembly or installation, user modifications, user's failure to perform routine maintenance, addition of aftermarket parts or option parts. This warranty lasts 30 days after arrival for original purchaser. In the event of a defect under this warranty, RC4WD will, at our discretion, replace the product, provided our inspection indicates that an original defect exists. RC4WD reserves the right to replace any product which is no longer available with a product of comparable value and function. If RC4WD determines the repair is not covered under warranty guidelines, we will contact you to discuss your options. If you have any questions, please contact us via email at sup-port@rc4wd.com. RC4WD warranties its electronics for 30 days from date of arrival. This covers all electrical items except items that are already noted on the individual product page.

Parts List



750-0068



Z-S1759
M1.6 x 5mm Hex Bolts



HSHS
M1.6 X 6mm



Z-S1328
Hex Bolt Tool for M1.6
Scale Bolts (1.5 mm Hex)



0.7mmx11mm hex L-shaped wrench

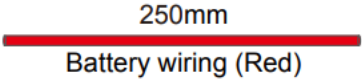
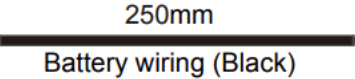
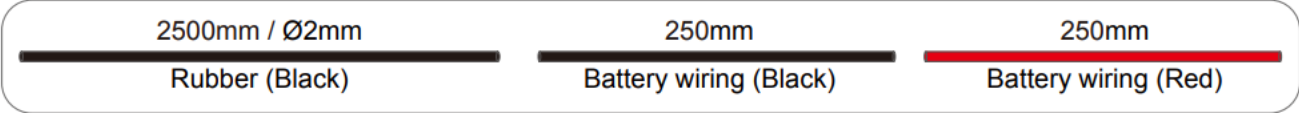
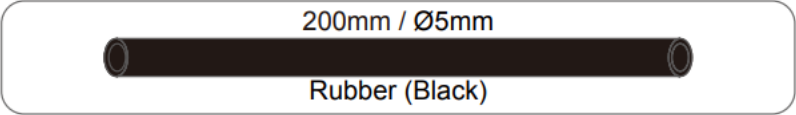

Step 1.

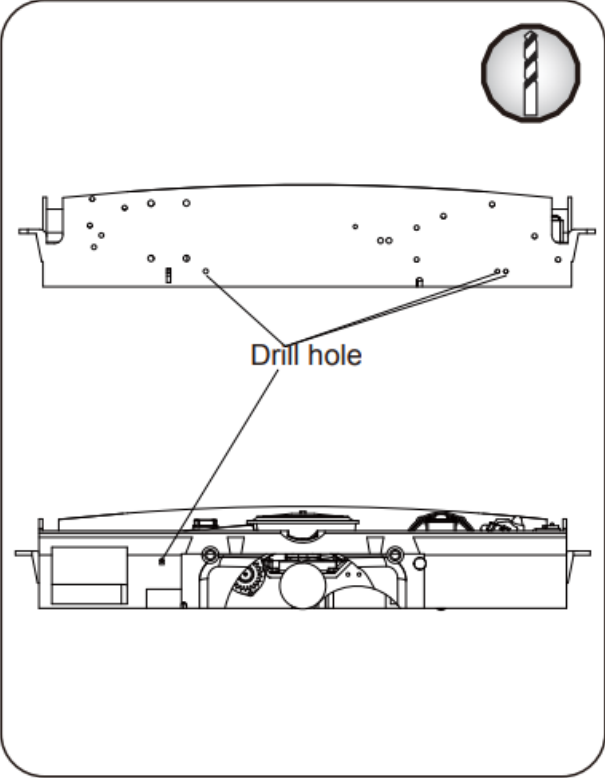

Step 2.

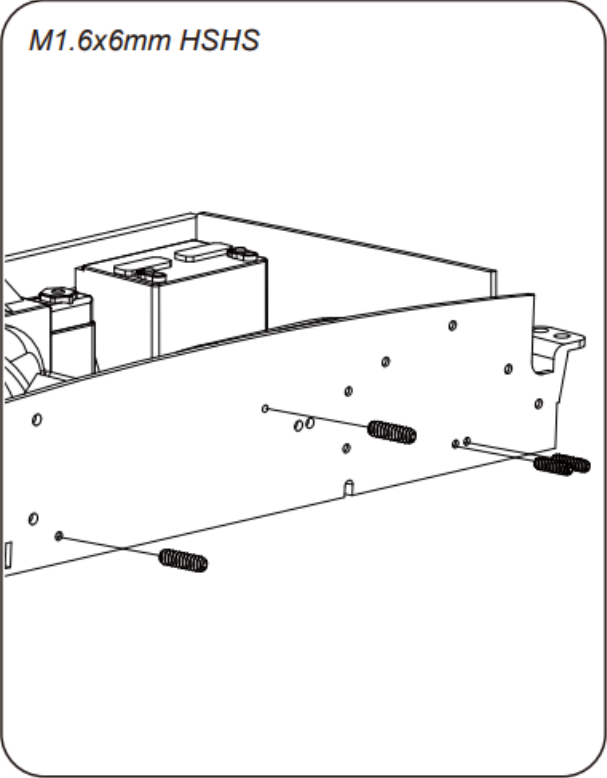

Step 3.

M1.6x6mm Set Screws

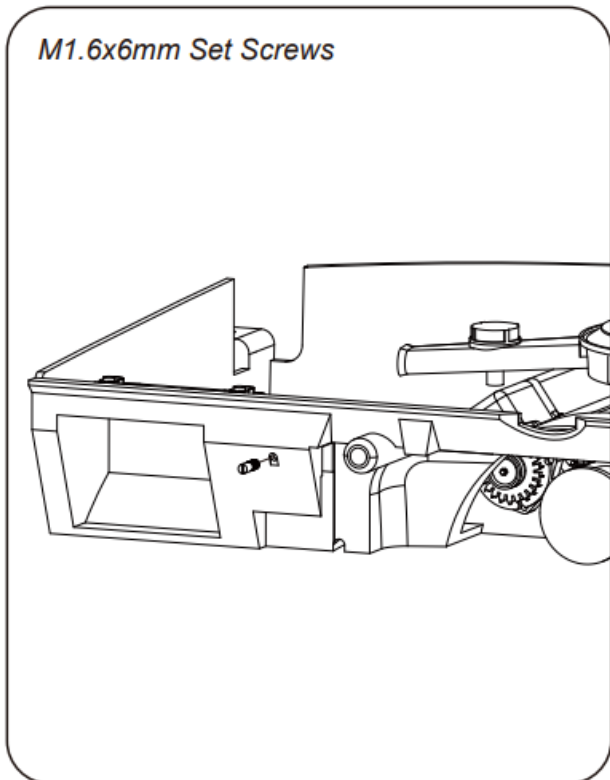

Step 4.

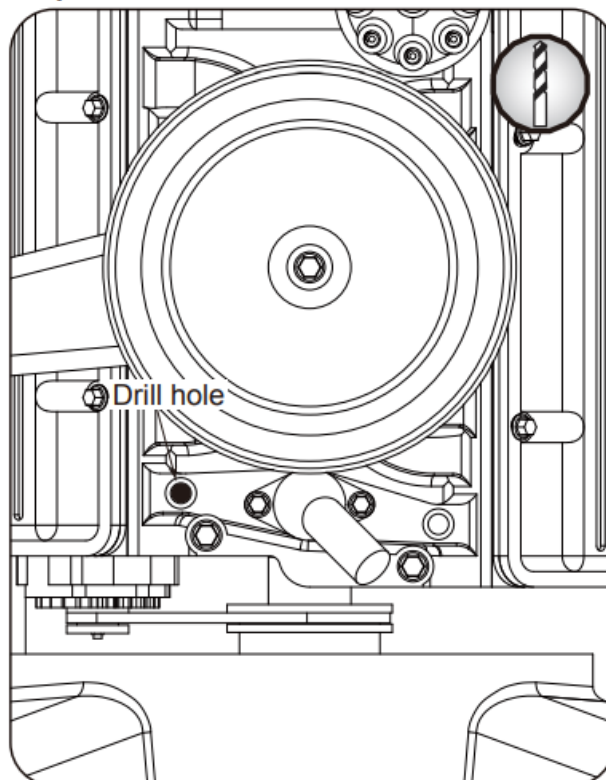

Step 5.

M1.6x6mm HSHS

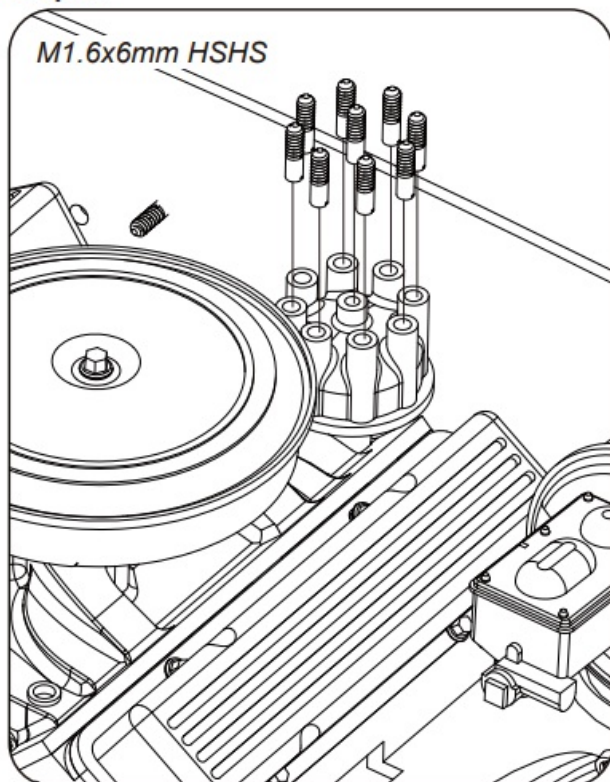

Step 6.

M1.6x4mm Hex Bolts

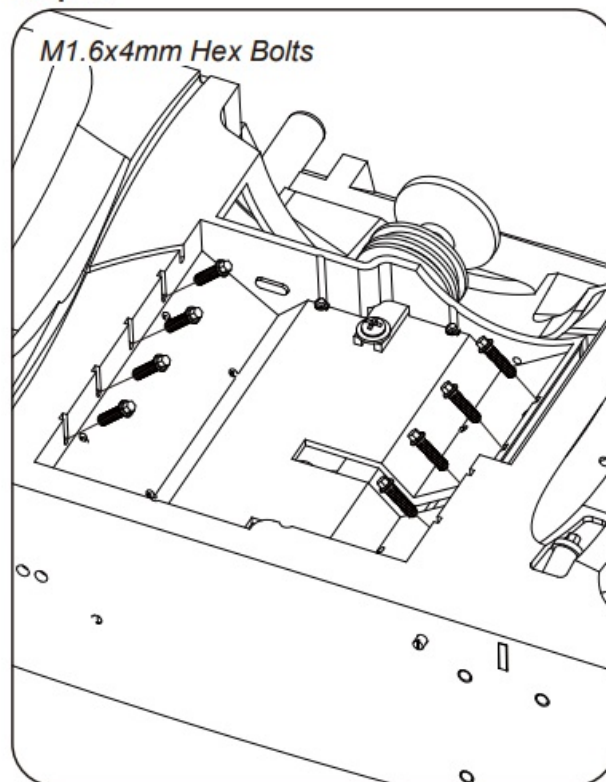

Step 7.

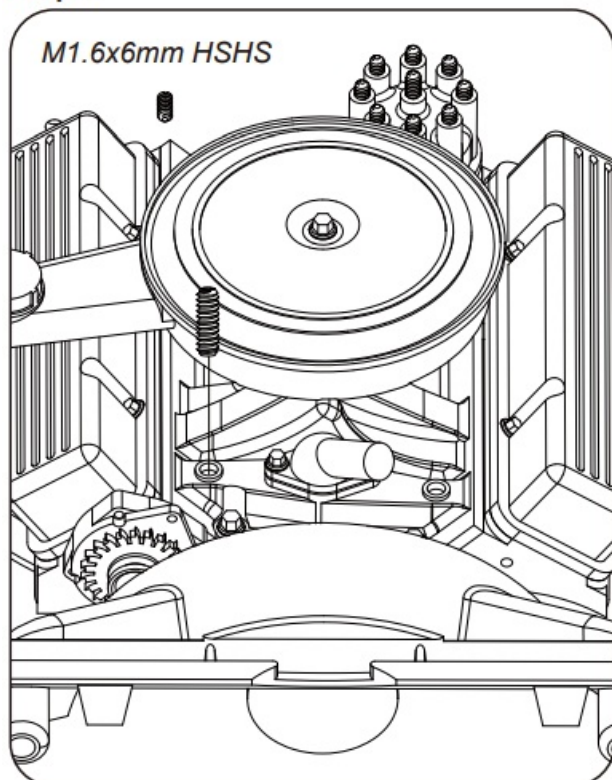

Step 8.

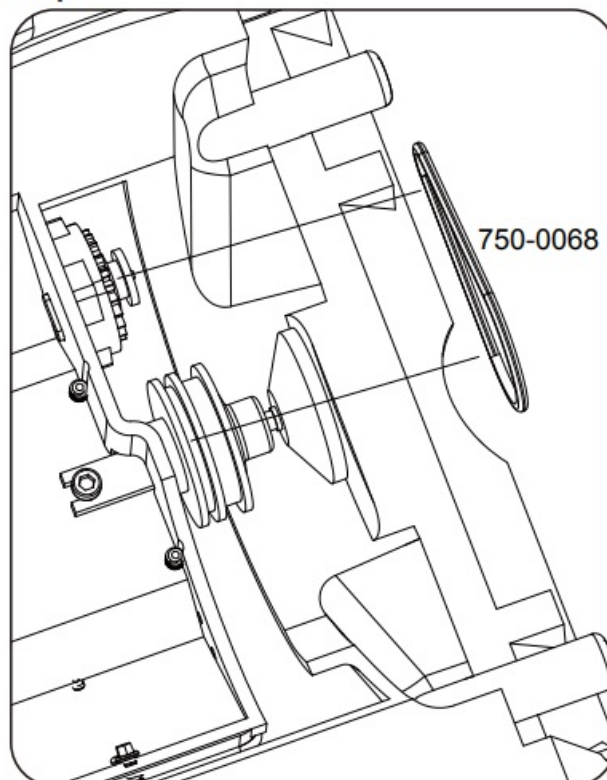

Step 9. *The length is for reference only.*

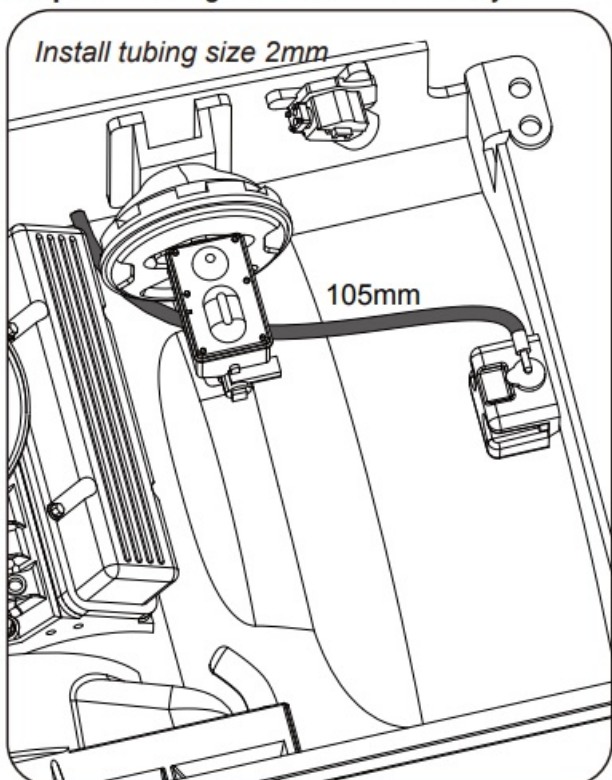

Step 10. *The length is for reference only.*

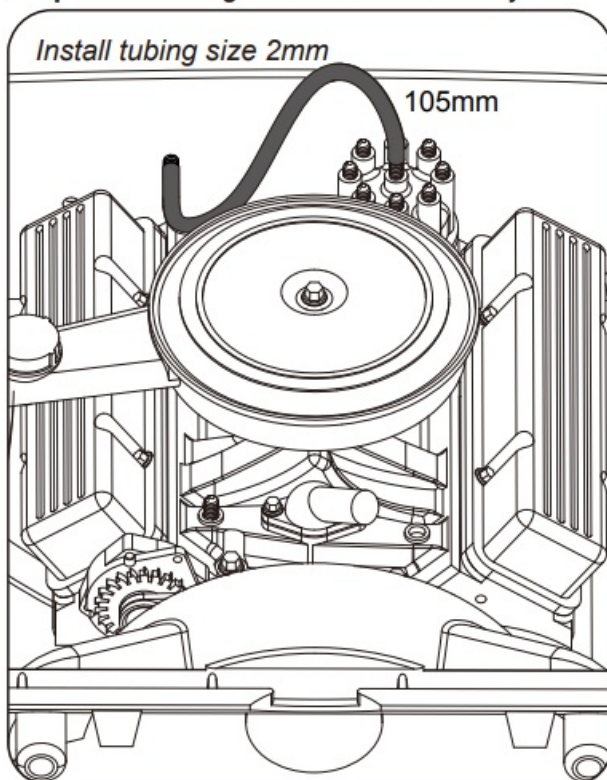

Step 11. *The length is for reference only.*

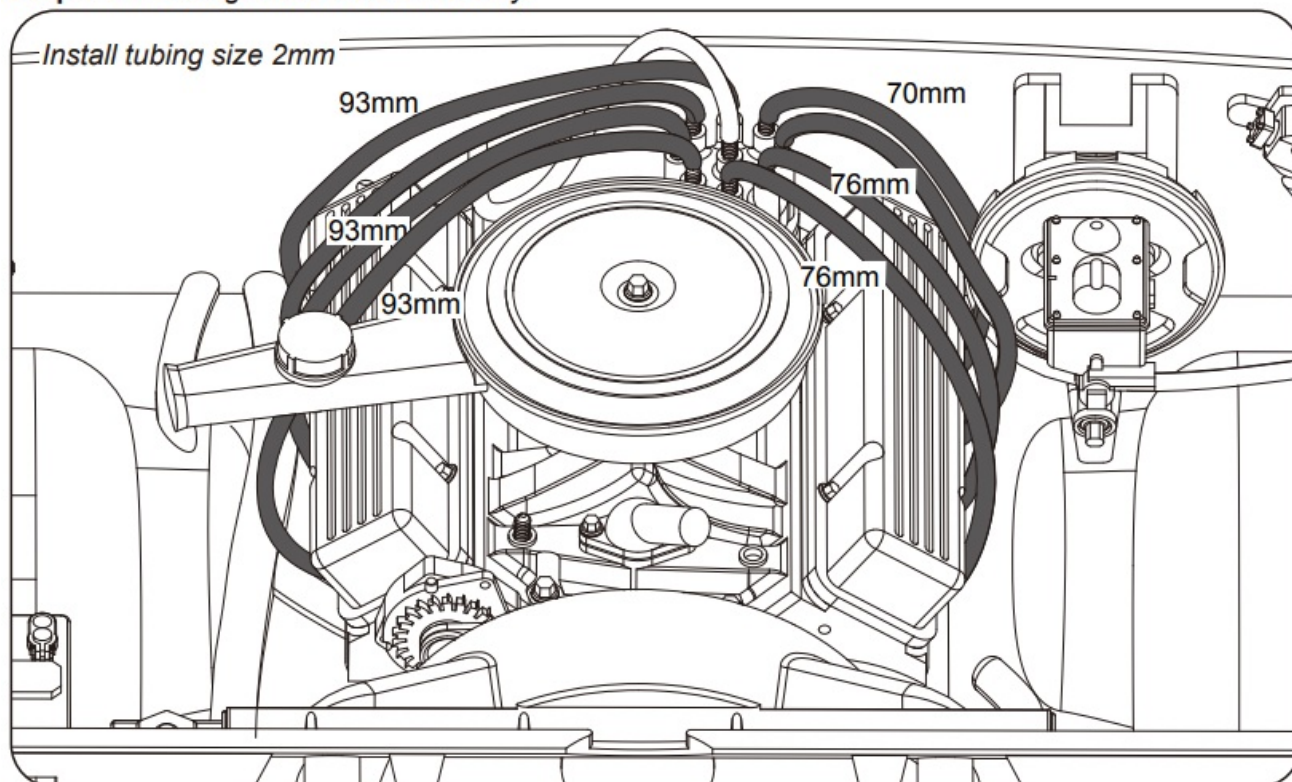

Step 12. *The length is for reference only.*

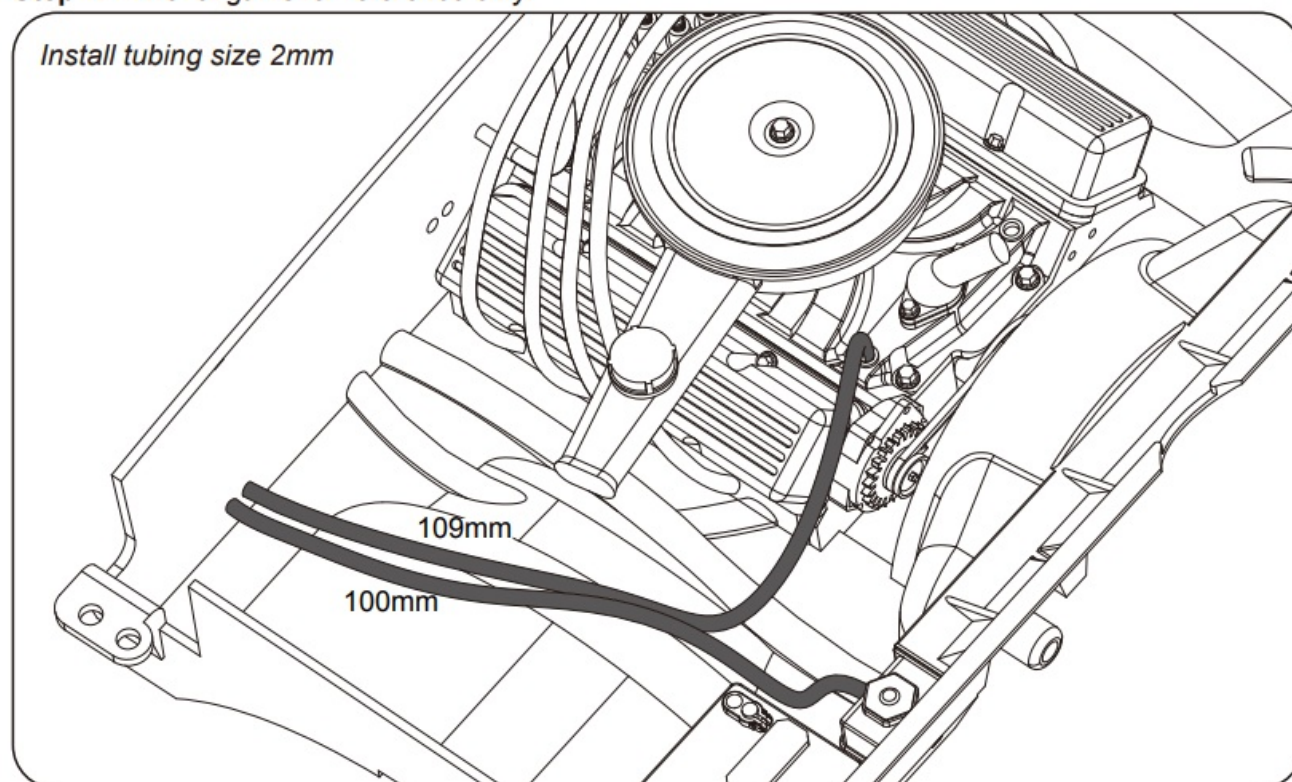

Step 13. *The length is for reference only.*

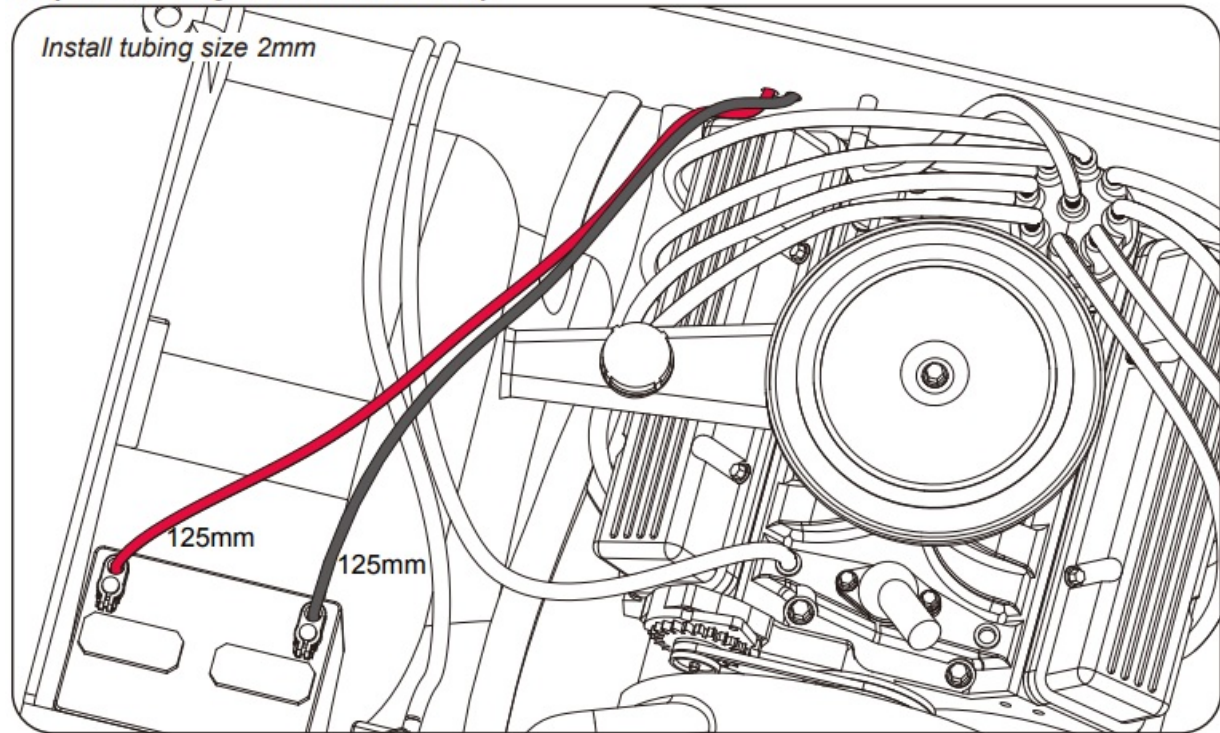

Step 14. *The length is for reference only.*

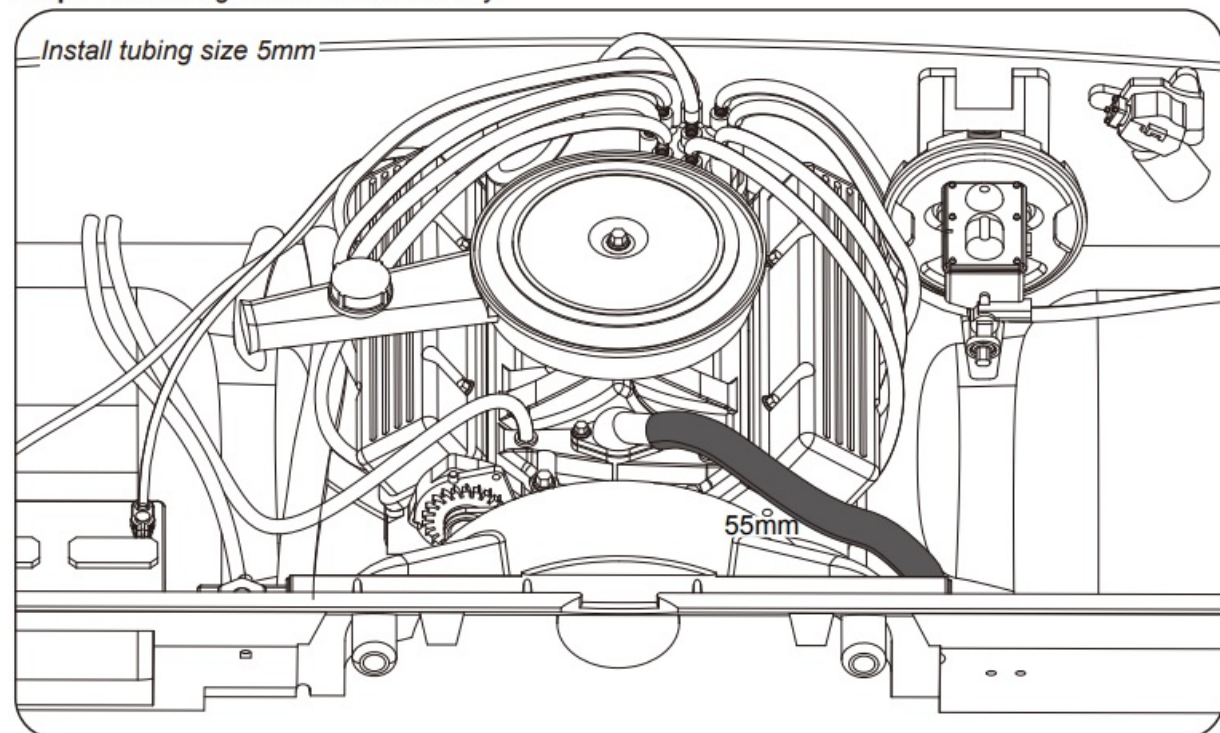

Step 15.

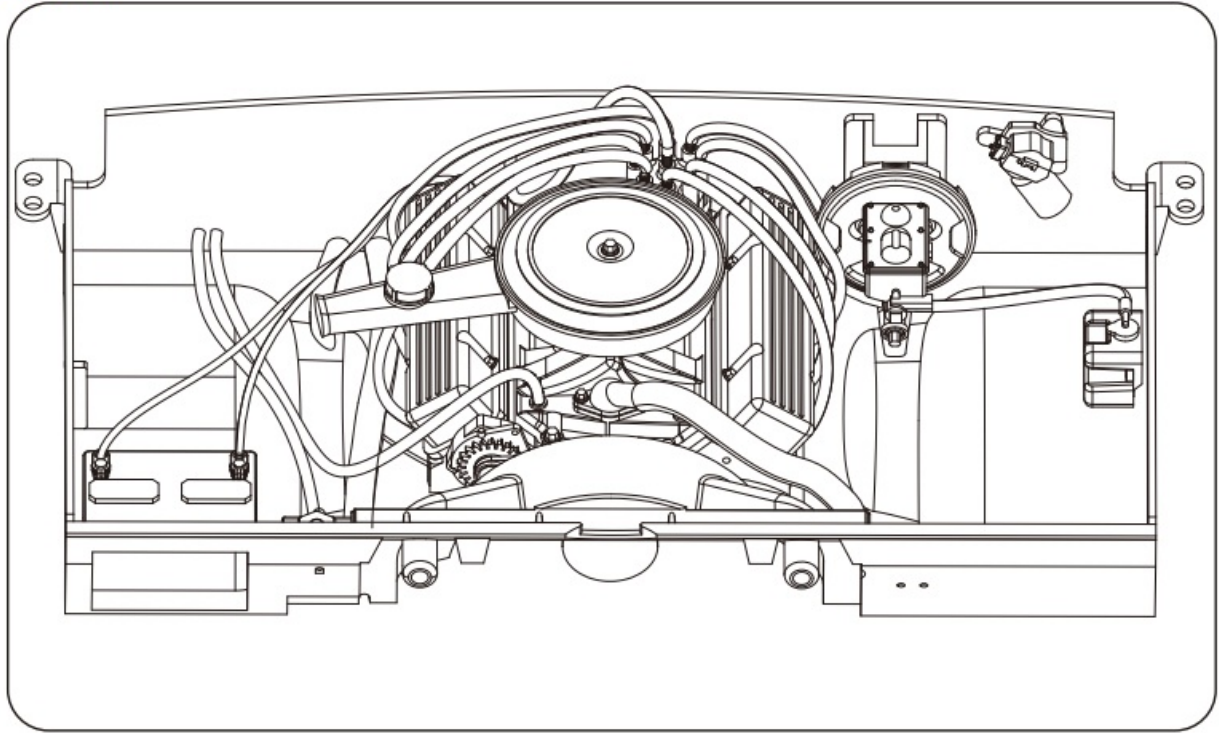

- Due to some parts needing to be permanently glued in place, we recommend that the RC4WD Small Block V8 Engine Bay Dress Up Kit for Chevrolet Blazer and K10 (Z-S0205) be purchased and installed first.

Accessories for Chevrolet Blazer and K10

Instruction Manual Symbols Key



CA Glue



Drill Hole



Cut with Scissors



Trim with Hobby Knife



Paint



Body Reamer



Attention

Recommended Tools



(Foam safe CA, Shoe Goo, E6000, Styrene Glue, Epoxy)

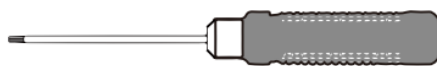

Hex Drivers (1.5mm, 2mm)

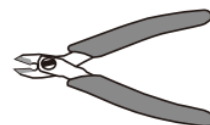

Side Cutters



Hobby Knife

Tips for Assembly

- Use good quality hex drivers to avoid stripping screw heads.
- Use the “Step” index for the quantity and size of hardware to be used for assembly.
- Do not overtighten screws.

Recommendations for building your Dress-up Kit for Engine Bay.

1. Carefully remove all pieces from parts trees with a hobby knife or side cutters. Take care to trim the injection point from the parts.
2. Test fit everything before gluing. Many areas will require extra attention to detail to ensure proper alignment.
3. Paint 3d printed parts and allow 1 day of drying time before installing.

Warranty

RC4WD non-electrical products are warranted to be free of defects in materials and workmanship when new. Our limited warranty does not cover damages due to normal wear and tear, user error of assembly or installation, user modifications, user's failure to perform routine maintenance, the or addition of aftermarket parts or option parts. This warranty lasts 30 days after arrival for the original purchaser. In the event of a defect under this warranty, RC4WD will, at our discretion, replace the product, provided our inspection indicates that an original defect exists. RC4WD reserves the right to replace any product that is no longer available with a product of comparable value and function. If RC4WD determines the repair is not covered under warranty guidelines, we will contact you to discuss your options. If you have any questions, please contact us via email at support@rc4wd.com. RC4WD warrants its electronics for 30 days from the date of arrival. This covers all electrical items except items that are already noted on the individual product page.

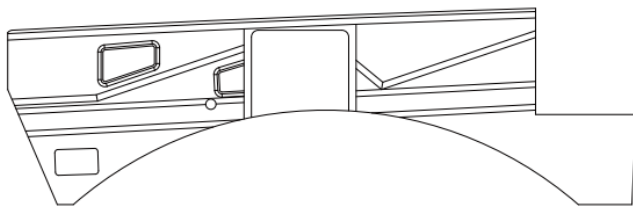

400-0094

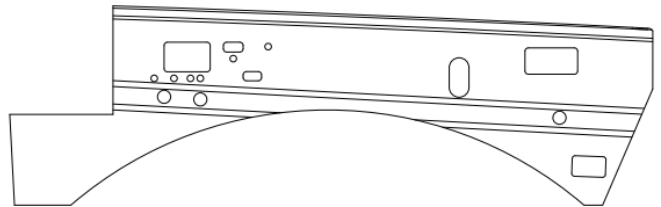

400-0095

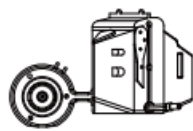

400-0096



400-0097

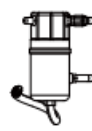

400-0098

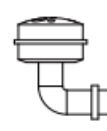

400-0099

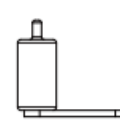

400-0100



400-0101



400-0102

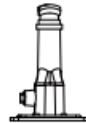

400-0103



400-0104



400-0105

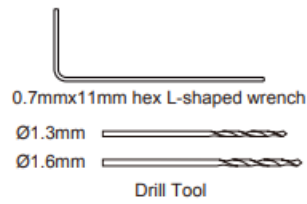

Drill Tool



400-0106



400-0107



Z-S0423
M2 x 8mm Hex Bolts



Z-S1124
M1.6 x 4mm Hex Bolts



Z-S1516
M2 x 4mm FHCS



HSHS
M1.6 X 6mm



1.9 x 45mm
Rubber Band



Z-S1328
Hex Bolt Tool for M1.6
Scale Bolts (1.5 mm Hex)



Z-S0626
Miniature Scale Hex
Bolt Tool (M2 Hex)

500mm / Ø2mm

Rubber (Black)

Step 1.

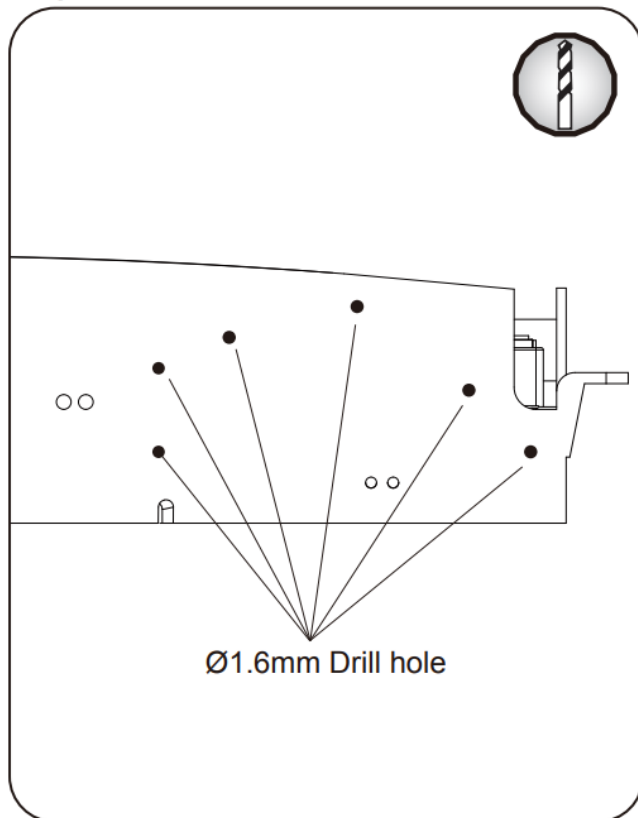

Step 2.

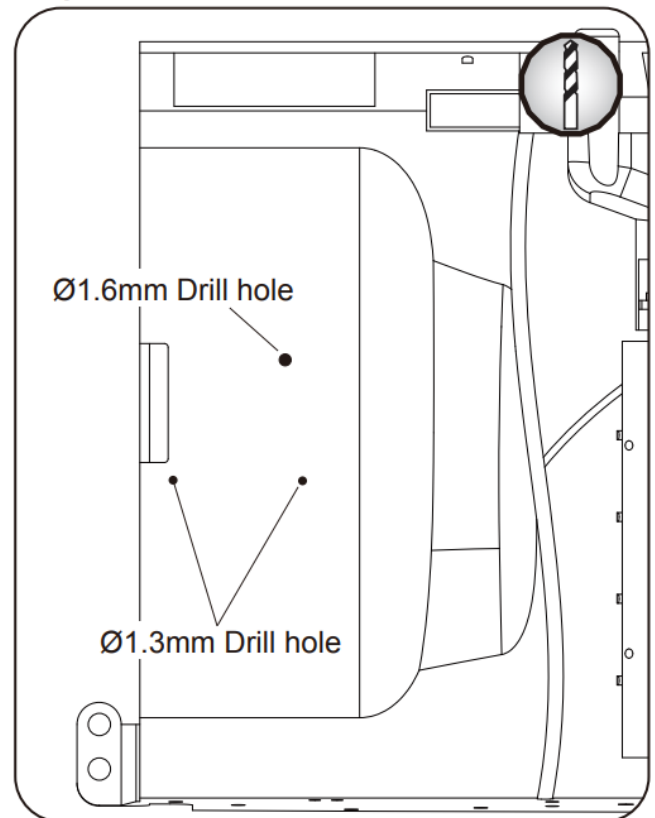

Step 3.

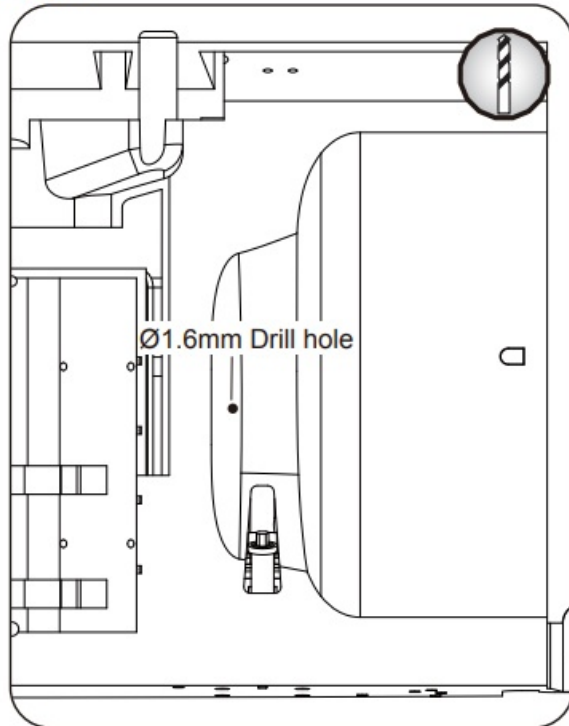

Step 4.

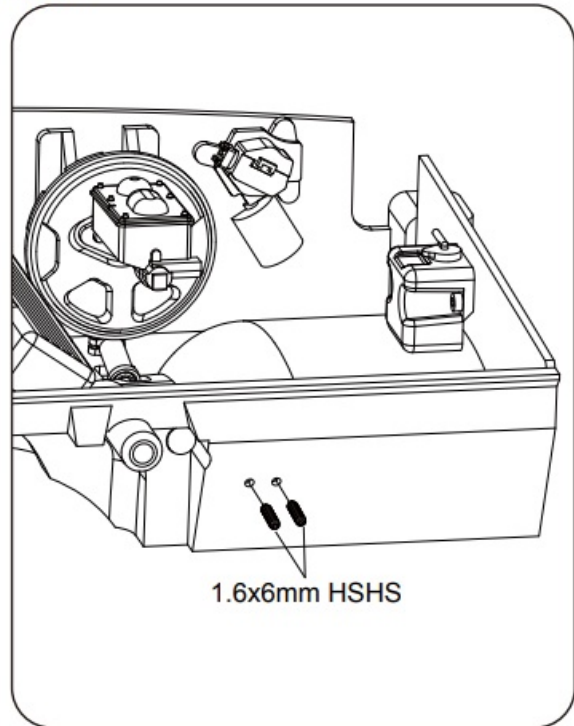

Step 5.

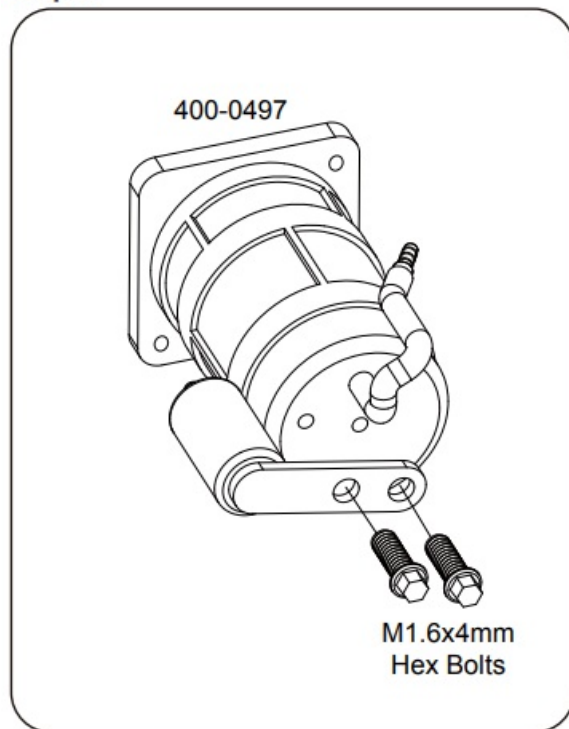

Step 6.

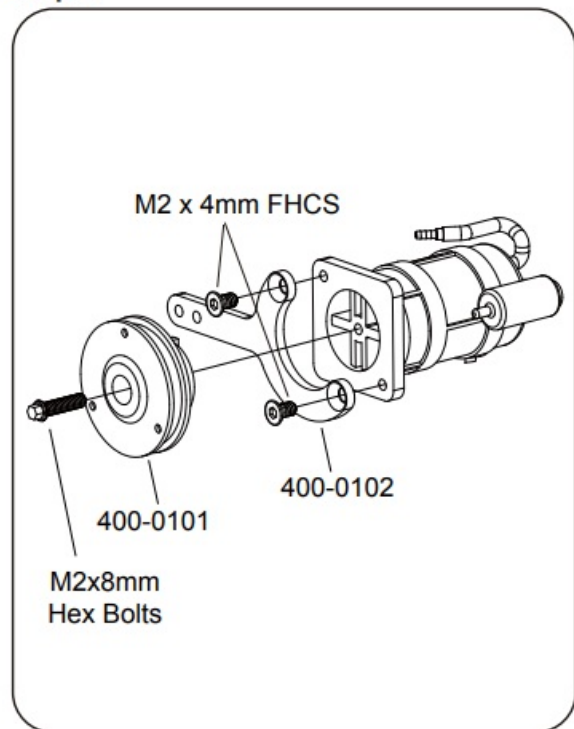

Step 7.

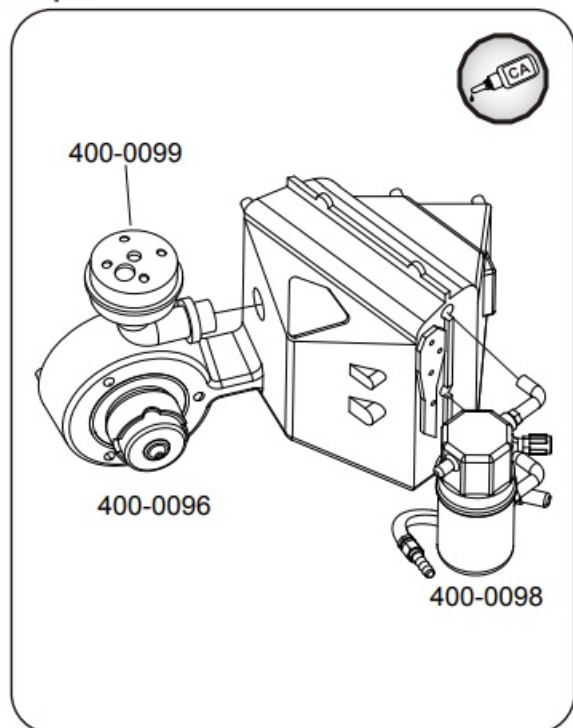

Step 8.

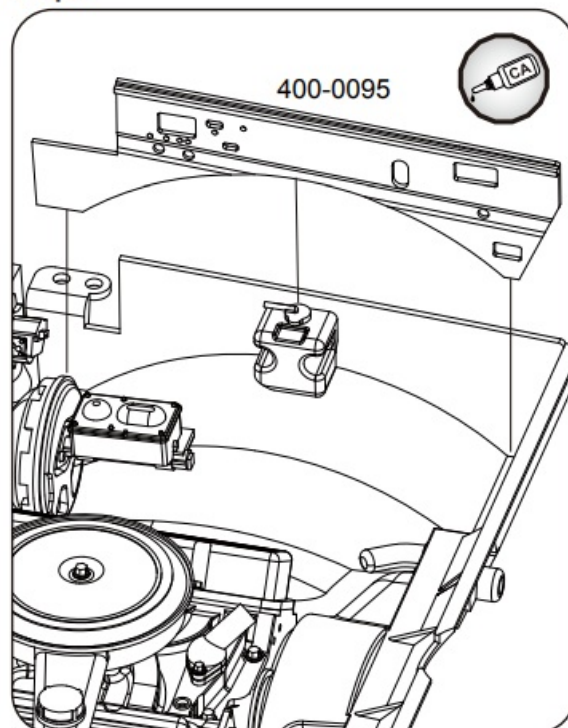

Step 9.

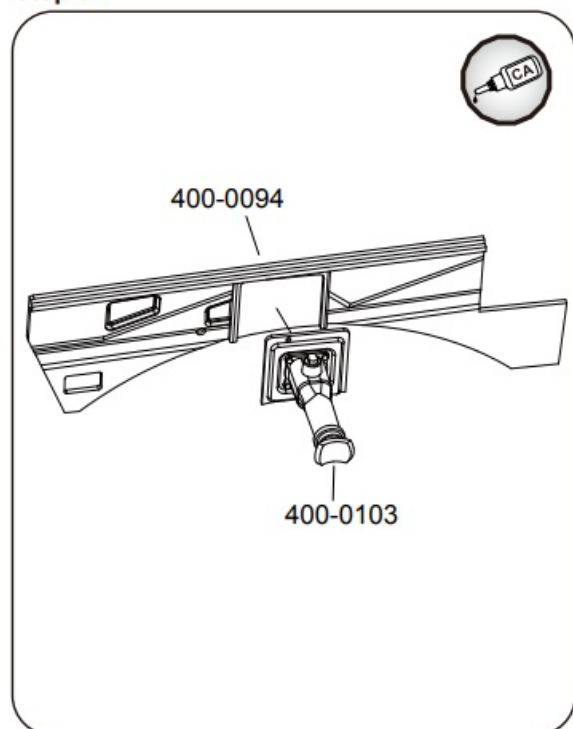

Step 10.

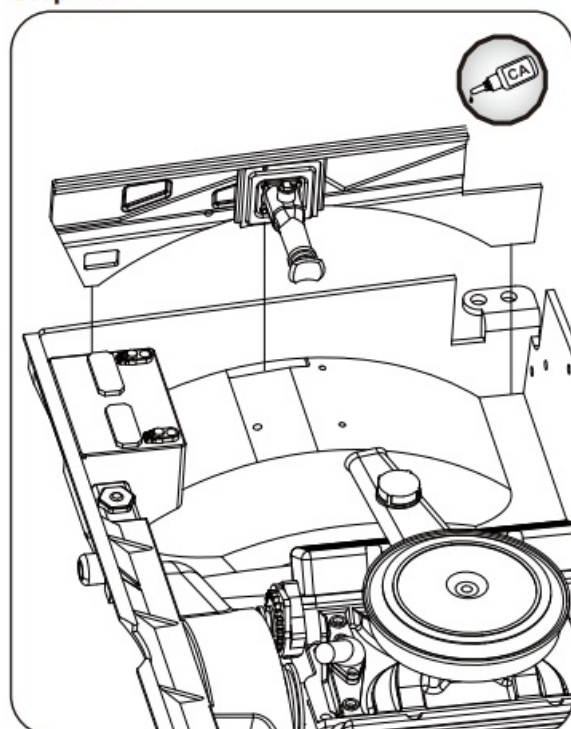

Step 11.

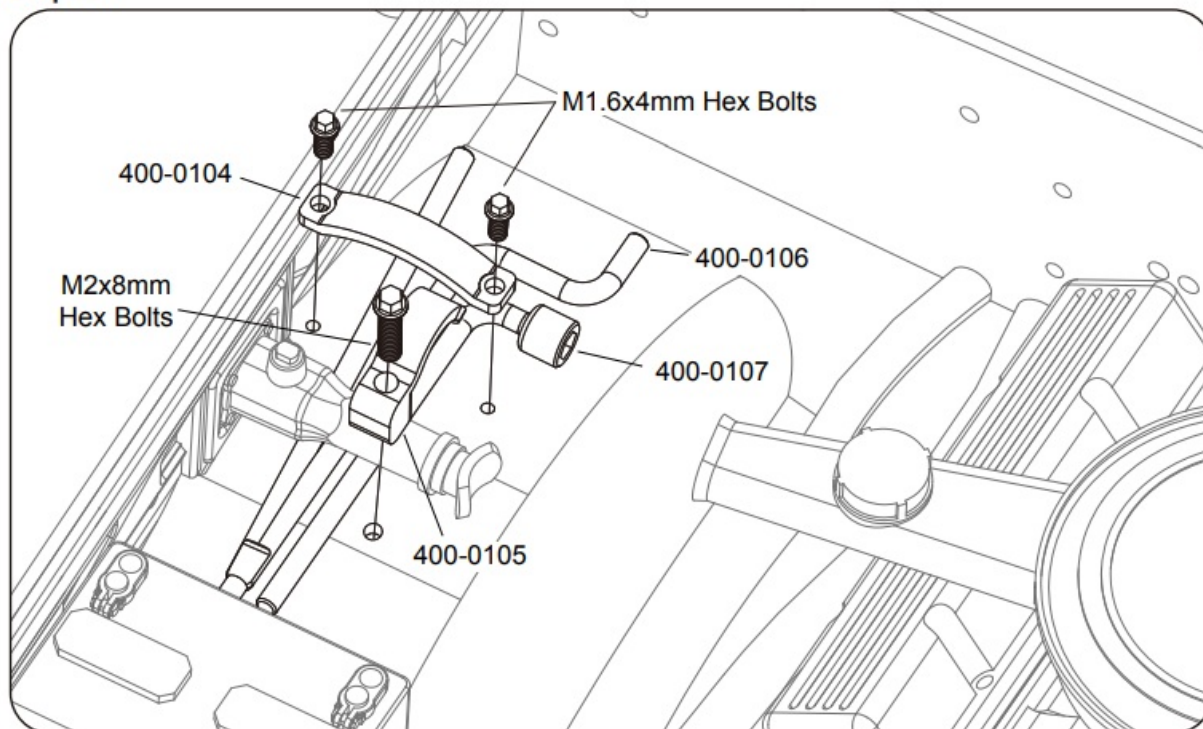

Step 12.

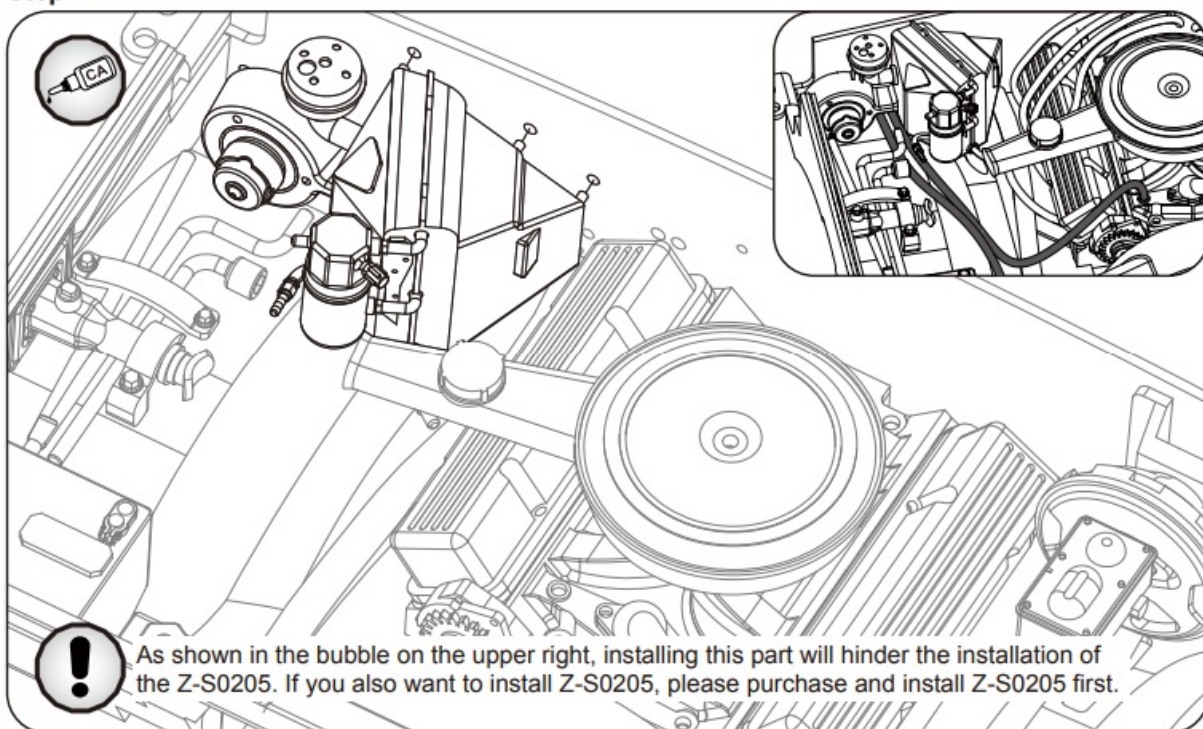

Step 13.

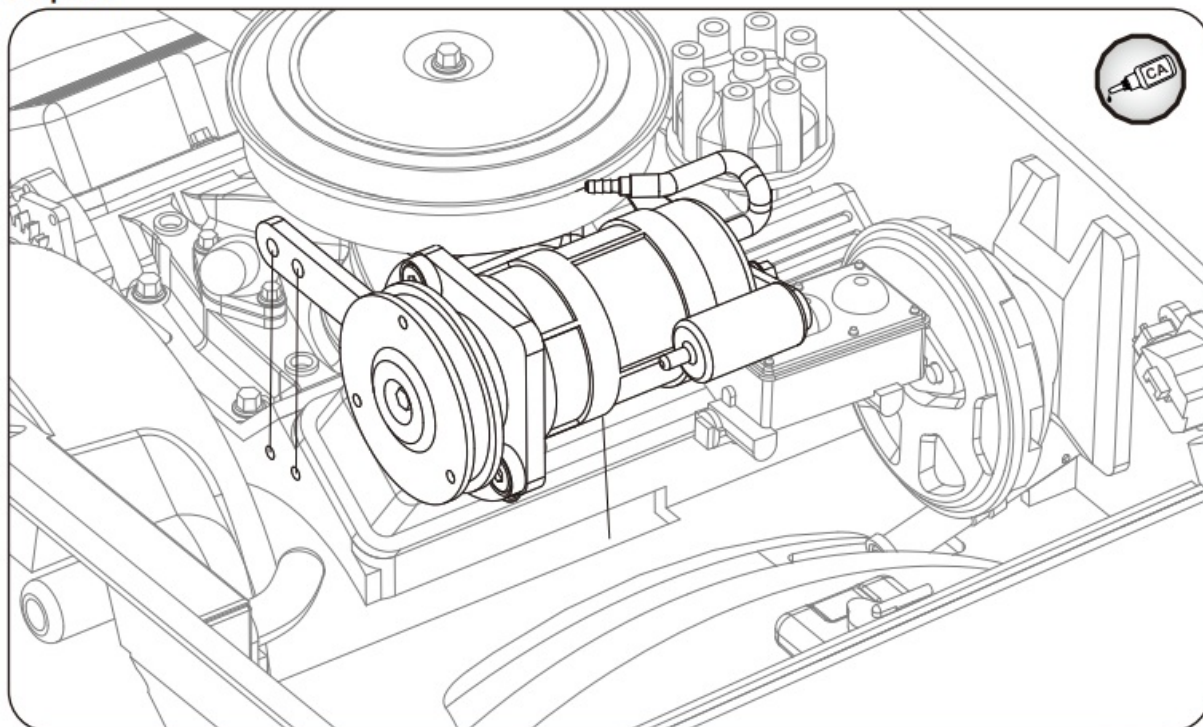

Step 14.

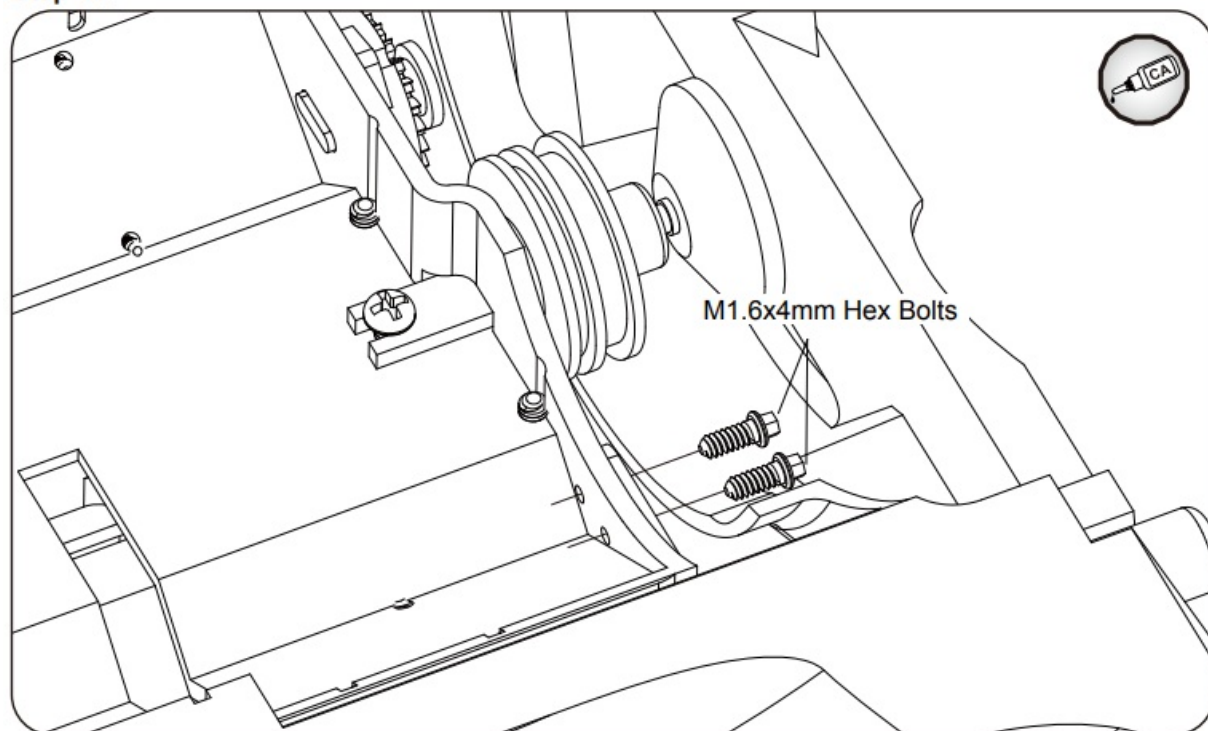

Step 15. *The length is for reference only.*

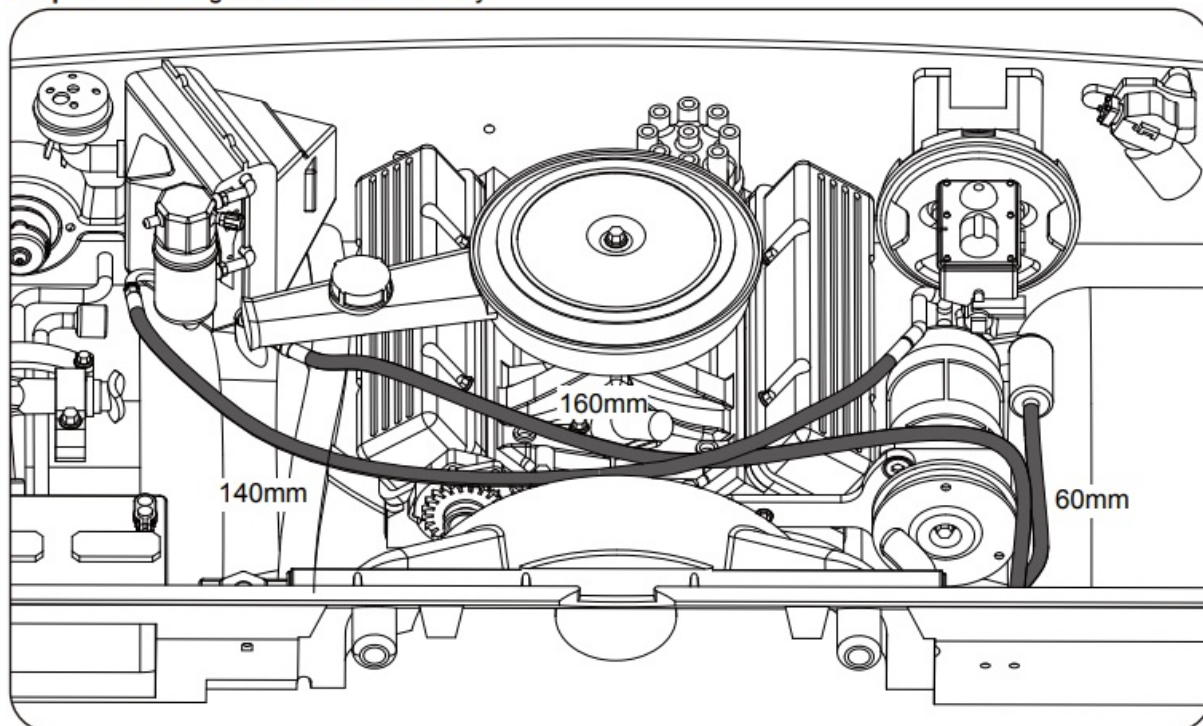

Step 16.

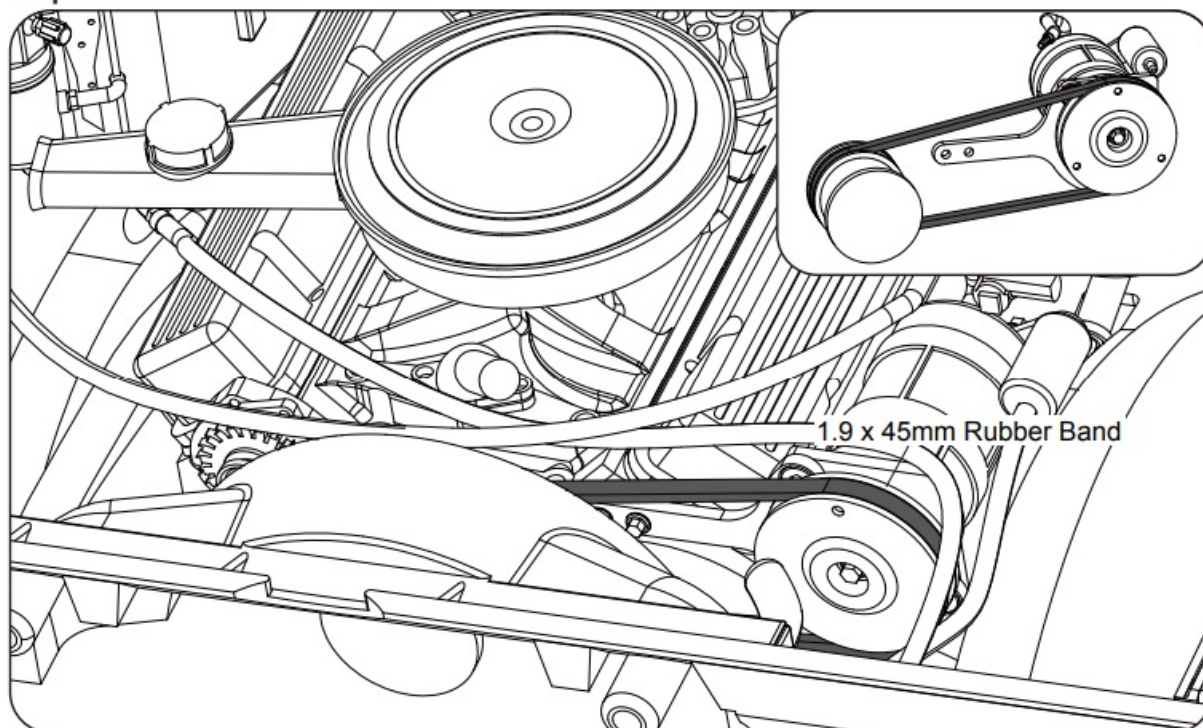

Step 17.

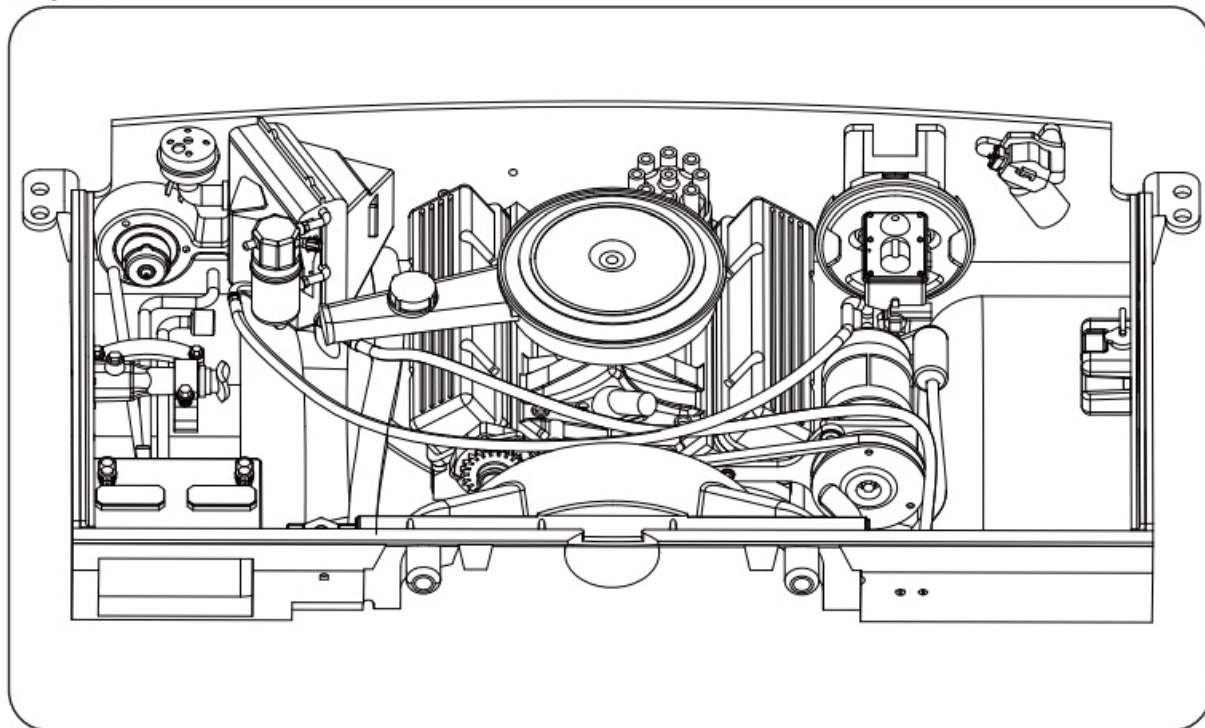

OPTIONAL DECAL PLACEMENT

Placement optionnel des autocollants

Step 1.

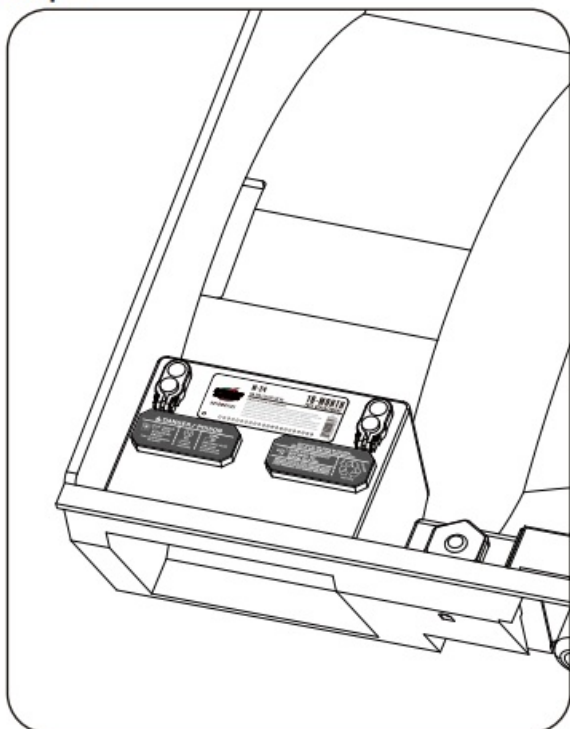

Step 2.

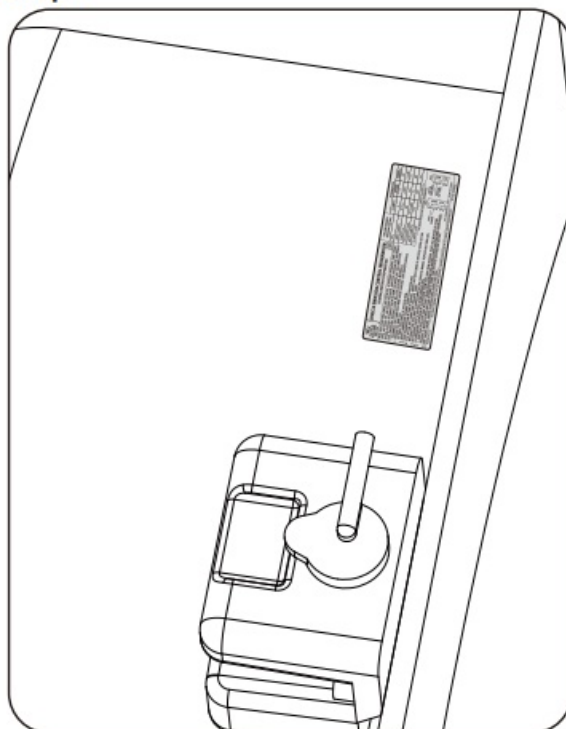

Step 3.

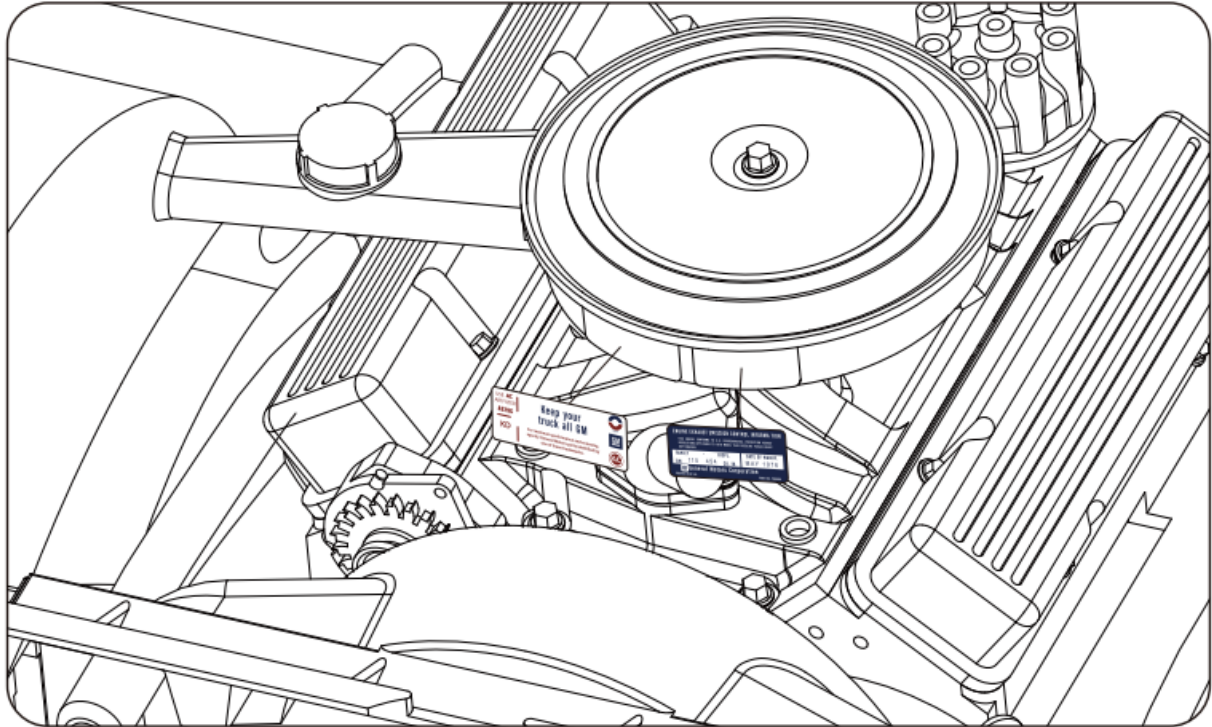

Step 4.

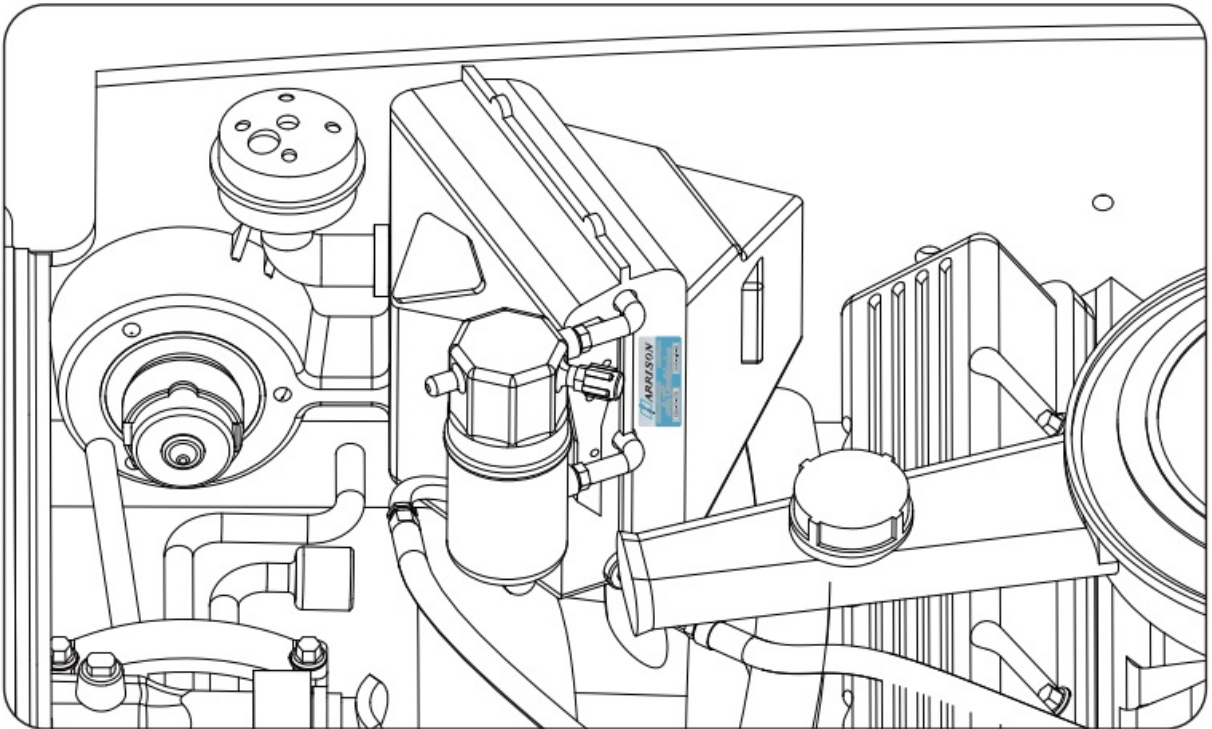

Step 5.

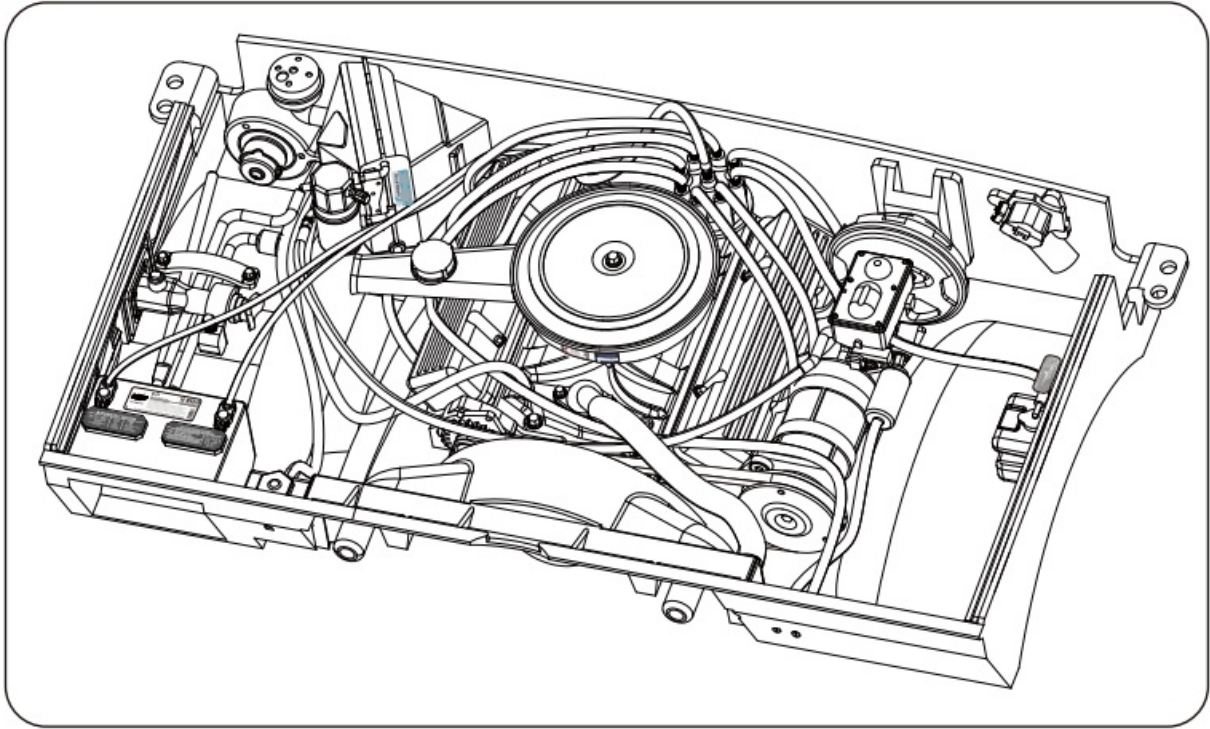

- www.rc4wd.com

737 N. Gateway St. Visalia, CA 93291 Web: www.rc4wd.com – Email: support@rc4wd.com



Documents / Resources

	<p>RC4WD V8 Small Block Engine Bay [pdf] Instruction Manual V8 Small Block Engine Bay, V8, Small Block Engine Bay, Block Engine Bay, Engine Bay, Bay</p>
---	--

References

- rc4wd.com
- [User Manual](#)

[Manuals+](#), [Privacy Policy](#)

This website is an independent publication and is neither affiliated with nor endorsed by any of the trademark owners. The "Bluetooth®" word mark and logos are registered trademarks owned by Bluetooth SIG, Inc. The "Wi-Fi®" word mark and logos are registered trademarks owned by the Wi-Fi Alliance. Any use of these marks on this website does not imply any affiliation with or endorsement.