



RAZER PWM PC Fan Controller User Guide

[Home](#) » [Razer](#) » RAZER PWM PC Fan Controller User Guide 

Contents

- [1 RAZER PWM PC Fan Controller](#)
- [2 WHAT'S INSIDE](#)
- [3 WHAT'S NEEDED](#)
- [4 LET'S GET YOU COVERED](#)
- [5 GETTING STARTED](#)
- [6 SAFETY AND MAINTENANCE](#)
- [7 LEGALESE](#)
- [8 Documents / Resources](#)
 - [8.1 References](#)
- [9 Related Posts](#)



RAZER PWM PC Fan Controller



Master your PC's airflow and noise with the Razer Pulse Width Modulation (PWM) PC Fan Controller. Easily use Razer Synapse software to unlock and customize the pulse width modulation curves for up to 8 fans and enjoy lower noise levels compared to traditional DC powered fan setups.

WHAT'S INSIDE

- Razer PWM PC Fan Controller

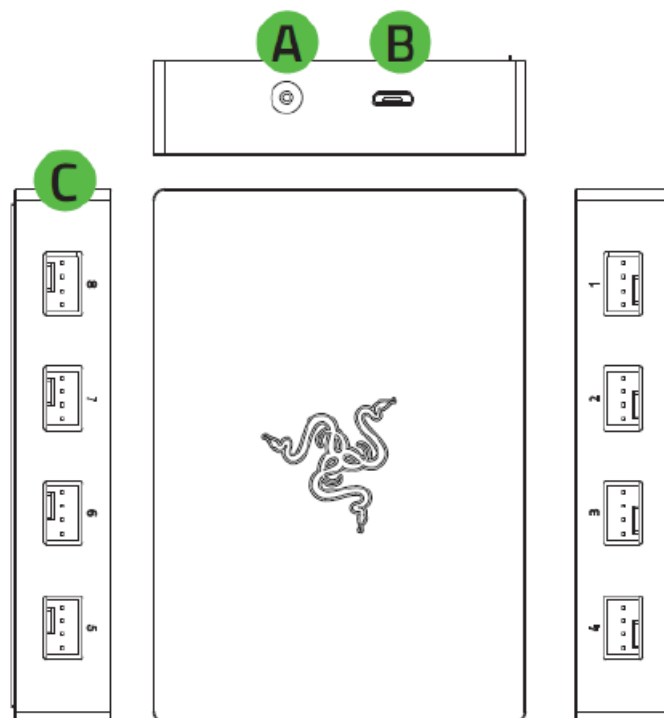

- DC power port
- Micro-USB port
- 4-pin PWM fan ports
- SATA to DC power cable

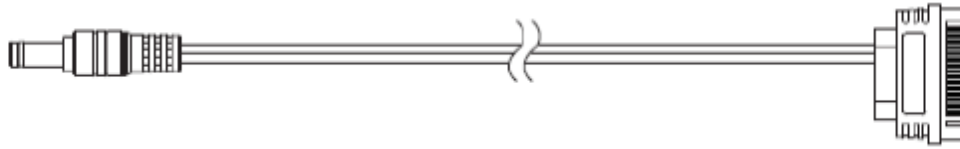

- Micro-USB to USB pin header cable

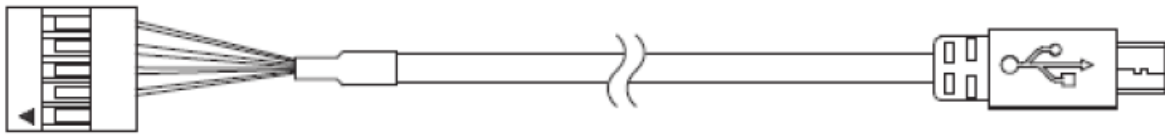

- Important Product Information Guide

WHAT'S NEEDED

PRODUCT REQUIREMENTS

- 4-pin PWM chassis fans
- 1 USB-A port
- 1 SATA port

RAZER SYNAPSE REQUIREMENTS

- Windows® 10 64-bit (or higher)
- Internet connection for software installation

LET'S GET YOU COVERED

You've got a great device in your hands, complete with a 2-year limited warranty coverage. Now maximize its potential and score exclusive Razer benefits by registering at razerid.razer.com

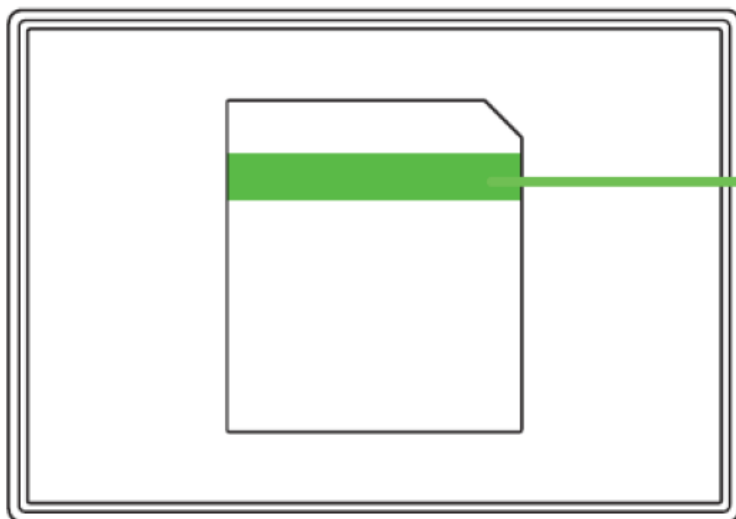

*Your product's serial number
can be found here.*

Got a question? Ask the Razer Support Team at support.razer.com

GETTING STARTED

Warning:

Please turn off your PC before proceeding to avoid electric shocks. For safety purposes, please wear an anti-static wrist strap (not included) to avoid damaging the internal components of your PC.

1. Plug your chassis fans to any of the 4-pin ports of your PWM controller. Before plugging a chassis fan to any of the 4-pin ports, make sure that its pins are properly aligned to the chosen port. 3-pin chassis fans may also be used but without the added benefit of fan speed and lighting controls,

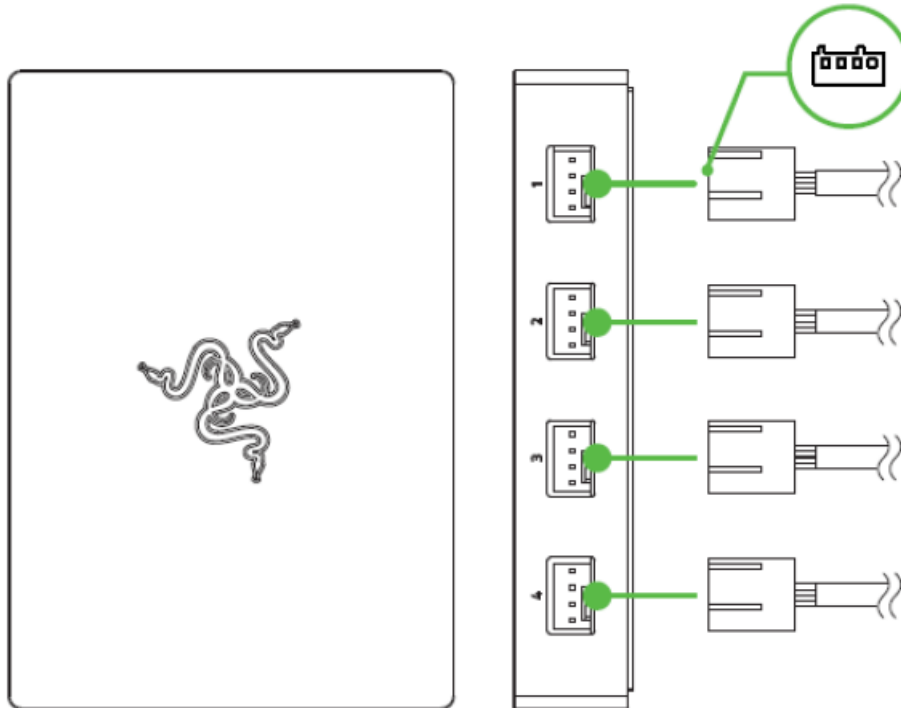

2. Connect your PWM controller to the SATA port of your Power Supply Unit (PSU) using the power cable.

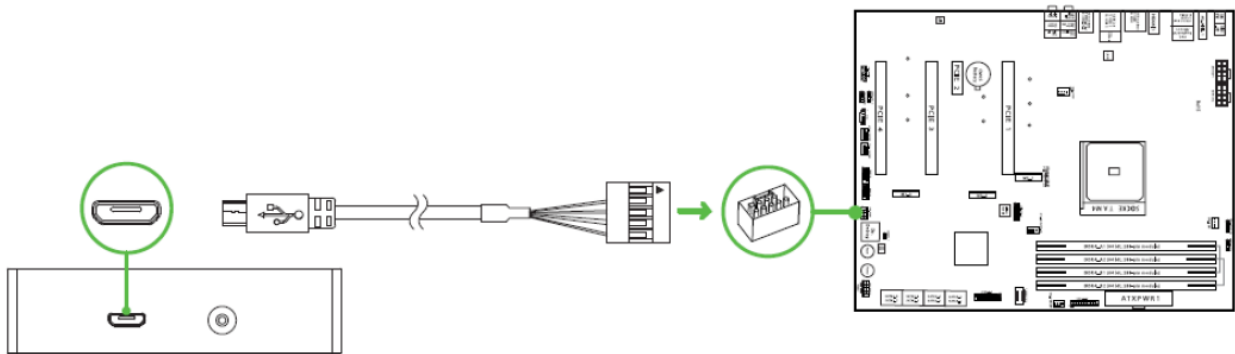

3. Connect your PWM controller to the SATA port of your Power Supply Unit (PSU) using the power cable.
4. The magnetized base may only adhere to metals with iron and nickel properties such as steel and not aluminum and lead. Attach your PWM controller to any metallic* surface of your PC's chassis using its magnetized base.

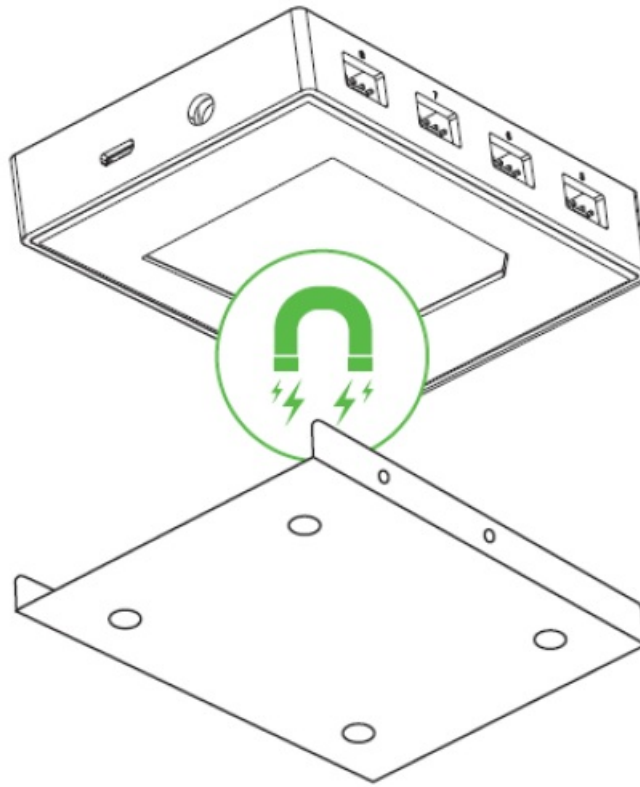

5. Use the Razer Synapse app to access fan speed adjustments and in-depth lighting customization options across your Razer Chroma-enabled devices for a truly immersive experience. Find out more at razer.com/chroma

- Install Razer Synapse when prompted or download the installer from razer.com/synapse

SAFETY AND MAINTENANCE

In order to achieve maximum safety while using your Razer PWM PC Fan Controller, we suggest that you adopt the following guidelines.

- Should you have trouble operating the device properly and troubleshooting does not work, unplug the device and contact the Razer hotline or go to support.razer.com for support.
- Don't attempt to service or fix the device yourself at any time.
- Don't take apart the device and don't attempt to operate it under abnormal current loads.
- Doing so may void your warranty.
- Only use accessories provided with the device and only purchase accessories made and/or approved by Razer.
- Power off the device before making any relocation, modifications, and/or connecting/disconnecting any component.
- Always handle all included accessories with care. When plugging or unplugging any accessory, always grip its plug/connector.
- Don't use or install the device and its components near water, moisture, solvents, or other wet surfaces, nor expose these components to high temperatures or direct sunlight.
- Keep the device and its components away from liquid, humidity or moisture. Operate the device and its components only within the specific temperature range of 0°[(32°F) to 45°[(113°F). Should the temperature exceed this range, unplug and switch off the device in order to let the temperature stabilize to an optimal level.

LEGALESE

COPYRIGHT AND INTELLECTUAL PROPERTY INFORMATION

©2021 Razer Inc. All rights reserved. Razer, the triple-headed snake logo, Razer logo, “For Gamers. By Gamers.”, and “Razer Chroma” logo are trademarks or registered trademarks of Razer Inc. or affiliated companies in the United States and other countries. All other trademarks are the property of their respective owners. Windows and the Windows logo are trademarks of the Microsoft group of companies. Razer Inc. (“Razer”) may have copyright, trademarks, trade secrets, patents, patent applications, or other intellectual property rights (whether registered or unregistered) concerning the product in this guide. Furnishing of this guide does not give you a license to any such copyright, trademark, patent or another intellectual property right. The Razer PWM PC Fan Controller (the “Product”) may differ from pictures whether on the packaging or otherwise. Razer assumes no responsibility for such differences or for any errors that may appear. Information contained herein is subject to change without notice.

LIMITED PRODUCT WARRANTY

For the latest and current terms of the Limited Product Warranty, please visit [razer.com/warranty](https://www.razer.com/warranty).

LIMITATION OF LIABILITY

Razer shall in no event be liable for any lost profits, loss of information or data, special, incidental, indirect, punitive or consequential or incidental damages, arising in any way out of the distribution of, sale of, resale of, use of, or inability to use the Product. In no event shall Razer’s liability exceed the retail purchase price of the Product.

GENERAL

These terms shall be governed by and construed under the laws of the jurisdiction in which The product was purchased. If any term herein is held to be invalid or unenforceable, then such term (in so far as it is invalid or unenforceable) shall be given no effect and deemed to be excluded without invalidating any of the remaining terms. Razer reserves the right to amend any term at any time without notice.

Documents / Resources

	RAZER PWM PC Fan Controller [pdf] User Guide PWM PC Fan Controller
---	---

References

- [Razer Synapse 3 - Cloud-Based Hardware Configuration Tool | Razer United States](#)
- [Razer Warranty Policy](#)
- [Official Razer Support](#)
- [RGB Lighting System For PC | Razer Chroma ?](#)
- [Razer ID](#)
- [Official Razer Support](#)