



RaySharp E1 Wireless IP Camera User Guide

[Home](#) » [RaySharp](#) » RaySharp E1 Wireless IP Camera User Guide 

RaySharp E1 Wireless IP Camera User Guide



Contents

- [1 Introduction](#)
- [2 APP Installation](#)
- [3 Register an account](#)
- [4 Adding Device](#)
- [5 Mounting the Camera](#)
- [6 FCC Statement](#)
- [7 Documents / Resources](#)
- [8 Related Posts](#)

Introduction

Thank you for using Smart Cam View. Please setup the camera by following the steps below:

1. In order to connect the camera stably, please install it in the range that could strongly accept the Wi-Fi signal of the home wireless router.

Before installing the camera, please determine the installation location(flat surface or wall)

When the camera is installed in a place where is difficult to obtain Wi-Fi signal, please use a Wi-Fi extender to extend the Wi-Fi network range.

2. Connect power adapter to the camera.



Please keep the wires away from children to avoid any potential danger.

In order to get the best image quality, please don't touch the camera lens with your hands.

Please make sure to use the matching power adapter cable, or the camera may not work properly.



APP Installation

Download the APP

- Download the "Smart Cam View" app from the App Store(IOS devices) or Google Play (Android devices).
- Scan the QR code below to download the APP



For IOS

Scan Me



For Android

Scan Me



1. Connect the power connector to the camera and plug the power adapter into a power outlet. Wait until the camera status LED turns solid red.
2. Create an account and tap “Add Device” to add a device into your device list, follow the instructions to complete the setup.

Recommended system specifications

Wi-Fi 802.11 b/g/n
IOS 11.0 or higher
Android OS 6.0 or higher

Application pre-check function

Make full use of Smart Cam View to monitor your home(the supported functions may be varied by different models) :

Event notification

Motion/Human/Vehicle/Package/Sound detection

Customized real-time monitoring

Voice intercom

Register an account

- Run Smart Cam View, then tap.
- Input user's information then tap , Verification code will be sent to your email.
Input the verification code, read and accept the relevant privacy policy,then tap.

The image displays two screenshots of the SmartCam View app interface. The left screenshot shows the login screen with the SmartCam View logo at the top. Below the logo are three input fields: 'Email', 'Password', and 'Choose Region'. Each field has a dropdown arrow on the right. Below these fields is a 'Forgot Password?' link. At the bottom of the login section is a blue 'Login' button. Below the login button is a link that says 'Don't have an account? Sign Up'. The right screenshot shows the 'Sign Up' screen. It has a back arrow at the top left. The title 'Sign Up' is at the top. Below the title are four input fields: 'Account' (with placeholder 'Enter Email address'), 'Choose Region' (with placeholder 'Choose Region'), 'Password' (with placeholder '8-20 Characters'), and 'Confirm Password' (with placeholder '8-20 Characters'). Each field has a dropdown arrow on the right. Below the password fields is a link for 'Password Rules'. Below the password fields is a 'Verification code' field with a placeholder 'Enter code' and a blue 'Get Verification Code' button. At the bottom of the sign up section is a checkbox labeled 'I agree to the Terms of Service Use and Privacy Policy.' and a blue 'Sign Up' button.

- Return to the login interface, input user name and password, Choose Region, then tap.
- After tap will reach the Home menu.

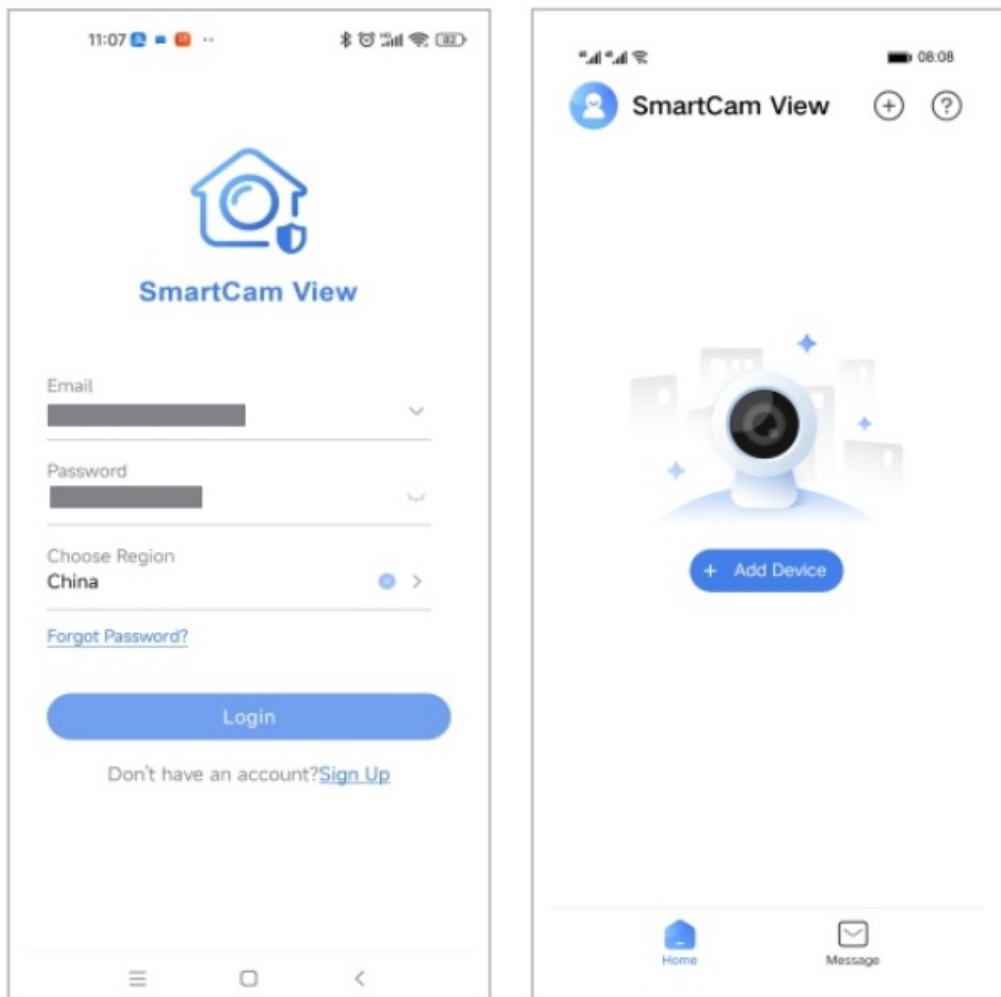

Adding Device

- Connect power adapter to the camera. Plug the adapter into an outlet. Wait until the camera indicator light on. Tap button in the middle of Home menu.
- Aim the scanning window at the QR code on the camera.

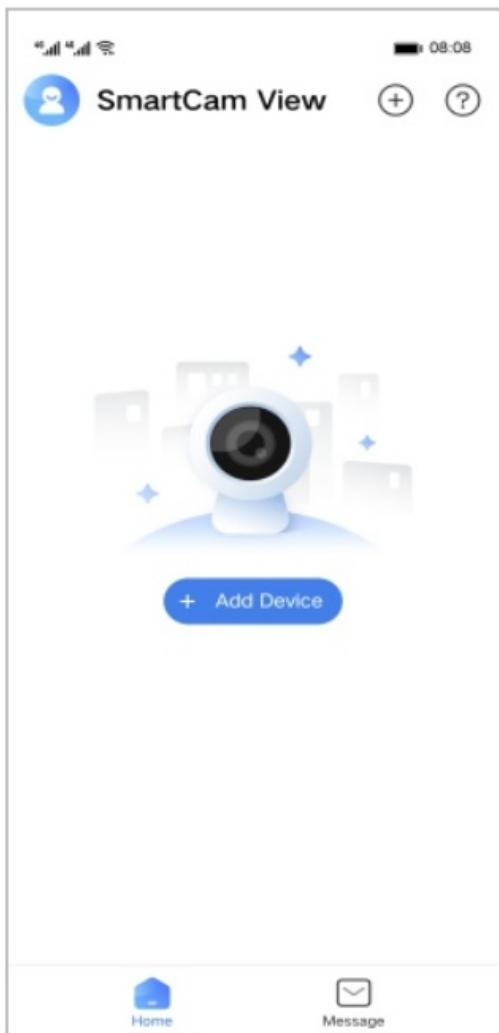

- Tap button <Yes, The LED is already slowly blinking Red> when the camera LED is blinking in red.
- Tap button to connect camera hotspot.

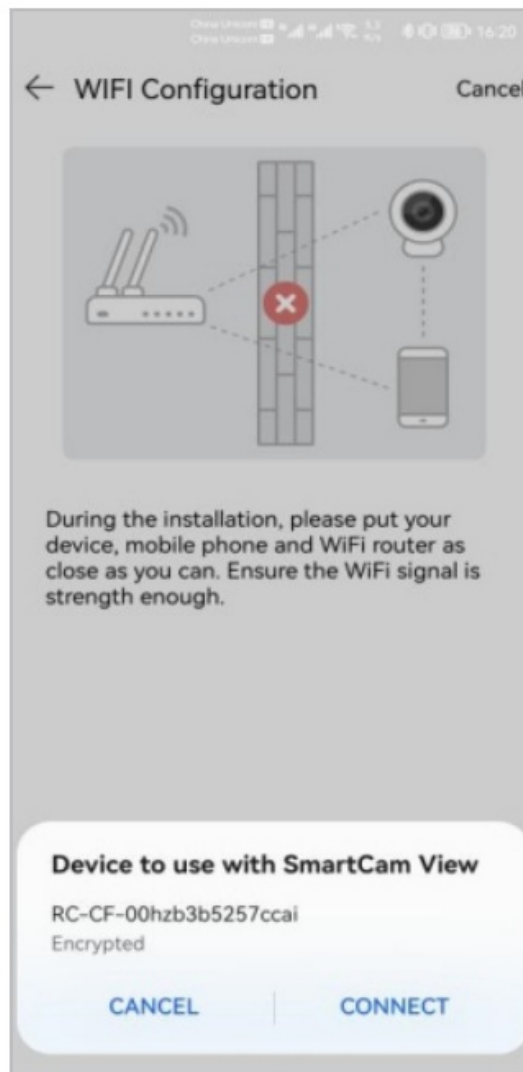
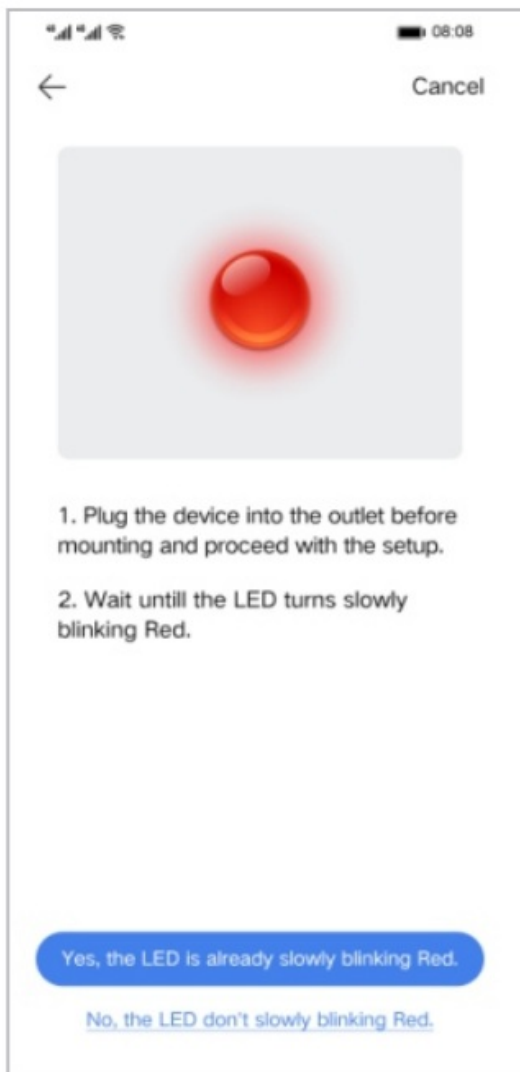

- Select a 2.4 GHz WIFI network for the camera to connect and input the WIFI password, tap button to connect WIFI.
- Waiting for the WIFI connecting.

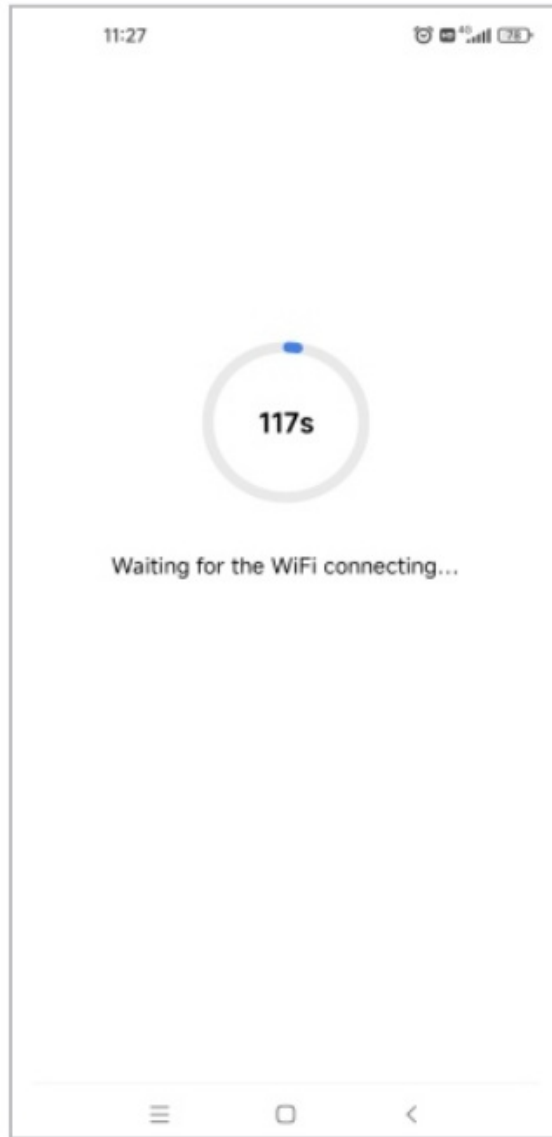
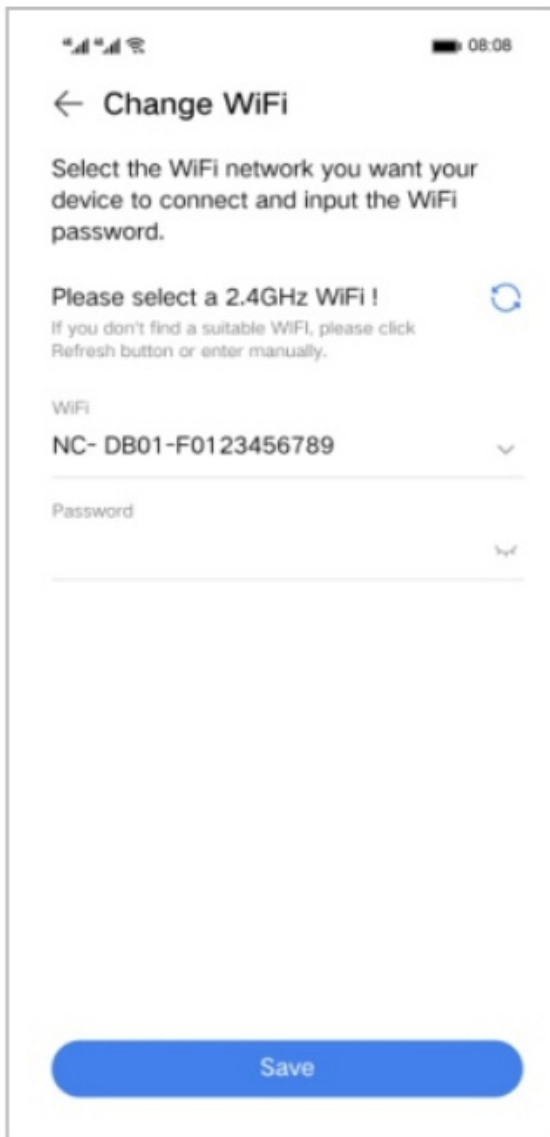

- Device was added successfully and tap <Next>.
- Set a device name, you can choose or customize a device name you want.

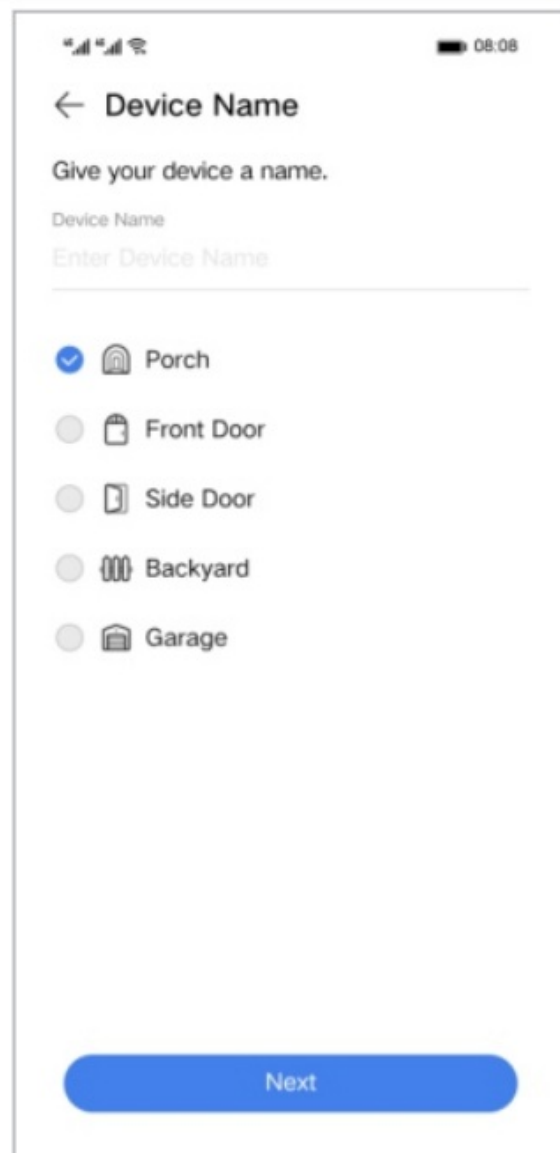
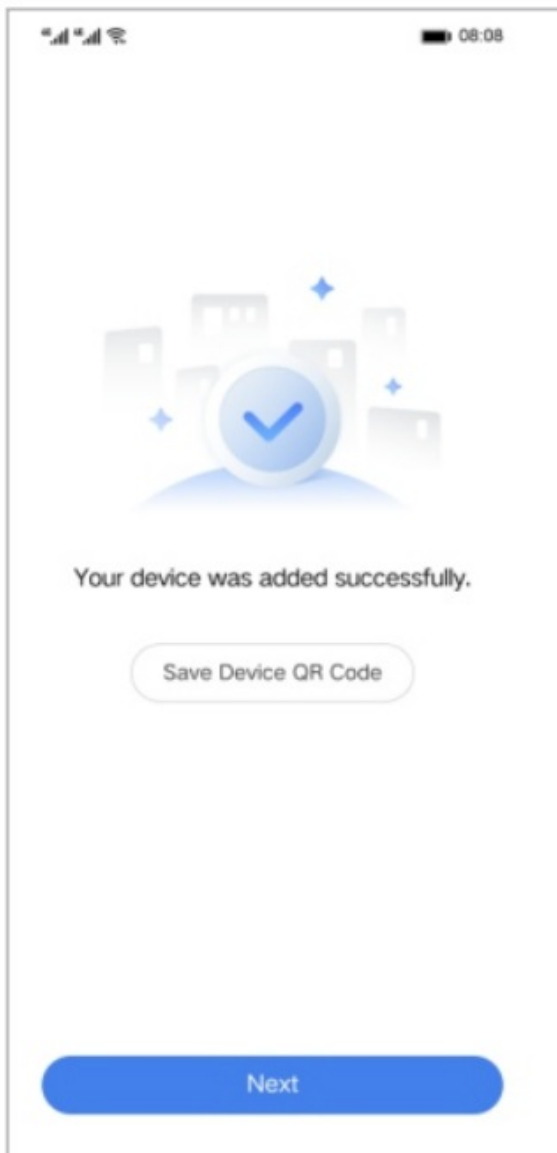

- Choose the accurate region in where you want to setup your devices.
- Please insert micro SD card and tap to format Micro SD. If you forgot to insert Micro SD, you can insert Micro SD and tap< Check again>.

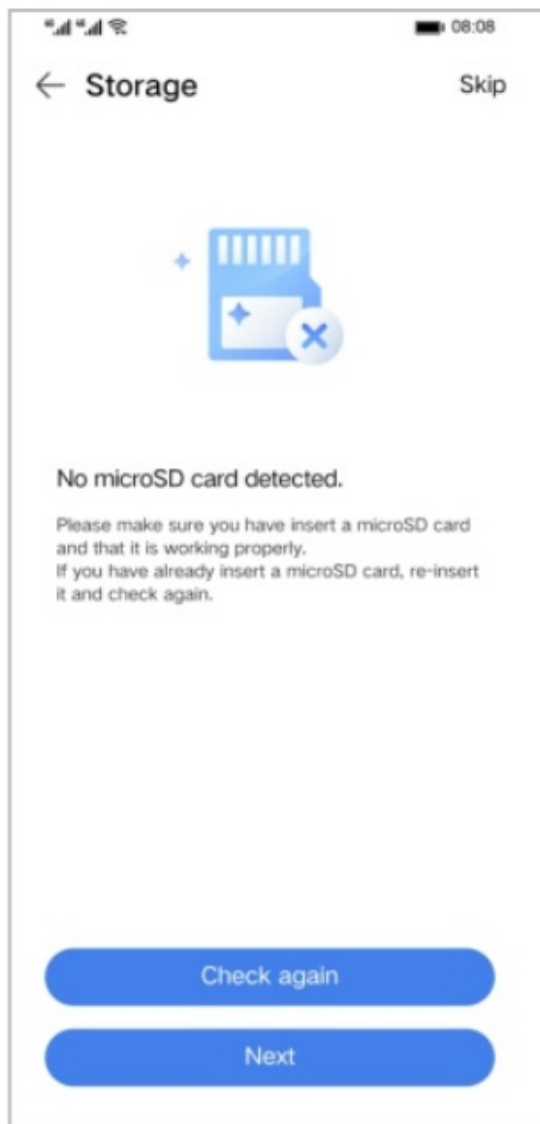

- Tap to format micro SD card.
- Tap after formatting successfully.

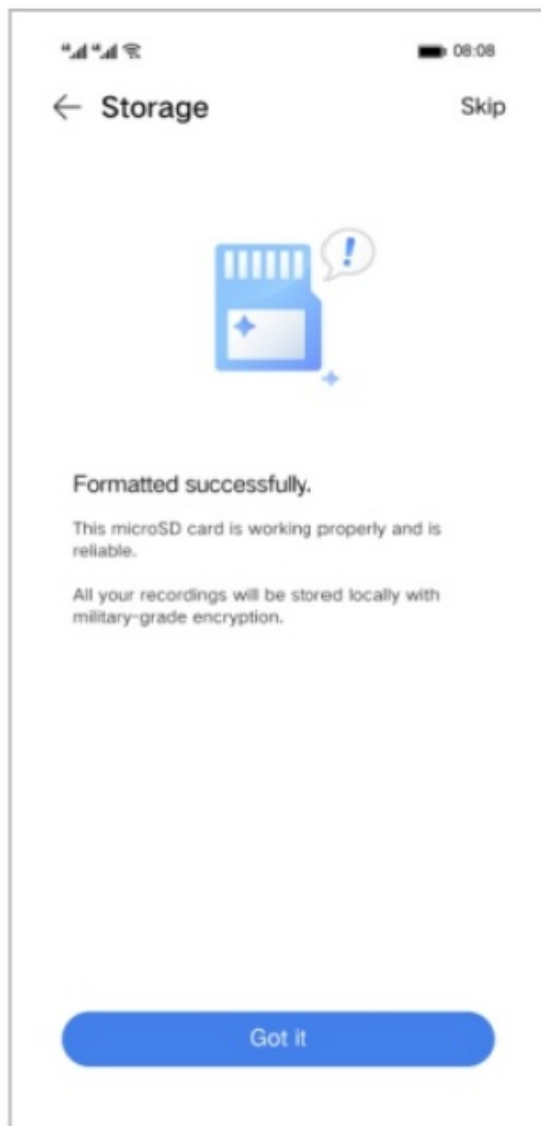

- Select a desired way to mount the camera according to the installation Guide.
- Tap to finish camera configuration.

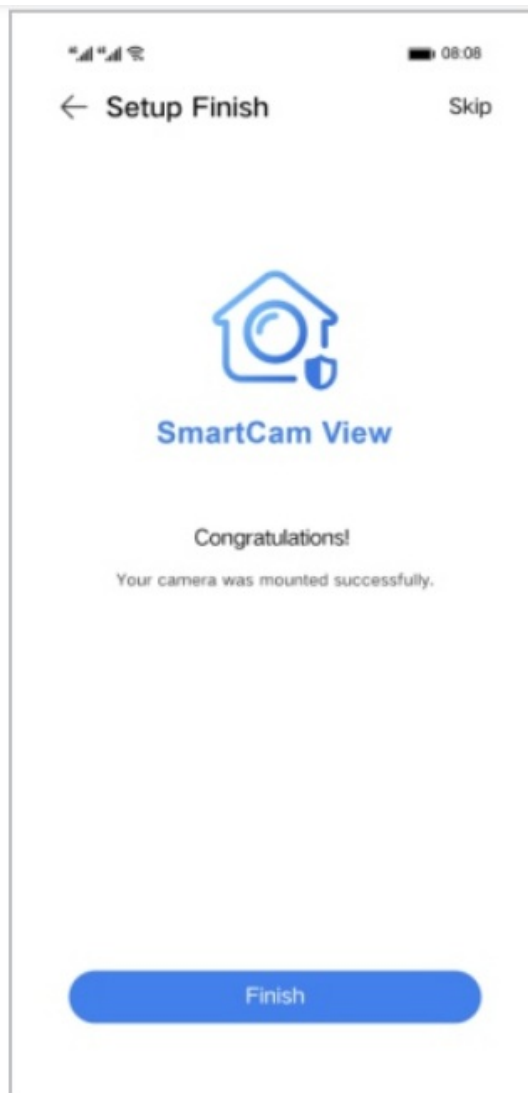

Mounting the Camera

Mount bullet camera onto a wall

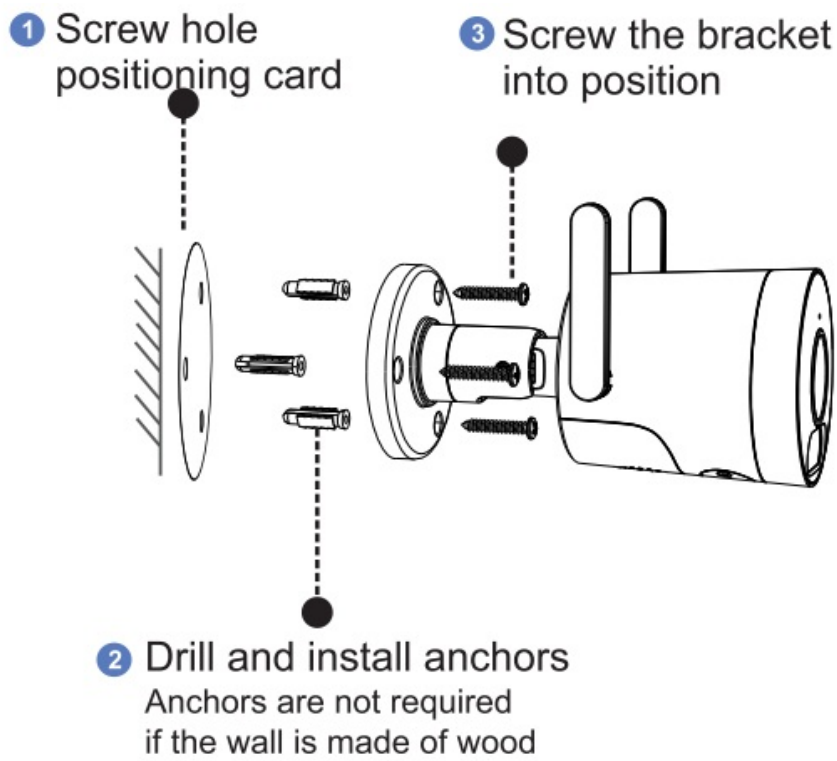

- Rotate the camera to adjust the view angle and check it by using the live stream which you can access in the Smart Cam View app.

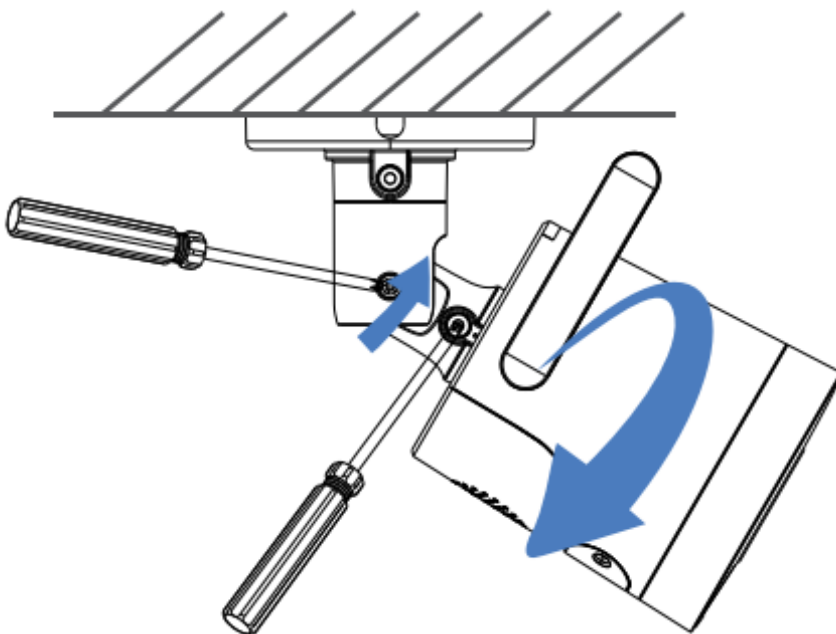

Place cube camera on a table

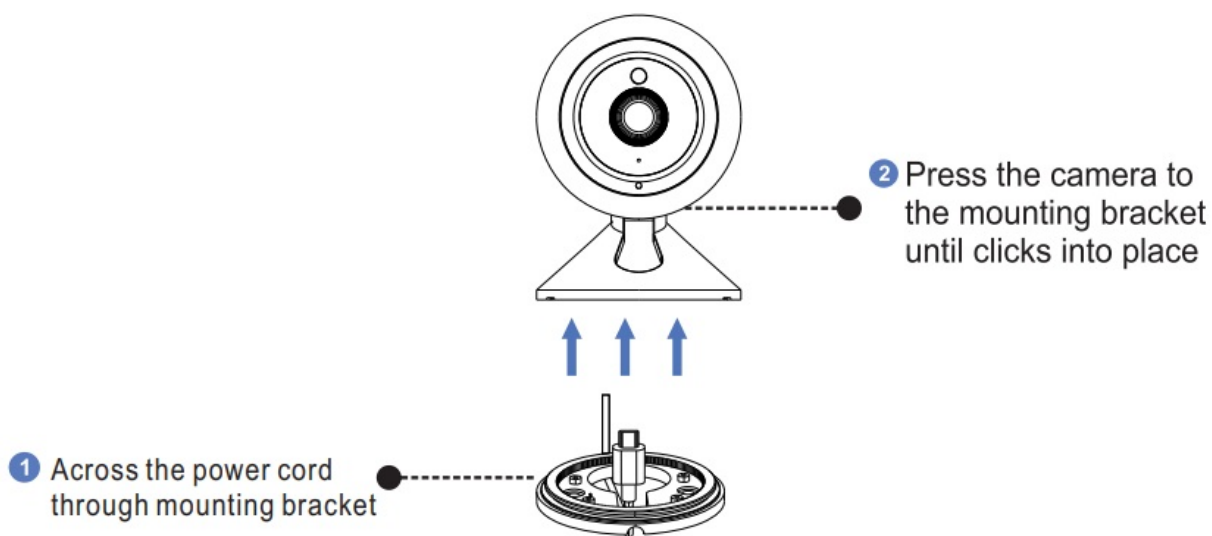

- Keep a gap of more than 10 inches (25cm) between objects to the side of the camera lens to avoid overexposure caused by infrared light reflection.

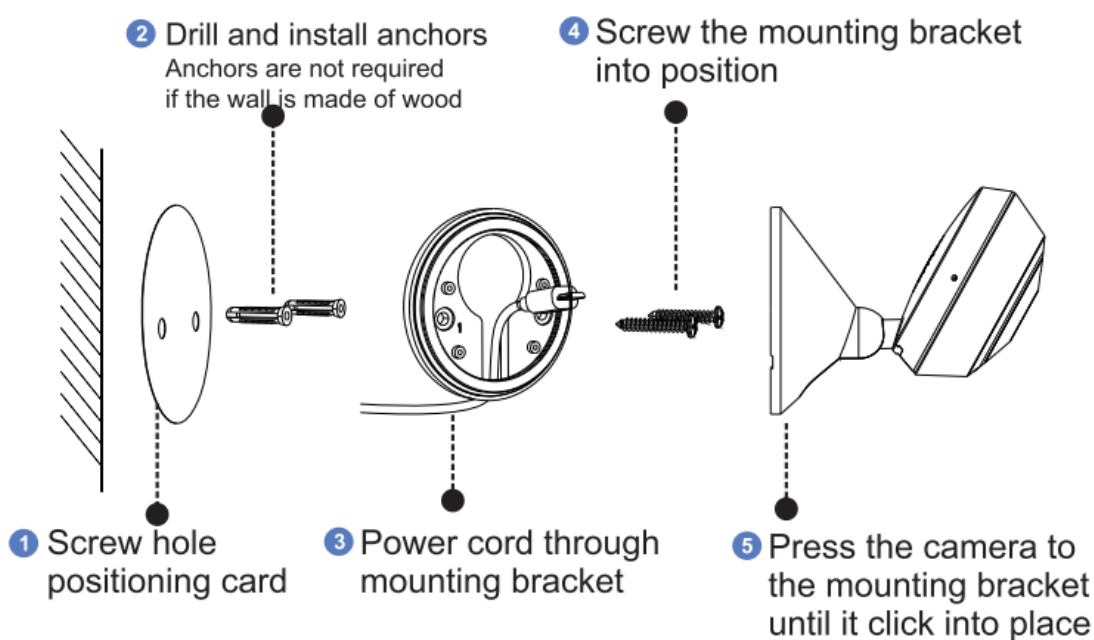
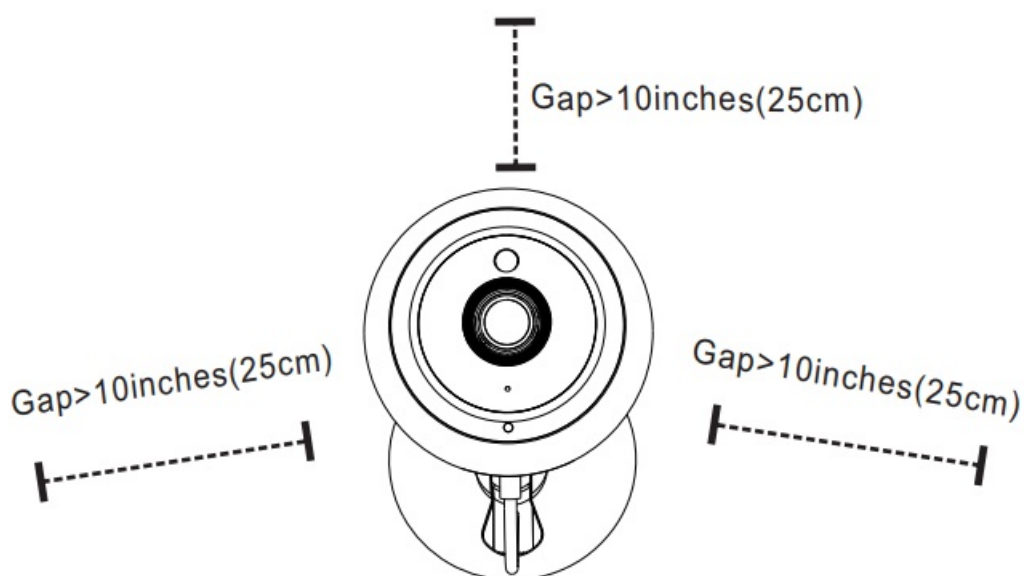

- Keep a gap of more than 10 inches (25cm) between objects to the side of the camera lens to avoid overexposure caused by infrared light reflection.

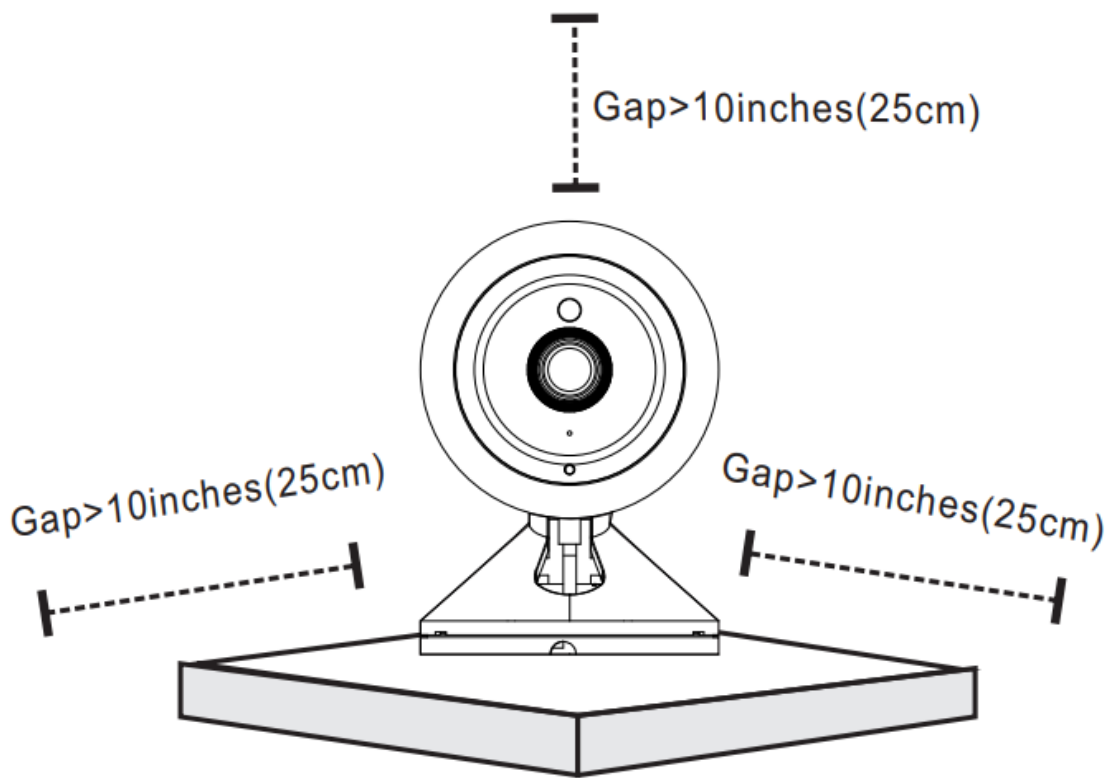

Place PT camera on a table

- Keep a gap of more than 10 inches (25cm) between objects to the side of the camera lens to avoid overexposure caused by infrared light reflection.

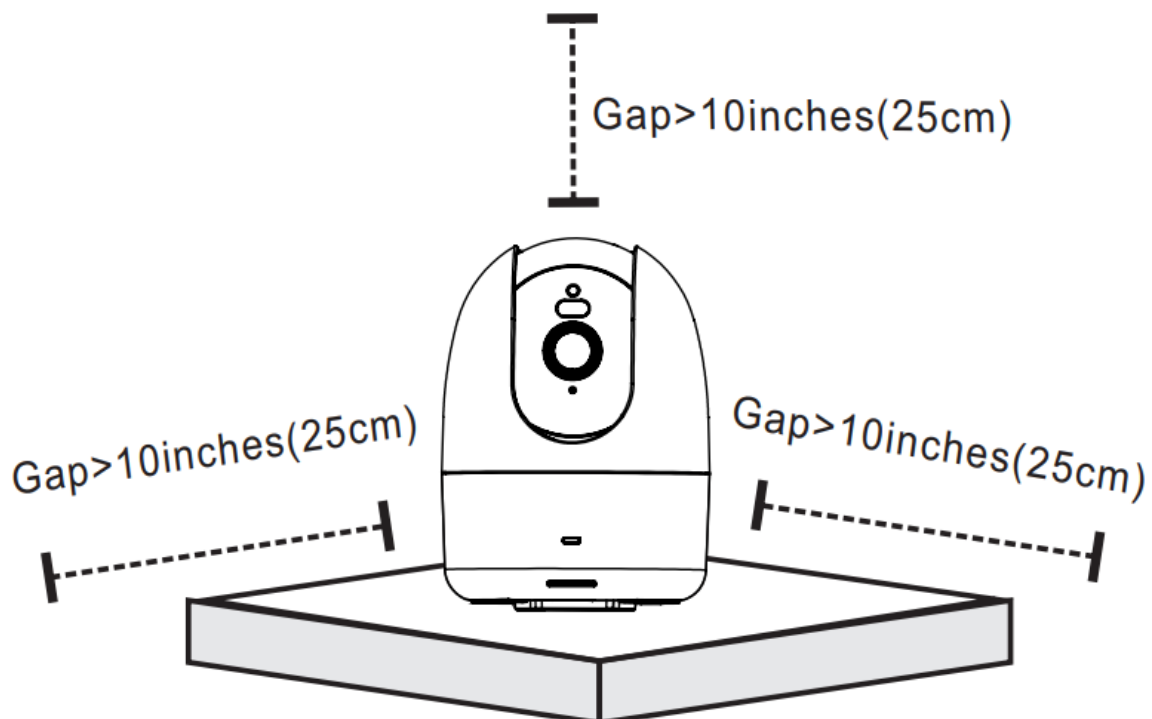

Mount the PT camera on ceiling

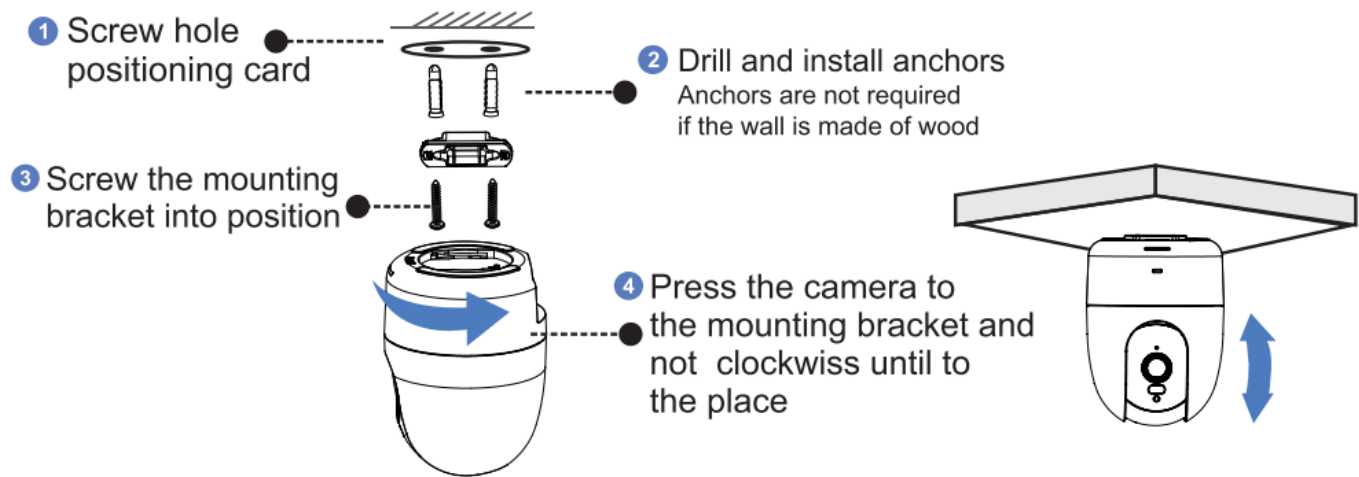

Mount the battery camera onto a wall

- Keep a gap of more than 10 inches (25cm) between objects to the side of the camera lens to avoid overexposure caused by infrared light reflection.

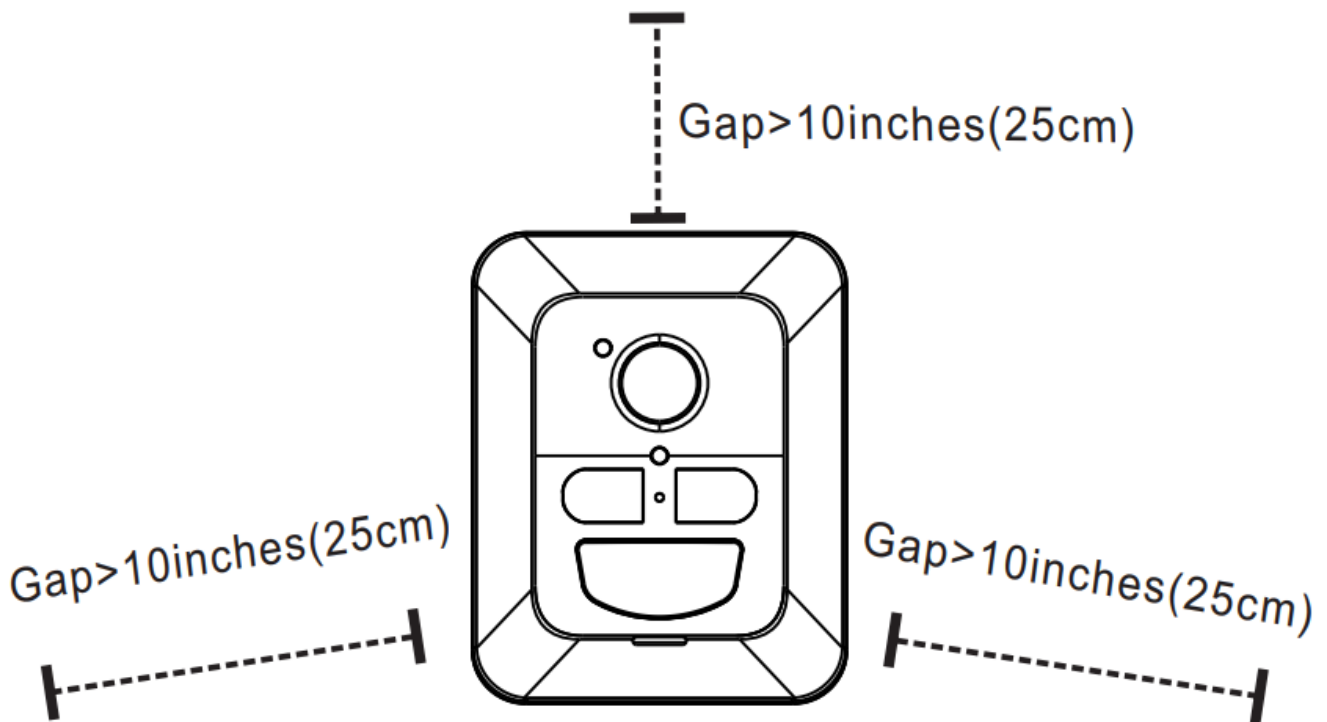

Mount with magnetic bracket

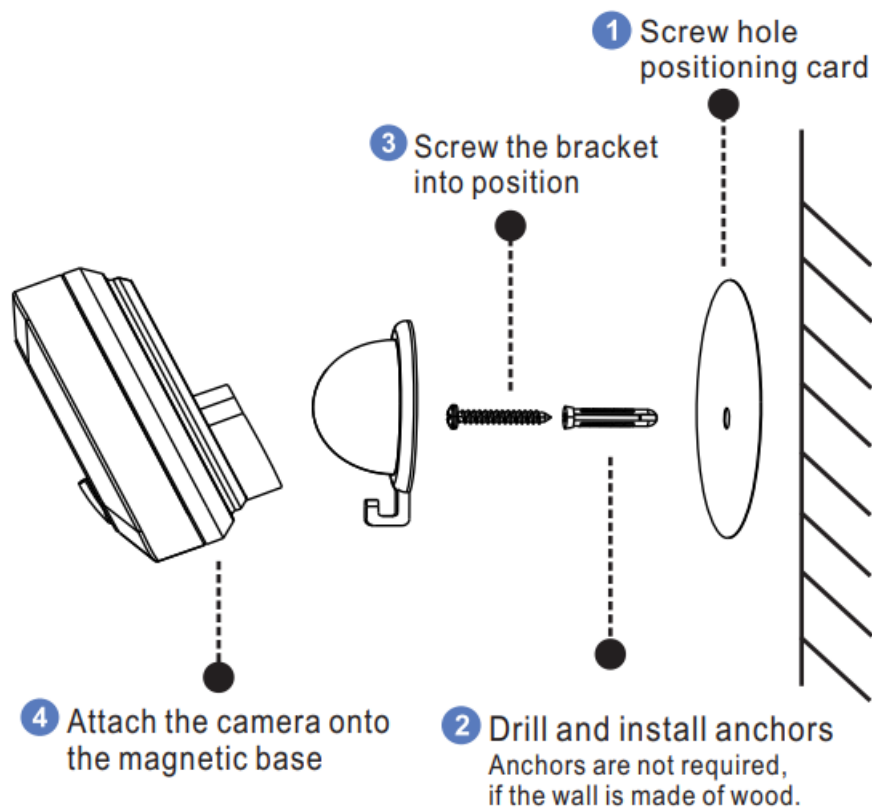

Mount with fixed bracket

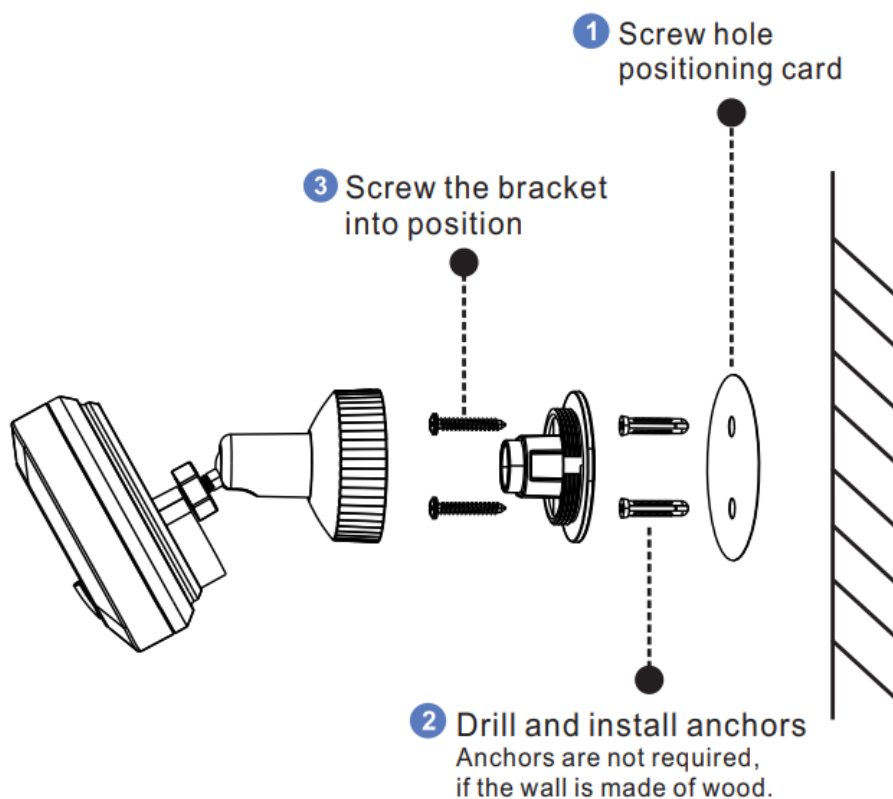

Note:

Before mounting the camera:

- Unplug the camera power connector from the power adapter.
- Find a spot where the camera can easily reach a power outlet.
- Make sure the camera receives a strong Wi-Fi connection in the spot where you want to mount it so that it can

stream video to your Smart Cam view app.

FCC Statement

Caution: The user is cautioned that changes or modifications not expressly approved by the party responsible for compliance could void the user's authority to operate the equipment.

This device contains license exempt transmitter(s)/receiver(s) that comply with Innovation, Science and Economic Development Canada's license exempt RSS(s) and Part 15 of the FCC Rules. Operation is subject to the following two conditions:

1. This device may not cause interference.
2. This device must accept any interference, including interference that may cause undesired operation of the device.

NOTE: This equipment has been tested and found to comply with the limits for a Class B digital device, pursuant to Part 15 of the FCC Rules. These limits are designed to provide reasonable protection against harmful interference in a residential installation. This equipment generates, uses and can radiate radio frequency energy and, if not installed and used in accordance with the instructions, may cause harmful interference to radio communications. However, there is no guarantee that interference will not occur in a particular installation.

If this equipment does cause harmful interference to radio or television reception, which can be determined by turning the equipment off and on, the user is encouraged to try to correct the interference by one or more of the following measures:

- Reorient or relocate the receiving antenna.
- Increase the separation between the equipment and receiver.
- Connect the equipment into an outlet on a circuit different from that to which the receiver is connected.
- Consult the dealer or an experienced radio/TV technician for help.

FCC& IC Radiation Exposure Statement:

This equipment complies with FCC and Canada radiation exposure limits set forth for an uncontrolled environment.

This equipment should be installed and operated with a minimum distance of 20cm between the radiator and your body.

This transmitter must not be co-located or operating in conjunction with any other antenna or transmitter.



Documents / Resources

	<p>RaySharp E1 Wireless IP Camera [pdf] User Guide</p> <p>E1, 2AJ3G-E1, 2AJ3GE1, E1 Wireless IP Camera, E1, Wireless IP Camera, IP Camera, Camera</p>
---	---