

RaySharp B221 Wireless NVR System



RaySharp B221 Wireless NVR System User Guide

[Home](#) » [RaySharp](#) » RaySharp B221 Wireless NVR System User Guide 

RaySharp

RaySharp B221 Wireless NVR System



Specifications

- **Model Number:** ZLUHOHV1956
- **Power:** 4XLFN6WDUW
- **Dimensions:** 6RODU3DQHO

Product Information

The ZLUHOHV1956 is a versatile product designed for various applications. It features a durable construction and efficient performance.

Product Usage Instructions:

Initial Setup

1. Unbox the product and check for any damages.
2. Connect the power source to the 4XLFN6WDUW input.
3. Place the product in a well-ventilated area.

Operating the Product

1. Turn on the device using the designated power button.
2. Follow the instructions on the display screen for further setup.
3. Adjust settings as needed for optimal performance.

Maintenance

- Regularly clean the product surfaces with a soft cloth.
- Avoid exposing the product to extreme temperatures or moisture.
- Refer to the user manual for troubleshooting tips.

FAQ

- **Q: How do I troubleshoot if the product stops working?**
 - A: Check the power source, ensure all connections are secure, and consult the user manual for troubleshooting steps.
- **Q: Can I use the product outdoors?**
 - A: It is recommended to use the product in a dry and stable indoor environment to prevent damage.
- **Q: What is the warranty period for this product?**
 - A: The warranty period for the ZLUHOHV1956 is one year from the date of purchase, covering manufacturing defects.

Wireless NVR System



Quick Start Guide

What's in the Box

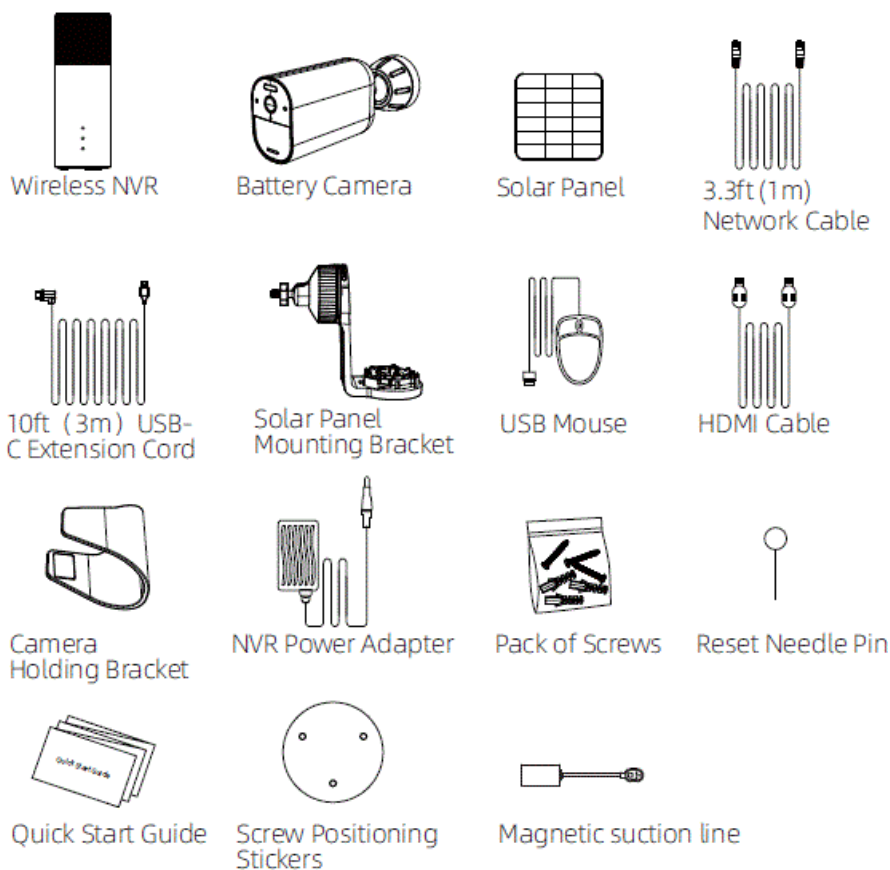

Note: Quantity of devices and accessories vary by different models that you purchase

Introduce the NVR

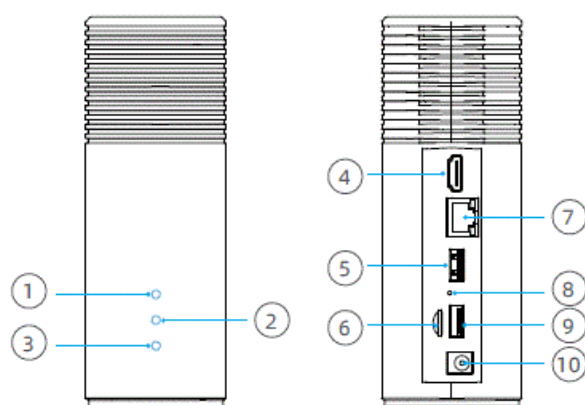

1. Network Status LED
2. Storage Status LED
3. Power Status LED
4. 4 HDMI Port
5. USB Port
6. MicroSD Card Slot
7. Ethernet Port
8. Reset Hole
9. USB Port
10. Power Port

Introduce the Camera

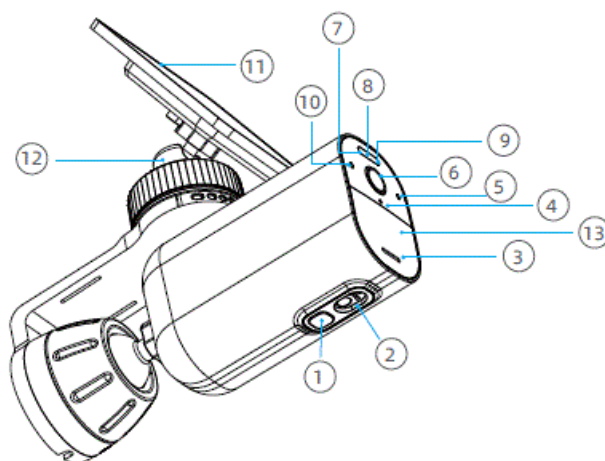

1. Eject button
2. Magnetic charging port
3. Speaker
4. Microphone
5. Photosensitive Sensor
6. Camera Lens
7. Warning lights
8. Spot Light
9. Infrared LED
10. Indicator Light
11. Solar Panel
12. Solar Panel Bracket
13. PIR Sensor

Indicator Light Status	Description
Red light is solid on	Camera is booting
Infrared LEDs flashing	Waiting for pairing
Green light is solid on	Camera is charging
Blue light is flashing	Remote preview
Purple light is solid on	Camera is upgrading
Red & Blue light is flashing	Network Error
Off	Sleep Mode / Fully Charged

Power Button

1. Press and hold for 3 seconds to turn on the camera when is off.
2. Press and hold for 8 seconds to turn off the camera when is on .

Expanding Storage(Optional)

The NVR supports SD cards (with a maximum capacity of 512G) or 2.5-inch hard drives for storing video recordings.

Prepare Your Hard Drive

Type	Hard disk drive (HDD) or solid state drive (SSD) that uses the SATA interface
Size	2.5 inch
Capacity	Unlimited
Recommended	Western Digital, Seagate, SAMSUNG, Toshiba, Kingston, PNY, Crucial, SanDisk

Your hard drive must meet the following requirements:

A new hard drive must be formatted. You may need to transfer all the data from your hard drive to a secure location if necessary.

Install Your Hard Drive

MR must be powered off when you install or remove a hard

1. Push down the bottom lid to remove it.

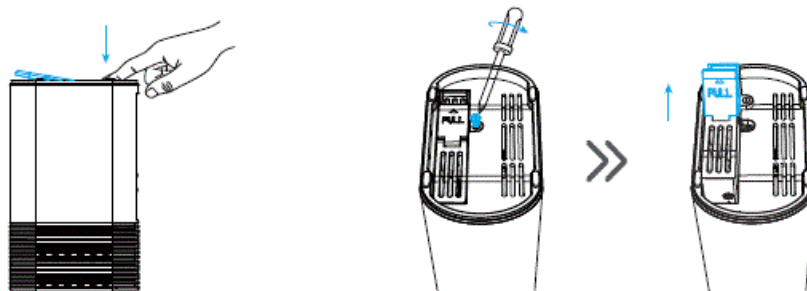

2. Loosen the screw, then pull out the hard drive bracket.
3. Fix your hard drive to the bracket with the provided screws.

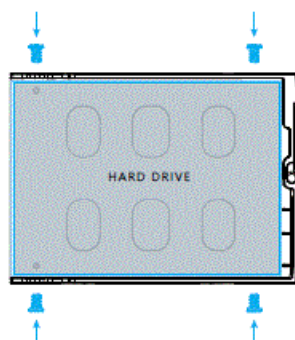

4. Insert and screw the bracket back to NVR, then put the bottom lid back into place.

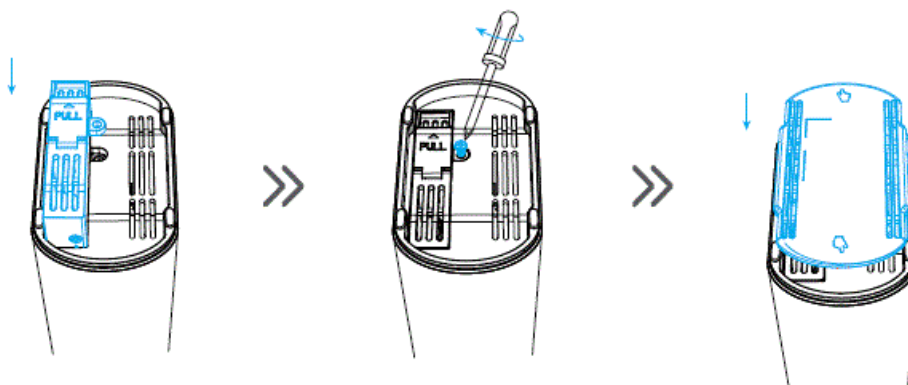

Charging the Camera

We recommend fully charge the cameras before first use.

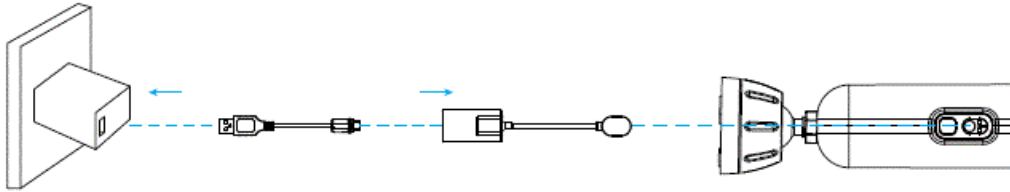

Indicator Light Status	Description
Green light is solid on	Camera is charging
OFF	Fully charged

Setting Up the System

1. Connect the included power adapter to the NVR, wait a few minutes for the system to start up.

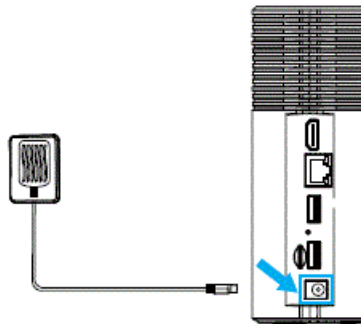

2. Connect the NVR to your router using the included Ethernet cable. And then, connect the USB mouse to the USB port of the NVR.

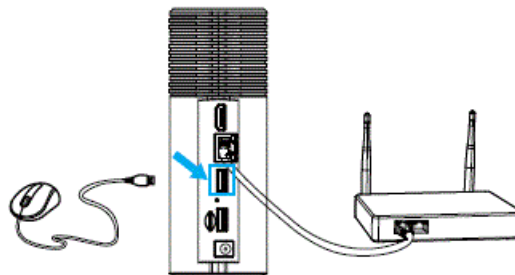

3. Connect the NVR to the monitor with a HDMI cable. (Optional, if you wish to monitor on a screen)

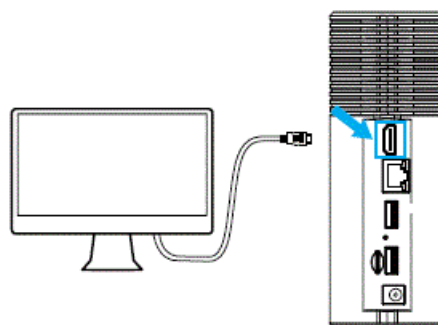

4. To turn on and pair the camera, please click the pairing button on the display and press the reset button three times within 3 seconds. It will automatically connect to the NVR via a wireless signal

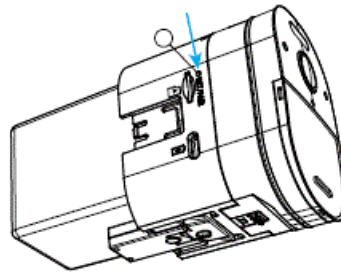

5. Download and install the free “Smart Camera View” app from the App Store (iOS devices) or Google Play (Android devices).



a. Download the APP by scanning the QR code



6. Run the “SmartCamera View” app, sign up for a SmartCamera View Life account. Then login with your account ID, tap “+Add Device” and scan the setup QR code on the Device Back (remove the bottom lid). Or scan the setup QR code in the NVR menu and then download the in-app instructions to add the remote

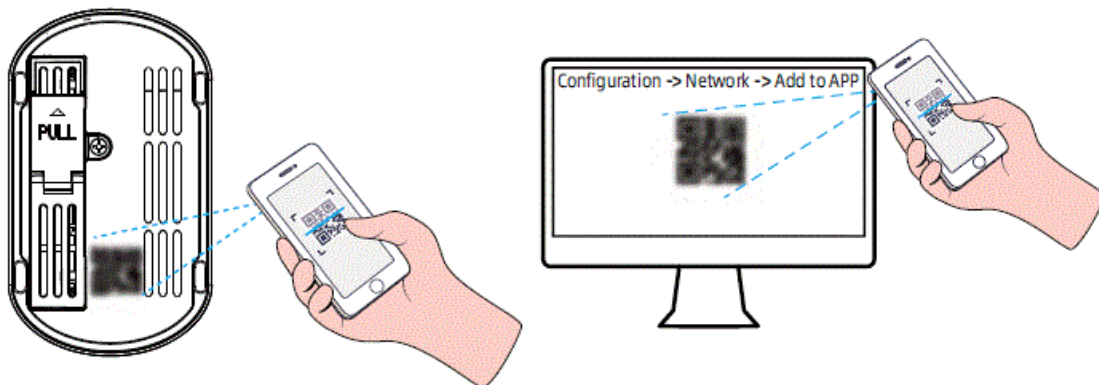

Mounting the Camera

Option 1: Mount the Camera with the Solar Panel Attached (Less Drilling) If you want a location without any shade and sunlight is not obstructed, install the solar panel directly on the top of the camera with the solar panel's mounting bracket.

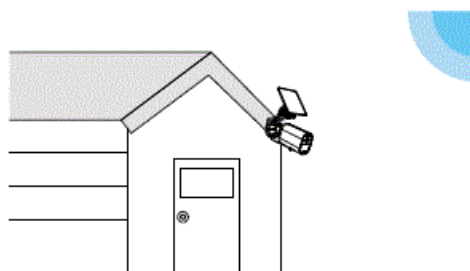

1. Install the solar panel on to the solar panel's mounting bracket by turning it.

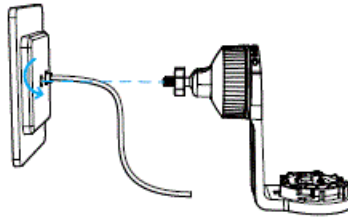

2. Secure the power cable of the solar panel on to the bracket's side .

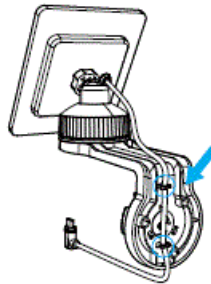

3. Drill holes with a 6.0 mm drill bit with the included positioning card, then insert the anchors into the holes.

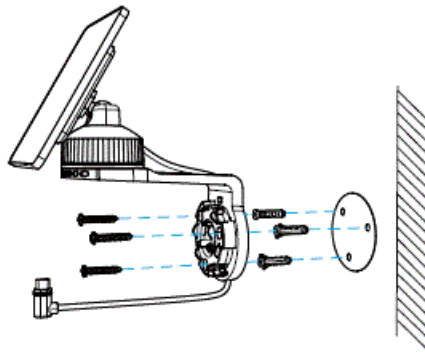

4. Install the camera to its mounting bracket by turning it clockwise until it clicks in top place

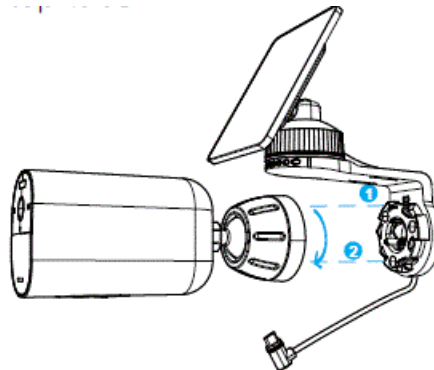

5. Tighten the locking screw on the mount bracket, adjust it to the angle you need, and connect the magnetic extension cord.

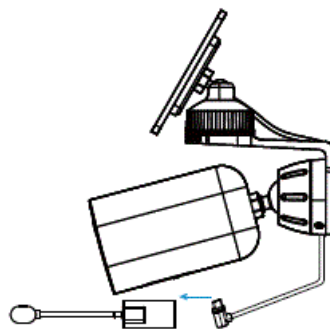

6. Connect the magnetic adaptor to the magnetic part of the solar panel.

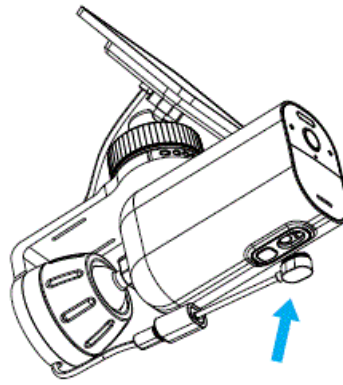

Option 2: Mount the Camera and the Solar Panel Separately (Best for Strong Solar Power)

If the camera is blocked, install the solar panel in solar and L5 e the provided USB-C extension cable and Magnetic suction line to get strong solar power. The camera can be mounted new wall allowing the ceiling.

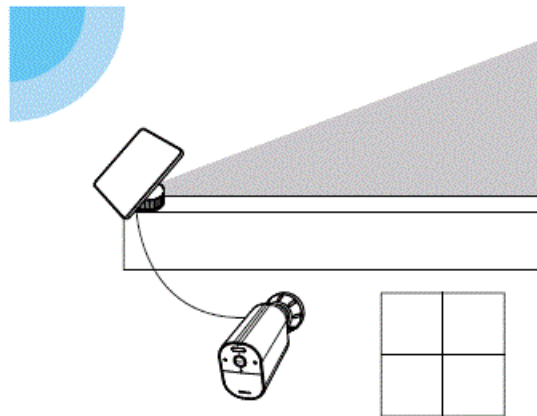

1. Disassemble the Solar Panel Mounting Bracket.

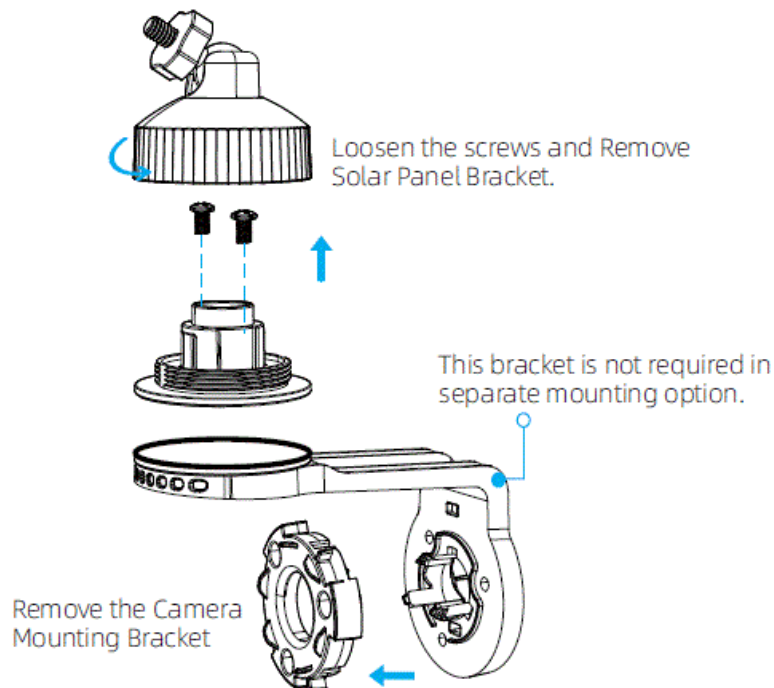

2. Install the mounting bracket of the solar panel in a suitable ambition

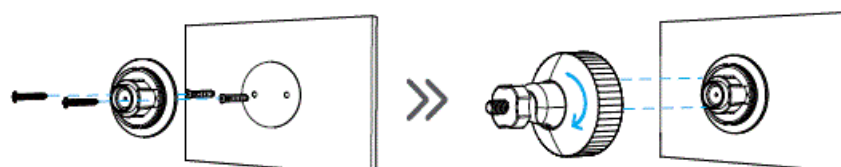

3. Install the solar panel onto its mounting bracket by turning it, then adjust the angle.

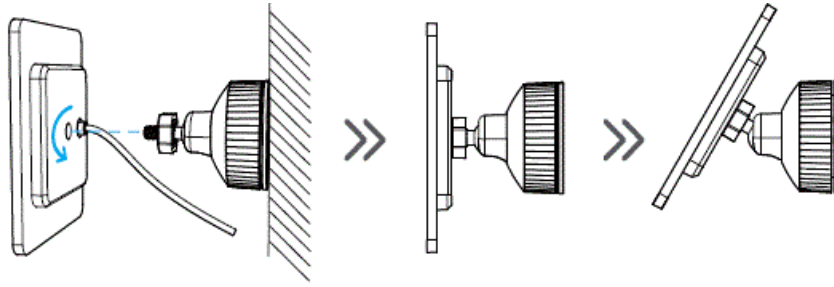

4. Install the camera

Drill holes with a 6.0 mm drill bit with the included positioning card then insert the anchors into the holes

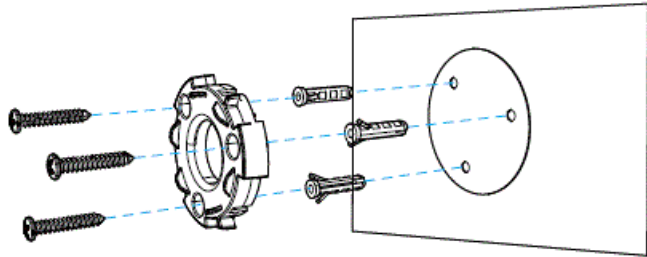

5. Install the camera onto its mounting bracket by turning it clockwise until it clicks into place.

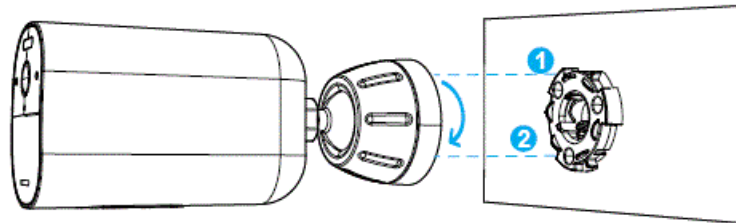

6. Tighten the locking screw on the mount bracket, and then adjust to the angle you need

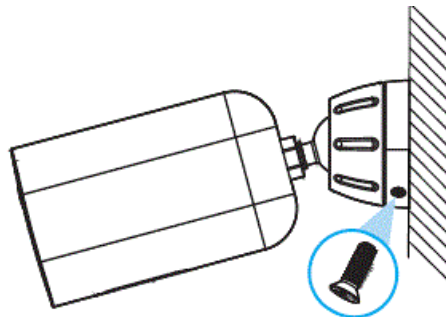

7. Connect the solar panel to the camera using the provided USB-C extension cable.

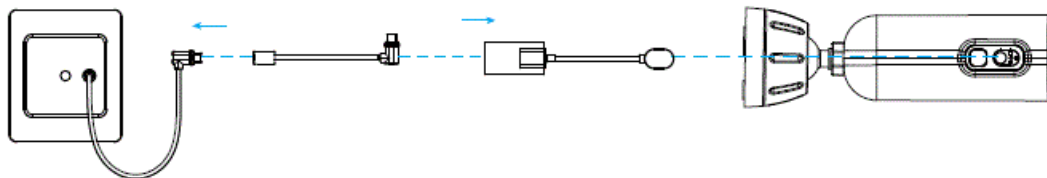

Contents

[1 Camera Holding Bracket](#)

[2 Troubleshooting](#)

[3 Notification of Compliance](#) The terms **HDMI** and **HDMI High- Definition Multimedia Interface**, and the **HDMI Logo** are trademarks or registered trademarks of **HDMI Licensing Administrator, Inc.** in the United States and other countries.

[4 compliance Statement](#)

[5 Documents / Resources](#)

[5.1 References](#)

[6 Related Posts](#)

Camera Holding Bracket

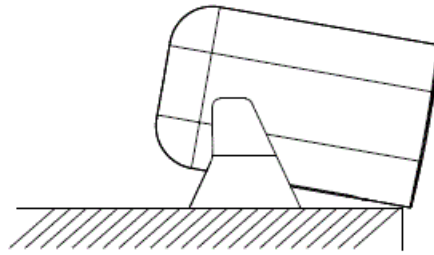

The camera holding bracket can be used for placement and adjustment of angles in some scenarios.

Pairing the Camera

Pair your add-on camera or re-add existing camera to your NVR:

Option 1 : Using the “SmartCamera View Life” app, from the Live view, tap the “.” button, and then tap “Pairing” to start the pairing process. You’ will have a 180-second timer to pair with your Camera.

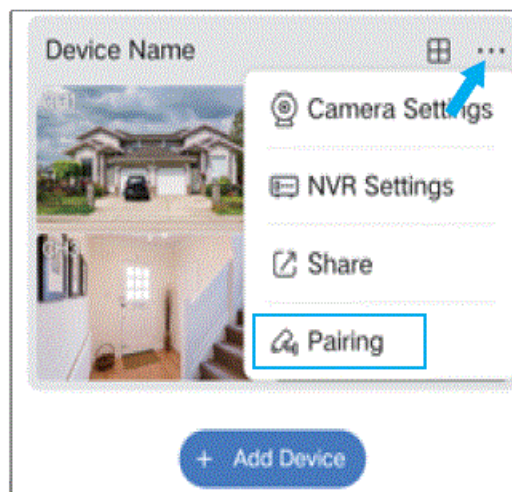

Poke the camera’s reset button three times within three seconds to start pairing with the NVR. A “Pairing Successful” message should appear on the screen. If you do not see this message, repeat the steps above.

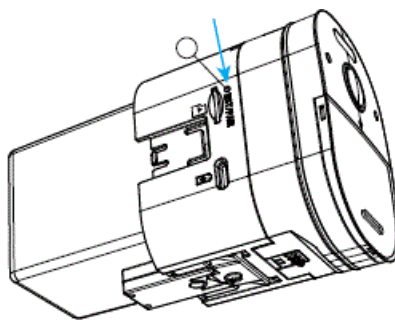

Option 2: You can also add the camera via the Monitor, tap the “pair” button on NVR Live View menu to start the pairing process. If t

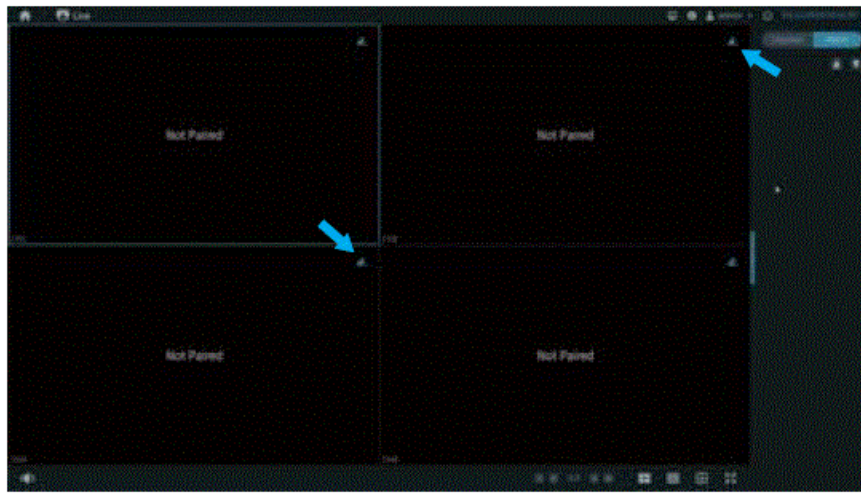

Poke the camera pair button three times within three seconds to start pairing with your NVR. A “Pairing Successful” message should appear on the screen. If you do not see this message, repeat the steps above.

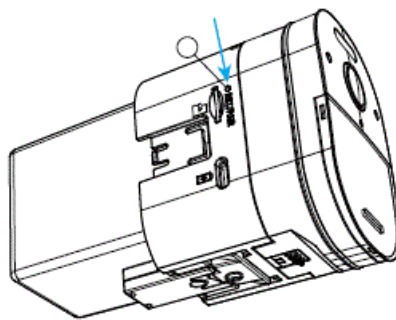

Troubleshooting

No video cut to put on the mounting wall

If there's no video output on the monitor from NVR, please try the following solutions:

- Monitor resolution should be at least 720P or above.
- Hold down right mouse button for 10 seconds to restore default resolution.
- Double check the HDMI connection, or swap another cable or monitor to test.

Notification of Compliance



The terms HDMI and HDMI High- Definition Multimedia Interface, and the HDMI Logo are trademarks or registered trademarks of HDMI Licensing Administrator, Inc. in the United States and other countries.



compliance Statement

This device contains licence-exempt transmitters)/receivers) that comply with Part 15 of the FCC Rules. Operation is subject to the following two conditions:

1. This device may not cause interference.
2. This device must accept any interference, including interference that may cause undesired operation of the device.

Caution: The user is cautioned that changes or modifications not expressly approved by the party responsible for compliance could void the user's authority to operate the equipment.

NOTE: This equipment has been tested and found to comply with the limits for a Class B digital device, pursuant to Part 15 of the FCC Rules. These limits are designed to provide reasonable protection against harmful interference in a residential installation. This equipment generates, uses and can radiate radio frequency energy and, if not installed and used in accordance with the instructions, may cause harmful interference to radio communications. However, there is no guarantee that interference will not occur in a particular installation. If this equipment does cause harmful interference to radio or television reception, which can be determined by turning the equipment off and on, the user is encouraged to try to correct the interference by one or more of the following measures:

- Reorient or relocate the receiving antenna.
- Increase the separation between the equipment and receiver.
- Connect the equipment into an outlet on a circuit different from that to which the receiver is connected.
- Consult the dealer or an experienced radio/TV technician for help.

FCC Radiation Exposure Statement

This equipment complies with FCC radiation exposure limits set forth for an uncontrolled environment. This equipment should be installed and operated with a minimum distance of 20cm between the radiator and your body. This transmitter must not be co-located or operating in conjunction with any other antenna or transmitter.



Compliance Statement

The transmitter/receiver exempt from licensing contained in this device complies with Innovation, Science and Economic Development Canada's (ISED) regulations applicable to license-exempt radio apparatus. Operation is subject to the following two conditions:

1. This device must not cause interference, and
2. This device must accept any interference, including interference that may cause undesired operation of the device.

IC Radiation Exposure Statement

This equipment complies with the radiation exposure limits set forth for uncontrolled environments in Canada. This equipment should be installed and operated with a minimum distance of 20 cm between the radiator and your body. This transmitter must not be co-located or operating in conjunction with any other antenna or transmitter.



Simplified EU Declaration of Conformity

SmartCamera View declares that this device is in compliance with the essential requirements and other relevant provision of Directive EN300328, EN301489-1, EN31489-17, EN IEC 62311, EN IEC 62368.

Correct Disposal of This Product Please recycle this product responsibly to promote the sustainable reuse of material resources and avoid potential harm to the environment.



Correct Disposal of This Product

Please recycle this product responsibly to promote the sustainable reuse of material resources and avoid potential harm to the environment.

Correct Disposal of This Product

This marking indicates that this product should not be disposed with other household wastes throughout the EU. To prevent possible harm to the environment or human health from uncontrolled waste disposal, recycle it responsibly to promote the sustainable reuse of material resources. To return your used device, please use the

return and collection systems or contact the retailer where the product was purchased. They can take this product for environment safe recycling.



Documents / Resources

	RaySharp B221 Wireless NVR System [pdf] User Guide B221 Wireless NVR System, B221, Wireless NVR System, NVR System
-----------------------------------------------------------------------------------	---------------------------------------------------------------------------------------------------------------------------------------

References

- [User Manual](#)

[Manuals+](#), [Privacy Policy](#)

This website is an independent publication and is neither affiliated with nor endorsed by any of the trademark owners. The "Bluetooth®" word mark and logos are registered trademarks owned by Bluetooth SIG, Inc. The "Wi-Fi®" word mark and logos are registered trademarks owned by the Wi-Fi Alliance. Any use of these marks on this website does not imply any affiliation with or endorsement.