



Rayrun P11 Single Color LED Wireless Remote Controller User Manual

[Home](#) » [RayRun](#) » Rayrun P11 Single Color LED Wireless Remote Controller User Manual 

Contents

- 1 Rayrun P11 Single Color LED Wireless Remote Controller User Manual
- 2 Introduction
- 3 Model: P11(-S)
- 4 Wiring & Indicator
 - 5 1. Power supply input
 - 6 2. LED output
 - 7 3. Work status indicator
 - 8 4. Wiring diagram
- 9 Functions
 - 10 5. Turn ON / OFF
 - 11 6. Brightness adjust
 - 12 5. Brightness control
 - 13 6. Color temperature control
 - 14 7. Brightness shortcut keys
 - 15 8. Color temprature shortcut keys
 - 16 9. Remote indicator
 - 17 10. Using the remote controller
 - 18 10. Pair a new remote controller
 - 19 11. Keep current remote only
- 20 12 . Protection
- 21 Specification
- 22 Read More About This Manual & Download PDF:
- 23 Documents / Resources
- 24 Related Posts

Rayrun P11 Single Color LED Wireless Remote Controller User Manual



Introduction

P11 single color LED controller is designed to drive constant voltage LED products in voltage range of DC5- 24V. The main unit works with a RF remote controller, user can setup LED brightness with shortcut keys from the remote controller. The main unit is powered by DC power supply and receives remote controller commands to drive LED fixtures.

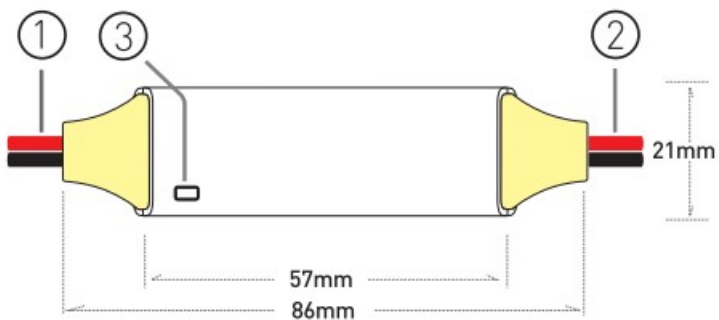

Model: P11(-S)

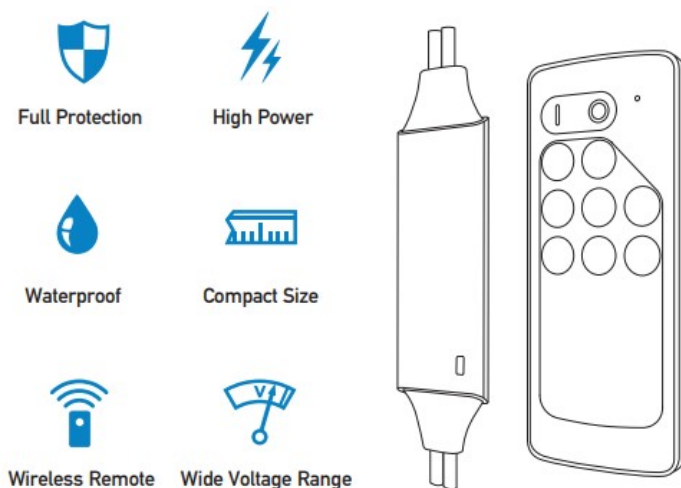

Wiring & Indicator

1. Power supply input

Wiring & Indicator

The controller supply voltage range is from DC 5V to 24V. The red power cable should be connected to power positive and black to negative. (For other cable color, please refer to the labels). The LED output voltage is at same level as the power voltage, please make sure the power supply voltage is correct and the power rating is capable for the load.

2. LED output

Connect constant voltage LED loads. Please connect red cable to LED+ and black cable to LED-. Please make sure the LED rated voltage is same as the power supply and each channel's maximum load current is in range of the controller rated current.

3. Work status indicator

This indicator shows all working status of the controller. It displays different events as following: Steady blue: Normal working. Short white blink: Command received.

White blink for 3 times: New remote paired. Single yellow flash : Edge of the content. Red flash: Overload protection. Yellow flash: Overheat protection.

4. Wiring diagram

Please connect the controller output to LED loads and power supply to the controller power input. The power supply voltage must be same as the LED load's rated voltage. Check all cables to be well connected and insulated before power on.

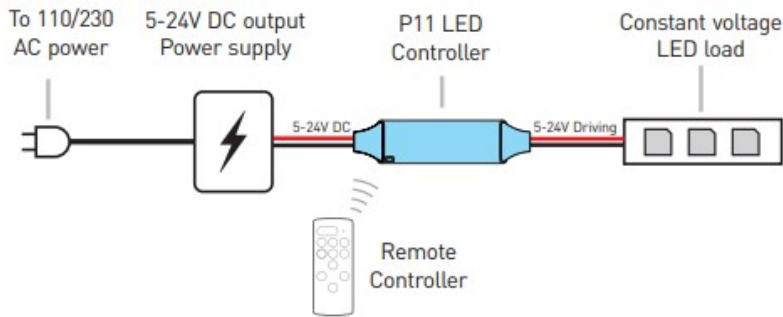

Functions

5. Turn ON / OFF

Press 'I' key to turn on unit or press 'O' key to turn off. Controller will memorize the on/off status and will restore to the previous status on next power on.

Please use remote controller to turn on the unit if it was switched to off status before previous power cut.

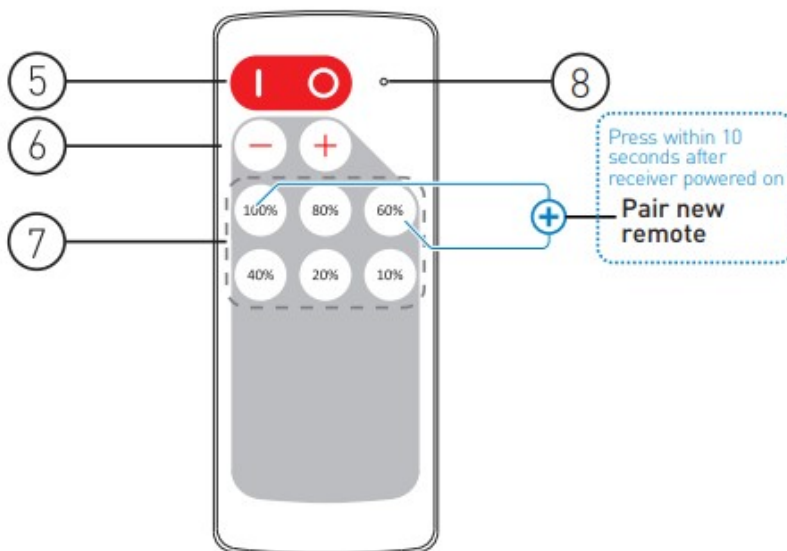

6. Brightness adjust

Press '+' key to increase brightness and press '-' key to decrease. Hold press '+' or '-' key to adjust brightness smoothly

5. Brightness control

Adjust light brightness. Press key to increase brightness and press key to decrease. The controller applies brightness gamma correction on dimming control and makes the brightness tuning more smooth to human sense.

6. Color temperature control

Adjust light color temperature. Press key to increase color temperature and press key to decrease.

7. Brightness shortcut keys

Jump to the relative brightness level when press the corresponding keys.

8. Color temprature shortcut keys

Set the color temperature to full cool white, full warm white or neutral white which is 50% warm and 50% cool white.

9. Remote indicator

This indicator blinks when remote controller is working. The indicator will flash slowly when the remote battery is used out, please change the battery in this case. The battery type is CR2032 cell.

10. Using the remote controller

Please pull out the battery insulation tape before using. The RF wireless remote signal can pass through some nonmetal barrier. For proper receiving remote signal, please do not install the controller in closed metal parts.

10. Pair a new remote controller

The remote controller and receiver is 1 to 1 paired as factory default. It's possible to pair maximum 5 remote controllers to one receiver and each remote controller can be paired to any receiver.

To pair a new remote controller, please operate with the following two steps:

- Plug off the power of receiver and plug in again after more than 5
- Press and key simultaneously for about 3 seconds, within time of 10 seconds after the receiver powered

11. Keep current remote only

If one receiver is paired with several remote controllers and only one remote need to be kept, user can pair the current using remote for the second time, then the receiver will unpair all other remote controllers.

12 . Protection

The controller has protection function against output short circuit, overload and overheat. It will run into protection and stop working at these extreme conditions. The controller will try to recover working after a while once the working condition is good.

For protection issues, please check the situation with different indicator information:

Red flash: Check the output cables and load, make sure no short circuit and the load current is in rated range. Also the load must be constant voltage type.

Yellow flash: Check the installation environment, make sure in a rated temperature range and with good ventilation or heat dissipation condition.

Specification

Model	N21
Brightness grade	11 levels
Brightness shortcut	3 levels
Color temperature grade	7 levels
Color temperature shortcut	3 levels
PWM grade	4000 steps
Overload protection	Yes
Overheat protection	Yes
Working voltage	DC 5-24V
Remote frequency	433.92MHz
Remote control distance	>15m at open area
Rated output current	5A
Controller dimension	87x24x15mm

Read More About This Manual & Download PDF:

Documents / Resources

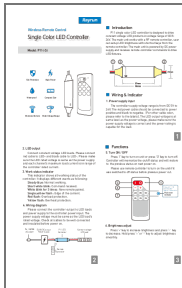

[Rayrun P11 Single Color LED Wireless Remote Controller](#) [pdf] User Manual

P11 Single Color LED Wireless Remote Controller, P11, P11 Single Remote Controller, Single Color LED Wireless Remote Controller, Single Color LED Remote Controller, LED Wireless Remote Controller, LED Remote Controller, LED Wireless Controller, Wireless Controller, Remote Controller, LED Controller, Controller