

Rayotec Freedom WiFi Mobile App



Rayotec Freedom WiFi Mobile App Owner's Manual

[Home](#) » [Rayotec](#) » Rayotec Freedom WiFi Mobile App Owner's Manual 

Contents

- 1 Rayotec Freedom WiFi Mobile App
- 2 Introduction to WI-FI Functions
- 3 Download and install the control software
- 4 Reset the AC WI-FI module
- 5 Configure the Devices
- 6 Others
- 7 Documents / Resources
 - 7.1 References



Rayotec Freedom WiFi Mobile App



Introduction to WI-FI Functions

The AC system is equipped with remote control technology, with the WI-FI module inside the machine connected to the display panel and the command to run the AC transmitted. The AC system is in constant connection with a wireless router or access point attached to the Internet. Mobile terminals such as smartphones and tablet computers, on which special control software are installed and WI-FI modules successfully configured locally, can be used as remote controllers once they are connected to the Internet.

Download and install the control software

The control software can be downloaded and installed as follows.

1. For mobile terminals such as smartphones and tablets (Android 4.1 and iOS 6.0 or above only), search and download "AC Freedom" from Google Play or App store and install it on your system.
2. You may also use your mobile terminal (Android 4.1 and iOS 6.0 or above only) to scan the "QR code" (see Fig. 1) with a third-party scan tool, which will automatically direct you to the download interface of AC Freedom for you to download and install the software.



Once the control software is installed, enter the “Scanning Interface” (for downloading the Welcome Page).
There are two types of log-ons contained in the Scanning Interface(See Fig.2):

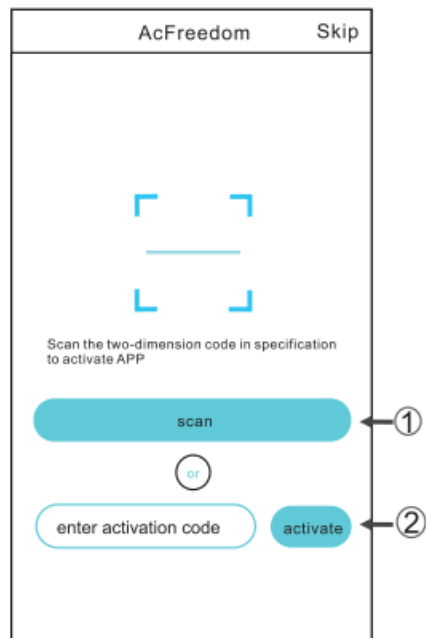

Download and install the control software

1. By clicking “scan” and scanning the QR code on the right (See Fig.3)

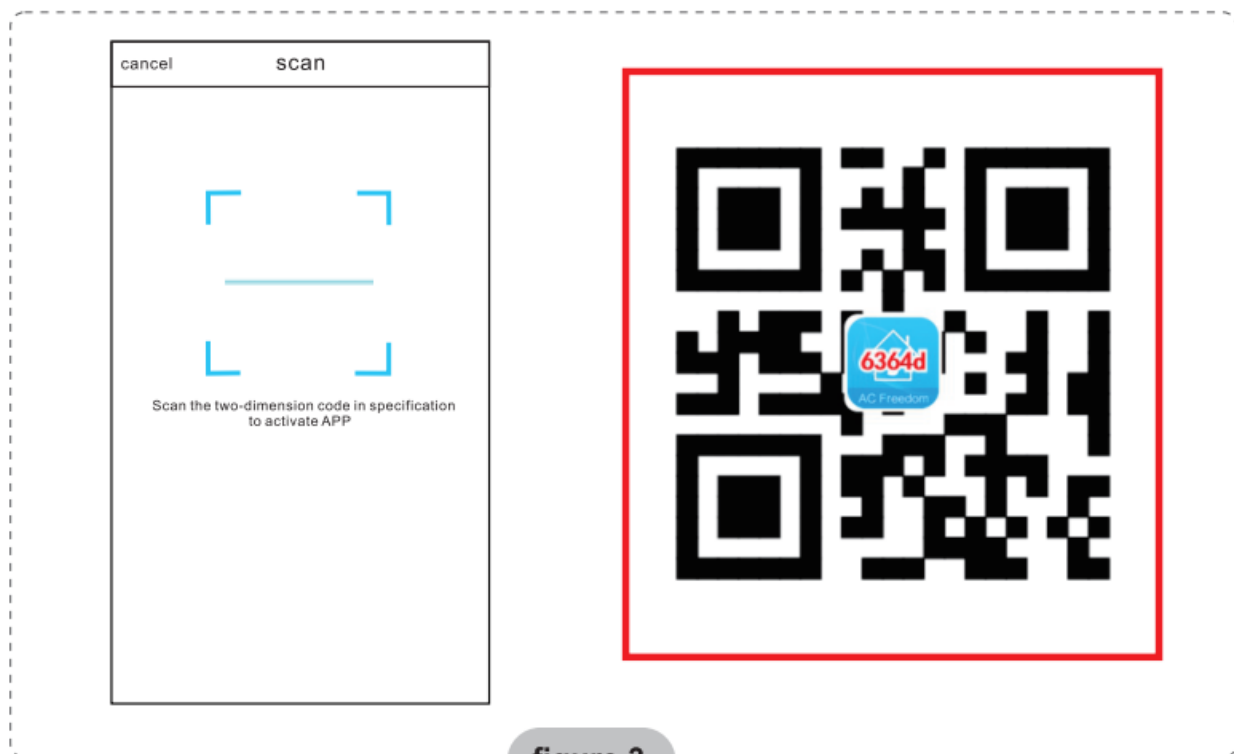
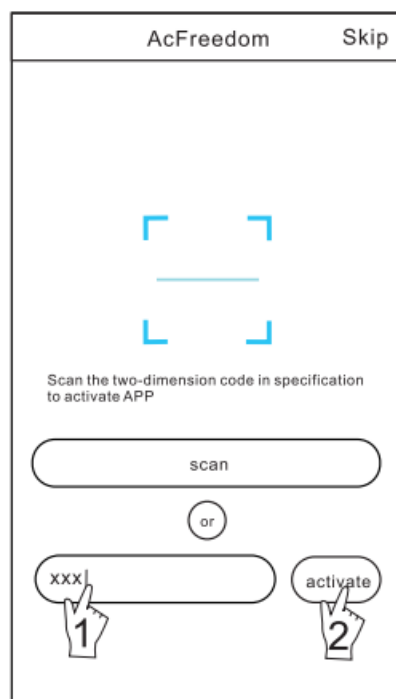

figure 3

2. By entering the activation code **(6364d)** in the area prompted by “enter activation code” (see Fig.4)



Reset the AC WI-FI module

In the case of first-time configuration or after changing the connected wireless router is, the WI-FI module inside the air conditioner needs to be reset.

Note: The remote controller provided in this figure is just one of many models which is for your reference only. Please rely on the model you have bought, though the operations are the same for all models.

- If the remote controller with “HEALTH” button, reset the WI-FI module following method 1;
- If the remote controller has no “HEALTH” button, reset the WI-FI module following method 2.

Method 1:

When AC is running, press the “HEALTH” button 8 times, and reset successfully after twice “beep” sounds. (see Fig.5)

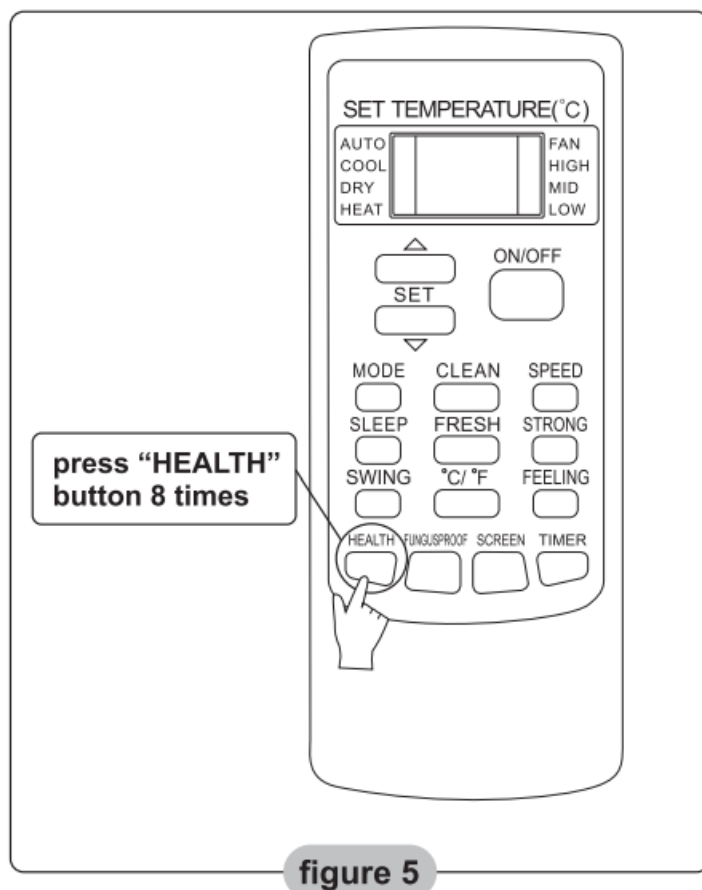

Method 2:

When AC is running, press the “COOL” button and the “+” button together for 3s, hear the “beep” sound 8 times, then interval 2s and hear twice “beep” sounds reset successfully. (see Fig.6)

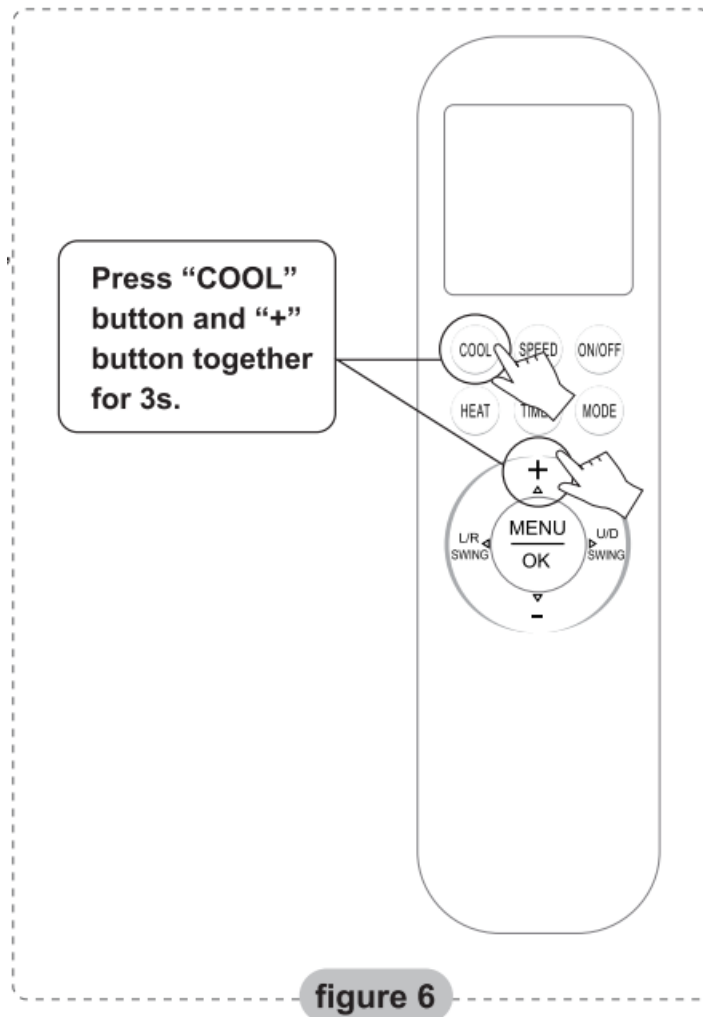

Note: If the device is not connected successfully, please reset the air conditioner Wi-Fi in the same way.
Smartphone and or other mobile terminals connect to Wi-Fi or hotspot

Activate the WI-FI function of the mobile terminal and connect it to a wireless router or an access point.

Note:

A wireless router is required for the WI-FI function to work. Please purchase one if you do not already have one.

Configure the Devices

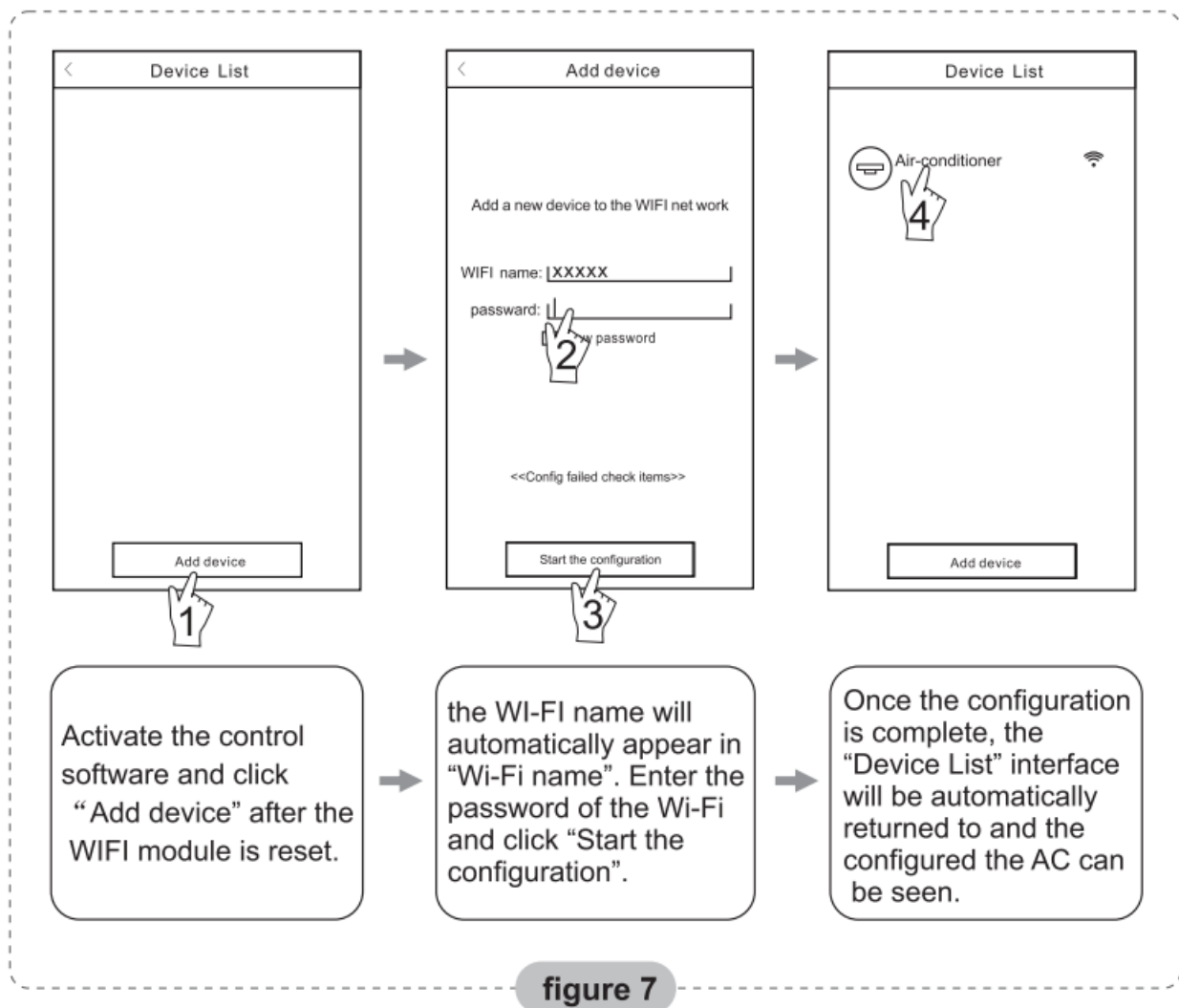

Note:

1. In the case of first-time configuration or after the connected wireless router or access point is changed, make sure the mobile terminal is already connected to the wireless router or access point to be paired with the WI-FI module.
2. If the configuration fails, press "Config field check items" to check notes about the failure before reconfiguring the AC.

After the configuration is successful, click the corresponding AC name to enter the control interface for further operation.

Others

1. The software provides a help service through which the users may check the operational instructions of the software and other information.
2. Besides, as the operation interface and the function of the software are under constant improvement, we will keep you informed about the subsequent upgrades for your updating.
3. As the operation interface may change due to the constant version upgrading, the figures in this manual are for reference only, so please rely on the actual operation interface.

Appendix A: <<Config failed check items>>

1. Please check the Wi-Fi icon on the air conditioner panel, if the icon is not displayed, please contact customer service.
 2. Please make sure the mobile phone network is under the current router WI-FI environment: Close the mobile phone 3G/4G data connection, to be connected to the router WI-FI pairing.
 3. Please check whether the module has been reset successfully. For details, see “Reset AC WI-FI module”
 4. Please check the Wi-Fi name of the router, recommended not to contain spaces and other non-alphanumeric characters.
 5. Please check the Wi-Fi password of the router, not allowed to be more than 32 bits, recommended not to contain spaces and special symbols in addition to letters and numbers.
 6. Please check whether the Wi-Fi password input is correct when APP configuration: you can check the show password to confirm when input the WI-FI password.
-

Documents / Resources

	<p>Rayotec Freedom WiFi Mobile App [pdf] Owner's Manual Untitled, arctic-pro-wifi-manual-eng.pdf, WiFi manual SLO-ENG.pdf, Freedom WiFi Mobile App, Freedom Mobile App, WiFi Mobile App, Mobile App, WiFi App, App</p>
--	--

References

- [User Manual](#)

Manuals+, Privacy Policy

This website is an independent publication and is neither affiliated with nor endorsed by any of the trademark owners. The "Bluetooth®" word mark and logos are registered trademarks owned by Bluetooth SIG, Inc. The "Wi-Fi®" word mark and logos are registered trademarks owned by the Wi-Fi Alliance. Any use of these marks on this website does not imply any affiliation with or endorsement.