



[Home](#) » [Raychem](#) » **Raychem CS-100 Core Sealer Cold Applied Owner's Manual** 

Contents [[hide](#)]

- [1 Raychem CS-100 Core Sealer Cold Applied](#)
- [2 Specifications](#)
- [3 DESCRIPTION](#)
- [4 APPROVALS](#)
- [5 KIT CONTENTS](#)
- [6 Product Usage Instuctions](#)
- [7 More Information](#)
- [8 FAQ](#)
- [9 Documents / Resources](#)
 - [9.1 References](#)



Raychem CS-100 Core Sealer Cold Applied

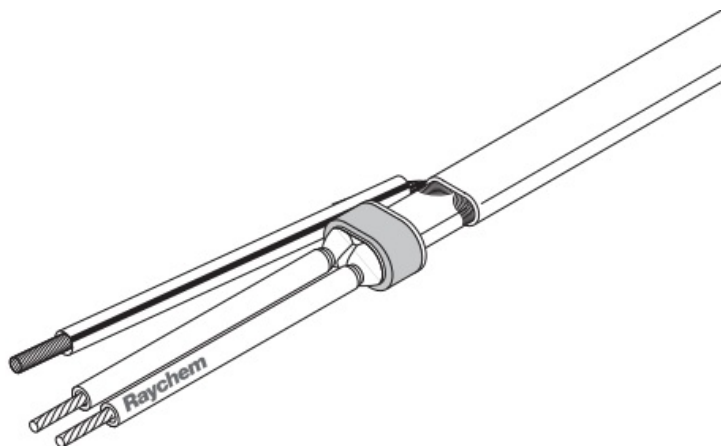

Specifications

- Product Name: CS-100 Heating Cable Core Sealer
- Approvals: FM Approved, CSA Certified for ordinary and hazardous locations
- Designed for use with: Raychem BTV-CR, BTV-CT, QTVR-CT, XTVR-CT, HTV-CT, and VPL-CT industrial parallel heating cables

DESCRIPTION

The Raychem CS-100 core sealer is a fluoroether-sealant-filled insulator. It is designed for use with Raychem BTV-CR, BTV-CT, QTVR-CT, XTVR-CT, HTV-CT, and VPL-CT industrial parallel heating cables. The core sealer is for use only as a replacement for the heat-shrinkable tubing insulators or CS-100 core sealer in the following kits.

- JBS-100-A
- JBM-100-A
- JS-100-A
- C75-100-A
- JBS-100-L-A
- JBM-100-L-A
- HAK-C-100
- T-100
- AMG-BC-III
- AMG-BS-III
- AMG-BY-III

This product must not be used with monitor wire, LBTv2 heating cables, with other connection kits, or by itself.

For technical support, call your local Chemelex representative.

APPROVALS

The core sealer is FM Approved and CSA Certified for ordinary and hazardous locations when used as described above.

KIT CONTENTS

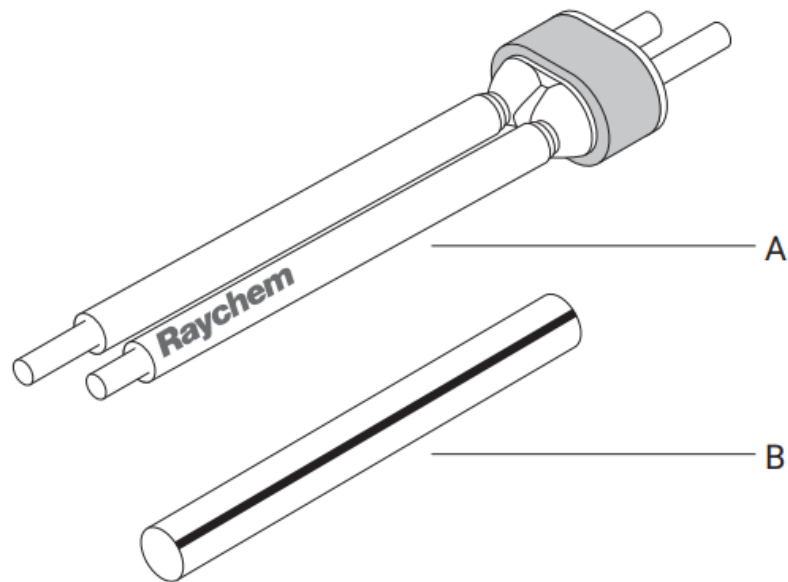

Item	Qty	Description
A	1	CS-100 core sealer
B	1	Green/yellow tube

WARNING

- This component must be installed correctly to ensure proper operation and to prevent shock or fire. Read these important warnings and carefully follow all the installation instructions.
- Component approvals and performance are based on the use of Chemelex-specified parts only. Do not use substitute parts or vinyl electrical tape.
- Bus wires will short if they contact each other. Keep bus wires separated.
- Damaged bus wires can overheat or short. Do not break bus wire strands when handling them.
- Keep components and heating cable ends dry before and during installation.

CAUTION

- HEALTH HAZARD: Prolonged or repeated contact with the sealant in the boot may cause skin irritation. Wash hands thoroughly.
- Overheating or burning the sealant will produce fumes that may cause polymer fume fever.
- Avoid contamination of cigarettes or tobacco.
- Consult MSDS VEN 0058 for further information.

- CHEMTREC 24-hour emergency telephone: [800-424-9300](tel:800-424-9300)
- Non-emergency health and safety information: [800-545-6258](tel:800-545-6258).

Product Usage Instructions

FOLLOW HEATING CABLE PREPARATION STEPS IN THE APPROPRIATE RAYCHEM CONNECTION KIT, THEN FOLLOW STEPS ILLUSTRATED BELOW.

For VPL Only

- Cut off and discard end of green/yellow tube.
- Cut off and discard end of core sealer legs.
- Mark the jacket as shown. VPL will appear different.
- Refer to material safety data sheet VEN 0058.
- If needed, re-twist and straighten bus wires.
- Insert bus wires into guide tubes.
- Push the core sealer onto the heating cable to the mark made in Step 1.
- Note: Extra force may be required for larger cables or at lower temperatures.
- Make sure the bus wires do not kink, bunch, or cross over.
- Remove guide tubes and dispose of them in a plastic bag.
- Slip the green/yellow tube onto the braid.
- Trim wires to length specified in kit installation instructions.
- Resume instructions in the kit at the appropriate step.
- Leave these instructions with the end user for future reference.

For VPL Only

- Cut off and discard end of green/yellow tube.
- Cut off and discard end of core sealer legs.

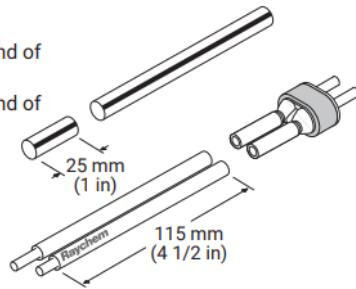

1

- Mark the jacket as shown. VPL will appear different.

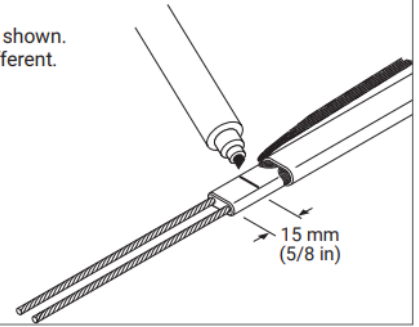

2

- Refer to material safety data sheet VEN 0058.
- If needed, re-twist and straighten bus wires.
- Insert bus wires into guide tubes.

Make sure all strands go into the tubes.

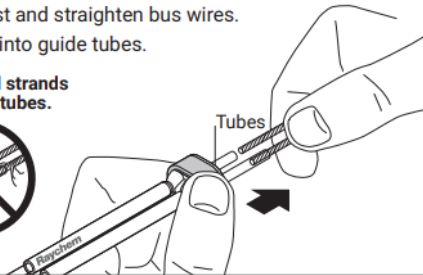

3

- Push the core sealer onto the heating cable to the mark made in Step 1.

Note: Extra force may be required for larger cables or at lower temperatures.

Make sure the bus wires do not kink, bunch, or cross over.

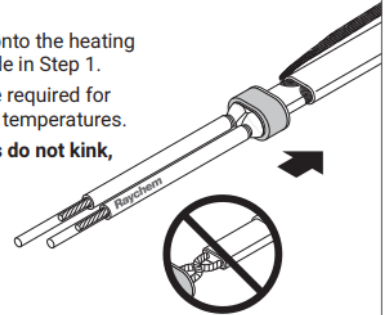

4

- Remove guide tubes and dispose of them in the a plastic bag.
- Slip the green/yellow tube onto the braid.

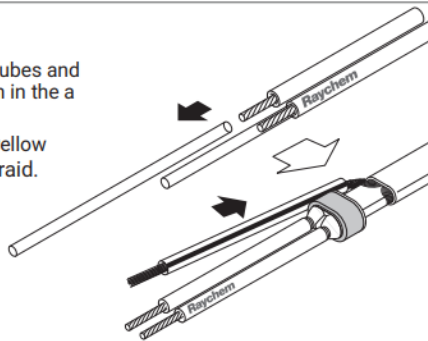

5

- Trim wires to length specified in kit installation instructions.
- Resume instructions in the kit at the appropriate step.
- Leave these instructions with the end user for future reference.

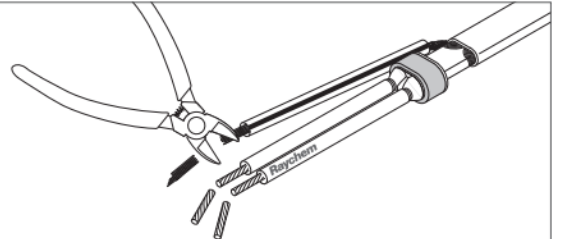

More Information

North America

Tel +1 800 545 6258 info@chemelex.com

Latin America

Tel +1 713 868 4800 info@chemelex.com

Europe, Middle East, Africa, India

Tel +32 16 213 511

Fax +32 16 213 604

info@chemelex.com

Asia Pacific

©2025 Chemelex. All Chemelex marks and logos are owned or licensed by Chemelex Europe GmbH or its affiliates. All other trademarks are the property of their respective owners. Chemelex reserves the right to change specifications without notice.

RAYCHEM-IM-H55821-CS100-EN-2504

FAQ

- **Q: Can the CS-100 core sealer be used with monitor wire?**

A: No, the CS-100 core sealer is not intended for use with monitor wire. It should only be used with the specified heating cables.

- **Q: What should I do if I experience skin irritation from the sealant?**

A: If you experience skin irritation from the sealant, wash your hands thoroughly and seek medical advice if necessary.

Documents / Resources

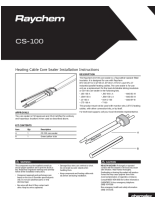
	Raychem CS-100 Core Sealer Cold Applied [pdf] Owner's Manual BTV-CR, BTV-CT, QTVR-CT, XTVR-CT, HTV-CT, VPL-CT, CS-100 Core Sealer Cold Applied, CS-100, Core Sealer Cold Applied, Sealer Cold Applied, Cold Applied
---	--

References

- [User Manual](#)

■ Raychem

■ BTV-CR, BTV-CT, Cold Applied, Core Sealer Cold Applied, CS-100, CS-100 Core Sealer Cold Applied, HTV-CT, QTVR-CT, Raychem, Sealer Cold Applied, VPL-CT, XTVR-CT

Leave a comment

Your email address will not be published. Required fields are marked *

Comment *

Name

Email

Website

☐ Save my name, email, and website in this browser for the next time I comment.

Post Comment

Search:

e.g. whirlpool wrf535swhz

Search

[Manuals+](#) | [Upload](#) | [Deep Search](#) | [Privacy Policy](#) | [@manuals.plus](#) | [YouTube](#)

This website is an independent publication and is neither affiliated with nor endorsed by any of the trademark owners. The "Bluetooth®" word mark and logos are registered trademarks owned by Bluetooth SIG, Inc. The "Wi-Fi®" word mark and logos are registered trademarks owned by the Wi-Fi Alliance. Any use of these marks on this website does not imply any affiliation with or endorsement.