



rapoo V780S Backlit Mechanical Gaming Keyboard User Guide

[Home](#) » [rapoo](#) » rapoo V780S Backlit Mechanical Gaming Keyboard User Guide 

rapoo V780S Backlit Mechanical Gaming Keyboard User Guide



Contents

- [1 Overview](#)
- [2 Package contents](#)
- [3 Installation](#)
- [4 System Requirements](#)
- [5 Combination keys](#)
- [6 Troubleshooting](#)
- [7 Warranty](#)
- [8 FCC Statement](#)
- [9 Documents / Resources](#)
- [10 Related Posts](#)

Overview

- **A.** Num-Lock indicator
- **B.** Caps Lock indicator

- C. Windows Lock indicator



Package contents

- 
- 

Installation

- Connect the keyboard cable to a USB port.

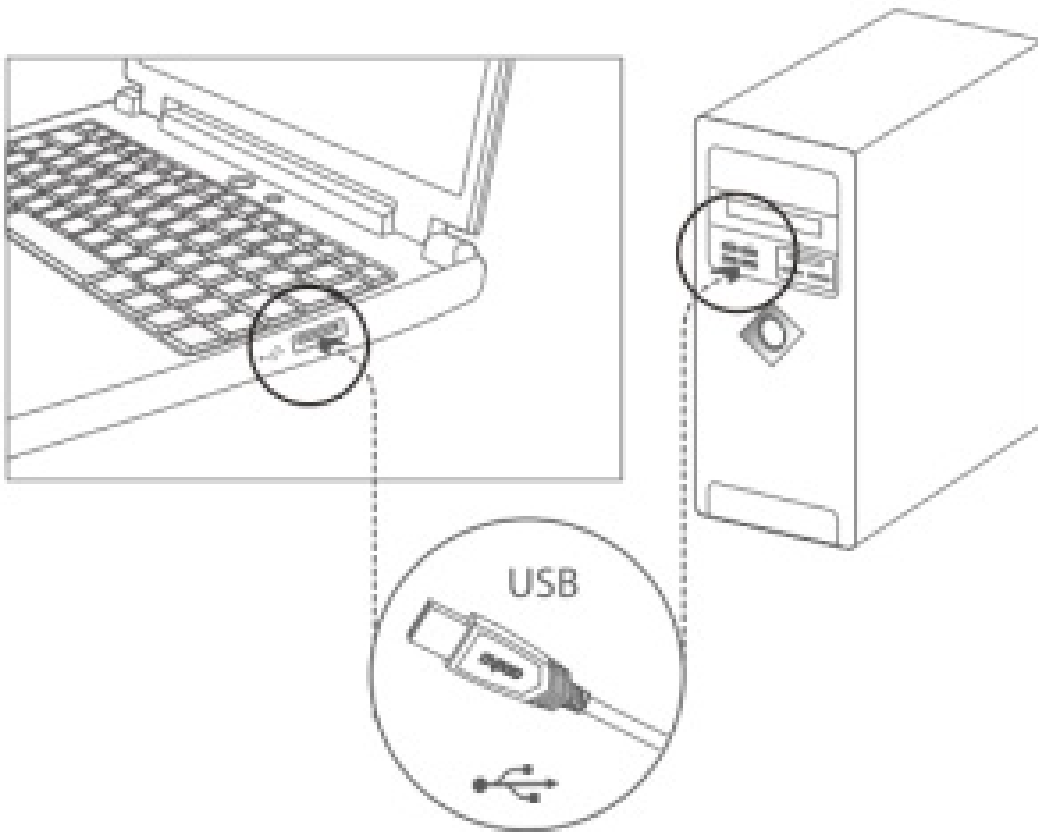

System Requirements

- Windows® XP/Vista/7/8/10 or later, USB port

Combination keys

- Fn+F1=Email
- Fn+F2=Homepage
- Fn+F3=My Computer
- Fn+F4=Search
- Fn+F5=Halt Key
- Fn+F6=Previous Music
- Fn+F7= Play / Pause
- Fn+F8=Next Music
- Fn+F9=Multimedia
- Fn+F10=Volume
- Fn+F11=Volume+
- Fn+F12=Mute
- Fn + ↑=Brightness+
- Fn + ↓=Brightness
- Fn + ←=Frequency
- Fn + →=Frequency+
- Fn + Windows key=Lock/unlock Windows key and APP key
- Fn + Ins=Static mode/breathing mode

- Fn +Home=Ripple mode
- Fn +PgUp=Shooting star mode
- Fn +PgDn=Flowing mode
- Fn +Del=Reactive mode
- Fn +End Switch among LOL mode, FPS mode, 8-key mode, 33-key mode and Over watch mode.
- Fn +Esc The backlight of the logo switches among breathing mode, static mode and off.

Troubleshooting

- **I always press the Windows key while gaming.**

PressFnkeyandWindowskeysimultaneouslytolocktheWindowskeyandpreventaccidentalactivations. There is an indicator in the upper right area.

Warranty

The device is provided with two-year limited hardware warranty from the purchase day. Please see www.rapoo.com for more information.



www.rapoo.com

FCC Statement

This equipment has been tested and found to comply with the limits for a Class B digital device, pursuant to part 15 of the FCC rules. These limits are designed to provide reasonable protection against harmful interference in a residential installation. This equipment generates, uses and can radiate radio frequency energy and, if not installed and used in accordance with the instructions, may cause harmful interference to radio communications. However, there is no guarantee that interference will not occur in a particular installation. If this equipment does cause harmful interference to radio or television reception, which can be determined by turning the equipment off and on, the user is encouraged to try to correct the interference by one or more of the following measures:

- Reorient or relocate the receiving antenna.
- Increase the separation between the equipment and receiver.
- Connect the equipment into an outlet on a circuit different from that to which the receiver is connected.
- Consult the dealer or an experienced radio/TV technician for help.

To assure continued compliance, any changes or modifications not expressly approved by the party responsible for compliance could void the user's authority to operate this equipment. (Example- use only shielded interface cables when connecting to computer or peripheral devices).

FCC Radiation Exposure Statement

This equipment complies with FCC RF radiation exposure limits set forth for an uncontrolled environment. This transmitter must not be co-located or operating in conjunction with any other antenna or transmitter.

This equipment complies with Part 15 of the FCC Rules. Operation is subject to the following two conditions:

1. This device may not cause harmful interference, and
2. This device must accept any interference received, including interference that may cause undesired operation.

Caution!

The manufacturer is not responsible for any radio or TV interference caused by unauthorized modifications to this equipment. Such modifications could void the user authority to operate the equipment.

ISED RSS warning

This device complies with Industry Canada licence-exempt RSS standard (s). Operation is subject to the following two conditions:

1. this device may not cause interference, and
2. this device must accept any interference, including interference that may cause undesired operation of the device.

ISED Radiation Exposure Statement:

This equipment complies with ISED RF radiation exposure limits set forth for an uncontrolled environment. This transmitter must not be co-located or operating in conjunction with any other antenna or transmitter.

Any Changes or modifications not expressly approved by the party responsible for compliance could void the user's authority to operate the equipment.

It is forbidden to reproduce any part of this quick start guide without the permission of Shenzhen Rapoo Technology Co., Ltd.

Declaration of Conformity



We, the manufacturer
Shenzhen Rapoo Technology Co., Ltd.
Fax: +86-0755-2858 8555

Declare that the product
Product Name Backlit Mechanical Gaming Keyboard
Model No V780S

Complies with the following norms of :

EN 300 440 V2.1.1(2017-03)
EN 300 328 V2.1.1(2016-11)

EN 301 489-1 V2.2.0(2017-03)

EN 301 489-3 V2.1.1(2017-03)

EN 301 489-17 V3.2.0(2017-03)

EN 50663:2017

EN 62479:2010

EN 60950-1:2006+A11:2009+A1:2010+A12:2011+A2:2013

The product is in compliance with the essential requirements of Radio Equipment Directive 2014/53/EU, and the RoHS Directive 2011/65/E



Manufacturer/Authorised representative

Kai Guo, Manager

R&D Department Date of Issue: Aug. 30, 2019



Documents / Resources



[rapoo V780S Backlit Mechanical Gaming Keyboard](#) [pdf] User Guide
V780S, Backlit Mechanical Gaming Keyboard

[Manuals+](#).