



## rapoo MT760LW Multi Mode Wireless Mouse User Guide

[Home](#) » [rapoo](#) » rapoo MT760LW Multi Mode Wireless Mouse User Guide 

# rapoo

MT760L/MT760M

Quick Start Guide

Multimode Wireless Mouse



## Contents

- 1 Overview
- 2 Packaging Contents
- 3 Charging Mode
- 4 Connection mode
- 5 Install driver
- 6 Safety Instruction
- 7 Warranty conditions
- 8 Legal & Compliance Information
- 9 Documents / Resources
  - 9.1 References

## Overview

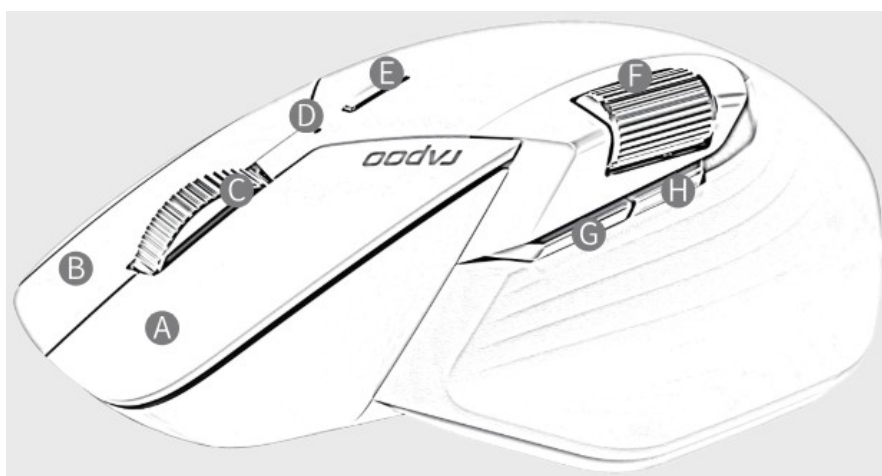

MT760L

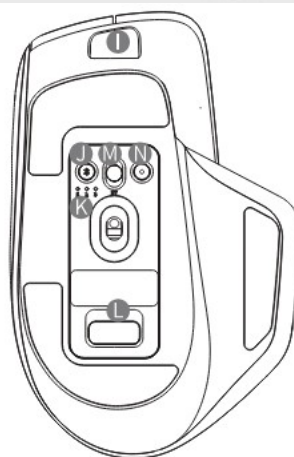

MT760M

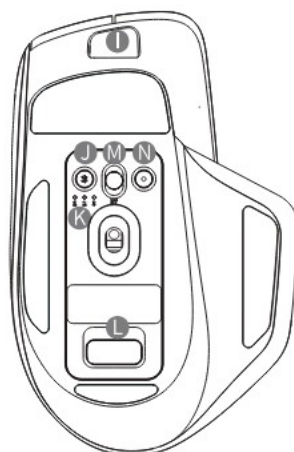

**A** Left button  
**B** Right button  
**C** Middle button/scroll wheel  
**D** Power and Connection Indicator  
**E** DPI Button  
**F** Side Scroll Wheel  
**G** Forward Button  
**H** Back Button

**I** Charging Port  
**J** Bluetooth Button  
**K** Bluetooth Indicator  
**L** Receiver Storage Bin  
**M** 2.4G Mode  
 Power Off  
 Bluetooth Mode  
**N** Customizable Button

## Packaging Contents

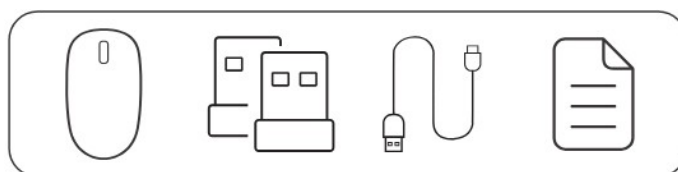

## Charging Mode

### Wired Charging

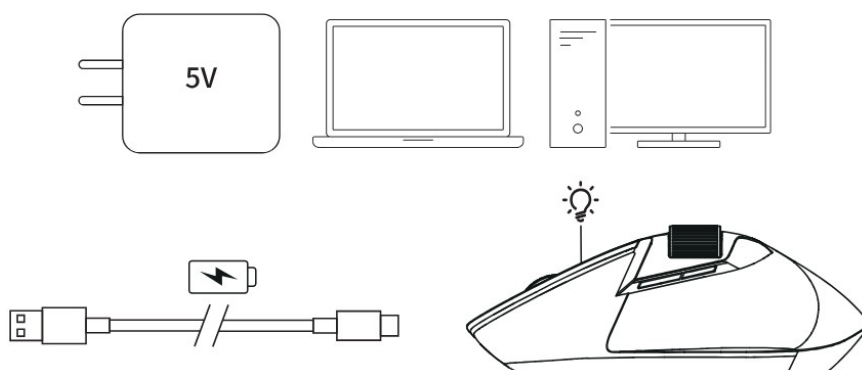

### Wireless Charging

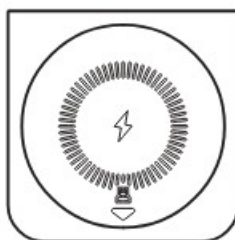

Wireless Charging Module WM1 (to be purchased separately)

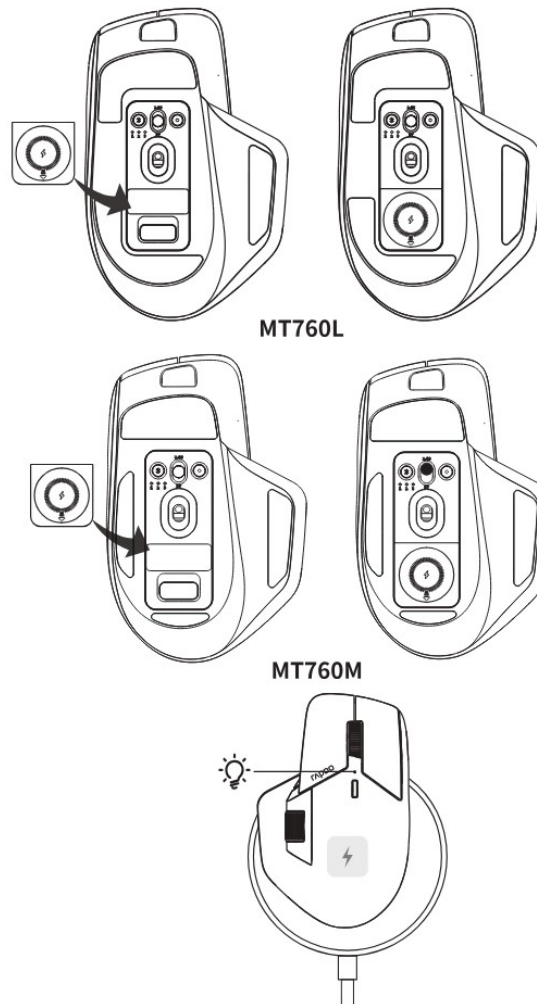

Lower Power Indication: Red indicator flashes (twice a second for 5 seconds) Charging: White indicator goes on  
 Fully Charged: White indicator goes off  
 Do not use wired connection during wireless charging, which will activate wired charging at the same time, resulting in product damage.

## Connection mode

2.4G Mode

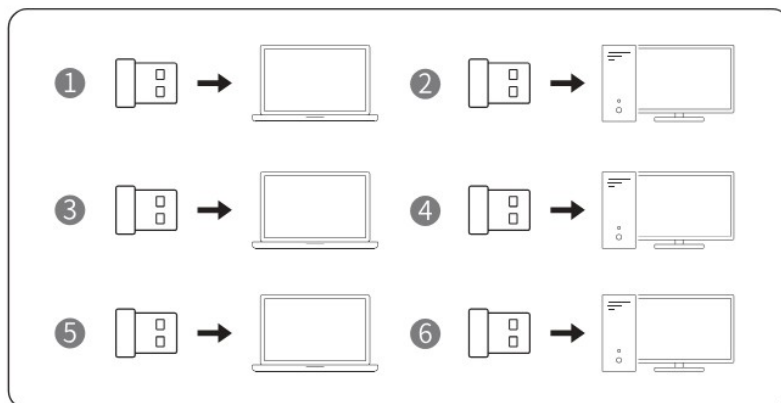
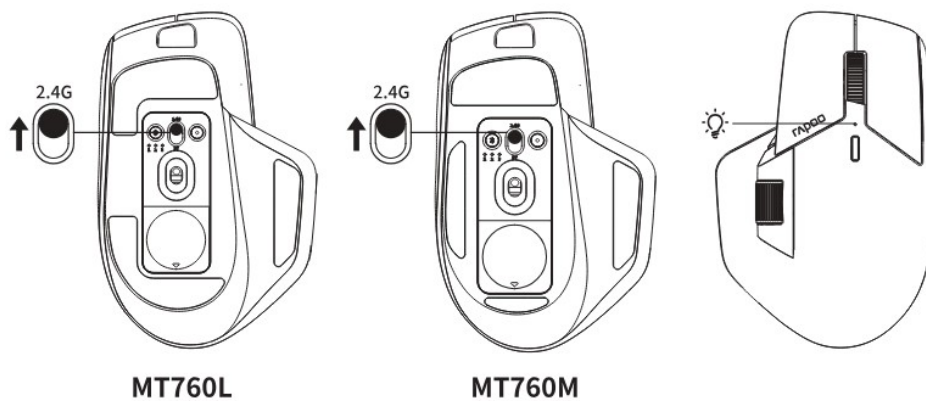

The mice can connect up to 6 receivers. The retail packaging includes 2 receivers are already connected to the mouse. Please purchase extra 4 receivers which needs to be paired by user (Please visit [www.rapoo-eu.com](http://www.rapoo-eu.com) for pairing steps)

**Connecting:** The mouse connection indicator flashes green for 5 times.

**Connected:** The mouse connection indicator goes off in green.

## Bluetooth mode

### Connecting Device A

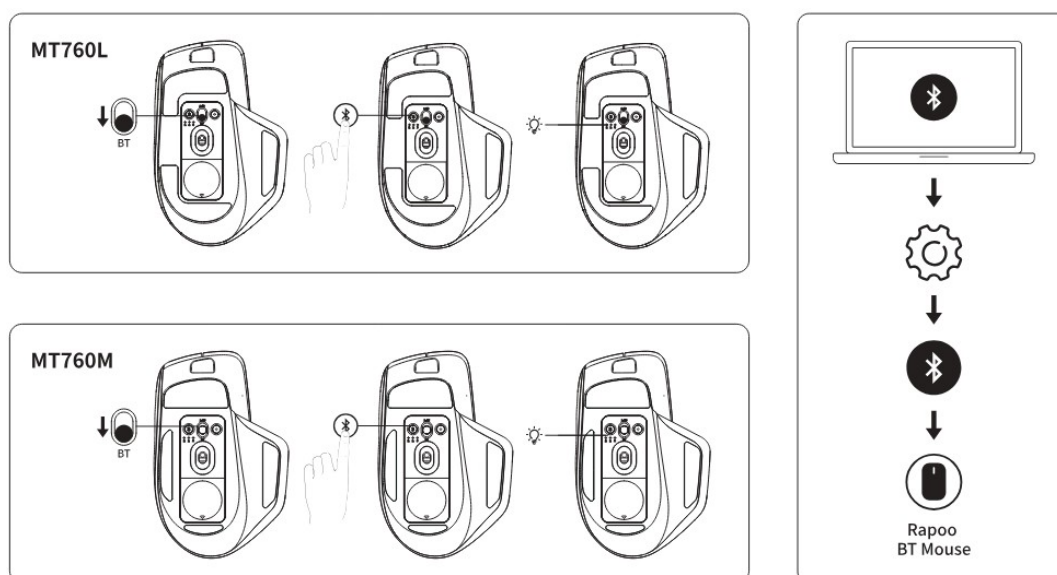

Press and hold the Bluetooth button more than 3 seconds for pairing: the green flashes rapidly twice a second; the light goes off if pairing is failed after 2 minute.

### Connecting Device B and C

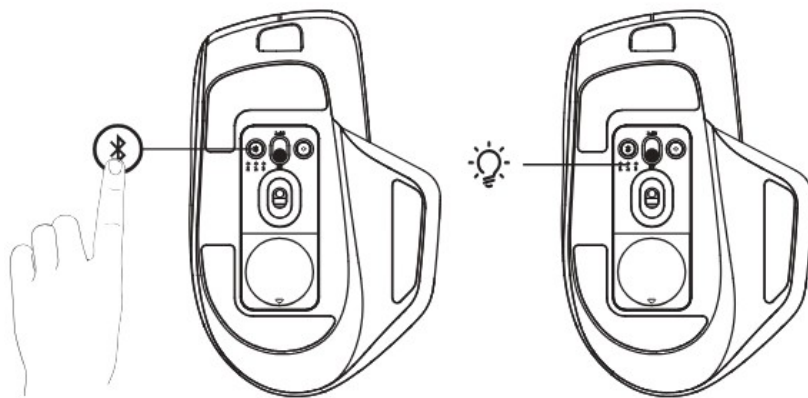

**MT760L**

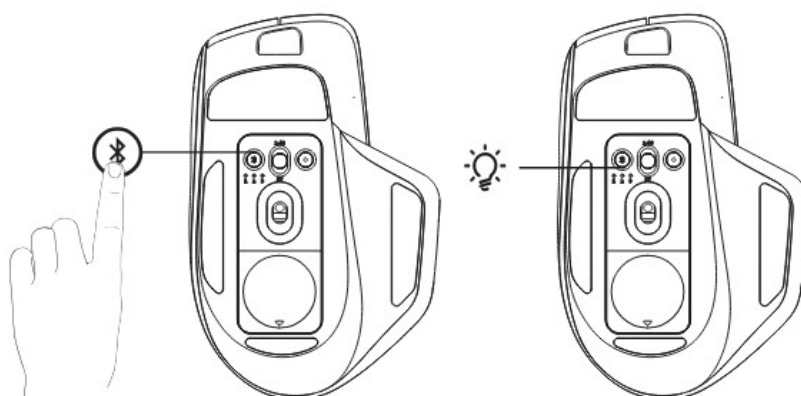

**MT760M**

Briefly press the Bluetooth button for switching: the green light flashes slowly once a second; the light goes off if pairing is failed after 30 seconds.

Press and hold the Bluetooth button more than 3 seconds for pairing: the green flashes rapidly twice a second; the light goes off if pairing is failed after 2 minutes.

#### Switching among Bluetooth devices

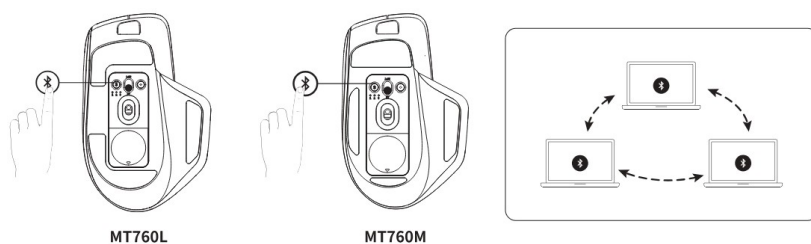

Briefly press the Bluetooth button to change among 3 paired devices.

#### Wired Mode

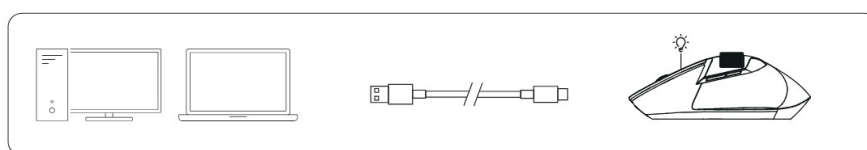

Wired Connection: The green light of the connection indicator is on for 3 seconds, while the white light of the power indicator stays on, and charging is carried out during connection and use.

## Install driver



## M+ Cross-device transmission function

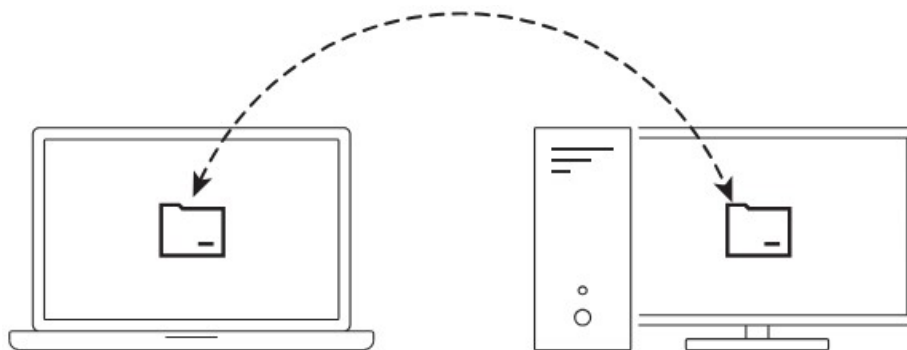

File transmission can be done by copying and pasting under Windows when mice is connected with 2.4G, all paired devices are installed with driver and connected with same LAN in the same domain. File transmission doesn't support drag and drop among devices.



## Safety Instruction

Please scan the QR code



<https://scanqr.to/2317dee6>

## Warranty conditions

This device is covered by a 2-year limited hardware warranty from the date of purchase.

## Legal & Compliance Information

**Product:** Rapoo Multi-mode Wireless Mouse

**Model:** MT760L / MT760M

[www.rapoo-eu.com](http://www.rapoo-eu.com)

[as-europe@rapoo.com](mailto:as-europe@rapoo.com)

Manufacturer:  
Rapoo Europe BV.  
Prismalaan West 27  
2665 PC Bleiswijk  
The Netherlands

UK Authorized Representative (for authorities)  
ProductIP (UK) Ltd.  
8, Northumberland Av.  
London WC2N 5BY  
United Kingdom



Conformity Information: Hereby, Rapoo Europe BV. declares that this radio equipment product is in compliance with Directive 2014/53 EU (RED) and all other applicable EU Regulations. The full text of the EU Declaration of Conformity is available at the following internet address: [www.rapoo-eu.com](http://www.rapoo-eu.com). Operating frequency band: 2402-2479MHz Maximum radio-frequency power transmitted: 5dBm/3.16mW



Conformity Information United Kingdom: Hereby, ProductIP (UK) Ltd., as authorized representative of Rapoo Europe BV., declares that this radio equipment product is in compliance with the UK Radio Equipment Regulations 2017 and all other applicable UK Regulations. The full text of the UK Declaration of Conformity is available at the following internet address: [www.rapoo-eu.com](http://www.rapoo-eu.com). Operating frequency band: 2402 to 2479 MHz. Maximum radio-frequency power transmitted: 5dBm/3.16mW

#### Recycling Information



**Disposal of Packaging Materials:** The packaging materials have been selected for their environmental friendliness and are recyclable.

Dispose of packaging materials which are no longer needed in accordance with applicable local regulations.



**Disposal of the Device:** The symbol above and on the product means that the product is classed as Electrical or Electronic equipment and should not be disposed with other household or commercial waste at the end of its useful life. The Waste of Electrical and Electronic Equipment (WEEE) Directive has been put in place to recycle products using best available recovery and recycling techniques to minimise the impact on the environment, treat any hazardous substances and avoid the increasing landfill. Contact local authorities for information on the correct disposal of Electrical or Electronic equipment.



**Disposal of Batteries:** Used batteries may not be disposed of in normal household waste. All consumers are required by law to dispose of batteries at a collection point provided by their local community or at a retail store. The purpose of this obligation is to ensure that batteries are disposed of in a non-polluting manner. Only dispose of batteries when they are fully discharged. Cover the poles of partially discharged batteries with tape to prevent short circuits.

#### Made in China



©2023 Rapoo. All rights reserved. The Bluetooth® word mark and logos are registered trademarks owned by Bluetooth SIG, Inc. and any use of such marks by Rapoo is under license. Rapoo, the Rapoo logo and other Rapoo marks are owned by Rapoo and may be registered. All other trademarks are property of their respective owners.

It's forbidden to reproduce any part of this quick start guide without the permission of Rapoo.





[www.rapoo-eu.com](http://www.rapoo-eu.com)

**Documents / Resources**

	<p><a href="#">rapoo MT760LW Multi Mode Wireless Mouse</a> [pdf] User Guide</p> <p>MT760LW Multi Mode Wireless Mouse, MT760LW, Multi Mode Wireless Mouse, Mode Wireless Mouse, Wireless Mouse, Mouse</p>
---	--

**References**

- [User Manual](#)

[Manuals+](#), [Privacy Policy](#)

This website is an independent publication and is neither affiliated with nor endorsed by any of the trademark owners. The "Bluetooth®" word mark and logos are registered trademarks owned by Bluetooth SIG, Inc. The "Wi-Fi®" word mark and logos are registered trademarks owned by the Wi-Fi Alliance. Any use of these marks on this website does not imply any affiliation with or endorsement.