



rapoo MT760L Multi Mode Wireless Mouse User Guide

[Home](#) » [rapoo](#) » rapoo MT760L Multi Mode Wireless Mouse User Guide 

Contents

- [1 rapoo MT760L Multi Mode Wireless Mouse](#)
- [2 Overview](#)
- [3 Instruction](#)
- [4 Package Contents](#)
- [5 Status LED](#)
- [6 Safety Instructions And Troubleshooting](#)
- [7 Agent Information](#)
- [8 Documents / Resources](#)
 - [8.1 References](#)
- [9 Related Posts](#)



rapoo MT760L Multi Mode Wireless Mouse



Overview

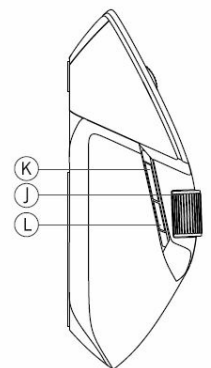
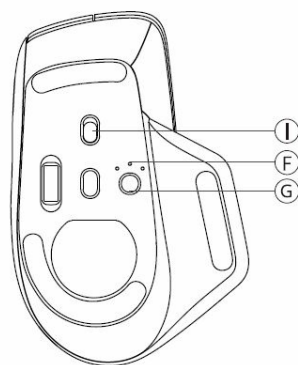
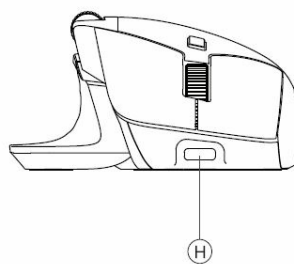
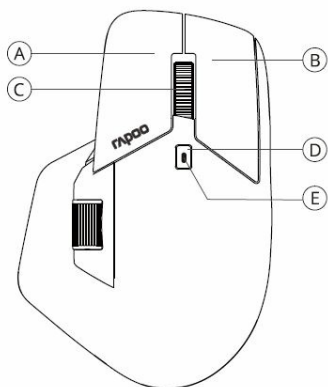

- **A:** Left button
- **B:** Right button
- **C:** Middle button/scroll wheel
- **D:** DPI switching button
- **E:** Power, charging and low-power
- **G:** Device switching button
- **H:** USB port
- **I:** On/off switch
- **J:** Side scroll wheel

- **K:** Forward button
- **L:** Back button

Instruction

2.4G

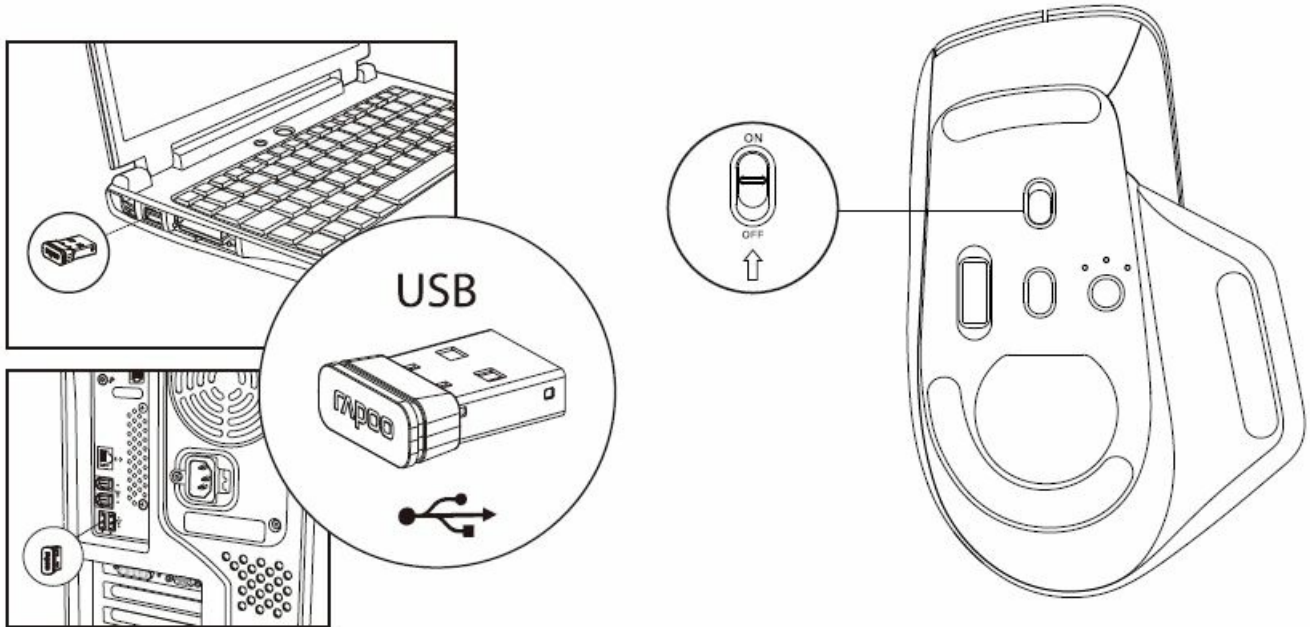

1. Plug in Rapoo receiver.
2. Turn on the mouse.
3. Done.

Bluetooth 3.0 and 5.0

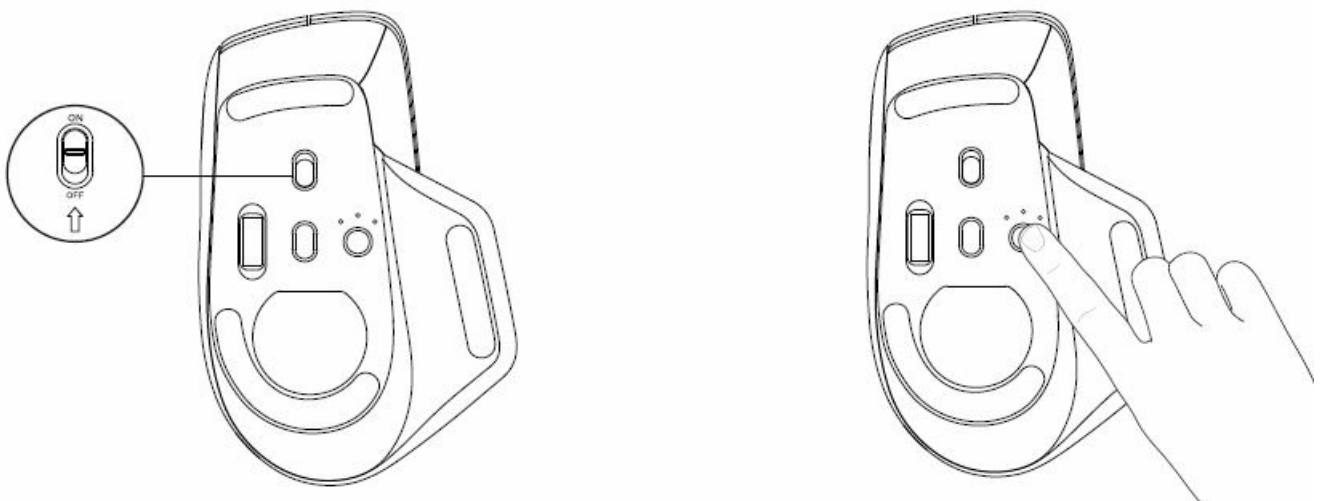

1. Turn on MT760L. Device light starts to blink rapidly.
2. Press the device switch button to select the device channel.
3. Keep pressing the device switch button at least 3 seconds to bluetooth pairing.
4. Connect the mouse with your Bluetooth device. Blinking stops.
5. Done.

- Bluetooth compatibility of the product is related to the host device and the installed software version. The product may be partially incompatible.

Package Contents

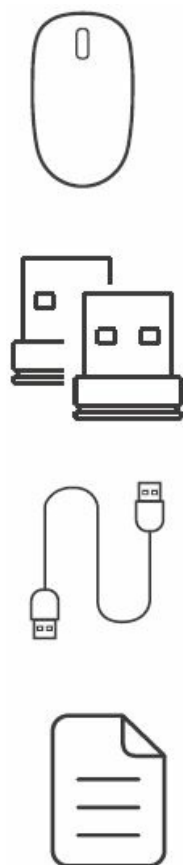

- Wireless mouse,
- Quick start guide,
- receiver*2,
- USB charging cable

System Requirements

- Windows® XP / Vista / 7 / 8 / 10 or later, USB port

Switch among devices

- Switch among five devices (two 2.4G devices + three Bluetooth devices) through the device toggle key.

Status LED

1. DPI switching indicator

- Green LED blinks. It blinks once when you switch to the first DPI, blinks twice for the second DPI, blinks three times for the third DPI and blinks four times for the fourth DPI.

2. Low power indicator

- Green LED blinks

3. Charging indicator

- The green indicator turns on when being charged, and the green indicator turns off when fully charged.

Devices LED

- The three Bluetooth devices have corresponding indicators.
- Press and hold the Bluetooth key for 3 seconds to enter the code alignment state (the blue indicator flashes slowly) or the reconnection state (flashing quickly),
- Short press the Bluetooth key to switch the device;
- The mouse can be found, and the blue device indicator flashes slowly and Bluetooth pairing can be made.
- The Bluetooth device is connected successfully: The corresponding blue device indicator is lit up for 5 seconds when the mouse is held.
- Toggle to 2.4G device connection without indicator prompt.

Side scroll wheel

- Scroll horizontally by default. Set up customize functions via driver.

Safety Instructions And Troubleshooting

Safety Instructions

- Do not open or repair this device. Do not use the device in a damp environment.
- Clean the device with a dry cloth.

Troubleshooting

- See www.rapoo.com for latest FAQs, drivers and quick start guide.
- For more services and help, please register on www.rapoo.com.

Agent Information

Country (or area)	Information	Description
Hongkong	Company name Address Tel#	Vim Yield Company 852-31522789
Malaysia	Company name Address Tel#	AV FUTURE LINK SDN BHD NO.23A,JALAN 5/152,TAMAN PERINDUSTRIAN OUG,PUCHONG,58200 KUALA LUMPUR ,MALAYSIA (+0060)377830011

More Information

Equipment name: Multi-mode Wireless Mouse				Type designation(Type): MT760L		
Unit	Restricted substances and its chemical symbols					
	Lead (Pb)	Mercury (Hg)	Cadmium (Cd)	Hexavalent chromium (Cr+6)	Polybrominated biphenyls (PBB)	Polybrominated diphenyl ethers (PBDE)
Cable	○	○	○	○	○	○
PWAs	○	○	○	○	○	○
Plastic parts	○	○	○	○	○	○
Metal parts	○	○	○	○	○	○
Rubber parts	○	○	○	○	○	○
<p>Note 1: “Exceeding 0.1 wt %” and “exceeding 0.01 wt %” indicate that the percentage content of the restricted substance exceeds the reference percentage value of presence condition.</p> <p>Note 2: “○” indicates that the percentage content of the restricted substance does not exceed the percentage of reference value of presence.</p> <p>Note 3: The “—” indicates that the restricted substance corresponds to the exemption.</p>						

Scan



- www.rapoo.com
- TEL: 4008 887 778

Copyright

It is forbidden to reproduce any part of this quick start guide without the permission of Shenzhen Rapoo



Documents / Resources

	<p>rapoo MT760L Multi Mode Wireless Mouse [pdf] User Guide</p> <p>MT760L Multi Mode Wireless Mouse, MT760L, Multi Mode Wireless Mouse, Mode Wireless Mo use, Wireless Mouse, Mouse</p>
--	--

References

- [User Manual](#)